

Features

- Three-year warranty
- Steam generators can be installed up to 25' (7.6 m) away from steam bath area

Codes/Standards Applicable

Specified model meets or exceeds the following:

- UL 499
- CSA C22.2 No. 88

STEAM GENERATOR K-1714-NA ALSO K-1715-NA, K-1697-NA, K-1716-NA

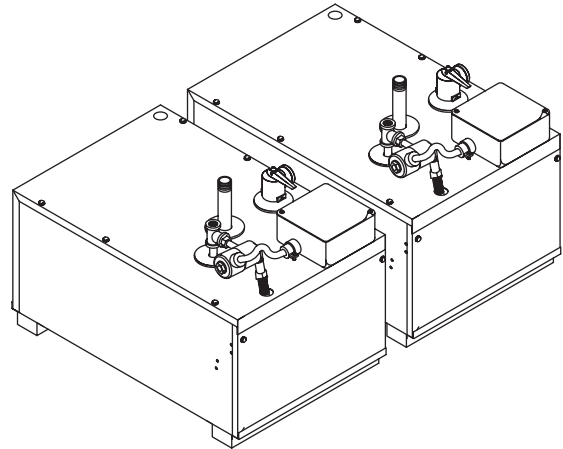

Colors/Finishes

- NA: None applicable

Accessories:

- CP: Polished Chrome
- PB: Polished Brass
- Other: Refer to Price Book for additional colors/finishes

Specified Model

Model	Description	Colors/Finishes
K-1714-NA	Steam generator, 18 kW	<input type="checkbox"/> NA
K-1715-NA	Steam generator, 22 kW	<input type="checkbox"/> NA
K-1697-NA	Steam generator, 26 kW	<input type="checkbox"/> NA
K-1716-NA	Steam generator, 30 kW	<input type="checkbox"/> NA

Required Accessories: Choose either Option 1 or Option 2 below.

Option 1:

K-1647-PC	Steam control kit, power clean	<input type="checkbox"/> CP	<input type="checkbox"/> PB	<input type="checkbox"/> Other_____
-----------	--------------------------------	-----------------------------	-----------------------------	-------------------------------------

Option 2:

K-1838	Steam adaptor kit and dual steam head AND	<input type="checkbox"/> CP	<input type="checkbox"/> PB	<input type="checkbox"/> Other_____
--------	--	-----------------------------	-----------------------------	-------------------------------------

K-694	Landscape digital interface OR			<input type="checkbox"/> Other_____
-------	---------------------------------------	--	--	-------------------------------------

K-695	Portrait digital interface			<input type="checkbox"/> Other_____
-------	----------------------------	--	--	-------------------------------------

Optional accessories are available, refer to the Kohler Price Book.

Product Specification

The steam generator shall have a three-year warranty. Product shall be installed up to 25' (7.6 cm) away from the steam bath area. Steam generator shall be Kohler Model K-_____-NA.

Technical Information

Water and drain requirements:		
Water supply	3/8" copper line, 3/8" NPT female thread	
Steam line	1/2" copper line 1/2" NPT female thread	
Pressure relief valve	3/4" NPT female thread, valve supplied	
Drain line	3/8" copper line, 3/8" NPT female thread, ball valve supplied	
Generator:		
Weight	18 kW, 22 kW = 42 lbs (19 kg) 26 kW, 30 kW = 64 lbs (29 kg)	
Electrical rating	18 kW 22 kW 26 kW 30 kW	45 A, 50/60 hz 48 A, 50/60 hz 60 A, 50/60 hz 70 A, 50/60 hz

Generator:		
Model	Power Rating	Max Volume Rating
K-1714-NA	18 kW	480 cu. ft. (14 cu. m)
K-1715-NA	22 kW	634 cu. ft. (18 cu. m)

Generator (cont'd):

Model	Power Rating	Max Volume Rating
K-1697-NA	26 kW	894 cu. ft. (25 cu. m)
K-1716-NA	30 kW	1000 cu. ft. (28 cu. m)

Required Electrical Service

Two dedicated circuits required:

Steam generator - 18 kW	240 V, 50 A, 50/60 Hz
Steam generator - 22, 26 kW	240 V, 70 A, 50/60 Hz
Steam generator - 30 kW	240 V, 100 A, 50/60 Hz

Installation Notes

Install this product according to the installation guide.

For this steam generator, do not exceed the maximum rating volume.

To determine the appropriate model for your installation, determine the cubic feet of your steam area by multiplying L x W x H. Compare the total to chart and use the closest match. Always round up. For every foot of ceiling height over 8' (2.45 m) use the next larger steam unit.

Minimum required access is 20" (50.8 cm)
L x 13" (33" cm) H x 6-1/2" (16.5 cm) W.

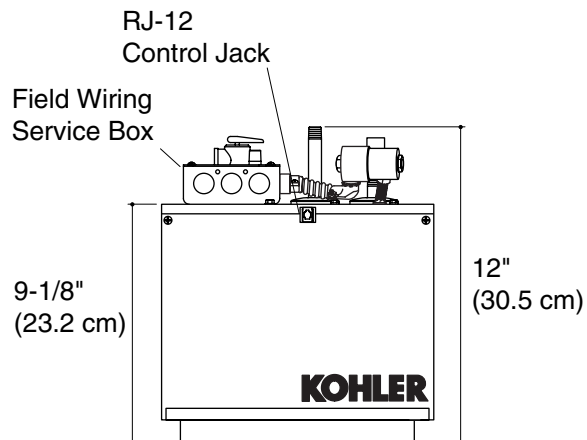
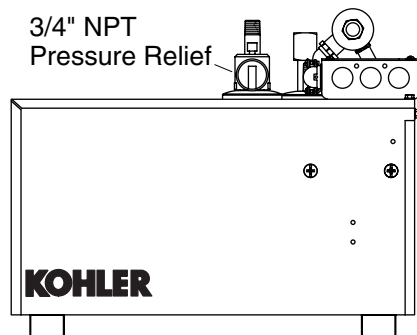
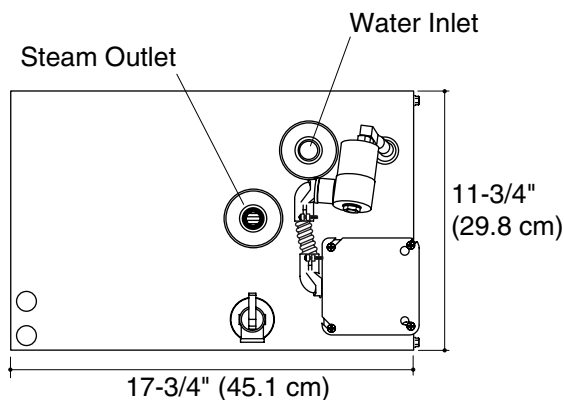

Product Diagram

STEAM GENERATOR

Page 2 of 2
1053777-4-B

THE BOLD LOOK
OF **KOHLER**