

# Classic / Victorian / Colonial

3/2- and 4/3-Port Diverter Valves

876/176/... 876/186/... 876/711/...

# JADO

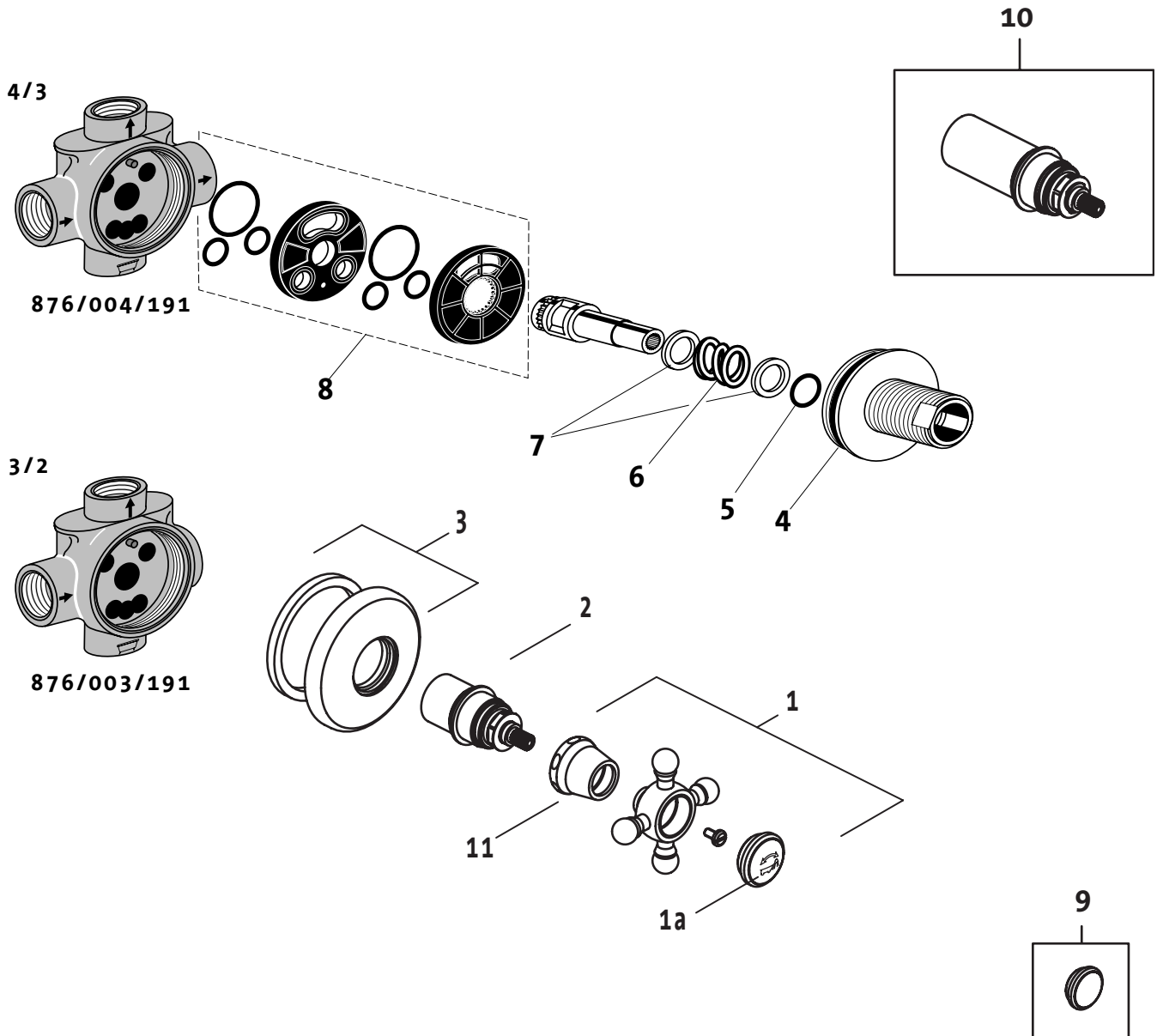

**Replace "XXX" with the appropriate finish code:**

Polished Chrome = 100, Old Bronze = 105, UltraBrass = 113, Brushed Nickel = 144,  
Platinum Nickel = 150, Diamond = 167, Antique Nickel = 444

**Example Repair Part order:**

H961220.105 in Old Bronze  
H961220.167 in Diamond

Pos.	Description	Repair Part Number	Delivery quantity	Pos.	Description	Repair Part Number	Delivery quantity
1	Cross Handle Set with "Icon"	H961220.XXX	1 Set	5	O-Ring	A860851.191	1 Piece
1a	Handle Cap with "Icon"	H960528.XXX	1 Set	6	Pressure Spring	A860850.191	1 Piece
2	Extension	H961221.XXX	1 Piece	7	Friction Flange	A860849.191	1 Piece
3	Rosette	H961222.XXX	1 Piece	8	Switch-over Element	A860848.191	1 Set
4	O-Ring	A860607.191	1 Piece	9	All Metal Handle Cap	H960986.XXX	1 Piece
				10	Extension Kit	H2749.XXX	1 Piece
				11	Tapered Sleeve	H960357.XXX	1 Piece