

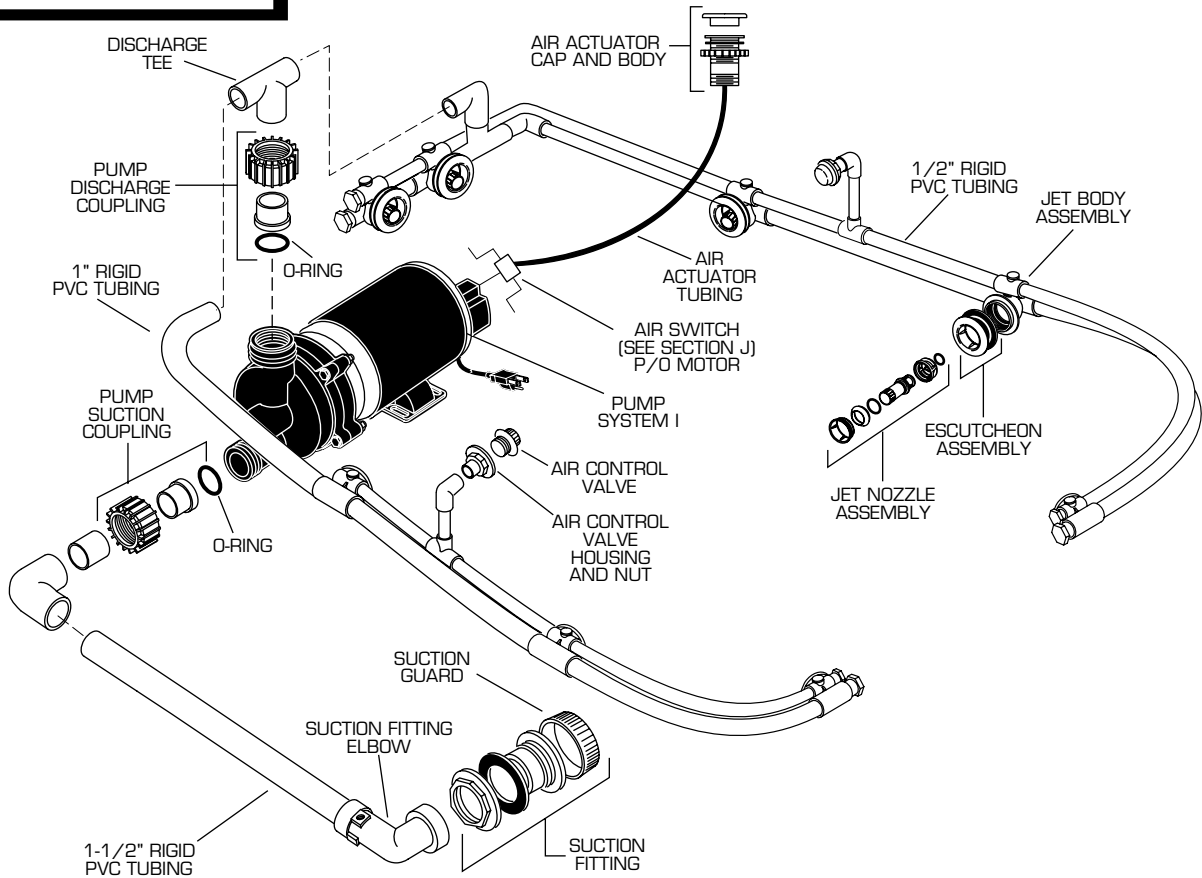

**CADET 6' X 36"  
WHIRLPOOL  
MODEL NUMBER**



*American Standard*

**2773.018**



DESCRIPTION	PART NUMBER	PKG QTY
Pump Suction Coupling	047186-0070A	1
O-Ring	047187-0070A	1
Pump Discharge Coupling	047186-0070A	1
★ Air Control Valve	751677-XXX0A	1
★ Air Control Valve Housing and Nut	068917-XXX0A	1
★ Jet Nozzle Assembly 	047587-XXX0A	1
★ Escutcheon Assembly 	047588-0070A	1
Jet Body Assembly	047627-00700A	1
★ Suction Guard	047463-XXX0A	1
★ Suction Fitting	047550-XXX0A	1
Suction Fitting Elbow	751186-0070A	1
Discharge Tee	047438-0070A	1
Pump w/Air Switch (1 HP)	752444-0070A	1
Air Switch (See Section J)	752388-0070A	1
★ Air Actuator Cap and Body	752439-XXX0A	1
Air Actuator Tubing	047602-0070A	3 ft.

NOTE: Schedule 40 Rigid PVC Piping available through local plumbing supply outlets.  
See Section "J" for Additional Parts and Accessories.

-  Removal/installation requires tool part no. 047530-0070A.
-  Removal/installation requires tool part no. 047605-0070A.

★ Replace XXX with Fixture Color Code; see page VII