

American Standard

HERITAGE 5' X 42" WHIRLPOOL MODEL NUMBERS

2805.018 2805.028 2805.028H

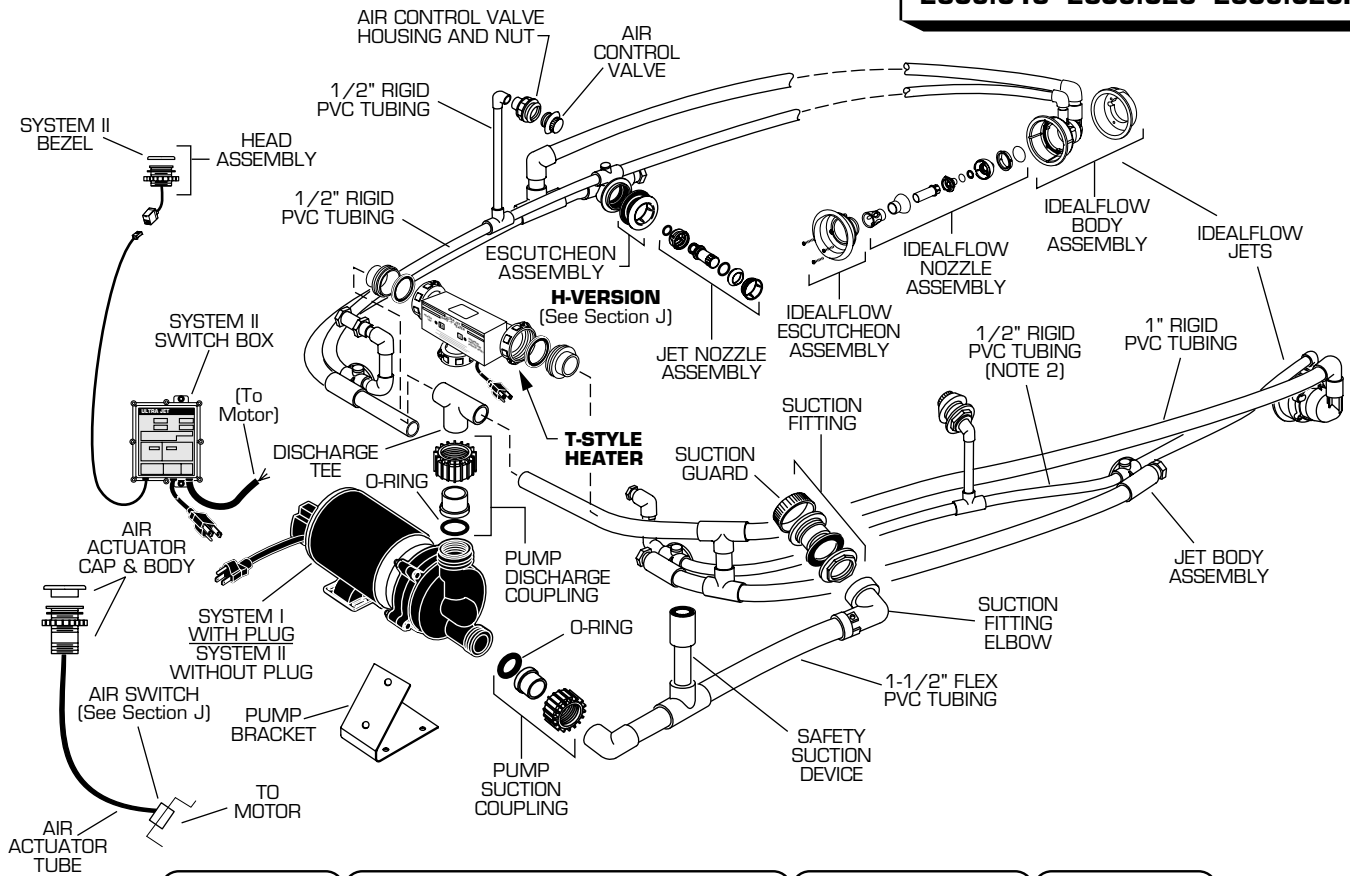

	DESCRIPTION	PART NUMBER	PKG QTY
ALL MODELS	Pump Suction Coupling	047186-0070A	1
	O-Ring	047187-0070A	1
	Pump Bracket	752183-0070A	1
	Pump Discharge Coupling	047186-0070A	1
	★ Air Control Valve (Plastic)	751676-XXX0A	1
	★ Air Control Valve (Metal)	068916-YYY0A	1
	★ Air Control Valve Housing/Nut	068917-XXX0A	1
	★ Jet Nozzle Assembly Δ	047587-XXX0A	1
	★ IdealFlow Nozzle Assembly	752407-XXX0A	1
	★ Escutcheon Assembly \square	047588-XXX0A	1
	★ IdealFlow Escutcheon	752408-XXX0A	1
	Jet Body Assembly	047627-0070A	1
	IdealFlow Body Assembly	752409-XXX0A	1
	★ Suction Guard	750537-XXX0A	1
	★ Suction Fitting	752396-XXX0A	1
Suction Fitting Elbow	751186-0070A	1	
Discharge Tee	047438-0070A	1	
Safety Suction Device	752390-0070A	1	
SYSTEM I .018	Pump (1 Speed, 3/4 HP)	751690-0070A	1
	Air Switch	See Section J	1
	★ Air Actuator Cap/Body	752330-XXX0A	1
SYSTEM II .028 .028H	Air Actuator Tubing	047602-0070A	3 ft.
	Pump (2 Speed, 1 HP)	752116-0070A	1
	★ Head Assembly \circ	752118-YYY0A	1
	★ System II Bezel \circ	752115-YYY0A	1
	System II Switch Box	752119-0070A	1
Heater (.028H only) See Section J	752356-0070A	1	

\circ Available in Chrome, Polished Brass, and Gold.

NOTE: Schedule 40 Rigid PVC Piping available through local plumbing supply outlets.

See Section "J" for Additional Parts and Accessories.

Δ Removal/installation requires tool part no. 047530-0070A.

\square Removal/installation requires tool part no. 047605-0070A.

★ Replace XXX with Fixture Color Code, YYY with Trim Finish Code; see page VII