

Sliding Door

Tools Required

Phillips Screwdriver

Adjustment

1. To adjust the door alignment first loosen top roller adjustment screw (Figure A)
2. Check alignment of door to edge of end panel on both sides of the cabinet. Adjust bottom roller as needed for alignment.
3. To tighten sliding mechanism, with bottom roller engaged in bottom track adjust top rollers so it is engaged into the top track and tighten adjustment screw. Important: Check that the door is not loose or too tight, that they move freely from side to side, and are flush from top to bottom.

Figure B

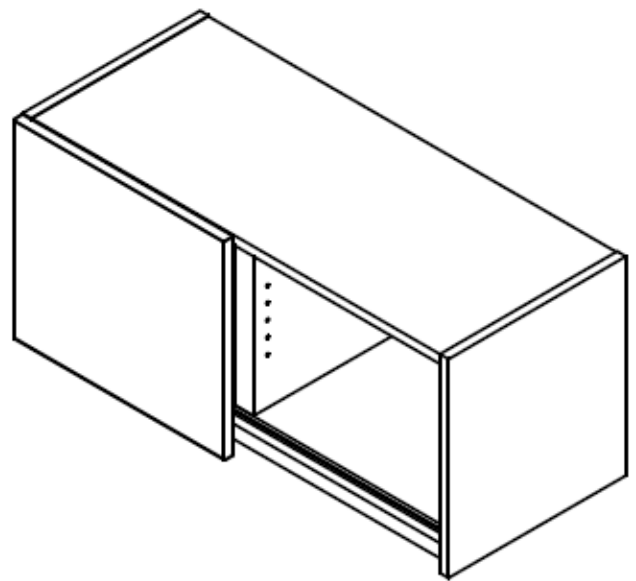

Figure A

