

Priority

108", 102", and 96" Highback Organizer

Tools Required

- Phillips Screwdriver
- Scissors or Utility Knife
- Allen Wrench
- Tape Measure or Ruler

Package Contents

- Connecting Bolts
- #8 x $\frac{5}{8}$ " Panhead Screws
- Gang Plates

Installation

Note: The 108" highback organizer is shipped as two pieces: a right and a left.

Note: It is recommended that more than one person be used to assemble and install this unit.

1. Install two halves on a flat surface. Lift the first highback half into its desired location on the worksurface. Lift the second highback half into position against the first unit. Make sure units align and are flush on all sides. (Figure A).
Caution: Make sure first unit is held steady while locating second unit.
2. Align connecting holes in highbacks and attach highbacks together using the four (4) provided connecting bolts. Insert half of a connector bolt into one connecting hole, and insert the other half into the opposite connecting hole. Tighten all bolts securely, making sure both highback halves are flush against each other with no gaps. (Figures B1 and B2).

Figure A

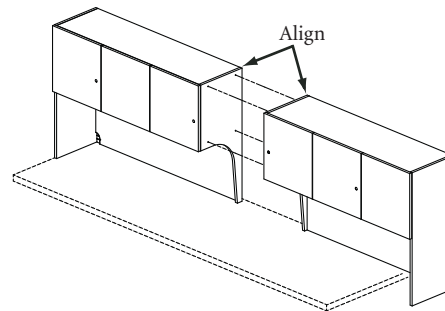

Figure B1

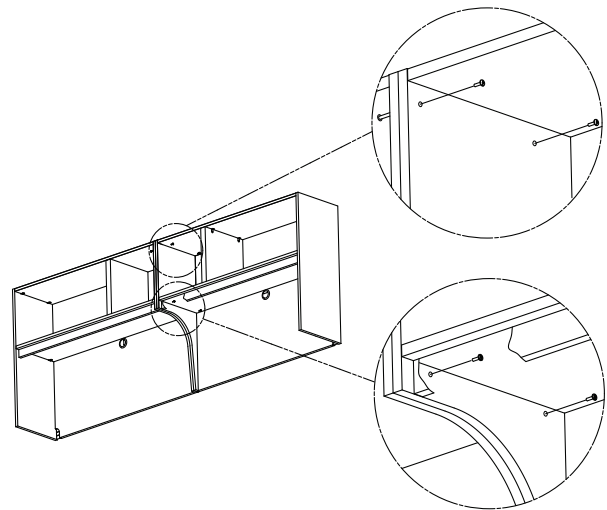
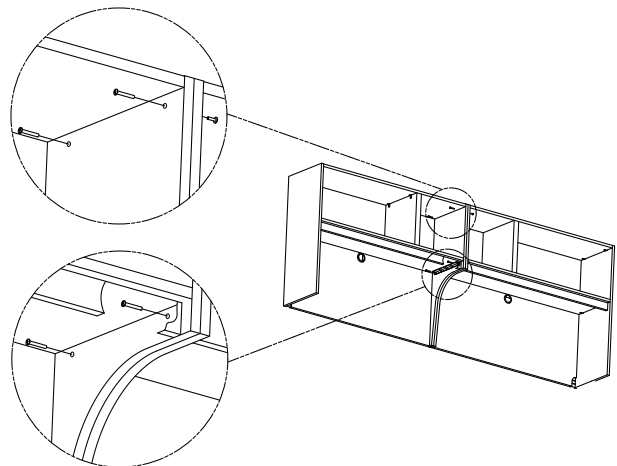

Figure B2



Installation (continued)

3. Lay assembled organizer halves on their front. Attach gang plates with fasteners provided as shown. (Figure C).
4. Make sure assembled unit is in its final desired position. (Figure E). Carefully tilt unit forward and remove the protective backing from each piece of double-sided adhesive tape located on the bottom of unit. (Figure D).
5. Set unit upright and press down to ensure good bond with adhesive. (Figure E).

Caution: Double-sided tape has a powerful adhesive which permanently bonds to any surface.

Figure C

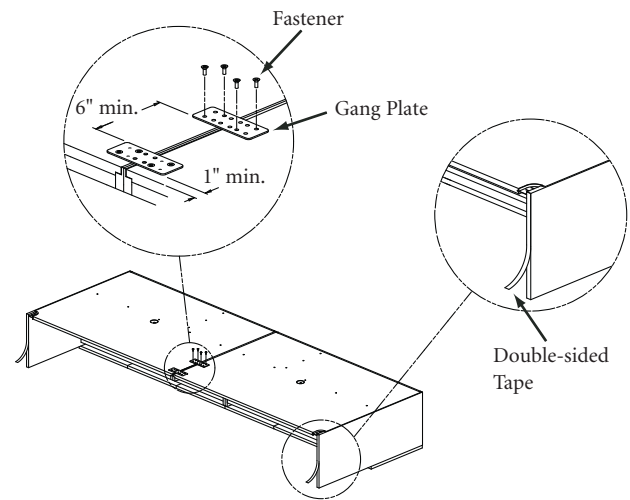

Figure D

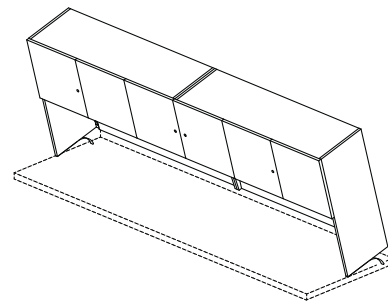

Figure E

