

Technology Modesty Panel

Tools Required

- * Tape Measure
- * Cordless Drill
- * #2 Philips Head Bit

Hardware Required

- * L Brackets
- * #8 x 5/8" Panhead Screws
- * #8 x 1" Panhead Screws
- * #8 x 1 3/4" Panhead Screws

Installation

1. Install L brackets to end panels with #8 x 1" panhead screw, long leg to panel (Figure A).
2. Align end panel flush with the bottom of panel it's attaching on a storage unit, the panel needs to be even with the back of the storage end panel to inset (Figure B). Check that both sides are the same distance off the back of the worksurface. Attach with #8 x 1 3/4" screws.
3. Flush bottom of modesty panel with bottom of end panels. Center in kneespace opening (Figure C). There is side to side adjustment to meet multiple applications.
4. Attach modesty to L brackets attaching end panels with #8 x 5/8" (Figure D).

Note: to ensure proper function modesty must be installed per-pendicular to the panels creating the kneespace. If not properly installed, hinged panel could rub sides of knee space.

Figure A

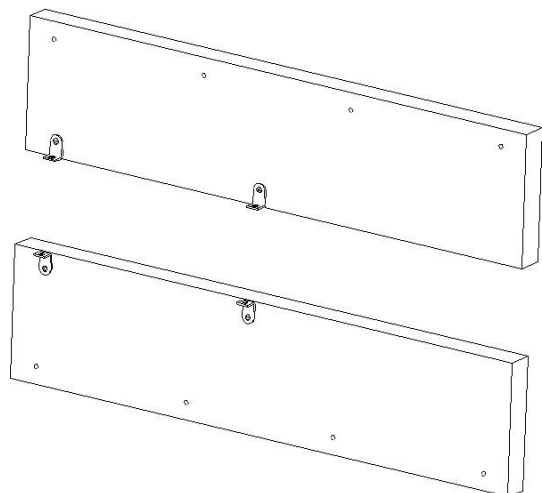

Figure B

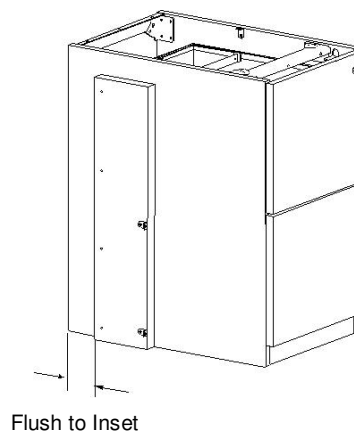

Figure C

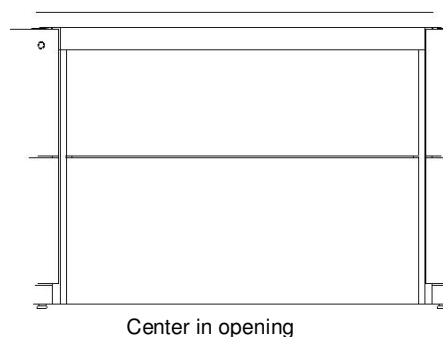
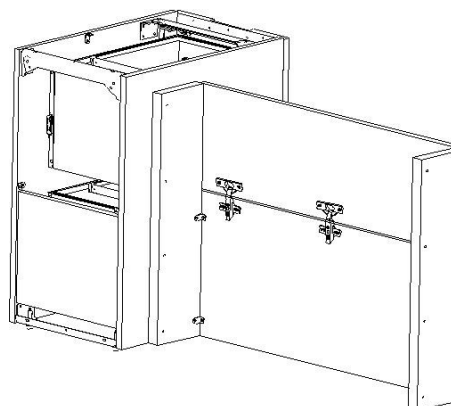

Figure D



Shown with worksurface and panels removed for clarity.