

PRESIDENT®

Traditional Casegoods



Price List Effective Dates:

Pricing	03.02.20
Revision	02.17.20

► See page

Statement of Line	13.2
Planning	13.4
Overview	13.4
Typical Configurations	13.5
Filing Capabilities	13.7
Pricing	13.8
Double-Pedestal Desks	13.8
Table Desks	13.10
Extended Single-Ped Desks	13.11
Single-Pedestal Desks	13.12
Executive Returns	13.13
Bridges	13.14
Credenzas	13.15
Task/Reception Station	13.18
Highback Organizers	13.19
Wall-Mounted Cabinets	13.20
Lateral Files	13.21
Lectern & Wardrobe	13.22
Mobile Utility Table	13.23
Component Storage	13.24
Bookcases	13.26
Surface Materials	13.28
Wood or HPL	13.28
Fabric & Upholstery	13.29
Leather	13.30

IMPORTANT: All dimensions shown below are nominal and have been rounded to the nearest inch. Refer the appropriate pricing pages for actual dimensions.



Double-Pedestal Desks

➤ See page 13.8 to specify.

	66"W	72"W	78"W	86"W
30"W	●			
36"D		●		
42"D			●	●



Table Desks

➤ See page 13.10 to specify.

	72"W
36"D	●



Extended Single-Pedestal Desks

Available in left and right models.

➤ See page 13.11 to specify.

	78"W
42"D	●



Single-Pedestal Desks

Available in left and right models.

➤ See page 13.12.

	72"W	78"W
36"D	●	●

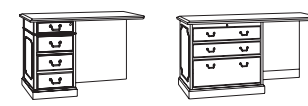

Executive Returns

Available in left and right models.

➤ See page 13.13.

	51"W	63"W
25"D	●	●



Bridges

● = Hinged modesty panel

■ = Partial modesty panel

➤ See page 13.14 to specify.

	51"W
25"D	● ■

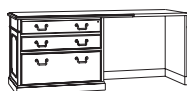

Single-Pedestal Credenzas

Available in left and right models.

● = Lateral file

■ = File/file

➤ See page 13.15 to specify.

	78"W
24"D	● ■



Credenzas

● = Full storage

■ = Kneespace

▲ = Buffet

➤ See pages 13.16–13.17 to specify.

	75"W	78"W
24"D	● ■ ▲	●

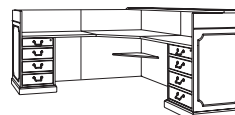

Task/Reception Station

➤ See page 13.18 to specify.

Storage

Statement of Line

IMPORTANT: All dimensions shown below are nominal and have been rounded to the nearest inch. Refer the appropriate pricing pages for actual dimensions.

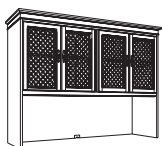

Highback Organizers

- = Grille doors
- = Glass doors
- ▲ = Wood doors
- See page 13.19 to specify.

74"W
16"D ● ■ ▲

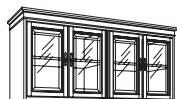

Wall-Mounted Cabinets

- = Grille doors
- = Glass doors
- ▲ = Wood doors
- See page 13.20 to specify.

74"W
16"D ● ■ ▲



Lateral Files

- See page 13.21 to specify.

30"H 55"H
39"W ● ●



Lectern

- See page 13.22 to specify.

47"H
24"W ●

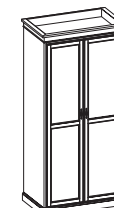

Wardrobe

- See page 13.22 to specify.

81"H
24"W ●



Mobile Utility Table

- See page 13.23 to specify.

37"H
39"W ●

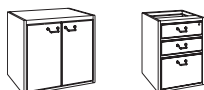

Component Storage

- = Lateral files
- = Hinged-door storage
- ▲ = Box/box/file or file/file
- See page 13.24 to specify.

25"H 51"H
18"W ▲
36"W ● ■ ●

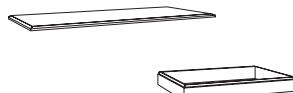

Credenza Worksurfaces and Bases

- For one, two, or three storage components.
- See page 13.25 to specify.

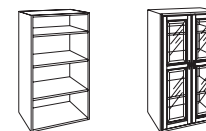

Bookcases

- = Open shelves
- = Grille doors
- = Glass doors
- ▲ = Wood doors
- See page 13.26 to specify.

48"H 70"H
36"W ○ ● ■ ▲ ○

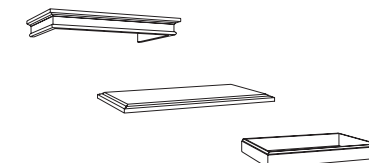

Cornice Frames, Tops, and Bases for Bookcases

- For one, two, or three storage components.
- See page 13.27 to specify.

Statement of Line	►See page 13.2
Planning	13.4
Pricing	13.8
Surface Materials	13.28

Exterior surfaces are walnut (plain sliced, book matched) veneer. Veneers are carefully selected and matched to assure proper balance and consistency.

Rims are solid hardwood with precisely mitered corners.

Decorative molding is available as an option. Upcharge applies.

Leveling glides adjust for uneven floors.

Drawer fronts are ¾" thick 3-ply and use 100% butt-figured walnut veneer.

Leather-wrapped pulls are available. Upcharge applies.

Tops are 1¾" thick, 3-ply balanced construction. Wood grain laminate is also available.

Writing shelf is standard on single- and double-pedestal desks.

Full-height pedestals have one pencil drawer, one box drawer, and one file drawer. File drawer has the appearance of two box drawers.

Drawer sides and back are ½" thick with veneer faces. Drawer bottoms are ¼" thick. 5-sided construction allows easy removal of drawer front. Dowel joint assembly is used for maximum strength. Interiors are sealed, sanded, and finished with a clear lacquer finish to protect against swelling, shrinking, or warping and to provide a smooth feel and appearance.

Center drawer is standard on double-pedestal and table desks. Bottom of drawer is lined with black leather.

Centra locking is featured on double- and single-pedestal desks, credenzas and lateral files to secure all drawers in the unit with a single lock. Lock cylinders are removable if rekeying is necessary. Key random and key specific options are available.

Base rails are solid hardwood for impact and wear resistance.

Details



Burl

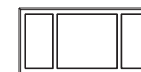

Leather Inlay

Burl and leather inlay models are available on select desk worksurfaces. ►See page 13.30 for leather choices.

Antique brass metal grommets are optional on all desks, returns, credenzas, and bridges.

Joints are securely fastened with screws, glue, and solid hardwood cleats to ensure maximum strength.

Drawer dividers are included in desks and credenzas for placement in any box drawer.

Full extension, progressive action drawer suspensions, with precision ball bearings on file drawers, provide a smooth, quiet operation. Box drawers have full extension slides with a positive stop action.

Heavy-duty filing hardware accommodates various filing requirements. ►See page 13.7 for filing capabilities.

Related Products

Accessories, such as keyboard drawer, adjustable keyboard products, and visual boards available to add functionality to workspaces. ►See the Perks chapter in the *Kimball Desks & Accessories Price List*.

Typical Configurations

Planning

Executive U and L

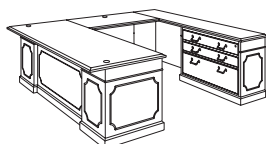

Qty	Model*	Description
1	PR3678DLFW	Left pedestal desk
1	PR2551BEFW	Bridge with full modesty panel
1	PR2478CRF6W	Right pedestal credenza
1	PR1932CD	Center drawer (optional)

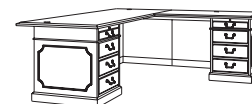

Qty	Model*	Description
1	PR3672DLFW	Left pedestal desk
1	PR2551RREFW	Right executive return with full modesty panel
1	PR1932CD	Center drawer (optional)

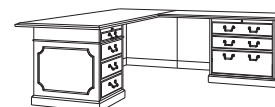

Qty	Model*	Description
1	PR3672DLFW	Left pedestal desk
1	PR2567RREF	Right executive return with full modesty panel

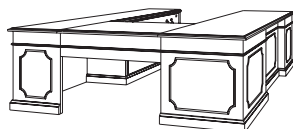

Executive U configurations can also be achieved by using a bridge with a partial modesty panel.

Statement of Line	▶ See page 13.2
Planning	13.4
Pricing	13.8
Surface Materials	13.28

The configurations shown at left are typical of those possible with President components. Many more configurations are possible to fit your installation.

Right configurations are shown; left units can easily be configured. ▶ See appropriate pricing pages for model numbers.

To price a configuration, simply add the prices of the individual components together.

* Check the applicable pricing page for the complete base model number.

Typical Configurations

Vertical Storage and Bookcases

Planning

Statement of Line	►See page 13.2
Planning	13.4
Pricing	13.8
Surface Materials	13.28



Qty	Model*	Description
1	PR1574CPCF	Cornice frame
2	PR3648BCO	Open bookcase
1	PR2475WSSW	Credenza worksurface
2	PR2236LFM2	Component lateral file
1	PR2373CPB	Base



Qty	Model*	Description
1	PR15110CPCFI	Cornice frame with wood insert
2	PR3648BCO	Open bookcase
1	PR3648BCHM	Bookcase with grille doors
1	PR24111WSSW	Credenza worksurface
2	PR2236PUBBF	Component box/box/file
1	PR2236PUH	Component storage unit
1	PR23109CPB	Base



Qty	Model*	Description
1	PR1539CPTW	Bookcase top
1	PR3648BCO	Open bookcase
1	PR1537CPB	Bookcase base



Qty	Model*	Description
1	PR1575CPTW	Bookcase top
2	PR3648BCHM	Bookcase with grille doors
1	PR1573CPB	Bookcase base

The configurations shown at left are typical of those possible with President components. Many more configurations are possible to fit your installation.

Right configurations are shown; left units can easily be configured.
►See appropriate pricing pages for model numbers.

To price a configuration, simply add the prices of the individual components together.

*Check the appropriate pricing page for the complete model number that includes the finish.



Many vertical storage units can also be achieved by using different sizes of cornice frames, work-surfaces, and bases with different components and bookcases.

A variety of bookcases can also be achieved by using grille, glass, or wood door bookcases with a top and base.

Statement of Line	►See page 13.2
Planning	13.4
Pricing	13.8
Surface Materials	13.28

Description	Type	Interior Dimensions			Standard Filing Capabilities	
		Inside Depth	Inside Width	Inside Height	Front-to-Back	Side-to-Side
Desks						
Double-pedestal desk, 42 x 86, 42 x 78,	Pencil	17"	15"	1½"	—	—
36 x 72 (with dictation slide)	Box	17"	15"	3"	—	—
	File	25"	15"	9"	Legal	Legal, double letter, and EDP
	Center	17"	26¾"	1½"	—	—
Double-pedestal desk, 36 x 72 (without dictation slide),	Pencil	17"	12"	1½"	—	—
30 x 66	Box	17"	12"	3"	—	—
	File	17"	12"	9"	Letter	Legal, letter, and EDP
	Center	17"	26¾"	1½"	—	—
Single-pedestal desk, 42 x 78, 36 x 78, 36 x 72, 30 x 66	Pencil	17"	12"	1½"	—	—
	Box	17"	12"	3"	—	—
	File	17"	12"	9"	Letter	Legal, letter, and EDP
Note: Center drawer on 30 x 66 only.	Center	17"	18¼"	1½"	—	—
Executive Returns, 25 x 51						
	Pencil	17"	15"	1½"	—	—
	Box	17"	15"	3"	—	—
	File	17"	15"	9"	Legal	Legal, letter, and EDP
Credenzas						
Single-pedestal credenza, 24 x 78	File	17"	15"	9"	Legal	Legal, letter, and EDP
Credenza, 24 x 78	Box	17"	15"	3"	—	—
	File	17"	15"	9"	Legal	Legal, letter, and EDP
Credenza, 24 x 75	Box	17"	15"	3"	—	—
	File	17"	15"	9"	Legal	Legal, letter, and EDP
	Center	17"	30"	1½"	—	—
Modular File Unit, 22 x 36						
	Box	15"	32¼"	3"	—	—
	File	15"	32¼"	9"	Legal	Legal, letter, and EDP
Lateral Files	Lateral File	15"	32¼"	9"	Legal, letter, and EDP	Legal and letter
Pedestals, 22 x 18						
	Box	17"	14⅞"	3"	—	—
	File	17"	14⅞"	9"	—	Legal, letter, and EDP

IMPORTANT: For all pedestals where legal front-to-back filing is standard, letter front-to-back filing is possible by specifying universal file bars separately.
►See the Perks chapter in the *Kimball Desks & Accessories Price List*.

Paper Reference:

- Legal size paper is 8½" x 14".
- Letter size paper is 8½" x 11".
- EDP size paper is 8½" x 14⅞".

Pedestal Configurations:

Double-Pedestal Desk

- Two pencil/box/file: letter width on 66"W desks and 72"W desks without dictation slide; legal width on 72"W desks with dictation slide, 78"W desks, and 86"W desks.

Ext. Single-Pedestal Desk

- Pencil/box/file: letter width

Single-Pedestal Desk

- Pencil/box/file: letter width

Return

- Box/file (legal width) on 45"W return; pencil/box/file (legal width) on 51"W return; 36"W lateral file on 67"W return

Single-Pedestal Credenza

- File/file (legal width) or 36"W lateral file

Kneespace Credenza

- Two box/box/file: legal width

Storage Credenza

- Two box/box/file: legal width
- Center storage area behind two hinged doors; one adjustable shelf

Buffet Credenza

- Four box drawers
- Four hinged door storage sections, each with an adjustable shelf

Double-Pedestal Desks

Pricing

42"D

GSA SIN 711-8



Note: Illustration shows desk with molding option.

<i>D</i>	<i>W</i>	<i>H</i>	<i>Kneespace</i>	<i>Approach Overhang</i>	<i>Arm Chair Clearance</i>	<i>Model</i>	<i>Price</i>
Worksurface							
Wood							
42"	78"	1 ³ / ₁₆ "	—	7 ³ / ₈ "	24 ¹ / ₂ "	PR4278WSSW	\$2177
42"	86"	1 ³ / ₁₆ "	—	7 ³ / ₈ "	24 ¹ / ₂ "	PR4286WSSW	2578
Burl							
42"	78"	1 ³ / ₁₆ "	—	7 ³ / ₈ "	24 ¹ / ₂ "	PR4278WSSB	\$5541
42"	86"	1 ³ / ₁₆ "	—	7 ³ / ₈ "	24 ¹ / ₂ "	PR4286WSSB	6315
Leather Inlay							
42"	78"	1 ³ / ₁₆ "	—	7 ³ / ₈ "	24 ¹ / ₂ "	PR4278WSSR	\$4450
42"	86"	1 ³ / ₁₆ "	—	7 ³ / ₈ "	24 ¹ / ₂ "	PR4286WSSR	4941
Chassis—Legal-Width Pedestals on Left and Right							
33"	69"	29 ¹³ / ₁₆ "	31 ⁷ / ₈ "	—	—	PR3375DC	\$5911

Standard Includes

Worksurface

- Wood, burl, or leather inlay worksurface

Chassis

- Center drawer
- Two pencil/box/file pedestals (legal width): file drawer front styled as two box drawers
- Pull-out writing shelf
- Breakfront modesty panel
- Centra lock mechanism
- Filing hardware

How to Specify

Worksurface

- ① Model
- ② Left grommet (omit for burl):
G7AB = With grommet (+\$66)
X = Without grommet
- ③ Right grommet (omit for burl):
G7AB = With grommet (+\$66)
X = Without grommet
- ④ Leather designator (include for leather inlay worksurface only)
- ⑤ Finish price group:
STD = Group 1
- ⑥ Finish designator

Chassis

- ① Model
- ② Molding option:
M = With molding (+\$359)
X = Without molding
- ③ Pull option:
26AB = Antique Brass
26AB [leather designator] = leather wrapped (+\$23 per pull)
- ④ Lock option:
KRB = Key random
KSB = Key specific (-\$27); specify lock core separately
- ⑤ Finish price group:
STD = Group 1
- ⑥ Finish designator

IMPORTANT: Worksurface and chassis are specified separately for 42"W desks.

Illustration above shows desk with molding option.

Double-Pedestal Desks

30" and 36"D

Pricing

GSA SIN 711-8



<i>D</i>	<i>W</i>	<i>H</i>	<i>Kneespace</i>	<i>Approach Overhang</i>	<i>Arm Chair Clearance</i>	<i>Model</i>	<i>Price</i>
Legal-Width Pedestals on Left and Right, Dictation Slide on Approach Side							
With Wood Worksurface							
30"	66"	30¼"	31⅞"	1⅜"	24"	PR3066DDFBW	\$6421
36"	72"	30¼"	31⅞"	1⅜"	24"	PR3672DDFBSW	\$7725
With Burl Worksurface							
36"	72"	30¼"	31⅞"	1⅜"	24"	PR3672DDFBSB	\$10393
With Leather Inlay Worksurface							
30"	66"	30¼"	31⅞"	1⅜"	24"	PR3066DDFBR	\$8191
36"	72"	30¼"	31⅞"	1⅜"	24"	PR3672DDFBSR	\$9922
Letter-Width Pedestal on Left and Right							
With Wood Worksurface							
36"	72"	30¼"	31⅞"	7⅜"	24"	PR3672DDFBW	\$6585
With Burl Worksurface							
36"	72"	30¼"	31⅞"	7⅜"	24"	PR3672DDFBB	\$9493
With Leather Inlay Worksurface							
36"	72"	30¼"	31⅞"	7⅜"	24"	PR3672DDFBR	\$8781

Illustrations above show desk with molding option.

Statement of Line	➤ See page 13.2
Planning	13.4
Pricing	13.8
Surface Materials	13.28

Standard Includes

- Wood, burl, or leather inlay worksurface
- Center drawer
- Two pencil/box/file pedestals: file drawer front styled as two box drawers
- Breakfront modesty panel
- Pull-out writing shelf
- Centra lock mechanism
- Filing hardware

How to Specify

- 1 Model
- 2 Molding option:
M = With molding (+\$359)
X = Without molding
- 3 Pull option:
26AB = Antique Brass
26AB [leather designator] = leather wrapped (+\$23 per pull)
- 4 Lock option:
KRB = Key random
KSB = Key specific (-\$27); specify lock core separately
- 5 Left grommet option (omit for burl worksurface):
G7AB = With grommet (+\$66)
X = Without grommet
- 6 Right grommet option (omit for burl worksurface):
G7AB = With grommet (+\$66)
X = Without grommet
- 7 Leather designator (include for leather inlay worksurface only)
- 8 Finish price group:
STD = Group 1
- 9 Finish designator

Table Desks

Pricing

GSA SIN 711-8



<i>D</i>	<i>W</i>	<i>H</i>	<i>Arm Chair Clearance</i>	<i>Model</i>	<i>Price</i>
Cabriole Legs					
With Wood Worksurface					
36"	72"	30½"	24"	PR3672DT2W	\$5568
With Laminate Worksurface					
36"	72"	30½"	24"	PR3672DT2LW	\$5568
With Leather Inlay Worksurface					
36"	72"	30½"	24"	PR3672DT2R	\$7760

Statement of Line	➤ See page 13.2
Planning	13.4
Pricing	13.8
Surface Materials	13.28

Standard Includes

- Wood, laminate, or leather inlay worksurface
- Center drawer (non-locking)
- Ships ready-to-assemble

How to Specify

- ① Model
- ② Pull option:
26AB = Antique Brass
26AB [leather designator] = leather wrapped (+\$23 per pull)
- ③ Leather designator (include for leather inlay worksurface only):
- ④ Finish price group:
STD = Group 1
- ⑤ Finish designator

Extended Single-Pedestal Desks

Pricing

GSA SIN 711-8

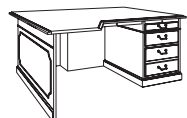

Note: Illustrations show desks with molding option.

D	W	H	Depth on Pedestal End	Model	Price
Pedestal on Right					
With Wood Worksurface					
42"	78"	30 1/4"	30"	PR4278DERFW	\$7136
With Laminate Worksurface					
42"	78"	30 1/4"	30"	PR4278DERFLW	\$7136
With Leather Inlay Worksurface					
42"	78"	30 1/4"	30"	PR4278DERFR	\$9411
Pedestal on Left					
With Wood Worksurface					
42"	78"	30 1/4"	30"	PR4278DELFW	\$7136
With Laminate Worksurface					
42"	78"	30 1/4"	30"	PR4278DELFLW	\$7136
With Leather Inlay Worksurface					
42"	78"	30 1/4"	30"	PR4278DELFR	\$9411

Critical Dimensions:

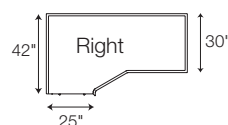

IMPORTANT: For use with executive returns or bridges.

Illustrations above show desk with molding option.

Statement of Line	➤ See page 13.2
Planning	13.4
Pricing	13.8
Surface Materials	13.28

Standard Includes

- Wood, laminate, or leather inlay worksurface
- Pencil/box/file pedestal (letter width): file drawer front styled as two box drawers
- Breakfront modesty panel
- Pull-out writing shelf
- Centra™ lock mechanism
- Filing hardware

How to Specify

- 1 Model
- 2 Molding option:
M = With molding (+\$359)
X = Without molding
- 3 Pull option:
26AB = Antique Brass
26AB [leather designator] = leather wrapped (+\$23 per pull)
- 4 Lock option:
KRB = Key random
KSB = Key specific (-\$27); specify lock core separately
- 5 Left grommet option:
G7AB = With grommet (+\$66)
X = Without grommet
- 6 Right grommet option:
G7AB = With grommet (+\$66)
X = Without grommet
- 7 Leather designator (include for leather inlay worksurface only)
- 8 Finish price group:
STD = Group 1
- 9 Finish designator

Single-Pedestal Desks

For Use with Executive Returns or Bridges

Pricing

GSA SIN 711-8

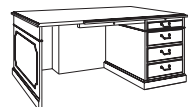

<i>D</i>	<i>W</i>	<i>H</i>	<i>Kneespace</i>	<i>Approach Overhang</i>	<i>Arm Chair Clearance</i>	<i>Model</i>	<i>Price</i>
Pedestal on Right							
With Wood Worksurface							
36"	72"	30 1/4"	30"	7 3/8"	28"	PR3672DRFW	\$5469
36"	78"	30 1/4"	35 7/8"	7 5/8"	28"	PR3678DRFW	6728
With Laminate Worksurface							
36"	72"	30 1/4"	30"	7 3/8"	28"	PR3672DRFLW	\$5469
36"	78"	30 1/4"	35 7/8"	7 5/8"	28"	PR3678DRFLW	6728
With Leather Inlay Worksurface							
36"	72"	30 1/4"	30"	7 3/8"	28"	PR3672DRFR	\$7661
36"	78"	30 1/4"	35 7/8"	7 5/8"	28"	PR3678DRFR	8920
Pedestal on Left							
With Wood Worksurface							
36"	72"	30 1/4"	30"	7 3/8"	28"	PR3672DLFW	\$5469
36"	78"	30 1/4"	35 7/8"	7 5/8"	28"	PR3678DLFW	6728
With Laminate Worksurface							
36"	72"	30 1/4"	30"	7 3/8"	28"	PR3672DLFLW	\$5469
36"	78"	30 1/4"	35 7/8"	7 5/8"	28"	PR3678DLFLW	6728
Leather Inlay Worksurface							
36"	72"	30 1/4"	30"	7 3/8"	28"	PR3672DLFR	\$7661
36"	78"	30 1/4"	35 7/8"	7 5/8"	28"	PR3678DLFR	8920

Related Products:

Center Drawer with Wood Pencil Tray

18 3/4"	31 5/8"	4"				PR1932CD	\$490
---------	---------	----	--	--	--	-----------------	-------

IMPORTANT: For use with executive returns or bridges.

Illustrations above show desk with molding option.

Statement of Line	➤ See page 13.2
Planning	13.4
Pricing	13.8
Surface Materials	13.28

Standard Includes

- Wood, laminate, or leather inlay worksurface
- Pencil/box/file pedestal (letter width): file drawer front styled as two box drawers
- Breakfront modesty panel
- Pull-out writing shelf
- Centra™ lock mechanism
- Filing hardware

How to Specify

- ① Model
- ② Molding option:
M = With molding (+\$359)
X = Without molding
- ③ Pull option:
26AB = Antique Brass
26AB [leather designator] = leather wrapped (+\$23 per pull)
- ④ Lock option:
KRB = Key random
KSB = Key specific (-\$27); specify lock core separately
- ⑤ Left grommet option:
G7AB = With grommet (+\$66)
X = Without grommet
- ⑥ Right grommet option:
G7AB = With grommet (+\$66)
X = Without grommet
- ⑦ Leather designator (include for leather inlay worksurface only)
- ⑧ Finish price group:
STD = Group 1
- ⑨ Finish designator

Center Drawer

- ① Model
- ② Pull option (see above)
- ③ Finish designator

Executive Returns

Pricing

GSA SIN 711-8

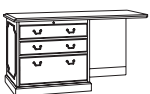

<i>D</i>	<i>W</i>	<i>H</i>	<i>Kneespace</i>	<i>Model</i>	<i>Price</i>
Lateral File on Right					
25"	62 ⁷ / ₈ "	30 ¹ / ₄ "	25 ¹ / ₂ "	PR2567RREF	\$5009
Lateral File on Left					
25"	62 ⁷ / ₈ "	30 ¹ / ₄ "	25 ¹ / ₂ "	PR2567RLEF	\$5009
Pencil/Box/File Pedestal on Right					
25"	50 ⁷ / ₈ "	30 ¹ / ₄ "	30"	PR2551RREF	\$3864
Pencil/Box/File Pedestal on Left					
25"	50 ⁷ / ₈ "	30 ¹ / ₄ "	30"	PR2551RLEF	\$3864

Statement of Line	➤ See page 13.2
Planning	13.4
Pricing	13.8
Surface Materials	13.28

Standard Includes

- Wood or laminate worksurface
- Two 36"W lateral file drawers (top drawer front styled as two box drawers) or pencil/box/file pedestal (legal width; file drawer front styled as two box drawers)
- Full modesty panel
- Lock
- Filing hardware

How to Specify

- 1 Model
- 2 Worksurface material:
W = Wood
LW = Laminate
- 3 Molding option:
M = With molding (+\$251)
X = Without molding
- 4 Pull option:
26AB = Antique Brass
26AB [leather designator] = leather wrapped (+\$23 per pull)
- 5 Lock option:
KRB = Key random
KSB = Key specific (-\$27); specify lock core separately
- 6 Center grommet option:
G7AB = With grommet (+\$66)
X = Without grommet
- 7 Finish price group:
STD = Group 1
- 8 Finish designator

Illustrations above show return with molding option.

Bridges

Pricing

GSA SIN 711-8



<i>D</i>	<i>W</i>	<i>H</i>	<i>Kneespace</i>	<i>Arm Chair Clearance</i>	<i>Model</i>	<i>Price</i>
Hinged Modesty Panel						
25"	50 ⁷ / ₈ "	30 ¹ / ₄ "	48"	29"	PR2551BEFH	\$2848
Partial Modesty Panel						
25"	50 ⁷ / ₈ "	11 ³ / ₁₆ "	48"	29"	PR2551BEQ	\$2848

Statement of Line	➤ See page 13.2
Planning	13.4
Pricing	13.8
Surface Materials	13.28

Standard Includes

- Wood or laminate worksurface
- Grommet on hinged modesty panel
- Ships ready-to-assemble.

How to Specify

- ① Model
- ② Worksurface material:
W = Wood
LW = Laminate
- ③ Molding option (omit for partial modesty panel bridge):
M = With molding (+\$164)
X = Without molding
- ④ Center grommet option:
G7AB = With grommet (+\$66)
X = Without grommet
- ⑤ Finish price group:
STD = Group 1
- ⑥ Finish designator

IMPORTANT: Hinged modesty panel swings forward to allow access to wall power.

Credenzas

Single-Pedestal

Pricing

GSA SIN 711-8

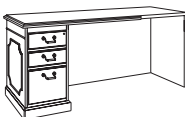
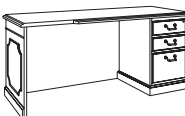
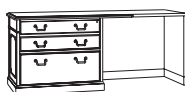

<i>D</i>	<i>W</i>	<i>H</i>	<i>Arm Chair Clearance</i>	<i>Model</i>	<i>Price</i>
Lateral File on Right					
23½"	78"	30¼"	29"	PR2478CRF6	\$6819
Lateral File on Left					
23½"	78"	30¼"	29"	PR2478CLF6	\$6819
File/File Pedestal on Right					
23½"	78"	30¼"	28"	PR2478CRF2	\$5218
File/File Pedestal on Left					
23½"	78"	30¼"	28"	PR2478CLF2	\$5218

IMPORTANT: For use with bridge only.

Illustrations above show credenzas with molding option.

Statement of Line	➤ See page 13.2
Planning	13.4
Pricing	13.8
Surface Materials	13.28

Standard Includes

- Wood or laminate worksurface
- Two 36"W lateral file drawers (top drawer front styled as two box drawers) or pencil/box/file pedestal (legal width; file drawer front styled as two box drawers)
- Lock
- Filing hardware

How to Specify

- 1 Model
- 2 Worksurface material:
W = Wood
LW = Laminate
- 3 Molding option:
M = With molding (+\$185)
X = Without molding
- 4 Pull option:
26AB = Antique Brass
26AB [leather designator] = leather wrapped (+\$23 per pull)
- 5 Lock option:
KRB = Key random
KSB = Key specific (-\$27); specify lock core separately
- 6 Left grommet option:
G7AB = With grommet (+\$66)
X = Without grommet
- 7 Center grommet option (omit for lateral file credenza):
G7AB = With grommet (+\$66)
X = Without grommet
- 8 Right grommet option:
G7AB = With grommet (+\$66)
X = Without grommet
- 9 Finish price group:
STD = Group 1
- 10 Finish designator

Credenzas

Pricing

Storage and Kneespace

† GSA SIN 711-9

†† GSA SIN 711-8

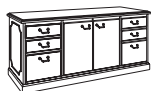

<i>D</i>	<i>W</i>	<i>H</i>	<i>Kneespace</i>	<i>Armchair Clearance</i>	<i>Model</i>	<i>Price</i>
----------	----------	----------	------------------	-------------------------------	--------------	--------------

Storage Credenza †

23½"	74⅓⁄₁₆"	30¼"			PR2475CSF	\$6141
23½"	78"	30¼"			PR2478CSF	\$6207

Kneespace Credenza ††

23½"	74⅓⁄₁₆"	30¼"	34¼"	28"	PR2475CKF	\$5425
------	---------	------	------	-----	------------------	--------

Related Products:

Center/Keyboard Drawer ††

18½"	32⅓⁄₁₆"	4⅓⁄₁₆"			PR1833CD	\$726
------	---------	--------	--	--	-----------------	-------

IMPORTANT: Center/keyboard drawer front folds down for keyboard access.

Kneespace credenza accepts keyboard drawer or trays only.

Illustrations above show credenza with molding option.

Statement of Line	➤ See page 13.2
Planning	13.4
Pricing	13.8
Surface Materials	13.28

Standard Includes

- Cord management opening in top center of modesty panel
- Two pencil/box/file pedestals (legal)
- Centra™ lock mechanism
- Center storage with one adjustable shelf behind two hinged doors on storage credenza

How to Specify

Credenza

- 1 Model
- 2 Worksurface material:
W = Wood
- 3 Molding option
M = With molding (+\$185)
X = Without molding
- 4 Pull option:
26AB = Antique Brass
26AB [leather designator] = leather wrapped (+\$23 per pull)
- 5 Lock option:
KRB = Key random
KSB = Key specific (-\$27); specify lock core separately
- 6 Left grommet option:
G7AB = With grommet (+\$66)
X = Without grommet
- 7 Center grommet option:
G7AB = With grommet (+\$66)
X = Without grommet
- 8 Right grommet option:
G7AB = With grommet (+\$66)
X = Without grommet
- 9 Finish price group:
STD = Group 1
- 10 Finish designator

Center Drawer

- 1 Model
- 2 Pull option (see above)
- 3 Finish designator

Credenzas

Pricing

Buffet

GSA SIN 711-9

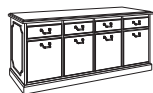

<i>D</i>	<i>W</i>	<i>H</i>	<i>Model</i>	<i>Price</i>
Buffet Credenza				
23½"	74 ¹³ / ₁₆ "	35¼"	PR2474CB	\$7368

Statement of Line	➤ See page 13.2
Planning	13.4
Pricing	13.8
Surface Materials	13.28

Standard Includes

- Wood or laminate worksurface
- Four box drawers in upper section (non-locking)
- Four hinged door sections, each with an adjustable shelf (non-locking)

How to Specify

- ① Model
- ② Worksurface material:
W = Wood
LW = Laminate
- ③ Molding option:
M = With molding (+\$185)
X = Without molding
- ④ Pull option:
26AB = Antique Brass
26AB [leather designator] = leather wrapped (+\$23 per pull)
- ⑤ Left grommet option:
G7AB = With grommet (+\$66)
X = Without grommet
- ⑥ Right grommet option:
G7AB = With grommet (+\$66)
X = Without grommet
- ⑦ Finish price group:
STD = Group 1
- ⑧ Finish designator

Illustrations above show credenza with molding option.

Task/Reception Station

Pricing

GSA SIN 711-8

Statement of Line	➤ See page 13.2
Planning	13.4
Pricing	13.8
Surface Materials	13.28

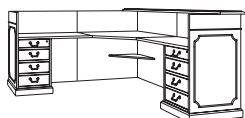

<i>D</i>	<i>W</i>	<i>H</i>	<i>Arm Chair Clearance</i>	<i>Model</i>	<i>Price</i>
Right Return					
24 ¹ / ₄ "	41 ⁷ / ₈ "	42 ⁷ / ₁₆ "	29"	PR2442RTR	\$5331
Left Return					
24 ¹ / ₄ "	41 ⁷ / ₈ "	42 ⁷ / ₁₆ "	29"	PR2442RTL	\$5331
Corner Unit					
41 ⁷ / ₈ "	41 ⁷ / ₈ "	42 ⁷ / ₁₆ "	29"	PR4242CFT	\$5304
Transaction Shelf					
12"	86 ³ / ₄ "	13 ¹ / ₁₆ "	—	PR1287WSTS	\$1726

Standard Includes

Return

- Pencil/box/file pedestal (legal width): file drawer front styled as two box drawers
- Pull-out writing shelf
- Lock

Corner Unit

- Utility shelf
- Ships assembled (corner worksurface is removable)

How to Specify

- ① Model
- ② Worksurface material:
W = Wood **LW** = Laminate
- ③ Molding option (omit for transaction shelf):
M = With molding (+\$285)
X = Without molding
- ④ Lock option (omit for corner unit and transaction shelf):
KRB = Key random
KSB = Key specific (-\$27); specify lock core separately
- ⑤ Pull option (omit for corner unit and transaction shelf):
26AB = Antique Brass
26AB [leather designator] = leather wrapped (+\$23 per pull)
- ⑥ Center grommet option (omit for transaction shelf):
G7AB = With grommet (+\$66)
X = Without grommet
- ⑦ Finish price group:
STD = Group 1
- ⑧ Finish designator

IMPORTANT: Components must be specified separately.

Illustrations above show station with molding option.

Highback Organizers

For Use on 75"W Credenzas

Pricing

GSA SIN 711-8

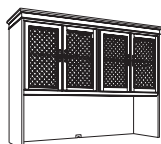

<i>D</i>	<i>W</i>	<i>H</i>	<i>Worksurface Clearance</i>	<i>Model</i>	<i>Price</i>
Grille Doors (shown)					
15½"	74"	50½"	20½"	TD7451HBHM	\$6656
Glass Doors					
15½"	74"	50½"	20½"	TD7451HBHG	\$6656
Wood Doors					
15½"	74"	50½"	20½"	TD7451HBHW	\$6769

Related Products:

<i>D</i>	<i>W</i>	<i>H</i>	<i>COM Yardage 66"W Non-Dir.</i>	<i>Model</i>	<i>COM</i>	<i>Panel Fabric Gr. A-E</i>	<i>Upholstery Fabric Gr. 1-3</i>	<i>Gr. 4-6</i>
Tackboards for Highback Organizer								
	66"	20"	2.5	TB-2066	\$509	\$584	\$599	\$712

IMPORTANT: For use on 75"W credenzas.

Panel fabric is turned 90° and applied railroad style to 62"W or wider tackboards. Upholstery fabric is turned 90° and applied railroad style to 50"W or wider tackboards.

Statement of Line	➤ See page 13.2
Planning	13.4
Pricing	13.8
Surface Materials	13.28

Standard Includes

- Storage area (13¾"D x 32½"W x 24¾"H) behind four hinged doors (non-locking)
- One adjustable shelf in each compartment (11⅞" clearance between shelves)
- Cord management grommet in back panel
- Unfinished back

How to Specify

Highback Organizers

- ① Model
- ② Finish price group:
STD = Group 1
- ③ Finish designator

Tackboards

- ① Model
- ② Upholstery grade
- ③ Upholstery number

Wall-Mounted Cabinets

Pricing

GSA SIN 711-8

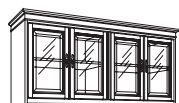

<i>D</i>	<i>W</i>	<i>H</i>	<i>Worksurface Clearance</i>	<i>Model</i>	<i>Price</i>
Grille Doors					
15½"	74"	29¾"	20½⅙"	TD7430SOHM	\$5600
Glass Doors (shown)					
15½"	74"	29¾"	20½⅙"	TD7430SOHG	\$5600
Wood Doors					
15½"	74"	29¾"	20½⅙"	TD7430SOHW	\$5722

Statement of Line	➤ See page 13.2
Planning	13.4
Pricing	13.8
Surface Materials	13.28

Standard Includes

- Storage area behind four hinged doors (non-locking)
- One adjustable shelf in each compartment (11⅞" clearance between shelves)
- Hardware for attachment

How to Specify

- ① Model
- ② Finish price group:
STD = Group 1
- ③ Finish designator

Lateral Files

Pricing

GSA SIN 711-8



<i>D</i>	<i>W</i>	<i>H</i>	<i>Model</i>	<i>Price</i>
Two-Drawer Lateral File				
23½"	38⅞"	30¼"	PR2439LFF2	\$3528
Four-Drawer Lateral File				
23½"	38⅞"	55⅞"	PR2439LFF4	\$5778

Statement of Line	➤ See page 13.2
Planning	13.4
Pricing	13.8
Surface Materials	13.28

Standard Includes

- Centra™ lock mechanism
- Finished back

How to Specify

- ① Model
- ② Worksurface material:
W = Wood
LW = Laminate
- ③ Pull option:
26AB = Antique Brass
26AB [leather designator] = leather wrapped (+\$23 per pull)
- ④ Lock option:
KRB = Key random
KSB = Key specific (-\$27); specify lock core separately
- ⑤ Finish price group:
STD = Group 1
- ⑥ Finish designator

Lectern and Wardrobe

Pricing

GSA SIN 711-9



<i>D</i>	<i>W</i>	<i>H</i>	<i>Model</i>	<i>Price</i>
Lectern				
23 ³ / ₁₆ "	24"	46 ³ / ₄ "	TD2347LC	\$4600
Wardrobe				
23 ¹ / ₄ "	38"	80 ⁵ / ₈ "	TD3680VHHW	\$8835

Statement of Line	➤ See page 13.2
Planning	13.4
Pricing	13.8
Surface Materials	13.28

Standard Includes

Lectern

- Sloped presentation shelf
- One adjustable shelf
- Hinged doors (non-locking)

Wardrobe

- Shelf across top
- Coat rod, left
- Four shelves on right (two adjustable)
- Cornice top and base
- Unfinished back
- Decorative lock

How to Specify

- ① Model
- ② Pull option (omit for wardrobe):
26AB = Antique Brass
26AB [leather designator] = leather wrapped (+\$23 per pull)
- ③ Finish price group:
STD = Group 1
- ④ Finish designator

Mobile Utility Table

Pricing

GSA SIN 711-9



<i>D</i>	<i>W</i>	<i>H</i>	<i>Model</i>	<i>Price</i>
Mobile Utility Table				
25"	38 ⁷ / ₈ "	36 ¹ / ₂ "	TD2539MUT	\$4361

Statement of Line	➤ See page 13.2
Planning	13.4
Pricing	13.8
Surface Materials	13.28

Standard Includes

- One adjustable shelf
- Two hinged doors (non-locking)
- Four dual wheel casters

How to Specify

- ① Model
- ② Worksurface material:
W = Wood
LW = Laminate
- ③ Pull option:
26AB = Antique Brass
26AB [leather designator] = leather wrapped (+\$23 per pull)
- ④ Finish price group:
STD = Group 1
- ⑤ Finish designator

Component Storage

For Use with Credenza Worksurface and Base

Pricing

GSA SIN 711-8



<i>D</i>	<i>W</i>	<i>H</i>	<i>Model</i>	<i>Price</i>
Lateral Files				
Two Lateral File Drawers				
22"	35 ⁷ / ₈ "	25 ³ / ₁₆ "	PR2236LFM2	\$2499
Two Wide Box Drawers and One Lateral File Drawer				
22"	35 ⁷ / ₈ "	25 ³ / ₁₆ "	PR2236PUBBF	\$2499
Four Lateral File Drawers				
22"	35 ⁷ / ₈ "	50 ⁷ / ₈ "	PR2236LFM4	\$4876
Hinged-Door Storage				
22"	35 ⁷ / ₈ "	25 ³ / ₁₆ "	PR2236PUH	\$2030
Box/Box/File Pedestal				
22"	17 ¹⁵ / ₁₆ "	25 ³ / ₁₆ "	PR2218PUBBF	\$2250
File/File Pedestal				
22"	17 ¹⁵ / ₁₆ "	25 ³ / ₁₆ "	PR2218PUFF	\$2250

Statement of Line	➤ See page 13.2
Planning	13.4
Pricing	13.8
Surface Materials	13.28

Standard Includes

Lateral Files & Pedestals

- Lock
- Unfinished back and open top
- Top drawer on two-drawer lateral file styled as two box drawers

Hinged-Door Storage

- One adjustable shelf behind two hinged doors (non-locking)
- Unfinished back and open top

How to Specify

- ① Model
- ② Pull option:
26AB = Antique Brass
26AB [leather designator] = leather wrapped (+\$23 per pull)
- ③ Lock option (omit for hinged-door storage):
KRB = Key random
KSB = Key specific (-\$27); specify lock core separately
- ④ Finish price group:
STD = Group 1
- ⑤ Finish designator

IMPORTANT: All component storage units require a credenza worksurface.

Credenza Worksurfaces and Bases

Pricing

For Use with Component Storage

GSA SIN 711-8



<i>D</i>	<i>W</i>	<i>H</i>	<i>Model</i>	<i>Price</i>
Credenza Worksurfaces				
For Use on Top of One Storage Component				
23½"	38⅞"	1⅜"	PR2439WSS	\$842
For Use on Top of Two Storage Components				
23½"	74⅜"	1⅜"	PR2475WSS	\$1457
For Use on Top of Three Storage Components				
23½"	110⅜"	1⅜"	PR2411WSS	\$2229
Credenza Bases				
For Use Below of One Storage Component				
22⅝"	37⅞"	3⅝"	PR2337CPB	\$446
For Use Below of Two Storage Components				
22⅝"	73"	4⅜"	PR2373CPB	\$739
For Use Below of Three Storage Components				
22⅝"	108⅞"	3⅝"	PR23109CPB	\$1542

Statement of Line	➤ See page 13.2
Planning	13.4
Pricing	13.8
Surface Materials	13.28

Standard Includes

Credenza Worksurface

- Wood or laminate worksurface
- Flat back edge on worksurface and base

How to Specify

Credenza Worksurface

- ① Model
- ② Worksurface material:
W = Wood
LW = Laminate
- ③ Left grommet option (omit for 39"W worksurface):
G7AB = With grommet (+\$66)
X = Without grommet
- ④ Center grommet option (omit for 39"W worksurface):
G7AB = With grommet (+\$66)
X = Without grommet
- ⑤ Right grommet option (omit for 39"W worksurface):
G7AB = With grommet (+\$66)
X = Without grommet
- ⑥ Finish price group:
STD = Group 1
- ⑦ Finish designator

Credenza Base

- ① Model
- ② Finish price group:
STD = Group 1
- ③ Finish designator

IMPORTANT: Bases are required for all component storage.

Grommets are not available on 39"W credenza worksurface.

Bookcases

Pricing

GSA SIN 711-8

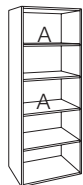

"A" denotes adjustable shelves.

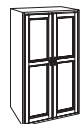
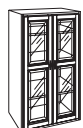
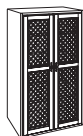
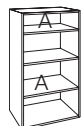

Bookcases have unfinished tops and require a bookcase top or cornice frame, specified separately.
➤ See page 13.26.

Bookcase base, specified separately, is required to make 48"H and 70"H bookcases freestanding. 70"H bookcases are for floor application only.

<i>D</i>	<i>W</i>	<i>H</i>	<i>Model</i>	<i>Price</i>
70"H Bookcase (four shelves)				
14"	35 ⁷ / ₈ "	69 ¹¹ / ₁₆ "	PR3670BCO	\$3584
48"H Bookcases (three shelves)				
Open				
14"	35 ⁷ / ₈ "	47 ³ / ₈ "	PR3648BCO	\$1668
Grille Doors				
14"	35 ⁷ / ₈ "	47 ³ / ₈ "	PR3648BCHM	\$2818
Beveled Glass Doors				
14"	35 ⁷ / ₈ "	47 ³ / ₈ "	PR3648BCHG	\$3455
Wood Doors (Non-Figured Walnut)				
14"	35 ⁷ / ₈ "	47 ³ / ₈ "	PR3648BCHW	\$3484

Statement of Line	➤ See page 13.2
Planning	13.4
Pricing	13.8
Surface Materials	13.28

Standard Includes

- Unfinished top and back
- Lock on models with doors
- Adjustable shelves (adjust up or down 2")

How to Specify

- ① Model
- ② Finish price group:
STD = Group 1
- ③ Finish designator

Cornice Frames, Tops, Bases, and Back Panels

Pricing

For Use with Bookcases

GSA SIN 711-8

Statement of Line	➤ See page 13.2
Planning	13.4
Pricing	13.8
Surface Materials	13.28

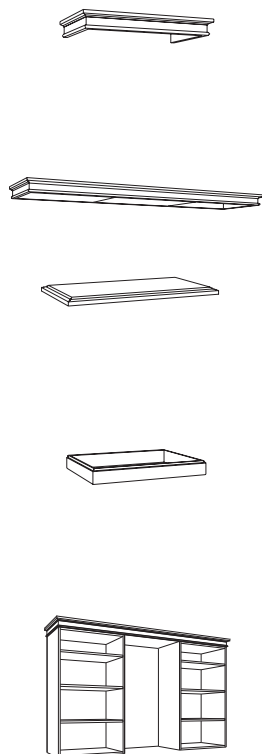

<i>D</i>	<i>W</i>	<i>H</i>	<i>Model</i>	<i>Price</i>
Cornice Frames				
For One Unit				
15 ¹ / ₁₆ "	38 ¹ / ₈ "	3 ⁵ / ₁₆ "	PR1538CPCF	\$782
For Two Units				
15 ¹ / ₁₆ "	74"	3 ⁵ / ₁₆ "	PR1574CPCF	\$1106
For Two or Three Units (with Wood Insert Panel)				
15 ¹ / ₁₆ "	110"	3 ⁵ / ₁₆ "	PR15110CPCFI	\$2207
Bookcase Tops				
For One Unit				
15 ¹ / ₂ "	38 ⁷ / ₈ "	1 ³ / ₁₆ "	PR1539CPT	\$693
For Two Units				
15 ¹ / ₂ "	74 ¹³ / ₁₆ "	1 ³ / ₁₆ "	PR1575CPT	\$1042
Bookcase Bases				
For One Unit				
14 ⁹ / ₁₆ "	37"	3 ⁵ / ₁₆ "	PR1537CPB	\$348
For Two Units				
14 ⁹ / ₁₆ "	73"	3 ⁵ / ₁₆ "	PR1573CPB	\$612
Bookcase Back Panel				
3/4"	35 ⁷ / ₈ "	47 ³ / ₈ "	PR3648CPBP	\$1912

Bookcases have unfinished tops and require a bookcase top or cornice frame. Cornice frames are for use on top of bookcases that are set on a worksurface. Bookcase tops are for use on bookcases for freestanding applications only.

Bookcase back panel is for use between two bookcases and has a cord opening centered in bottom edge of back panel.

Standard Includes

- Frame, top, base, or back panel: wood

How to Specify

- ① Model
- ② Worksurface material (include for top only):
W = Wood
- ③ Finish price group:
STD = Group 1
- ④ Finish designator

Statement of Line	➤See page 13.2
Planning	13.4
Pricing	13.8
Surface Materials	13.28

- See the *Kimball Surface Materials Reference Guide* at www.kimball.com for a complete overview of the Kimball materials program, including:
- Characteristics of wood
 - Special wood finishes
 - Customer-specified laminate (CSL)
 - Customer-specified paint (CSP)
 - Fabric application and colorways
 - Customer's own material (COM) overview
 - Alliance program
 - TB133 process

IMPORTANT: Wood finishes applied to solid hardwood are complementary to the same wood finish applied to wood veneer, but not an exact match.
➤Contact Customer Service for more information.

IMPORTANT: Woodgrain laminate is a commercially compatible match to the wood finish of the same name and designator with consideration for the most common application—laminate surfaces on a wood chassis. When laminate and wood are mixed in other applications, the flip that occurs naturally in veneer may influence the overall match from piece to piece.

Wood

Applies to:

- President casegoods

➤See the *Kimball Surface Materials Reference Guide* at www.kimball.com for the most up-to-date list of available fabric patterns.

Group 1

ES	Espresso Walnut
MW	Midtown Walnut
TW	Tribeca Walnut
UW	Urban Walnut

HPL

Applies to:

- President casegoods tops

➤See the *Kimball Surface Materials Reference Guide* at www.kimball.com for the most up-to-date list of available fabric patterns.

Woodgrain

MW	Midtown Walnut
TW	Tribeca Walnut
UW	Urban Walnut

Statement of Line	➤See page 13.2
Planning	13.4
Pricing	13.8
Surface Materials	13.28

➤See the *Kimball Surface Materials Reference Guide* at www.kimball.com for a complete overview of the Kimball materials program, including:

- Characteristics of wood
- Special wood finishes
- Customer-specified laminate (CSL)
- Customer-specified paint (CSP)
- Fabric application and colorways
- Customer's own material (COM) overview
- Alliance program
- TB133 process

Applies to:

- Tackboards

Kimball Panel Fabric

Price Grades A–E

EXCEPTION: Tackboards are not available in Crossroads or Tenor patterns.

➤See the *Surface Materials Reference Guide* at www.kimball.com for the most up-to-date list of available panel fabric patterns.

Kimball Seating Fabric (Upholstery)

Price Grades 1–6

EXCEPTIONS: Tackboards are not available in vinyl, faux leather, or polyurethane patterns.

➤See the *Surface Materials Reference Guide* at www.kimball.com for the most up-to-date list of available seating fabric patterns.

Statement of Line	➤ See page 13.2
Planning	13.4
Pricing	13.8
Surface Materials	13.28

➤ See the *Kimball Surface Materials Reference Guide* at www.kimball.com for a complete overview of the Kimball materials program, including:

- Characteristics of wood
- Special wood finishes
- Customer-specified laminate (CSL)
- Customer-specified paint (CSP)
- Fabric application and colorways
- Customer's own material (COM) overview
- Alliance program
- TB133 process

Applies to:

- President leather inlay top
- Leather-wrapped pulls

Kimball Seating Leather (Upholstery)

Price Grades L7 and L8

EXCEPTION: Not available in Florence leather.

➤ See the *Surface Materials Reference Guide* at www.kimball.com for the most up-to-date list of available seating leather.