

Opus™ Field Installed Lock for a Wardrobe Sliding Door

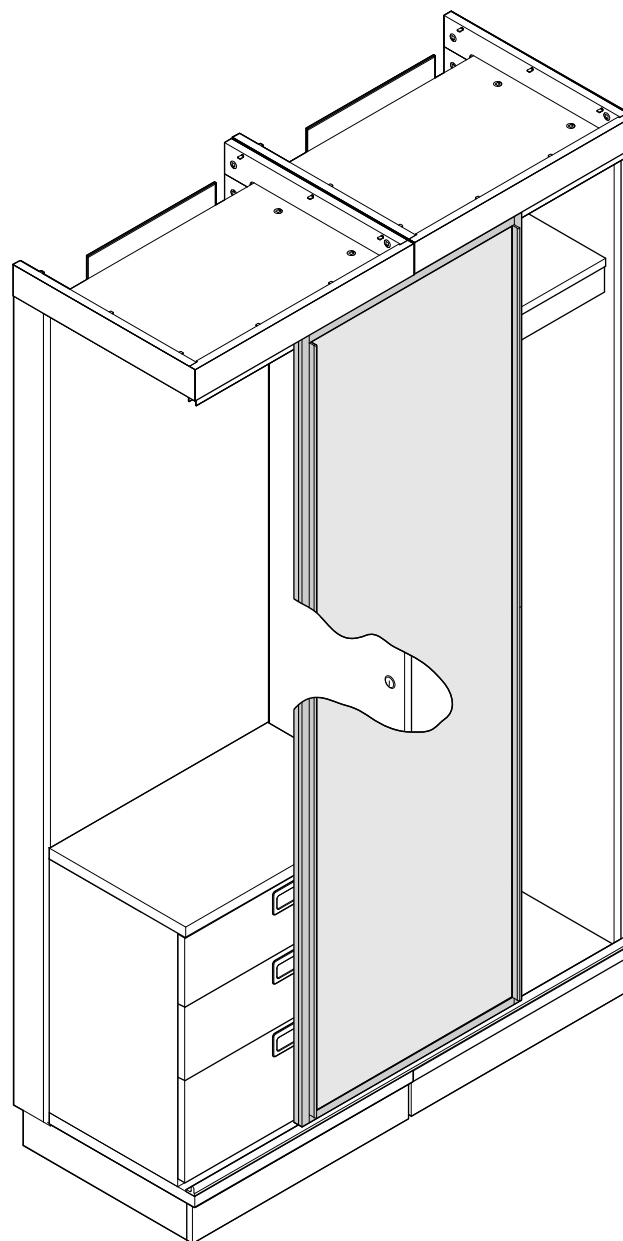

If you have a problem, question, or request, call your local dealer, or Steelcase Line 1 at **888.STEELCASE** (888.783.3522) for immediate action by people who want to help you. (Outside the U.S.A., Canada, Mexico, Puerto Rico, and the U.S. Virgin Islands, call: 1.616.247.2500) Or visit our website: www.steelcase.com

© 2014 Steelcase Inc.
Grand Rapids, MI 49501
U.S.A.

Printed in U.S.A.

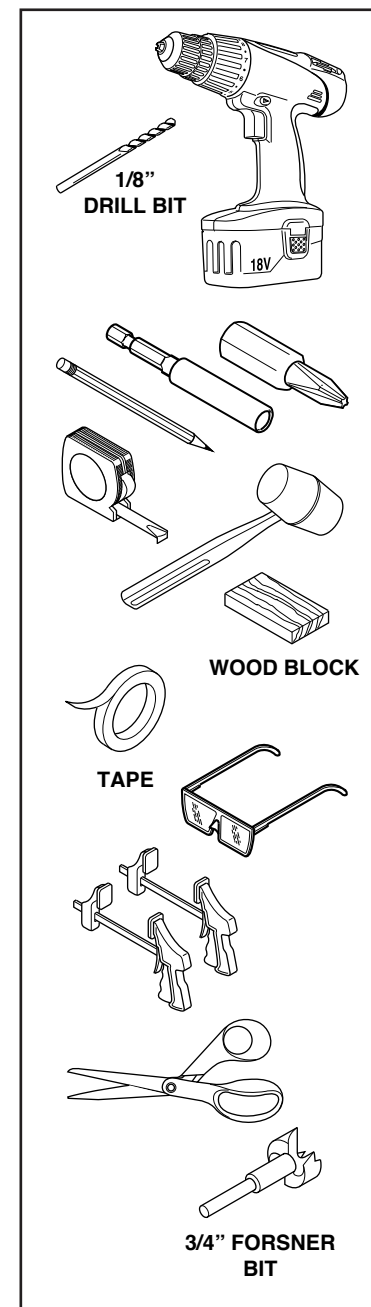

NOTE: Right hand scenario shown.

- 1.** Slide the door to the center of the base units.
- 2.** Remove the door end stop at one end of the upper track, where there is room to slide the door out.

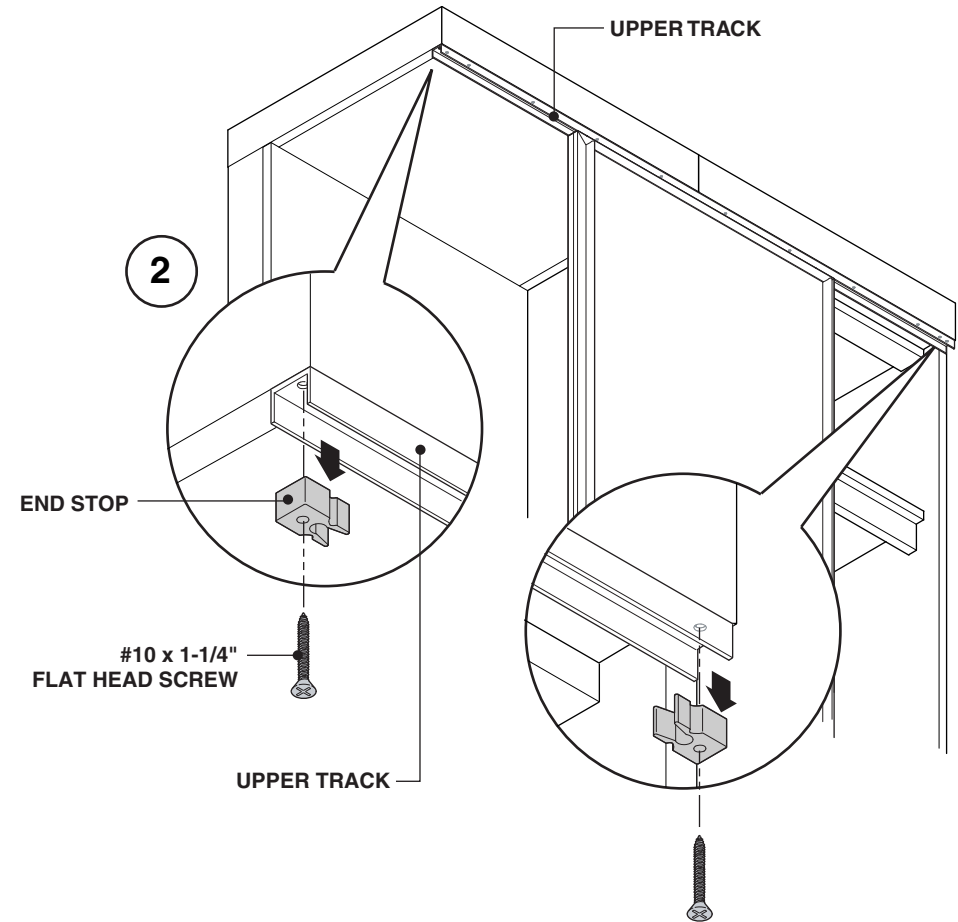
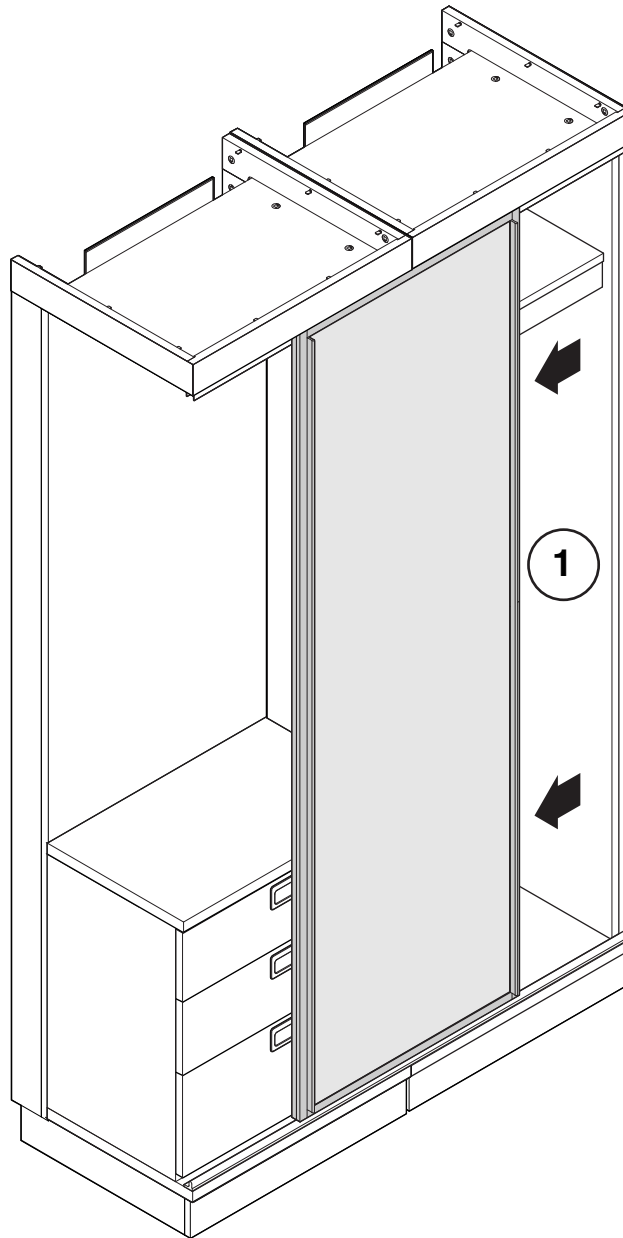

- 3.** Remove door (3a).
Measure 35-1/4" up from
the top of the bottom (3b)
and mark with a pencil (3c).
Repeat procedure on other
side of cabinet wall.

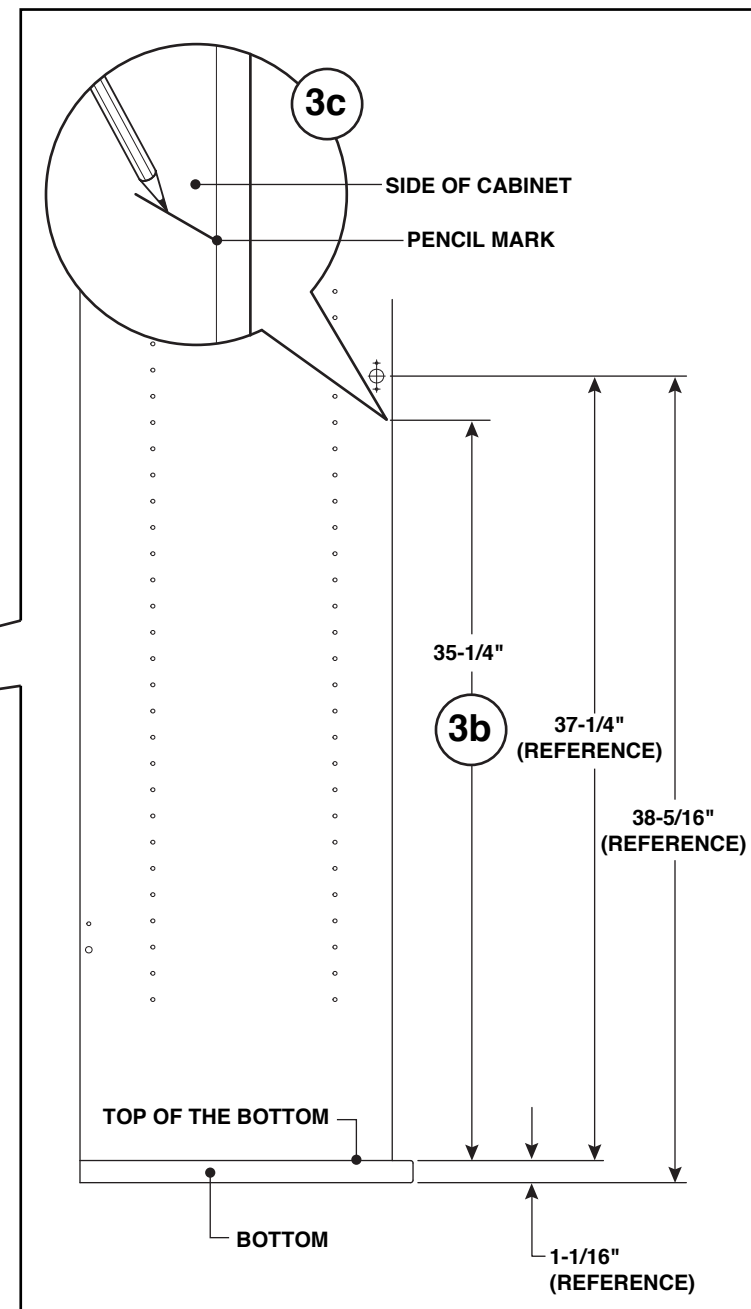
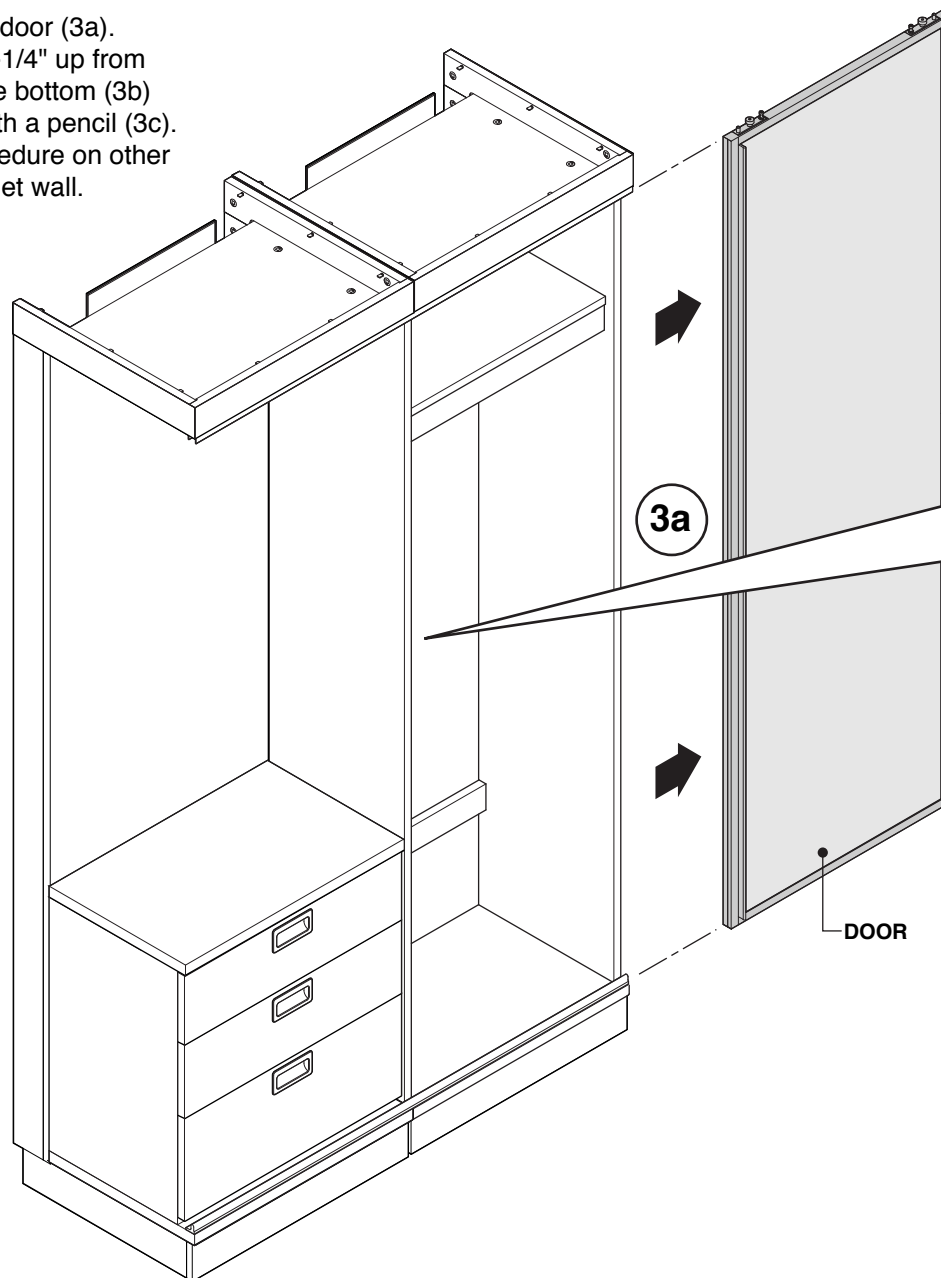

Templates

LEFT HAND TEMPLATE

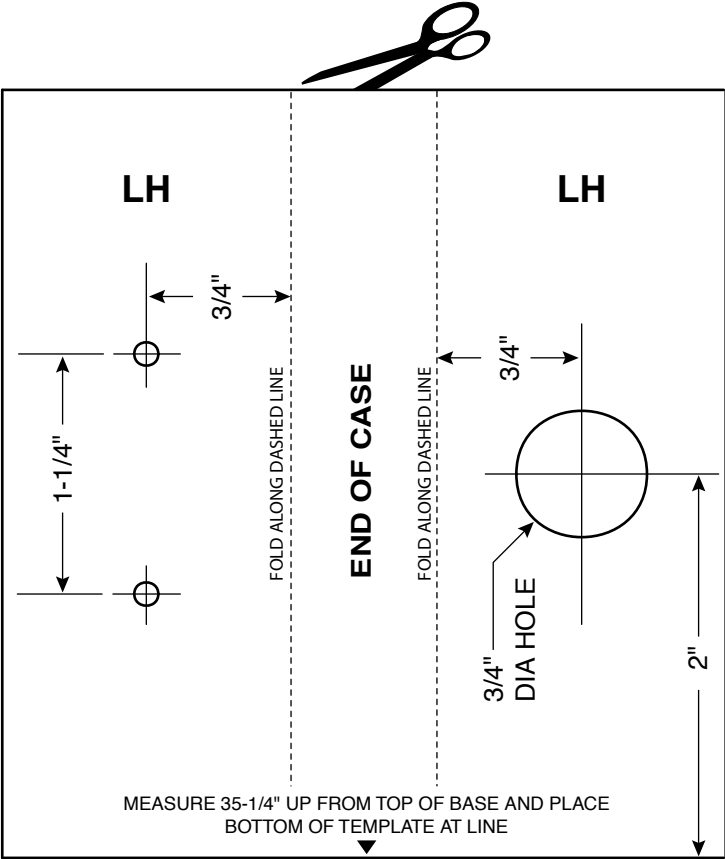

RIGHT HAND TEMPLATE

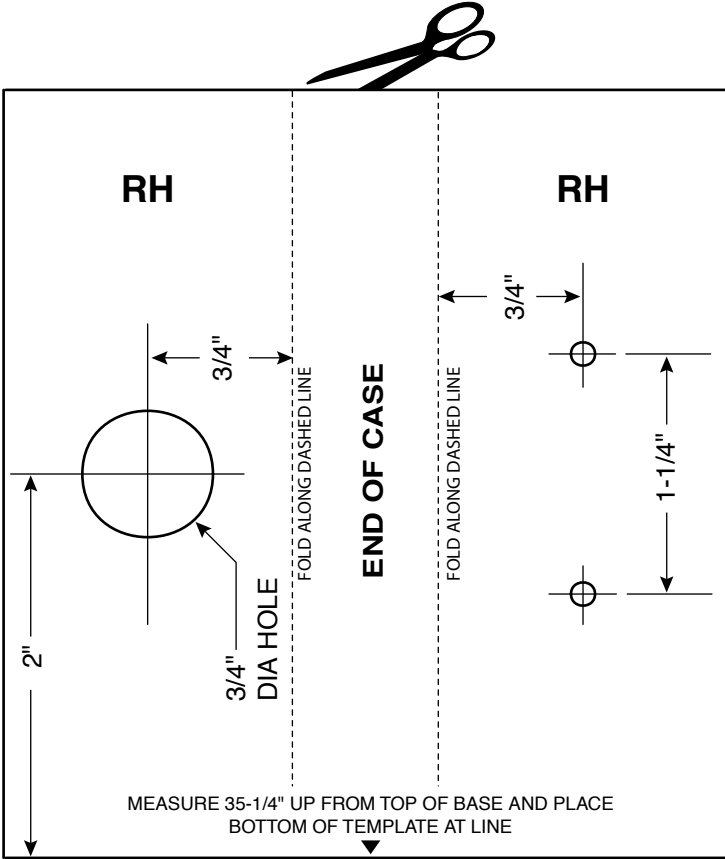

NOTE: Before using the template, double check the dimensions for accuracy.

4. Fold template along dashed lines as shown.

5. Place template to the end of case as shown making sure you line up bottom of template with pencil marks created in step 3c.

6. Apply tape to entire template.

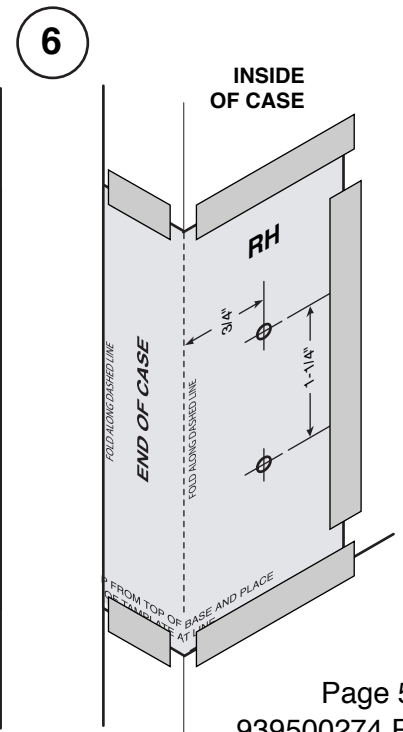
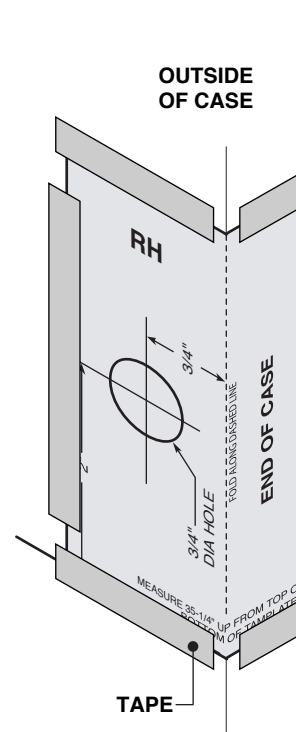
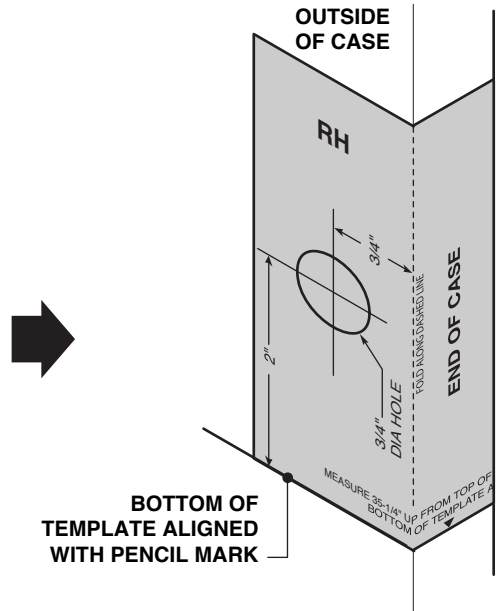
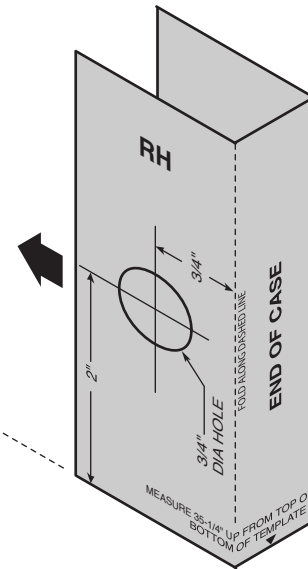
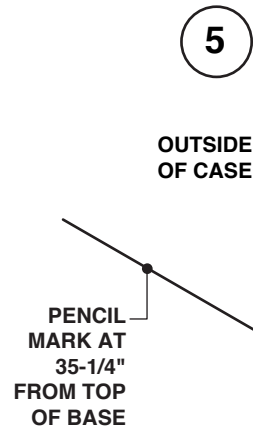
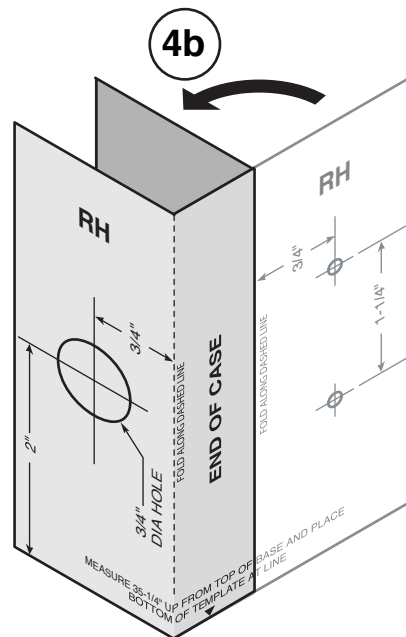
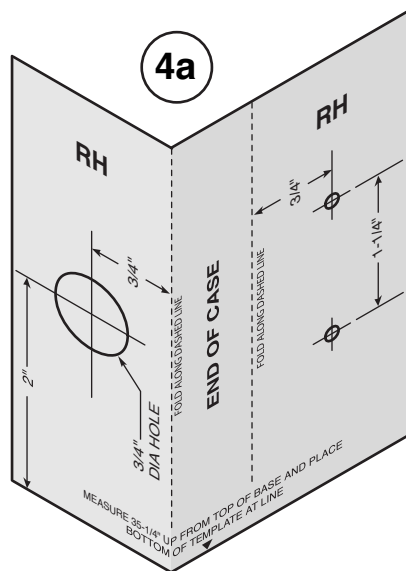

7. Using a 3/4" forsnr bit, drill hole through side of case.

NOTE: Clamp a wood block on the other side of the case, as you drill, to prevent chipping.

8. On inside of case, drill two (2) 1/8" pilot holes into case 1/4" deep. Remove template.

NOTE: Do not drill holes all the way through case!

9. Insert lock assembly into hole on inside of case (9a) and secure using two (2) #6 x 5/8" screws (9b).

10. Insert bezel from outside of case.

11. Reattach door and end stop.

