

FrameOne™ or Universal Laminate - Mid-High Storage

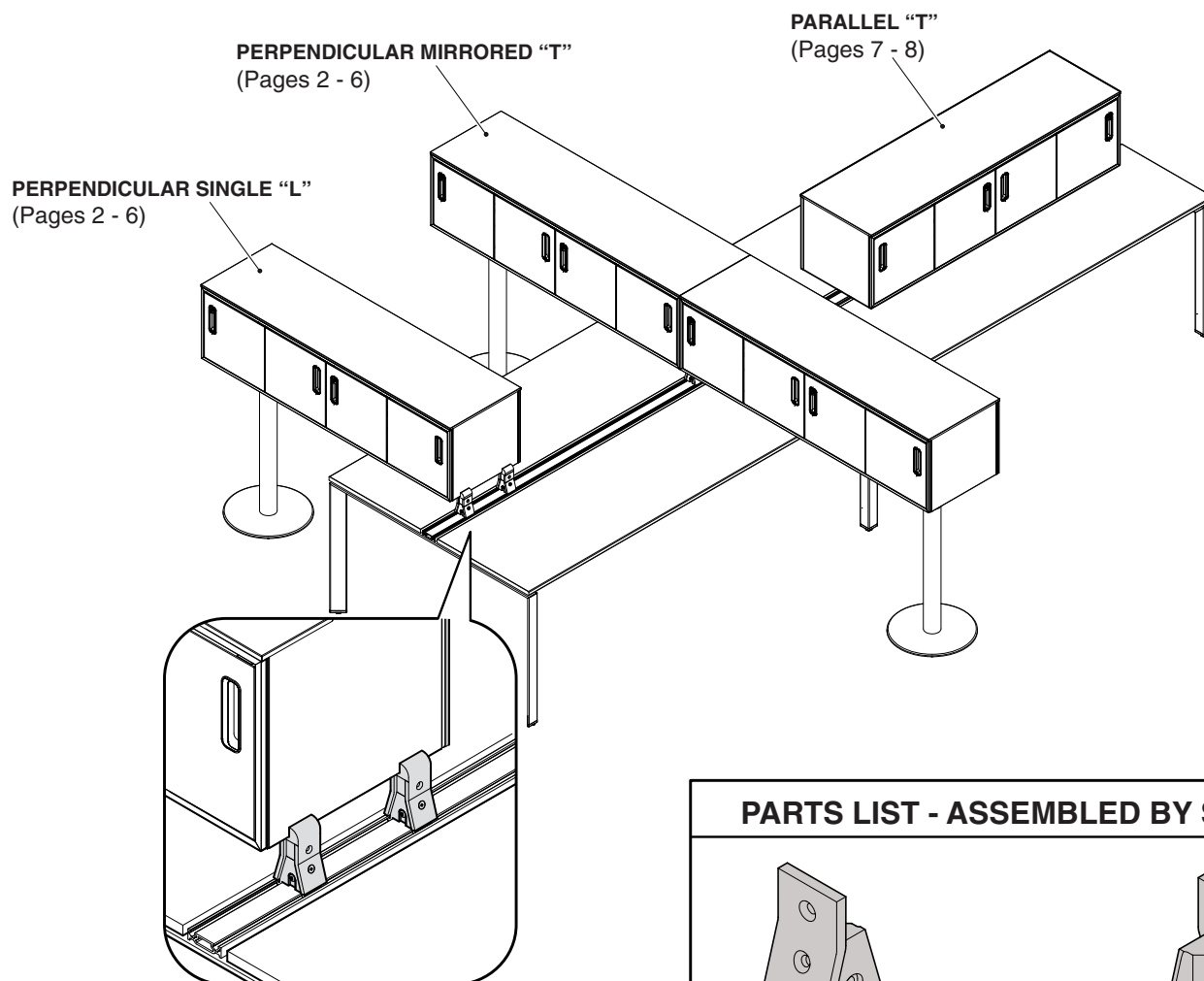

If you have a problem, question, or request, call your local dealer, or Steelcase Line 1 at **888.STEELCASE** (888.783.3522) for immediate action by people who want to help you.

(Outside the U.S.A., Canada, Mexico, Puerto Rico, and the U.S. Virgin Islands, call: 1.616.247.2500)
Or visit our website: www.steelcase.com

© 2015 Steelcase Inc.
Grand Rapids, MI 49501
U.S.A.

Printed in U.S.A.

PARTS LIST - ASSEMBLED BY SUPPLIER

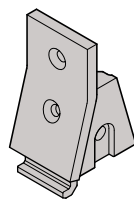

SUPPORT LH

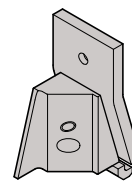

SUPPORT RH

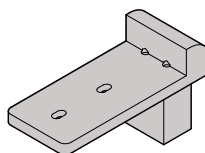

SUPPORT TOP SINGLE

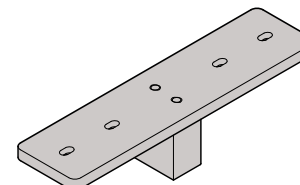

SUPPORT TOP DUAL

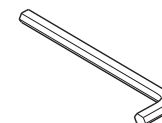
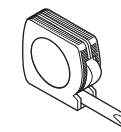
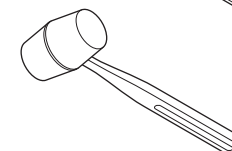
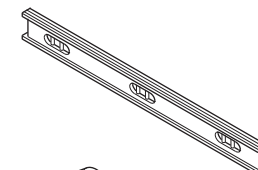
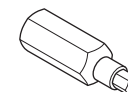
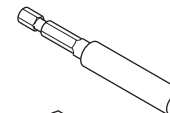

1. Assemble LH and RH supports to aluminum rail.

A. Install LH Support into place in aluminum rail.

B. Position RH Support so that it is aligned with the LH support.

C. Secure the assembly with a screw. **Do not completely tighten.**

Note: For perpendicular applications, proceed to page 3. For parallel applications, go to page 7.

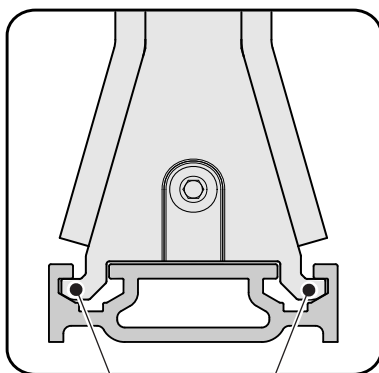

Ensure that both supports are seated securely into rails.

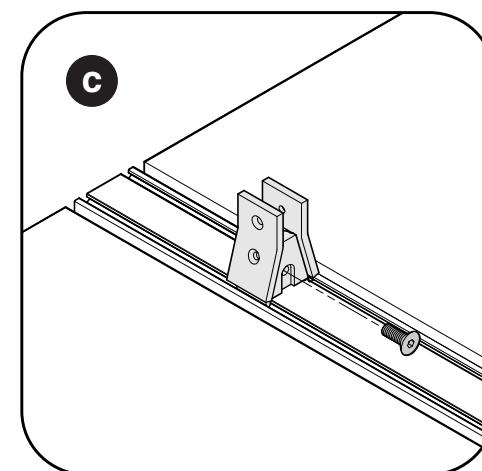
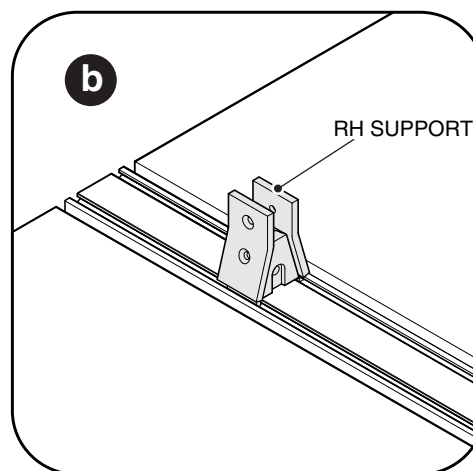
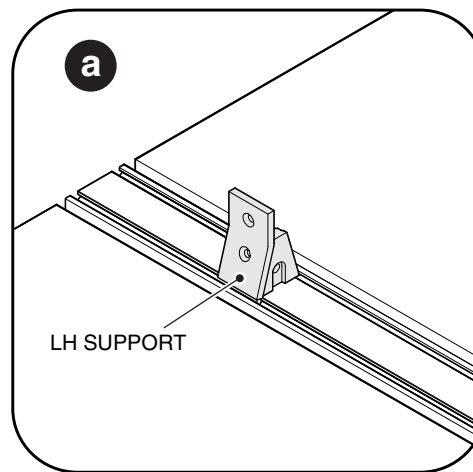

2. Assembling Mid Storage Unit to Stanchions [suggested method]:

a) On a clean, soft surface free of tools, screws, debris, etc., turn the storage unit upside-down.

b) Attach the "T" or "L" castings to the storage unit with the screws supplied with the stanchion hardware package.

TIP: For "L" castings, push the casting up tight against the case side before tightening screws.

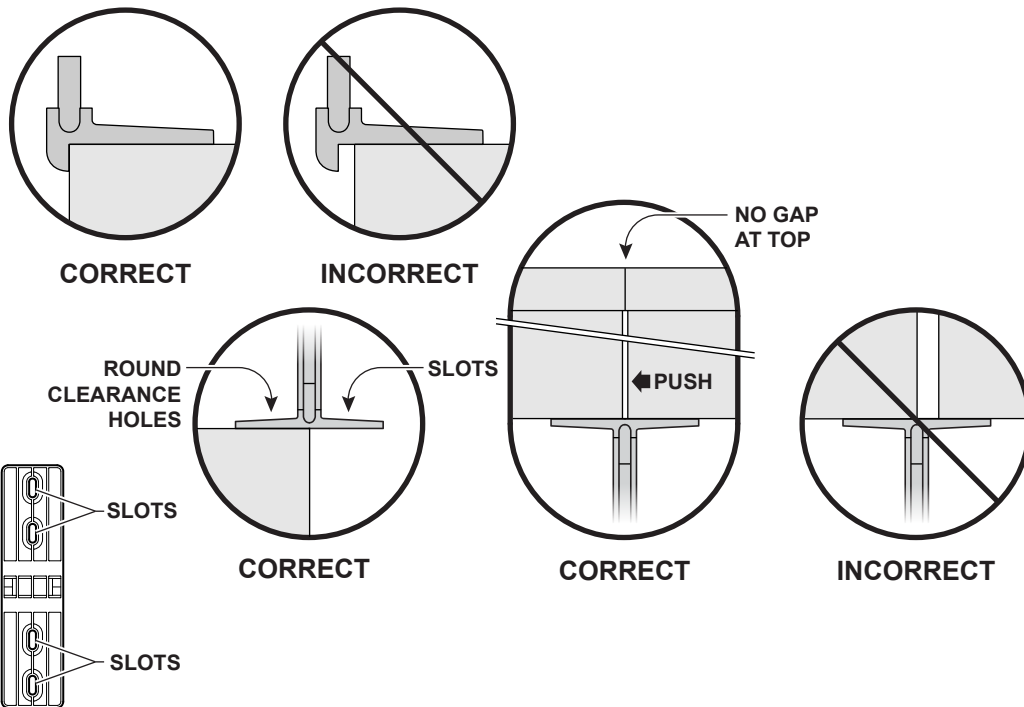
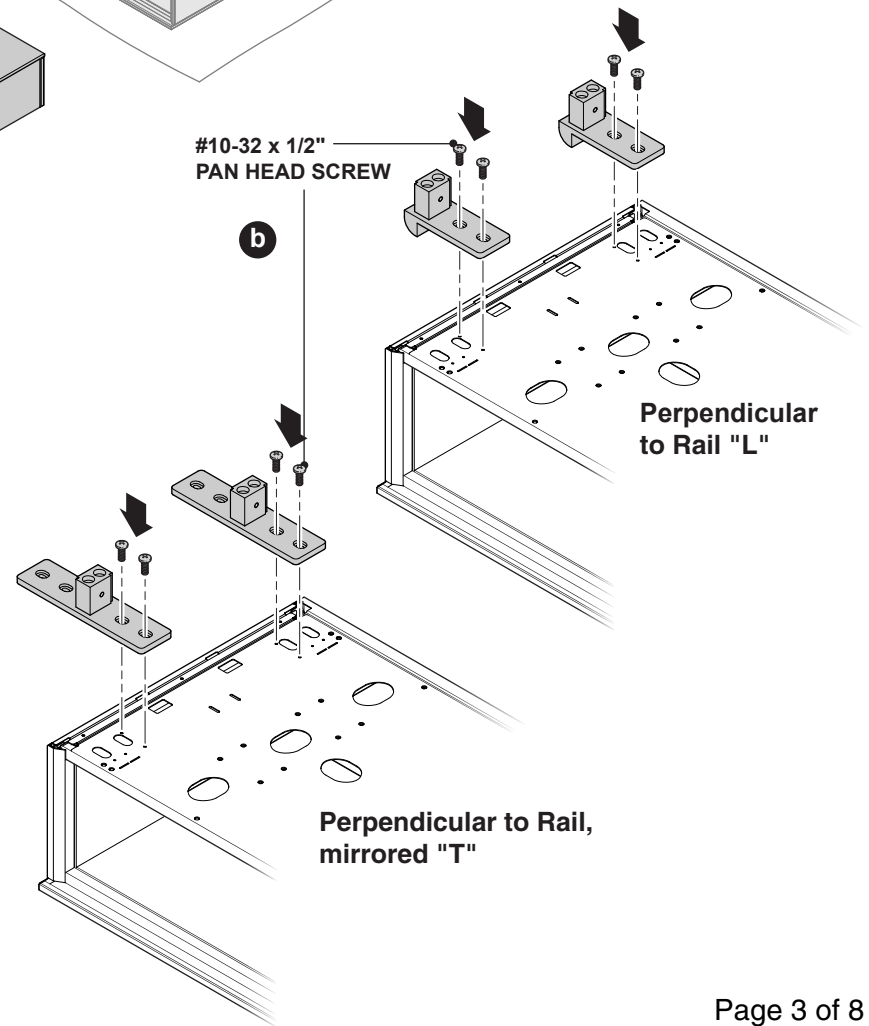
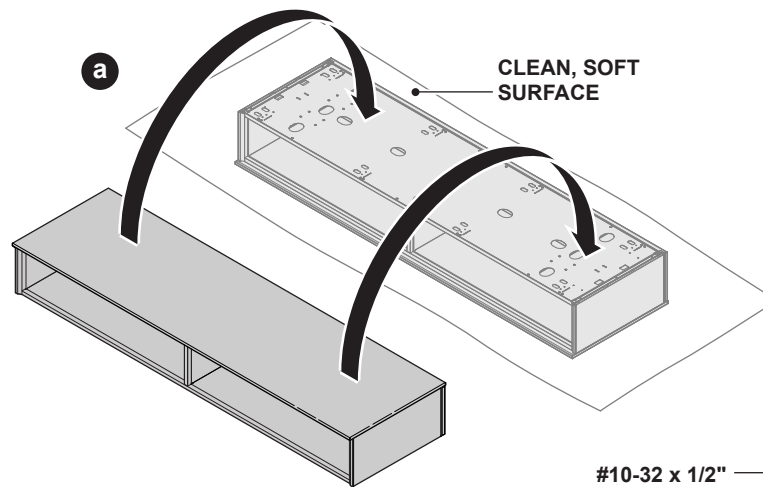

3. Assembling Mid Storage Unit to Stanchions, Perpendicular [suggested method] (continued)

c) Measure distance between castings on storage unit, and adjust positions of stanchions on beam to match.

d) Insert lower center screw into each stanchion and get the threads started. Do not tighten yet.

e) With the help of two (2) assistants, flip the storage unit right side up. Place on the stanchions, and install two (2) top screws to each stanchion.

f) Tighten lower center screws with not more than 100 in-lb of torque.

TIP: To avoid stripping of threads in aluminum blocks, do not overtighten screws.

g) When mid storage units will be ganged together, adhere a strip of foam tape approximately centered on the outer skin of each case. Cut the strip of provided foam tape to match the full height of the outer skin. The foam tape creates a light seal once the units are adjacent to each other and ganged.

NOTE: Foam tape light seal must be added prior to placing units next to each other.

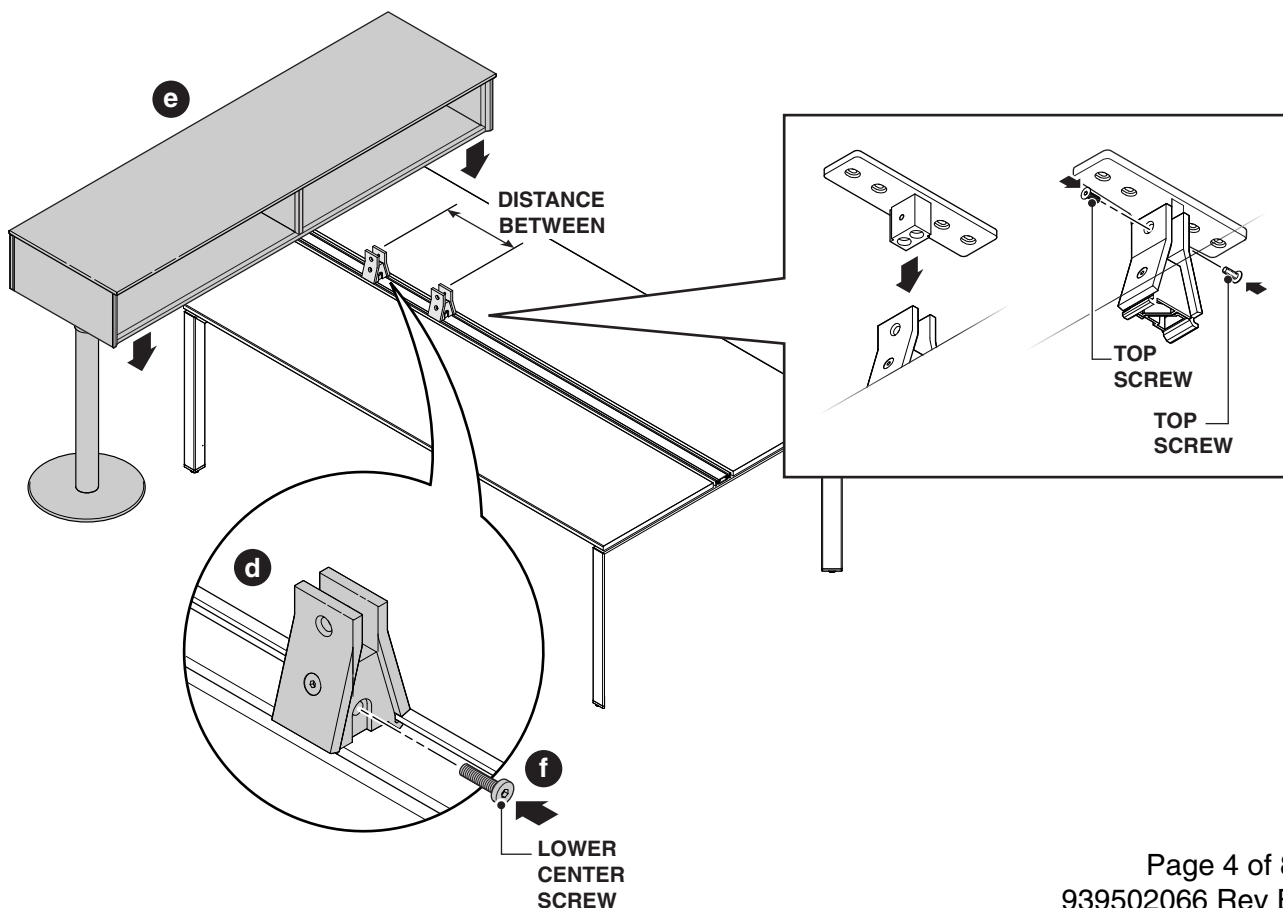
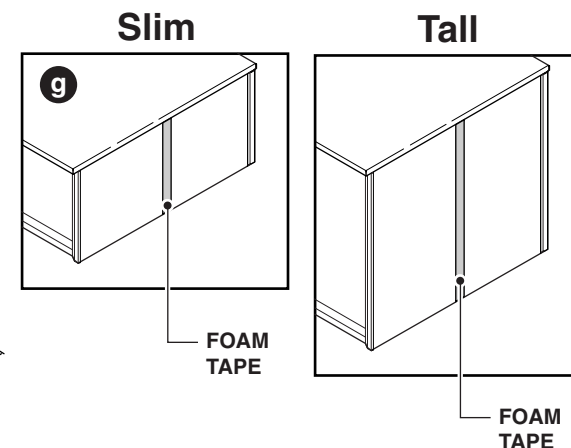
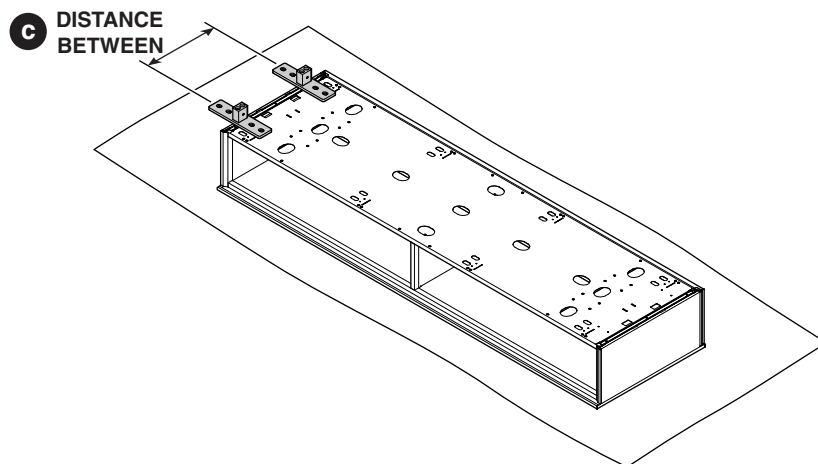

4. Assembling Mid Storage to the Column, in Perpendicular Applications

a) Align the column base to the column.

b) Attach using four (4) 1/4-20 x 1" flat head screws.

c) Measure height of L-stanchion.

d) Adjust the height of the column so it is the same measurement as the one taken in step c.

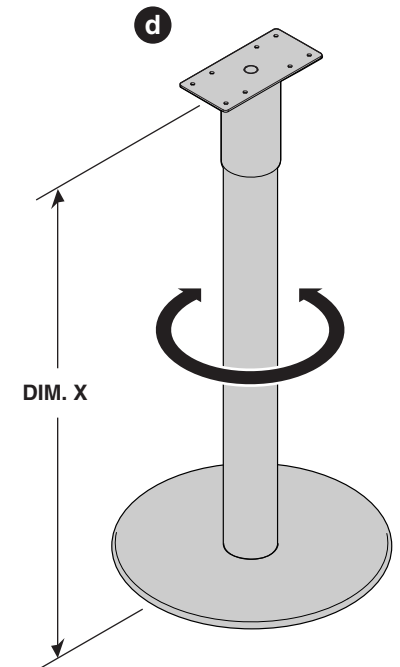
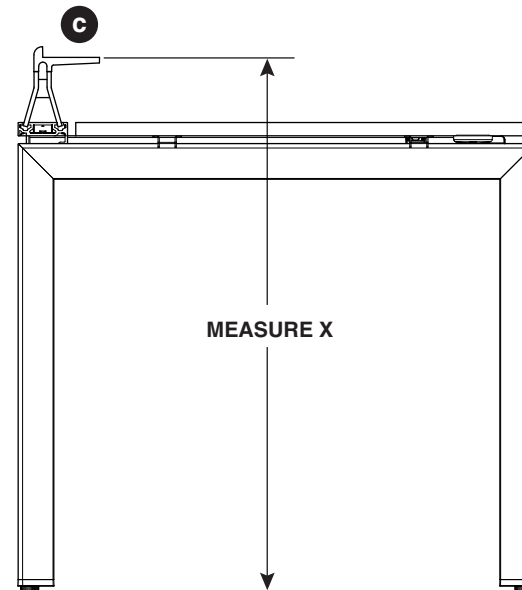
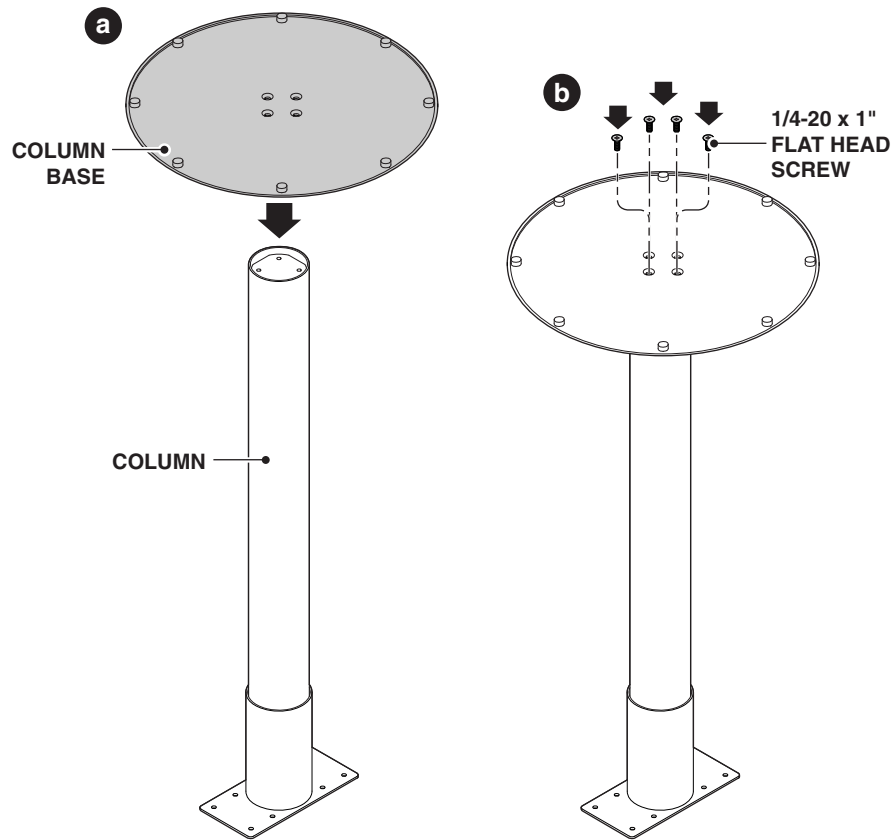

5. Assembling Mid Storage to the Column, Perpendicular (continued)

e) Attach the column to the underside of the mid storage with eight (8) #10-32 x 1/2" pan head screws.

f) Check the mid storage for level. Adjust column height if necessary by slightly lifting the base off the floor and rotating the column.

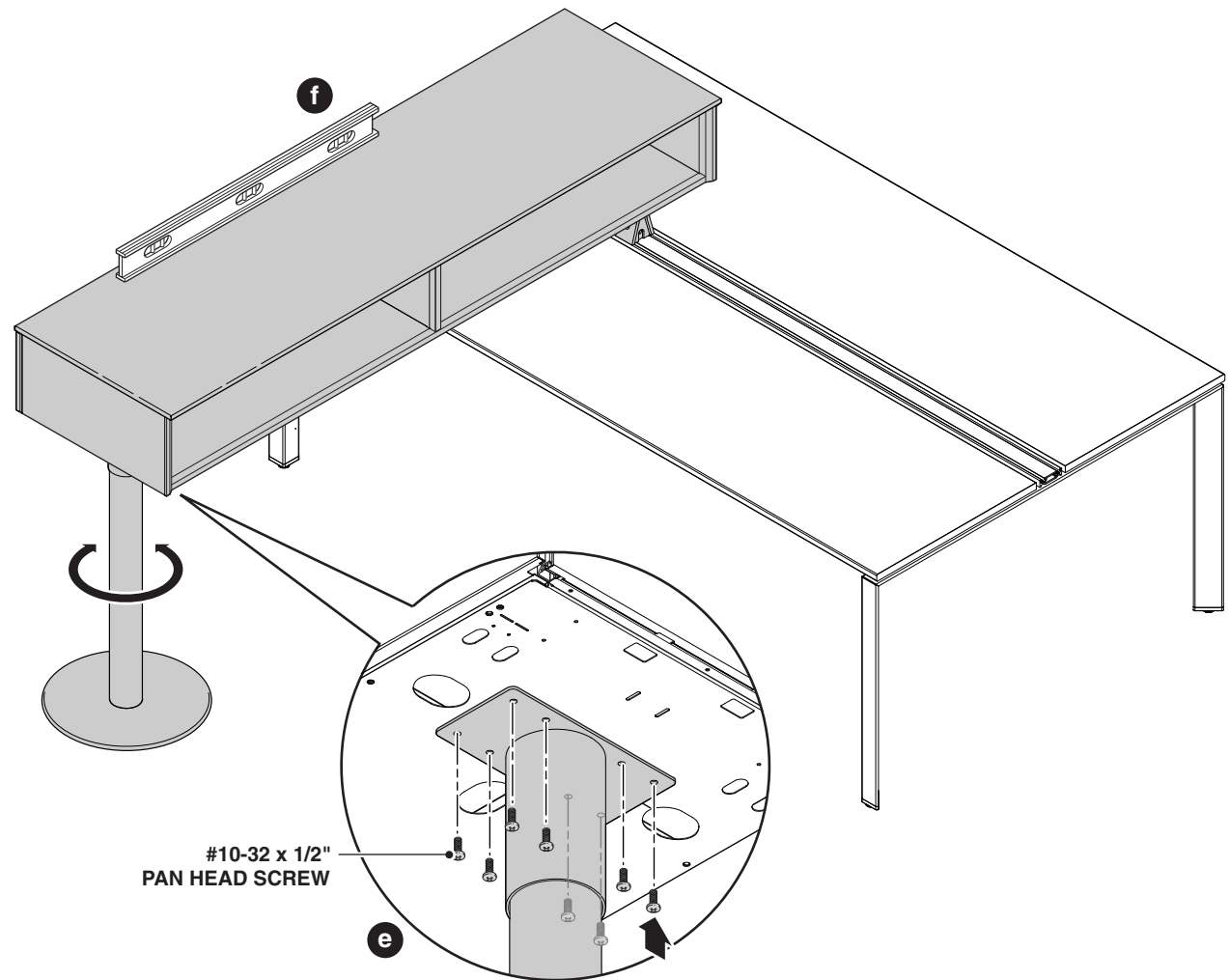

2. Assembling Mid Storage Unit to Stanchions, Parallel [suggested method]

c) Measure distance between castings on storage unit, and adjust positions of stanchions on desk to match.

d) Insert lower center screw into each stanchion and get the threads started. Do not tighten yet.

e) With the help of two (2) assistants, flip the storage unit right side up. Place on the stanchions, and install two (2) top screws to each stanchion.

f) Tighten lower center screws with not more than 100 in-lb of torque.

TIP: To avoid stripping of threads in aluminum blocks, do not overtighten screws.

g) When mid storage units will be ganged together, adhere a strip of foam tape approximately centered on the outer skin of each case. Cut the strip of provided foam tape to match the full height of the outer skin. The foam tape creates a light seal once the units are adjacent to each other and ganged.

NOTE: Foam tape light seal must be added prior to placing units next to each other.

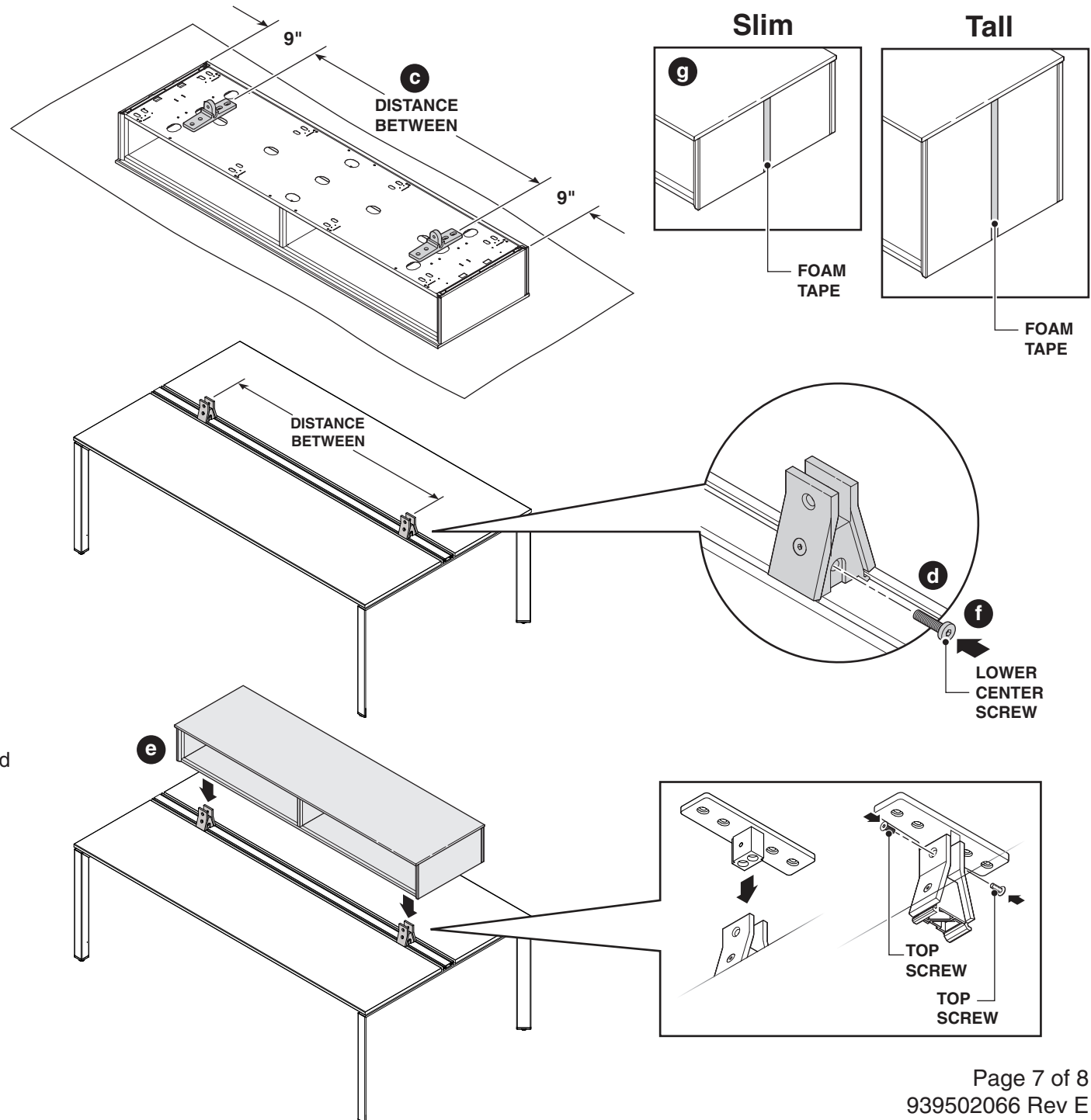

Ganging Mid Storage Cases in Parallel Applications

NOTE: Verify that the units have the foam tape (light seal) applied prior to ganging.

TIP: Mid storage units must be touching each other.

a) Align the ganging plate to the holes on the underside of the mid storage units.

b) Secure the ganging bracket to the cabinet using eight (8) #10-32 x 1/2" pan head screws. Install the round holes first, then the slots.

