

## 482 Amia™ Chair - Cylinder Replacement

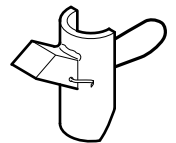
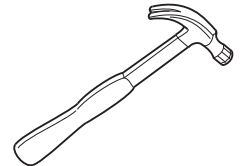
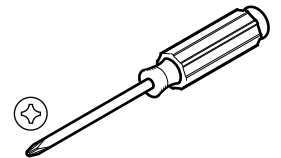
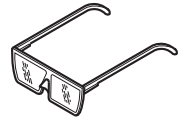
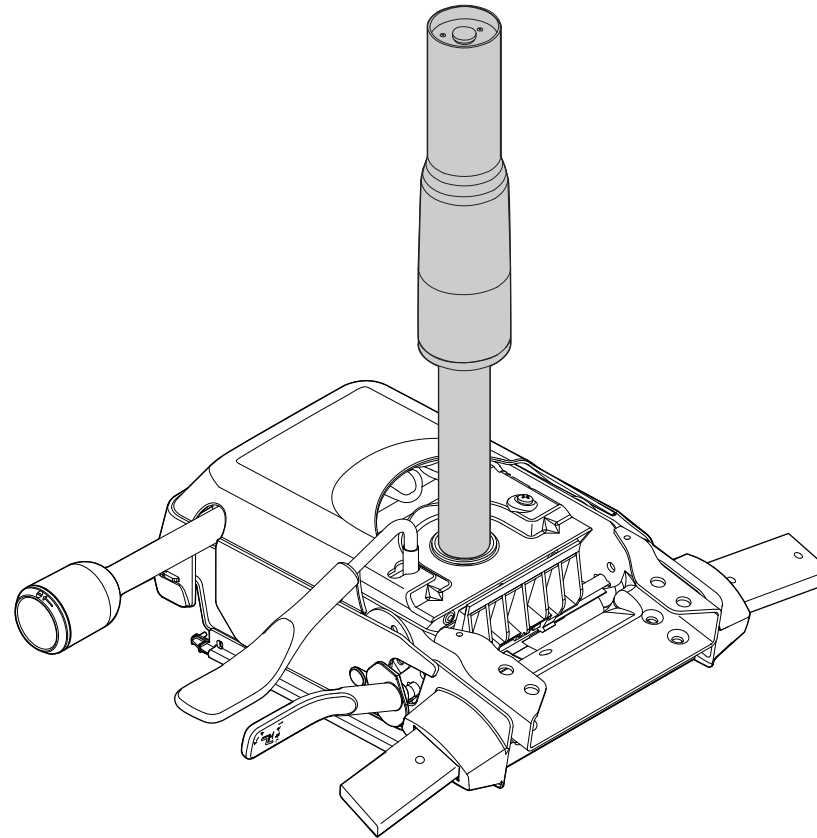

**PNEUMATIC CYLINDER  
REMOVAL TOOL**

If you have a problem, question, or request, call your local dealer, or Steelcase Line 1 at 888.STEELCASE (888.783.3522) for immediate action by people who want to help you. (Outside the U.S.A., Canada, Mexico, Puerto Rico, and the U.S. Virgin Islands, call: 1.616.247.2500) Or visit our website: [www.steelcase.com](http://www.steelcase.com)  
© 2007 Steelcase Inc.  
Grand Rapids, MI 49501  
U.S.A.  
Printed in U.S.A.

**1.** Turn chair over. Hit bottom of the cylinder with a hammer (1a) while pulling forward on the chair base (1b).

**2.** Remove chair base.  
**NOTE:** If stool chair, loosen and remove footring.

**3.** Install the pneumatic cylinder removal tool (part number 879100100) on the top part of the column, as close as possible to the control.

**4.** Apply lifting force to the column, with one hand. With the hammer in the other hand, give the removal tool several solid hits, on the flat part.

If pneumatic cylinder does not separate from control, apply WD-40 where lift is embedded into control. Wait approx. 20 minutes and repeat step 4.

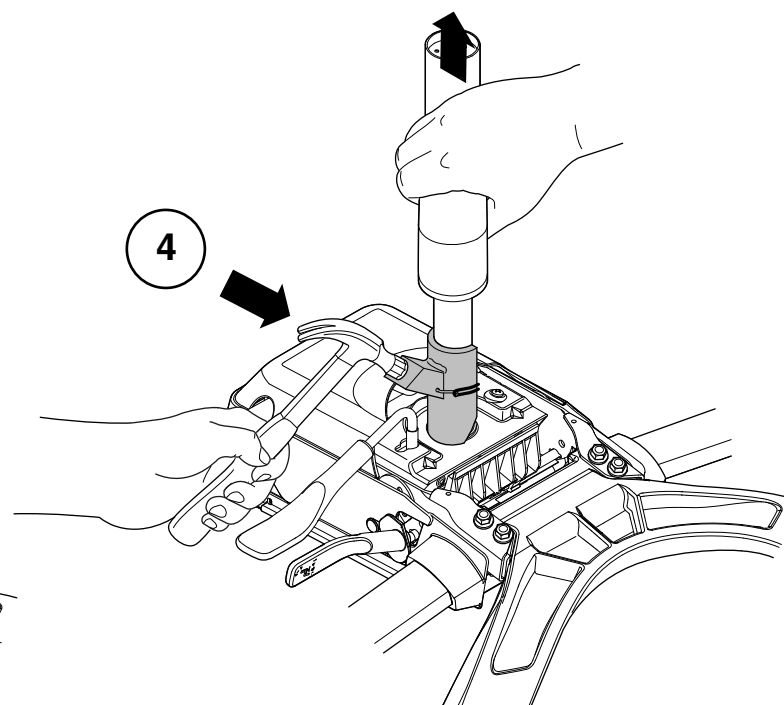
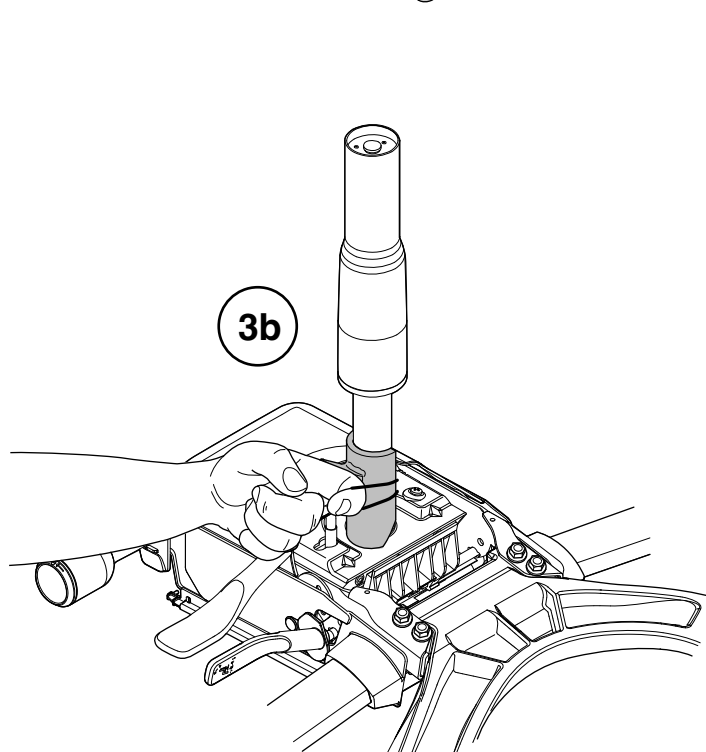
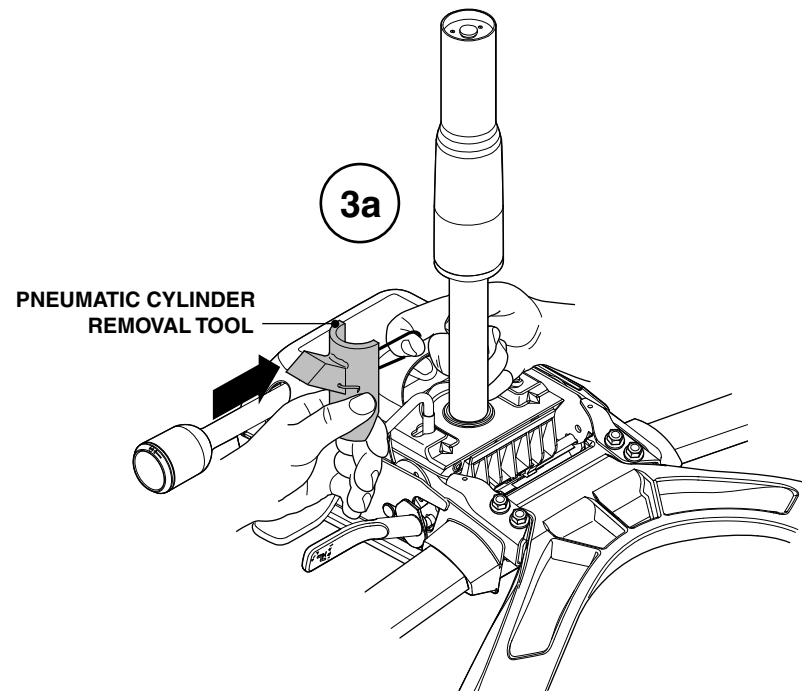
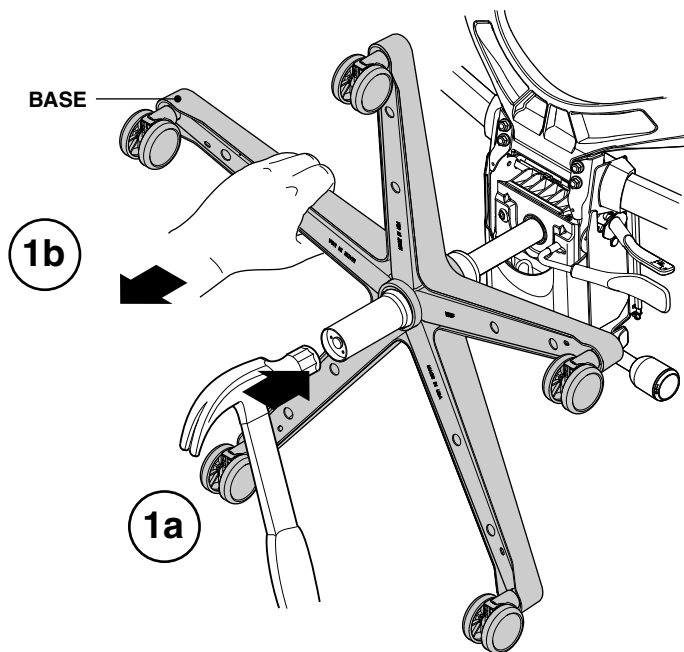

## For Stool Chairs Only

**5.** Install new cylinder into chair control.

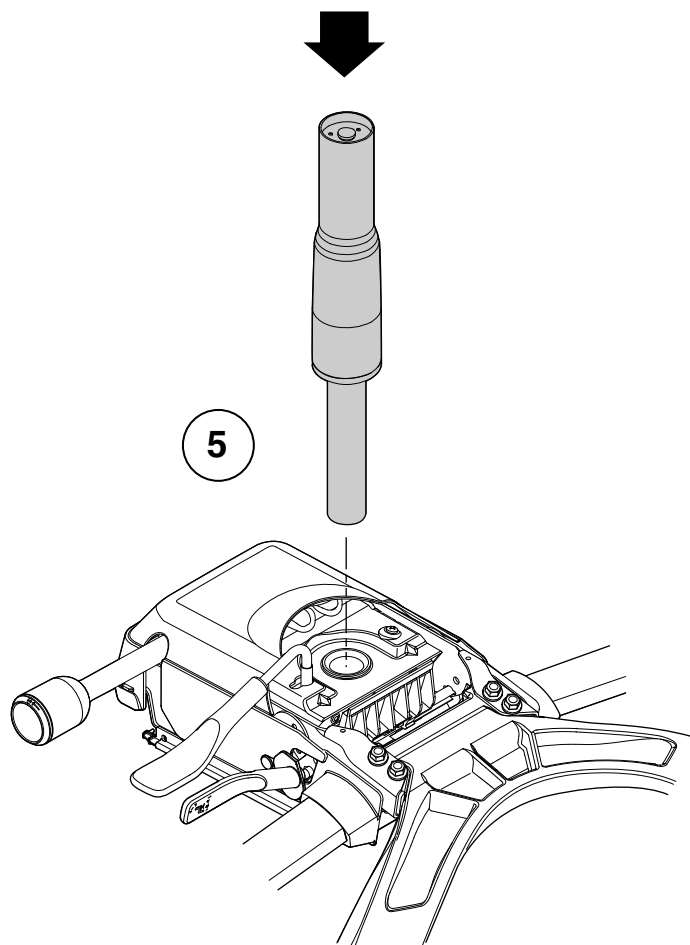

**6.** Align footing with cylinder (6a) and twist to tighten (6b).

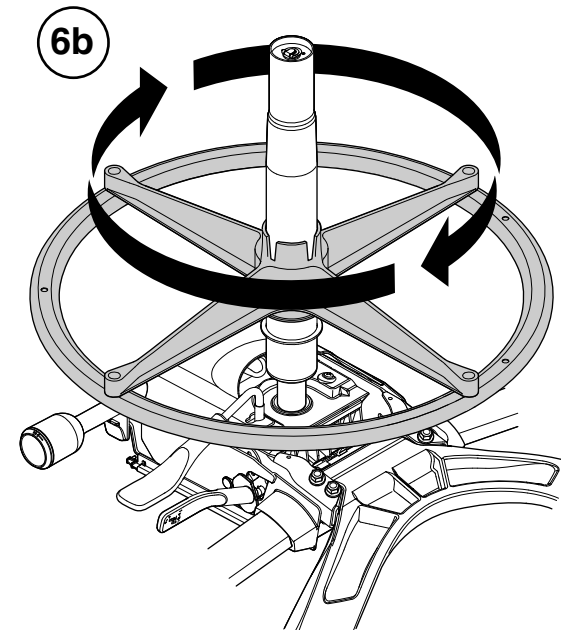
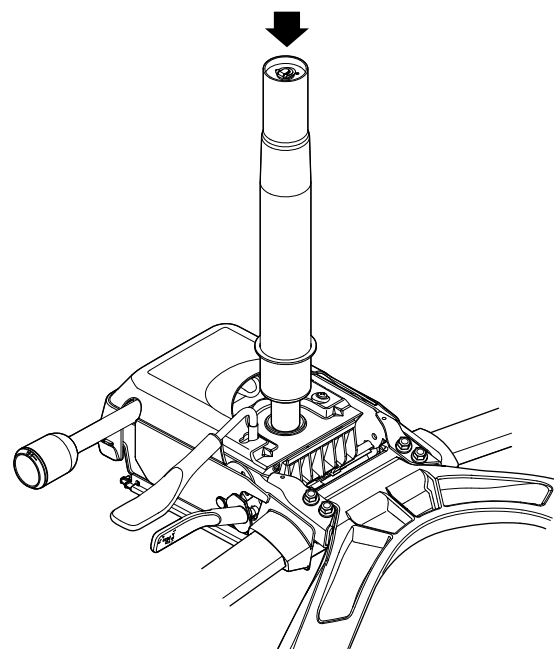
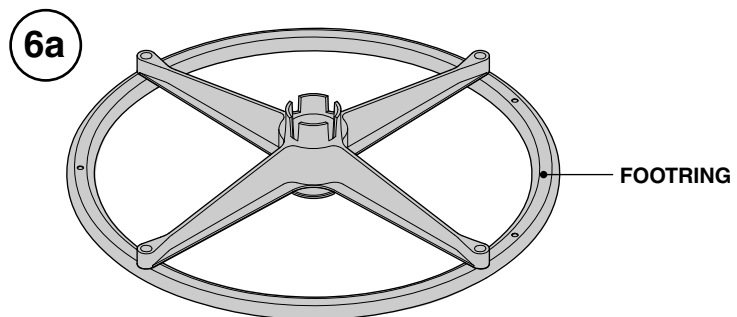

**7.** To install base, align base with cylinder and slide onto cylinder.

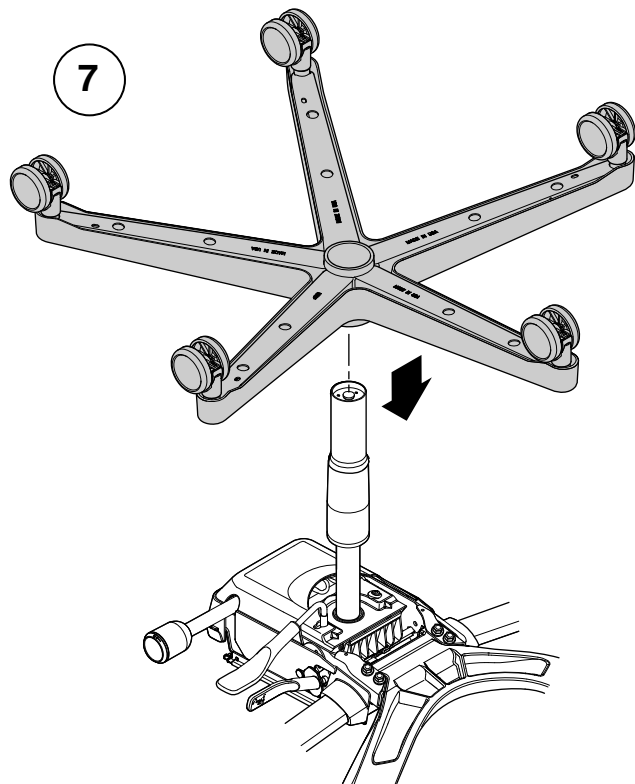

**8.** Flip chair over

**9.** Sit in chair to seat the cylinder into the chair control and base.

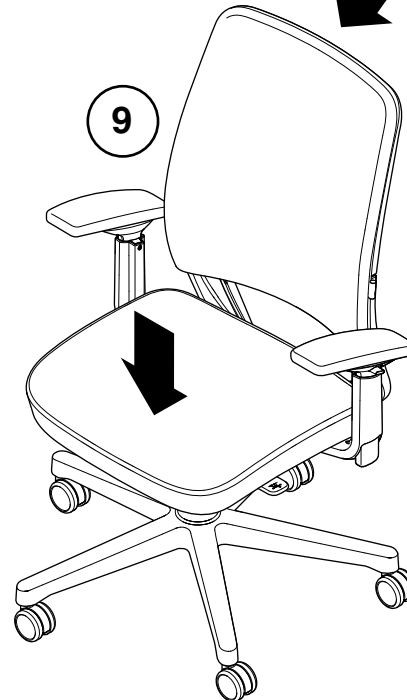
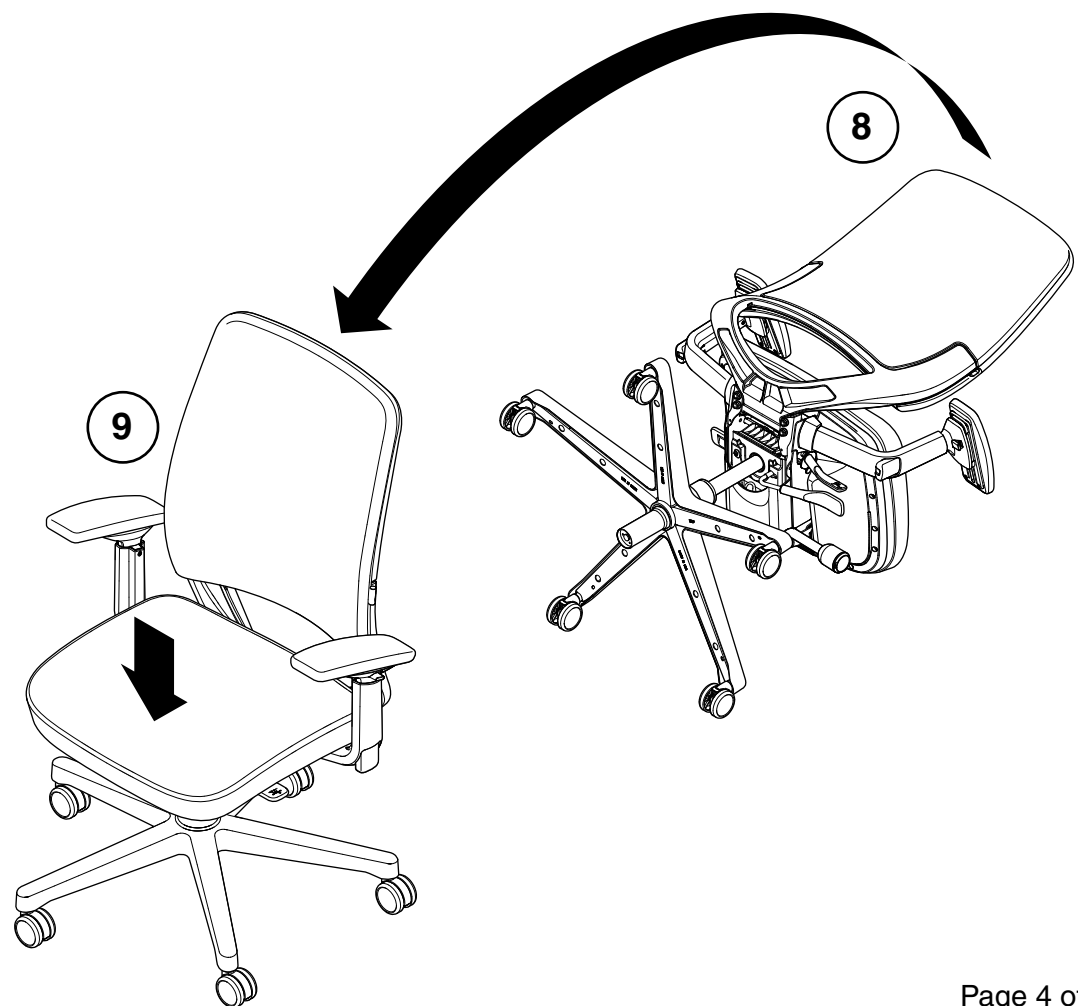

**10.** Flip the chair over a final time and adjust the pneumatic lever (if required) to have a 1/4" of free vertical movement.

