

# Disassembly Instructions

Strive Chair

Material Type: A . Steel B. Plastic

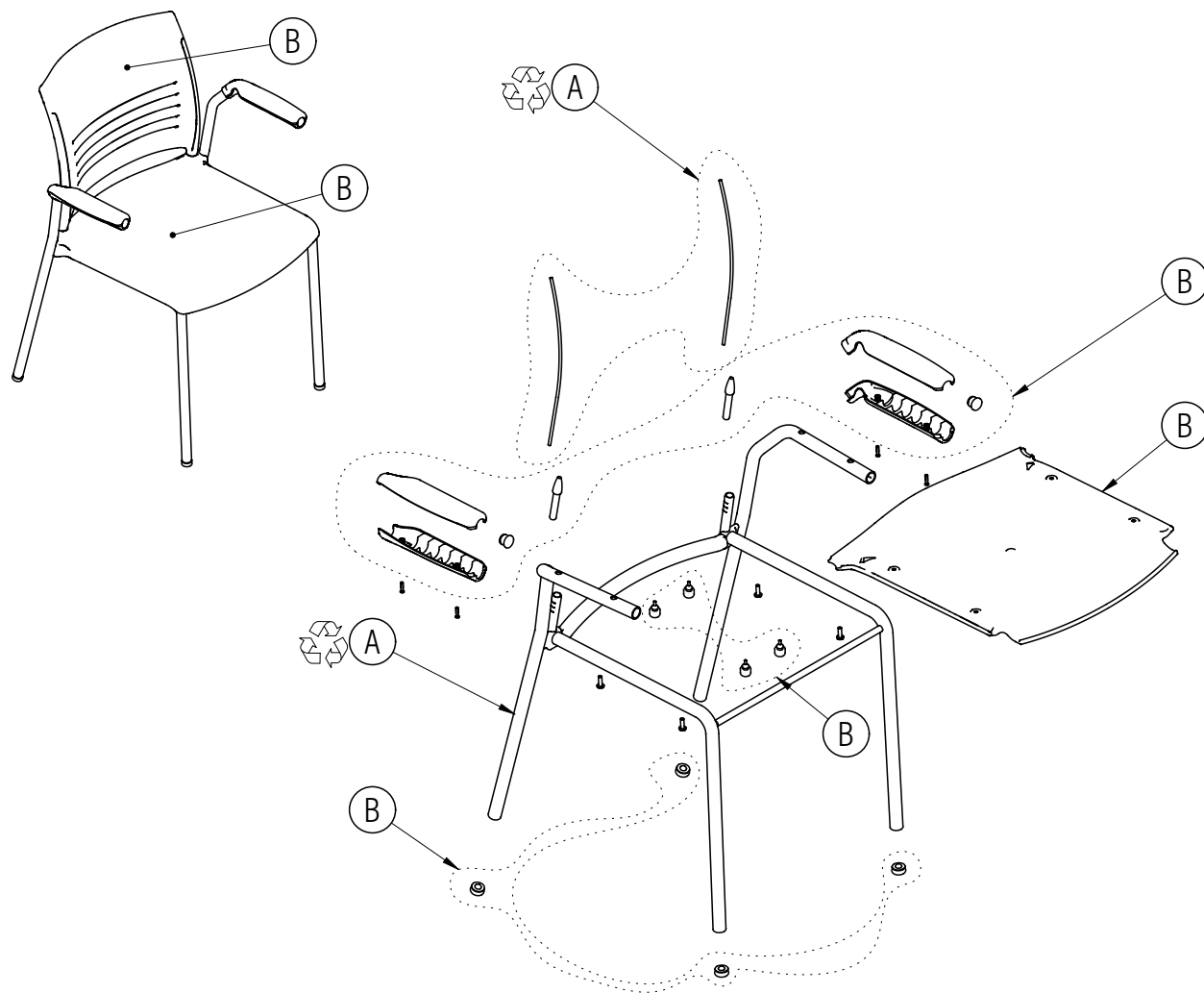

## Procedure:

1. Knock the backrest upwards off the chair frame from underneath. Pull out the backrest springs and the spring bushings.
2. Remove the screws holding the seat to the seat shroud and remove the seat and shroud.
3. Remove the screws holding each arm cap to the chair frame and remove the arm caps. Pry out the end caps from the arm tubes.
4. Pry the out the glides from the ends of the leg tubes.

## General Notes:

1. Disassembly time: 5-10 minutes
2. This procedure assumes basic familiarity with hand tools and furniture terminology: no specialized training is required
3. All materials removed and disassembled shall be sorted and segregated with like materials and disposed of or recycled according to recycling availability or waste acceptance
4. For items to be recycled, refer to KI's End of Life Recycling Matrix and KI's End of Life Recovery Options Matrix, available at [www.ki.com](http://www.ki.com)

All fasteners not explicitly tagged are Material Type A: Steel

## Required Tools



Gloves



Safety Glasses

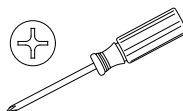

Philips Screwdriver

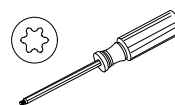

Torx Screwdriver

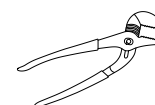

Channel Lock Pliers

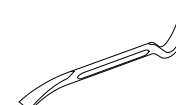

Pry Bar

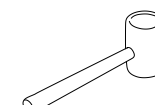

Rubber Mallet