

Disassembly Instructions

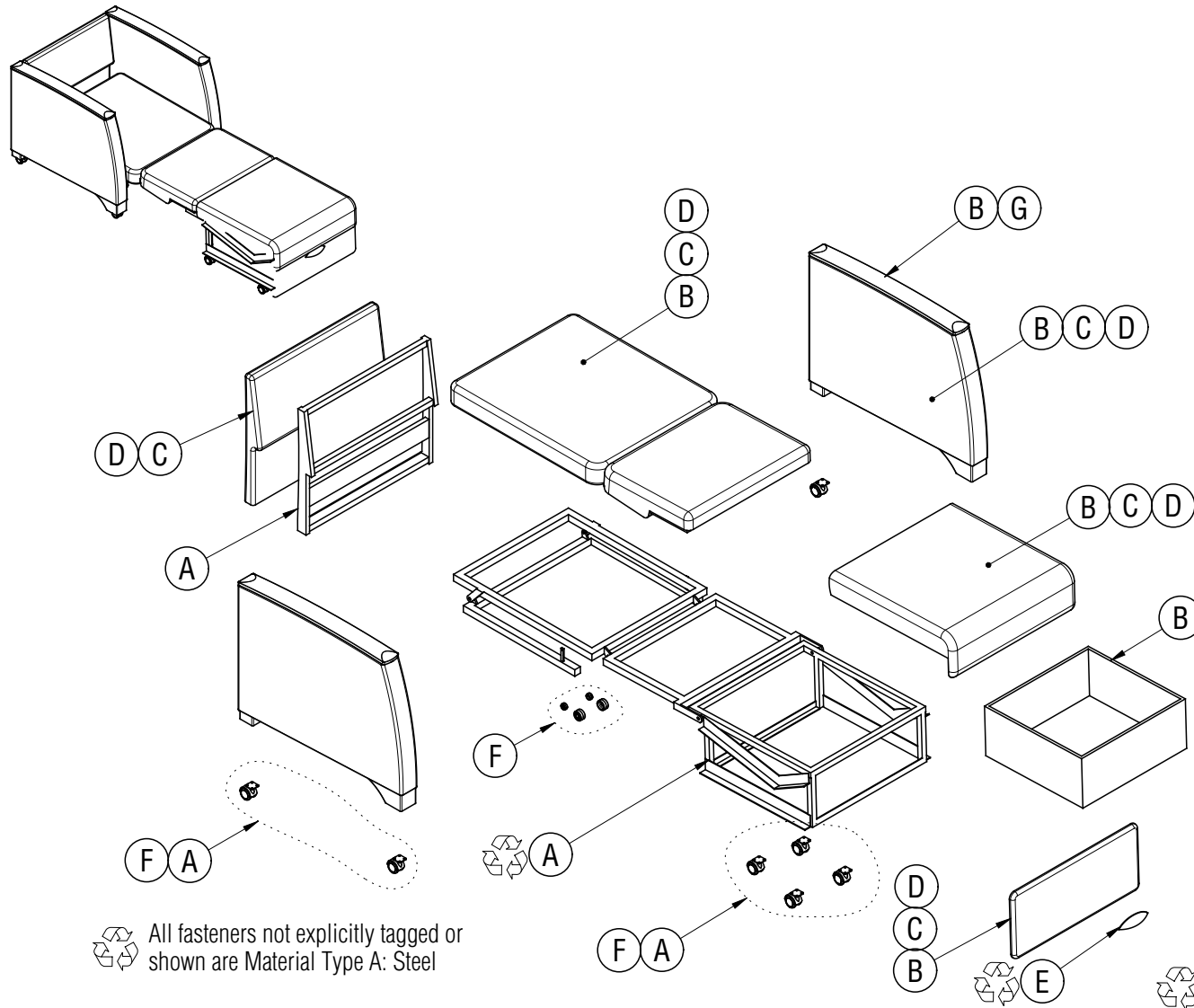

Lounge Sleeper: Affina, Briar, Flex, Perth, Soltice, Three

Material Type: A. Steel B. Wood C. Foam D. Fabric E. Aluminum/Alloy F. Plastic G. Coated Steel



Procedure:

1. Extend the sleeper fully and turn onto its side to access all fasteners holding the bed frame to the arms.
2. Remove the bed frame from the arms.
3. Pry off the armcaps. Cut inside chair back fabric to expose the fasteners holding back to arms. Remove the back of the chair.
4. Turn bed frame over to expose all fasteners holding the bed foam pads. Remove all pads.
5. Remove the storage box padded front. Remove the storage box. Remove the pull handle.
6. Remove all casters and bed frame rollers from arms and frame.
7. Cut the bed pad fabric and separate any wood frame or seat board from the foam. Cut the fabric from arms and scrape off any thin foam.

General Notes:

1. Disassembly time: 45-50 minutes
2. This procedure assumes basic familiarity with hand tools and furniture terminology: no specialized training is required
3. All materials removed and disassembled shall be sorted and segregated with like materials and disposed of or recycled according to recycling availability or waste acceptance
4. For items to be recycled, refer to KI's End of Life Recycling Matrix and KI's End of Life Recovery Options Matrix, available at www.ki.com

Required Tools



Gloves



Safety Glasses

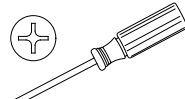

Philips Screwdriver

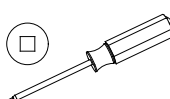

Robertson Screwdriver

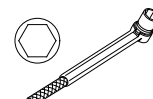

Hex Socket Wrench

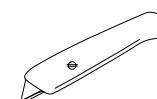

Utility Knife



Pry Bar



Combination Wrench