

# Disassembly Instructions

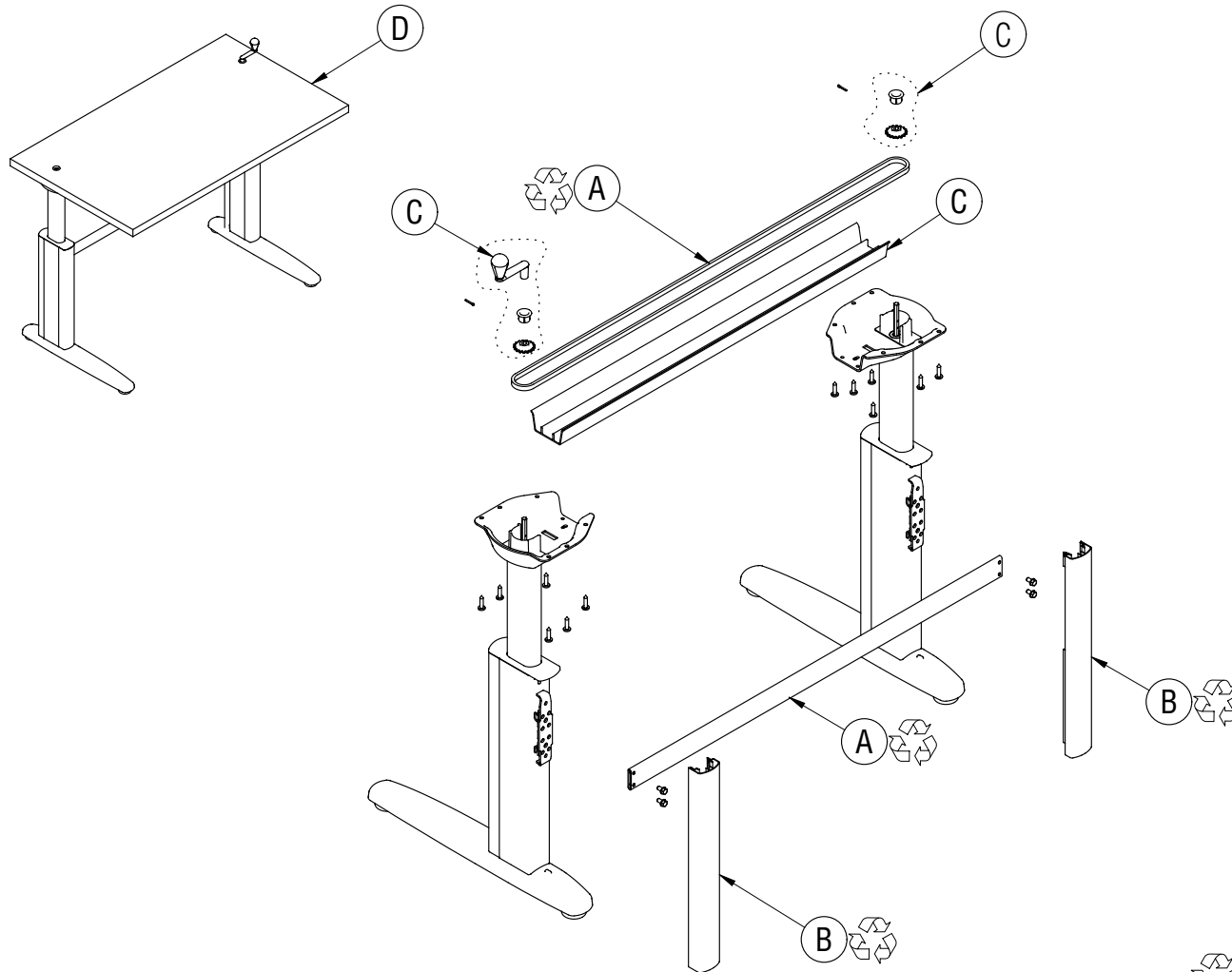

Genesis® Tables

Material Type:      A. Steel                      B. Aluminum                      C. Plastic                      D. Wood / Particle Board



Procedure:

1. Remove any crank handle(s) from the top of the table and pry out the plastic grommets from the crank holes (if applicable).
2. Remove the screws holding the table base to the top and remove the top. Pry out any grommets from the table top.
3. Pull out the cotter pins holding the sprockets onto the hex adjusting rods and pull off the sprockets and chain. Lift out the plastic chain channel (if applicable).
4. Pry off the metal covers from the rear of the table base, remove the screws holding the crossbar onto the legs and remove the crossbar (if applicable).

(continued on next page)

General Notes:

1. Disassembly time: 15-30 minutes
2. This procedure assumes basic familiarity with hand tools and furniture terminology: no specialized training is required
3. All materials removed and disassembled shall be sorted and segregated with like materials and disposed of or recycled according to recycling availability or waste acceptance
4. For items to be recycled, refer to KI's End of Life Recycling Matrix and KI's End of Life Recovery Options Matrix, available at [www.ki.com](http://www.ki.com)

All fasteners not explicitly tagged are Material Type A: Steel

Required Tools								
	Safety Glasses	Gloves	Pry Bar	Hex Socket Wrench	Phillips Screwdriver	Rubber Mallet	Pliers	Flat Screwdriver

# Disassembly Instructions



Genesis® Tables

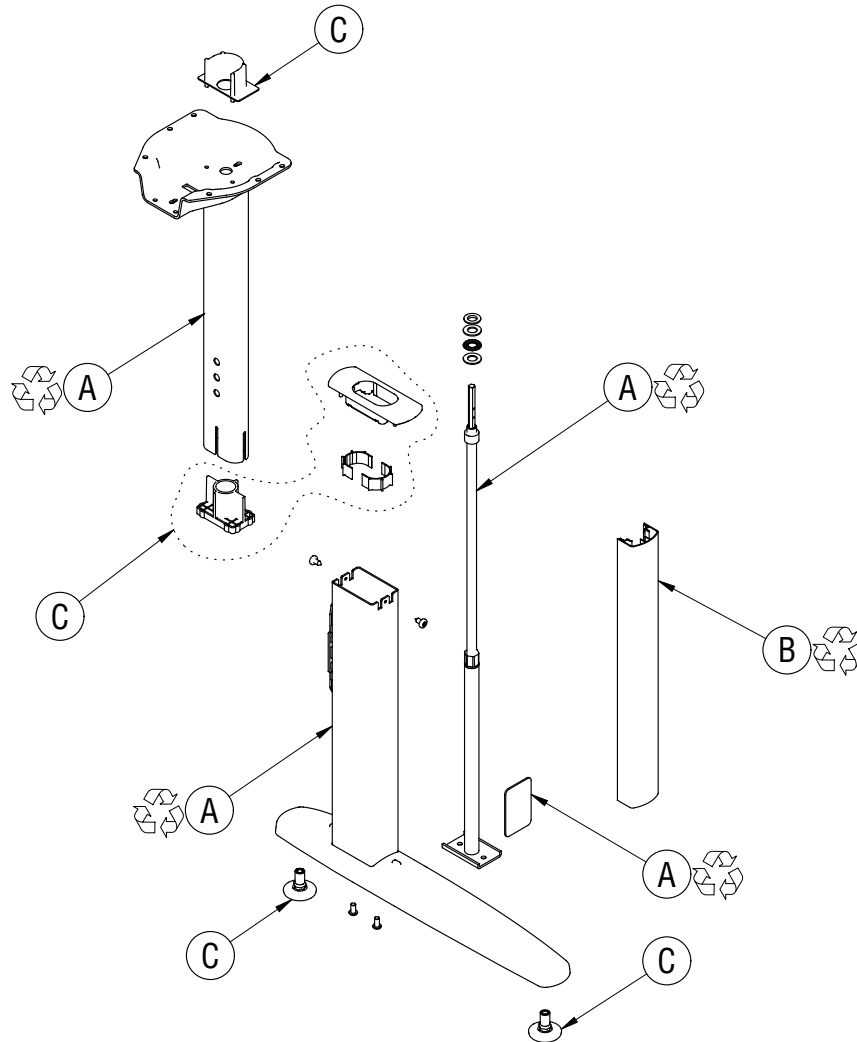

Material Type:      A. Steel                  B. Aluminum                  C. Plastic



Procedure (continued):

5. Pry the bearing and thrust washers off the top of the hexagonal shaft and remove them. Pry out the chain guard from the top of the inner leg and remove it.
6. Remove the screws holding the trim plate to the lower leg.
7. Pull the inner leg, trim plate and the inner leg glide out of the top of the leg assembly.
8. Slide up the front leg cover to remove it. Tear off the attachment plate from the front of the leg.
9. Remove the glides from the table leg foot. Remove the screws holding the height adjustment mechanism into the leg and pull out the mechanism.

 All items not explicitly tagged are Material Type A: Steel

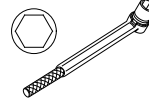
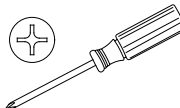
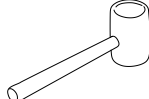
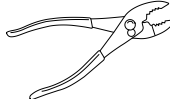
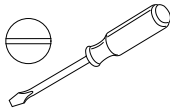
<b>Required Tools</b>								
	Safety Glasses	Gloves	Pry Bar	Hex Socket Wrench	Phillips Screwdriver	Rubber Mallet	Pliers	Flat Screwdriver