

# Parts Diagram ■

## 700 Series® Lateral File Locks

Top Lock

August 2016

Price list unit height is referenced.

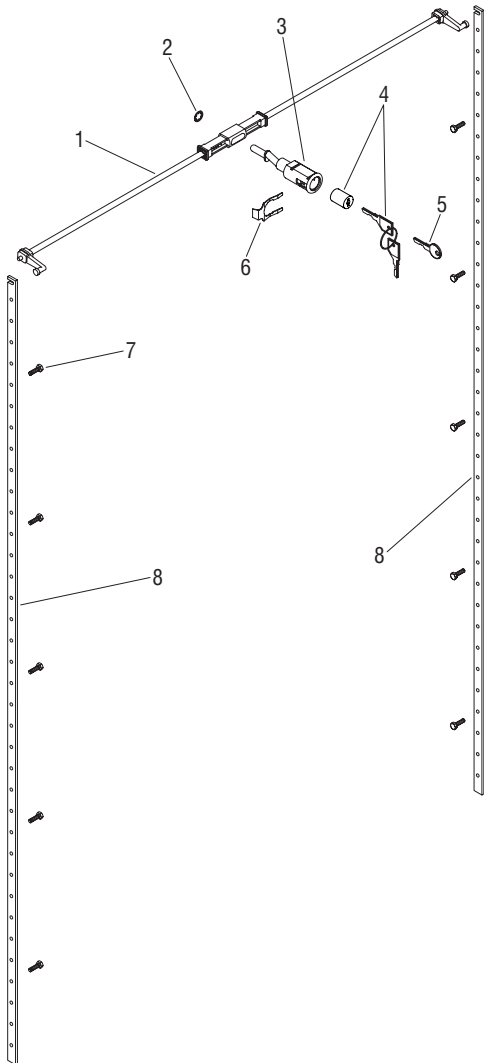

### Item Part Number Item Description

1	2.KP29040	Transfer Rod, 30", Lateral File
	2.KP29041	Transfer Rod, 36", Lateral File
	2.KP29042	Transfer Rod, 42", Lateral File
2	2.KP29006	Retaining Clip
3	2.KP29069	Lock Housing
4	2.KP20522	Lock Core/Keys
5	2.KP20551	Extractor Key
6	2.KP29005	Lock Clip
7	2.KP20260	Lock Stud
8	2.KP61340	Lock Bar, Unit Ht. 16 <sup>9</sup> / <sub>32</sub> ", (15" part length)
	2.KP61300	Lock Bar, Unit Ht. 17 <sup>13</sup> / <sub>16</sub> ", (16 <sup>9</sup> / <sub>16</sub> " part length)
	2.KP61301	Lock Bar, Unit Ht. 19 <sup>11</sup> / <sub>32</sub> ", (18 <sup>1</sup> / <sub>16</sub> " part length)
	2.KP61302	Lock Bar, Unit Ht. 20 <sup>7</sup> / <sub>8</sub> ", (19 <sup>5</sup> / <sub>8</sub> " part length)
	2.KP61303	Lock Bar, Unit Ht. 22 <sup>13</sup> / <sub>32</sub> ", (21 <sup>1</sup> / <sub>8</sub> " part length)
	2.KP61304	Lock Bar, Unit Ht. 23 <sup>15</sup> / <sub>16</sub> ", (22 <sup>11</sup> / <sub>16</sub> " part length)
	2.KP61305	Lock Bar, Unit Ht. 25 <sup>15</sup> / <sub>32</sub> ", (24 <sup>3</sup> / <sub>16</sub> " part length)
	2.KP61306	Lock Bar, Unit Ht. 27", (25 <sup>3</sup> / <sub>4</sub> " part length)
	2.KP61307	Lock Bar, Unit Ht. 28 <sup>17</sup> / <sub>32</sub> ", (27 <sup>1</sup> / <sub>4</sub> " part length)
	2.KP61308	Lock Bar, Unit Ht. 30 <sup>1</sup> / <sub>16</sub> ", (28 <sup>13</sup> / <sub>16</sub> " part length)
	2.KP61309	Lock Bar, Unit Ht. 31 <sup>19</sup> / <sub>32</sub> ", (30 <sup>5</sup> / <sub>16</sub> " part length)
	2.KP61310	Lock Bar, Unit Ht. 33 <sup>1</sup> / <sub>8</sub> ", (31 <sup>7</sup> / <sub>8</sub> " part length)
	2.KP61311	Lock Bar, Unit Ht. 34 <sup>21</sup> / <sub>32</sub> ", (33 <sup>3</sup> / <sub>8</sub> " part length)
	2.KP61312	Lock Bar, Unit Ht. 36 <sup>3</sup> / <sub>16</sub> ", (34 <sup>15</sup> / <sub>16</sub> " part length)
	2.KP61313	Lock Bar, Unit Ht. 37 <sup>23</sup> / <sub>32</sub> ", (36 <sup>7</sup> / <sub>16</sub> " part length)
	2.KP61314	Lock Bar, Unit Ht. 39 <sup>1</sup> / <sub>4</sub> ", (38" part length)
	2.KP61315	Lock Bar, Unit Ht. 40 <sup>25</sup> / <sub>32</sub> ", (39 <sup>1</sup> / <sub>2</sub> " part length)
	2.KP61316	Lock Bar, Unit Ht. 42 <sup>9</sup> / <sub>16</sub> ", (41 <sup>5</sup> / <sub>8</sub> " part length)
	2.KP61317	Lock Bar, Unit Ht. 43 <sup>27</sup> / <sub>32</sub> ", (42 <sup>9</sup> / <sub>16</sub> " part length)
	2.KP61318	Lock Bar, Unit Ht. 45 <sup>3</sup> / <sub>8</sub> ", (44 <sup>1</sup> / <sub>8</sub> " part length)
	2.KP61319	Lock Bar, Unit Ht. 46 <sup>29</sup> / <sub>32</sub> ", (45 <sup>5</sup> / <sub>8</sub> " part length)
	2.KP61320	Lock Bar, Unit Ht. 48 <sup>7</sup> / <sub>16</sub> ", (47 <sup>3</sup> / <sub>16</sub> " part length)
	2.KP61321	Lock Bar, Unit Ht. 49 <sup>31</sup> / <sub>32</sub> ", (48 <sup>1</sup> / <sub>16</sub> " part length)
	2.KP61322	Lock Bar, Unit Ht. 51 <sup>1</sup> / <sub>2</sub> ", (50 <sup>1</sup> / <sub>4</sub> " part length)
	2.KP61323	Lock Bar, Unit Ht. 53 <sup>1</sup> / <sub>32</sub> ", (51 <sup>3</sup> / <sub>4</sub> " part length)
	2.KP61324	Lock Bar, Unit Ht. 54 <sup>9</sup> / <sub>16</sub> ", (53 <sup>5</sup> / <sub>16</sub> " part length)
	2.KP61325	Lock Bar, Unit Ht. 56 <sup>3</sup> / <sub>32</sub> ", (54 <sup>13</sup> / <sub>16</sub> " part length)
	2.KP61326	Lock Bar, Unit Ht. 57 <sup>5</sup> / <sub>8</sub> ", (56 <sup>3</sup> / <sub>8</sub> " part length)
	2.KP61327	Lock Bar, Unit Ht. 59 <sup>5</sup> / <sub>32</sub> ", (57 <sup>7</sup> / <sub>8</sub> " part length)
	2.KP61328	Lock Bar, Unit Ht. 60 <sup>11</sup> / <sub>16</sub> ", (59 <sup>7</sup> / <sub>16</sub> " part length)
	2.KP61329	Lock Bar, Unit Ht. 62 <sup>7</sup> / <sub>32</sub> ", (60 <sup>15</sup> / <sub>16</sub> " part length)
	2.KP61330	Lock Bar, Unit Ht. 63 <sup>3</sup> / <sub>4</sub> ", (62 <sup>1</sup> / <sub>2</sub> " part length)
	2.KP61331	Lock Bar, Unit Ht. 65 <sup>9</sup> / <sub>32</sub> ", (64" part length)
	2.KP61332	Lock Bar, Unit Ht. 66 <sup>13</sup> / <sub>16</sub> ", (65 <sup>9</sup> / <sub>16</sub> " part length)
	2.KP61333	Lock Bar, Unit Ht. 68 <sup>11</sup> / <sub>32</sub> ", (67 <sup>1</sup> / <sub>16</sub> " part length)
	2.KP61334	Lock Bar, Unit Ht. 69 <sup>7</sup> / <sub>8</sub> ", (68 <sup>5</sup> / <sub>8</sub> " part length)
	2.KP61335	Lock Bar, Unit Ht. 71 <sup>13</sup> / <sub>32</sub> ", (70 <sup>1</sup> / <sub>8</sub> " part length)
	2.KP61336	Lock Bar, Unit Ht. 72 <sup>15</sup> / <sub>16</sub> ", (71 <sup>1</sup> / <sub>16</sub> " part length)
	2.KP61337	Lock Bar, Unit Ht. 74 <sup>15</sup> / <sub>32</sub> ", (73 <sup>3</sup> / <sub>16</sub> " part length)
	2.KP61338	Lock Bar, Unit Ht. 76", (74 <sup>3</sup> / <sub>4</sub> " part length)
	2.KP61339	Lock Bar, Unit Ht. 77 <sup>17</sup> / <sub>32</sub> ", (76 <sup>1</sup> / <sub>4</sub> " part length)