

# Power/Data Center

## Tools Required

- None

## Package Contents

- 1 Power/Data Center
- 2 Retainer Clips
- 2 Cord Clips (1 Cord Clip on Small Unit)

## Description

The power/data center rests snug in table tops that feature an appropriately machined cutout. It provides electrical and telecommunication access to users seated at the conference table. (Figure A)

**Note:** It is recommended that two (2) persons be used to lift and place power/data center into table top cutout.

## Installation

1. Unpack the power/data center. If needed, attach 2 retainer clips, one at each end on back of unit base. (Figure A).
- Note:** Make sure that no items were damaged during shipping.
2. Lift power/data center above table and run power cords through cutout. Holding parallel and level above cutout, carefully lower power/data center into table top. (Figure B).
  3. Use cord clips to retain any loose or hanging cords. (Figure C).
  4. Plug in units under table where necessary.

Figure A

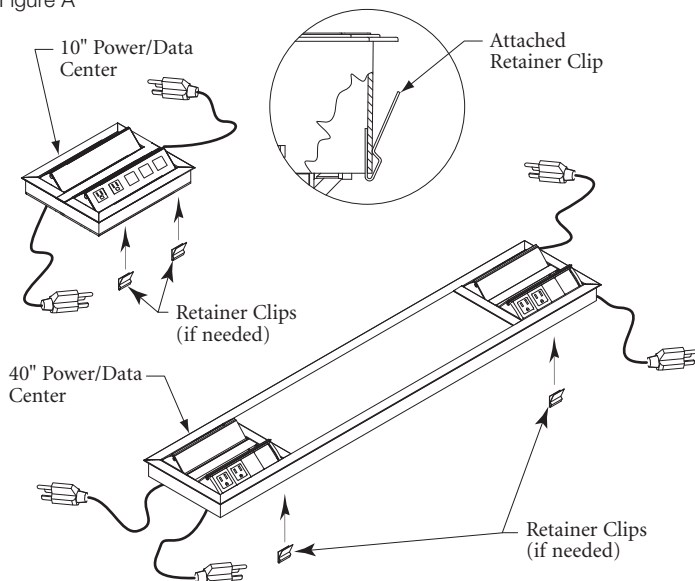

Figure B

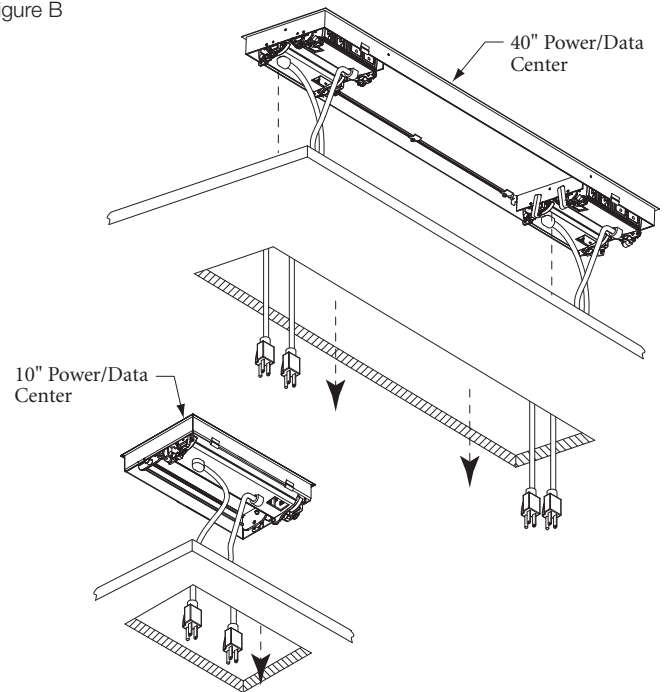
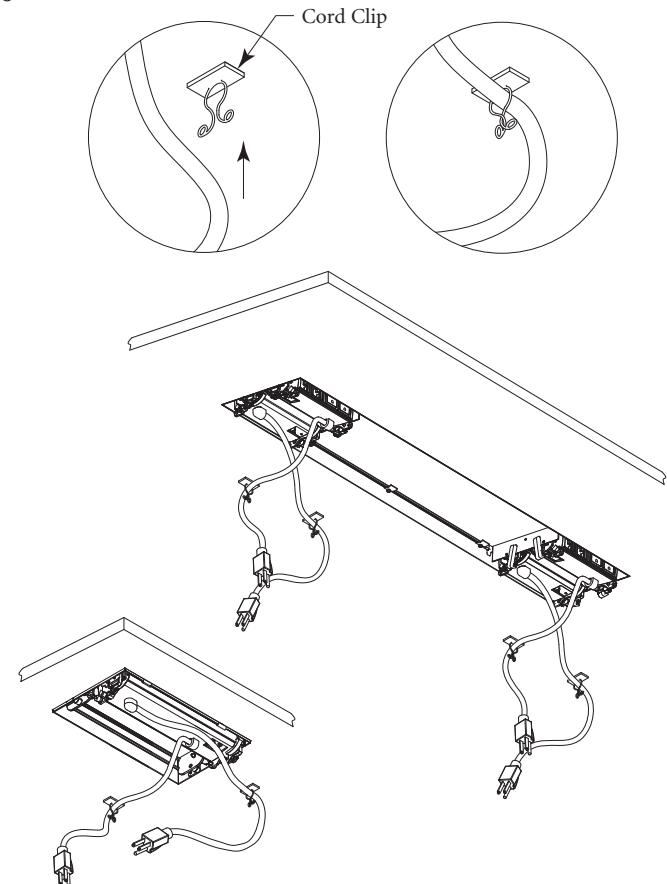

Figure C



Proper product installation, in accordance with these instructions, is the responsibility of the installing agent. If you have any questions concerning these instructions, please call Kimball Office Customer Service.

Kimball® Office