

If you have a problem, question, or request, call your local dealer, or Steelcase Line 1 at **888.STEELCASE** (888.783.3522) for immediate action by people who want to help you. (Outside the U.S.A., Canada, Mexico, Puerto Rico, and the U.S. Virgin Islands, call: 1.616.247.2500) Or visit our website: [www.steelcase.com](http://www.steelcase.com)

© 2014 Steelcase Inc.  
Grand Rapids, MI 49501  
U.S.A.  
Printed in U.S.A.

## Removal of the Seat

**1.** Locate the white quick release tab located on the left hand side of the chair (as you sit in it) between the plates.

**2.** Lift the quick release tab (2a) while lifting the seat slide lever (2b) and sliding the seat forward & off.

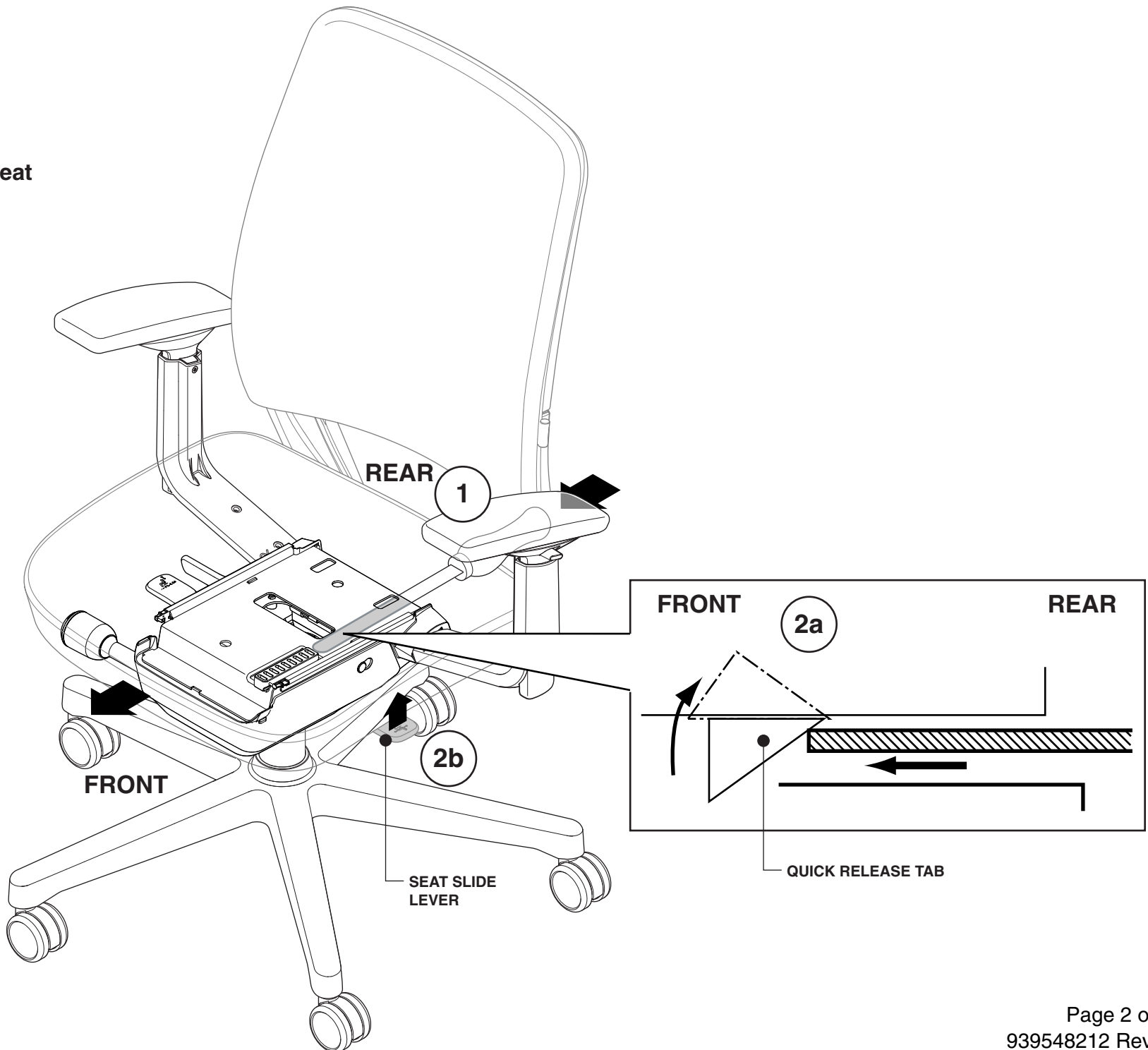

**3.** Feed pneumatic lever through hole in bottom plate (3a), over cylinder and into black plastic retainer (3b).

**4.** Insert set screw and adjust the pneumatic lever to have 1/4" of free vertical movement.

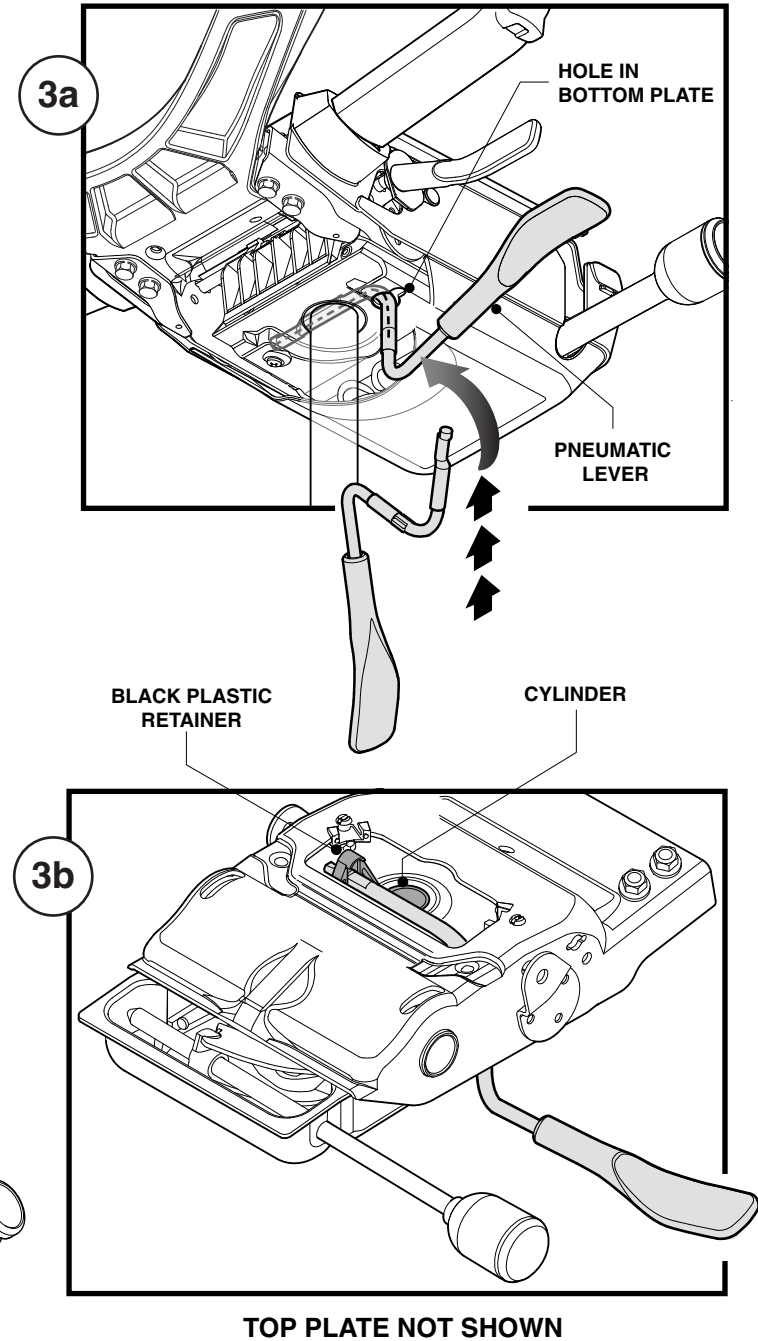
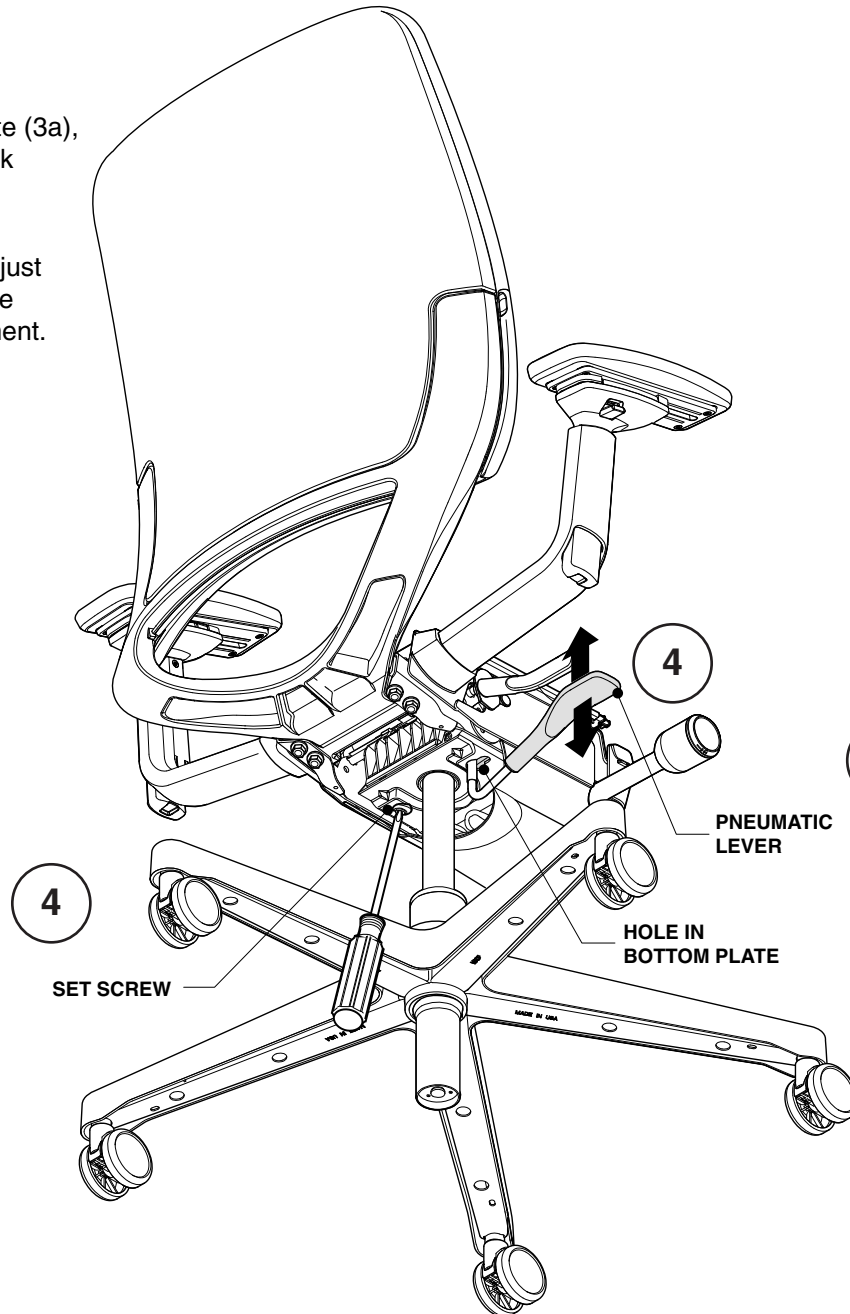

**5.** Align the seat with the chair control and engage the slots on the bottom of the seat with the tabs located on the seat bearings (5a). Slide seat fully backward while holding up on the seat slide lever (5b).

