

Disassembly Instructions

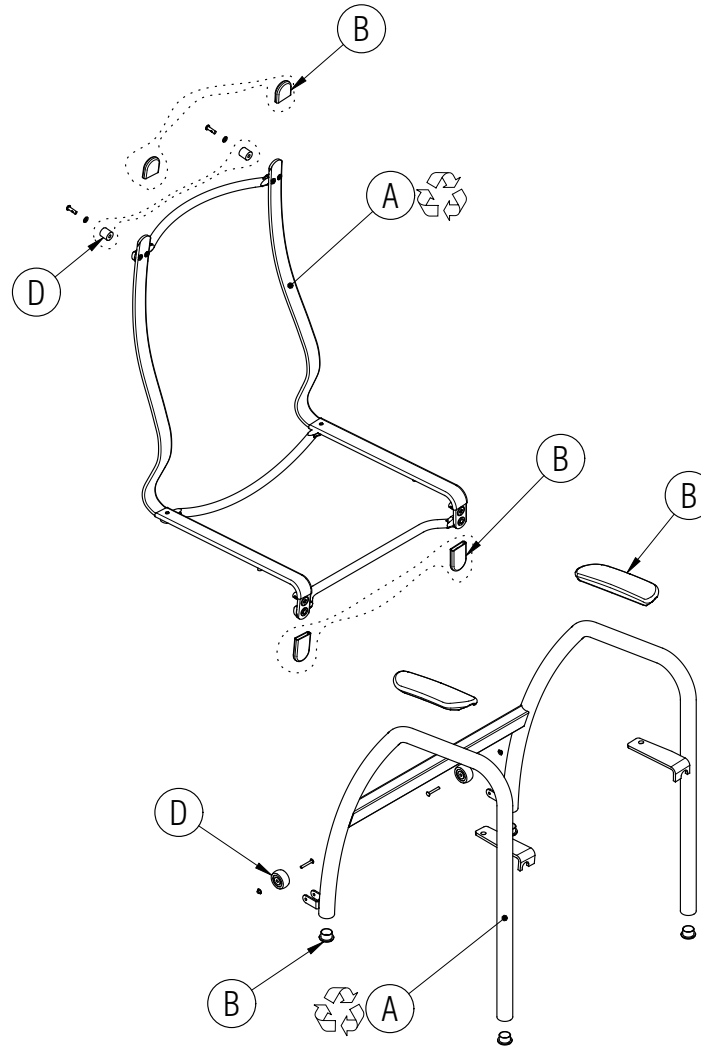

Rose Chair

Material Type: A . Steel B. Plastic C. Fabric D. Rubber

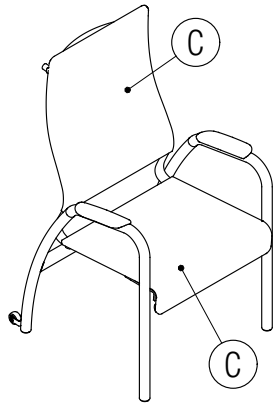

Procedure:

1. Cut the stitching holding the fabric to the frame and remove the fabric.
2. Remove the pins holding the casters onto the frame and remove the casters.
3. Pry out the glides from the frame.
4. Remove the arm caps, if applicable
5. Recycle the fasteners and steel frame, if applicable.
6. Discard the fabric, casters and glides, if applicable.

General Notes:

1. Disassembly time: 15-20 minutes
2. This procedure assumes basic familiarity with hand tools and furniture terminology: no specialized training is required
3. All materials removed and disassembled shall be sorted and segregated with like materials and disposed of or recycled according to recycling availability or waste acceptance
4. For items to be recycled, refer to KI's End of Life Recycling Matrix and KI's End of Life Recovery Options Matrix, available at www.ki.com

 All fasteners not explicitly tagged are Material Type A: Steel

Required Tools



Gloves



Safety Glasses

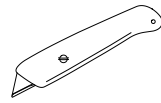

Utility Knife

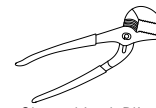

Channel Lock Pliers

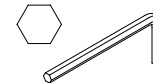

Allen Wrench

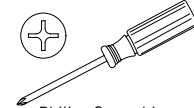

Philips Screwdriver