

# Parts Diagram

## Perry® Armless Stack Chair

Non-Ganging, Ganging, Polypropylene, Upholstered with and without Cushion

December 2017

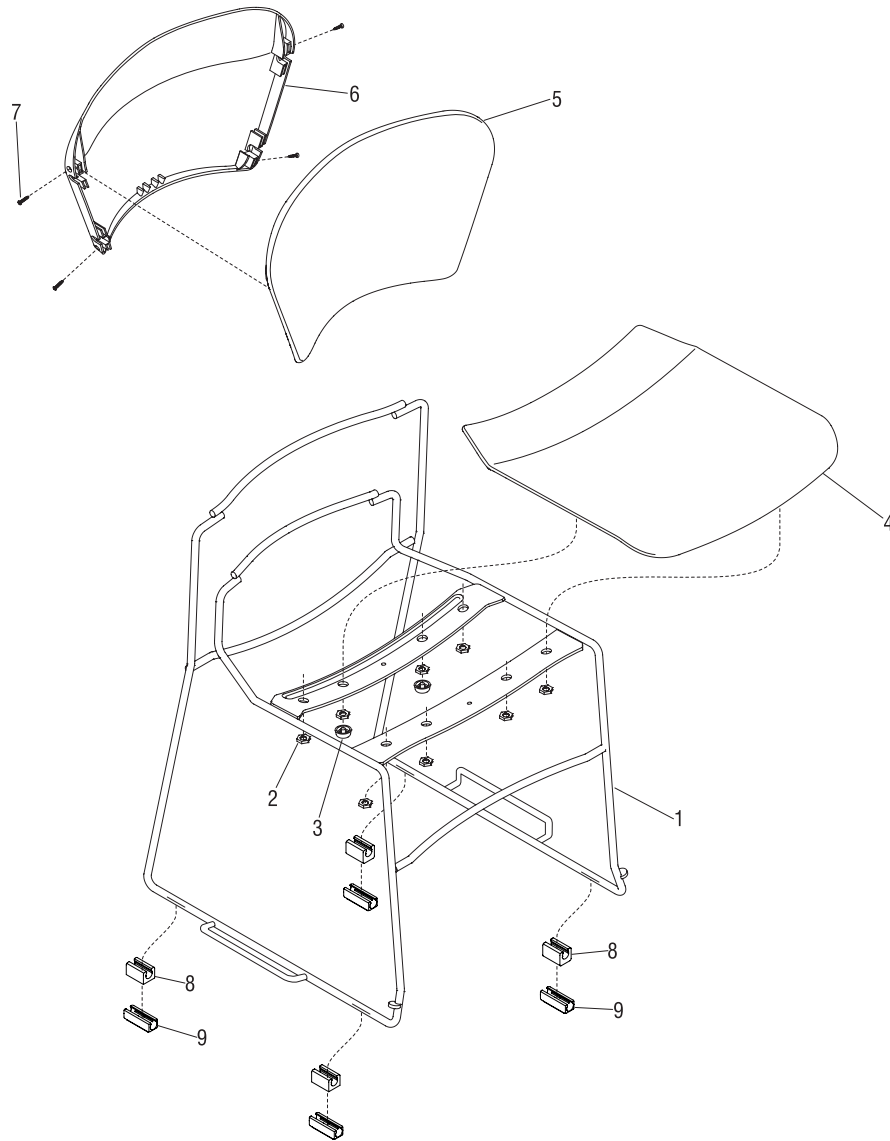

.X = KD  
.CC = Select Color

Item	Part Number	Description	Qty	Item	Part Number	Description	Qty
1	85.6032.CCX	Perry Chair Frame	1	5	85.5041.CCX	Seat Back, Perry Polypropylene	1
	85.6032.WCHX	Perry Chair Frame, Ganging	1		Special	Seat Back, Upholstered without Cushion	1
2	12.0710.X	Palnut, 1/2"	8		Special	Seat Back, Upholstered with Cushion	1
3	53.1128.X	Stack Bumper, Round	2	6	85.5040.CCX	Back Shroud, Perry	1
4	85.5042.CCX	Seat, Perry Polypropylene	1	7	12.0697.PRY.X	Screw, #6 x 7/8" Oval Head Sq Drive, Back Shroud	4
	Special	Seat, Upholstered without Cushion	1	8	46.3281.X	Glide, PVC Non-Skid (slot-style)	4
	Special	Seat, Upholstered with Cushion	1	9	46.3282.X	Glide, Polycarbonate (slot-style)	4
					46.3283.X	Glide, Stainless Steel (slot-style)	4