

Assembly Instructions

Intellect™ Chairs

August 2003

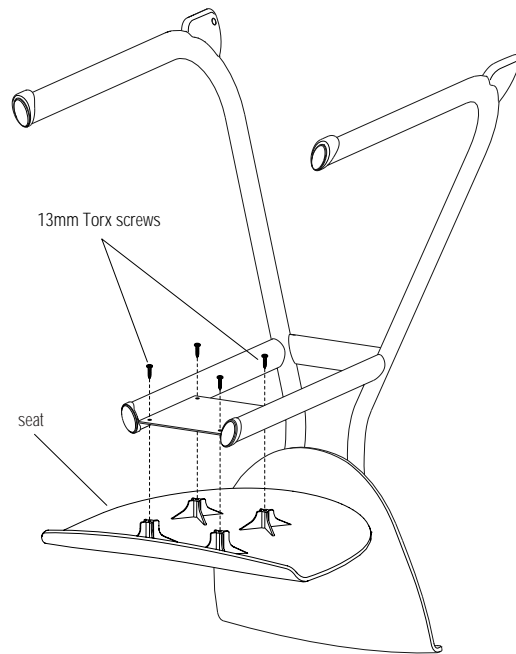

Figure 1

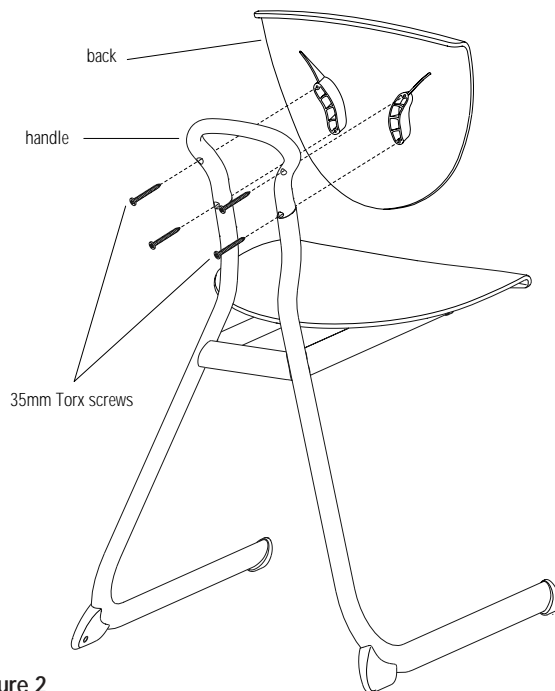

Figure 2

Note: Chairs are shipped assembled. Use the following instructions when a seat or back needs to be replaced.

Note: If a powered device is to be used to tighten the screws, start at the lowest torque setting and slowly increase the torque until the screws are snug against the frame. Damage to the plastic boss could result if the screws are over-tightened.

1. To remove an existing seat, carefully turn the chair upside down on a soft protective surface. Locate the four 13mm seat mounting screws and remove them with a Torx T20 drive (Figure 1).
2. To install a new seat, first position the seat in place over the mounting holes and loosely start each of the four 13mm Torx screws. Using a Torx T20 drive, carefully tighten each of the four screws (Figure 1).
3. To remove an existing back, first locate the four 35mm Torx screws which are recessed into the back of the handle. Remove the screws with a Torx T20 drive (Figure 2).
4. To install a new back, first position the back in place over the mounting holes and loosely start each of the four 35mm Torx screws. Using a Torx T20 drive, carefully tighten each of the four screws (Figure 2).

General Maintenance

Intellect seats, backs and desktops are one-piece injection molded ABS. The surfaces may be cleaned with most common cleaners and a rag or soft brush. Avoid using any solvent-based cleaners as they can react with the ABS and degrade the appearance and strength of the product.

