

Assembly Instructions ■

Activ8™ Electrical System

DataLink, InTandem & WorkZone

December 2013

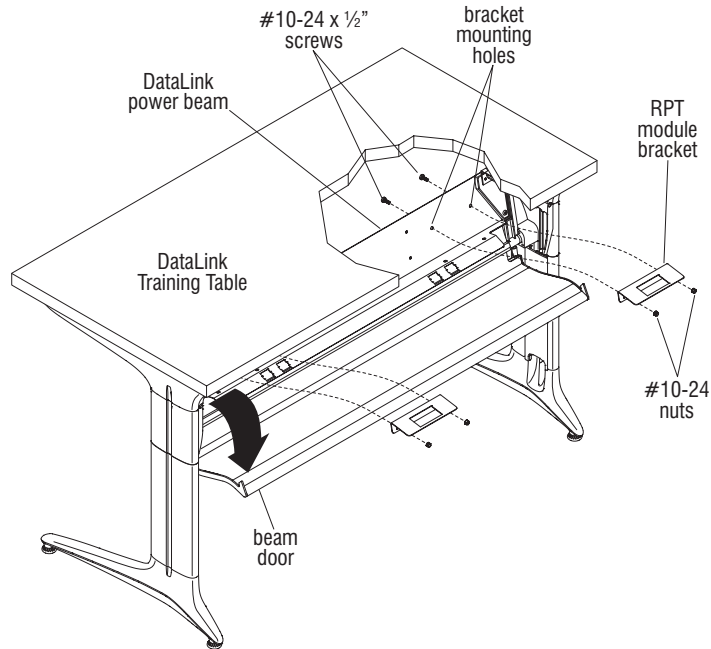

Figure 1 - DataLink Training Table

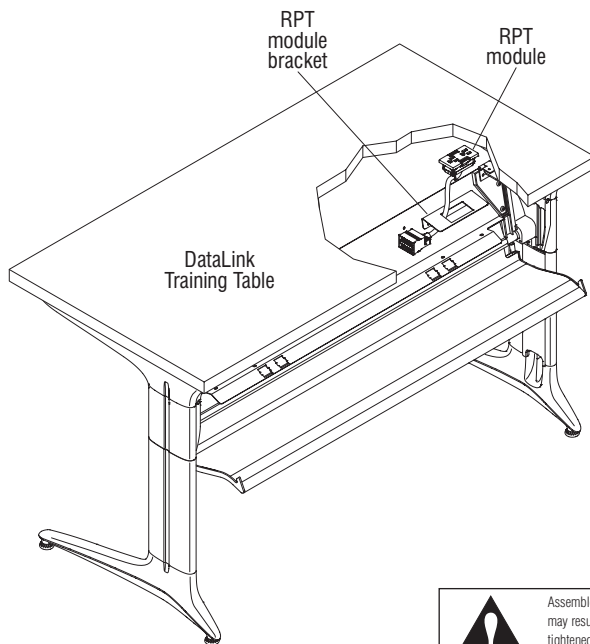

Figure 2 - DataLink Training Table



Assemble units as described herein only. To do otherwise may result in instability. All screws, nuts and bolts must be tightened securely and must be checked periodically after assembly. Failure to assemble properly, or to secure parts may result in assembly failure and personal injury.

Activ8 RPT Module to DataLink Training Table

Note: Refer to the DataLink Training Table System Assembly Instructions to assemble the legs, beam and the beam door.

1. Open the beam door at the rear of the table to expose the power beam and locate the two RPT module bracket mounting hole locations, one pair at each end of the beam as illustrated (Figure 1).

Note: Each table may have one or two RPT module brackets attached to it, one at each end.

2. Position the RPT module bracket up to the power beam as illustrated and use the #10-24 screws and nuts provided to secure the bracket to the beam (Figure 1).
3. Feed the connector end of the RPT module through the rectangular opening in the bracket and snap the module into place (Figure 2).



Assemble units as described herein only. To do otherwise may result in instability. All screws, nuts and bolts must be tightened securely and must be checked periodically after assembly. Failure to assemble properly, or to secure parts may result in assembly failure and personal injury.

Activ8 RPT Module to InTandem Table System

Note: Refer to the InTandem Table System Assembly Instructions to assemble the legs, beam and the beam door.

1. Open the inner plastic beam door at the inside, rear of the table to expose the upper power beam. Locate the two RPT module bracket mounting hole locations near the back-to-back receptacle covers. One pair of mounting holes is at each end of the beam as illustrated (Figure 3).

Note: Each table may have one or two RPT module brackets attached to it, one at each end.

2. Position the RPT module bracket up to the power beam as illustrated and use the #10 self-tapping Torx screws to secure the bracket to the beam (Figure 3).
3. Feed the connector end of the RPT module through the rectangular opening in the bracket as illustrated and snap the module into place (Figure 4).

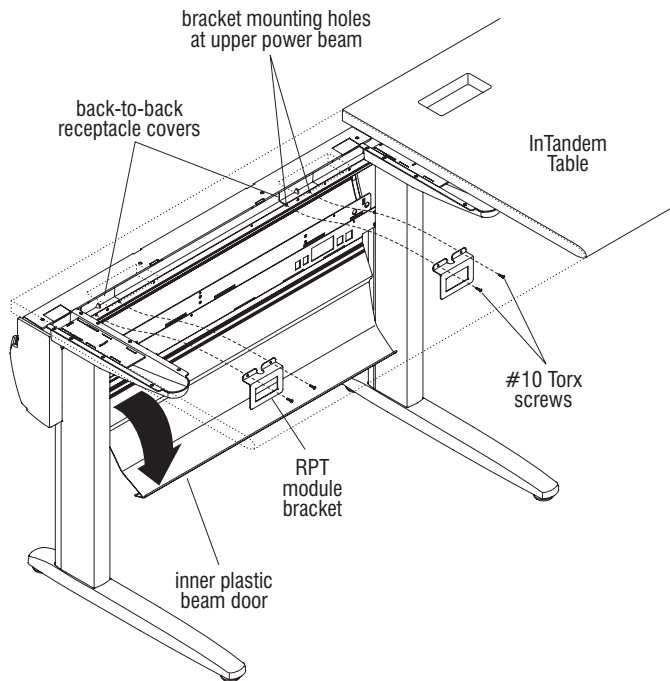

Figure 3 - InTandem Table System

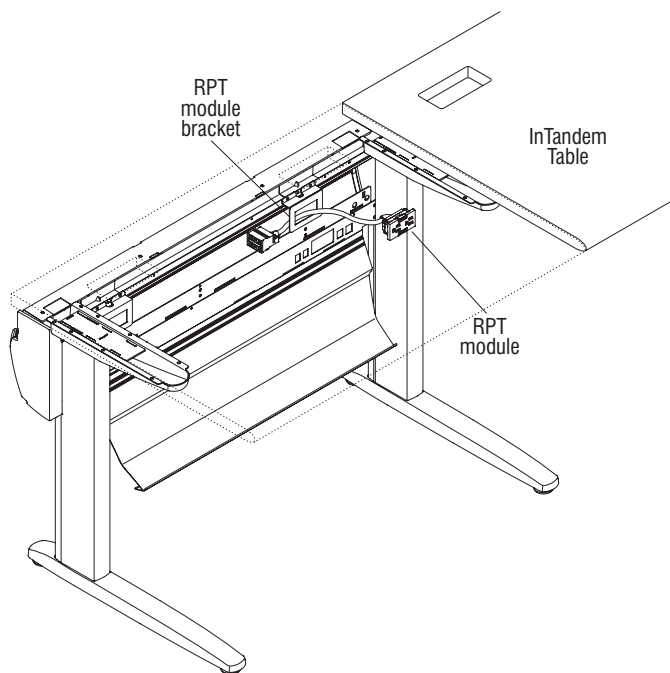

Figure 4 - InTandem Table System



Assemble units as described herein only. To do otherwise may result in instability. All screws, nuts and bolts must be tightened securely and must be checked periodically after assembly. Failure to assemble properly, or to secure parts may result in assembly failure and personal injury.

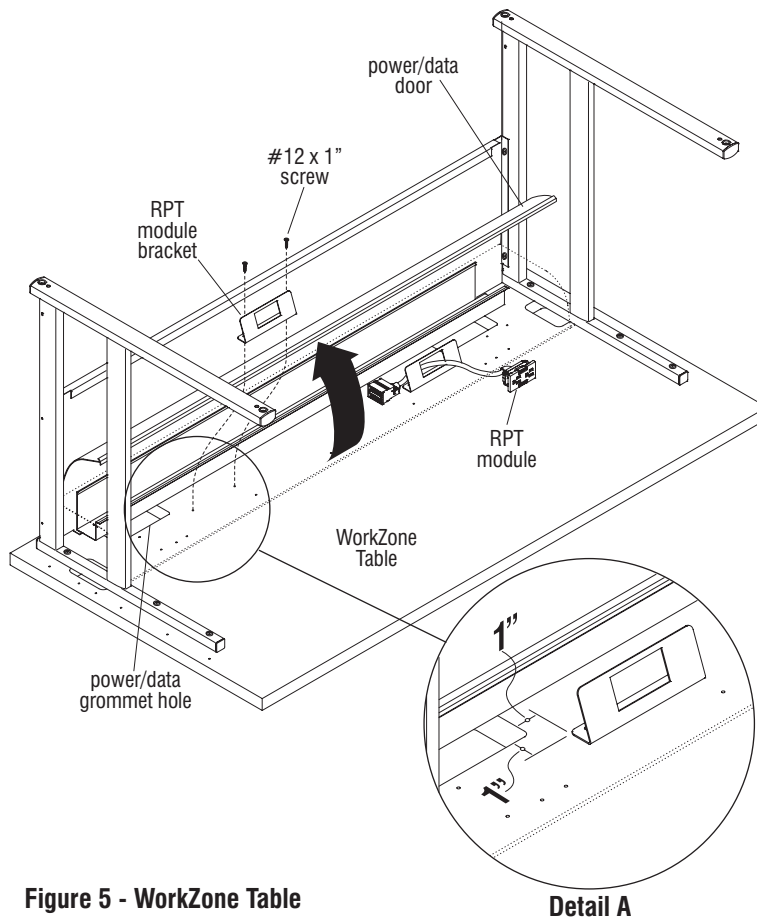

Figure 5 - WorkZone Table

Detail A

Activ8 RPT Module to WorkZone Table

Note: Refer to the WorkZone Desking System Assembly Instructions to assemble the worksurface, legs, modesty panels and the power/data door.

1. Open the power/data door under the table and locate mounting positions for the two RPT module brackets as illustrated. The module brackets must be located 1" away from any power/data grommet hole and mounted such that when the power/data door closes, there is no interference (Figure 5 & Detail A).
2. Using the two mounting holes of the RPT module brackets as a template, mark drilling locations to the underside of the table. Using a drill driver and 1/8" drill bit, with depth gauge set to 3/4", pre-drill two mounting holes at each marked location. Take care to not drill too deep as damage to the worksurface may occur.
3. Position the RPT module bracket over the holes and secure using two #12 x 1" screws (Figure 5).
4. Feed the connector end of the RPT module through the rectangular opening in the bracket and snap the module into place (Figure 5).



Assemble units as described herein only. To do otherwise may result in instability. All screws, nuts and bolts must be tightened securely and must be checked periodically after assembly. Failure to assemble properly, or to secure parts may result in assembly failure and personal injury.

WARNING: Assembly of all mechanical frame components must be completed before any electrical connections. All electrically connected furnishings must also be mechanically connected.

Activ8 Connections & Source Power

1. After the RPT module/bracket components are installed and tables are mechanically connected together, the remaining electrical devices may be installed per your space-planning layout.
2. PowerUp module (shown) or Villa power modules may be installed if specified. PowerUp module snaps into the worksurface at the top and Villa installs with screws from underneath. For Villa module installation, refer to instructions provided with the unit (Figure 6).
3. Jumper cables come in various sizes and connect Activ8 components between RPT modules, PowerUp & Villa modules and between tables. Jumper cables are keyed and can only be plugged in one way (Figure 6).

Warning: Never attach more than one power infeed to a chain of devices. Always check to be certain that the system is not already powered from another infeed before attaching an infeed.

4. Choose a location close to a power source outlet for the power infeed component. Plug the power infeed into an appropriate location in the Activ8 system only after all other components are installed. The NEMA 5-15P plug end of the power infeed may connect to a standard 100/120V wall outlet power source.

5. Once connected to a power source, verify that a green LED is lit on the power infeed enclosure. A green LED indicates that power is being supplied to the devices. If the LED is flashing red, verify that no other infeeds are attached to the system. If the LED is solid red, verify that there is no more than 8 devices plugged together, and that the total length of the system and all interconnecting cords (exclusive of the power infeed unit) does not exceed 40 feet, or 12 meters.

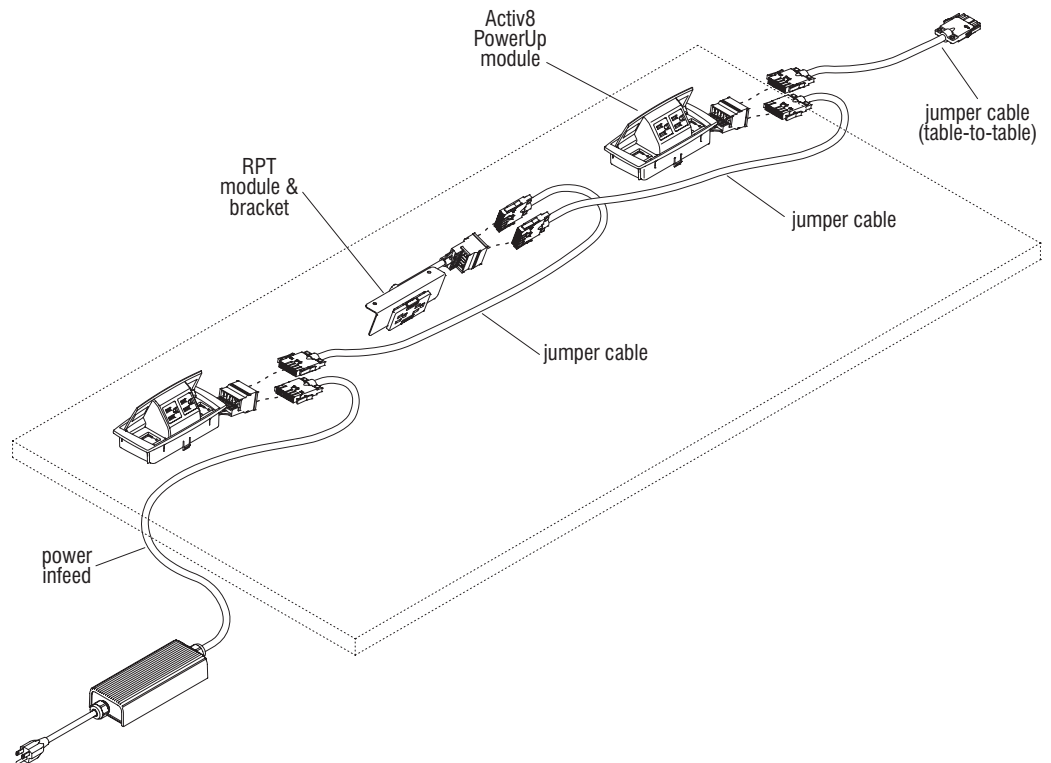

Figure 6 - Activ8 Power Components