

Disassembly Instructions

Affina, Arissa, Briar, Cody, Flex, Grand Salon, Jessa, Lido, Lola, Lyra,
Lounge Patient Seating: Mesa, Neena, Perth, Relax, Sela, Soltice, Soltice 7, Tea Cup, Three

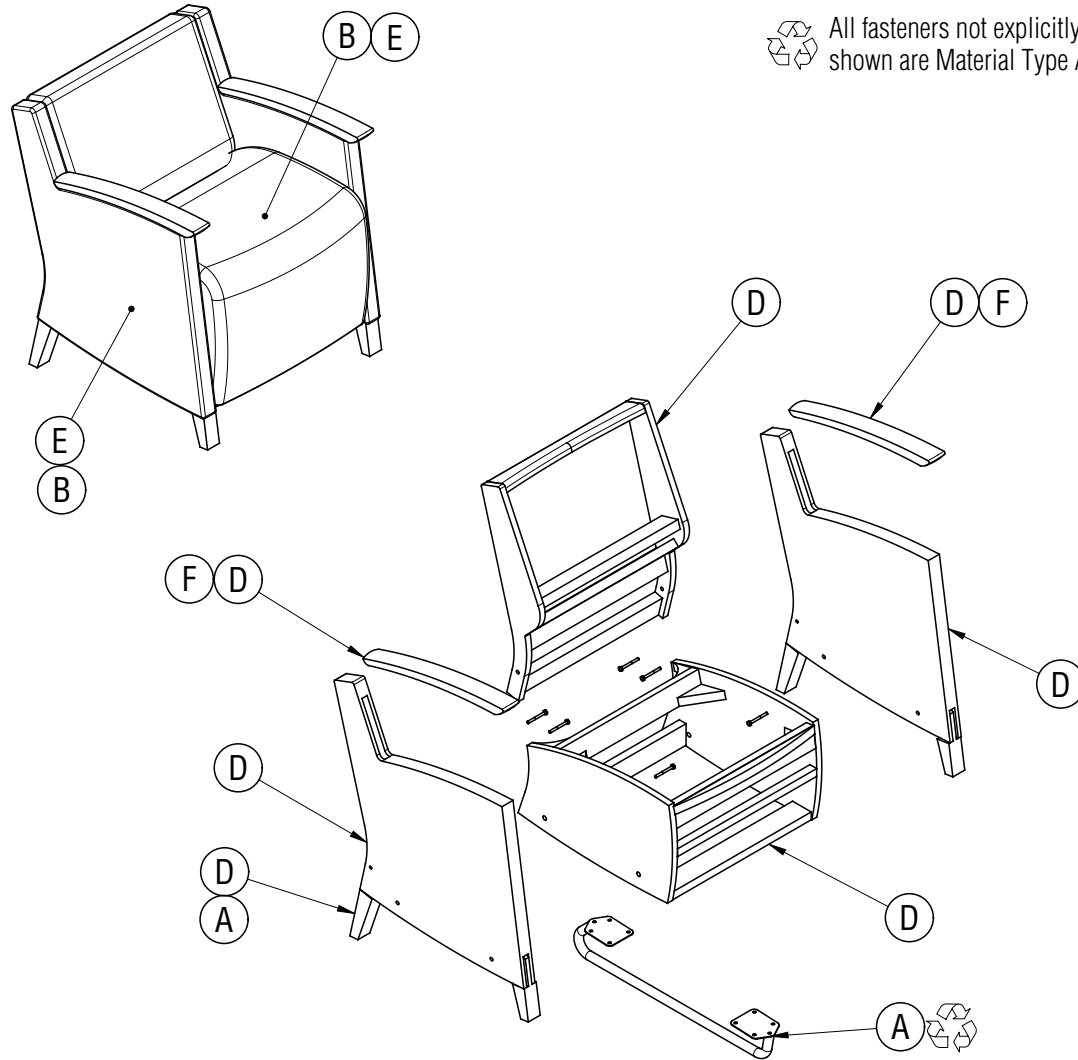

Material Type: A .Steel B. Foam C. Elastic Banding (not shown) D. Wood E. Fabric F. Coated Steel



All fasteners not explicitly tagged or shown are Material Type A: Steel

Procedure:

1. Remove armcaps.
2. Turn chair bottom up and cut away cloth covering.
3. Cut into fabric back to expose fasteners for back removal, top and bottom.
4. Remove all screws holding seat to arms. Remove alternate steel tube legs if product has them.
5. When arms are separated, cut away fabric and scrape thin foam from wood components.
6. Remove large seat and back foam by hand.
7. Cut seat and back elastic banding away from wooden frames.
8. Remove any steel brackets or braces .

General Notes:

1. Disassembly time: 20-30 minutes
2. This procedure assumes basic familiarity with hand tools and furniture terminology: no specialized training is required
3. All materials removed and disassembled shall be sorted and segregated with like materials and disposed of or recycled according to recycling availability or waste acceptance
4. For items to be recycled, refer to KI's End of Life Recycling Matrix and KI's End of Life Recovery Options Matrix, available at www.ki.com

Required Tools



Gloves



Safety Glasses

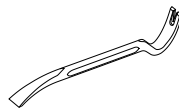

Pry Bar

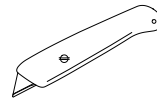

Utility Knife

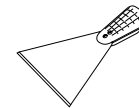

Putty Knife

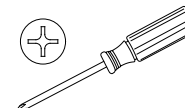

Phillips Screwdriver

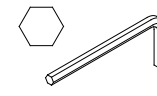

Allen Wrench

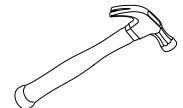

Claw Hammer