

# LAMP® INSTRUCTION MANUAL

## PUSH KNOB WITH LATCH (PKL-07) PAT.P

◀ Be sure to read prior to installation ▶

—MORTISE TYPE—

**Fig.1 Specifications**

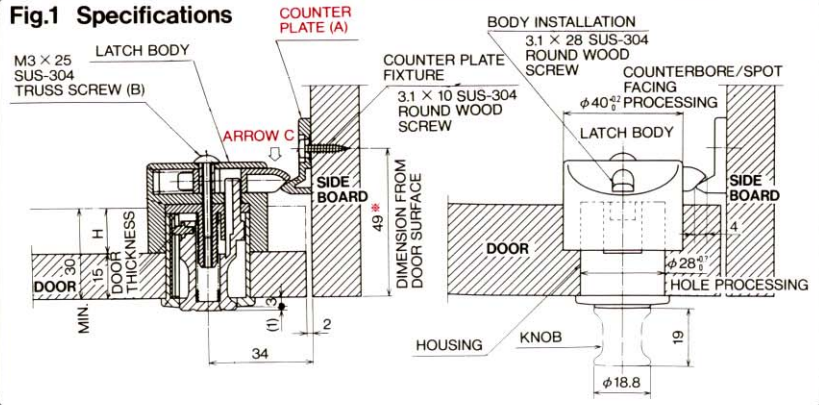

### INSTALLATION PROCEDURE

- Conduct hole processing in specified location on door. (Re: Fig.1 & 2).
- Push-in the PUSH KNOB into the hole from the door surface. Use attached screw B (M3×25) to stabilize. Attach two more installation screws (3.1×28) on two separate locations. (Re: Fig.1). Do not over-fasten screw B in particular. (Fasten just tightly enough to prevent any shaking or lashing. Fastening more strongly than necessary will be the cause of later damages).
- Install counter plate (A) in specified location with counter plate fixture screws (3.1×10). (Attach temporary in two long-holes). The attachment/installation dimensions marked by\* are lengths measured from the door surface, in case of inset door specifications as well as of outset door specifications. (Re: Fig.1).
- If the latching movement is poor after attachment/installation, move attachment position of the counter plate (A) towards the front (see: Arrow C). Remove the slight clearance between counter plate and latch. Confirm improvement in the movement of the latch. Tighten firmly the loosened counter plate fixture screws. (Re: Fig.1).

**Note 1.** Be sure to push the knob after the door has been closed. Mistake in this order may result in future damage.

**Note 2.** In correct installation and improper use of the product may cause damage to the product, and can also cause injury. This installation sheet should be kept by the user after installation.

### HOW TO USE

Close the door and push in the PUSH KNOB. Door will be latched and not be opened.

Another push on knob head will allow opening the door.

#### Feature:

- \* Non-handed. \* SUS-304 STAINLESS SCREWS
- \* Applicable for 15 – 30 mm thick inset as well as overlaid knob in one type.
- \* In case of thinner door, 2 mm (5/64") plastic distance plate (PKL-SP) is available at surcharge.
- \* After the door has been closed, pushing-in the knob activates and secures the latch so the door will not open until the knob is pushed again.

#### Caution:

- \* For the prevention of breakage or any other future damage, please do not push the knob in before closing the door.

**Fig.2 Installation hole processing**

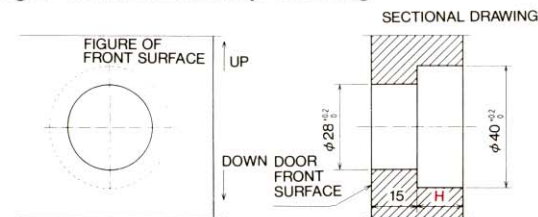

Art No	Door thickness (mm)	H: Counterbore/spot facing depth
PKL-07	15 – 30	H = Door thickness – 15 (Door back surface)
PKLSW (*)		
PKLB(*)		

Note: (\*) PKLSW & PKLB, latch body are separately sold.

Japan Head Office:  
**SUGATSUNE KOGYO CO. LTD.**  
 1-8-11, Higashikanda, Chiyodaku, Tokyo 101 Japan  
 Phone: 813-3866-2260 Fax: 813-3866-4447



U.S. Subsidiary:  
**SUGATSUNE AMERICA INC.**  
 221 East Selandia Lane, Carson, CA 90746 U.S.A.  
 Phone: 310-329-6373 Fax: 310-329-0819  
 Toll Free: 1-800-562-LAMP