

GLASS PIVOT HINGE (INSET)

XL-GC04

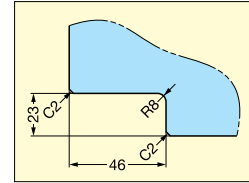

- Inset-type hinge for glass cabinet.
- Sold as a pair (top/bottom).
- Compatible with glass door lock XL-GC02 and bracket XL-GC05 (both sold separately).
- Door Size: Max. W500 × H1200 × t8 mm (W19-11/16" × H47-1/4" × t5/16")

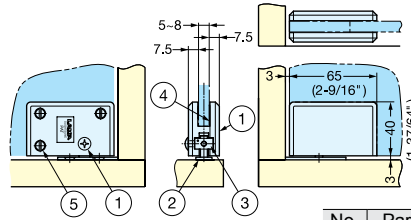

Cut Out Dimension

No.	Part Name	Material	Finish/Color
①	Body	Zinc Alloy	Chrome
②	Bottom Plate	Steel	Chrome
③	Plate	304 Stainless Steel	Plain
④	Spacer	PVC	Black
⑤	Screws	304 Stainless Steel	Plain

Item No.	Glass Thickness (mm)	Load Capacity (kg)	Weight (g)	Box (pairs)	Carton (pairs)
XL-GC04-C	5-8	12 (26.5 lbs)/Door	560	1	24

GLASS BRACKET

XL-GC05



- Bracket for hinge XL-GC04 (sold separately).
- For use when top panel is glass.

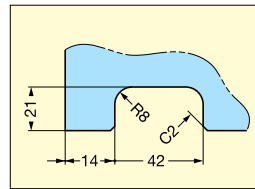
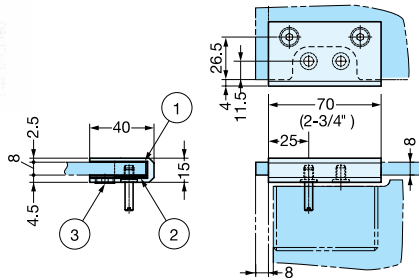

Cut Out Dimension (Top Panel)

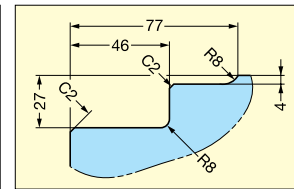

Cut Out Dimension (Glass Door)

No.	Part Name	Material	Finish/Color
①	Bracket	Zinc Alloy	Chrome
②	Spacer	Synthetic Rubber	Clear
③	Screws	304 Stainless Steel	Plain

Item No.	Type	Glass Thickness (mm)	Weight (g)	Box (pcs)	Carton (pcs)
XL-GC05-R-C	Right	8	174	1	24
XL-GC05-L-C	Left				

GLASS HINGE (OVERLAY, W/CATCH)

XL-GC07



- 10 mm (3/8") Overlay hinge with catch for glass cabinetry.
- Door Size: Max. W500 × H1200 × t8 mm (W19-11/16" × H47-1/4" × t5/16")
- Not for use with lock XL-GC02.

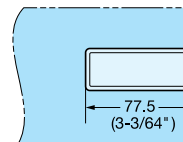
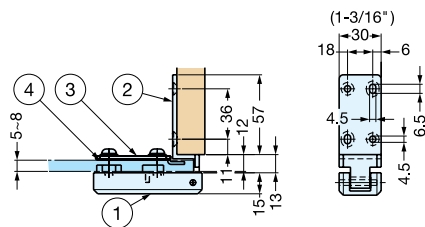

Cut Out Dimension

No.	Part Name	Material	Finish/Color
①	Body	Zinc Alloy	Chrome
②	Hinge Plate		Chrome
③	Backplate	Steel	Chrome
④	Spacer	Synthetic Rubber	Black

Item No.	Glass Thickness (mm)	Load Capacity (kg)	Weight (g)	Box (pcs)	Carton (pcs)
XL-GC07-C	5-8	12 (26.5 lbs)/Door	301	1	24