



GSA prices effective April 2, 2018
(based on February 6, 2017, commercial price list)
Published June 2018

Storage Systems

Tu® Wood Storage

**General Services Administration
Federal Supply Service
Authorized Federal Supply Schedule Price List**

Online access to contract ordering information, terms and conditions, up-to-date pricing, and the option to create an electronic delivery order is available through GSA Advantage!®, a menu-driven database system. The Internet address for GSA Advantage! is www.gsaadvantage.gov.

Office Furniture
FSC Group 71, Part 1
Contract Number: GS-03F-036DA
Contract Period: December 21, 2015—December 20, 2020

Herman Miller, Inc.
855 East Main Avenue
Zeeland, Michigan 49464
(616) 654 3000 Phone
(616) 654 8278 Fax
www.HermanMiller.com/government

Business Size: Large

Contract Information

1a. Special Item Numbers (SIN)

SIN 71-1
Packaged Offices

SIN 711-1
Furniture Systems

SIN 711-2
Computer Furniture

SIN 711-3
Filing and Storage Cabinets

SIN 711-11
Tables and Accessories

SIN 711-16
Upholstered Seating

SIN 711-18
Multi-Purpose Seating

SIN 711-91
Project Management

Services under this SIN may be used only in conjunction with the purchase of new furniture. Please contact your local Herman Miller representative to discuss the available labor categories (listed below). The hourly rates listed are "Not To Exceed" or "NTE" values.

Furniture Project Manager: \$64.75 per hour
Furniture Project Coordinator: \$49.00 per hour
Build-Out Project Manager: \$80.00 per hour

SIN 711-93
Reconfiguration and Relocation Services

Reconfiguration and Relocation Services will be provided by Herman Miller, Inc., or its participating dealer based on a fee not to exceed \$55 per hour, which applies to services totaling \$150,000 (per SIN) and below only. Services above \$150,000 shall be negotiated on a case-by-case basis. This SIN may only be used with the purchase of new product under SIN 711-1.

See * Additional Notes for Installation & Reconfiguration and Relocation Services.

SIN 711-94
Design/Layout

Design service will be provided by Herman Miller, Inc., or its participating dealer based on a fee not to exceed \$65 per hour.

SIN 711-95

Installation Services

Installation Services will be provided by Herman Miller, Inc., or its participating dealer based on a fee not to exceed \$55 per hour (\$82.50 per hour for after-hours Installation), which applies to services totaling \$150,000 (per SIN) and below only. Services above \$150,000 shall be negotiated on a case-by-case basis.

See * Additional Notes for Installation & Reconfiguration and Relocation Services.

* Additional Notes for Installation & Reconfiguration and Relocation Services:

FOB Destination (Drop Ship): Price includes product delivery to the site, brought to the tailgate of the truck. The purchaser is responsible for unloading.

Prices effective up to the maximum order by SIN only. Above the MO, pricing shall be negotiated on a case-by-case basis between the client and local dealer.

Standard Services are Subject to the Following Conditions:

Installation will be performed during normal weekday working hours.

Adequate facilities for delivery, unloading, moving and staging/ storing the product during the installation process shall be provided.

Service work will not be hindered by other trades.

Electric, heat, and adequate elevator service will be furnished without charge.

The immediate installation area shall be complete and free of debris including the carpet/flooring before installation commences.

Any work requiring a licensed electrician is the responsibility of the buyer.

Additional Charges May Apply For:

Major Metro Markets and any non-ground floor installation.

Major Metro Markets include large population centers and urban environments.

Installation in a clinical/medical environment.

Special restrictions or limits established by local laws, ordinances or the directions of the buyer, including but not limited to restrictions on transportations of materials, street access to the job site and/or dock facilities.

Installations outside of a 50 mile radius of the servicing dealer.

Local Prevailing Wage and/or Union Labor Rates.

Any additional charges shall be quoted by the dealer and approved by the buyer prior to performance of the work.

SIN 711-96

Leasing

Contact Herman Miller participating government dealer for current leasing information.

SIN 711-99

New Product Introductions

Contract Information

continued

1b. Lowest Priced Model

SIN 711-1:	G9999.B	\$7
SIN 711-2:	6-5-D	\$35
SIN 711-3:	9M10018	\$14
SIN 711-11:	DT9A.	\$36
SIN 711-16:	OA401	\$41
SIN 711-18:	AS90598	\$46
SIN 711-99:	R1366	\$27

1c. Not applicable

2. Maximum Order

SIN 711-1, SIN 711-2
\$500,000 net product value

SIN 711-3, SIN 711-11
\$300,000 net product value

SIN 711-16, SIN 711-18
\$200,000 net product value

SIN 711-93
\$150,000

SIN 711-94
\$150,000

SIN 711-95
\$150,000

SIN 711-96
\$500,000 net product value

SIN 711-99
\$50,000 net product value

3. Minimum Order

\$100 net

4. Geographic Coverage

Continental U.S.

Orders for Alaska, Hawaii, and Puerto Rico will be shipped F.O.B. inland carrier point of exportation.

5. Point of Production

Zeeland, Ottawa County, Michigan
Spring Lake, Ottawa County, Michigan

6. Pricing

Prices shown are list. Discounts include Industrial Funding Fee.

SIN 711-1

Product: Selected Action Office 1, Action Office 2, C-Style Overhead Storage, Ethospace System, Quadrant Pedestals, Supplemental Products, Tu Pedestals and Pedastools, and approved Herman Miller Options Products.

Standard Lead Time	Single Order Net Purchase	Discount From list
	\$100 - 250,000	73.8%
	\$250,001 - 500,000	76.8%

SIN 711-1

Product: Selected Renew™ Tables, Renew Link and approved Herman Miller Options Products

Standard Lead Time	Single Order Net Purchase	Discount From List
	\$100 - 500,000	72.8%

SIN 711-1

Product: Selected Motia™ Tables, and approved Herman Miller Options Products

Standard Lead Time	Single Order Net Purchase	Discount From List
	\$100 - 500,000	73.8%

SIN 711-1

Product: Tu Wood Pedestals and approved Herman Miller Options Products

Standard Lead Time	Single Order Net Purchase	Discount From List
	\$100 - 300,000	74.3%

SIN 711-1

Product: Selected Canvas Office Landscape and approved Herman Miller Options Products

Standard Lead Time	Single Order Net Purchase	Discount From List
	\$100 - 500,000	74.8%

SIN 711-1

Product: Selected Layout Studio® and approved Herman Miller Options Products

Standard Lead Time	Single Order Net Purchase	Discount From List
	\$100 - 500,000	60.7%

SIN 711-1

Product: Selected Meridian Pedestals, Meridian Pedastools, and approved Herman Miller Options Products

Standard Lead Time	Single Order Net Purchase	Discount From List
	\$100 - 500,000	64.2%

Contract Information

continued

SIN 711-1

Product: Selected Thrive Portfolio and approved Herman Miller Options Products

Standard Lead Time	Single Order Net Purchase	Discount From List
	\$100 - 250,000	62%
	\$250,001 - 500,000	66.4%

SIN 711-2

Product: Passage Desking System and approved Herman Miller Options Products

Standard Lead Time	Single Order Net Purchase	Discount From List
	\$100 - 500,000	56.7%

SIN 711-2

Product: 5000 Series Furniture and approved Herman Miller Options Products

Standard Lead Time	Single Order Net Purchase	Discount From List
	\$100 - 500,000	58.7%

SIN 711-3

Product: Meridian Laterals, Verticals, Towers, and Storage products and approved Herman Miller Options Products

Standard Lead Time	Single Order Net Purchase	Discount From List Laterals	Verticals	Towers & Storage
	\$100 - 300,000	67.3%	66.3%	62.7%

SIN 711-3

Product: Tu Lateral Files, Tu Storage, Tu Towers, Tu Wood Cases, Tu Wood Cubbies, Tu Wood Credenzas, Tu Wood Towers, and approved Herman Miller Options Products

Standard Lead Time	Single Order Net Purchase	Discount From List
	\$100 - 300,000	74.3%

SIN 711-11

Product: Selected Tables and Accessories and approved Herman Miller Options Products

Standard Lead Time	Single Order Net Purchase	Discount From List
Avive® Tables	\$100 - 250,000	72.8%
	\$250,001 - 500,000	74.8%
Herman Miller Eames® Tables	\$100 - 250,000	73.6%
	\$250,001 - 300,000	77.6%
Everywhere™ Tables	\$100 - 300,000	72.8%

SIN 711-16

Product: Swoop upholstered seating products and approved Herman Miller Options Products

Standard Lead Time	Single Order Net Purchase	Discount From List
Swoop™	\$100 - 200,000	60.7%

SIN 711-18

Product: Selected Seating and approved Herman Miller Options Products

Standard Lead Time	Single Order Net Purchase	Discount From List
Aeron® (Classic and New)	\$100 - 200,000	64.5%
Aside®	\$100 - 200,000	64.2%
Caper®	\$100 - 200,000	61.5%
Celle®	\$100 - 200,000	59.7%
Embody®	\$100 - 200,000	59.7%
Equa 2®	\$100 - 200,000	65.8%
Ergon 3®	\$100 - 200,000	68.8%
Keyn	\$100 - 200,000	57.7%
Mirra® 2	\$100 - 200,000	61.7%
Setu®	\$100 - 200,000	59.7%
Sayl®	\$100 - 200,000	62.2%
Verus™	\$100 - 200,000	63.7%

SIN 711-99

Product: Selected Exclave™, Locale®, Public Office Landscape®, Resolve® System, and approved Herman Miller Options Products

Standard Lead Time	Single Order Net Purchase	Discount From List
Exclave	\$100 - 50,000	61.7%
Locale	\$100 - 50,000	63.7%
Public Office Landscape	\$100 - 50,000	61.7%
Resolve System	\$100 - 50,000	69.8%
Intent Solution	\$100 - 50,000	58.7%

7. Quantity Discounts

Reference item #6.

8. Payment Term

Net 30 days

9. Government Commercial Credit Card

- Government commercial credit cards are accepted below the micropurchase threshold.
- Government commercial credit cards are accepted above the micropurchase threshold.

10. Foreign Items

None

11. Time of Delivery

- 90 day ARO
- Expedited delivery: Items listed in the 10-Day section of the catalogs are available for expedited delivery.
- Overnight/2-day delivery: Select items may be available for overnight or 2-day delivery. Contact Herman Miller or a participating dealer for availability and rates.
- Urgent requirements: Agencies may contact contractor or participating dealer to request faster delivery.

Contract Information

continued

12. F.O.B.

F.O.B. destination except Alaska, Hawaii, and Puerto Rico, which will be shipped F.O.B. inland carrier point of exportation.

13. Ordering Address

- a. Herman Miller, Inc.,
Government Customer Care 0161
855 East Main Avenue
Zeeland MI 49464.
- b. For supplies and services, the ordering procedures information on Blanket Purchase Agreements (BPA's) and a sample BPA can be found at the GSA/FSS Schedule homepage (www.fss.gsa.gov/schedules).

14. Payment Address.

Herman Miller, Inc.
22764 Network Place
Chicago, IL 60673-1227

15. Warranty

Herman Miller, Inc., commercial warranty applies.

16. Export Packing Charge

Prices supplied on request.

17. Terms and Conditions of Government Purchase Card Acceptance

(any thresholds above the micropurchase level)
None.

18. Rental Maintenance and Repair Terms

Not applicable

19. Terms and Conditions of Installation

Installation Services will be provided by Herman Miller, Inc., or its participating dealer based on a fee not to exceed \$55 per hour (\$82.50 per hour for after-hours Installation), which applies to services totaling \$150,000 (per SIN) and below only. Services above \$150,000 shall be negotiated on a case-by-case basis.

Additional Notes for Installation & Reconfiguration and Relocation Services:

FOB Destination (Drop Ship): Price includes product delivery to the site, brought to the tailgate of the truck. The purchaser is responsible for unloading.

Prices effective up to the maximum order by SIN only. Above the MO, pricing shall be negotiated on a case-by-case basis between the client and local dealer.

Standard Services are Subject to the Following Conditions:

Installation will be performed during normal weekday working hours.

Adequate facilities for delivery, unloading, moving and staging/storing the product during the installation process shall be provided.

Service work will not be hindered by other trades.

Electric, heat, and adequate elevator service will be furnished without charge.

The immediate installation area shall be complete and free of debris including the carpet/flooring before installation commences.

Any work requiring a licensed electrician is the responsibility of the buyer.

Additional Charges May Apply For:

Major Metro Markets and any non-ground floor installation.

Major Metro Markets include large population centers and urban environments.

Installation in a clinical/medical environment.

Special restrictions or limits established by local laws, ordinances or the directions of the buyer, including but not limited to restrictions on transportations of materials, street access to the job site and/or dock facilities.

Installations outside of a 50 mile radius of the servicing dealer.

Local Prevailing Wage and/or Union Labor Rates.

Any additional charges shall be quoted by the dealer and approved by the buyer prior to performance of the work.

20. Terms and Conditions of Repair Parts

Not applicable

21. Service and Distribution Points

For service and distribution points nearest you, call (800) 851 1196.

22. Participating Dealers

Access Herman Miller web site for current list of participating dealers: www.HermanMiller.com/government.

23. Preventive Maintenance

Not applicable

24a. Special Attributes.

2018

For the 11th consecutive year, Herman Miller received a perfect score on the Corporate Equality Index and we were designated as Best Place to Work for LGBT equality. This report evaluates U.S. companies in terms of diversity, particularly their LGBT-related policies and practices.

Contract Information

continued

2017

Herman Miller was named the 2017 “Corporation of the Year” in the consumer products sector by the Michigan Minority Supplier Development Council (MMSDC).

Herman Miller has received a 2017 SEAL (Sustainability, Environmental Achievement and Leadership) Business Sustainability Award.

Herman Miller has earned the 4 Star Diversity Visionary Award. This award celebrates the diversity, equality, and inclusion work of Herman Miller. The award is presented at the annual Diversity Equity Inclusion Summit, held by the Grand Rapids Area Chamber of Commerce.

Herman Miller named one of the Best and Brightest in Wellness for the fifth year in a row.

Working Mother magazine has recognized Herman Miller as one of the 2017 Working Mother 100 Best Companies.

Herman Miller earned our tenth consecutive perfect score in Human Rights Campaign (HRC) Foundation’s 2017 Corporate Equality Index.

As one of the top-scoring companies in our industry for the thirteenth consecutive year, Herman Miller has qualified for inclusion in RobecoSAM’s 2017 Sustainability Yearbook and received the Bronze Class distinction for our excellent economic, environmental, and social sustainability performance.

Herman Miller has once again earned the WorldatWork Seal of Distinction, a unique standard of excellence in work-life effectiveness that shows we provide a distinct, mutually beneficial workplace experience.

2016

Herman Miller was recognized as the Business of the Year at the Annual Meeting of the West Michigan Environmental Action Council (WMEAC). This award goes to the business with the greatest depth and breadth of support, unwavering dedication to environmental action in West Michigan, and a strong corporate commitment to environmental advocacy.

The 101 Best and Brightest Sustainable Companies once again (fifth consecutive year) recognized Herman Miller as an organization in Michigan (and for the first time, in the nation) that exhibits leadership and innovation in its approach to sustainability.

Herman Miller has been recognized by the Michigan Minority Supplier Development Council (MMSDC), as a “Corporation of the Year”, and we also received a “2016 Excellence in Supplier Diversity Award” from the Great Lakes Women’s Business Council. Additionally, we are the only West Michigan company this year to receive an “Ambassadors Championing Excellence” Award from the MMSDC.

Plex Lounge Furniture from Herman Miller receives #MetropolisLikes award at NeoCon 2016.

Plex Lounge Furniture from Herman Miller receives Interior Design HiP Award for Workplace Seating/Lounge at NeoCon 2016.

Spot Stools from Herman Miller Collection receive Interior Design HiP Award for Hospitality Seating at NeoCon 2016.

Herman Miller has been named a 2020 Women on Boards Winning Company. Companies selected for this recognition are considered champions of board diversity as 20 percent or more of their board seats are occupied by women.

Herman Miller selected for inclusion in the 2016 RobecoSAM Sustainability Yearbook for twelfth consecutive year.

Herman Miller again earns the WorldatWork Work-Life 2016 Seal of Distinction. This award identifies organizations that focus on programs that promote work-life balance and overall well-being.

2015

Herman Miller earns ninth consecutive perfect score in Human Rights Campaign (HRC) Foundation’s 2016 Corporate Equality Index and we were designated as Best Place to Work for LGBT equality.

This is the fourth consecutive year that Herman Miller was named one of Michigan’s Best and Brightest Sustainable Companies.

Herman Miller has received the Best and Brightest in Wellness Award for the third year in a row. This program is an innovative initiative that recognizes and celebrates quality and excellence in health awareness.

Herman Miller received the Forest Stewardship Council (FSC) Leadership Award for longstanding commitment to manufacturing with wood sourced from responsibly managed forests, which reduces environmental impacts by protecting against deforestation and forest degradation.

Herman Miller accepted its second Excellence in Reusable Packaging Award from the Reusable Packaging Association.

Herman Miller has once again been recognized for its commitment to best-in-class economic, environmental, and societal sustainability, earning a spot on the prestigious Dow Jones Sustainability Index (DJSI) for the twelfth consecutive year. We are the only contract furniture company recognized globally for its corporate sustainability leadership.

Herman Miller selected for inclusion in the 2015 RobecoSAM Sustainability Yearbook; awarded Bronze Class distinction for excellent sustainability performance for the second consecutive year.

Contract Information

continued

Herman Miller received a Michigan Business Pollution Prevention (MBP₃) Certificate – a recognition given by the Michigan Department of Environmental Quality (MDEQ) to organizations committed to environmental stewardship, conservation, and sustainable operations. This basic partnership with the MDEQ, which we've maintained since 1998, makes us eligible for our Clean Corporate Citizen (CCC) status that began in 2004 and our Environmental Leader status, which we received for the first time this past year.

MedAssets named Herman Miller Healthcare as Platinum Suppliers. MedAssets, a large group purchasing organization, helps providers enhance operational and financial performance so they can sustainably serve the needs of their community.

Herman Miller honored with five of 20 spots for the Michigan Environmental Leaders Award by the Michigan Department of Environmental Quality for our outstanding, voluntary environmental stewardship.

Renew Sit-to-Stand tables recognized on Record Products 2014 list by Architectural Record.

Herman Miller was again awarded a perfect score in the 2015 Corporate Equality Index. This is the eighth consecutive year we received a perfect score.

2014

Herman Miller has received the Best and Brightest in Wellness Award for the second year in a row. This program is an innovative initiative that recognizes and celebrates quality and excellence in health awareness.

Herman Miller's Locale wins International Design Excellence Awards (IDEA) Gold in the Office & Productivity category.

Herman Miller achieves eleventh consecutive listing on Dow Jones Sustainability World Index, an international stock portfolio that evaluates the annual performance of the world's largest 2500 companies using economic, environmental, and social criteria, known as the "triple bottom line" of sustainability.

2013

Herman Miller achieves tenth consecutive listing on Dow Jones Sustainability World Index.

Herman Miller has received the Best and Brightest in Wellness Award. This program is an innovative initiative that recognizes and celebrates quality and excellence in health awareness.

Herman Miller Earns Perfect Score on the Corporate Equality Index. We are one of only 303 major U.S. businesses to receive a perfect score in 2013, an achievement we have now obtained seven years in a row.

Herman Miller is listed in Forbes Magazine inaugural "Platinum List" of America's 400 best managed, large companies.

For the second consecutive year, Herman Miller is honored as one of West Michigan's "101 Best and Brightest Sustainable Companies".

2012

Herman Miller accepted its first Excellence in Reusable Packaging Award from the Reusable Packaging Association.

Herman Miller is named "Corporation of the Year" in the commercial products sector by the Michigan Minority Supplier Development Council.

In July 2012 Herman Miller was inducted into the Made in the USA Hall of Fame. Herman Miller is one of only 20 companies across the nation to receive this distinction.

Herman Miller achieves ninth consecutive listing on Dow Jones Sustainability World Index.

Herman Miller is honored as one of West Michigan's 101 Best and Brightest Sustainable Companies.

The Sustainable Asset Management (SAM) group selected Herman Miller for inclusion in "The Sustainability Yearbook 2012" and has awarded Herman Miller both the "SAM Sector Leader" and "SAM Sector Mover" distinctions.

Herman Miller was named one of 16 Section Leaders on Climate Counts 2011-2012 Scorecard Report, making us the industry leader for Home and office Furnishings.

SGS International Certification Services, Inc., recognizes Herman Miller's manufacturing sites, Midwest Distribution Center, and Design Yard for initial certification to the OHSAS 18001 standard as well as re-certification to ISO 14001.

2011

Trust Across America, a company dedicated to unraveling the complexities of trustworthy business behavior, listed Herman Miller as one of their "Top Ten Most Trustworthy Companies in America 2011."

The U.S. Environmental Protection Agency (EPA) selected Herman Miller, as a WasteWise Gold Achievement—Climate Change winner.

Herman Miller achieves eighth consecutive listing on Dow Jones Sustainability World Index, an international stock portfolio that evaluates the annual performance of the world's largest 2500 companies using economic, environmental, and social criteria, known as the "triple bottom line" of sustainability.

The Michigan Minority Supplier Development Council (MMSDC) named Herman Miller as its "Corporation of the Year" in the commercial products sector. This was the fifth time Herman Miller has received this award since 2005.

Contract Information

continued

Herman Miller accepted its third Neighborhood Environmental Partners (NEP) award from the Michigan Department of Natural Resources and Environment.

Herman Miller receives the Reader's Choice award from TreeHugger's Best of Green: Design and Architecture category for the SAYL chair.

Herman Miller earns Citibank's Global Environmental Vendor of the Year award.

The SAYL chair from Herman Miller was dubbed the "Product Design of the Year" from the 2010 International Design Awards (IDA) jury.

Herman Miller Healthcare's Compass system was awarded a 2011 Medical Design Excellence Award (MDEA) for its research-based design and ability to be used in a variety of healing spaces, while simultaneously improving the overall delivery of healthcare.

The Sustainable Asset Management (SAM) Group selected Herman Miller for inclusion in the "Sustainability Yearbook 2011" and awarded us both the "SAM Sector Leader" and "SAM Sector Mover" distinctions.

Herman Miller has received the top rating for a fourth consecutive year in the Human Rights Campaign (HRC) Foundation's eighth annual Corporate Equality Index. The "Best Places to Work for LGBT Equality" distinction is awarded to businesses that scored 100% on the HRC Foundation's 2011 Corporate Equality Index.

Herman Miller again tops contract furniture industry in FORTUNE's "Most Admired" Companies survey. For the 23rd time in 25 years.

2010

The NASDAQ OMX CRD Global Sustainability Index (QCRD) has included Herman Miller among their top 100 companies in the world.

Herman Miller achieves seventh consecutive listing on Dow Jones Sustainability World Index, an international stock portfolio that evaluates the annual performance of the world's largest 2500 companies using economic, environmental, and social criteria, known as the "triple bottom line" of sustainability. Herman Miller is one of approximately 300 companies worldwide and the only contract office furniture manufacturer, selected for this index.

Herman Miller has been recognized by Fast Company magazine as one of its 2010 Most Innovative Companies and among the more select Innovation All-Stars.

The U.S. Environmental Protection Agency's Office of Resource Conservation and Recovery has selected Herman Miller to receive the 2010 WasteWise Gold Achievement Award for Green Purchasing.

The Michigan Department of Natural Resources and Environment (MDNRE) has recognized Herman Miller's West Michigan manufacturing sites and Midwest Distribution Center as continuing Clean Corporate Citizens.

Herman Miller makes the U.S. Environmental Protection Agency's (EPA) list of the top fifty users of renewable electricity, of more than 1,200 organizations participating in the Green Power Partnership. This is the second consecutive time Herman Miller was recognized. Herman Miller was the only furniture manufacturer on the list.

Herman Miller accepted its second Neighborhood Environmental Partners (NEP) award from the Michigan Department of Natural Resources and Environment.

For the 22nd time in 24 years, Herman Miller was awarded the No. 1 industry ranking in a survey among the executives and board members of peer companies and independent industry analysts, as published in FORTUNE magazine's annual "Most Admired" companies feature.

The Michigan Department of Environmental Quality (MDEQ) recognizes Herman Miller's GreenHouse as one of Michigan's top environmental performers with a Clean Corporate Citizen (C3) longevity award. This recognizes that the GreenHouse has maintained its C3 designation for the past five years.

For the third year in a row, Herman Miller makes FORTUNE magazine's "100 Best Companies to Work For" list. Herman Miller is one of only three Michigan-based companies to make the list.

24b. Section 508 Compliance

Not applicable

25. Data Universal Numbering System (DUNS): 00-601-2801

26. Registered in System for Award Management (www.SAM.gov) Database

27. Cancellation

Prior to production, no cancellation charge will apply. After production, only actual cost incurred that the contractor can demonstrate if items are sold after 3 months.

28. Restocking Charges

Agencies must notify the contractor for authorization prior to returning any items. The customer agency will be required to pay all packaging and return freight charges. A restocking fee of 50% for Systems Furniture and 35% for all other product lines will be charged for any returned items.

Herman Miller Miscellaneous Information:

Federal ID Number: 38-0837640

Commercial and Government Entity Code (CAGE): 40636

Data Universal Numbering System (DUNS) 00-601-2801

Commercial Entity Code (CEC): 00702290J

Introduction	page 2
Tu® Wood Storage	3
Pedestals	5
Credenzas	23
Storage Towers	42
Personal Towers	51
Wardrobe	58
End-of-Run Storage	61
Cubbies	73
Indices	91
By Name	91
By Number	93
Appendices	
20-Day or Less/Assigned Lead-Time Order Information	
Keyed-Alike Information	
Customer's Own Material/Customer's Own Leather Order Information-Cushion Tops	
For the latest materials information, refer to the Materials pages on HermanMiller.com.	

Introduction

A Note on the Organization of This Book

There are a few signals that will help you understand the organization of this book. Once you know them, you should be able to find your way around easily.

Like a newspaper, this book is formatted with columns of text and illustrations that run vertically.

Information wraps from one column to the next and continues for as many pages as it needs to.

Black bars are clues.

A black bar at the top of a page signals the start of information about a product.

This information is divided into two sections, each signaled by a black bar. Product Information includes a description, additional notes, and dimensional drawings. Specification Information, which always begins at the top of a column, includes a series of steps. Each step represents a decision you need to make in order to complete your product number. Steps must be followed sequentially. The number of pages needed to complete information on a product varies; some will be complete in one page; others may fill three or four pages. Just continue going through the steps until you run into the next product, signaled by the black bar at the top of the page.

Black tabs running along the outside edge of the page help you locate what section you are in or what section you want to go to. You can thumb forwards or backwards to find a section; tabs and text appear on both sides of the page.

The additional pages in the back of the book include the appendices and indices. They are signaled by a long black bar running along the outside edge of the page.

The index is presented two ways.

The first index is in alphabetical order by product name. It can be helpful if you are new to the products and numbering scheme or if you are looking for a type of product, such as work chair or round table.

The second index is by product number. It lists, in alphanumeric order, the base product number, typically a five-digit number.

General Information

This book is effective April 2, 2018, subject to change without notice. Products may be purchased from authorized Herman Miller dealers who will quote prices upon request. For more information about our products and services or to see a list of dealers, visit www.HermanMiller.com.

All prices are list prices. Additional services, such as planning services, design, storage, and installation, are not included and must be added to these prices when the additional services are requested.

Illustrations, specifications, and prices are based on the latest information at the time of publication. The right is reserved to make changes at any time without notice in prices, fabrics, finishes, materials, specifications, and models, and also to discontinue models and finishes.

Dimensions shown in the drawings are engineering drawing dimensions rounded up to the nearest $\frac{1}{8}$ ". Product is shipped set up or knocked down. Products that include "Shipped knocked down" in the description require some assembly. If this statement does not appear in the description, the product is shipped assembled.

Service problems are normally handled by a Herman Miller authorized dealer. Where this cannot be accomplished on a local level, service problems should be referred to the Customer Care Representative for your region, Herman Miller, Inc., Zeeland, Michigan 49464.

20-Day or Less/Assigned Lead-Time Shipments

All products and options in this price book not designated by an Assigned Program icon  will ship in **20 business days or less** after being acknowledged by Herman Miller.

Products and options designated by an  are on the assigned lead-time program and may ship in 20 days, less than 20 days, or more than 20 days from order acknowledgement.

Surface-Attached Pedestal

L2PS.

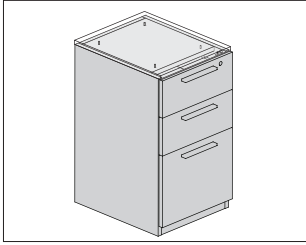

Product Information

Description

This pedestal attaches under a work surface on the left or right side to provide support and eliminate the need for a cantilever. It has an all-laminate case with laminate fronts, 2"-high recessed base, base with front to floor, or 2"-high foot with 1" leveling glides. A counterweight and top are required when specified in a freestanding application.

Actual pedestal depth is 19⁷/₈" (20), 22⁷/₈" (24), or 28⁷/₈" (28). Actual pedestal width is 15". Actual pedestal height is 27¹/₄". Adding top will increase height by 3/4", 1¹/₈", or 1¹/₄".

Box drawers and file drawers have full-extension slides. File drawers accommodate front-to-back filing of letter-sized hanging files. Specify a file converter to file side-to-side.

Notes

Order optional accessories separately:

- Storage top (L2ST.)
- Pencil tray (L2UT.906)
- File converter (L29P.15)

For keyed-alike locks, order lock plugs separately. See Keyed-Alike information in Appendices.

Dimensions

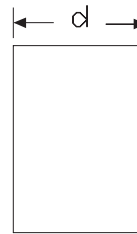
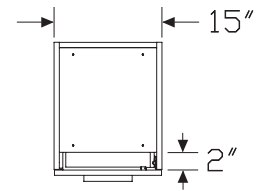

Box/Box/File

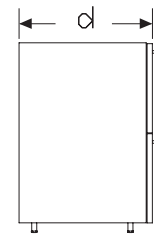

File/File

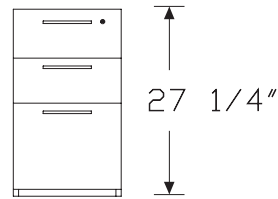

Base

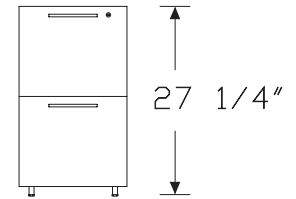

Foot

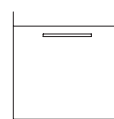

Base with front to floor

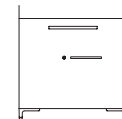

C-Foot

Surface-Attached Pedestal *continued*

Specification Information		
Step 1.		
L2PS.	A	
Step 2. Width		
15	15" wide A	+\$0
Step 3. Depth		
20	20" deep	+\$948
24	24" deep	+\$1014
28	28" deep	+\$1080
Step 4. Base/Foot Height		
1	base	+\$0
3	base with fronts to floor A	+\$0
5	foot	+\$100
9	c-foot A	+\$0
Step 5. Configuration		
FF	file/file	+\$0
BBF	box/box/file	+\$80
Step 6. Case/Front Material		
L	laminate	+\$0
Step 7. Pull Type		
A	arc pull	+\$0
K	bar pull	+\$0
U	flush pull A	+\$0
Step 8. Interior Drawer Material		
M	metal	+\$0

Step 9. Case/Front Finish		
LBM	crisp linen	+\$0
LBN	classic linen	+\$0
LBP	casual linen	+\$0
LBK	pewter mesh	+\$0
LBL	steel mesh	+\$0
8Q	folkstone grey	+\$0
91	white	+\$0
98	studio white	+\$0
CL	cool grey neutral	+\$0
LU	soft white	+\$0
WL	sandstone	+\$0
WN	warm grey neutral	+\$0
LBF	neutral twill	+\$0
LBG	sarum twill	+\$0
LBH	earthen twill	+\$0
LBJ	graphite twill	+\$0
LBQ	white twill	+\$0
76	light brown walnut	+\$0
HM	natural maple	+\$0
HP	light anigre	+\$0
HX	aged cherry	+\$0
HY	walnut on cherry	+\$0
LBA	clear on ash	+\$0
LBR	phantom ecru	+\$0
LBS	phantom cocoa	+\$0
LBU	medium matte walnut	+\$0
LBV	warm grey teak	+\$0
LBB	oak on ash	+\$0
LBC	walnut on ash	+\$0
LBD	dark brown walnut	+\$0
LBE	medium red walnut	+\$0

Step 10. Pull Finish		
<i>For arc pull (A)</i>		
NH	brushed nickel	+\$0
NK	black nickel	+\$0

Surface-Attached Pedestal *continued*

For bar pull (K) or flush pull (U)

8Q	folkstone grey <input type="checkbox"/> <input type="checkbox"/>	+\$0
91	white <input type="checkbox"/>	+\$0
98	studio white <input type="checkbox"/>	+\$0
G1	graphite <input type="checkbox"/>	+\$0
WL	sandstone <input type="checkbox"/>	+\$0
CN	metallic champagne <input type="checkbox"/>	+\$5
MS	metallic silver	+\$5
79	green apple <input type="checkbox"/>	+\$15
MY3	yellow oxide <input type="checkbox"/>	+\$15
RO	red <input type="checkbox"/>	+\$15
TRQ	turquoise <input type="checkbox"/>	+\$15

Step 11. Foot Finish

For foot (5) or c-foot (9)

8Q	folkstone grey <input type="checkbox"/>	+\$0
91	white	+\$0
98	studio white <input type="checkbox"/>	+\$0
CL	cool grey neutral	+\$0
G1	graphite	+\$0
WL	sandstone <input type="checkbox"/>	+\$0
WN	warm grey neutral	+\$0
CN	metallic champagne	+\$10
EH	metallic bronze	+\$10
MS	metallic silver	+\$10

Step 12. Counterweight

NO	no counterweight	+\$0
CB	counterweight	+\$25

Step 13. Lock Option

KA	keyed alike	+\$0
KC	keyed differently, chrome	+\$0
KD	keyed differently, black	+\$0

Mobile Pedestal

L2PM.

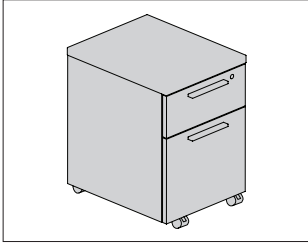

Tu® Wood Storage

Product Information

Description

This mobile pedestal fits below a hanging or freestanding work surface. It has an all-laminate case with laminate fronts, applied metal pulls, and black umber casters. It has 1 box drawer and 1 file drawer. Counterweight is included.

Actual pedestal depth is 19⁷/₈". Actual pedestal width is 15". Actual pedestal height is 22" with ³/₄" laminate top.

Box drawers and file drawers have full-extension slides and hold front-to-back letter-sized hanging files. Specify a file converter for side-to-side filing.

Notes

Order optional accessories separately:

- Add-on cushion top (L2SC.PD)
- Pencil tray (L2UT.906)
- File converter (L29P.15)

Dimensions

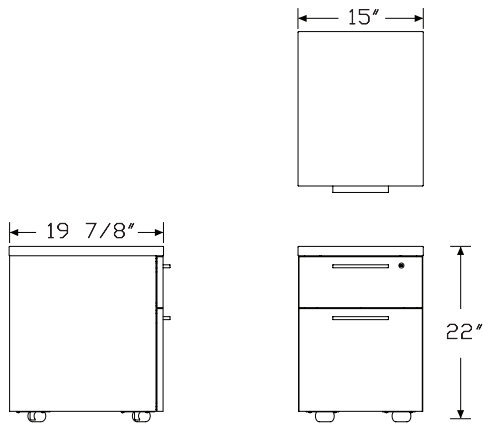

Specification Information

Step 1.

L2PM. A

Step 2. Depth

20 20" deep + \$0

Step 3. Configuration

BF box/file + \$952

Step 4. Case/Front Material

L laminate + \$0

Step 5. Top Material

02 ³/₄" laminate + \$0

08 1¹/₈" laminate + \$25

06 1¹/₄" laminate + \$50

Step 6. Pull Type

A arc pull + \$0

K bar pull + \$10

U flush pull A + \$0

Step 7. Interior Drawer Material

M metal + \$0

Step 8. Case/Front Finish

LBM	crisp linen	+\$0
LBN	classic linen	+\$0
LBP	casual linen	+\$0
LBK	pewter mesh	+\$0
LBL	steel mesh	+\$0
8Q	folkstone grey	+\$0
91	white	+\$0
98	studio white	+\$0
CL	cool grey neutral	+\$0
LU	soft white	+\$0
WL	sandstone	+\$0
WN	warm grey neutral	+\$0
LBF	neutral twill	+\$0
LBG	sarum twill	+\$0
LBH	earthen twill	+\$0
LBJ	graphite twill	+\$0
LBQ	white twill	+\$0
LA	light ash A	+\$0
76	light brown walnut	+\$0
HM	natural maple	+\$0
HP	light anigre	+\$0
HX	aged cherry	+\$0
HY	walnut on cherry	+\$0
LBA	clear on ash	+\$0
LBR	phantom ecru	+\$0
LBS	phantom cocoa	+\$0
LBU	medium matte walnut	+\$0
LBV	warm grey teak	+\$0
LBB	oak on ash	+\$0
LBC	walnut on ash	+\$0
LBD	dark brown walnut	+\$0
LBE	medium red walnut	+\$0

Step 9. Top/Edge Finish

For 3/4" laminate (o2), 1 1/8" laminate (o8), or 1 1/4" laminate (o6)

8Q	folkstone grey	+\$0
91	white	+\$0
98	studio white	+\$0
CL	cool grey neutral	+\$0
LU	soft white	+\$0
WL	sandstone	+\$0
WN	warm grey neutral	+\$0
LBM	crisp linen	+\$0
LBN	classic linen	+\$0
LBP	casual linen	+\$0
LBK	pewter mesh	+\$0
LBL	steel mesh	+\$0
LBF	neutral twill	+\$0
LBG	sarum twill	+\$0
LBH	earthen twill	+\$0
LBJ	graphite twill	+\$0
LBQ	white twill	+\$0
LA	light ash A	+\$0
76	light brown walnut	+\$0
HM	natural maple	+\$0
HP	light anigre	+\$0
HX	aged cherry	+\$0
HY	walnut on cherry	+\$0
LBA	clear on ash	+\$0
LBR	phantom ecru	+\$0
LBS	phantom cocoa	+\$0
LBU	medium matte walnut	+\$0
LBV	warm grey teak	+\$0
LBB	oak on ash	+\$0
LBC	walnut on ash	+\$0
LBD	dark brown walnut	+\$0
LBE	medium red walnut	+\$0

Step 10. Pull Finish

For arc pull (A)

NH	brushed nickel	+\$0
NK	black nickel	+\$0

Mobile Pedestal *continued*

Tu® Wood Storage

For bar pull (K) or flush pull (U)

8Q	folkstone grey <input type="checkbox"/> A	+\$0
91	white <input type="checkbox"/> A	+\$0
98	studio white <input type="checkbox"/> A	+\$0
G1	graphite <input type="checkbox"/> A	+\$0
WL	sandstone <input type="checkbox"/> A	+\$0
CN	metallic champagne <input type="checkbox"/> A	+\$5
MS	metallic silver	+\$5
79	green apple <input type="checkbox"/> A	+\$15
MY3	yellow oxide <input type="checkbox"/> A	+\$15
RO	red <input type="checkbox"/> A	+\$15
TRQ	turquoise <input type="checkbox"/> A	+\$15

Step 11. Lock Option

KA	keyed alike	+\$0
KC	keyed differently, chrome	+\$0
KD	keyed differently, black	+\$0

Combination Pedestal

L2CP.

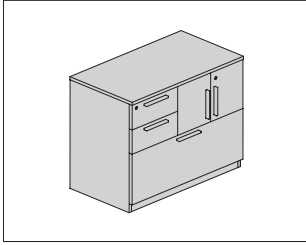

Product Information

Description

This extended width pedestal attaches under a work surface on the left or right side to provide support and eliminate the need for a cantilever. It is available in 2 widths and 2 depths. It has an all-laminate case with laminate fronts, applied metal pulls, 2"-high recessed base, base with front to floor, or 2"-high foot with 1" leveling glides, and comes with or without a top. A counterweight and top are required when specified in a freestanding application.

Actual pedestal width is 29⁷/₈" (30) or 35⁷/₈" (36).

Actual pedestal depth is 19⁷/₈" (20) or 23⁷/₈" (24).

Actual pedestal height is 27¹/₄", or 28¹/₂" with optional 1¹/₄" laminate top.

The combination unit has 2 box drawers, 1 storage area with door, and 1 large file drawer. Drawers have full-extension slides and accommodate side-to-side letter filing.

Notes

For use with Layout Studio® or Canvas Office Landscape®, specify 1¹/₈" thick top (o8) or 1¹/₄" thick top (o6).

When specified in a freestanding application, counterweight (CB) and top (o2, o6, or o8) are required.

For front-to-back filing of letter- or legal-size hanging files, order optional file converter (L29P.15) separately. Specify 2 converters per drawer.

For keyed-alike locks, order lock plugs separately. See Keyed-Alike Information in appendices.

Dimensions

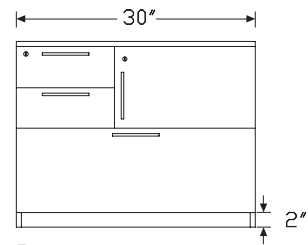
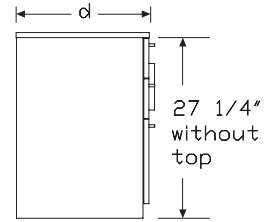

Base

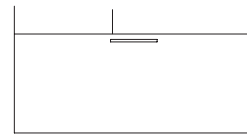

Base with front to floor

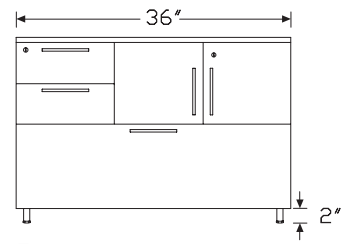

Foot

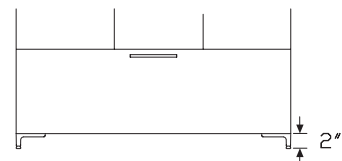

C-Foot

Combination Pedestal *continued*

Tu® Wood Storage

Specification Information		
Step 1.		
L2CP. A		
Step 2. Width		
30	30" wide	+\$500
36	36" wide	+\$600
Step 3. Depth		
20	20" deep	+\$0
24	24" deep	+\$65
Step 4. Base/Foot Height		
1	base	+\$0
3	base with fronts to floor	+\$20
5	foot	+\$100
9	c-foot	+\$130
Step 5. Configuration		
<i>For 30" wide (30)</i>		
DL	door left, box/box right	+\$915
DR	door right, box/box left	+\$915
OL	open left, box/box right	+\$840
OR	open right, box/box left	+\$840
<i>For 36" wide (36)</i>		
DL	door left, box/box right	+\$925
DR	door right, box/box left	+\$925
OL	open left, box/box right	+\$850
OR	open right, box/box left	+\$850
Step 6. Case/Front Material		
L	laminate	+\$0
Step 7. Top Material		
NT	no top	-\$20
02	3/4" low-pressure laminate with thermoplastic edge	+\$0
08	1 1/8" high-pressure laminate with thermoplastic edge	+\$75
06	1 1/4" high-pressure laminate with thermoplastic edge	+\$75
Step 8. Pull Type		
A	arc pull	+\$0
K	bar pull	+\$0
U	flush pull	+\$0

Step 9. Interior Drawer Material		
M	metal	+\$0
Step 10. Case/Front Finish		
Solid-Color Laminate		
8Q	folkstone grey	+\$0
91	white	+\$0
98	studio white	+\$0
CL	cool grey neutral	+\$0
LU	soft white	+\$0
WL	sandstone	+\$0
WN	warm grey neutral	+\$0
Linen Laminate		
LBM	crisp linen	+\$0
LBN	classic linen	+\$0
LBP	casual linen	+\$0
Mesh Laminate		
LBK	pewter mesh	+\$0
LBL	steel mesh	+\$0
Twill Laminate		
LBF	neutral twill	+\$0
LBG	sarum twill	+\$0
LBH	earthen twill	+\$0
LBJ	graphite twill	+\$0
LBQ	white twill	+\$0
Wood-Grain Laminate		
76	light brown walnut	+\$0
HM	natural maple	+\$0
HP	light anigre	+\$0
HX	aged cherry	+\$0
HY	walnut on cherry	+\$0
LBA	clear on ash	+\$0
LBR	phantom ecru	+\$0
LBS	phantom cocoa	+\$0
LBU	medium matte walnut	+\$0
LBV	warm grey teak	+\$0
LBB	oak on ash	+\$0
LBC	walnut on ash	+\$0
LBD	dark brown walnut	+\$0
LBE	medium red walnut	+\$0

Combination Pedestal *continued*

Step 11. Top/Edge Finish

For $\frac{3}{4}$ " low-pressure laminate with thermoplastic edge (o2), $\frac{1}{8}$ " high-pressure laminate with thermoplastic edge (o8), or $\frac{1}{4}$ " high-pressure laminate with thermoplastic edge (o6)

Solid-Color Laminate

8Q	folkstone grey	+\$0
91	white	+\$0
98	studio white	+\$0
CL	cool grey neutral	+\$0
LU	soft white	+\$0
WL	sandstone	+\$0
WN	warm grey neutral	+\$0

Linen Laminate

LBM	crisp linen	+\$0
LBN	classic linen	+\$0
LBP	casual linen	+\$0

Mesh Laminate

LBK	pewter mesh	+\$0
LBL	steel mesh	+\$0

Twill Laminate

LBF	neutral twill	+\$0
LBG	sarum twill	+\$0
LBH	earthen twill	+\$0
LBJ	graphite twill	+\$0
LBQ	white twill	+\$0

Wood-Grain Laminate

76	light brown walnut	+\$0
HM	natural maple	+\$0
HP	light anigre	+\$0
HX	aged cherry	+\$0
HY	walnut on cherry	+\$0
LBA	clear on ash	+\$0
LBR	phantom ecru	+\$0
LBS	phantom cocoa	+\$0
LBU	medium matte walnut	+\$0
LBV	warm grey teak	+\$0
LBB	oak on ash	+\$0
LBC	walnut on ash	+\$0
LBD	dark brown walnut	+\$0
LBE	medium red walnut	+\$0

Step 12. Pull Finish

For arc pull (A)

NH	brushed nickel	+\$0
NK	black nickel	+\$0

For bar pull (K) or flush pull (U)

8Q	folkstone grey	+\$0
91	white	+\$0
98	studio white <input type="checkbox"/>	+\$0
CN	metallic champagne	+\$5
G1	graphite	+\$0
WL	sandstone	+\$0
MS	metallic silver	+\$5
79	green apple <input type="checkbox"/>	+\$15
MY3	yellow oxide <input type="checkbox"/>	+\$15
RO	red <input type="checkbox"/>	+\$15
TRQ	turquoise <input type="checkbox"/>	+\$15

Step 13. Foot Finish

For foot (5) or c-foot (9)

8Q	folkstone grey <input type="checkbox"/>	+\$0
91	white	+\$0
98	studio white <input type="checkbox"/>	+\$0
CL	cool grey neutral	+\$0
G1	graphite	+\$0
WL	sandstone <input type="checkbox"/>	+\$0
WN	warm grey neutral	+\$0
CN	metallic champagne	+\$10
EH	metallic bronze	+\$10
MS	metallic silver	+\$10

Step 14. Counterweight

NO	no counterweight (must gang or anchor)	+\$0
CB	counterweight (recommended)	+\$70

Step 15. Lock Option

KA	keyed alike	+\$0
KC	keyed differently, chrome	+\$0
KD	keyed differently, black	+\$0

Storage Tops

L2ST.

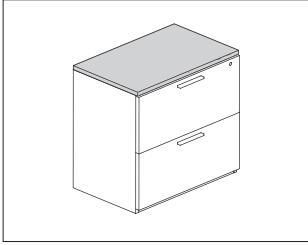

Tu® Wood Storage

Product Information

Description

This file top attaches to a surface-attached pedestal or an extended-width surface-attached pedestal. It has a laminate top with thermoplastic edge or veneer top with veneer edge.

Notes

For use with Layout Studio® or Canvas Office Landscape®, specify 1 1/8" thick top (8) or 1 1/4" thick top (6).

Dimensions

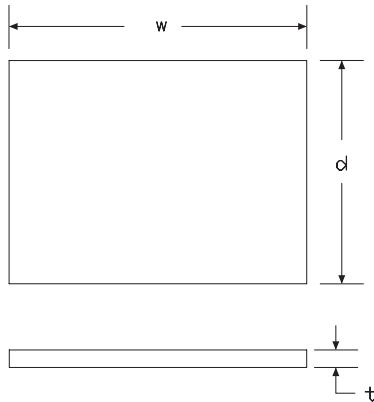

Specification Information

Step 1.

L2ST.

Step 2. Width

015	15" wide	+\$115
030	30" wide	+\$141
036	36" wide	+\$188
042	42" wide	+\$203
060	60" wide	+\$239
066	66" wide	+\$253
072	72" wide	+\$266

Step 3. Depth

20	20" deep	+\$0
24	24" deep	+\$10

Step 4. Top Material

For 15" wide (015), 30" wide (030), 36" wide (036), or 42" wide (042)

2	3/4" laminate top	+\$0
8	1 1/8" laminate top	+\$75
6	1 1/4" laminate top	+\$75

For 60" wide (060), 66" wide (066), or 72" wide (072)

2	3/4" laminate top	+\$0
8	1 1/8" laminate top	+\$125
6	1 1/4" laminate top	+\$125

Step 5. Surface Finish

Solid-Color Laminate

8Q	folkstone grey	+\$0
91	white	+\$0
98	studio white	+\$0
CL	cool grey neutral	+\$0
LU	soft white	+\$0
WL	sandstone	+\$0
WN	warm grey neutral	+\$0

Storage Tops *continued*

Wood-Grain Laminate		
HM	natural maple	+\$0
HP	light anigre	+\$0
76	light brown walnut	+\$0
HX	aged cherry	+\$0
HY	walnut on cherry	+\$0
LBA	clear on ash	+\$0
LBR	phantom ecru	+\$0
LBS	phantom cocoa	+\$0
LBU	medium matte walnut	+\$0
LBV	warm grey teak	+\$0
LBB	oak on ash	+\$0
LBC	walnut on ash	+\$0
LBD	dark brown walnut	+\$0
LBE	medium red walnut	+\$0

Twill Laminate		
LBF	neutral twill	+\$0
LBG	sarum twill	+\$0
LBH	earthen twill	+\$0
LBJ	graphite twill	+\$0
LBQ	white twill	+\$0

Linen Laminate		
LBM	crisp linen	+\$0
LBN	classic linen	+\$0
LBP	casual linen	+\$0

Mesh Laminate		
LBK	pewter mesh	+\$0
LBL	steel mesh	+\$0

Extended Width Surface-Attached L2EW. Pedestal

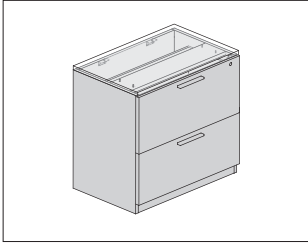

Tu® Wood Storage

Product Information

Description

This extended width pedestal attaches under a work surface on the left or right side to provide support and eliminate the need for a cantilever. It is available in 4 widths and 2 depths. It has an all-laminate case with laminate fronts, applied metal pulls, 2"-high recessed base, base with front to floor, or 2"-high foot with 1" leveling glides, and comes with or without a top. Tops are available in 3/4", 1 1/8", and 1 1/4" thicknesses. A counterweight and top are required when specified in a freestanding application.

Actual pedestal case depth is 18 7/8" (20) or 21 7/8" (24). Fronts add 1" to case depth.

Actual pedestal width is 23 7/8" (24), 29 7/8" (30), 35 7/8" (36), or 41 7/8" (42).

Actual pedestal height is 27 1/4", or 28 1/2" with optional 1 1/4" laminate top.

The file/file unit (FF) has 2 file drawers with positive interlock system that permits only 1 drawer to open at a time. Drawers have full-extension slides and accommodate side-to-side letter filing. Specify optional file converter for front-to-back filing of letter or legal hanging files. Specify 2 converters per drawer.

The open unit with shelf (OS) is an open cabinet with 1 laminate adjustable shelf. Shelf has 3 locations and adjusts in 1 1/4" increments.

Actual cabinet depth is 18 7/8" (20) or 21 7/8" (24).

The unit with doors and shelf (DS) has 2 laminate doors that enclose a cabinet with one laminate adjustable shelf. Shelf has 3 locations and adjusts in 1 1/4" increments.

Notes

Dimensional illustrations do not include all possible configurations.

Order optional accessories separately:

- Storage top (L2ST.)
- File converter (L29P.15)

For keyed-alike locks, order lock plugs separately. See Keyed-Alike information in Appendices.

Dimensions

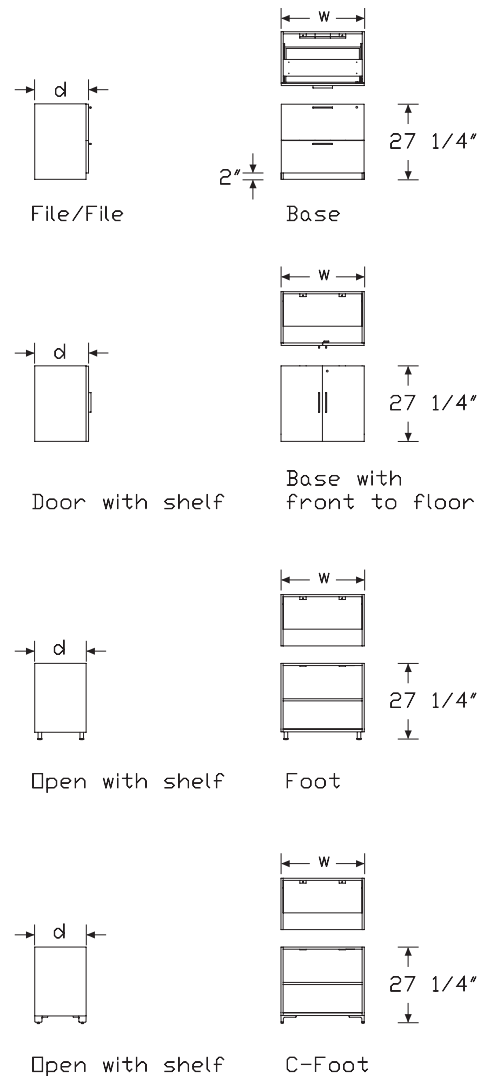

Extended Width Surface-Attached Pedestal *continued*

Specification Information

Step 1.

L2EW. A

Step 2. Width

24	24" wide	+\$525
30	30" wide	+\$585
36	36" wide	+\$650
42	42" wide	+\$700

Step 3. Depth

20	20" deep	+\$0
24	24" deep	+\$65

Step 4. Base/Foot Height

1	base	+\$0
3	base with fronts to floor	+\$0
5	foot	+\$100
9	c-foot	+\$0

Step 5. Configuration

For 24" wide (24), 30" wide (30), or 36" wide (36)

OP	open with shelf	+\$0
DS	doors with shelf	+\$160
OF	open/file	+\$250
OBF	open/box/file	+\$350
FF	file/file	+\$500
BBF	box/box/file	+\$580

For 42" wide (42)

OF	open/file	+\$310
OBF	open/box/file	+\$410
FF	file/file	+\$560
BBF	box/box/file	+\$640

Step 6. Case/Front Material

L	laminate	+\$0
----------	----------	------

Step 7. Pull Type

For open/file (OF), doors with shelf (DS), open/box/file (OBF), file/file (FF), or box/box/file (BBF)

A	arc pull	+\$0
K	bar pull	+\$0
U	flush pull	+\$0

For open with shelf (OP)

N	no pull	+\$0
----------	---------	------

Step 8. Interior Drawer Material

For open/file (OF), open/box/file (OBF), file/file (FF), or box/box/file (BBF)

M	metal	+\$0
----------	-------	------

Step 9. Case/Front Finish

8Q	folkstone grey	+\$0
91	white	+\$0
98	studio white	+\$0
CL	cool grey neutral	+\$0
LU	soft white	+\$0
WL	sandstone	+\$0
WN	warm grey neutral	+\$0
LBM	crisp linen	+\$0
LBN	classic linen	+\$0
LBP	casual linen	+\$0
LBK	pewter mesh	+\$0
LBL	steel mesh	+\$0
LBF	neutral twill	+\$0
LBG	sarum twill	+\$0
LBH	earthen twill	+\$0
LBJ	graphite twill	+\$0
LBQ	white twill	+\$0
76	light brown walnut	+\$0
HM	natural maple	+\$0
HP	light anigre	+\$0
HX	aged cherry	+\$0
HY	walnut on cherry	+\$0
LBA	clear on ash	+\$0
LBR	phantom ecru	+\$0
LBS	phantom cocoa	+\$0
LBU	medium matte walnut	+\$0
LBV	warm grey teak	+\$0
LBB	oak on ash	+\$0
LBC	walnut on ash	+\$0
LBD	dark brown walnut	+\$0
LBE	medium red walnut	+\$0

Step 10. Pull Finish

For arc pull (A)

NH	brushed nickel	+\$0
NK	black nickel	+\$0

Extended Width Surface-Attached Pedestal *continued*

Tu® Wood Storage

For bar pull (K) or flush pull (U)

98	studio white <input type="checkbox"/> A	+\$0
MS	metallic silver	+\$5
79	green apple <input type="checkbox"/> A	+\$0
MY3	yellow oxide <input type="checkbox"/> A	+\$15
RO	red <input type="checkbox"/> A	+\$15
TRQ	turquoise <input type="checkbox"/> A	+\$15

Step 11. Foot Finish

For foot (5) or c-foot (9)

8Q	folkstone grey	+\$0
91	white	+\$0
98	studio white <input type="checkbox"/> A	+\$0
CL	cool grey neutral	+\$0
G1	graphite	+\$0
WL	sandstone	+\$0
WN	warm grey neutral	+\$0
CN	metallic champagne	+\$10
EH	metallic bronze	+\$10
MS	metallic silver	+\$10

Step 12. Counterweight

For open/file (OF), open/box/file (OBF), file/file (FF), or box/box/file (BBF)

NO	no counterweight	+\$0
CB	counterweight	+\$50

For open with shelf (OP) or doors with shelf (DS)

NO	no counterweight	+\$0
-----------	------------------	------

Step 13. Lock Option

For open/file (OF), doors with shelf (DS), open/box/file (OBF), file/file (FF), or box/box/file (BBF)

KA	keyed alike	+\$0
KC	keyed differently, chrome	+\$0
KD	keyed differently, black	+\$0

Cushion Top for Pedestals

L2SC.

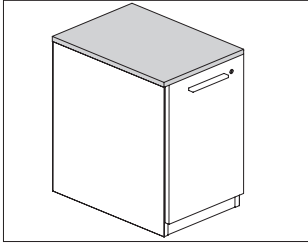

Product Information

Description

This 1" thick cushion attaches to the top of a mobile pedestal to provide temporary guest seating. Attachment hardware included.

Dimensions

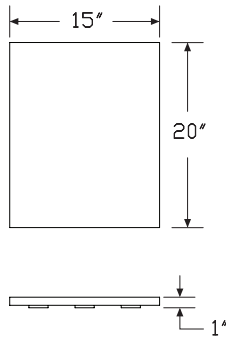

Specification Information

Step 1.

L2SC.PD [A]

Step 2. Height

1	1" high	+ \$50
----------	---------	--------

Step 3. Depth

20	19.88" deep	+ \$110
24	22.88" deep	+ \$130

Step 4. Width

15	15" wide	+ \$0
-----------	----------	-------

Step 5. Cushion Top Fabric

See application chart and textiles list for fabric usage and numbers. First 2 digits of number indicate fabric line; remaining digit(s) indicate fabric color.

Price Category 1	+ \$0
Price Category 2	+ \$68
Price Category 3	+ \$82
Price Category 4	+ \$101
Price Category 5	+ \$120
Price Category 7 [A]	+ \$137
Price Category 9	+ \$950
Price Category B	+ \$52
Price Category C	+ \$40
Price Category D	+ \$51
Price Category E	+ \$108
Price Category F	+ \$140
Price Category G	+ \$182
Price Category H	+ \$221
Price Category I	+ \$260
Price Category J	+ \$299

Tu® Wood Storage

Utility Tray Pedestal

L2UT.

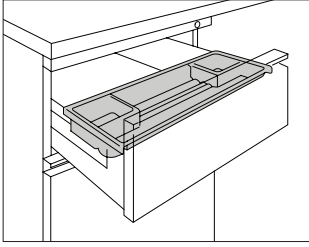

Tu® Wood Storage

Product Information

Description

This plastic tray provides storage for pencils and other small items in a pedestal or credenza box drawer. It hangs side-to-side on pedestal drawer and front-to-back on credenza drawer. Finish is black umber.

Notes

To install tray front-to-back in the box drawer of credenza, order side-to-side filing rail (L2902.) separately.

Dimensions

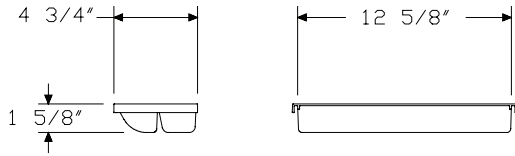

Specification Information

Step 1.

L2UT. [A]

Step 2. Drawer

906 15" metal drawer [A]

Prices for Steps 1-2.

L2UT. 906 \$24

File Rail

L29P.

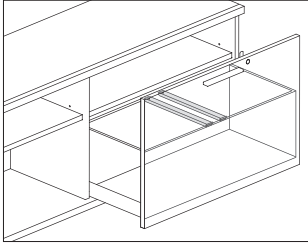

Product Information

Description

This file rail provides the capability to file front-to-back in a file/file extended width pedestal or credenza file drawer. Finish is black. Rails are individually packaged.

Notes

Specify 1 rail for each row of front-to-back files to be supported.

Dimensions

Specification Information

Step 1.

L29P. A

Step 2. Depth

15 front to back file rail A

Prices for Steps 1-2.

L29P. 15 \$10

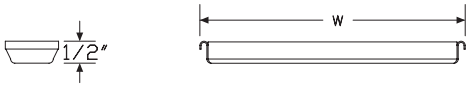

Side-To-Side Filing Rail, Credenza L2902.
Drawer

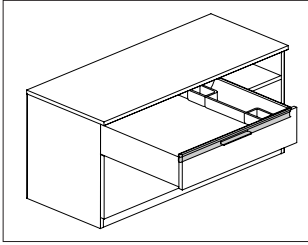

Tu® Wood Storage

Product Information

Description

This rail will hold a utility tray when installed in a laminate credenza metal box drawer. Package contains 1 rail.

Notes

Specify 1 rail per each credenza box drawer.

This rail can be used in box drawer of a laminate credenza, open with box/file (L2CD.BF) to suspend a utility tray front to back of drawer.

Order utility tray (L2UT.) separately.

Dimensions

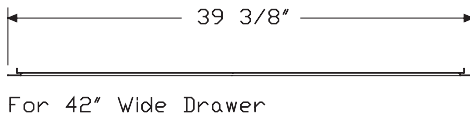
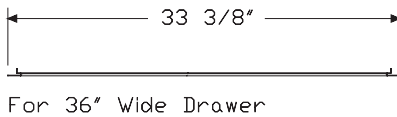
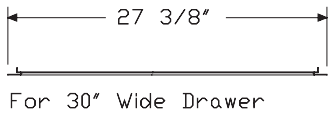
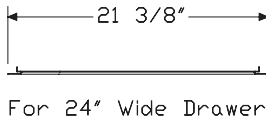
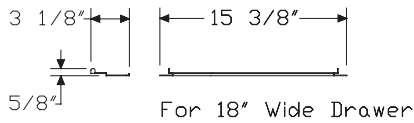

Specification Information

Step 1.

L2902. A

Step 2. Width

- 18** for 18"-wide credenza box drawer A
- 24** for 24"-wide credenza box drawer A
- 30** for 30"-wide credenza box drawer A
- 36** for 36"-wide credenza box drawer A
- 42** for 42"-wide credenza box drawer A

Prices for Steps 1-2.

L2902. 18	\$18
24	\$20
30	\$23
36	\$26
42	\$30

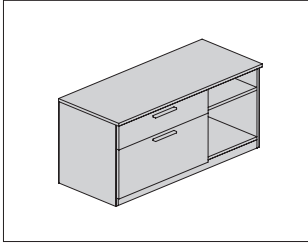

Product Information

Description

This credenza provides drawer storage on 1 side with open storage on the other side and can be used freestanding or to support 1 end of a work surface. It has an all-laminate case with laminate front, recessed 2"-high base, base with front to floor, or 2"-high foot with 1" leveling glides, and comes with or without a top. The open side has a laminate shelf that adjusts in 1/4" increments. The drawer side has 1 file drawer and 1 box drawer.

Notes

For use with Layout Studio® or Canvas Office Landscape®, specify 1 1/8" thick top (o8) or 1 1/4" thick top (o6).

A counterweight is required when specified in a freestanding application.

File drawers have full-extension slides and accommodate side-to-side letter filing. For front-to-back filing of letter- or legal-size hanging files, order optional file converter (oP1500) separately. Specify 2 converters per drawer.

Actual credenza depths are 16 1/2" (16), or 20" (20). Actual credenza widths are 47 3/4" (48), 53 3/4" (54), 59 3/4" (60), 65 3/4" (66), or 71 3/4" (72).

Actual credenza height is 22" including the 3/4" top.

Order optional accessories separately:

- Add-on cushion top (LSC.CD)
- Canvas surface support, fixed (FT298.M)
- Canvas surface support, adjustable (FT299.M)

Grain direction is vertical on front and sides, and horizontal on back.

For keyed-alike locks, order lock plugs separately. See Keyed-Alike

Information in appendices.

See planning guide for additional configuration information and dimensions.

Dimensions

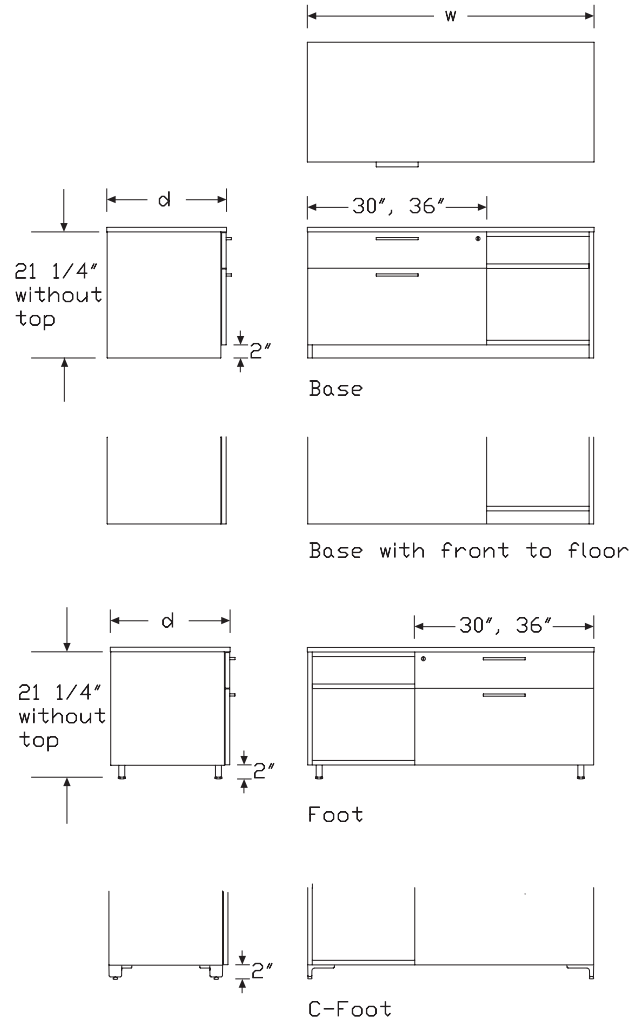

Credenza - Open with Box/ File

continued

Tu® Wood Storage

Specification Information

Step 1.

L2CD.BF A

Step 2. Width

48	48" wide	+\$1530
54	54" wide	+\$1630
60	60" wide	+\$1730
66	66" wide	+\$1830
72	72" wide	+\$1930

Step 3. Depth

16	16.5" deep	+\$0
20	20" deep A	+\$100

Step 4. Base/Foot Height

1	base	+\$0
3	base with fronts to floor A	+\$20
5	foot	+\$100
9	c-foot	+\$130

Step 5. Configuration

For 48" wide (48)

BC	30" file left, open right	+\$0
BD	open left, 30" file right	+\$0

For 54" wide (54)

BC	30" file left, open right	+\$0
BD	open left, 30" file right	+\$0
BE	36" file left, open right	+\$65
BF	open left, 36" file right	+\$65

For 60" wide (60)

BC	30" file left, open right	+\$0
BD	open left, 30" file right	+\$0
BE	36" file left, open right	+\$65
BF	open left, 36" file right	+\$65

For 66" wide (66)

BC	30" file left, open right	+\$0
BD	open left, 30" file right	+\$0
BE	36" file left, open right	+\$65
BF	open left, 36" file right	+\$65

For 72" wide (72)

BC	30" file left, open right	+\$0
BD	open left, 30" file right	+\$0
BE	36" file left, open right	+\$65
BF	open left, 36" file right	+\$65

Step 6. Case/Front Material

For 48" wide (48) or 54" wide (54)

L	lamine	+\$0
----------	--------	------

For 60" wide (60), 66" wide (66), or 72" wide (72)

L	lamine	+\$0
----------	--------	------

Step 7. Top Material

NT	no top	-\$20
02	3/4" lamine A	+\$0
08	1 1/8" lamine A	+\$125
06	1 1/4" lamine A	+\$125

Step 8. Pull Type

A	arc pull	+\$0
K	bar pull	+\$0
U	flush pull	+\$0

Step 9. Interior Drawer Material

M	metal	+\$0
----------	-------	------

Step 10. Case/Front Finish

Solid-Color Lamine

8Q	folkstone grey	+\$0
91	white	+\$0
98	studio white	+\$0
CL	cool grey neutral	+\$0
LU	soft white	+\$0
WL	sandstone	+\$0
WN	warm grey neutral	+\$0

Linen Lamine

LBM	crisp linen	+\$0
LBN	classic linen	+\$0
LBP	casual linen	+\$0

Mesh Lamine

LBK	pewter mesh	+\$0
LBL	steel mesh	+\$0

Credenza - Open with Box/ File

continued

Twill Laminate		
LBF	neutral twill	+\$0
LBG	sarum twill	+\$0
LBH	earthen twill	+\$0
LBJ	graphite twill	+\$0
LBQ	white twill	+\$0

Wood-Grain Laminate		
LA	light ash A	+\$0
76	light brown walnut	+\$0
HM	natural maple	+\$0
HP	light anigre	+\$0
HX	aged cherry	+\$0
HY	walnut on cherry	+\$0
LBA	clear on ash	+\$0
LBR	phantom ecru	+\$0
LBS	phantom cocoa	+\$0
LBU	medium matte walnut	+\$0
LBV	warm grey teak	+\$0
LBB	oak on ash	+\$0
LBC	walnut on ash	+\$0
LBD	dark brown walnut	+\$0
LBE	medium red walnut	+\$0

Step 11. Top/Edge Finish
For 3/4" laminate (02), 1 1/8" laminate (08), or 1 1/4" laminate (06)

Solid-Color Laminate		
8Q	folkstone grey	+\$0
91	white	+\$0
98	studio white	+\$0
CL	cool grey neutral	+\$0
LU	soft white	+\$0
WL	sandstone	+\$0
WN	warm grey neutral	+\$0

Linen Laminate		
LBM	crisp linen	+\$0
LBN	classic linen	+\$0
LBP	casual linen	+\$0

Mesh Laminate		
LBK	pewter mesh	+\$0
LBL	steel mesh	+\$0

Twill Laminate		
LBF	neutral twill	+\$0
LBG	sarum twill	+\$0
LBH	earthen twill	+\$0
LBJ	graphite twill	+\$0
LBQ	white twill	+\$0

Wood-Grain Laminate		
LA	light ash A	+\$0
76	light brown walnut	+\$0
HM	natural maple	+\$0
HP	light anigre	+\$0
HX	aged cherry	+\$0
HY	walnut on cherry	+\$0
LBA	clear on ash	+\$0
LBR	phantom ecru	+\$0
LBS	phantom cocoa	+\$0
LBU	medium matte walnut	+\$0
LBV	warm grey teak	+\$0
LBB	oak on ash	+\$0
LBC	walnut on ash	+\$0
LBD	dark brown walnut	+\$0
LBE	medium red walnut	+\$0

Step 12. Pull Finish

For arc pull (A)

NH	brushed nickel	+\$0
NK	black nickel	+\$0

For bar pull (K) or flush pull (U)

8Q	folkstone grey A	+\$0
91	white A	+\$0
98	studio white A	+\$0
G1	graphite A	+\$0
WL	sandstone A	+\$0
CN	metallic champagne A	+\$5
MS	metallic silver	+\$5
79	green apple A	+\$15
MY3	yellow oxide A	+\$15
RO	red A	+\$15
TRQ	turquoise A	+\$15

Credenza - Open with Box/ File

continued

Tu® Wood Storage

Step 13. Foot Finish

For foot (5) or c-foot (9)

8Q	folkstone grey <input type="checkbox"/> A	+\$0
91	white	+\$0
98	studio white <input type="checkbox"/> A	+\$0
CL	cool grey neutral	+\$0
G1	graphite	+\$0
WL	sandstone <input type="checkbox"/> A	+\$0
WN	warm grey neutral	+\$0
CN	metallic champagne	+\$10
EH	metallic bronze	+\$10
MS	metallic silver	+\$10

Step 14. Counterweight

NO	no counterweight (must gang or anchor)	+\$0
CB	counterweight (recommended)	+\$70

Step 15. Lock Option

KA	keyed alike	+\$0
KC	keyed differently, chrome	+\$0
KD	keyed differently, black	+\$0

Credenza - Open

L2CD.

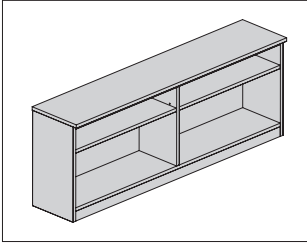

Product Information

Description

This credenza provides open storage and can be used freestanding or to support 1 end of a work surface. It has an all-laminate case, 2"-high recessed base or foot with 1" leveling glides, and a laminate top with thermoplastic edge.

Both sides are open with 1 adjustable shelf per side. Shelves adjust in 1/4" increments.

Actual credenza depth is 12 1/2" (12) or 16 1/2" (16).

Actual credenza width is 47 3/4" (48), 59 3/4" (60) or 71 3/4" (72).

Actual credenza height is 22" including the 3/4" top. For use with Layout Studio® or Canvas Office Landscape®, specify 1 1/8" thick top (o8) or 1 1/4" thick top (o6).

Notes

Order optional accessories separately:

- Add-on cushion top (LSC.CD)
- Canvas surface support, fixed (FT298.M)
- Canvas surface support, adjustable (FT299.M)

Grain direction is vertical on front and sides, and horizontal on back.

See planning guide for additional configuration information and dimensions.

Dimensions

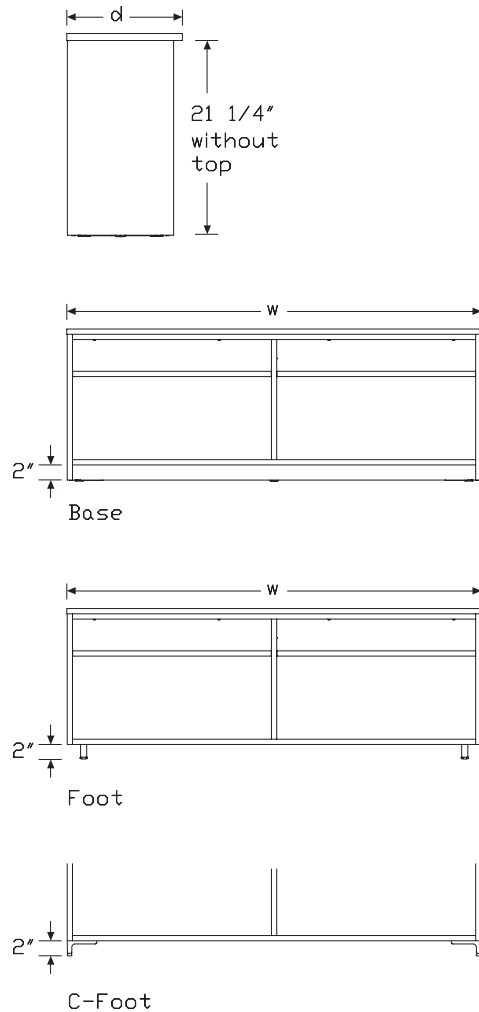

Specification Information		
Step 1.		
L2CD.OP <input type="checkbox"/>		
Step 2. Width		
48	48" wide	+\$1150
60	60" wide	+\$1300
72	72" wide	+\$1450
Step 3. Depth		
<i>For 48" wide (48) or 60" wide (60)</i>		
12	12.5" deep	+\$0
16	16.5" deep	+\$50
<i>For 72" wide (72)</i>		
12	12.5" deep	+\$0
16	16.5" deep	+\$100
Step 4. Base/Foot Height		
1	base <input type="checkbox"/>	+\$0
5	foot <input type="checkbox"/>	+\$100
9	c-foot <input type="checkbox"/>	+\$0
Step 5. Case/Front Material		
<i>For 48" wide (48)</i>		
L	laminate <input type="checkbox"/>	+\$0
<i>For 60" wide (60) or 72" wide (72)</i>		
L	laminate <input type="checkbox"/>	+\$0
Step 6. Top Material		
NT	no top <input type="checkbox"/>	-\$20
02	3/4" laminate <input type="checkbox"/>	+\$0
08	1 1/8" laminate <input type="checkbox"/>	+\$125
06	1 1/4" laminate <input type="checkbox"/>	+\$125

Step 7. Case Finish		
8Q	folkstone grey	+\$0
91	white	+\$0
98	studio white	+\$0
CL	cool grey neutral	+\$0
LU	soft white	+\$0
WL	sandstone	+\$0
WN	warm grey neutral	+\$0
LBM	crisp linen	+\$0
LBN	classic linen	+\$0
LBP	casual linen	+\$0
LBK	pewter mesh	+\$0
LBL	steel mesh	+\$0
LBF	neutral twill	+\$0
LBG	sarum twill	+\$0
LBH	earthen twill	+\$0
LBJ	graphite twill	+\$0
LBQ	white twill	+\$0
76	light brown walnut	+\$0
HM	natural maple	+\$0
HP	light anigre	+\$0
HX	aged cherry	+\$0
HY	walnut on cherry	+\$0
LBA	clear on ash	+\$0
LBR	phantom ecru	+\$0
LBS	phantom cocoa	+\$0
LBU	medium matte walnut	+\$0
LBV	warm grey teak	+\$0
LBB	oak on ash	+\$0
LBC	walnut on ash	+\$0
LBD	dark brown walnut	+\$0
LBE	medium red walnut	+\$0

Step 8. Top/Edge Finish		
<i>For 3/4" laminate (02), 1 1/8" laminate (08), or 1 1/4" laminate (06)</i>		
Solid-Color Laminate		
8Q	folkstone grey	+\$0
91	white	+\$0
98	studio white	+\$0
CL	cool grey neutral	+\$0
LU	soft white	+\$0
WL	sandstone	+\$0
WN	warm grey neutral	+\$0

Credenza - Open *continued*

Linen Laminate		
LBM	crisp linen	+\$0
LBN	classic linen	+\$0
LBP	casual linen	+\$0

Mesh Laminate		
LBK	pewter mesh	+\$0
LBL	steel mesh	+\$0

Twill Laminate		
LBF	neutral twill	+\$0
LBG	sarum twill	+\$0
LBH	earthen twill	+\$0
LBJ	graphite twill	+\$0
LBQ	white twill	+\$0

Wood-Grain Laminate		
76	light brown walnut	+\$0
HM	natural maple	+\$0
HP	light anigre	+\$0
HX	aged cherry	+\$0
HY	walnut on cherry	+\$0
LBA	clear on ash	+\$0
LBR	phantom ecru	+\$0
LBS	phantom cocoa	+\$0
LBU	medium matte walnut	+\$0
LBV	warm grey teak	+\$0
LBB	oak on ash	+\$0
LBC	walnut on ash	+\$0
LBD	dark brown walnut	+\$0
LBE	medium red walnut	+\$0

Step 9. Foot Finish		
<i>For foot (5) or c-foot (9)</i>		
8Q	folkstone grey <input type="checkbox"/> A	+\$0
91	white	+\$0
98	studio white <input type="checkbox"/> A	+\$0
CL	cool grey neutral	+\$0
G1	graphite	+\$0
WL	sandstone <input type="checkbox"/> A	+\$0
WN	warm grey neutral	+\$0
CN	metallic champagne	+\$10
EH	metallic bronze	+\$10
MS	metallic silver	+\$10

Credenza - Open with File/Shelf

L2CD.

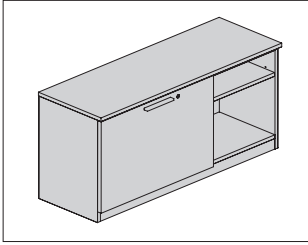

Tu® Wood Storage

Product Information

Description

This credenza provides drawer storage on 1 side with open storage on the other side and can be used freestanding or to support 1 end of a work surface. It has an all-laminate case with laminate front, 2"-high recessed base, base with front to floor, or 2"-high foot with 1" leveling glides, and a laminate top with thermoplastic edge.

The open side has a laminate shelf that adjusts in 1/4" increments. The drawer side has 1 file drawer and 1 fixed shelf.

A counterweight is required when specified in a freestanding application.

Actual credenza depth is 16 1/2".

Actual credenza width is 47 3/4" (48), 53 3/4" (54), 59 3/4" (60), 65 3/4" (66) or 71 3/4" (72).

Actual credenza height is 22" including the 3/4" top. For use with Layout Studio® or Canvas Office Landscape®, specify 1 1/8" thick top (o8) or 1 1/4" thick top (o6).

File drawers have full-extension slides and accommodate side-to-side letter filing. Specify optional file converter for front-to-back filing of letter or legal hanging files. Specify 2 file converters per drawer.

Notes

Order optional accessories separately:

- Add-on cushion top (LSC.CD)
- Canvas surface support, fixed (FT298.M)
- Canvas surface support, adjustable (FT299.M)
- File converter (gP1500)

Grain direction is vertical on front and sides, and horizontal on back.

For keyed-alike locks, order lock plugs separately. See Keyed-Alike information in Appendices.

See planning guide for additional configuration information and dimensions.

Dimensions

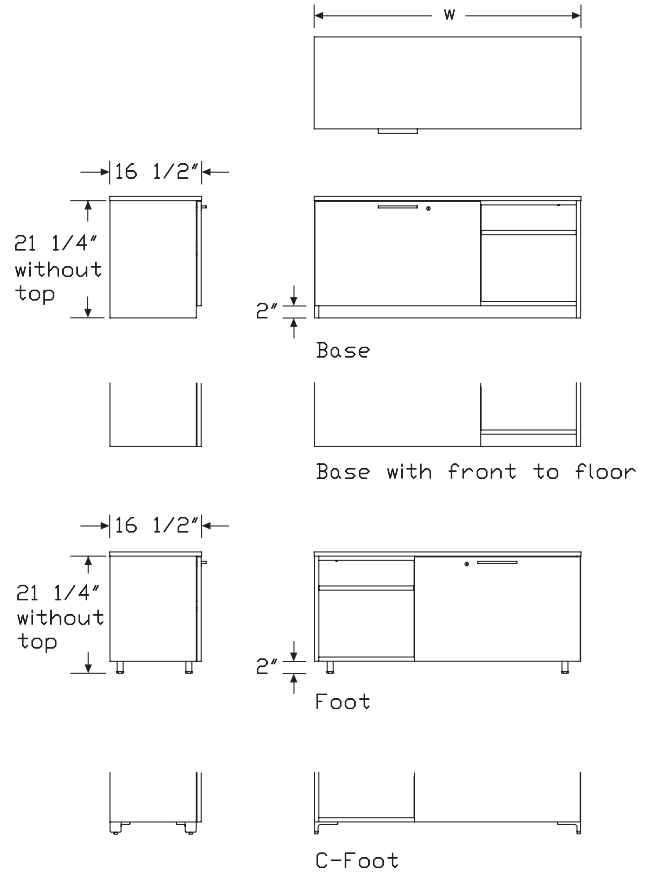

Credenza - Open with File/Shelf

continued

Specification Information		
Step 1.		
L2CD.OF	A	
Step 2. Width		
48	48" wide	+\$1430
54	54" wide	+\$1530
60	60" wide	+\$1630
66	66" wide	+\$1730
72	72" wide	+\$1830
Step 3. Depth		
16	16 ¹ / ₂ " deep	+\$0
Step 4. Base/Foot Height		
1	base	+\$0
3	base with fronts to floor	+\$10
5	foot A	+\$100
9	c-foot	+\$130
Step 5. Configuration		
<i>For 48" wide (48)</i>		
BC	30" file left, open right	+\$0
BD	30" wide drawer right open left	+\$0
<i>For 54" wide (54), 60" wide (60), 66" wide (66), or 72" wide (72)</i>		
BC	30" file left, open right	+\$0
BD	open left, 30" file right	+\$0
BE	36" file left, open right	+\$0
BF	open left, 36" file right	+\$0
Step 6. Case/Front Material		
<i>For 48" wide (48) or 54" wide (54)</i>		
L	laminate case/front	+\$0
<i>For 60" wide (60), 66" wide (66), or 72" wide (72)</i>		
L	laminate case/front	+\$0
Step 7. Top Material		
NT	no top A	-\$20
02	3/4" laminate A	+\$0
08	1 ¹ / ₈ " laminate A	+\$125
06	1 ¹ / ₄ " laminate A	+\$125

Step 8. Pull Type		
U	flush pull	+\$0
A	arc pull	+\$0
K	bar pull	+\$0
Step 9. Interior Drawer Material		
M	metal	+\$0
Step 10. Case/Front Finish		
LBM	crisp linen	+\$0
LBN	classic linen	+\$0
LBP	casual linen	+\$0
LBK	pewter mesh	+\$0
LBL	steel mesh	+\$0
8Q	folkstone grey	+\$0
91	white	+\$0
98	studio white	+\$0
CL	cool grey neutral	+\$0
LU	soft white	+\$0
WL	sandstone	+\$0
WN	warm grey neutral	+\$0
LBF	neutral twill	+\$0
LBG	sarum twill	+\$0
LBH	earthen twill	+\$0
LBJ	graphite twill	+\$0
LBQ	white twill	+\$0
LA	light ash A	+\$0
76	light brown walnut	+\$0
HM	natural maple	+\$0
HP	light anigre	+\$0
HX	aged cherry	+\$0
HY	walnut on cherry	+\$0
LBA	clear on ash	+\$0
LBR	phantom ecru	+\$0
LBS	phantom cocoa	+\$0
LBU	medium matte walnut	+\$0
LBV	warm grey teak	+\$0
LBB	oak on ash	+\$0
LBC	walnut on ash	+\$0
LBD	dark brown walnut	+\$0
LBE	medium red walnut	+\$0

Tu® Wood Storage

Credenza - Open with File/Shelf

continued

Tu® Wood Storage

Step 11. Top/Edge Finish

For 3/4" laminate (o2), 1 1/8" laminate (o8), or 1 1/4" laminate (o6)

LBM	crisp linen	+\$0
LBN	classic linen	+\$0
LBP	casual linen	+\$0
LBK	pewter mesh	+\$0
LBL	steel mesh	+\$0
8Q	folkstone grey	+\$0
91	white	+\$0
98	studio white	+\$0
CL	cool grey neutral	+\$0
LU	soft white	+\$0
WL	sandstone	+\$0
WN	warm grey neutral	+\$0
LBF	neutral twill	+\$0
LBG	sarum twill	+\$0
LBH	earthen twill	+\$0
LBJ	graphite twill	+\$0
LBQ	white twill	+\$0
LA	light ash A	+\$0
76	light brown walnut	+\$0
HM	natural maple	+\$0
HP	light anigre	+\$0
HX	aged cherry	+\$0
HY	walnut on cherry	+\$0
LBA	clear on ash	+\$0
LBR	phantom ecru	+\$0
LBS	phantom cocoa	+\$0
LBU	medium matte walnut	+\$0
LBV	warm grey teak	+\$0
LBB	oak on ash	+\$0
LBC	walnut on ash	+\$0
LBD	dark brown walnut	+\$0
LBE	medium red walnut	+\$0

Step 12. Pull Finish

For arc pull (A)

NH	brushed nickel	+\$0
NK	black nickel	+\$0

For flush pull (U) or bar pull (K)

8Q	folkstone grey	+\$0
91	white	+\$0
98	studio white A	+\$0
G1	graphite	+\$0
WL	sandstone	+\$0
CN	metallic champagne	+\$5
MS	metallic silver	+\$5
79	green apple A	+\$15
MY3	yellow oxide A	+\$15
RO	red A	+\$15
TRQ	turquoise A	+\$15

Step 13. Foot Finish

For foot (5) or c-foot (9)

8Q	folkstone grey	+\$0
WL	sandstone	+\$0
91	white	+\$0
98	studio white A	+\$0
CL	cool grey neutral	+\$0
G1	graphite	+\$0
WN	warm grey neutral	+\$0
CN	metallic champagne	+\$10
EH	metallic bronze	+\$10
MS	metallic silver	+\$10

Step 14. Counterweight

NO	no counterweight	+\$0
CB	counterweight	+\$70

Step 15. Lock

KA	keyed alike	+\$0
KC	keyed differently, chrome	+\$0
KD	keyed differently	+\$0

Credenza - Catch Flex

L2CD.

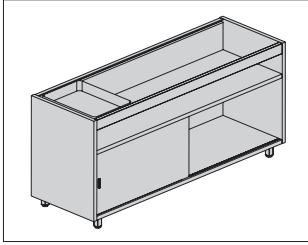

Product Information

Description

This credenza provides open storage with a sliding translucent acrylic door and sliding tray. It has an all-laminate case, 2"-high foot or casters, and 1" leveling glides.

Actual credenza depth is 13½" (13) or 16½" (16).

Actual credenza width is 35⅞" (36) or 47¾" (48).

Actual credenza height is 22".

Dimensions

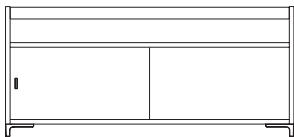
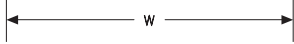

C-foot

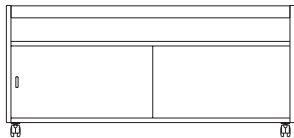
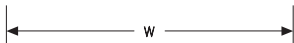
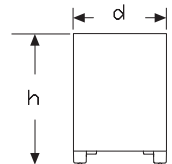

Mobile

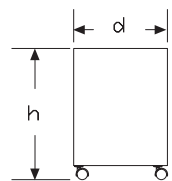

Specification Information

Step 1.

L2CD.CF A

Step 2. Width

36	36" wide	+ \$1422
48	48" wide	+ \$1616

Step 3. Depth

For 36" wide (36)

13	13½" deep	+ \$0
16	16½" deep	+ \$75

For 48" wide (48)

16	16½" deep	+ \$75
-----------	-----------	--------

Step 4. Base/Foot Height

7	mobile	+ \$20
9	c-foot	+ \$130

Step 5. Configuration

For 36" wide (36)

AN	18" slide left open right	+ \$0
-----------	---------------------------	-------

For 48" wide (48)

AA	24" slide left open right	+ \$0
-----------	---------------------------	-------

Step 6. Pull Type

L	mini bar pull	+ \$0
----------	---------------	-------

Step 7. Case Material

L	laminate	+ \$0
----------	----------	-------

Step 8. Front Material

T	acrylic	+ \$0
----------	---------	-------

Credenza - Catch Flex *continued*

Tu® Wood Storage

Step 9. Case Finish		
LBM	crisp linen	+\$0
LBN	classic linen	+\$0
LBP	casual linen	+\$0
LBK	pewter mesh	+\$0
LBL	steel mesh	+\$0
8Q	folkstone grey	+\$0
91	white	+\$0
98	studio white	+\$0
CL	cool grey neutral	+\$0
LU	soft white	+\$0
WL	sandstone	+\$0
WN	warm grey neutral	+\$0
LBF	neutral twill	+\$0
LBG	sarum twill	+\$0
LBH	earthen twill	+\$0
LBJ	graphite twill	+\$0
LBQ	white twill	+\$0
76	light brown walnut	+\$0
HM	natural maple	+\$0
HP	light anigre	+\$0
HX	aged cherry	+\$0
HY	walnut on cherry	+\$0
LBA	clear on ash	+\$0
LBR	phantom ecru	+\$0
LBS	phantom cocoa	+\$0
LBU	medium matte walnut	+\$0
LBV	warm grey teak	+\$0
LBB	oak on ash	+\$0
LBC	walnut on ash	+\$0
LBD	dark brown walnut	+\$0
LBE	medium red walnut	+\$0

Step 10. Front Finish		
J9	opal frosted	+\$0

Step 11. Rail/Tray Finish		
8Q	folkstone grey	+\$0
91	white	+\$0
98	studio white	+\$0
G1	graphite	+\$0
WL	sandstone	+\$0
CN	metallic champagne	+\$10
MS	metallic silver	+\$10

Step 12. Pull Finish		
8Q	folkstone grey	+\$0
91	white	+\$0
AN	clear anodized aluminum	+\$0
CN	metallic champagne	+\$5
G1	graphite	+\$0
WL	sandstone	+\$0

Step 13. Foot Finish		
<i>For c-foot (9)</i>		
8Q	folkstone grey	+\$0
91	white	+\$0
98	studio white	+\$0
G1	graphite	+\$0
WL	sandstone	+\$0
CN	metallic champagne	+\$10
MS	metallic silver	+\$10

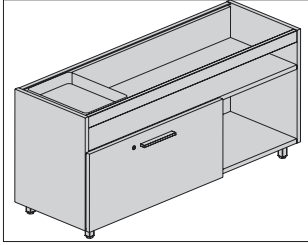

Product Information

Description

This credenza provides open storage with drawer and has an open top with sliding tray. It has an all-laminate case and front, 2"-high recessed base or 2"-high foot or base with fronts to floor, and 1" leveling glides.

Actual credenza depth is 16¹/₂" (16).

Actual credenza width is 35⁷/₈" (36) or 47³/₄" (48).

Actual credenza height is 22".

File drawers have full-extension slides and accommodate side-to-side letter filing. Specify optional file converter for front-to-back filing of letter or legal hanging files. Specify 2 file converters per drawer.

Dimensions

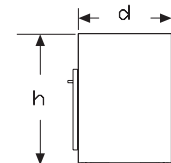
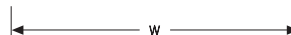

Base

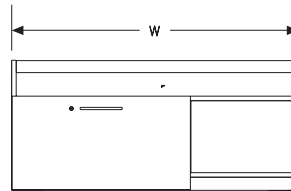

Base with fronts to floor

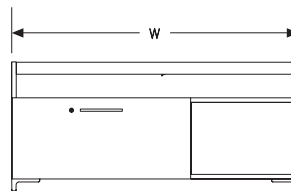
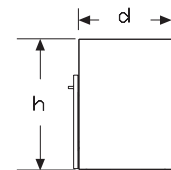

C-foot

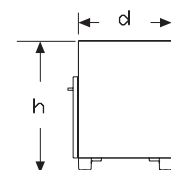

Specification Information		
Step 1.		
L2CD.CR <input type="checkbox"/> A		
Step 2. Width		
36	36" wide	+\$1488
48	48" wide	+\$1656
Step 3. Depth		
16	16½" deep <input type="checkbox"/> A	+\$0
Step 4. Configuration		
<i>For 36" wide (36)</i>		
BN	18" wide drawer left open right	+\$50
BP	18" wide drawer right open left	+\$50
<i>For 48" wide (48)</i>		
BN	18" wide drawer left open right	+\$0
BP	18" wide drawer right open left	+\$0
BG	24" wide drawer left open right	+\$75
BH	24" wide drawer right open left	+\$75
BC	30" wide drawer left open right	+\$100
BD	30" wide drawer right open left	+\$100
Step 5. Base/Foot Height		
1	base	+\$0
3	base with fronts to floor	+\$10
9	c-foot	+\$130
Step 6. Case/Front Material		
L	laminate	+\$0
Step 7. Pull Type		
A	arc pull	+\$0
K	bar pull	+\$0
U	flush pull	+\$0
Step 8. Drawer Material		
M	metal	+\$0

Step 9. Case/Front Finish		
LBM	crisp linen	+\$0
LBN	classic linen	+\$0
LBP	casual linen	+\$0
LBK	pewter mesh	+\$0
LBL	steel mesh	+\$0
8Q	folkstone grey	+\$0
91	white	+\$0
98	studio white	+\$0
CL	cool grey neutral	+\$0
LU	soft white	+\$0
WL	sandstone	+\$0
WN	warm grey neutral	+\$0
LBF	neutral twill	+\$0
LBG	sarum twill	+\$0
LBH	earthen twill	+\$0
LBJ	graphite twill	+\$0
LBQ	white twill	+\$0
76	light brown walnut	+\$0
HM	natural maple	+\$0
HP	light anigre	+\$0
HX	aged cherry	+\$0
HY	walnut on cherry	+\$0
LBA	clear on ash	+\$0
LBR	phantom ecru	+\$0
LBS	phantom cocoa	+\$0
LBU	medium matte walnut	+\$0
LBV	warm grey teak	+\$0
LBB	oak on ash	+\$0
LBC	walnut on ash	+\$0
LBD	dark brown walnut	+\$0
LBE	medium red walnut	+\$0
Step 10. Rail/Tray Finish		
8Q	folkstone grey	+\$0
91	white	+\$0
98	studio white	+\$0
G1	graphite	+\$0
WL	sandstone	+\$0
CN	metallic champagne	+\$10
MS	metallic silver	+\$10
Step 11. Pull Finish		
<i>For arc pull (A)</i>		
NH	brushed nickel	+\$0
NK	black nickel	+\$0

Credenza - Catch Resident *continued*

For bar pull (K) or flush pull (U)

8Q	folkstone grey	+\$0
91	white	+\$0
98	studio white	+\$0
G1	graphite	+\$0
WL	sandstone	+\$0
CN	metallic champagne	+\$5
MS	metallic silver	+\$5
79	green apple <input type="checkbox"/> A	+\$15
MY3	yellow oxide <input type="checkbox"/> A	+\$15
RO	red <input type="checkbox"/> A	+\$15
TRQ	turquoise <input type="checkbox"/> A	+\$15

Step 12. Foot Finish

For c-foot (g)

8Q	folkstone grey	+\$0
91	white	+\$0
98	studio white	+\$0
G1	graphite	+\$0
WL	sandstone	+\$0
CN	metallic champagne	+\$10
MS	metallic silver	+\$10

Step 13. Lock

KA	keyed alike	+\$0
KC	keyed differently, chrome <input type="checkbox"/> A	+\$0
KD	keyed differently <input type="checkbox"/> A	+\$0

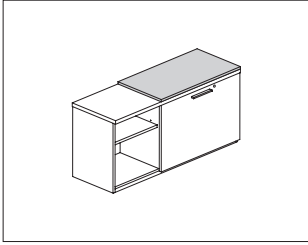

Product Information

Description
 This 1" cushion top attaches to the top of a Tu Wood credenza to provide temporary guest seating. Attachment hardware included.

Notes

Match cushion depth to credenza depth.
 When using 2 12½" deep credenzas back-to-back, specify 1 25" deep cushion.
 When using 2 16½" deep credenzas back-to-back, specify 1 33" deep cushion.
 See planning guide for additional applications.
 Cushion top accepts Customer's Own Material (COM). Yardage is estimated for nondirectional 54"-wide fabrics.

Depth—Yardage

12—0.61
16—0.72
25—0.97
33—1.23

For information on multiple quantities or directional fabrics, contact COM Department. See Order Information in Appendices.

Dimensions

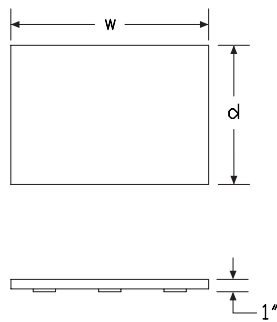

Specification Information

Step 1.
LSC.CD

Step 2. Height
1 1" high

Step 3. Depth
12 12.5" deep
16 16.5" deep
25 25" deep
33 33" deep

Step 4. Width
18 18" wide
24 24" wide
30 30" wide
36 36" wide

Prices for Steps 1-4.

		18	24	30	36
LSC.CD	1 12	\$172	183	225	235
	16	\$192	233	245	265
	25	\$221	299	332	341
	33	\$254	342	366	400

Step 5. Cushion Top Fabric

See application chart and textiles list for fabric usage and numbers.
 First 2 digits of number indicate fabric line; remaining digit(s) indicate fabric color.

Price Category 1	+\$0
Price Category 2	+\$102
Price Category 3	+\$123
Price Category 4	+\$151
Price Category 5	+\$169
Price Category 7	+\$206
Price Category 9	+\$1425
Price Category B	+\$71
Price Category C	+\$98
Price Category E	+\$150
Price Category F	+\$193
Price Category G	+\$251
Price Category H	+\$305
Price Category I	+\$359
Price Category J	+\$413
Price Category K	+\$310

File Rail

L29P.

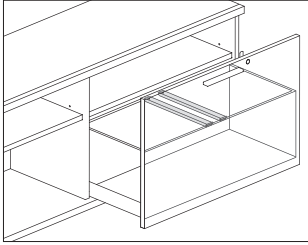

Product Information

Description

This file rail provides the capability to file front-to-back in a file/file extended width pedestal or credenza file drawer. Finish is black. Rails are individually packaged.

Notes

Specify 1 rail for each row of front-to-back files to be supported.

Dimensions

Specification Information

Step 1.

L29P. A

Step 2. Depth

15 front to back file rail A

Prices for Steps 1-2.

L29P. 15 \$10

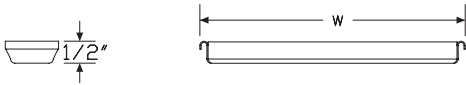

Side-To-Side Filing Rail, Credenza L2902.
Drawer

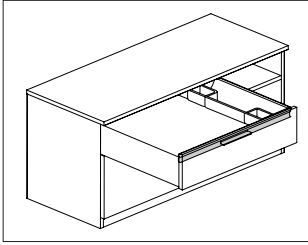

Tu® Wood Storage

Product Information

Description

This rail will hold a utility tray when installed in a laminate credenza metal box drawer. Package contains 1 rail.

Notes

Specify 1 rail per each credenza box drawer.

This rail can be used in box drawer of a laminate credenza, open with box/file (L2CD.BF) to suspend a utility tray front to back of drawer.

Order utility tray (L2UT.) separately.

Dimensions

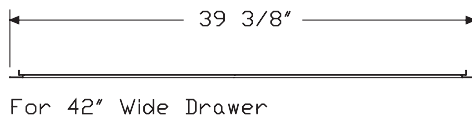
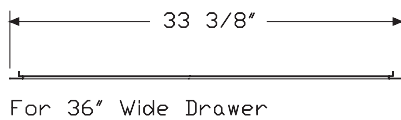
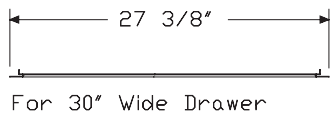
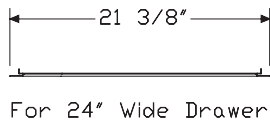
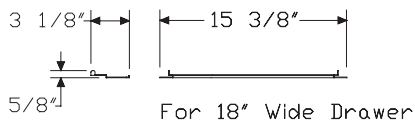

Specification Information

Step 1.

L2902. A

Step 2. Width

- 18** for 18"-wide credenza box drawer A
- 24** for 24"-wide credenza box drawer A
- 30** for 30"-wide credenza box drawer A
- 36** for 36"-wide credenza box drawer A
- 42** for 42"-wide credenza box drawer A

Prices for Steps 1-2.

L2902. 18	\$18
24	\$20
30	\$23
36	\$26
42	\$30

Utility Tray Pedestal

L2UT.

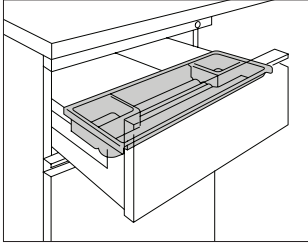

Product Information

Description

This plastic tray provides storage for pencils and other small items in a pedestal or credenza box drawer. It hangs side-to-side on pedestal drawer and front-to-back on credenza drawer. Finish is black umber.

Notes

To install tray front-to-back in the box drawer of credenza, order side-to-side filing rail (L2902.) separately.

Dimensions

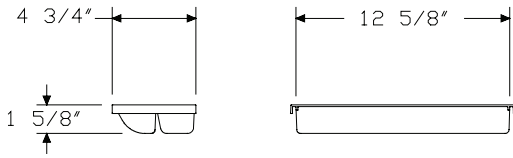

Specification Information

Step 1.

L2UT. A

Step 2. Drawer

906 15" metal drawer A

Prices for Steps 1-2.

L2UT. 906 \$24

Storage Tower

L2T.

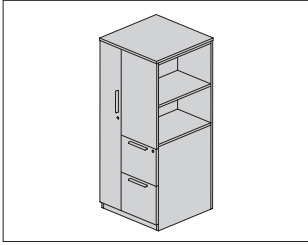

Tu® Wood Storage

Product Information

Description

This freestanding storage tower has a wardrobe on 1 side and a side-facing bookcase on the other side. Pedestal is located opposite of wardrobe. The tower is available in 5 heights, 2 widths, and 2 depths, and comes with or without top. The tower has a laminate or veneer case, applied metal pulls, a 2"-high recessed base, base with front to floor, or 2"-high foot with 1" leveling glides.

Actual tower widths are 23⁷/₈" (24) and 29⁷/₈" (30).

Actual tower depths are 23¹/₄" (24) and 29¹/₄" (30).

Side-facing bookcase is 14¹/₂" deep and 23¹/₄" wide. It includes adjustable shelves that adjust in 1" increments.

Pedestal is locking, with 1 lock securing all drawers. Drawers are available in a variety of box and file drawer combinations.

Notes

For use with Layout Studio® or Canvas Office Landscape®, specify 1¹/₈" thick top (o8) or 1¹/₄" thick top (o6).

Dimensional illustration does not include all possible configurations.

For keyed-alike locks, order lock plugs separately. See Keyed-Alike Information in appendices.

Dimensions

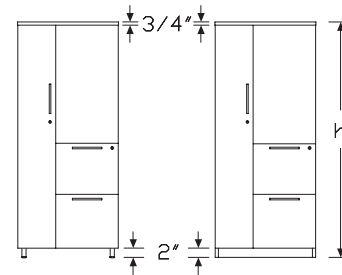
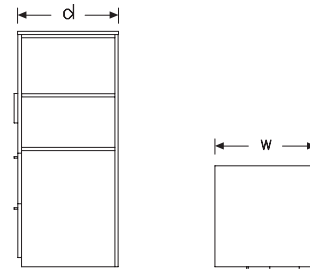

Foot Base

File/File, Wardrobe Left



C-Foot Base with Front to Floor

File/File, Wardrobe Right

Storage Tower *continued*

Specification Information

Step 1.

L2T.S A

Step 2. Height

42	42" high	+\$2411
46	46" high	+\$2450
53	53" high A	+\$2492
57	57" high	+\$2534
68	68" high	+\$2617

Step 3. Width

24	24" wide	+\$0
30	30" wide	+\$100

Step 4. Depth

24	24" deep	+\$0
30	30" deep	+\$100

Step 5. Base/Foot Height

1	base	+\$0
3	base with fronts to floor A	+\$15
5	foot	+\$100
9	c-foot	+\$130

Step 6. Configuration

BL	file/file, wardrobe left	+\$0
BR	file/file left, wardrobe right	+\$0
CL	box/box/file, wardrobe left	+\$125
CR	box/box/file, wardrobe right	+\$125

Step 7. Case/Front Material

For 42" high (42) or 46" high (46)

L	laminate	+\$0
----------	----------	------

For 53" high (53) or 57" high (57)

L	laminate	+\$0
----------	----------	------

For 68" high (68)

L	laminate	+\$0
----------	----------	------

Step 8. Top Material

NT	no top	-\$20
02	3/4" low-pressure laminate with thermoplastic edge	+\$0
08	1 1/8" high-pressure laminate with thermoplastic edge	+\$75
06	1 1/4" high-pressure laminate with thermoplastic edge	+\$75

Step 9. Pull Type

A	arc pull	+\$0
K	bar pull	+\$0
U	flush pull	+\$0

Step 10. Interior Drawer Material

M	metal	+\$0
----------	-------	------

Step 11. Case/Front Finish

Solid-Color Laminate

8Q	folkstone grey	+\$0
91	white	+\$0
98	studio white	+\$0
CL	cool grey neutral	+\$0
LU	soft white	+\$0
WL	sandstone	+\$0
WN	warm grey neutral	+\$0

Linen Laminate

LBM	crisp linen	+\$0
LBN	classic linen	+\$0
LBP	casual linen	+\$0

Mesh Laminate

LBK	pewter mesh	+\$0
LBL	steel mesh	+\$0

Twill Laminate

LBF	neutral twill	+\$0
LBG	sarum twill	+\$0
LBH	earthen twill	+\$0
LBJ	graphite twill	+\$0
LBQ	white twill	+\$0

Wood-Grain Laminate		
76	light brown walnut	+\$0
HM	natural maple	+\$0
HP	light anigre	+\$0
HX	aged cherry	+\$0
HY	walnut on cherry	+\$0
LBA	clear on ash	+\$0
LBR	phantom ecru	+\$0
LBS	phantom cocoa	+\$0
LBU	medium matte walnut	+\$0
LBV	warm grey teak	+\$0
LBB	oak on ash	+\$0
LBC	walnut on ash	+\$0
LBD	dark brown walnut	+\$0
LBE	medium red walnut	+\$0

Step 12. Top/Edge Finish

For 3/4" low-pressure laminate with thermoplastic edge (o2), 1/8" high-pressure laminate with thermoplastic edge (o8), or 1/4" high-pressure laminate with thermoplastic edge (o6)

Solid-Color Laminate		
8Q	folkstone grey	+\$0
91	white	+\$0
98	studio white	+\$0
CL	cool grey neutral	+\$0
LU	soft white	+\$0
WL	sandstone	+\$0
WN	warm grey neutral	+\$0

Linen Laminate		
LBM	crisp linen	+\$0
LBN	classic linen	+\$0
LBP	casual linen	+\$0

Mesh Laminate		
LBK	pewter mesh	+\$0
LBL	steel mesh	+\$0

Twill Laminate		
LBF	neutral twill	+\$0
LBG	sarum twill	+\$0
LBH	earthen twill	+\$0
LBJ	graphite twill	+\$0
LBQ	white twill	+\$0

Wood-Grain Laminate		
76	light brown walnut	+\$0
HM	natural maple	+\$0
HP	light anigre	+\$0
HX	aged cherry	+\$0
HY	walnut on cherry	+\$0
LBA	clear on ash	+\$0
LBR	phantom ecru	+\$0
LBS	phantom cocoa	+\$0
LBU	medium matte walnut	+\$0
LBV	warm grey teak	+\$0
LBB	oak on ash	+\$0
LBC	walnut on ash	+\$0
LBD	dark brown walnut	+\$0
LBE	medium red walnut	+\$0

Step 13. Pull Finish

For arc pull (A)

NH	brushed nickel	+\$0
NK	black nickel	+\$0

For bar pull (K) or flush pull (U)

79	green apple	+\$15
98	studio white A	+\$0
MS	metallic silver	+\$5
MY3	yellow oxide	+\$15
RO	red	+\$15
TRQ	turquoise	+\$15

Step 14. Foot Finish

For foot (5) or c-foot (9)

8Q	folkstone grey A	+\$0
91	white	+\$0
98	studio white A	+\$0
CL	cool grey neutral	+\$0
CN	metallic champagne	+\$10
EH	metallic bronze	+\$10
G1	graphite	+\$0
MS	metallic silver	+\$10
WL	sandstone A	+\$0
WN	warm grey neutral	+\$0

Step 15. Lock Option

KA	keyed alike	+\$0
KC	keyed differently, chrome	+\$0
KD	keyed differently, black	+\$0

Bookcase Tower

L2BT.

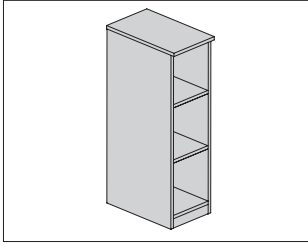

Product Information

Description

This bookcase tower has a laminate case with laminate top or veneer case with veneer top available in 3 thicknesses, or with no top. It comes in 4 heights, 2 widths, and 2 depths. Base options are 2"-high base, base with front to floor, or 2"-high feet with 1" leveling glides. Interior has adjustable shelves that will vary based on case height. Shelves adjust in 1/4" increments. Available with or without door. Doors come standard with lock.

Notes

Actual widths are 11 7/8" (12) and 14 7/8" (15).

For use with Layout Studio® or Canvas Office Landscape®, specify 1 1/8" thick top (08) or 1 1/4" thick top (06).

12" wide towers 57" high require the cases to be ganged or secured for stability.

Dimensions

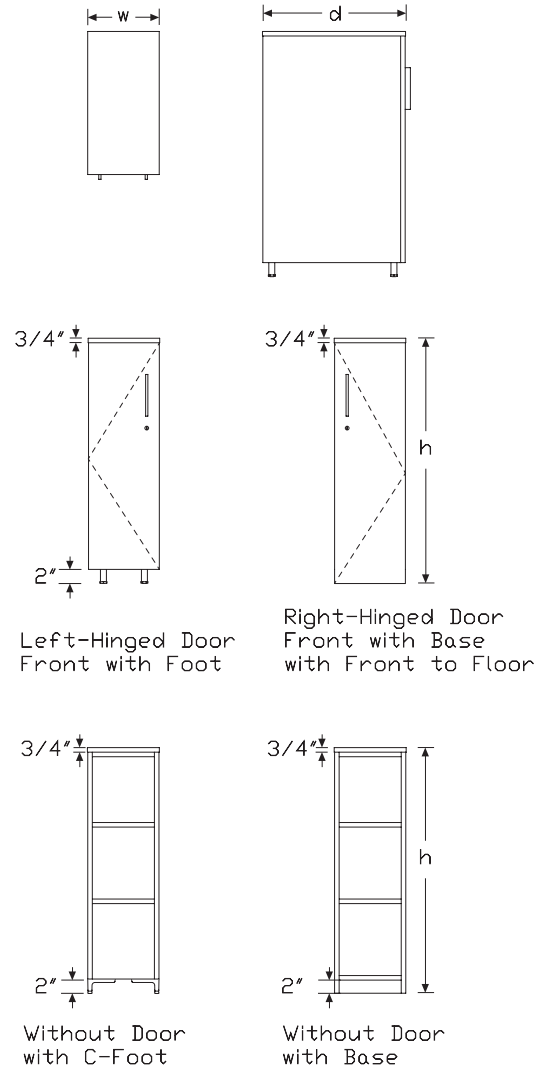

Specification Information		
Step 1.		
L2BT.	<input type="checkbox"/>	
Step 2. Height		
42	42" high	+\$861
46	46" high	+\$961
57	57" high	+\$1061
Step 3. Width		
12	12" wide	+\$0
15	15" wide	+\$65
Step 4. Depth		
24	24" deep	+\$0
30	30" deep	+\$100
Step 5. Base/Foot Height		
1	2" high base	+\$0
3	base with fronts to floor	+\$10
5	2" high foot	+\$100
9	c-foot	+\$130
Step 6. Case Material		
<i>For 42" high (42) or 46" high (46)</i>		
L	laminate	+\$0
<i>For 57" high (57)</i>		
L	laminate	+\$0
Step 7. Top Material		
NT	no top	-\$20
02	3/4" laminate	+\$0
08	1 1/8" laminate	+\$50
06	1 1/4" laminate	+\$50
Step 8. Configuration		
<i>For 2" high base (1), 2" high foot (5), or c-foot (9) with laminate (L)</i>		
SN	shelves, no door	+\$0
SL	shelves, left-hinged door	+\$175
SR	shelves, right-hinged door	+\$175
<i>For base with fronts to floor (3) with laminate (L)</i>		
SL	shelves, left-hinged door	+\$175
SR	shelves, right-hinged door	+\$175

Step 9. Pull Type		
<i>For shelves, left-hinged door (SL) or shelves, right-hinged door (SR)</i>		
A	arc pull	+\$0
K	bar pull	+\$0
U	flush pull	+\$0
Step 10. Case/Front Finish		
LBM	crisp linen <input type="checkbox"/>	+\$0
LBN	classic linen <input type="checkbox"/>	+\$0
LBP	casual linen <input type="checkbox"/>	+\$0
LBK	pewter mesh <input type="checkbox"/>	+\$0
LBL	steel mesh <input type="checkbox"/>	+\$0
8Q	folkstone grey <input type="checkbox"/>	+\$0
91	white <input type="checkbox"/>	+\$0
98	studio white <input type="checkbox"/>	+\$0
CL	cool grey neutral <input type="checkbox"/>	+\$0
LU	soft white <input type="checkbox"/>	+\$0
WL	sandstone <input type="checkbox"/>	+\$0
WN	warm grey neutral <input type="checkbox"/>	+\$0
LBF	neutral twill <input type="checkbox"/>	+\$0
LBG	sarum twill <input type="checkbox"/>	+\$0
LBH	earthen twill <input type="checkbox"/>	+\$0
LBJ	graphite twill <input type="checkbox"/>	+\$0
LBQ	white twill <input type="checkbox"/>	+\$0
76	light brown walnut <input type="checkbox"/>	+\$0
HM	natural maple <input type="checkbox"/>	+\$0
HP	light anigre <input type="checkbox"/>	+\$0
HX	aged cherry <input type="checkbox"/>	+\$0
HY	walnut on cherry <input type="checkbox"/>	+\$0
LBA	clear on ash <input type="checkbox"/>	+\$0
LBB	oak on ash <input type="checkbox"/>	+\$0
LBC	walnut on ash <input type="checkbox"/>	+\$0
LBD	dark brown walnut <input type="checkbox"/>	+\$0
LBE	medium red walnut <input type="checkbox"/>	+\$0
LBR	phantom ecru <input type="checkbox"/>	+\$0
LBS	phantom cocoa <input type="checkbox"/>	+\$0
LBU	medium matte walnut <input type="checkbox"/>	+\$0
LBV	warm grey teak <input type="checkbox"/>	+\$0

Bookcase Tower *continued*

Step 11. Top/Edge Finish For 3/4" laminate (o2), 1 1/8" laminate (o8), or 1 1/4" laminate (o6)

Solid-Color Laminate		
8Q	folkstone grey	+\$0
91	white	+\$0
98	studio white	+\$0
CL	cool grey neutral	+\$0
LU	soft white	+\$0
WL	sandstone	+\$0
WN	warm grey neutral	+\$0
Linen Laminate		
LBM	crisp linen	+\$0
LBN	classic linen	+\$0
LBP	casual linen	+\$0
Mesh Laminate		
LBK	pewter mesh	+\$0
LBL	steel mesh	+\$0
Twill Laminate		
LBF	neutral twill	+\$0
LBG	sarum twill	+\$0
LBH	earthen twill	+\$0
LBJ	graphite twill	+\$0
LBQ	white twill	+\$0
Wood-Grain Laminate		
76	light brown walnut	+\$0
HM	natural maple	+\$0
HP	light anigre	+\$0
HX	aged cherry	+\$0
HY	walnut on cherry	+\$0
LBA	clear on ash	+\$0
LBR	phantom ecru	+\$0
LBS	phantom cocoa	+\$0
LBU	medium matte walnut	+\$0
LBV	warm grey teak	+\$0
LBB	oak on ash	+\$0
LBC	walnut on ash	+\$0
LBD	dark brown walnut	+\$0
LBE	medium red walnut	+\$0

Step 12. Pull Finish

For arc pull (A)		
NH	brushed nickel	+\$0
NK	black nickel	+\$0
For bar pull (K) or flush pull (U)		
8Q	folkstone grey A	+\$0
91	white A	+\$0
98	studio white A	+\$0
G1	graphite A	+\$0
WL	sandstone A	+\$0
CN	metallic champagne A	+\$5
MS	metallic silver	+\$5
79	green apple	+\$15
MY3	yellow oxide	+\$15
RO	red	+\$15
TRQ	turquoise	+\$15

Step 13. Foot Finish For 2" high foot (5) or c-foot (9)

8Q	folkstone grey A	+\$0
91	white	+\$0
98	studio white A	+\$0
CL	cool grey neutral	+\$0
CN	metallic champagne	+\$10
EH	metallic bronze	+\$10
G1	graphite	+\$0
MS	metallic silver A	+\$10
WL	sandstone A	+\$0
WN	warm grey neutral	+\$0

Step 14. Lock For shelves, left-hinged door (SL) or shelves, right-hinged door (SR)

KA	keyed alike	+\$0
KD	keyed differently, black	+\$0
KC	keyed differently, chrome	+\$0

Wardrobe Tower

L2WT.

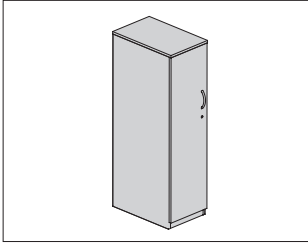

Tu® Wood Storage

Product Information

Description

This wardrobe tower has a laminate case and front or veneer case and front with laminate or veneer top available in 3 thicknesses. Wardrobe comes in 4 heights, 2 widths, and 3 depths. Base options are 2"-high base, base with front to floor, or 2"-high foot with 1" leveling glides. Interior has a coat hook and 1 shelf. Door is single width and locking.

Notes

For use with Layout Studio® or Canvas Office Landscape®, specify 1 1/8" thick top (08) or 1 1/4" thick top (06).

12" wide towers 57" high require the cases to be ganged or secured for stability.

Dimensions

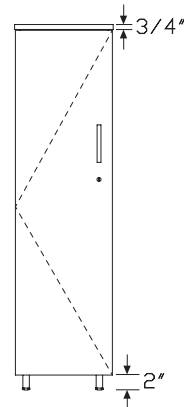
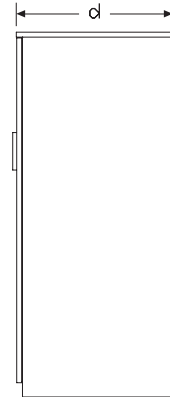

Left-Hinged
Door Front
with Foot

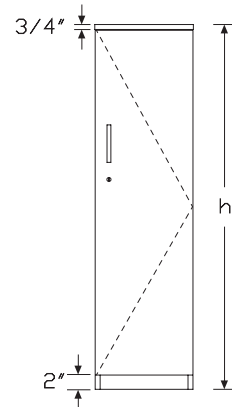

Right-Hinged
Door Front
with Base

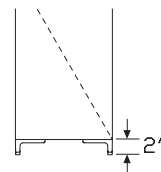

Left-Hinged
Door Front
with C-Foot

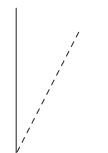

Right-Hinged
Door Front
With Base with
Front to Floor

Specification Information		
Step 1.		
L2WT.	<input type="checkbox"/> A	
Step 2. Height		
42	42" high	+\$931
46	46" high	+\$1031
53	53" high <input type="checkbox"/> A	+\$1068
57	57" high	+\$1131
Step 3. Width		
12	12" wide	+\$0
15	15" wide	+\$65
Step 4. Depth		
20	20" deep	+\$0
24	24" deep	+\$75
30	30" deep	+\$150
Step 5. Base/Foot Height		
1	base	+\$0
3	base with fronts to floor <input type="checkbox"/> A	+\$10
5	foot	+\$100
9	c-foot	+\$130
Step 6. Case Material		
<i>For 42" high (42) or 46" high (46)</i>		
L	laminate	+\$0
<i>For 53" high (53) or 57" high (57)</i>		
L	laminate	+\$0
Step 7. Top Material		
NT	no top	-\$20
02	3/4" laminate	+\$0
08	1 1/8" laminate	+\$50
06	1 1/4" laminate	+\$50
Step 8. Hinge Location		
L	left-hinged door	+\$0
R	right-hinged door	+\$0
Step 9. Pull Type		
A	arc pull	+\$0
K	bar pull	+\$0
U	flush pull	+\$0

Step 10. Case/Front/Top Finish		
Solid-Color Laminate		
8Q	folkstone grey	+\$0
91	white	+\$0
98	studio white	+\$0
CL	cool grey neutral	+\$0
LU	soft white	+\$0
WL	sandstone	+\$0
WN	warm grey neutral	+\$0
Linen Laminate		
LBM	crisp linen	+\$0
LBN	classic linen	+\$0
LBP	casual linen	+\$0
Mesh Laminate		
LBK	pewter mesh	+\$0
LBL	steel mesh	+\$0
Twill Laminate		
LBF	neutral twill	+\$0
LBG	sarum twill	+\$0
LBH	earthen twill	+\$0
LBJ	graphite twill	+\$0
LBQ	white twill	+\$0
76	light brown walnut	+\$0
HM	natural maple	+\$0
HP	light anigre	+\$0
HX	aged cherry	+\$0
HY	walnut on cherry	+\$0
LBA	clear on ash	+\$0
LBR	phantom ecru	+\$0
LBS	phantom cocoa	+\$0
LBU	medium matte walnut	+\$0
LBV	warm grey teak	+\$0
LBW	oak on ash	+\$0
LBC	walnut on ash	+\$0
LBD	dark brown walnut	+\$0
LBE	medium red walnut	+\$0
Step 11. Pull Finish		
<i>For arc pull (A)</i>		
NH	brushed nickel	+\$0
NK	black nickel	+\$0

Wardrobe Tower *continued*

Tu® Wood Storage

For bar pull (K) or flush pull (U)

98	studio white <input type="checkbox"/> A	+\$0
MS	metallic silver	+\$5
79	green apple	+\$15
MY3	yellow oxide	+\$15
RO	red	+\$15
TRQ	turquoise	+\$15

Step 12. Foot Finish

For foot (5) or c-foot (9)

8Q	folkstone grey <input type="checkbox"/> A	+\$0
91	white	+\$0
98	studio white <input type="checkbox"/> A	+\$0
CL	cool grey neutral	+\$0
CN	metallic champagne	+\$10
EH	metallic bronze	+\$10
G1	graphite	+\$0
MS	metallic silver	+\$10
WL	sandstone <input type="checkbox"/> A	+\$0
WN	warm grey neutral	+\$0

Step 13. Lock Option

KA	keyed alike	+\$0
KC	keyed differently, chrome	+\$0
KD	keyed differently, black	+\$0

Personal Tower - Tall

L2PT.

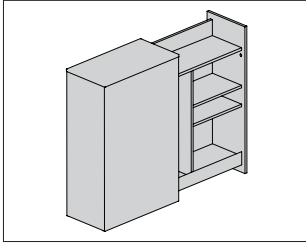

Product Information

Description

This personal storage tower has a single pull-out door that provides storage for a variety of personal and work related items.

Notes

Resident option (RS) has a laminate wardrobe, laminate fixed shelf, and 1 laminate adjustable shelf.

Flex option (FX) has a laminate wardrobe, laminate fixed shelf, and steel cascading dividers with integrated pencil cup and file bin.

USB cutout option (PW1) provides access for a dual port USB 2.0 Type A low-voltage power module that is field installed into factory-cut holes in the inner structure. The cord for USB power is routed via field installed clips through the inside of the case, down the back wall and out through a field drilled hole on the side of the case. Order USB module (LEE.) separately.

To use personal tower to support 1 end of a work surface, order Canvas attachment bracket (FV692) separately.

Dimensions

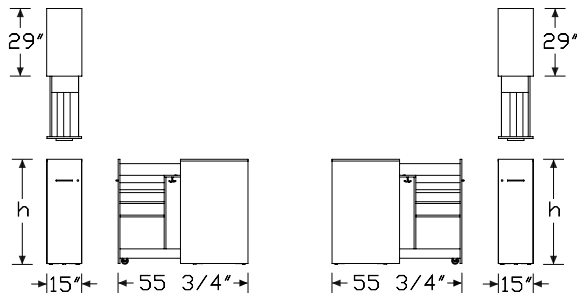

Flex Left

Flex Right

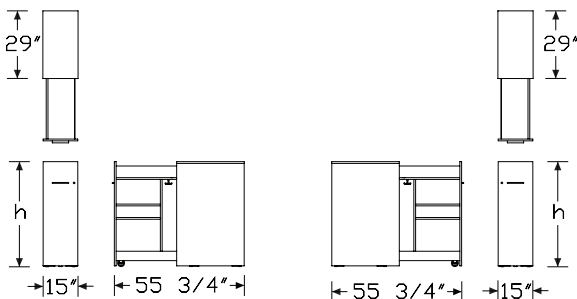

Resident Left

Resident Right

Specification Information

Step 1.

L2PT. A

Step 2. Height

42	42" high	+\$2291
46	46" high	+\$2376

Step 3. Depth

30	30" deep	+\$255
----	----------	--------

Step 4. Interior Configuration

RS	resident <input type="checkbox"/> A	+\$0
FX	flex <input type="checkbox"/> A	+\$179

Step 5. Open

L	left <input type="checkbox"/> A	+\$0
R	right <input type="checkbox"/> A	+\$0

Step 6. Case/Front Material

L	laminate	+\$0
---	----------	------

Step 7. Pull Type

A	arc pull	+\$0
K	bar pull	+\$0
U	flush pull	+\$0

Step 8. Case/Front Finish

Solid-Color Laminate

8Q	folkstone grey	+\$0
91	white	+\$0
98	studio white	+\$0
CL	cool grey neutral	+\$0
LU	soft white	+\$0
WL	sandstone	+\$0
WN	warm grey neutral	+\$0

Linen Laminate

LBM	crisp linen	+\$0
LBN	classic linen	+\$0
LBP	casual linen	+\$0

Mesh Laminate

LBK	pewter mesh	+\$0
LBL	steel mesh	+\$0

Twill Laminate		
LBF	neutral twill	+\$0
LBG	sarum twill	+\$0
LBH	earthen twill	+\$0
LBJ	graphite twill	+\$0
LBQ	white twill	+\$0

Wood-Grain Laminate		
76	light brown walnut	+\$0
HM	natural maple	+\$0
HP	light anigre	+\$0
HX	aged cherry	+\$0
HY	walnut on cherry	+\$0
LBA	clear on ash	+\$0
LBR	phantom ecru	+\$0
LBS	phantom cocoa	+\$0
LBU	medium matte walnut	+\$0
LBV	warm grey teak	+\$0
LBB	oak on ash	+\$0
LBC	walnut on ash	+\$0
LBD	dark brown walnut	+\$0
LBE	medium red walnut	+\$0

Step 9. Pull Finish

<i>For arc pull (A)</i>		
NH	brushed nickel	+\$0
NK	black nickel	+\$0

<i>For bar pull (K) or flush pull (U)</i>		
79	green apple	+\$15
8Q	folkstone grey <input type="checkbox"/> A	+\$0
91	white <input type="checkbox"/> A	+\$0
98	studio white <input type="checkbox"/> A	+\$0
CN	metallic champagne <input type="checkbox"/> A	+\$5
G1	graphite <input type="checkbox"/> A	+\$0
MS	metallic silver	+\$5
MY3	yellow oxide	+\$15
RO	red	+\$15
TRQ	turquoise	+\$15
WL	sandstone <input type="checkbox"/> A	+\$0

Step 10. Interior Finish		
8Q	folkstone grey <input type="checkbox"/> A	+\$0
91	white <input type="checkbox"/> A	+\$0
CL	cool grey neutral <input type="checkbox"/> A	+\$0
LU	soft white <input type="checkbox"/> A	+\$0
WL	sandstone <input type="checkbox"/> A	+\$0
WN	warm grey neutral <input type="checkbox"/> A	+\$0

Step 11. Power		
NNN	no cutout <input type="checkbox"/> A	+\$0
PW1	with USB cutout <input type="checkbox"/> A	+\$169

Step 12. Lock Option		
KA	keyed alike	+\$0
KC	keyed differently, chrome	+\$0
KD	keyed differently, black	+\$0

Personal Tower - Mini Storage/ Bag

L2PN.

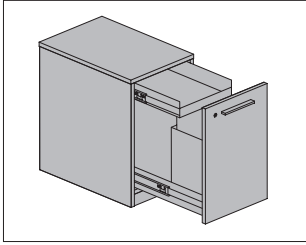

Product Information

Description

This personal tower-mini drawer is fully enclosed with single pull-out door and provides storage for a variety of personal and work related items. Standard interior has area for bag storage and for files. Optional personal drawer provides additional storage of smaller items and can be specified with USB power. The tower has an all-laminate case and front, 2"-high recessed base or 2"-high foot or base with fronts to floor, and 1" leveling glides. Counterweight included.

Actual height is 21 7/8" (22).

Actual width is 12 1/2".

Actual depth is 22 7/8" (24).

Notes

To provide USB power to the personal drawer, order USB module (LEE.200) separately.

Dimensions

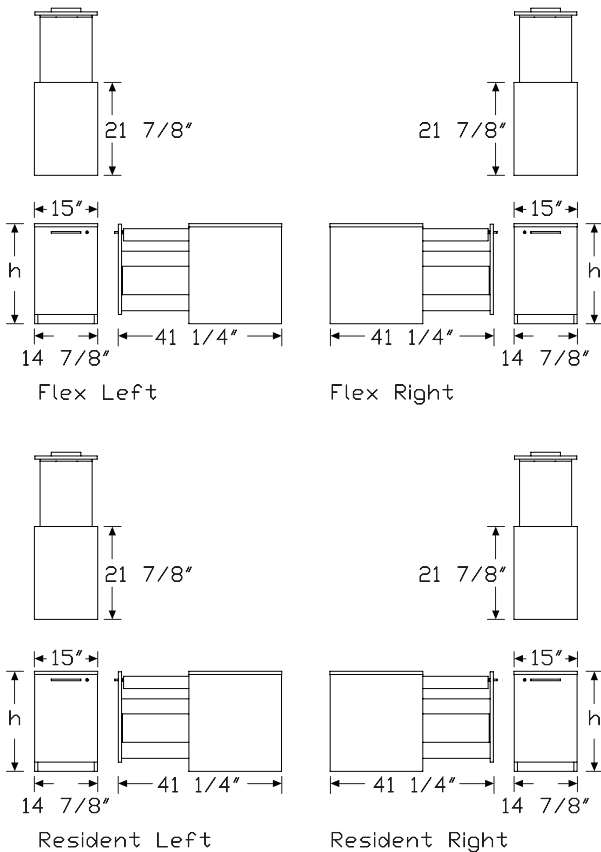

Specification Information

Step 1.

L2PN.

Step 2. Height

22 21 7/8" high +\$1079

Step 3. Depth

24 22 7/8" deep +\$75

Step 4. Configuration/Open

NL	no personal drawer open left	+\$0
NR	no personal drawer open right	+\$0
PL	personal drawer open left	+\$240
PR	personal drawer open right	+\$240

Step 5. Base/Foot Height

1	base	+\$0
3	base with fronts to floor	+\$10
7	casters	+\$30
9	c-foot	+\$130

Step 6. Case/Top/Front Material

L	laminate	+\$0
---	----------	------

Step 7. Pull Type

A	arc pull	+\$0
K	bar pull	+\$0
U	flush pull	+\$0

Step 8. Case/Front/Top Finish

Solid-Color Laminate

8Q	folkstone grey	+\$0
91	white	+\$0
CL	cool grey neutral	+\$0
LU	soft white	+\$0
WL	sandstone	+\$0
WN	warm grey neutral	+\$0

Twill Laminate

LBF	neutral twill	+\$0
LBG	sarum twill	+\$0
LBH	earthen twill	+\$0
LBJ	graphite twill	+\$0
LBQ	white twill	+\$0

Personal Tower - Mini Storage/ Bag *continued*

Tu® Wood Storage

Mesh Laminate

LBK	pewter mesh	+\$0
LBL	steel mesh	+\$0

Linen Laminate

LBM	crisp linen	+\$0
LBN	classic linen	+\$0
LBP	casual linen	+\$0

Wood-Grain Laminate

76	light brown walnut	+\$0
HM	natural maple	+\$0
HP	light anigre	+\$0
HX	aged cherry	+\$0
HY	walnut on cherry	+\$0
LBA	clear on ash	+\$0
LBR	phantom ecru	+\$0
LBS	phantom cocoa	+\$0
LBU	medium matte walnut	+\$0
LBV	warm grey teak	+\$0
LBB	oak on ash	+\$0
LBC	walnut on ash	+\$0
LBD	dark brown walnut	+\$0
LBE	medium red walnut	+\$0

Step 9. Pull Finish

Pull Finish

For arc pull (A)

NH	brushed nickel	+\$0
NK	black nickel	+\$0

Pull Finish

For bar pull (K) or flush pull (U)

8Q	folkstone grey	+\$0
91	white	+\$0
98	studio white	+\$0
G1	graphite	+\$0
WL	sandstone	+\$0
CN	metallic champagne	+\$5
MS	metallic silver	+\$5
79	green apple A	+\$15
MY3	yellow oxide A	+\$15
RO	red A	+\$15
TRQ	turquoise A	+\$15

Step 10. Foot Finish

For c-foot (g)

8Q	folkstone grey	+\$0
91	white	+\$0
98	studio white	+\$0
G1	graphite	+\$0
WL	sandstone	+\$0
CN	metallic champagne	+\$10
MS	metallic silver	+\$10

Step 11. Interior Finish

Finish

CN	metallic champagne	+\$10
G1	graphite	+\$0
MS	metallic silver	+\$10
8Q	folkstone grey	+\$0
91	white	+\$0
CL	cool grey neutral	+\$0
LU	soft white A	+\$0
WL	sandstone	+\$0
WN	warm grey neutral	+\$0

Step 12. Lock

KA	keyed alike	+\$0
KC	keyed differently, chrome	+\$0
KD	keyed differently, black	+\$0

Personal Tower-Mini Door

L2PD.

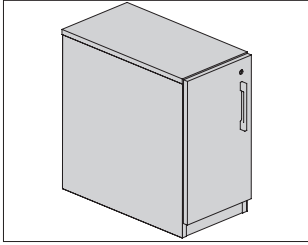

Product Information

Description

This personal tower-mini door is fully enclosed with single hinged door and provides storage for a variety of personal and work related items. Interior options include 1 removable shelf or no shelf. Door can be hinged left or right and comes with lock. The tower has an all-laminate case and front, 2"-high recessed base, base with front to floor, or 2"-high foot with 1" leveling glides.

Actual height is 21 7/8" (22).

Actual width is 12 1/2".

Actual depth is 22 7/8" (24).

Dimensions

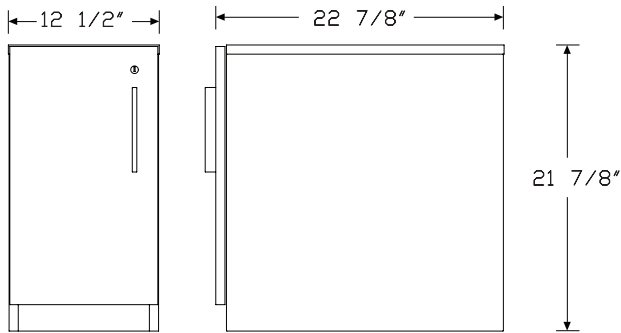

Base

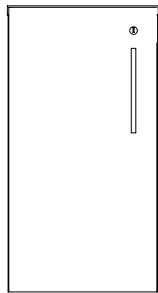

Base with fronts to floor

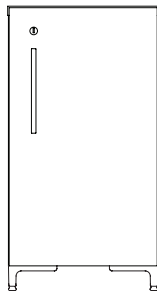

C-foot

Specification Information

Step 1.

L2PD.

Step 2. Height

22 21 7/8" high +\$783

Step 3. Width

13 12 1/2" wide +\$0

Step 4. Depth

24 22 7/8" deep +\$25

Step 5. Base/Foot Height

1 base +\$0
 3 base with fronts to floor [A] +\$10
 9 c-foot [A] +\$130

Step 6. Hinge Location

For base (1) or c-foot (9)

ND no door +\$0
 DL door hinged left +\$50
 DR door hinged right +\$50

For base with fronts to floor (3)

DL door hinged left +\$50
 DR door hinged right +\$50

Step 7. Case/Top/Front Material

L laminate +\$0

Step 8. Pull Type

For door hinged left (DL) or door hinged right (DR)

A arc pull +\$0
 K bar pull +\$0
 U integrated pull +\$0

Step 9. Interior

NS0 no interior -\$10
 NS1 one shelf +\$0

Step 10. Case/Front/Top Finish

LBM	crisp linen	+\$0
LBN	classic linen	+\$0
LBP	casual linen	+\$0
LBK	pewter mesh	+\$0
LBL	steel mesh	+\$0
8Q	folkstone grey	+\$0
91	white	+\$0
98	studio white	+\$0
CL	cool grey neutral	+\$0
LU	soft white	+\$0
WL	sandstone	+\$0
WN	warm grey neutral	+\$0
LBF	neutral twill	+\$0
LBG	sarum twill	+\$0
LBH	earthen twill	+\$0
LBJ	graphite twill	+\$0
LBQ	white twill	+\$0
76	light brown walnut	+\$0
HM	natural maple	+\$0
HP	light anigre	+\$0
HX	aged cherry	+\$0
HY	walnut on cherry	+\$0
LBA	clear on ash	+\$0
LBR	phantom ecru	+\$0
LBS	phantom cocoa	+\$0
LBU	medium matte walnut	+\$0
LBV	warm grey teak	+\$0
LBB	oak on ash	+\$0
LBC	walnut on ash	+\$0
LBD	dark brown walnut	+\$0
LBE	medium red walnut	+\$0

Step 11. Pull Finish

For arc pull (A)

NH	brushed nickel	+\$0
NK	black nickel	+\$0

For bar pull (K) or integrated pull (U)

8Q	folkstone grey	+\$0
91	white	+\$0
98	studio white	+\$0
CN	metallic champagne	+\$5
G1	graphite	+\$0
WL	sandstone	+\$0
79	green apple A	+\$15
MY3	yellow oxide A	+\$15
RO	red A	+\$15
TRQ	turquoise A	+\$15

Step 12. Foot Finish

For c-foot (g)

8Q	folkstone grey	+\$0
91	white	+\$0
98	studio white	+\$0
CN	metallic champagne	+\$10
G1	graphite	+\$0
MS	metallic silver	+\$10
WN	warm grey neutral	+\$0

Step 13. Lock

For door hinged left (DL) or door hinged right (DR)

KA	keyed alike	+\$0
KC	keyed differently, chrome	+\$0
KD	keyed differently, black	+\$0

USB Module for Personal Tower

LEE.

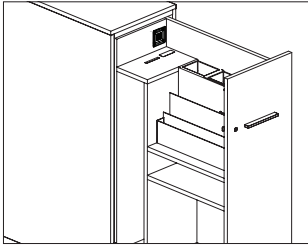

Product Information

Description

This dual port USB 2.0 Type A low-voltage power module is designed for field installation into the laminate personal tower or mini storage/bag tower. The personal tower requires access and routing holes to be cut in the field. Access and routing holes for the mini storage/bag tower are standard. The cord for USB power is routed via field installed clips through the inside of the case, down the back wall and out through a field drilled hole located on the side of the case for the personal tower and out of the bottom of the mini storage/bag tower.

Notes

Dual USB module-tower (100) is designed for field installation into the laminate personal tower (L2PT), ordered separately.

Dual USB module-drawer (200) is designed for field installation into the mini drawer within the mini storage/bag tower (L2PN).

Dimensions

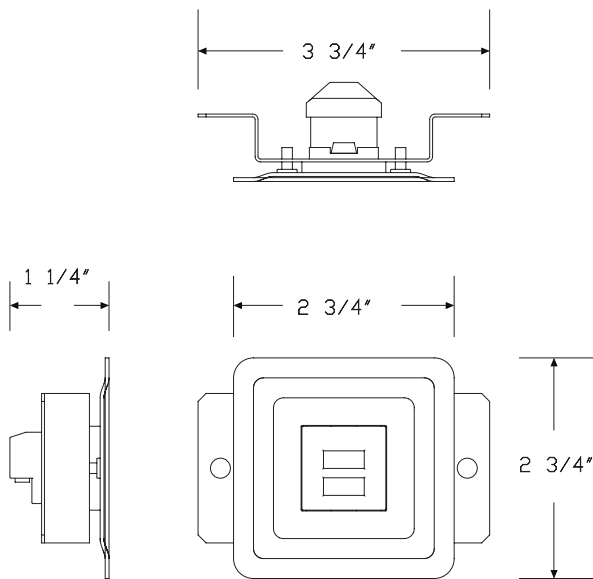

Specification Information

Step 1.

LEE.

Step 2. Configuration

200 dual USB module-drawer A

100 dual USB module-tower

Prices for Steps 1-2.

LEE.	200	\$289
	100	\$289

Step 3. Color

91	white	+ \$0
-----------	-------	-------

G2	graphite satin	+ \$0
-----------	----------------	-------

Wardrobe

L2WR.

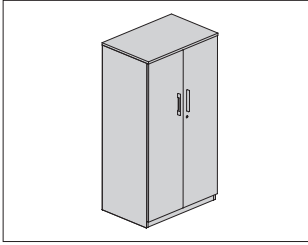

Tu® Wood Storage

Product Information

Description

This freestanding wardrobe cabinet is fully enclosed and has a laminate case, front and 3/4"-thick top. Wardrobe comes in 8 heights, 4 widths, and 2 depths. Base options are 2"-high base, base with front to floor, or 2"-high foot with 1" leveling glides. Interior has a coat rod and 1 shelf. Cabinet comes standard with double doors and lock.

Notes

Actual cabinet widths are 23⁷/₈" (24), 29⁷/₈" (30), 35⁷/₈" (36), or 41⁷/₈" (42).

For use with Layout Studio® or Canvas Office Landscape®, specify 1¹/₈" thick top (o8) or 1¹/₄" thick top (o6).

Dimensions

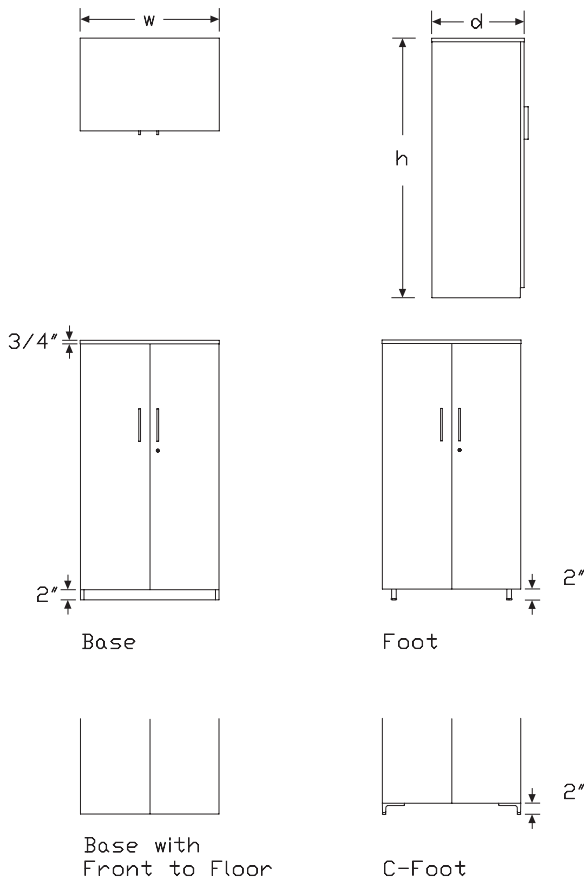

Specification Information

Step 1.

L2WR. [A]

Step 2. Height

42	42" high	+\$1180
46	46" high	+\$1245
53	53" high [A]	+\$1328
57	57" high	+\$1375
60	60" high	+\$1429
68	68" high	+\$1570
72	72" high	+\$1765
84	84" high	+\$1960

Step 3. Width

24	24" wide	+\$0
30	30" wide	+\$100
36	36" wide	+\$200
42	42" wide	+\$400

Step 4. Depth

20	20" deep	+\$100
24	24" deep	+\$200

Step 5. Base

1	base	+\$0
3	base with fronts to floor [A]	+\$10
5	foot	+\$100
9	c-foot	+\$130

Step 6. Case Material

For 42" high (42) or 46" high (46)

L	laminate	+\$0
----------	----------	------

For 53" high (53), 57" high (57), or 60" high (60)

L	laminate	+\$0
----------	----------	------

For 68" high (68) or 72" high (72)

L	laminate	+\$0
----------	----------	------

For 84" high (84)

L	laminate	+\$0
----------	----------	------

Step 7. Top Material		
NT	no top	-\$20
02	3/4" laminate	+\$0
08	1 1/8" laminate	+\$75
06	1 1/4" laminate	+\$75

Step 8. Pull Type		
A	arc pull	+\$0
K	bar pull	+\$0
U	flush pull	+\$0

Step 9. Case/Front Finish		
LBM	crisp linen	+\$0
LBN	classic linen	+\$0
LBP	casual linen	+\$0
LBK	pewter mesh	+\$0
LBL	steel mesh	+\$0
8Q	folkstone grey	+\$0
91	white	+\$0
98	studio white	+\$0
CL	cool grey neutral	+\$0
LU	soft white	+\$0
WL	sandstone	+\$0
WN	warm grey neutral	+\$0
LBF	neutral twill	+\$0
LBG	sarum twill	+\$0
LBH	earthen twill	+\$0
LBJ	graphite twill	+\$0
LBQ	white twill	+\$0
76	light brown walnut	+\$0
HM	natural maple	+\$0
HP	light anigre	+\$0
HX	aged cherry	+\$0
HY	walnut on cherry	+\$0
LBA	clear on ash	+\$0
LBB	oak on ash	+\$0
LBC	walnut on ash	+\$0
LBD	dark brown walnut	+\$0
LBE	medium red walnut	+\$0
LBR	phantom ecru	+\$0
LBS	phantom cocoa	+\$0
LBU	medium matte walnut	+\$0
LBV	warm grey teak	+\$0

Step 10. Top/Edge Finish		
<i>For 3/4" laminate (02), 1 1/8" laminate (08), or 1 1/4" laminate (06)</i>		
Solid-Color Laminate		
8Q	folkstone grey	+\$0
91	white	+\$0
98	studio white	+\$0
CL	cool grey neutral	+\$0
LU	soft white	+\$0
WL	sandstone	+\$0
WN	warm grey neutral	+\$0

Linen Laminate		
LBM	crisp linen	+\$0
LBN	classic linen	+\$0
LBP	casual linen	+\$0

Mesh Laminate		
LBK	pewter mesh	+\$0
LBL	steel mesh	+\$0

Twill Laminate		
LBF	neutral twill	+\$0
LBG	sarum twill	+\$0
LBH	earthen twill	+\$0
LBJ	graphite twill	+\$0
LBQ	white twill	+\$0

Wood-Grain Laminate		
76	light brown walnut	+\$0
HM	natural maple	+\$0
HP	light anigre	+\$0
HX	aged cherry	+\$0
HY	walnut on cherry	+\$0
LBA	clear on ash	+\$0
LBR	phantom ecru	+\$0
LBS	phantom cocoa	+\$0
LBU	medium matte walnut	+\$0
LBV	warm grey teak	+\$0
LBB	oak on ash	+\$0
LBC	walnut on ash	+\$0
LBD	dark brown walnut	+\$0
LBE	medium red walnut	+\$0

Step 11. Pull Finish

For arc pull (A)

NH	brushed nickel	+\$0
NK	black nickel	+\$0

For bar pull (K) or flush pull (U)

8Q	folkstone grey <input type="checkbox"/> A	+\$0
91	white <input type="checkbox"/> A	+\$0
98	studio white <input type="checkbox"/> A	+\$0
G1	graphite <input type="checkbox"/> A	+\$0
WL	sandstone <input type="checkbox"/> A	+\$0
CN	metallic champagne <input type="checkbox"/> A	+\$5
MS	metallic silver	+\$5
79	green apple <input type="checkbox"/> A	+\$15
MY3	yellow oxide	+\$15
RO	red <input type="checkbox"/> A	+\$15
TRQ	turquoise <input type="checkbox"/> A	+\$15

Step 12. Foot Finish

For foot (5) or c-foot (9)

8Q	folkstone grey <input type="checkbox"/> A	+\$0
91	white	+\$0
98	studio white <input type="checkbox"/> A	+\$0
CL	cool grey neutral	+\$0
CN	metallic champagne	+\$10
EH	metallic bronze	+\$0
G1	graphite	+\$0
MS	metallic silver	+\$10
WL	sandstone <input type="checkbox"/> A	+\$0
WN	warm grey neutral	+\$0

Step 13. Interior

CR	coat rod with fixed shelf	+\$0
-----------	---------------------------	------

Step 14. Lock

KA	keyed alike	+\$0
KD	keyed differently, black	+\$0
KC	keyed differently, chrome	+\$0

Bookcase (EOR)

L2ER.

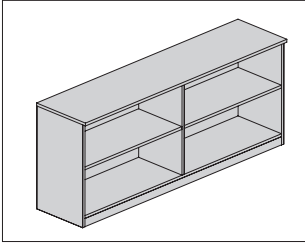

Product Information

Description

This end of run bookcase provides storage and display space. It has an all-laminate case, 2"-high recessed base or 2"-high foot, and 1" leveling glides. Top thicknesses are available to align with adjacent surfaces. Bookcase includes 1 laminate adjustable shelf that has 3 locations and adjusts in 1 1/4" increments.

Actual case depth is 16 1/2" (16).

Actual case width is 47 3/4" (48), 50 3/4" (51), 59 3/4" (60), or 62 3/4" (63).

Actual case height without top is 27 1/4" (28).

Notes

To align top with work surface for Layout Studio®, specify the 1 1/8" (8) top. To align top with work surface for Canvas Office Landscape®, specify the 1 1/4" (6) top. To align top with Renew™, specify the 3/4" (2) top. For applications where top alignment is not required, a 3/4" (2) top is available.

Dimensions

16 1/2"

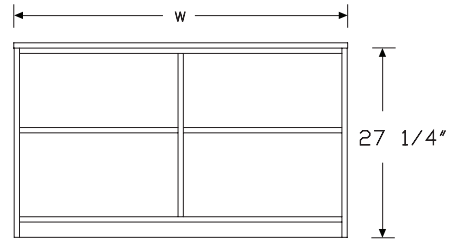

Base

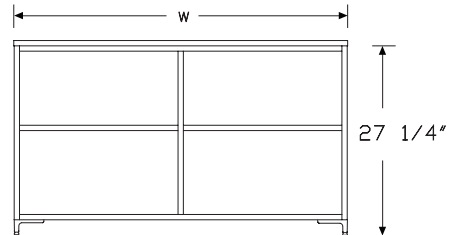

C-foot

Bookcase (EOR) *continued*

Tu® Wood Storage

Specification Information		
Step 1.		
L2ER.B	A	
Step 2. Height		
28	27 ¹ / ₄ " high	+\$0
Step 3. Width		
48	48" wide	+\$1346
51	51" wide	+\$1406
60	60" wide	+\$1586
63	63" wide	+\$1646
Step 4. Depth		
16	16 ¹ / ₂ " deep	+\$0
Step 5. Base/Foot Height		
1	base	+\$0
9	c-foot	+\$130
Step 6. Configuration		
0	no doors	+\$0
Step 7. Case Material		
L	laminate A	+\$0
Step 8. Top Material		
2	3/4" low-pressure laminate with thermoplastic edge A	+\$0
8	1 ¹ / ₈ " high-pressure laminate with thermoplastic edge A	+\$125
6	1 ¹ / ₄ " high-pressure laminate with thermoplastic edge A	+\$125

Step 9. Case/Top Finish		
LBM	crisp linen	+\$0
LBN	classic linen	+\$0
LBP	casual linen	+\$0
LBK	pewter mesh	+\$0
LBL	steel mesh	+\$0
8Q	folkstone grey	+\$0
91	white	+\$0
98	studio white	+\$0
CL	cool grey neutral	+\$0
LU	soft white	+\$0
WL	sandstone	+\$0
WN	warm grey neutral	+\$0
LBF	neutral twill	+\$0
LBG	sarum twill	+\$0
LBH	earthen twill	+\$0
LBJ	graphite twill	+\$0
LBQ	white twill	+\$0
76	light brown walnut	+\$0
HM	natural maple	+\$0
HP	light anigre	+\$0
HX	aged cherry	+\$0
HY	walnut on cherry	+\$0
LBA	clear on ash	+\$0
LBR	phantom ecru	+\$0
LBS	phantom cocoa	+\$0
LBU	medium matte walnut	+\$0
LBV	warm grey teak	+\$0
LBB	oak on ash	+\$0
LBC	walnut on ash	+\$0
LBD	dark brown walnut	+\$0
LBE	medium red walnut	+\$0

Step 10. Foot Finish		
<i>For c-foot (9)</i>		
8Q	folkstone grey	+\$0
91	white	+\$0
98	studio white	+\$0
CN	metallic champagne	+\$10
G1	graphite	+\$0
MS	metallic silver	+\$10
WL	sandstone	+\$0

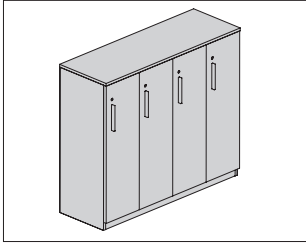

Product Information

Description

This end of run locker unit provides storage for coats, bags and other items. It has an all-laminate case and front, 2"-high recessed base or 2"-high foot or base with fronts to floor, and 1" leveling glides. Interior options are shelf with coat hook, or Z-interior (for 60" width only). Top thicknesses are available to match adjacent work surfaces.

Actual height is 41¹/₈" (42) or 45¹/₈" (46).

Actual width is 47⁷/₈" (48) or 59⁷/₈" (60).

Actual depth is 16¹/₂" (16).

Notes

To match top thickness with work surface for Layout Studio®, specify the 1¹/₈" (8) top. To match top thickness with work surface for Canvas Office Landscape®, specify the 1¹/₄" (6) top.

For applications where matching top thickness is not required, a 3³/₄" (2) top is available.

Dimensions

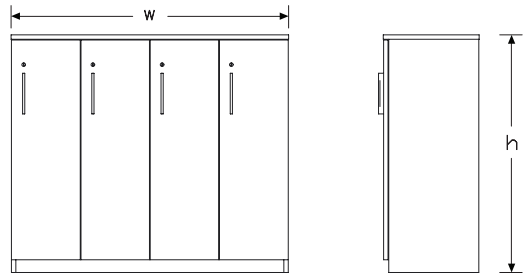
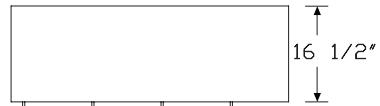

Base

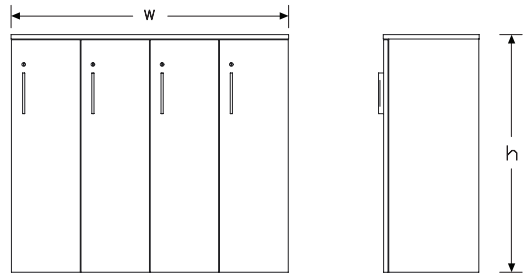

Base with fronts to floor

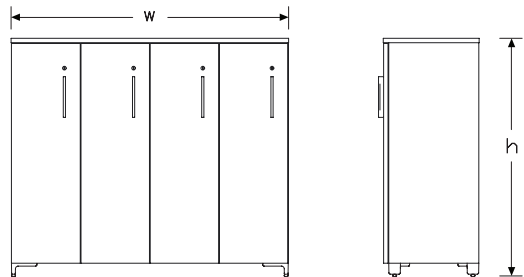

C-foot

Specification Information		
Step 1.		
L2ER.L	<input type="checkbox"/> A	
Step 2. Height		
42	42" high	+\$2646
46	46" high	+\$2890
Step 3. Width		
48	48" wide	+\$0
60	60" wide	+\$175
Step 4. Depth		
16	16½" deep <input type="checkbox"/> A	+\$0
Step 5. Base/Foot Height		
1	base	+\$0
3	base with fronts to floor	+\$10
9	c-foot	+\$130
Step 6. Hinge Location		
L	wardrobe hinge left	+\$0
R	wardrobe hinge right	+\$0
Step 7. Case/Front Material		
L	laminate	+\$0
Step 8. Top Material		
2	¾" low-pressure laminate with thermoplastic edge <input type="checkbox"/> A	+\$0
6	1¼" high-pressure laminate with thermoplastic edge <input type="checkbox"/> A	+\$125
8	1⅛" high-pressure laminate with thermoplastic edge <input type="checkbox"/> A	+\$125
Step 9. Pull Type		
A	arc pull	+\$0
K	bar pull	+\$0
U	flush pull	+\$0
Step 10. Interior		
<i>For 48" wide (48)</i>		
CH	coathook with shelf	+\$0
<i>For 60" wide (60)</i>		
CH	coathook with shelf <input type="checkbox"/> A	+\$0
CZ	z-interior	+\$100

Step 11. Case/Front Finish		
LBM	crisp linen	+\$0
LBN	classic linen	+\$0
LBP	casual linen	+\$0
LBK	pewter mesh	+\$0
LBL	steel mesh	+\$0
8Q	folkstone grey	+\$0
91	white	+\$0
98	studio white	+\$0
CL	cool grey neutral	+\$0
LU	soft white	+\$0
WL	sandstone	+\$0
WN	warm grey neutral	+\$0
LBF	neutral twill	+\$0
LBG	sarum twill	+\$0
LBH	earthen twill	+\$0
LBJ	graphite twill	+\$0
LBQ	white twill	+\$0
76	light brown walnut	+\$0
HM	natural maple	+\$0
HP	light anigre	+\$0
HX	aged cherry	+\$0
HY	walnut on cherry	+\$0
LBA	clear on ash	+\$0
LBR	phantom ecru	+\$0
LBS	phantom cocoa	+\$0
LBU	medium matte walnut	+\$0
LBV	warm grey teak	+\$0
LBB	oak on ash	+\$0
LBC	walnut on ash	+\$0
LBD	dark brown walnut	+\$0
LBE	medium red walnut	+\$0

Step 12. Top/Edge Finish		
Linen Laminate		
LBM	crisp linen	+\$0
LBN	classic linen	+\$0
LBP	casual linen	+\$0
Mesh Laminate		
LBK	pewter mesh	+\$0
LBL	steel mesh	+\$0

Lockers (EOR) *continued*

Solid-Color Laminate		
8Q	folkstone grey	+\$0
91	white	+\$0
98	studio white	+\$0
CL	cool grey neutral	+\$0
LU	soft white	+\$0
WL	sandstone	+\$0
WN	warm grey neutral	+\$0

Twill Laminate		
LBF	neutral twill	+\$0
LBG	sarum twill	+\$0
LBH	earthen twill	+\$0
LBJ	graphite twill	+\$0
LBQ	white twill	+\$0

Wood-Grain Laminate		
76	light brown walnut	+\$0
HM	natural maple	+\$0
HP	light anigre	+\$0
HX	aged cherry	+\$0
HY	walnut on cherry	+\$0
LBA	clear on ash	+\$0
LBR	phantom ecru	+\$0
LBS	phantom cocoa	+\$0
LBU	medium matte walnut	+\$0
LBV	warm grey teak	+\$0
LBB	oak on ash	+\$0
LBC	walnut on ash	+\$0
LBD	dark brown walnut	+\$0
LBE	medium red walnut	+\$0

Step 13. Pull Finish

For arc pull (A)		
NH	brushed nickel	+\$0
NK	black nickel	+\$0

For bar pull (K) or flush pull (U)		
8Q	folkstone grey	+\$0
91	white	+\$0
98	studio white	+\$0
G1	graphite	+\$0
CN	metallic champagne	+\$5
MS	metallic silver	+\$5
WL	sandstone	+\$0
79	green apple A	+\$15
MY3	yellow oxide A	+\$15
RO	red A	+\$15
TRQ	turquoise A	+\$15

Step 14. Foot Finish

For c-foot (g)		
8Q	folkstone grey	+\$0
91	white	+\$0
98	studio white	+\$0
CN	metallic champagne	+\$10
G1	graphite	+\$0
MS	metallic silver	+\$10
WL	sandstone	+\$0

Step 15. Lock

KA	keyed alike	+\$0
KC	keyed differently, chrome	+\$0
KD	keyed differently, black	+\$0

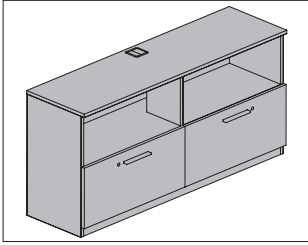

Tu® Wood Storage

Product Information

Description

This end of run media case provides open storage and drawer storage. It has an all-laminate case and front, 2"-high recessed base or 2"-high foot or base with fronts to floor, and 1" leveling glides. Grommets are available in the top and inside the open area to allow cord management and access to power. Drawers come with locks. Top thicknesses are available to align with adjacent surfaces.

Actual depth is 22⁷/₈" (24).

Actual width is 47⁷/₈" (48) or 59⁷/₈" (60).

Actual height is 27¹/₄" without top.

Notes

Widths of 48" (48) and 60" (60) work with Layout Studio, Renew™ Link, and Canvas Office Landscape® Beam.

To align top with work surface for Layout Studio®, specify the 1¹/₈" (8) top. To align top with work surface for Canvas Office Landscape, specify the 1¹/₄" (6) top.

For applications where top alignment is not required, a 3³/₄" (2) top is available.

Dimensions

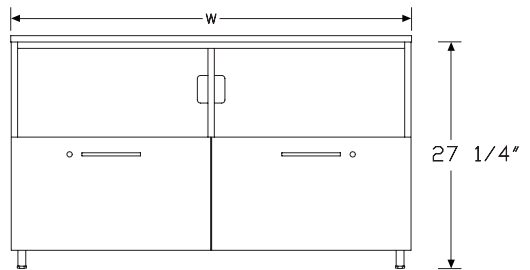
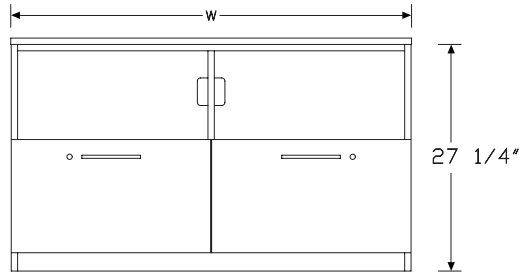
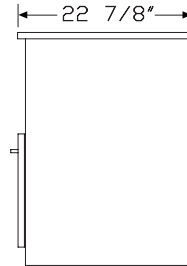

Media Case (EOR) *continued*

Specification Information		
Step 1.		
L2ER.M	A	
Step 2. Height		
28	27 ¹ / ₄ " high	+\$0
Step 3. Width		
48	48" wide	+\$1640
60	60" wide	+\$1775
Step 4. Depth		
24	22.88" deep	+\$200
Step 5. Base/Foot Height		
1	base	+\$0
3	base with fronts to floor	+\$10
9	c-foot	+\$130
Step 6. Configuration		
C	lower drawer, upper open	+\$400
Step 7. Case/Front Material		
L	laminate A	+\$0
Step 8. Top Material		
2	3/4" low-pressure laminate with thermoplastic edge	+\$0
6	1 ¹ / ₄ " high-pressure laminate with thermoplastic edge	+\$125
8	1 ¹ / ₈ " high-pressure laminate with thermoplastic edge	+\$125
Step 9. Pull Type		
A	arc pull	+\$0
K	bar pull	+\$0
U	flush pull	+\$0
Step 10. Interior Drawer Material		
M	metal	+\$0

Step 11. Case/Front Finish		
LBM	crisp linen	+\$0
LBN	classic linen	+\$0
LBP	casual linen	+\$0
LBK	pewter mesh	+\$0
LBL	steel mesh	+\$0
8Q	folkstone grey	+\$0
91	white	+\$0
98	studio white	+\$0
CL	cool grey neutral	+\$0
LU	soft white	+\$0
WL	sandstone	+\$0
WN	warm grey neutral	+\$0
LBF	neutral twill	+\$0
LBG	sarum twill	+\$0
LBH	earthen twill	+\$0
LBJ	graphite twill	+\$0
LBQ	white twill	+\$0
76	light brown walnut	+\$0
HM	natural maple	+\$0
HP	light anigre	+\$0
HX	aged cherry	+\$0
HY	walnut on cherry	+\$0
LBA	clear on ash	+\$0
LBB	oak on ash	+\$0
LBC	walnut on ash	+\$0
LBD	dark brown walnut	+\$0
LBE	medium red walnut	+\$0
LBR	phantom ecru	+\$0
LBS	phantom cocoa	+\$0
LBU	medium matte walnut	+\$0
LBV	warm grey teak	+\$0

Tu® Wood Storage

Step 12. Top/Edge Finish		
LBM	crisp linen	+\$0
LBN	classic linen	+\$0
LBP	casual linen	+\$0
LBK	pewter mesh	+\$0
LBL	steel mesh	+\$0
8Q	folkstone grey	+\$0
91	white	+\$0
98	studio white	+\$0
CL	cool grey neutral	+\$0
LU	soft white	+\$0
WL	sandstone	+\$0
WN	warm grey neutral	+\$0
LBF	neutral twill	+\$0
LBG	sarum twill	+\$0
LBH	earthen twill	+\$0
LBJ	graphite twill	+\$0
LBQ	white twill	+\$0
76	light brown walnut	+\$0
HM	natural maple	+\$0
HP	light anigre	+\$0
HX	aged cherry	+\$0
HY	walnut on cherry	+\$0
LBA	clear on ash	+\$0
LBB	oak on ash	+\$0
LBC	walnut on ash	+\$0
LBD	dark brown walnut	+\$0
LBE	medium red walnut	+\$0
LBR	phantom ecru	+\$0
LBS	phantom cocoa	+\$0
LBU	medium matte walnut	+\$0
LBV	warm grey teak	+\$0

Step 13. Pull Finish

<i>For arc pull (A)</i>		
NH	brushed nickel	+\$0
NK	black nickel	+\$0

<i>For bar pull (K) or flush pull (U)</i>		
8Q	folkstone grey	+\$0
91	white	+\$0
98	studio white	+\$0
G1	graphite	+\$0
WL	sandstone	+\$0
CN	metallic champagne	+\$5
MS	metallic silver	+\$5
79	green apple A	+\$15
MY3	yellow oxide A	+\$15
RO	red A	+\$15
TRQ	turquoise A	+\$15

Step 14. Grommet Position Selection		
N	no top location	+\$0
L	left grommet	+\$30
R	right grommet	+\$30
C	grommet center	+\$30

Step 15. Grommet Finish		
<i>For no top location (N), left grommet (L), right grommet (R), or grommet center (C)</i>		
91	white	+\$0
G1	graphite	+\$0

Step 16. Foot Finish		
<i>For c-foot (g)</i>		
8Q	folkstone grey	+\$0
91	white	+\$0
98	studio white	+\$0
CN	metallic champagne	+\$10
G1	graphite	+\$0
MS	metallic silver	+\$10
WL	sandstone	+\$0

Step 17. Counterweight		
CB	counterweight	+\$70
NO	no counterweight	+\$0

Step 18. Lock		
KA	keyed alike	+\$0
KC	keyed differently, chrome	+\$0
KD	keyed differently, black	+\$0

Recycle/Drawer, Recycle/Shelf
(EOR)

L2ER.

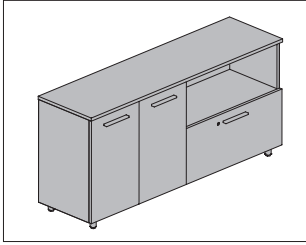

Product Information

Description

This end of run storage unit provides several configurations of recycle bins, drawers, and open shelves. It has an all-laminate case and front, 2"-high recessed base or 2"-high foot or base with fronts to floor, and 1" leveling glides. Top thicknesses are available to align with adjacent surfaces.

Actual depth is 16 1/2" (16). Case depth without top is 15 1/2".

Actual width is 47 3/4" (48), 50 3/4" (51), 59 3/4" (60), or 62 3/4" (63).

Notes

Use widths 48" (48) and 60" (60) with Layout Studio, Renew™ Link, and Canvas Office Landscape® Beam. Use widths 51" (51) and 63" (63) with Canvas Wall and Dock.

To align top with work surface for Layout Studio®, specify the 1 1/8" (8) top. To align top with work surface for Canvas Office Landscape, specify the 1 1/4" (6) top.

For applications where top alignment is not required, a 3/4" (2) top is available.

Recycle/shelf (S) configuration has 15"-wide recycle storage on either side of open shelf. Shelf width will vary based on specified unit width.

Recycle interior color is folkstone grey (8Q).

Dimensions

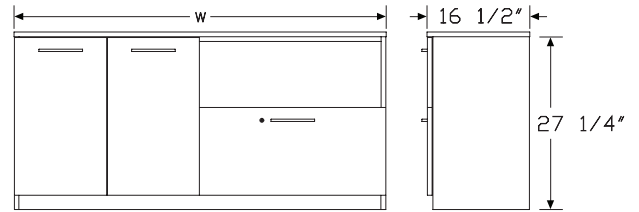

Base

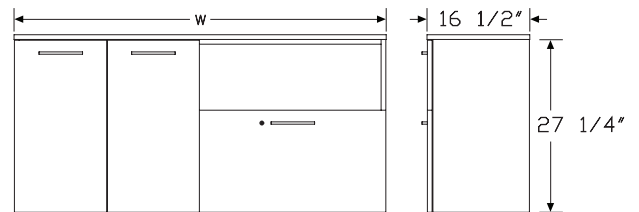

Base with fronts to floor

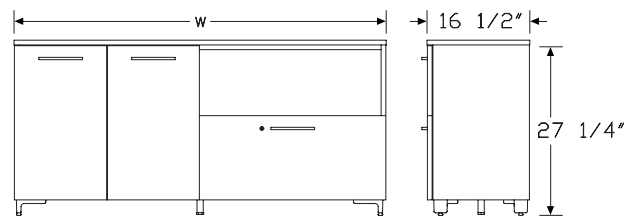

C-foot

Recycle/Drawer, Recycle/Shelf (EOR) *continued*

Tu® Wood Storage

Specification Information		
Step 1.		
L2ER.R		
Step 2. Height		
28	27 ¹ / ₄ " without top	+\$0
Step 3. Width		
48	48" wide	+\$2059
51	51" wide	+\$2083
60	60" wide	+\$2150
63	63" wide	+\$2170
Step 4. Depth		
16	16.5" deep	+\$0
Step 5. Base/Foot Height		
1	base	+\$0
3	base with fronts to floor	+\$10
9	c-foot	+\$130
Step 6. Configuration		
<i>For 48" wide (48), 51" wide (51), or 63" wide (63)</i>		
S	recycle/shelf	+\$0
<i>For 60" wide (60)</i>		
S	recycle/shelf	+\$0
L	recycle-left/drawer-right	+\$100
R	recycle-right/drawer-left	+\$100
Step 7. Case/Front Material		
L	laminate	+\$0
Step 8. Top Material		
2	³ / ₄ " laminate top	+\$0
6	1 ¹ / ₄ " laminate top	+\$125
8	1 ¹ / ₈ " laminate top	+\$125
Step 9. Pull Type		
A	arc pull	+\$0
K	bar pull	+\$0
U	flush pull	+\$0
Step 10. Interior Drawer Material		
<i>For recycle-left/drawer-right (L) or recycle-right/drawer-left (R)</i>		
M	metal	+\$0

Step 11. Case/Front Finish		
LBM	crisp linen	+\$0
LBN	classic linen	+\$0
LBP	casual linen	+\$0
LBK	pewter mesh	+\$0
LBL	steel mesh	+\$0
8Q	folkstone grey	+\$0
91	white	+\$0
98	studio white	+\$0
CL	cool grey neutral	+\$0
LU	soft white	+\$0
WL	sandstone	+\$0
WN	warm grey neutral	+\$0
LBF	neutral twill	+\$0
LBG	sarum twill	+\$0
LBH	earthen twill	+\$0
LBJ	graphite twill	+\$0
LBQ	white twill	+\$0
76	light brown walnut	+\$0
HM	natural maple	+\$0
HP	light anigre	+\$0
HX	aged cherry	+\$0
HY	walnut on cherry	+\$0
LBA	clear on ash	+\$0
LBB	oak on ash	+\$0
LBC	walnut on ash	+\$0
LBD	dark brown walnut	+\$0
LBE	medium red walnut	+\$0
LBR	phantom ecru	+\$0
LBS	phantom cocoa	+\$0
LBU	medium matte walnut	+\$0
LBV	warm grey teak	+\$0

Recycle/Drawer, Recycle/Shelf (EOR) *continued*

Step 12. Top/Edge Finish

LBM	crisp linen	+\$0
LBN	classic linen	+\$0
LBP	casual linen	+\$0
LBK	pewter mesh	+\$0
LBL	steel mesh	+\$0
8Q	folkstone grey	+\$0
91	white	+\$0
98	studio white	+\$0
CL	cool grey neutral	+\$0
LU	soft white	+\$0
WL	sandstone	+\$0
WN	warm grey neutral	+\$0
LBF	neutral twill	+\$0
LBG	sarum twill	+\$0
LBH	earthen twill	+\$0
LBJ	graphite twill	+\$0
LBQ	white twill	+\$0
76	light brown walnut	+\$0
HM	natural maple	+\$0
HP	light anigre	+\$0
HX	aged cherry	+\$0
HY	walnut on cherry	+\$0
LBA	clear on ash	+\$0
LBB	oak on ash	+\$0
LBC	walnut on ash	+\$0
LBD	dark brown walnut	+\$0
LBE	medium red walnut	+\$0
LBR	phantom ecru	+\$0
LBS	phantom cocoa	+\$0
LBU	medium matte walnut	+\$0
LBV	warm grey teak	+\$0

Step 13. Pull Finish

For arc pull (A)

NH	brushed nickel	+\$0
NK	black nickel	+\$0

For bar pull (K) or flush pull (U)

8Q	folkstone grey	+\$0
91	white	+\$0
98	studio white	+\$0
G1	graphite	+\$0
WL	sandstone	+\$0
CN	metallic champagne	+\$5
MS	metallic silver <input type="checkbox"/> A	+\$5
79	green apple <input type="checkbox"/> A	+\$15
MY3	yellow oxide <input type="checkbox"/> A	+\$15
RO	red <input type="checkbox"/> A	+\$15
TRQ	turquoise <input type="checkbox"/> A	+\$15

Step 14. Foot Finish

For c-foot (g)

8Q	folkstone grey	+\$0
91	white	+\$0
98	studio white	+\$0
G1	graphite	+\$0
WL	sandstone	+\$0
CN	metallic champagne	+\$10
MS	metallic silver	+\$10

Step 15. Lock

For recycle-left/drawer-right (L) or recycle-right/drawer-left (R)

KA	keyed alike	+\$0
KC	keyed differently, chrome	+\$0
KD	keyed differently, black	+\$0

Storage Attachment Kit, End Leg L2SL.

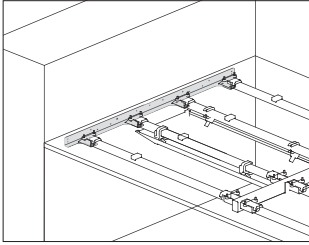

Tu® Wood Storage

Product Information

Description

This hardware kit attaches Layout Studio® beams to a Tu® Wood freestanding storage unit to allow the storage unit to replace a Layout Studio double end leg. The kit is available for use with a 48"-wide or a 60"-wide freestanding storage case. Finish is cool grey neutral.

Notes

To replace a Layout Studio double leg with a storage unit, order a Tu Wood end-of-run cabinet (L2ER.) separately.
Specify storage base option to match base option on storage unit.

Dimensions

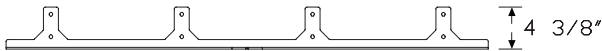
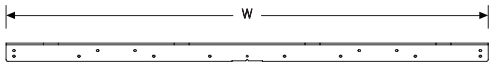

Specification Information

Step 1.

L2SL. A

Step 2. Depth

48 48" double end leg A

60 60" double end leg A

Prices for Steps 1-2.

L2SL.	48	\$260
	60	\$280

Step 3. Storage Base Option

1	base A	+ \$0
3	base with fronts to floor A	+ \$0
5	foot A	+ \$0
9	c-foot A	+ \$0

Shared Cubby

L2EY.

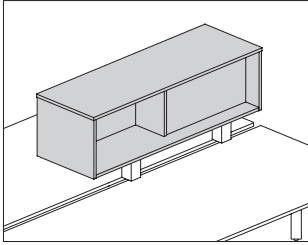

Product Information

Description

This all-laminate cubby has a laminate shell and septum, and has alternate-facing openings to provide storage to workers on both sides of the unit, either across from each other or side-by-side. Cubby is mounted using stanchions which are specified separately.

Notes

12½"-deep cubby used in a parallel application will attach to Layout Studio® beams. Single cubby requires 1 end stanchion kit (LSS.SE). Multiple cubbies will require the end stanchion kit, along with a shared stanchion (LSS.SM) wherever 2 cubbies meet.

12½"-deep cubby used in a perpendicular application will attach to the back edge of a work surface on one end of the cubby and rest on top of a 22"-high credenza on the other end of the cubby. Specify 1 credenza/work surface mounted stanchion kit (LSS.CD) for each cubby.

16"-deep cubby is 12" deep on half and 3" deep on the other half. To attach to Layout Studio performance rail, order stanchion kits (L2SS.) separately.

For 16" deep cubby, 24"-wide and 30"-wide cubbies can only be used in a parallel application. 36"-72" wide cubbies can be used in either a parallel or perpendicular application.

To cover interior septum on 1 side of 16"D × 13½"H cubby (L2EY.x1613xx) with a painted insert, order insert (LLCM.Z13xxP) separately.

Dimensions

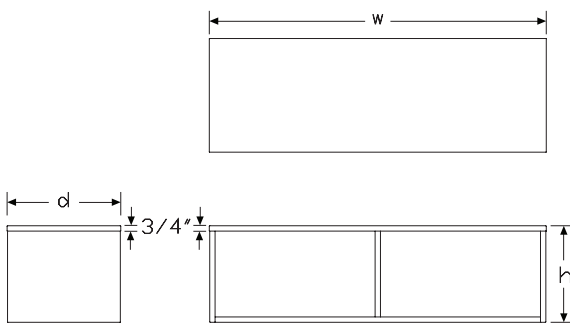

Specification Information

Step 1.

L2EY.

Step 2. Attachment

- B** parallel application, Layout Studio beam attachment
- S** perpendicular application, surface attachment
- R** Layout Studio performance rail attachment

Step 3. Depth

For parallel application, Layout Studio beam attachment (B) or perpendicular application, surface attachment (S)

12 12.5" deep

For Layout Studio performance rail attachment (R)

16 16" deep

Step 4. Height

For 12.5" deep (12)

09 9.75" high

13 13.75" high

For 16" deep (16)

13 13.75" high

Step 5. Width

For Layout Studio performance rail attachment (R)

24 24" wide

30 30" wide

36 36" wide

42 42" wide

48 48" wide

For perpendicular application, surface attachment (S)

48 48" wide

60 60" wide

For parallel application, Layout Studio beam attachment (B)

36 36" wide

42 42" wide

48 48" wide

60 60" wide

72 72" wide

Step 6. Position

L	opening left
R	opening right

Step 7. Surface Material

L	laminate
----------	----------

Prices for Steps 1-7.

		0936LL	0936RL	0942LL	0942RL	0960LL	0960RL
L2EY.	B 12	\$805	805	905	905	1073	1073
	S 12	—	—	—	—	\$1073	1073

		0948LL	0948RL	0972LL	0972RL	1324LL	1324RL
L2EY.	B 12	\$948	948	1198	1198	—	—
	S 12	\$948	948	—	—	—	—
	R 16	—	—	—	—	\$800	800

		1330LL	1330RL	1336LL	1336RL	1342LL	1342RL
L2EY.	B 12	—	—	\$850	850	950	950
	R 16	\$900	900	1000	1000	1100	1100

		1360LL	1360RL	1348LL	1348RL	1372LL	1372RL
L2EY.	B 12	\$1118	1118	993	993	1243	1243
	S 12	\$1118	1118	993	993	—	—
	R 16	—	—	\$1200	1200	—	—

Step 8. Case Finish

LBM	crisp linen	+\$0
LBN	classic linen	+\$0
LBP	casual linen	+\$0
LBK	pewter mesh	+\$0
LBL	steel mesh	+\$0
8Q	folkstone grey	+\$0
91	white	+\$0
98	studio white	+\$0
CL	cool grey neutral	+\$0
LU	soft white	+\$0
WL	sandstone	+\$0
WN	warm grey neutral	+\$0
LBF	neutral twill	+\$0
LBG	sarum twill	+\$0
LBH	earthen twill	+\$0
LBJ	graphite twill	+\$0
LBQ	white twill	+\$0
76	light brown walnut	+\$0
HM	natural maple	+\$0
HP	light anigre	+\$0
HX	aged cherry	+\$0
HY	walnut on cherry	+\$0
LBA	clear on ash	+\$0
LBR	phantom ecru	+\$0
LBS	phantom cocoa	+\$0
LBU	medium matte walnut	+\$0
LBV	warm grey teak	+\$0
LBB	oak on ash	+\$0
LBC	walnut on ash	+\$0
LBD	dark brown walnut	+\$0
LBE	medium red walnut	+\$0

Individual Cubby

L2EC.

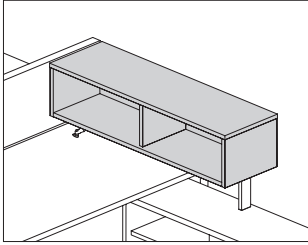

Product Information

Description

This all laminate cubby attaches to stanchions and provides open storage accessible from 1 side of the cubby. The inbound stanchion either sits on top of a work surface and attaches to the underside of the surface, or attaches to a Layout Studio® performance rail. The outbound stanchion rests on top of a 22"-high Tu® Wood credenza.

Notes

Surface-attached cubby cannot be used on a Layout Studio sliding surface.

Order stanchion kit for surface attachment (LSS.) or Layout Studio performance rail attachment (L2SS.) separately.

Can be used only in perpendicular application.

Order optional accessories separately:

- Tackboard (LLCT.)
- Whiteboard (LLCW.)
- Magnet board (LLCM.)

Dimensions

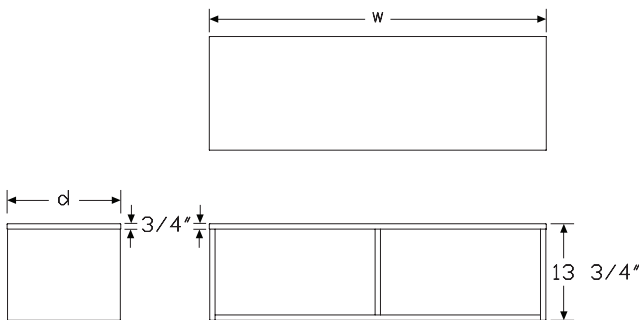

Specification Information

Step 1.

L2EC.

Step 2. Attachment

R Layout Studio performance rail attachment
S surface attachment

Step 3. Height

09 9.75" high
13 13.75" high

Step 4. Width

For Layout Studio performance rail attachment (R)

36 36" wide
42 42" wide
48 48" wide

For surface attachment (S)

48 48" wide
60 60" wide

Step 5. Depth

12 12 1/2" deep

Step 6. Surface Material

L laminate

Prices for Steps 1-6.

			3612L	4212L	6012L	4812L
L2EC.	R	09	\$850	900	—	950
		13	\$900	950	—	1000
	S	09	—	—	\$1050	950
		13	—	—	\$1100	1000

Individual Cubby *continued*

Tu® Wood Storage

Step 7. Case Finish

8Q	folkstone grey	+\$0
91	white	+\$0
98	studio white	+\$0
CL	cool grey neutral	+\$0
LU	soft white	+\$0
WL	sandstone	+\$0
WN	warm grey neutral	+\$0
LBM	crisp linen	+\$0
LBN	classic linen	+\$0
LBP	casual linen	+\$0
LBK	pewter mesh	+\$0
LBL	steel mesh	+\$0
LBF	neutral twill	+\$0
LBG	sarum twill	+\$0
LBH	earthen twill	+\$0
LBJ	graphite twill	+\$0
LBQ	white twill	+\$0
76	light brown walnut	+\$0
HM	natural maple	+\$0
HP	light anigre	+\$0
HX	aged cherry	+\$0
HY	walnut on cherry	+\$0
LBA	clear on ash	+\$0
LBR	phantom ecru	+\$0
LBS	phantom cocoa	+\$0
LBU	medium matte walnut	+\$0
LBV	warm grey teak	+\$0
LBB	oak on ash	+\$0
LBC	walnut on ash	+\$0
LBD	dark brown walnut	+\$0
LBE	medium red walnut	+\$0

Suspended End Cubby Hardware Kit

LSH.

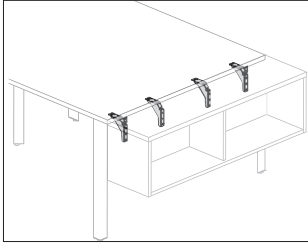

Product Information

Description

This hardware kit attaches a suspended end cubby to the outside of a Layout Studio® double desk end leg.

Notes

Order suspended end cubby (L2ES.B) separately.

Dimensions

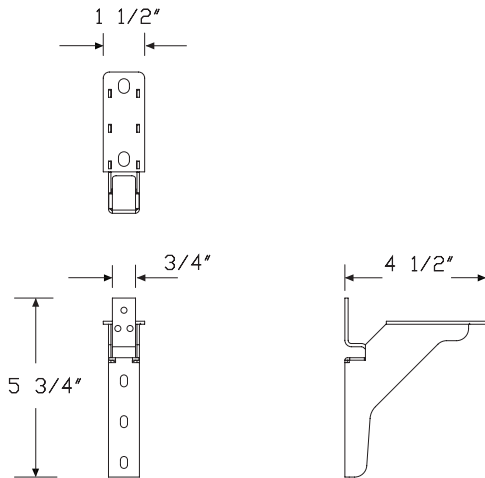

Specification Information

Step 1.

LSH. A

Step 2. Application

B suspended below surface A

Prices for Steps 1-2.

LSH. B \$335

Step 3. Finish

Bright Sand Texture Paint

91 white A +\$0

G1 graphite A +\$0

Metallic Paint

MS metallic silver A +\$5

Laminate Work Surface Cubby

L2WC.

Tu® Wood Storage

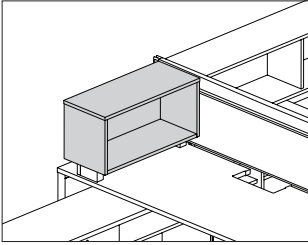

Product Information

Description
 This all laminate cubby attaches to stanchions, sits atop a work surface and provides open storage. The inbound stanchion attaches to the underside of the surface.

Notes

- Perpendicular application only.
 Order stanchion kit (LSS.WS) separately.
 Order optional accessories separately:
- Tackboard (LLCT.)
 - Whiteboard (LLCW.)
 - Magnet board (LLCM.)

Dimensions

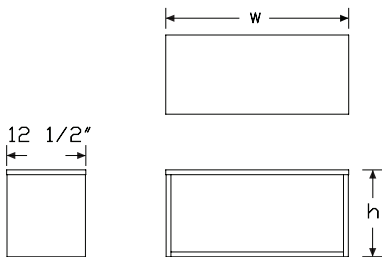

Specification Information

Step 1.

L2WC. [A]

Step 2. Height

- 09 9.75" high [A]
- 13 13.75" high [A]

Step 3. Width

- 24 24" wide [A]
- 30 30" wide [A]

Step 4. Depth

- 12 12.5" deep [A]

Step 5. Material

L laminate [A]

Prices for Steps 1-5.

	12L
L2WC. 09 24	\$750
30	\$800
13 24	\$850
30	\$900

Laminate Work Surface Cubby

continued

Step 6. Case Finish

LBM	crisp linen <input type="checkbox"/> A	+\$0
LBN	classic linen <input type="checkbox"/> A	+\$0
LBP	casual linen <input type="checkbox"/> A	+\$0
LBK	pewter mesh <input type="checkbox"/> A	+\$0
LBL	steel mesh <input type="checkbox"/> A	+\$0
8Q	folkstone grey <input type="checkbox"/> A	+\$0
91	white <input type="checkbox"/> A	+\$0
98	studio white <input type="checkbox"/> A	+\$0
CL	cool grey neutral <input type="checkbox"/> A	+\$0
LU	soft white <input type="checkbox"/> A	+\$0
WL	sandstone <input type="checkbox"/> A	+\$0
WN	warm grey neutral <input type="checkbox"/> A	+\$0
LBF	neutral twill <input type="checkbox"/> A	+\$0
LBG	sarum twill <input type="checkbox"/> A	+\$0
LBH	earthen twill <input type="checkbox"/> A	+\$0
LBJ	graphite twill <input type="checkbox"/> A	+\$0
LBQ	white twill <input type="checkbox"/> A	+\$0
76	light brown walnut <input type="checkbox"/> A	+\$0
HM	natural maple <input type="checkbox"/> A	+\$0
HP	light anigre <input type="checkbox"/> A	+\$0
HX	aged cherry <input type="checkbox"/> A	+\$0
HY	walnut on cherry <input type="checkbox"/> A	+\$0
LBA	clear on ash <input type="checkbox"/> A	+\$0
LBR	phantom ecru <input type="checkbox"/> A	+\$0
LBS	phantom cocoa <input type="checkbox"/> A	+\$0
LBU	medium matte walnut <input type="checkbox"/> A	+\$0
LBV	warm grey teak <input type="checkbox"/> A	+\$0
LBB	oak on ash <input type="checkbox"/> A	+\$0
LBC	walnut on ash <input type="checkbox"/> A	+\$0
LBD	dark brown walnut <input type="checkbox"/> A	+\$0
LBE	medium red walnut <input type="checkbox"/> A	+\$0

Laminate Suspended End Cubby

L2ES.

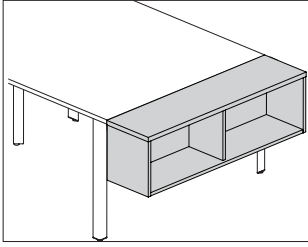

Tu® Wood Storage

Product Information

Description

This all laminate cubby attaches to the outside of a Layout Studio® double desk end leg and provides open storage. The top of the cubby aligns with the adjacent surface(s). Each cubby has a center divider.

Notes

Specify cubby width to match depth of leg to which it will attach.

Order hardware kit (LSH.B) separately.

Grain direction is vertical on front and sides, and horizontal on top and back. Vertical grain direction on the top is available via Made-to-Measure or the Vary Easy Program.

Dimensions

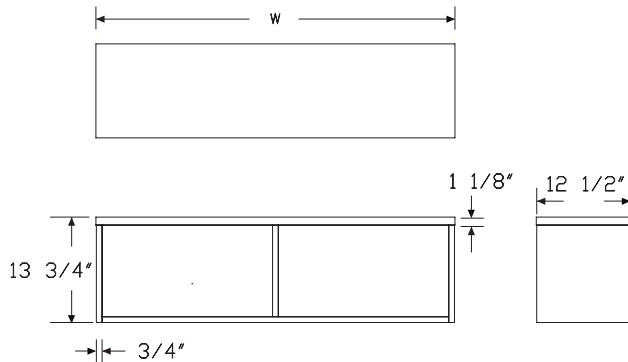

Specification Information

Step 1.

L2ES.

Step 2. Application

B suspended below surface

Step 3. Height

13 13.75" high

Step 4. Width

48 48" wide

60 60" wide

Step 5. Depth

12 12.5" deep

Step 6. Surface Material

L laminate

Prices for Steps 1-6.

	4812L	6012L
L2ES. B 13	\$1000	1100

Step 7. Top Finish

Solid-Color Laminate

8Q	folkstone grey	+\$0
91	white	+\$0
98	studio white	+\$0
CL	cool grey neutral	+\$0
LU	soft white	+\$0
MT	medium tone	+\$0
WL	sandstone	+\$0
WN	warm grey neutral	+\$0

Linen Laminate

LBM	crisp linen	+\$0
LBN	classic linen	+\$0
LBP	casual linen	+\$0

Mesh Laminate

LBK	pewter mesh	+\$0
LBL	steel mesh	+\$0

Laminate Suspended End Cubby

continued

Twill Laminate		
LBF	neutral twill	+\$0
LBG	sarum twill	+\$0
LBH	earthen twill	+\$0
LBJ	graphite twill	+\$0
LBQ	white twill	+\$0

Wood-Grain Laminate		
76	light brown walnut	+\$0
HM	natural maple	+\$0
HP	light anigre	+\$0
HX	aged cherry	+\$0
HY	walnut on cherry	+\$0
LBA	clear on ash	+\$0
LBR	phantom ecru	+\$0
LBS	phantom cocoa	+\$0
LBU	medium matte walnut	+\$0
LBV	warm grey teak	+\$0
LBB	oak on ash	+\$0
LBC	walnut on ash	+\$0
LBD	dark brown walnut	+\$0
LBE	medium red walnut	+\$0

Step 8. Case Finish

Solid-Color Laminate		
8Q	folkstone grey	+\$0
91	white	+\$0
98	studio white	+\$0
CL	cool grey neutral	+\$0
LU	soft white	+\$0
MT	medium tone	+\$0
WL	sandstone	+\$0
WN	warm grey neutral	+\$0

Low Sheen Finishes		
LBM	crisp linen	+\$0
LBN	classic linen	+\$0
LBP	casual linen	+\$0

Mesh Laminate		
LBK	pewter mesh	+\$0
LBL	steel mesh	+\$0

Twill Laminate		
LBF	neutral twill	+\$0
LBG	sarum twill	+\$0
LBH	earthen twill	+\$0
LBJ	graphite twill	+\$0
LBQ	white twill	+\$0

Wood-Grain Laminate		
76	light brown walnut	+\$0
HM	natural maple	+\$0
HP	light anigre	+\$0
HX	aged cherry	+\$0
HY	walnut on cherry	+\$0
LBA	clear on ash	+\$0
LBR	phantom ecru	+\$0
LBS	phantom cocoa	+\$0
LBU	medium matte walnut	+\$0
LBV	warm grey teak	+\$0
LBB	oak on ash	+\$0
LBC	walnut on ash	+\$0
LBD	dark brown walnut	+\$0
LBE	medium red walnut	+\$0

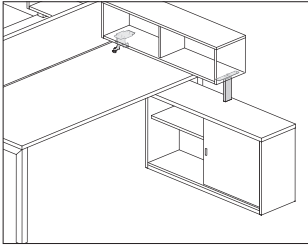

Product Information

Description

These stanchions elevate and support the shared cubby and individual cubby when attaching to a Layout Studio® performance rail. The center application kit has 1 stanchion, and the perpendicular application kit has 2 stanchions. Attachment hardware included.

Notes

Specify cubby (L2EY., L2EC.) separately.

The center application, rail-attached end stanchion (CE) supports 1 end of a single cubby.

The center application, rail-attached shared stanchion (CS) supports the end of 2 cubbies that are placed side-by-side.

The perpendicular application, rail and credenza supported stanchion kit (PRC) supports both ends of a cubby when placed perpendicular to a bench.

Dimensions

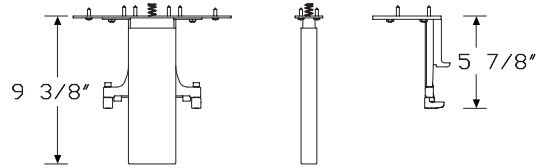
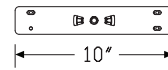
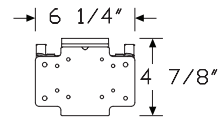

Perpendicular Rail and Credenza Support

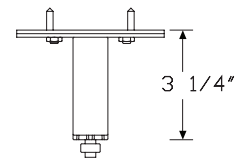
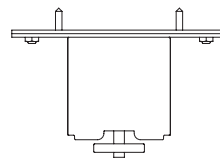
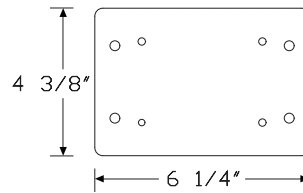

End Center Rail

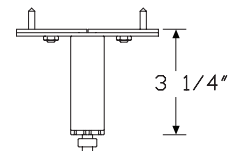
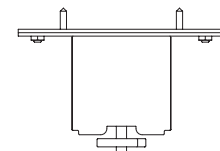
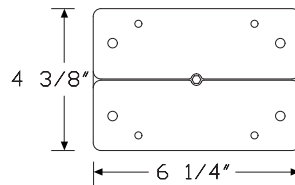

Shared Center Rail

Stanchion Kit, Performance Rail

continued

Specification Information

Step 1.

L2SS.

Step 2. Application

CE center application, rail-attached, end

CS center application, rail-attached, shared

PRC perpendicular application, rail and credenza supported

Prices for Steps 1-2.

L2SS. CE	\$200
CS	\$200
PRC	\$525

Step 3. Finish

91 white	+\$0
G1 graphite	+\$0
MS metallic silver	+\$10

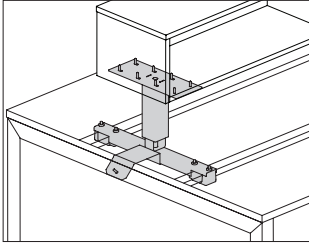

Product Information

Description

These stanchions elevate and support the laminate work surface cubby, individual cubby, and shared cubby. The shared mount kit has 1 shared stanchion, and the other kits have 2 stanchions. Attachment hardware included.

Notes

Specify cubby separately.

For use with laminate work surface cubby (L2WC.), specify work surface mounted stanchion (LSS.WS).

For use with individual cubby (L2EC.), specify credenza/work surface mounted stanchion (LSS.CD). The tall outbound stanchion has 1" of adjustability.

The inbound stanchion included in each kit attaches to the underside of the work surface.

For use in Layout Studio® applications, specify end mount kit (LSS.SE) and the correct number of shared mount kits (LSS.SM) for the number of cubbies to be used.

Dimensions

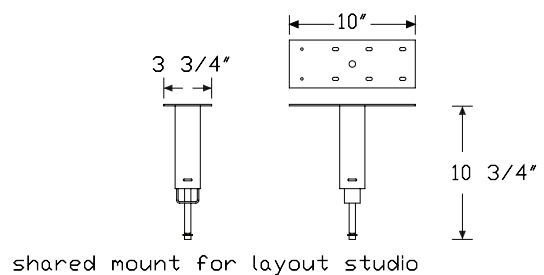
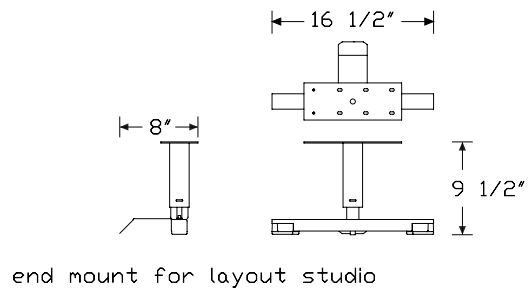
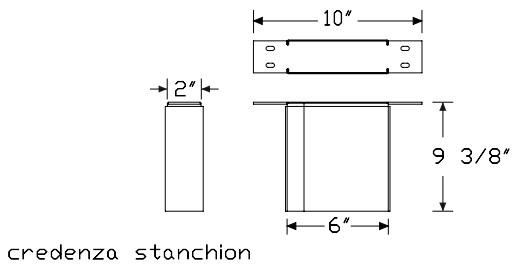
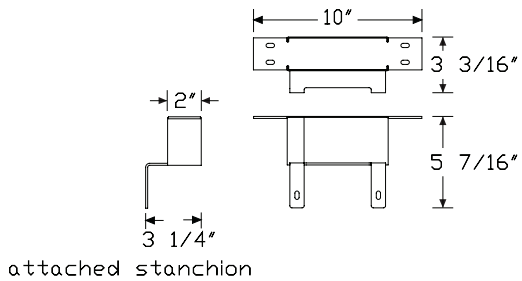
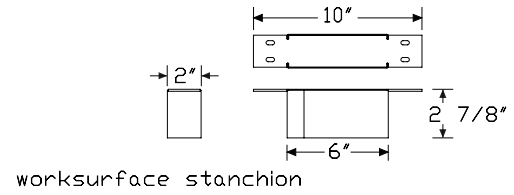

Specification Information

Step 1.

LSS.

Step 2. Width

- SM** shared mount for layout studio
- WS** work surface mounted
- CD** credenza/work surface mounted
- SE** end mount for layout studio

Prices for Steps 1-2.

LSS.	SM	\$290
	WS	\$325
	CD	\$390
	SE	\$660

Step 3. Finish

Bright Sand Texture Paint

91	white	+ \$0
G1	graphite	+ \$0

Metallic Paint

MS	metallic silver	+ \$10
-----------	-----------------	--------

Cubby Tackboard

LLCT.

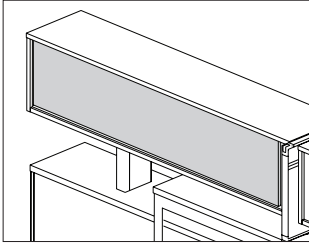

Tu® Wood Storage

Product Information

Description

This tackboard attaches to the back side of a work surface cubby, extended cubby or shared cubby to provide a tackable surface. Attachment hardware included.

Notes

Specify tackboard width to match cubby width. Shared cubby tackboard is for 1 half of cubby.

All fabric is railroaded.

Tackboard accepts Customer's Own Material (COM). Yardage is estimated for nondirectional 54"-wide fabrics.

Width—Yardage

For work surface cubby (W):

24—0.90

30—1.10

For extended cubby (E):

48—1.63

60—2.00

For shared cubby (S):

16—0.75

19—0.85

22—0.95

28—1.14

34—1.32

For information on multiple quantities or directional fabrics, contact COM Department. See Order Information in Appendices.

Dimensions

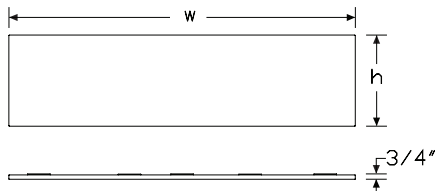

Specification Information

Step 1.

LLCT.

Step 2. Configuration

S shared cubby

W work surface cubby

E extended cubby

Step 3. Height

09 9.75" high

13 13.75" high

Step 4. Width

For work surface cubby (W)

24 24" wide

30 30" wide

For extended cubby (E)

48 48" wide

60 60" wide

For shared cubby (S)

16 36" wide

19 42" wide

22 48" wide

28 60" wide

34 72" wide

Prices for Steps 1-4.

		16	24	48	19	30	60		
LLCT.	S 09	\$130	—	—	133	—	—		
	13	\$140	—	—	143	—	—		
W	09	—	\$135	—	—	160	—		
	13	—	\$145	—	—	170	—		
E	09	—	—	\$170	—	—	320		
	13	—	—	\$190	—	—	340		
							22	28	34
LLCT.	S 09				\$135	150	165		
	13				\$145	160	175		

Cubby Tackboard *continued*

Step 5. Finish	S	W	E
Price Category 1	+\$0	0	0
Price Category 2	+\$11	11	21
Price Category 3	+\$27	27	49
Price Category 4	+\$48	48	86
Price Category 5	+\$80	80	144

Cubby Whiteboard

LLCW.

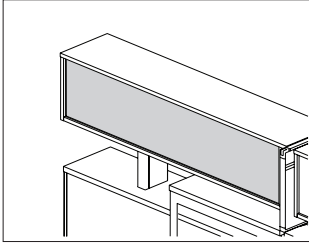

Tu® Wood Storage

Product Information

Description

This marker board attaches to the back side of a work surface cubby, extended cubby or shared cubby to provide a writing surface for dry-erase markers. Attachment hardware included.

Notes

Specify marker board width to match width of cubby. Marker board for shared cubby will cover 1 half width of the cubby.

Dry-erase markers not included.

Dimensions

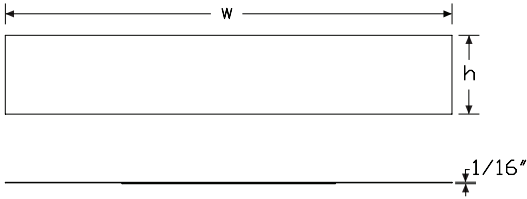

Specification Information

Step 1.

LLCW.

Step 2. Configuration

- W** work surface cubby
- E** extended cubby
- S** shared cubby

Step 3. Height

- 09** 9.75" high
- 13** 13.75" high

Step 4. Width

For work surface cubby (W)

- 24** 24" wide
- 30** 30" wide

For extended cubby (E)

- 48** 48" wide
- 60** 60" wide

For shared cubby (S)

- 16** 36" wide
- 19** 42" wide
- 22** 48" wide
- 28** 60" wide
- 34** 72" wide

Prices for Steps 1-4.

			16	24	48	19	30	60
LLCW. W	09		—	\$115	—	—	130	—
	13		—	\$125	—	—	140	—
E	09		—	—	\$240	—	—	270
	13		—	—	\$250	—	—	280
S	09		\$110	—	—	113	—	—
	13		\$120	—	—	123	—	—
						22	28	34
LLCW. S	09					\$115	120	135
	13					\$125	135	145

Cubby Magnet Board

LLCM.

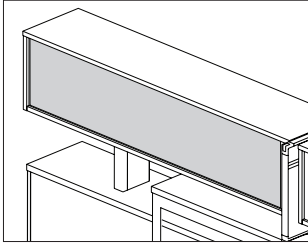

Product Information

Description

This magnet board attaches to the back side of a work surface cubby, extended cubby or shared cubby to provide a place to hang paper by magnets. Attachment hardware included.

Notes

Specify magnet board width to match width of cubby. Shared cubby magnet board covers 1 half of cubby.
Magnets not included.

Dimensions

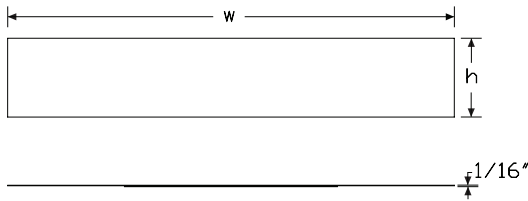

Specification Information

Step 1.

LLCM.

Step 2. Configuration

- W** work surface cubby
- E** extended cubby
- S** shared cubby

Step 3. Height

- 09** 9.75" high
- 13** 13.75" high

Step 4. Width

For work surface cubby (W)

- 24** 24" wide
- 30** 30" wide

For extended cubby (E)

- 48** 48" wide
- 60** 60" wide

For shared cubby (S)

- 16** 36" wide
- 19** 42" wide
- 22** 48" wide
- 28** 60" wide
- 34** 72" wide

Prices for Steps 1-4.

		16	24	48	19	30	60
LLCM. W	09	—	\$115	—	—	130	—
	13	—	\$125	—	—	140	—
E	09	—	—	\$240	—	—	270
	13	—	—	\$250	—	—	280
S	09	\$110	—	—	113	—	—
	13	\$120	—	—	123	—	—
					22	28	34
LLCM. S	09				\$115	120	135
	13				\$125	135	145

Cubby Magnet Board *continued*

Tu® Wood Storage

Step 5. Finish

Bright Sand Texture Paint

91	white	+\$0
G1	graphite	+\$0

Sand Texture Paint

RO	red	+\$30
TRQ	turquoise	+\$30
79	green apple	+\$30
MY3	yellow oxide	+\$30

Smooth Paint

MS	metallic silver	+\$10
-----------	-----------------	-------

Index by Product Name

Tu® Wood Storage	
	page(s)
Bookcase (EOR)	61
Bookcase Tower	45
Combination Pedestal	11
Credenza - Catch Flex	33
Credenza - Catch Resident	35
Credenza - Open	27
Credenza - Open with Box/ File	23
Credenza - Open with File/Shelf	30
Cubby Magnet Board	89
Cubby Tackboard	86
Cubby Whiteboard	88
Cushion Top for Credenzas	38
Cushion Top for Pedestals	19
Extended Width Surface-Attached Pedestal	16
File Rail	39, 21
Individual Cubby	75
Laminate Suspended End Cubby	80
Laminate Work Surface Cubby	78
Lockers (EOR)	63
Media Case (EOR)	66
Mobile Pedestal	8
Personal Tower-Mini Door	55
Personal Tower - Mini Storage/Bag	53
Personal Tower - Tall	51
Recycle/Drawer, Recycle/Shelf (EOR)	69
Shared Cubby	73
Side-To-Side Filing Rail, Credenza Drawer	40, 22
Stanchion Kit	84
Stanchion Kit, Performance Rail	82
Storage Attachment Kit, End Leg	72
Storage Tops	14
Storage Tower	42
Surface-Attached Pedestal	5
Suspended End Cubby Hardware Kit	77
USB Module for Personal Tower	57
Utility Tray Pedestal	41, 20
Wardrobe	58
Wardrobe Tower	48



Index by Product Number

L2BT. Bookcase Tower	page(s) 45
L2CD. Credenza - Catch Flex	33
L2CD. Credenza - Catch Resident	35
L2CD. Credenza - Open	27
L2CD. Credenza - Open with Box/ File	23
L2CD. Credenza - Open with File/Shelf	30
L2CP. Combination Pedestal	11
L2EC. Individual Cubby	75
L2ER. Bookcase (EOR)	61
L2ER. Lockers (EOR)	63
L2ER. Media Case (EOR)	66
L2ER. Recycle/Drawer, Recycle/Shelf (EOR)	69
L2ES. Laminate Suspended End Cubby	80
L2EW. Extended Width Surface-Attached Pedestal	16
L2EY. Shared Cubby	73
L2PD. Personal Tower-Mini Door	55
L2PM. Mobile Pedestal	8
L2PN. Personal Tower - Mini Storage/Bag	53
L2PS. Surface-Attached Pedestal	5
L2PT. Personal Tower - Tall	51
L2SC. Cushion Top for Pedestals	19
L2SL. Storage Attachment Kit, End Leg	72
L2SS. Stanchion Kit, Performance Rail	82
L2ST. Storage Tops	14
L2T. Storage Tower	42
L2UT. Utility Tray Pedestal	41, 20
L2WC. Laminate Work Surface Cubby	78
L2WR. Wardrobe	58
L2WT. Wardrobe Tower	48
L29P. File Rail	39, 21
L2902. Side-To-Side Filing Rail, Credenza Drawer	40, 22
LEE. USB Module for Personal Tower	57
LLCM. Cubby Magnet Board	89
LLCT. Cubby Tackboard	86
LLCW. Cubby Whiteboard	88
LSC. Cushion Top for Credenzas	38
LSH. Suspended End Cubby Hardware Kit	77
LSS. Stanchion Kit	84



20-Day or Less/Assigned Lead-Time Order Information

20-Day or Less and Assigned Lead-Time Programs

20-day or less and assigned lead-time products are designed for established Herman Miller dealers with pre-approved credit.

Products are distributed from multiple manufacturing facilities across the United States. All products and options not designated by an Assigned Lead-Time icon [A] will ship in 20 business days or less after being acknowledged by Herman Miller. Products and options designated by an [A] are on the assigned lead-time program and will ship in 20 days, less than 20 days, or more than 20 days from order acknowledgement.

Ordering Procedure

Please place orders through Order Manager. If this is not available to you, place orders through mail or fax. Verbal purchase orders will not be accepted.

Order Entry fax number for Passage®, 5000 Series, and Meridian® Filing and Storage: (616) 846 9236.

Order Entry fax number for all other products:
(616) 654 3085.

For more information, contact your Customer Care representative at:
(866) 854 3048 EXT 3400.

Shipments and Delivery

Per Herman Miller Terms and Conditions.

Changes and Cancellation

Per Herman Miller Terms and Conditions.



10-Day Keyed-Alike Information

Keyed-Alike Locks

All components with locks may be specified keyed alike. Products with keyed-alike locks will be shipped with lock chassis installed. Installation of lock cylinders will be on-site according to instructions provided. Herman Miller, Inc. will not be responsible for lock cylinder installation.

When specifying product keyed-alike, include separate lines on your order for the lock cylinders.

For Action Office®, Ethospace®, and Passage® products, list cylinder part number and key number (232092-XXX); select a key number (or numbers) between 226 and 427, excluding numbers 408 and 412.

For Meridian® Storage or 5000 Series, see the following charts.

Keyed-alike locks are field installed.

To order keyed-alike locks for Action Office® Series 1 and 2 door panels, please contact Customer Care.

A master key can be used to open any lock on an attached or freestanding component. In addition, a removal key or lock change tool is required to remove lock plugs. Customers interested in ordering master keys, removal keys, or lock change tools should contact Customer Care.

For Meridian Storage or 5000 Series desk components with pedestals, specify as follows:

Specification Code	Key Number	Color	Lock Series
KA	232092-XXX ¹	black	UM series 226-427
KA	1B2JK7-XXX ¹	chrome	UM series 226-427

For 5000 Series flipper door unit with bezel or credenza storage cabinet with bezel, specify as follows:

Specification Code	Key Number	Color	Lock Series
KA	232092-XXX ¹	black	UM series 226-427

Key Number:

XXX¹ = a key number between 226 and 427 (excluding 408 and 412)



Customer's Own Material/ Customer's Own Leather Order Information — Cushion Tops

Customer's Own Material/Customer's Own Leather

Program Overview

The Customer's Own Material (COM) and Customer's Own Leather (COL) program gives you the option of using textiles other than those listed. Herman Miller will test textiles for application to Herman Miller products and will process orders for those with approved COM/COL textiles only. COM/COL are assigned lead time textiles.

Omni lists an overview of fabrics and leathers that have been tested and indicates whether or not they were approved for application to Herman Miller products.

Specific information on the terms and conditions, testing, approval, and ordering process for COM/COL is listed below. Questions about the COM/COL program and requests for assistance may be directed to your COM representative at:

(616) 654 3400

(866) 854 3048 EXT 6543400

Customer's Own Material/Customer's Own Leather Warranty

Herman Miller does not warrant COM/COL textiles. COM/COL textiles are tested for application only; they are not tested for performance. The Herman Miller warranty does apply to the underlying products.

Suppliers of COM/COL textiles are responsible for color consistency within commercial tolerances, UV stability, and resistance to soiling and perspiration.

Customer's Own Material/Customer's Own Leather Pricing

COM is a Category 1 fabric. There are no application charges for COM fabrics. COL is a Category 7 textile; refer to prices on specific products to determine the application charge.

Ordering and payment for COM/COL textile yardage are the responsibility of the customer and the textile supplier.

If desired, Herman Miller will purchase COM textiles directly from True Textiles, C.F. Stinson, Luna Textiles, Maharam, and Momentum Textiles to simplify ordering and shipment. For this service, refer to the Supplier Connection program.

Application Note

Herman Miller does not guarantee that Customer's Own Material (COM) fabric patterns will align across panels/tiles or from one screen to the next. We also do not guarantee that COM fabric designs will be positioned consistently in the same location across several panels, tiles, or screens.

Textile Approval

1. Select a COM/COL textile.
2. If your textile is not listed on Omni, obtain a test number from a COM representative at (616) 654 3400. You can also submit your request within Omni. Please have the following information ready before calling: textile name, number, pattern, and the product you will apply it to.
3. Herman Miller will notify you of approval or disapproval within 4 days from receipt of the test yardage.

Customer's Own Material/ Customer's Own Leather Order Information — Cushion Tops

continued

Ordering Products with COM/COL

1. Refer to the specific products to determine the yardage required for COM/COL textiles.
2. If your textile is not listed on Omni, call a COM representative at (616) 654 3400 or (866) 854 3048 EXT 6543400. The representative will assign an identification number for your textile (ID#) and will verify yardage requirements for your order. Yardage requirements are based on directional, 54"-wide textiles. Additional yardage may be needed due to the unique characteristics of a textile.
3. Enter your order on Order Manager in Omni.
4. Upon receipt of your purchase order, Herman Miller will send you a PO acknowledgment.
5. Arrangements must be made for the textiles to be shipped from the supplier to Herman Miller for application to the seating products. See Omni for shipping procedures and current shipping addresses or contact a COM representative at (616) 654 3400 or (866) 854 3048 EXT 6543400.

Products will be scheduled for production when COM/COL textiles are received at Herman Miller. Standard lead times in effect at that time will apply.

Note: If textiles are to be purchased directly by Herman Miller through the Supplier Connection program, Herman Miller will handle the ordering and shipping process and will schedule your order for production upon receipt of your purchase order (dependent on textile availability). Refer to the Supplier Connection program for more information.

Supplier Connection

Program Overview

The Supplier Connection program is a service offered by Herman Miller to purchase approved COM textiles directly from True Textiles, C.F. Stinson, Luna Textiles, Maharam, and Momentum Textiles. When you select a textile through this program, Herman Miller will facilitate the ordering, scheduling, and shipment of the textile directly with the supplier.

Suppliers included in the Supplier Connection program keep an active inventory of textiles that are pre-approved for application to Herman Miller products. Pre-approval applies only to the suitability of a textile for manufacturing and application to a Herman Miller product. Omni provides an overview of fabrics that have been tested and indicates whether or not they were approved for application to Herman Miller products.

Specific information on the terms and conditions, testing, approval, and ordering process for the Supplier Connection program is listed below. Questions and requests for assistance may be directed to your COM representative at:

(616) 654 3400
(866) 854 3048 EXT 6543400

Supplier Connection Warranty

Textiles purchased by Herman Miller through the Supplier Connection program are COM and are not warranted by Herman Miller. COM textiles are tested for application only; they are not tested for performance. The Herman Miller warranty does apply to the underlying products.

Suppliers of COM textiles are responsible for color consistency within commercial tolerances, UV stability, and resistance to soiling and perspiration.

Customer's Own Material/ Customer's Own Leather Order Information — Cushion Tops

continued

Supplier Connection Pricing

Textiles purchased by Herman Miller through the Supplier Connection program are COM. COM is a Category 1 fabric. There are no application charges for COM fabrics.

Payment for textiles purchased by Herman Miller through the Supplier Connection program is the responsibility of the customer or dealer. Herman Miller will invoice the order at the supplier's prices published at the time of the order.

Textile Approval

1. Refer to Omni to identify the approval status of the textile. If your textile is not listed, contact the COM Department to request testing for application to Herman Miller products.
2. Herman Miller will notify you of approval or disapproval in approximately 4 days from receipt of the test yardage. If the textile is approved, it will be assigned a COM identification number.

Ordering Products with Supplier Connection COM

1. Identify and include the following information on your purchase order:
 - Product number and option
 - Herman Miller's COM identification number
2. Enter your order on Order Manager in Omni.
3. Upon receipt of the purchase order, Herman Miller will process your order and send you a PO acknowledgment. Herman Miller will determine the yardage required to produce your product and will order and schedule for delivery the required textile. Standard lead times in effect at the time the textile is allocated at the supplier will apply to products ordered through this program.

For more information about our products and services or to see a list of dealers, please visit us at HermanMiller.com or call (800) 851 1196.

© 2018 Herman Miller, Inc., Zeeland, Michigan

® **HermanMiller**, ●, Action Office, Aeron, Aside, Avive, Canvas Office Landscape, Caper, Celle, Co/Struc, Eames, Embody, Equa 2, Ergon 3, Ethospace, Exclave, Fine-Tune, FlexFront, Formcoat, Ground Cloth, Herman Miller Healthcare, Layout Studio, Maharam, Meridian, Mirra, Passage, Pellicle, Perspectives, PostureFit, Resolve, Sayl, Setu, Thrive, Tu, Y-Tower, and Z-Axis are among the registered trademarks of Herman Miller, Inc., and its owned subsidiaries.

™ AireWeave, Bubbletack, Cellular Suspension, Compass, Connect, DOT, Durawrap, Everywhere, Flex-Edge, Hopsak 2, Intent, Iota, Keyless Entry, Latitude, Lyris 2, Motia, Multiscrim, Nelson, Renew, Stackable, Swoop, TriFlex, Twist, and Verus are among the trademarks of Herman Miller, Inc., and its owned subsidiaries.

®Chemsurf® is a registered trademark of Wilsonart International.

Corian® is a registered trademark of E.I. du Pont de Nemours and Company Corporation.

FLEXNET™ is a trademark of Milliken & Company.

Floor Saver Glide® is a registered trademark of Carpin Manufacturing, Inc.

Geiger® is a registered trademark of Geiger International.

Microsoft® and Natural® Keyboard are registered trademarks of Microsoft Corporation.

Place Textiles® is a registered trademark of Place Textiles.