

Privacy Wall Butt-Hinged Door (For products manufactured after September 14, 2009)

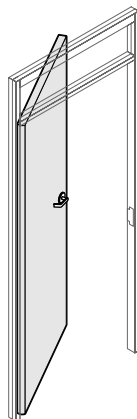

Full-Height
(No Switch)



Transom
(No Switch)

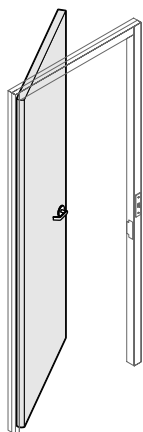

Full-Height
(With Switch)

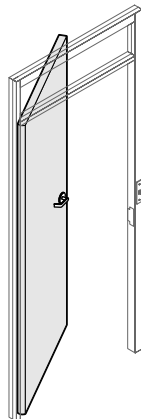

Transom
(With Switch)

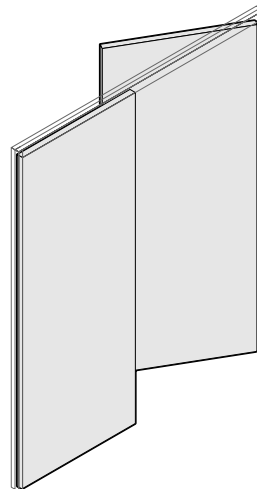

Full-Height Pair

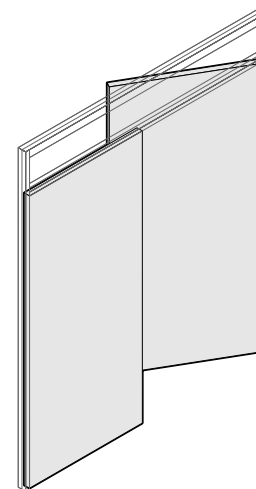

Transom Pair

ETCHED GLASS STYLES:

- Satin
- Mist

PATTERN GLASS STYLES:

- Waterfall
- Bamboo
- Harp
- Mirage

NOTE:

For etched/pattern glass orientation please refer to the installation drawings. Unless noted otherwise, use the default.

DEFAULT GLASS ORIENTATION:

ETCHED GLASS:

Rough side to go on the **inside** of the office space.

PATTERN GLASS:

Rough side to go on the **outside** of the office space.

Topic

Page

Butt-Hinged Door Components 2

Butt-Hinged Door Frame Assembly 3

High Voltage Switch Installation (optional) 9

Low Voltage Switch Installation (optional) 12

Install Hardware on Inactive Leaf (Door Pairs) 13

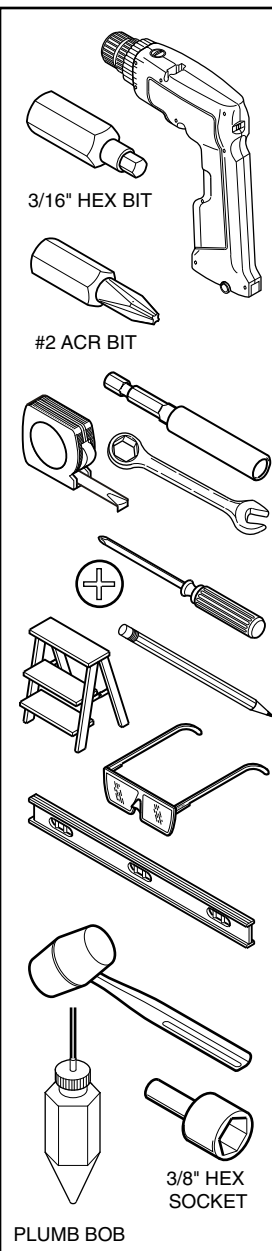

If you have a problem, question, or request, call your local dealer, or Steelcase Line 1 at **888.STEELCASE** (888.783.3522) for immediate action by people who want to help you.

(Outside the U.S.A., Canada, Mexico, Puerto Rico, and the U.S. Virgin Islands, call: 1.616.247.2500) Or visit our website: www.steelcase.com

© 2016 Steelcase Inc.
Grand Rapids, MI 49501
U.S.A.

Printed in U.S.A.

FULL HEIGHT FRAME (KNOCK-DOWN)
TOP RAIL ASSEMBLY, TOP STRIKE ASSEMBLY,
UPRIGHT (KEEPER SIDE) & UPRIGHT (HINGE SIDE).

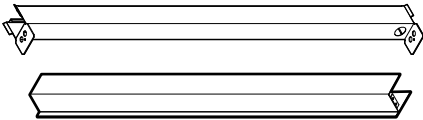

Butt-Hinged Door Components

TRANSOM
FRAME

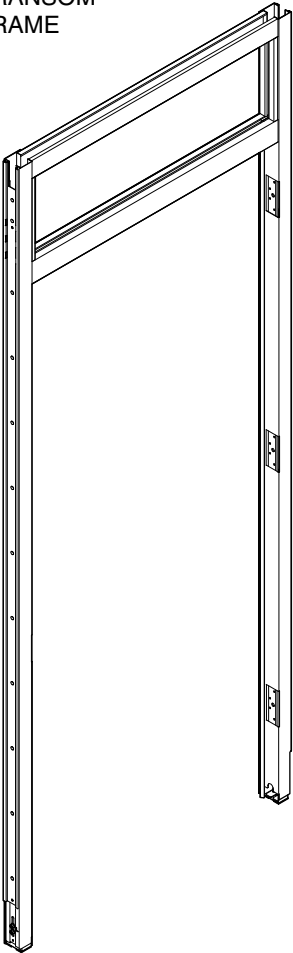

DOOR
(Ordered separately
from frame unit.)

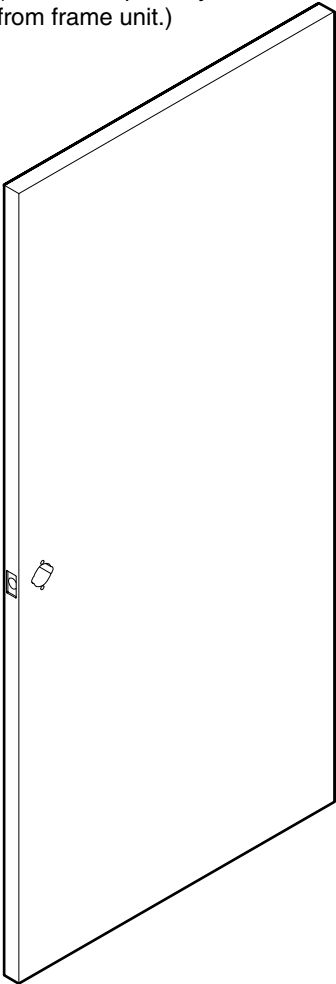

DOOR SEAL

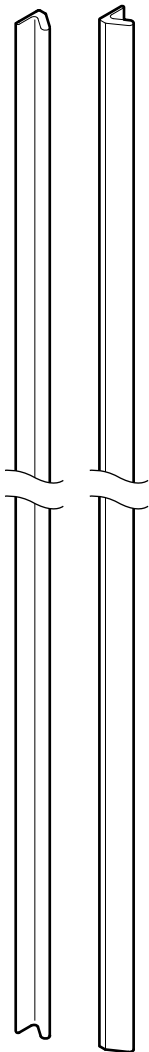

(Ordered separately from the frame unit.)

DOOR HANDLE AND STRIKE
MORTISE HANDLE
(LOCK VERSION)

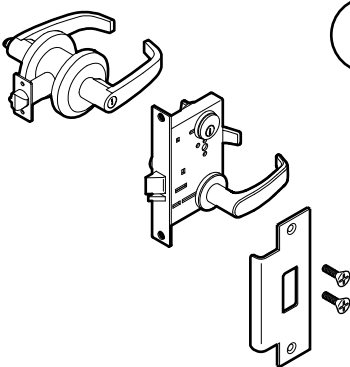

or

DOOR HANDLE AND STRIKE
MORTISE HANDLE
(LATCH VERSION)

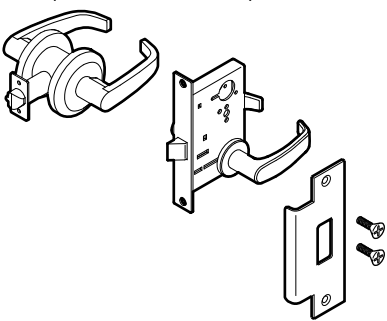

INNER PLINTH
ASSEMBLIES

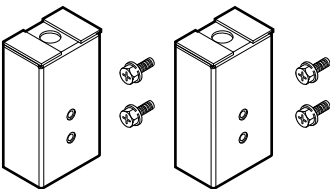

OUTER PLINTHS

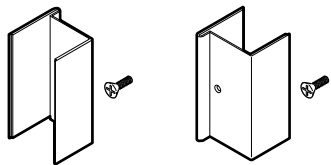

HINGE
(Quantity varies per door style)

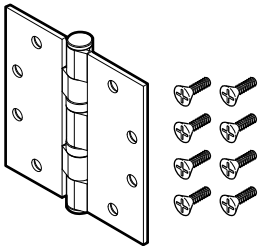

ANCHOR PLATE

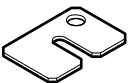

FULL HEIGHT BUTT-HINGED DOOR FRAME ASSEMBLY

If you have a transom frame, start assembly on next page.

1. Install the top strike assembly on the two (2) outer door verticals on both sides, as shown, with two (2) #10-16 x 1/2" pan head self tapping screws per side.

2. Slide the top rail assembly into the top of the outer door vertical and line up holes on both sides. Install the top rail assembly with one (1) #10-16 x 1/2" pan head self tapping screws per side.

NOTE: Make sure to align the electrical pass through hole with the switch side of the frame.

NOTE: On a full height butt hinged door only, if the bottom door gap appears too large. The split outer door vertical feature allows the top rail to telescope 1/2" from the top strike. Allowing the door frame to be positioned lower. On both sides slide out the post extension and loosen the fasteners holding the top half of the upright clamp plates. The telescoping inner horizontal can now be raised. Now reassemble.

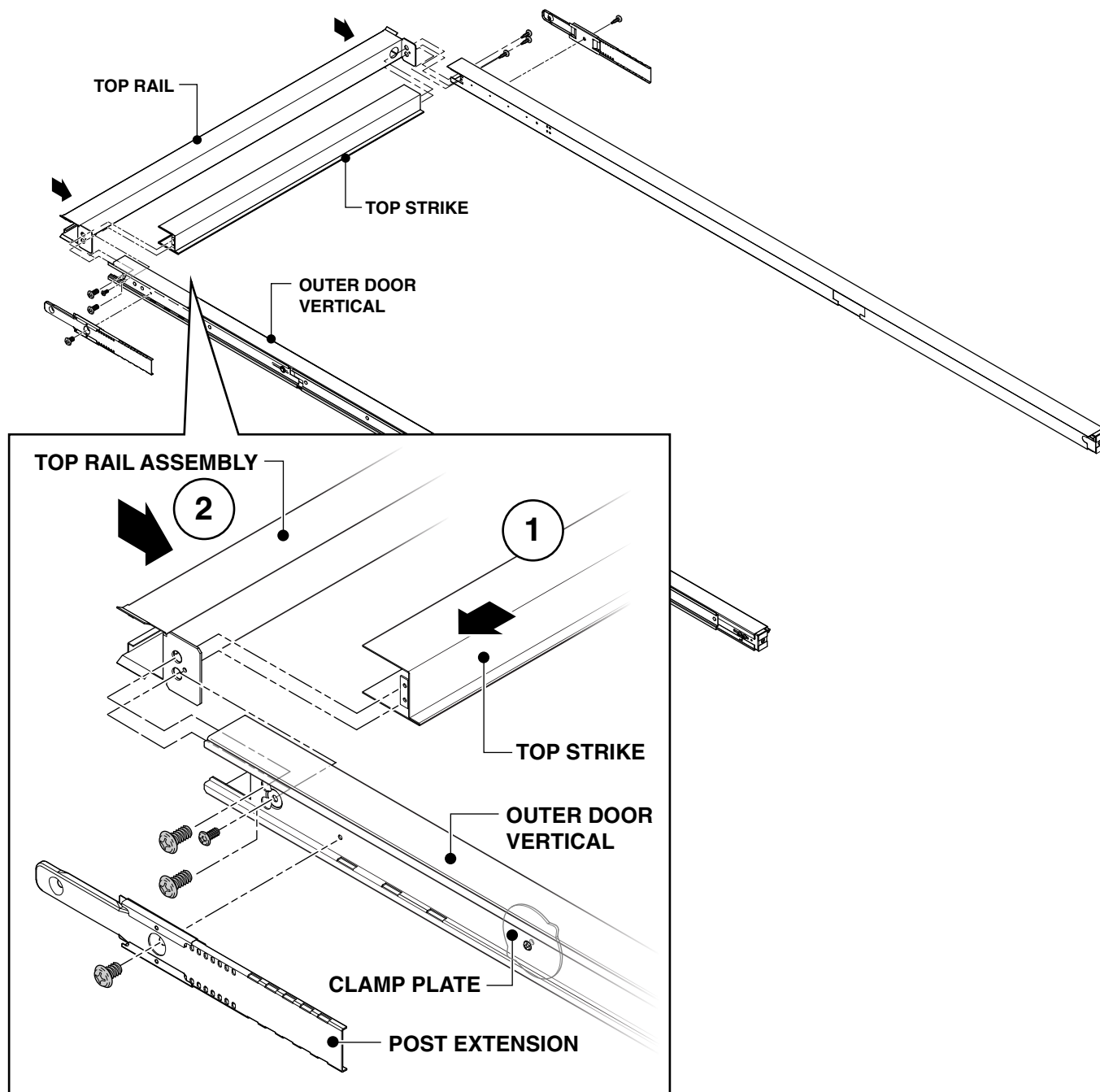

3. Lift frame up and align with panels.

4. Determine which outer door vertical must be moved upward to make the inner header assembly level horizontally. Adjust screws securing the outer door vertical.

5. Check for squareness by measuring the door opening.

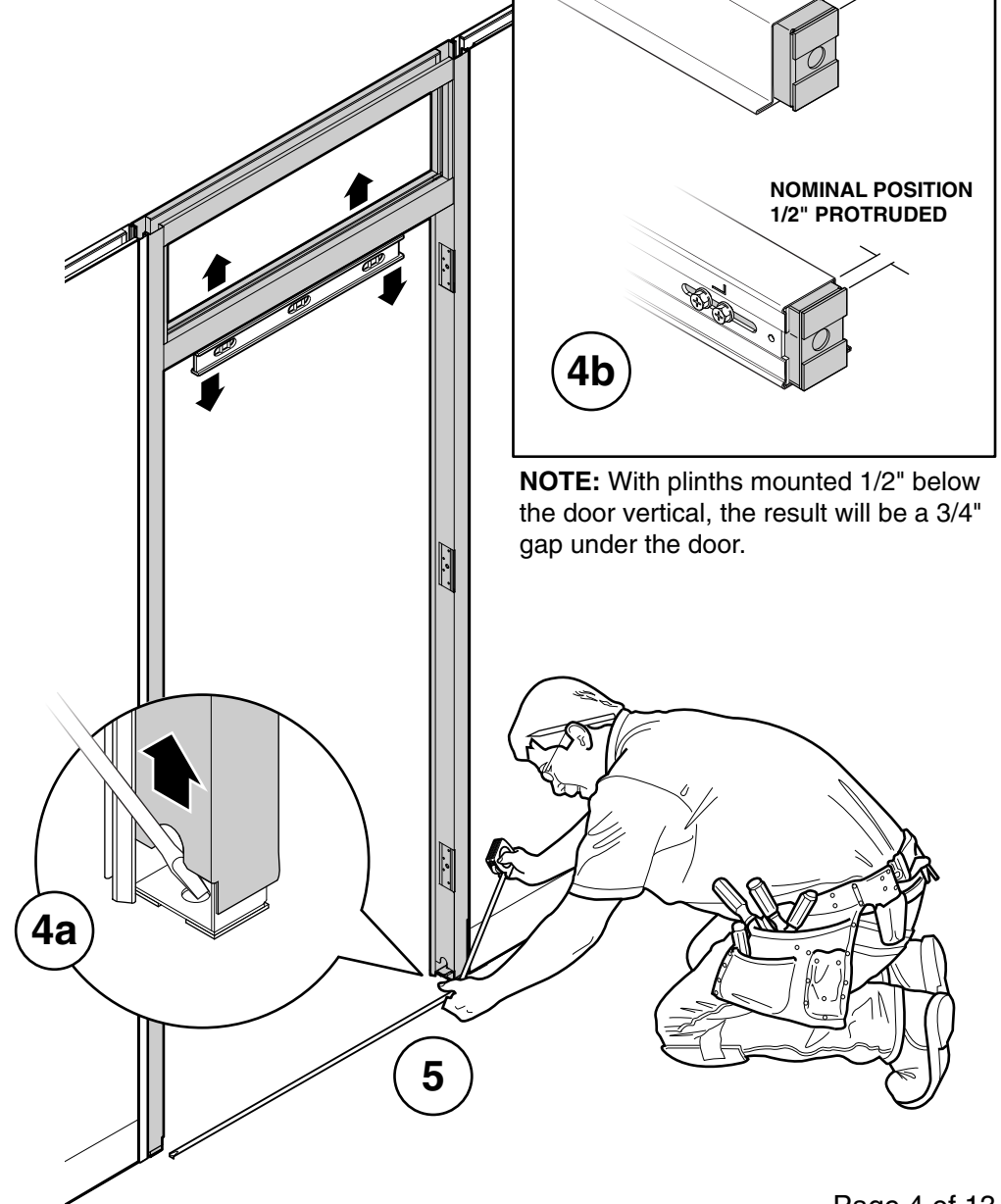
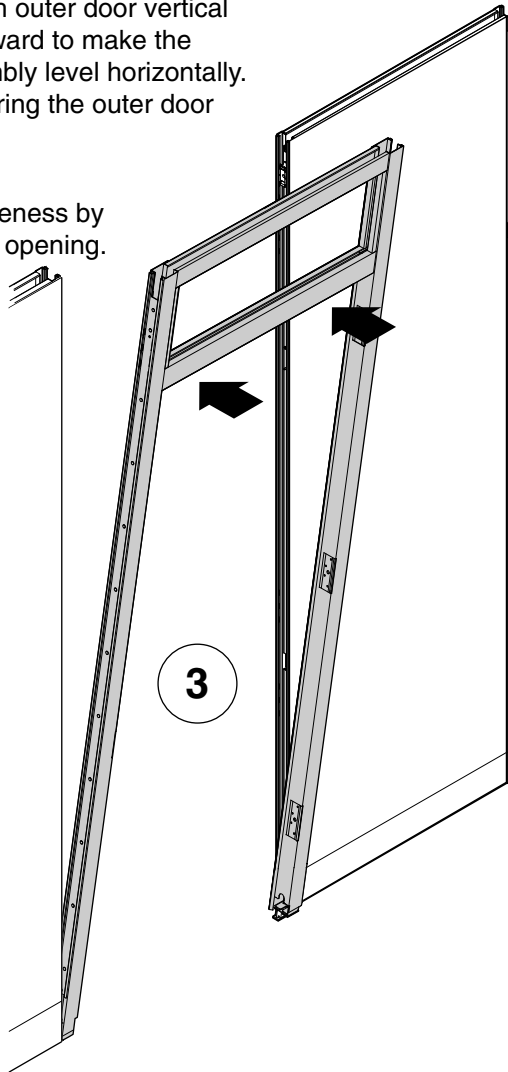

NOTE: With plinths mounted 1/2" below the door vertical, the result will be a 3/4" gap under the door.

Optional Anchoring

1. Mark the center of the hole (both sides) (1a) plus note the 37-1/2" hole distance (1b).

2. Slide frame legs forward (2a) for access to drill holes (2b).

3. Drill holes on the floor (3a) and semi mount the anchor screws (1/8" under screw head) (3b).

4. Slide and lift frame back into position. Check for squareness.

5. Slide anchor plate under screw head.

6. Tighten down the anchor screws.

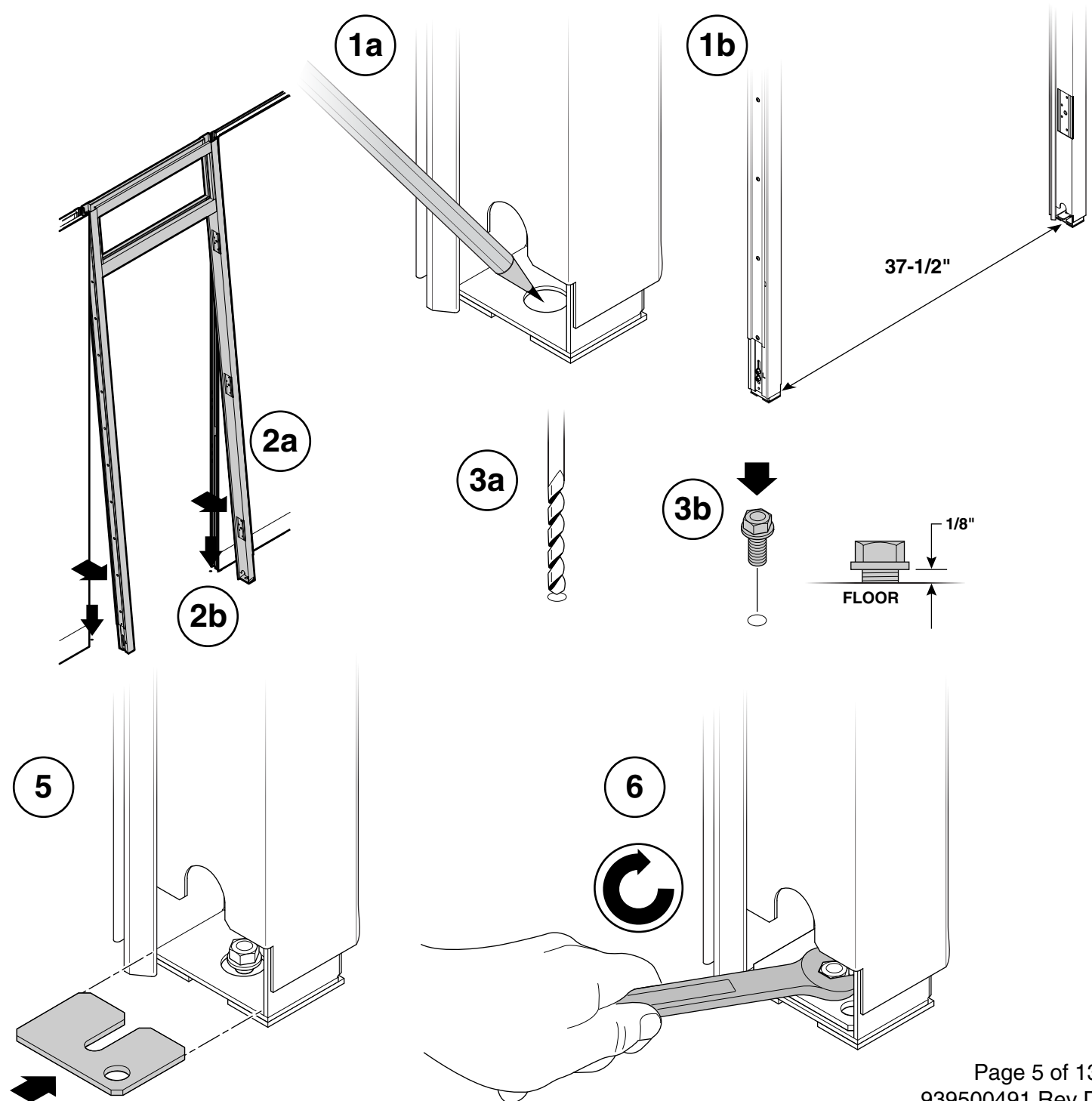

Hinge Side

Strike Plate Side

7. Peel off paper on back of seal (7a).

On hinge side, apply door seal onto the door seal retainer assembly at top and work downward (7b).

Repeat procedure for strike plate side (7c).

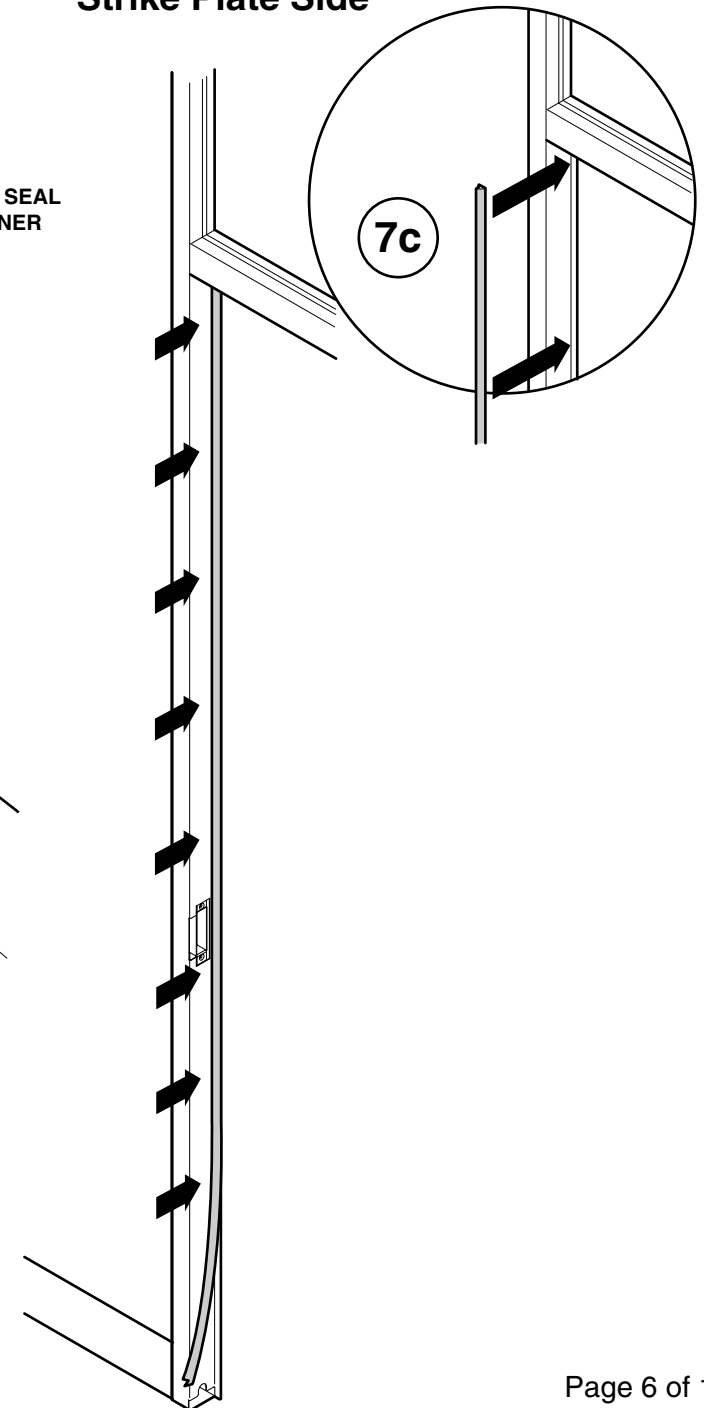
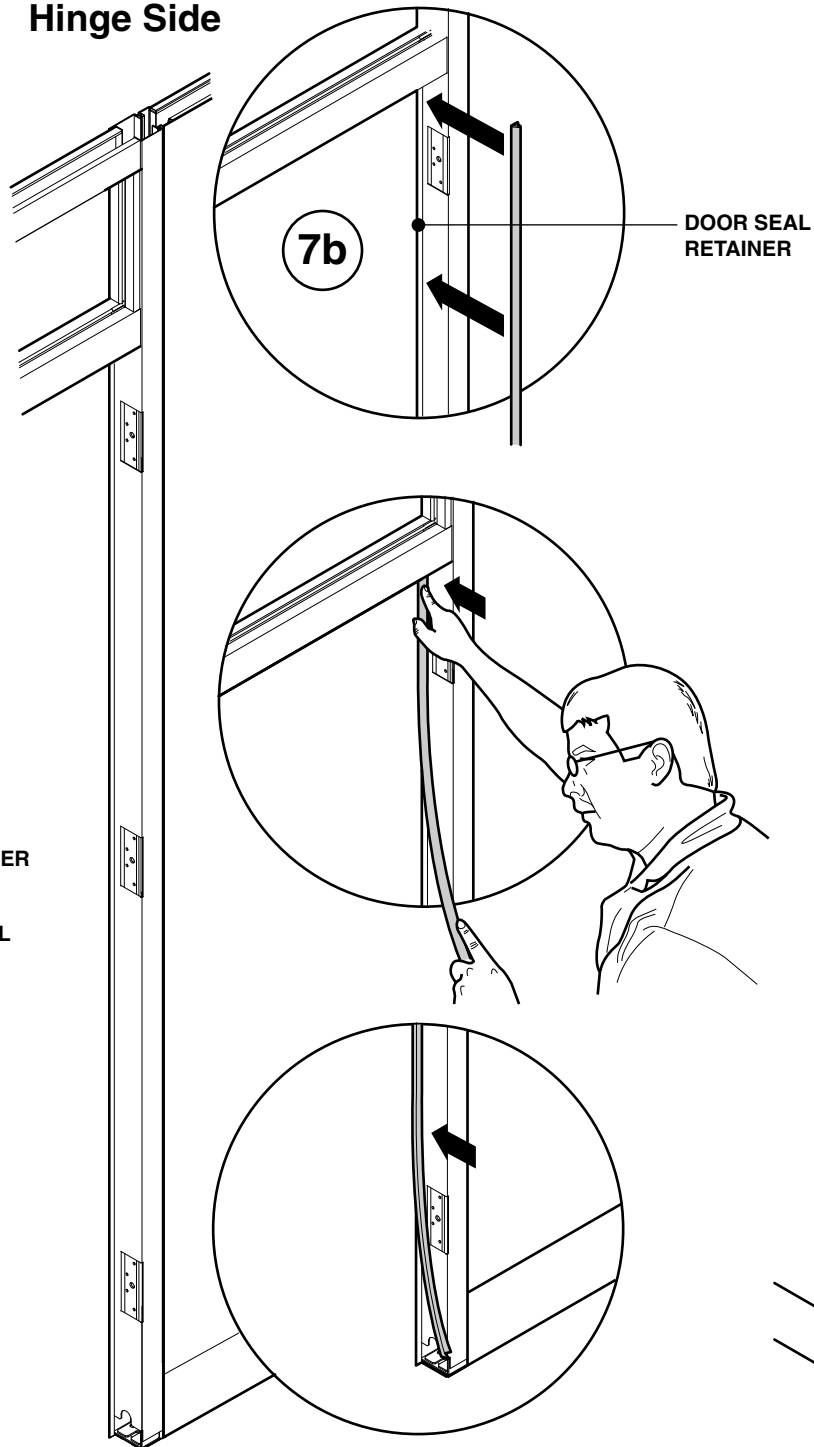
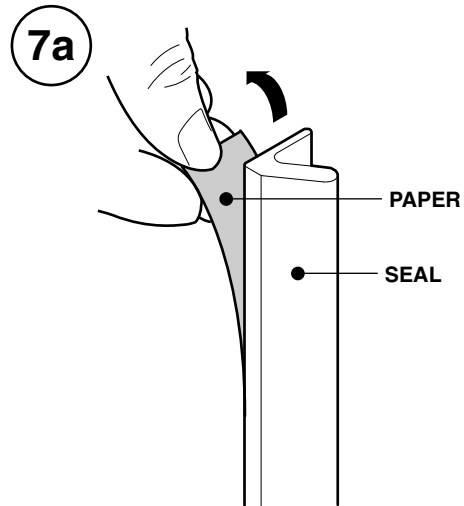

8. Install outer plinths using screws provided.

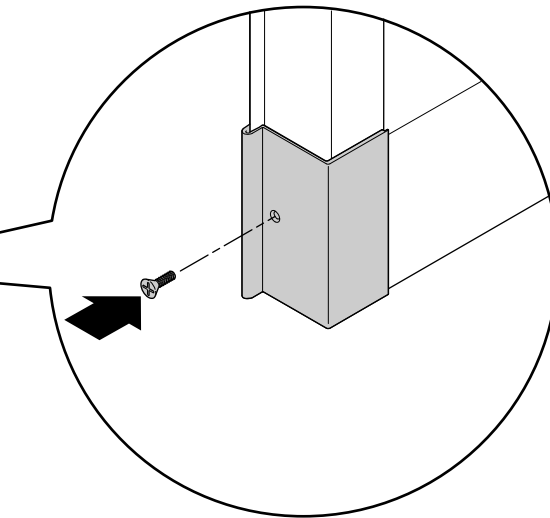
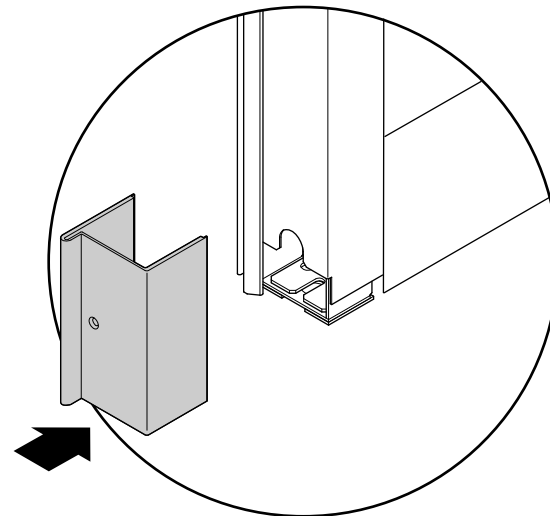
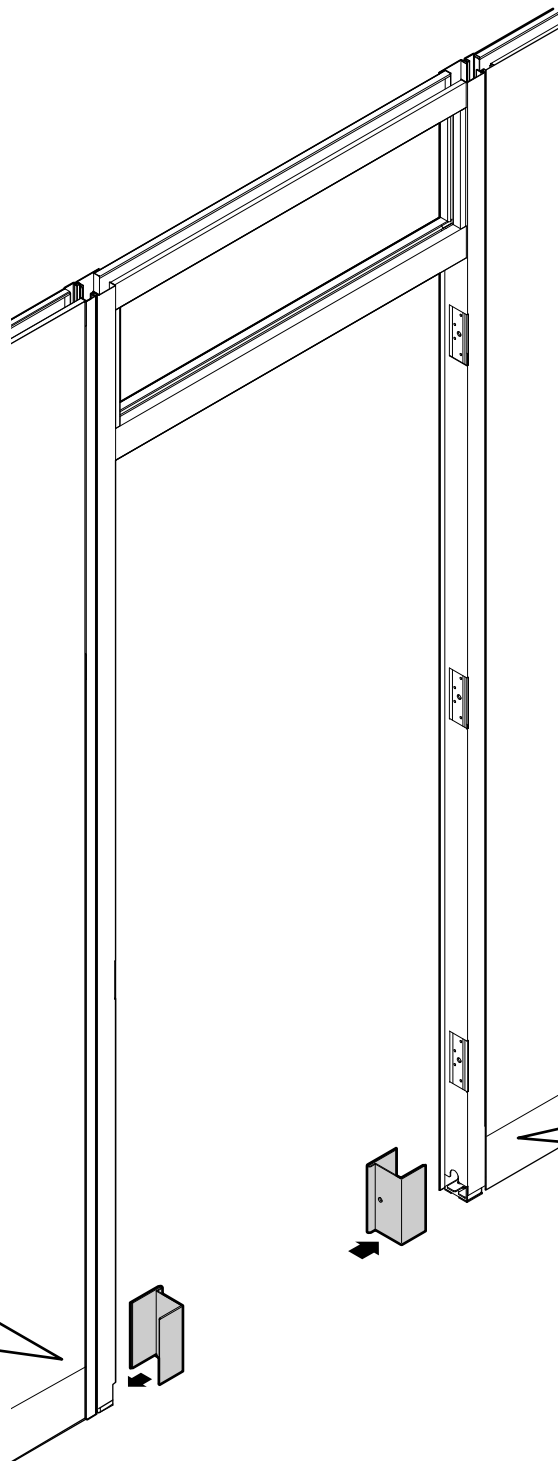
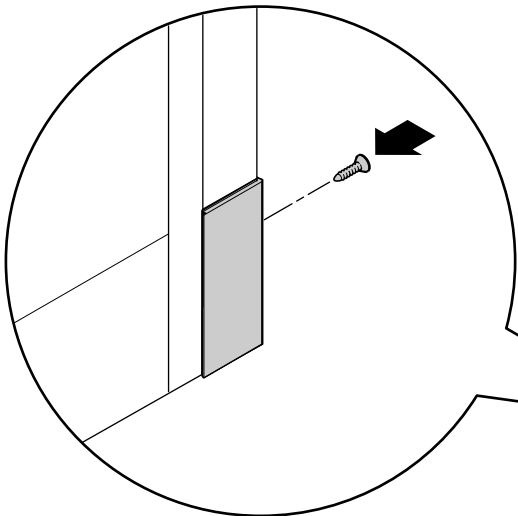
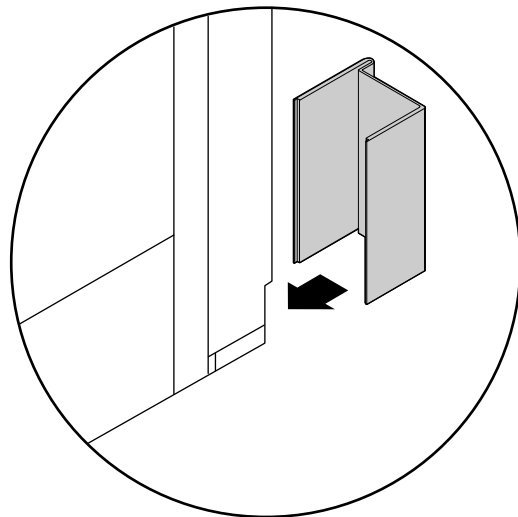

9. Install strike plate to the inner door vertical (strike side) with the two (2) #10-16 x 1/2" flat head screws provided.

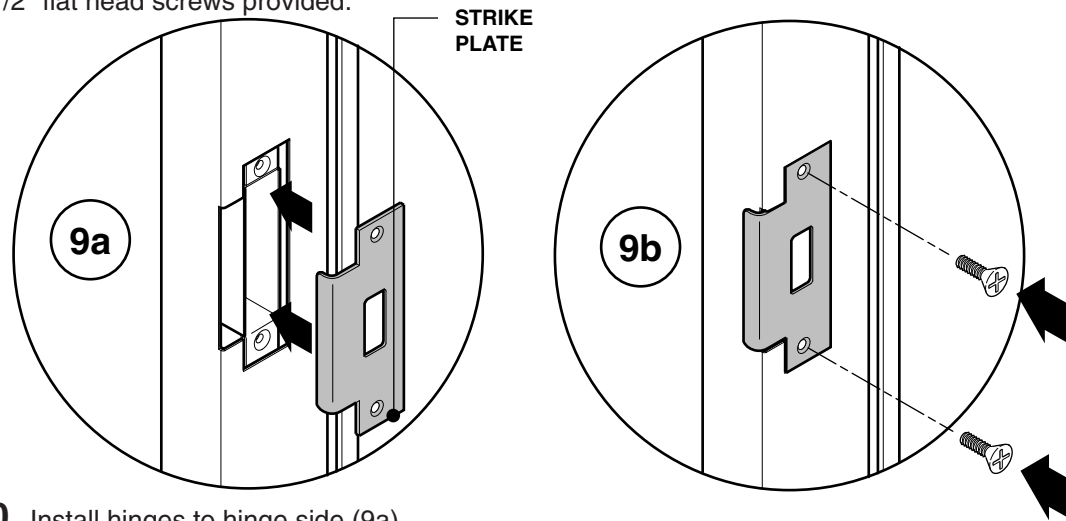

10. Install hinges to hinge side (9a). Attach using the four (4) #10-16 x 1/2" flat head screws provided.

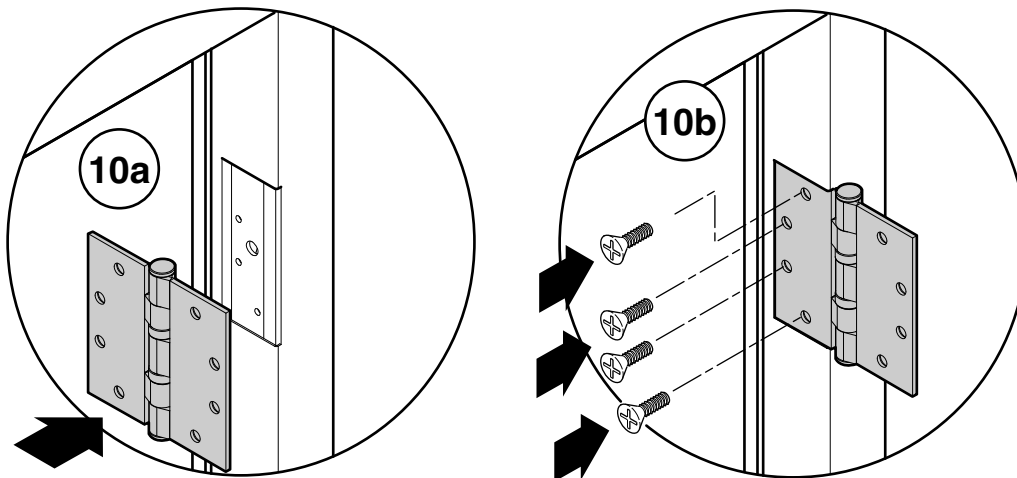

11. Attach door to hinges.

12. Assemble door hardware (Ordered separately from the frame unit.)

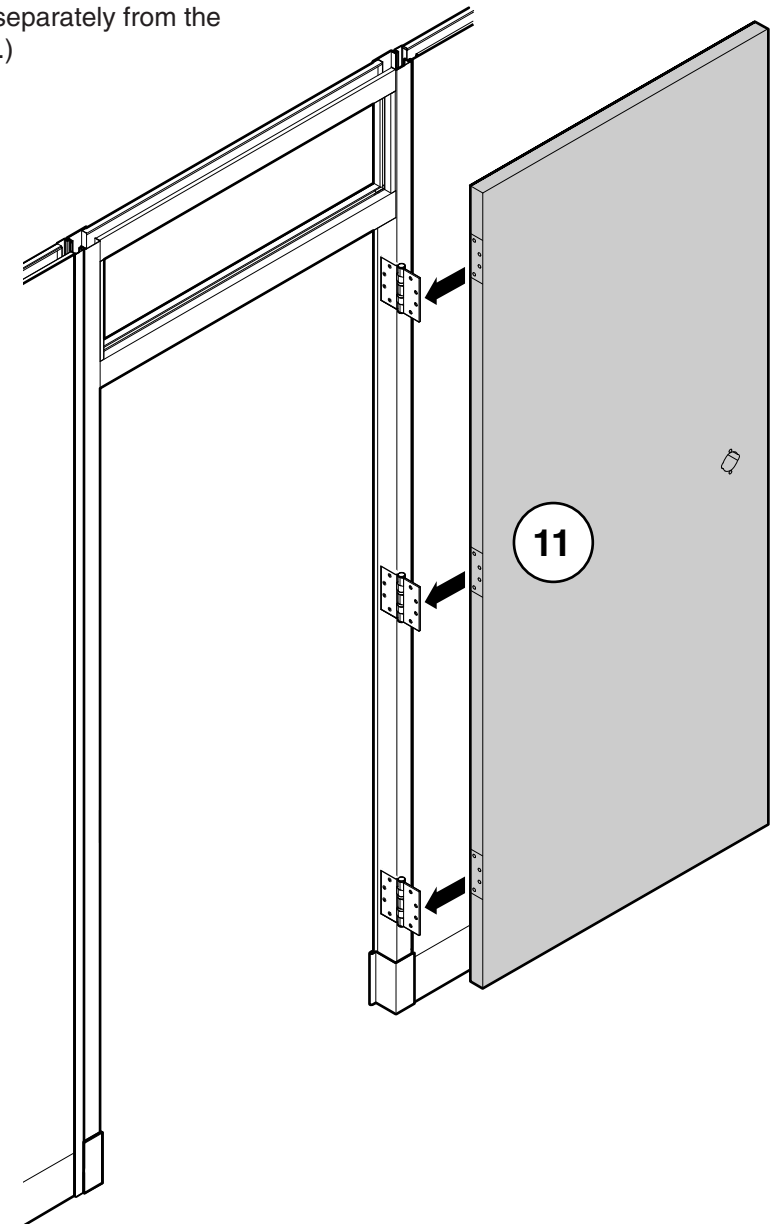

High Voltage Switch Installation (optional)

1. Remove the desired knockout on the high voltage electrical box.
2. Route the conduit through the frame, out of opening in the frame and attach to the high voltage electrical box depending on the desired scenario.

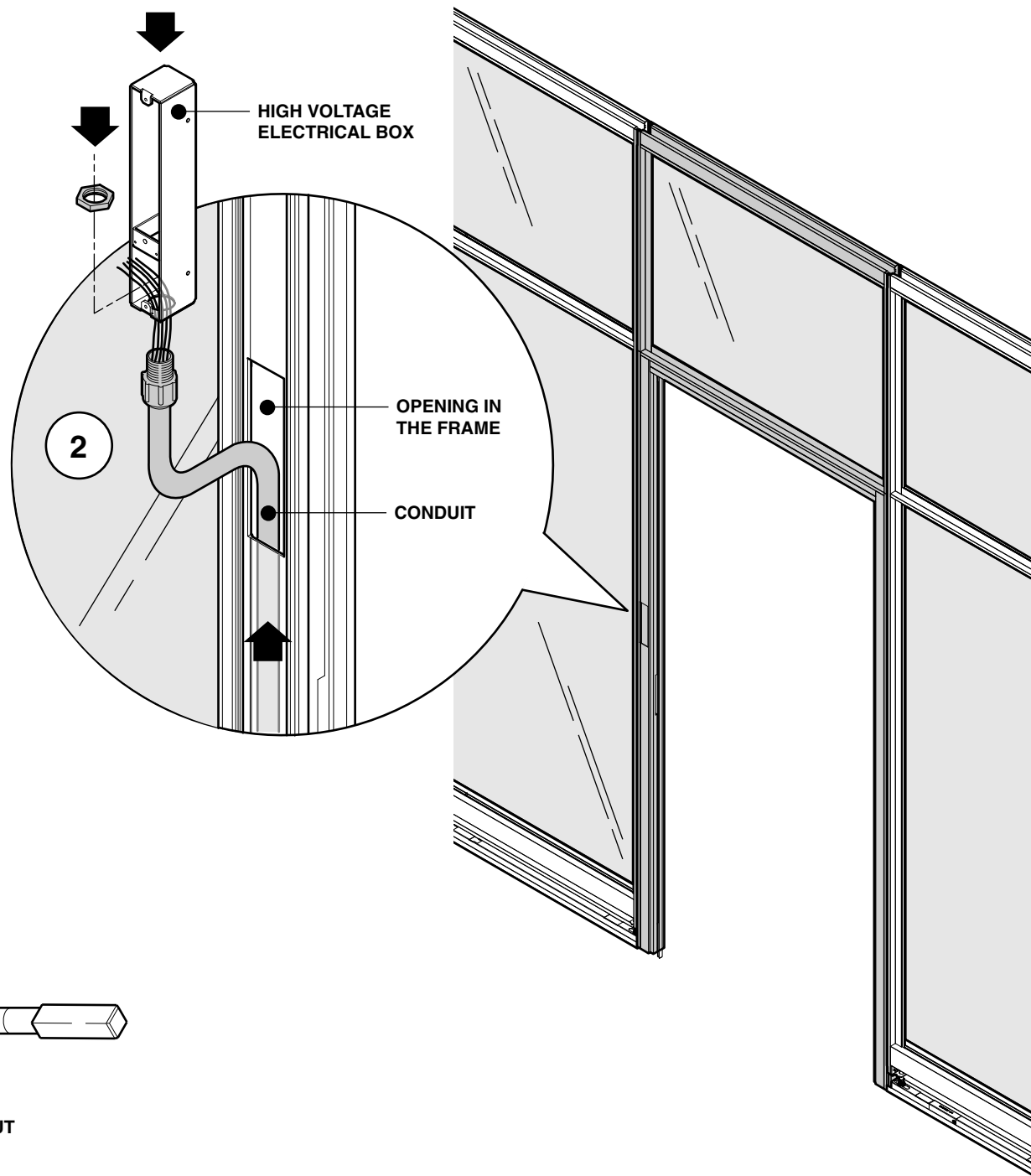
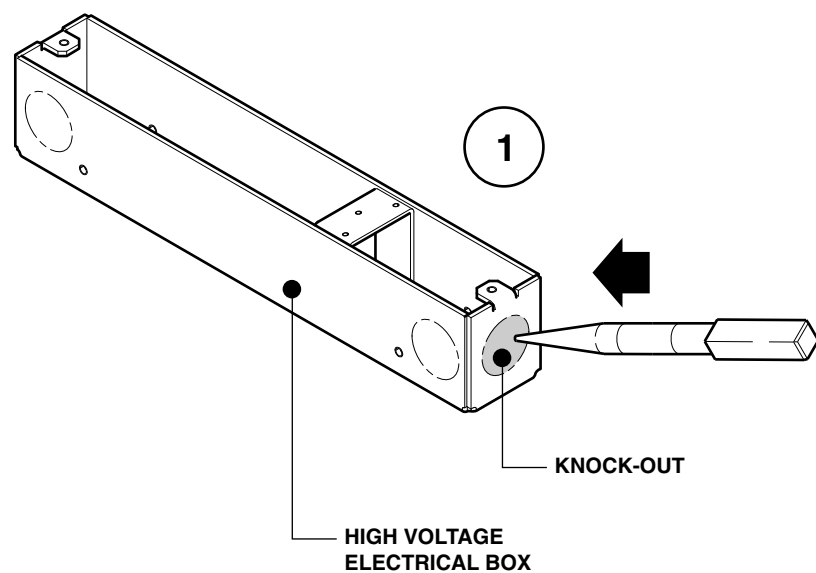

3. With conduit properly attached, feed conduit back through opening in frame including the high voltage electrical box (3a). Attach box to vertical rail (3b).

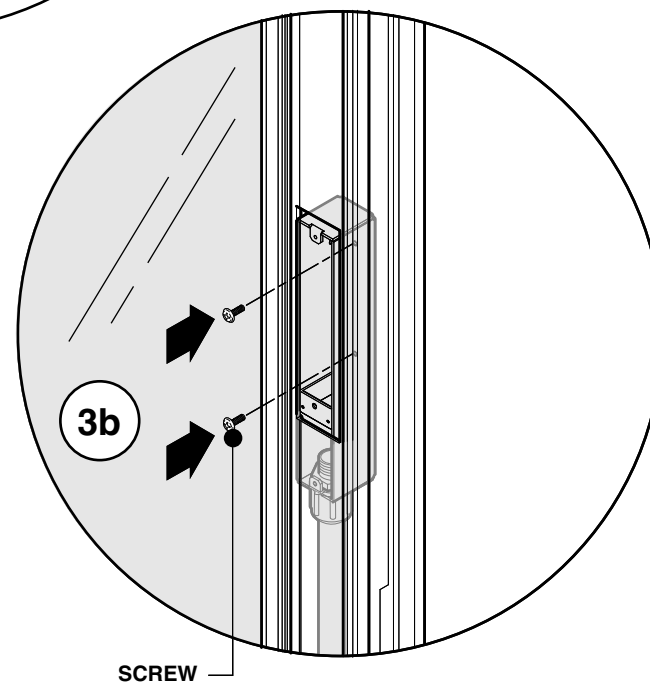
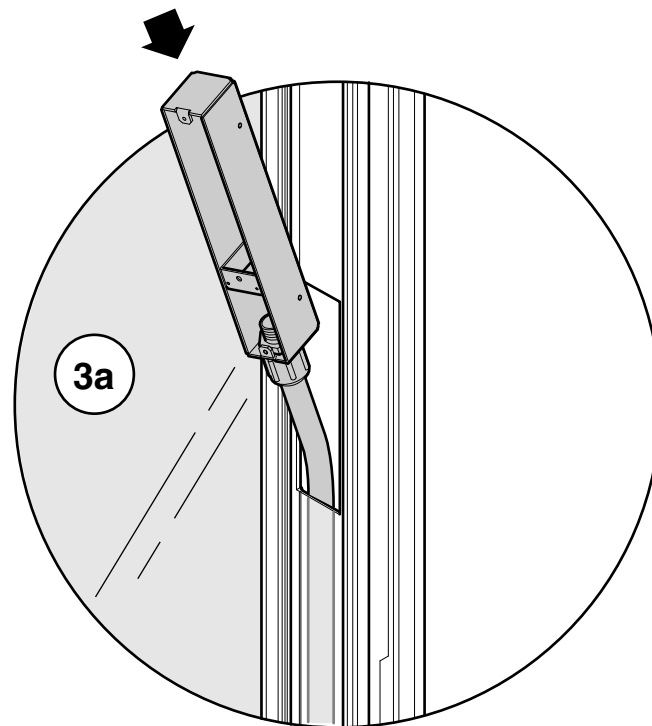

SCREW

4. Snap flush switch onto box strap.
Wire switch.

NOTE: Must be a licensed electrician to wire switch.

Attach wired assembly to electrical box using two (2) screws (4a).

Attach switch plate to electrical box using two (2) screws (4b).

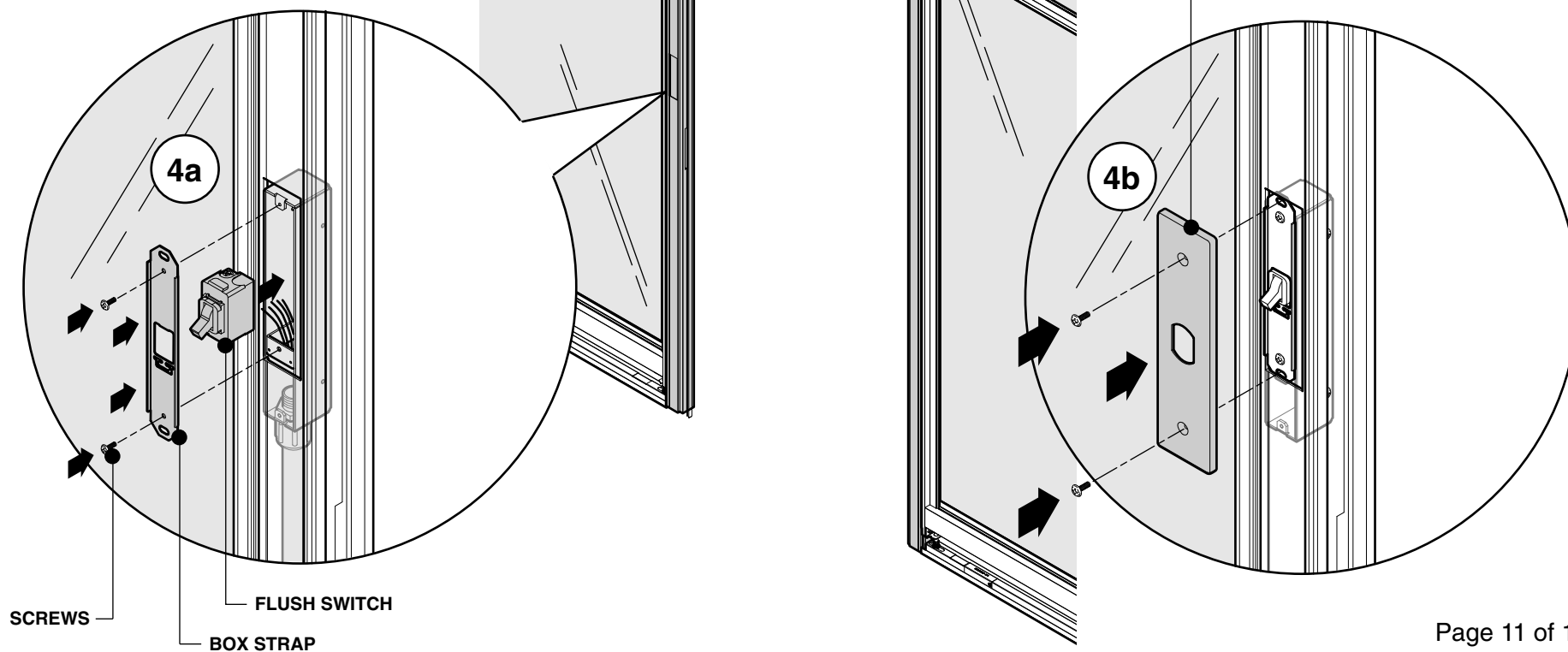

WARNING: All electrical installations should be done by a qualified electrician in accordance with codes and regulations applicable at the installation site.

Low Voltage Switch Installation (optional)

1. Attach watt stopper to J-box (1a). Route low voltage wire up through bottom of frame or down from top of frame in full height scenarios only (1b).
2. Pull low voltage wire through opening and attach to quick connects (2a). Attach low voltage switch to quick connects (2b) and insert assembly into hole (2c) and snap into place.
3. Install plinth and seal as shown on pages 16 & 17, steps 5 through 7.

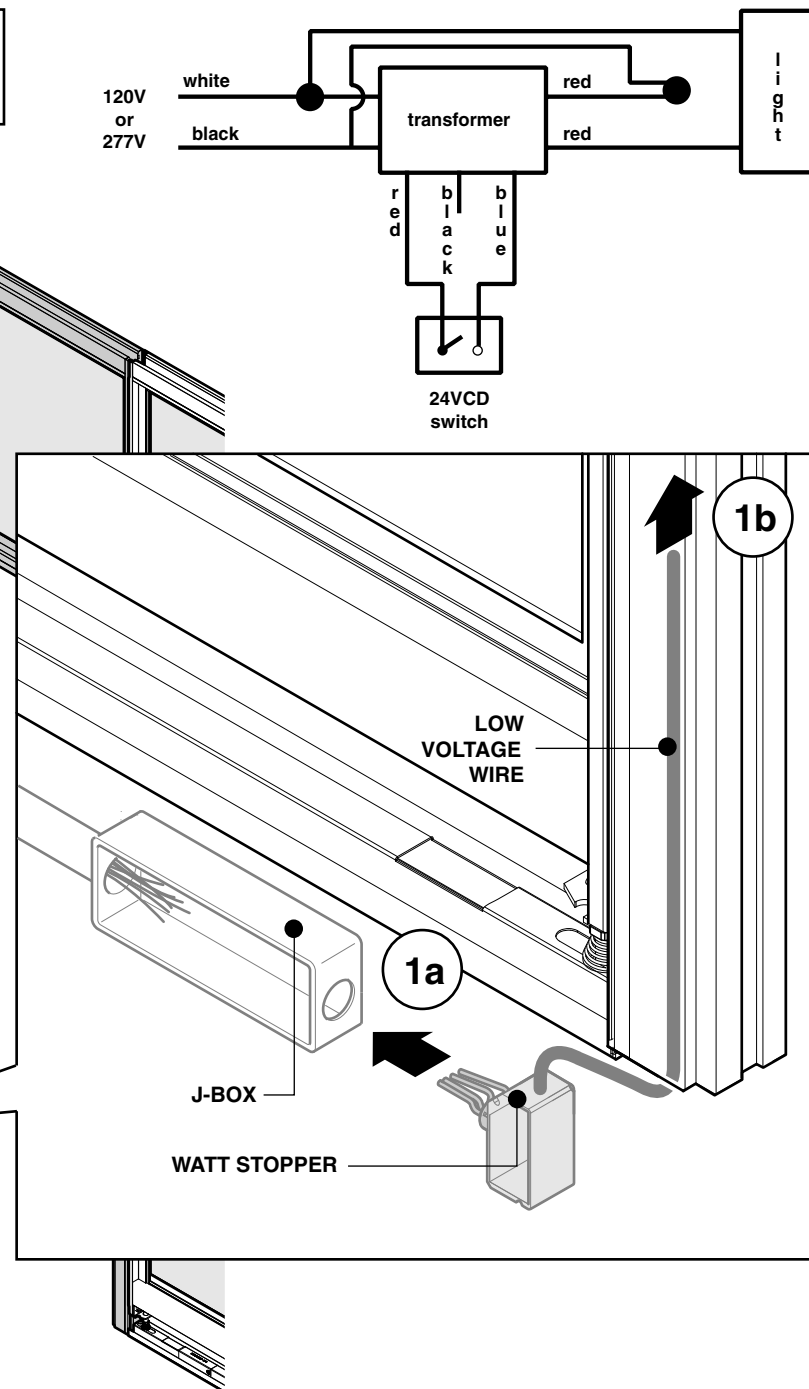
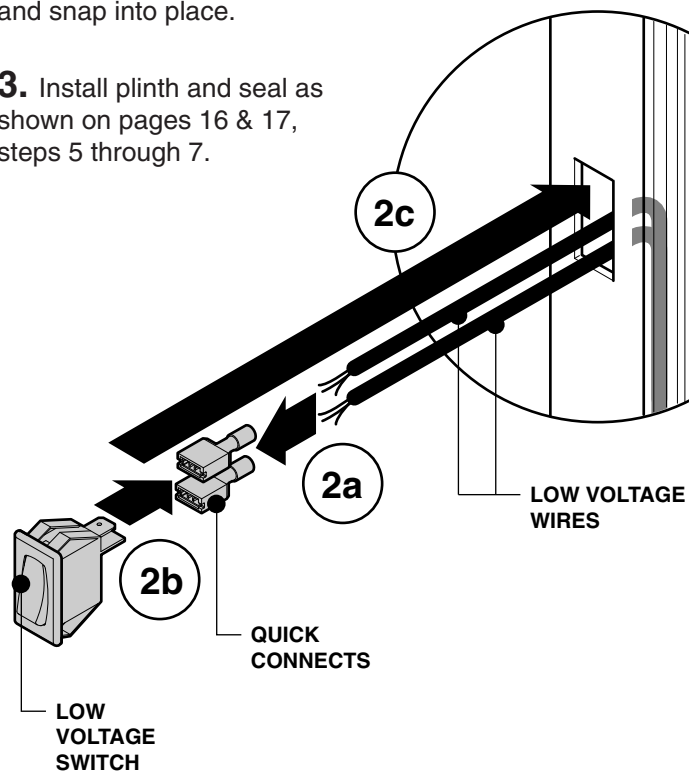

Install Hardware on Inactive Leaf (Door Pairs)

1. Install flush bolts with threaded rods into inactive door leaf using screws provided.

Note: For transom height doors, the stock threaded rod that comes with the flush bolts is used on top and bottom. For full height doors, the flush bolt used at the top uses the long threaded rod. It will need to be cut to length so that the bolt is flush with the top of the door.

2. Install the door guide plates to the top and bottom of the door.

3. Hang inactive door leaf into frame and install strike plate.

4. Mark location for top and bottom strike plates on header and floor. Drill necessary holes in the door header and floor for attachment screws and to receive flush bolt rods. 5/8" diameter hole 3/4" deep is sufficient to receive rods. Use appropriate fasteners depending on the floor type. Install the top and bottom strike plates.

