

®

FECTION™

Ceiling &
Wall Panels

Inspiring Great Spaces®

Armstrong®
CEILING & WALL SOLUTIONS

TECTUM®

Ceiling & Wall Panels

Tectum® ceiling and wall panels provide durable, sustainable, acoustical solutions with unlimited design options. Tectum 1" thick panels are part of the Sustain® portfolio and meet the most stringent sustainability standards today.

Direct-Attach in custom colors;
Kalamazoo Public Library, Kalamazoo, MI;
David Milling Architects, Ann Arbor, MI ►



4
BLADES™ &
BAFFLES



5
SHAPES &
CLOUDS



6-7
DIRECT-ATTACH
CEILINGS & WALLS



8
FINALE™ HIGH NRC
CEILINGS & WALLS



9
LAY-IN & TEGULAR
CEILINGS



10
FABRIC WALLS



11
PANEL ART
CEILINGS & WALLS



13
SIZES, COLORS &
ACOUSTICAL
PERFORMANCE



Blades™ & Baffles FIT TO THE MAX

Vertical elements control acoustics
with an upscale linear visual.

- Upscale linear visual adds acoustics and aesthetics to any space
- Noise absorption up to 0.50 Sabins/SF
- Custom shapes and sizes available to meet your project needs

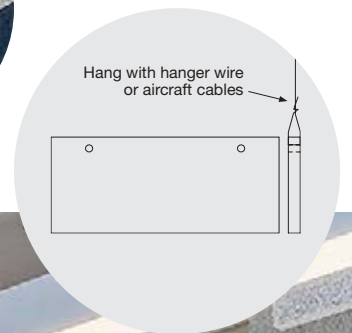
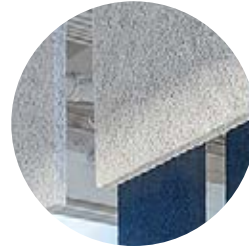

▼ Tectum® Blades™ custom vertical panels; Capital One Labs, San Francisco, CA



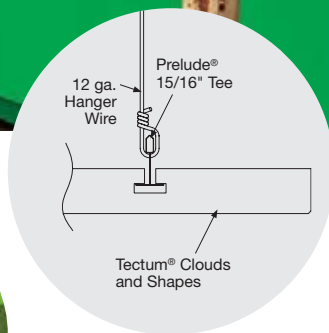

▲ Tectum® Clouds; Retail Me Not, Austin, TX; STG Design, Austin, TX

Shapes & Clouds

FLEXIBLE FIT

Shapes and Clouds offer design flexibility in a floating system.

- Noise absorption up to 0.50 Sabins/SF
- Wide variety of color options available
- Installs with 15/16" Prelude® suspension system
- Square or radius edges



▲ Tectum® Panel Art and Direct-Attach wall panels in White and custom colors;
Boys & Girls Club of Lancaster, Lancaster, PA

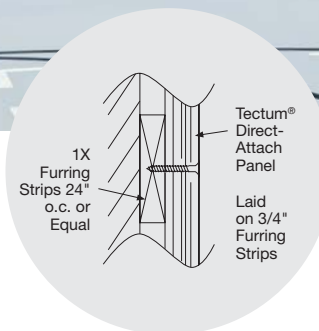

Direct-Attach FIT THE BILL

Install panels directly to ceilings and walls to add durability and noise reduction to a wide variety of spaces.

- Durable for heavy-use interiors, pools (walls), and exterior-covered spaces (ceilings)
- Retrofit solution for noise reduction
- Excellent sound absorption – NRC up to 1.0
- 1" thick panels are part of the Sustain® portfolio
- Can be mechanically fastened to a wide variety of surfaces
- FSC® Certified Panels available



CASE STUDY

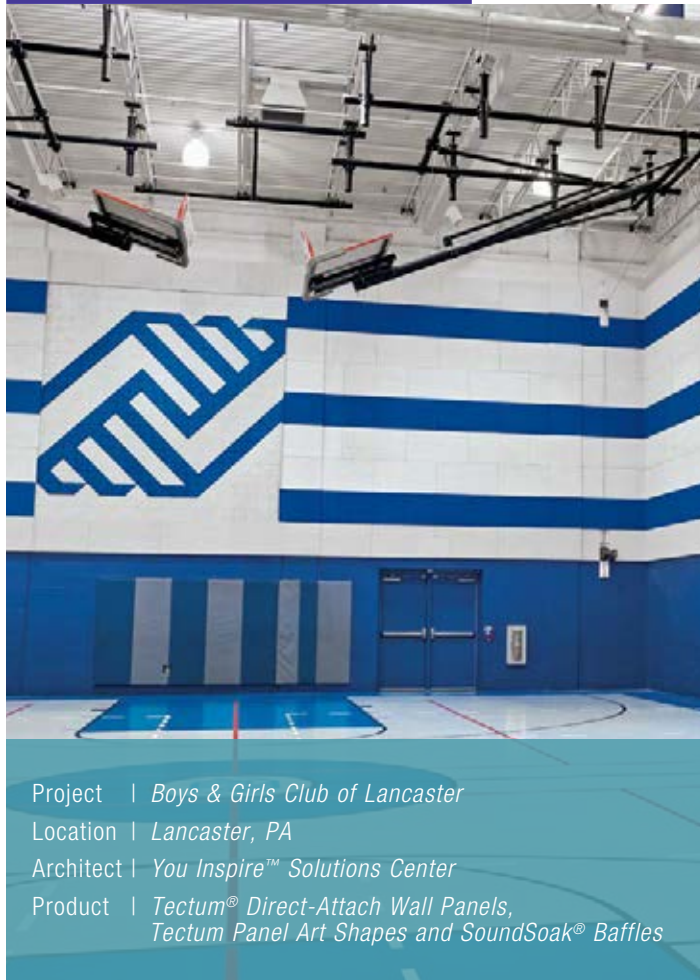

Project | Boys & Girls Club of Lancaster
 Location | Lancaster, PA
 Architect | You Inspire™ Solutions Center
 Product | Tectum® Direct-Attach Wall Panels,
 Tectum Panel Art Shapes and SoundSoak® Baffles

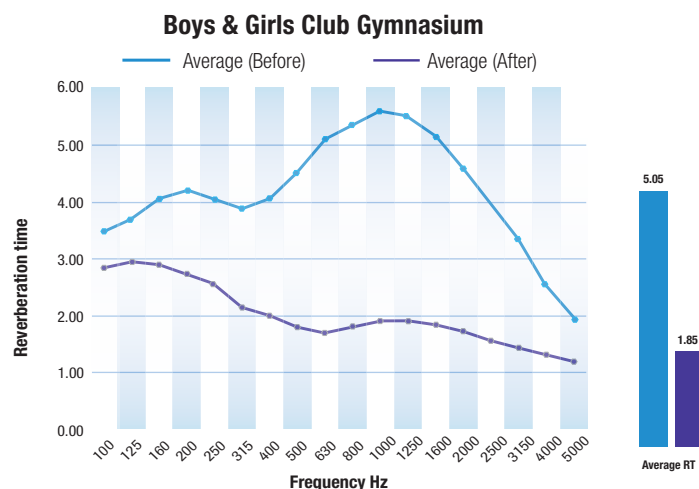

the challenge:

The gymnasium at the Boys & Girls Club of Lancaster is in use every day, not only for sports activities but a variety of other functions as well. Its acoustic environment, however, was not always ideal. Acoustical testing showed that reverberation time in the gym was 5.05 seconds, far above the 2.00 seconds or less recommended for this type of space. As Karen Schloer, the Club's Chief Executive Officer, notes, "The noise level was putting a real strain on the staff because they had to shout so often when trying to communicate with the kids."

the solution:

To solve the problem, Armstrong Ceiling and Wall Solutions installed more than 3,500 square feet of Tectum® Direct-Attach wall panels on the gym's masonry walls. The panels were chosen because of their ability to absorb both sound and the impact of basketballs, volleyballs, and other objects that hit the walls.

Aesthetically, the two-inch-thick, 2' x 4' panels are installed in ribbons of white and a custom blue that match the Club's colors. They start nearly 10-feet off the floor and continue up the wall another 18-feet.

In addition, a re-creation of the Boys & Girls Club logo is installed at each end of the gym. The 15-foot wide and 13-feet high visual of two interlocking hands was created using 8-inch triangular Tectum Panel Art shapes. The white triangles are one-inch thick, while the blue triangles are two-inches thick so that they stand out from the wall. Two rows of 12 SoundSoak® Baffles were installed in the center of the ceiling for added noise absorption.

Acoustically, the 2" Direct-Attach Tectum wall panels have a Noise Reduction Coefficient (NRC) of 0.70. Acoustical testing conducted after the installation of the combination acoustical treatment showed that reverberation time dropped to 1.85 seconds, a 63% reduction.

According to Chief Operations Officer, Scott McLellan, "The difference is like night and day. The biggest takeaway is how much easier it is now for the staff to gain control of the space because the kids can hear directions much more clearly."

Looking back at the difference in the gym's acoustic comfort, McLellan adds, "The staff simply didn't realize how bad it was because they didn't realize how good it could be."

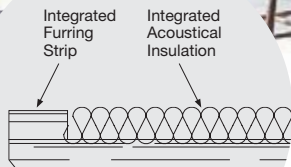

▲ Tectum® Finale™ High NRC direct-attach ceiling panels



- Abuse-resistant composite panel design for maximum noise reduction and efficient installation
- Excellent sound absorption – NRC up to 0.80
- Variety of color options available
- Can be mechanically fastened to a wide variety of surfaces

Finale™ High NRC

A SOUND FIT

Finale™ direct-attach ceiling and wall panels offer maximum noise reduction and install 2.5x faster than C-20 mount direct-attach panels for reduced installation costs. A perfect way to add acoustics to exposed structure spaces.

Lay-In & Tegular FIT FOR PURPOSE

Durable, sustainable, noise control for spaces requiring acoustics and design flexibility.

▼ Tectum® Tegular 24" x 48" panels in White with Prelude® XL® 15/16" suspension system

- Durable for heavy-use interiors
- 1" thick panels are part of the Sustain® portfolio
- Tegular panels have Total Acoustics® Performance*
- FSC® Certified Panels available

* When installed with Fine Fissured™ infill panels



SUSTAIN®
High Performance
Sustainable
Ceiling Systems



**TOTAL
ACOUSTICS®**
Sound Absorption (NRC)
+ Sound Blocking (CAC)

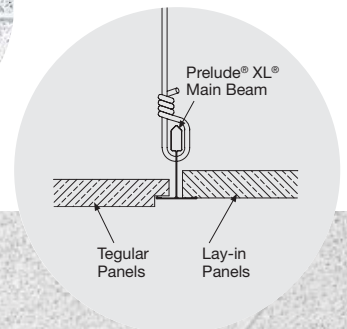

Fabric Walls TWICE THE FIT

Fabric walls do double duty, providing both acoustics and a tackable surface for displays and bulletin boards.

- Abuse-resistant, fabric wrapped panels attach directly to walls
- Excellent Noise Absorption – NRC up to 0.90
- Mounting is quick and easy using internal spline system
- Durable fabric options available
- Fabric wrapped to kerf or decor clip, edges unfinished

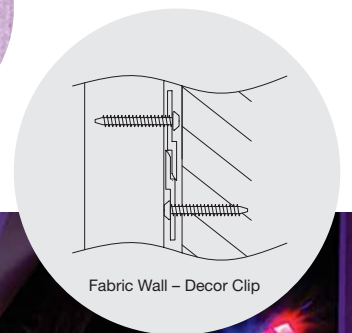

▼ Tectum® Fabric wall panels; Southland Christian Church, Lexington, KY



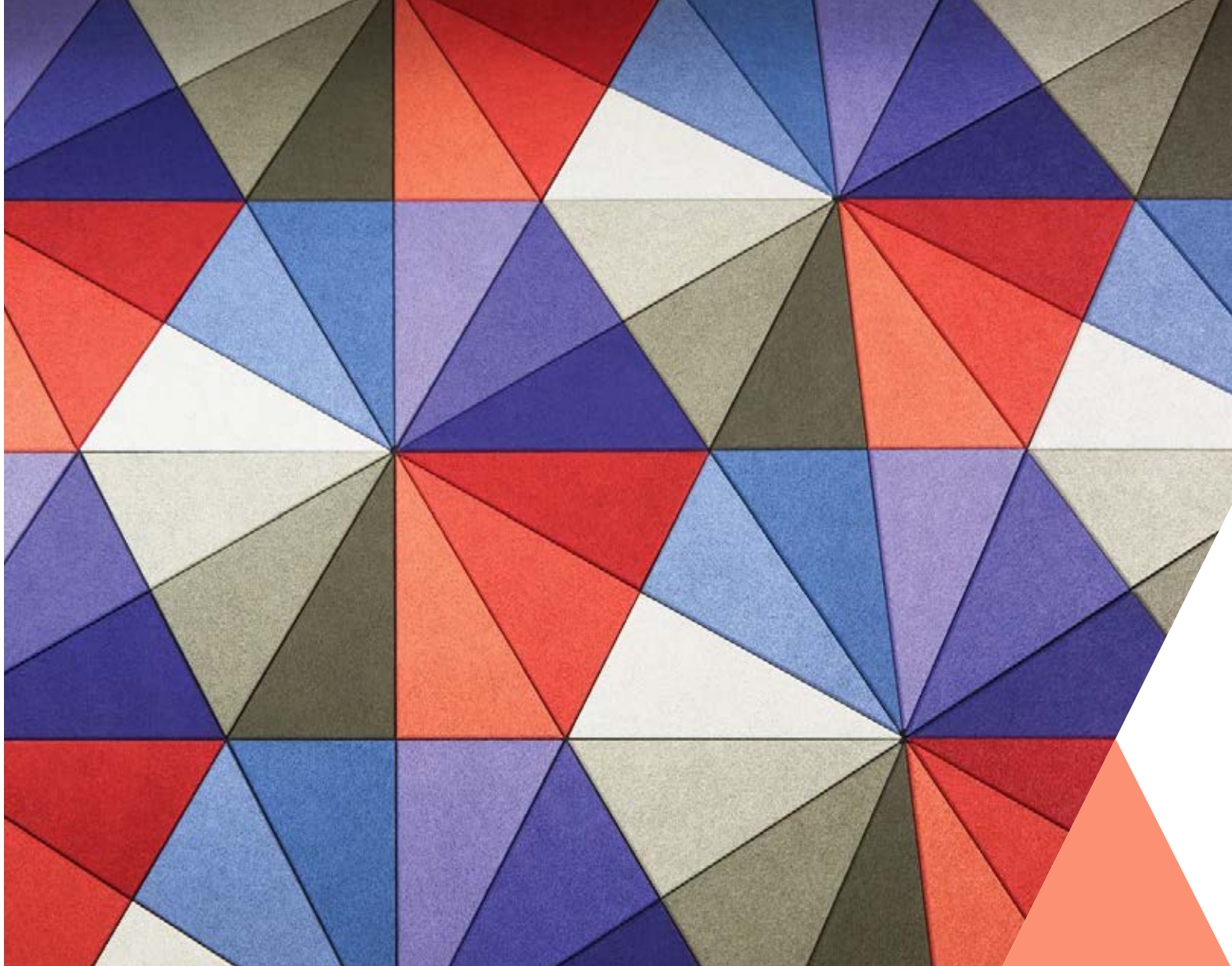

▲ Tectum® Panel Art ceiling and wall panels; Armstrong World Industries, Lancaster, PA

Panel Art FIT TO A "T"

Create your own custom shapes or use one of eight prefabricated geometrics to help your ceiling and wall designs take shape.

- Available in eight shapes or create custom shapes from panels up to 48" x 48"
- Excellent sound absorption – NRC up to 1.0
- All panels have beveled edges on all four sides
- Can be mechanically fastened to a wide variety of surfaces
- White or Natural 1" thick panels are part of the Sustain® portfolio



7.5" Hexagon



8" x 16" Right Parallelogram



8" x 16" Left Parallelogram



8" x 16" Rectangle



8" Square



8" Circle



8" Triangle



16" Triangle



Tectum® Direct-Attach Wall Panels;
Chula Vista Elementary School, San Diego, CA;
◀ Ruhnau Ruhnau Clarke, Riverside, CA



TECTUM® MADE TO FIT

Tectum® ceiling and wall panels are available in a variety of sizes, shapes, forms, and colors. Select from a natural factory finish, white, or made-to-order colors. Panels can be field-painted up to six times without impacting acoustic or fire performance. Tectum panels are made to fit your design needs.

SIZES COLORS ACOUSTICS

TECTUM® PANELS

	Width	Length	Thickness
Blades™ & Baffles	23-3/4" – 47-3/4"	11-3/4" – 23-3/4"*	1", 1-1/2", 2"
Shapes & Clouds	23-3/4" – 47-3/4"	Up to 96"	1-1/2", 2"
Direct-Attach	23-3/4" – 47-3/4"	48" – 144"	1", 1-1/2", 2"
Finale™ High NRC	23-3/4" – 47-3/4"	48" – 144"	1", 1-1/2", 2"
Panel Art	47-3/4"	48" **	1", 1-1/2", 2"
Lay-in & Tegular	23-3/4" – 47-3/4"	23-3/4" – 47-3/4"	1", 1-1/2", 2"
Fabric Walls	23-3/4" – 47-3/4"	48" – 120"	1", 1-1/2", 2"

* Available height for Blades™ & Baffles

** Larger custom sizes available upon request.

MADE-TO-ORDER COLORS

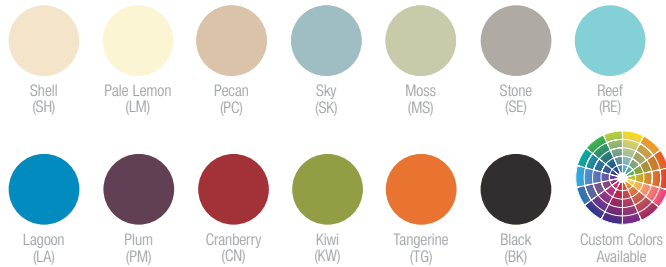

STANDARD COLORS

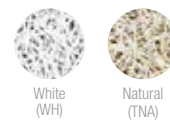

Made-to-order colors are available across the Armstrong Ceiling and Wall Systems portfolio including SoundScapes®, Infusions®, and Serpentina® product families, as well as Axiom® trim and suspension systems.

NOTE: Please order a color sample to ensure proper color reference on Tectum products.

Product	Panel Thickness	Weight (Sq.Ft)	Mounting				
			Suspended NRC	A Mounting NRC	D-20 Mounting NRC	C-40 Mounting NRC	C-20 Mounting NRC
Blades™ & Baffles	1"	1.63 lbs/SF	0.40 (Sabins/Sq. Ft.)	–	–	–	–
	1-1/2"	2.53 lbs/SF	0.50 (Sabins/Sq. Ft.)	–	–	–	–
Shapes & Clouds	1-1/2"	2.53 lbs/SF	0.50 (Sabins/Sq. Ft.)	–	–	–	–
Lay-in & Tegular Ceiling Panels	1"	1.63 lbs/SF	0.40	–	–	–	–
	1" w/ 1713 Infill	–	0.90/CAC 33	–	–	–	–
	1-1/2"	2.53 lbs/SF	0.50	–	–	–	–
Fabric Walls	1"	1.63 lbs/SF	–	0.50	0.60	0.90	–
Direct-Attach Ceiling & Wall Panels	1"	1.63 lbs/SF	–	0.40	0.45	0.85	0.80
Panel Art Ceiling & Wall Panels	1-1/2"	2.53 lbs/SF	–	0.55	0.60	0.95	0.90
	2"	3.30 lbs/SF	–	0.60	0.70	1.00	0.95
Finale™ Ceiling & Wall Panels	1" Panel with Integral Minwool Insert & 1" Furring	3.00 lbs/SF		0.75			
	1-1/2" Panel with Integral Minwool Insert & 1" Furring	3.50 lbs/SF		0.80			

ACOUSTICAL MOUNTING METHODS

Mounting A

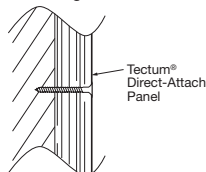

Mounting D-20

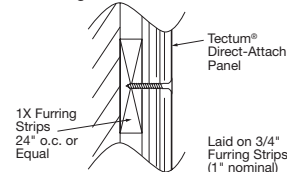

Mounting C-20

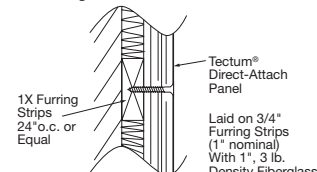

Mounting C-40

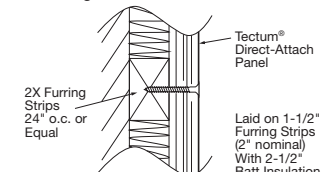



SUSTAIN®

High Performance
Sustainable
Ceiling Systems

The SUSTAIN portfolio contributes to better spaces. Here's how:

- Contribute to LEED® v4 (including new Materials and Resources credits)
- Have Health Product Declarations (HPDs) which tell you what's in the products
- Are free of Red List chemicals per Living Building Challenge 3.0 (including no added formaldehyde)
- Have Declare labels – easy reference “nutrition labels”
- Meet California Department of Public Health (CDPH) low emissions standards
- Have Environmental Product Declarations (EPDs) which tell you the impact of the products
- Contribute to Living Building Challenge
- Contribute to WELL Building Standard

SUSTAIN: [ABLE] TO CREATE BETTER SPACES.

1" Thick Tectum Panels in White and Natural are part of the Armstrong Sustain Portfolio.

Tectum® Direct-Attach Ceiling Panels;
Temple School of Architecture, Philadelphia, PA;
NELSON, Philadelphia, PA ►



TAKE THE NEXT STEP

1 877 276 7876

Customer Service Representatives
7:45 a.m. to 5:00 p.m. EST
Monday through Friday

TechLine – Technical information, detail drawings,
CAD design assistance, installation information,
other technical services – 8:00 a.m. to 5:30 p.m. EST,
Monday through Friday. FAX 1 800 572 8324
or email: techline@armstrongceilings.com

armstrongceilings.com/tectum

Latest product news
Standard and custom product information
Online catalog
CAD, Revit®, SketchUp® files
A Ceiling for Every Space® Visual Selection Tool
Product literature and samples – express service
or regular delivery
Contacts – reps, where to buy, who will install

YOU INSPIRE™ SOLUTIONS CENTER

1 800 988 2585
email: solutionscenter@armstrongceilings.com
armstrongceilings.com/youinspire

Design Assistance

Collaborative design
Detail drawings
Specifications
Planning and budgeting

Pre-construction Assistance

Layout drawings for standard
and premium products
Project installation recommendations
Contractor installation assistance

you inspire™
solutions center

helping to bring your one-of-a-kind ideas to life

FSC® is a registered trademark of FSC Forest Stewardship Council®, A.C., license code FSC-C007626
Inspiring Great Spaces® is a registered trademark of AFI Licensing LLC
LEED® is a registered trademark of the U.S. Green Building Council
Revit® is a trademark of Autodesk, Inc.
SketchUp® is a registered trademark of Trimble, Inc.
All other trademarks used herein are the property of AWI Licensing LLC and/or its affiliates
© 2018 AWI Licensing LLC • Printed in the United States of America

armstrongceilings.com/tectum

Inspiring Great Spaces®

Armstrong®
CEILING & WALL SOLUTIONS