

Ecophon® Focus™ Dg 4x4 Installation Instructions

(Suited for seismic categories A, B, C, D, E, F)

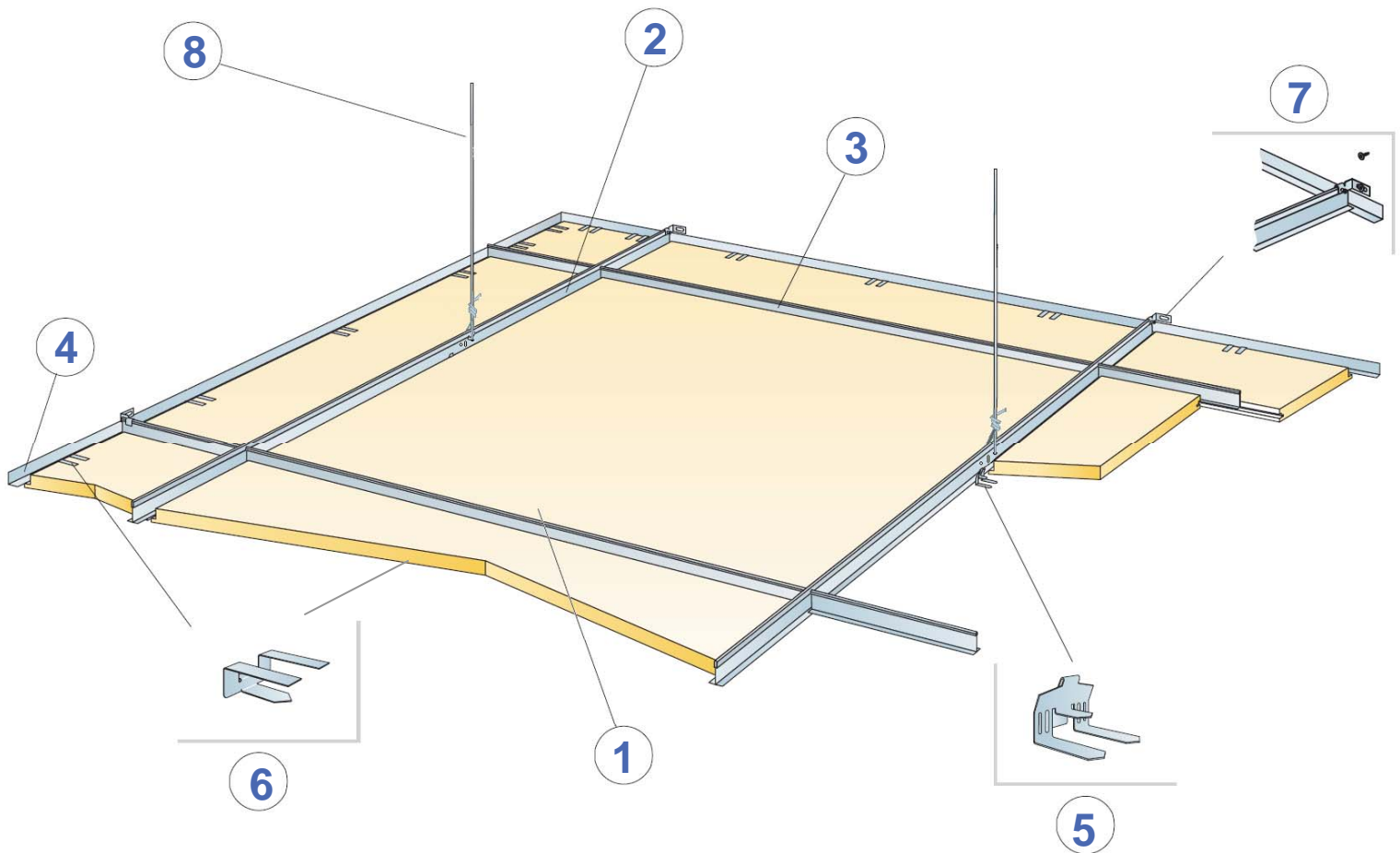

Components:

1. Ecophon Focus Dg Panel (4'x4')
2. CertainTeed 15/16" Classic Main Runners
3. CertainTeed 15/16" Classic Cross Tees

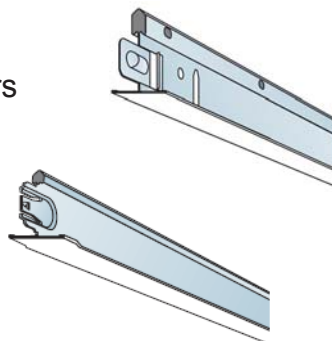

4. CertainTeed Ceilings 15/16" Wall Angle

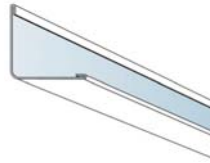

5. Connect Edge Clip Dg 0546
(2 per panel / REQUIRED)

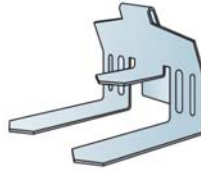

6. Connect DG25 Support Clip 0548

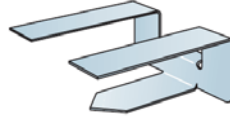

7. ****Optional**** Connect Wall Bracket T-profile 0524
(All required screws by others)

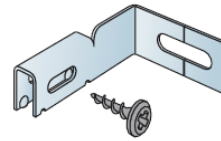

8. 12 Gauge Hanger Wire

Additional Components:

9. Connect DG Cutting Tool 0991

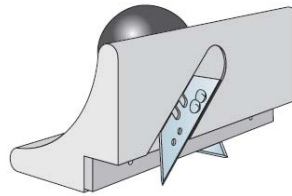

10. Connect Edge Sealant 0691

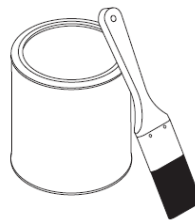

It is important to note that grid installation methodology may require alteration dictated by the project's declared seismic category

Refer to ICC ESR 3336 for additional accessories and installation methods that may be required per the project's seismic category

Wear clean white cotton gloves when handling Focus Dg panels.

Pre-Installation: Please read CertainTeed Ceiling's Pre-Installation Instructions before you begin these installation instructions. Note that the finished surface of Focus Dg Panels is 1/2" below the grid. **Focus Dg is an extremely precise system and the tolerance is low. The grid system must be square and level.**

1. Installing Wall Angle

- To install Wall Angle choose a height at least 3" below joists, existing ceilings, ducts, pipes, or wiring, to ensure clearance and maneuverability required to install the panels (integration with diffusers and light fixtures may dictate a greater depth of system).
- Mark the desired height for the finished surface of the ceiling on all four walls (see Steps 2-3).
- Attach Wall Angle using appropriate fasteners.

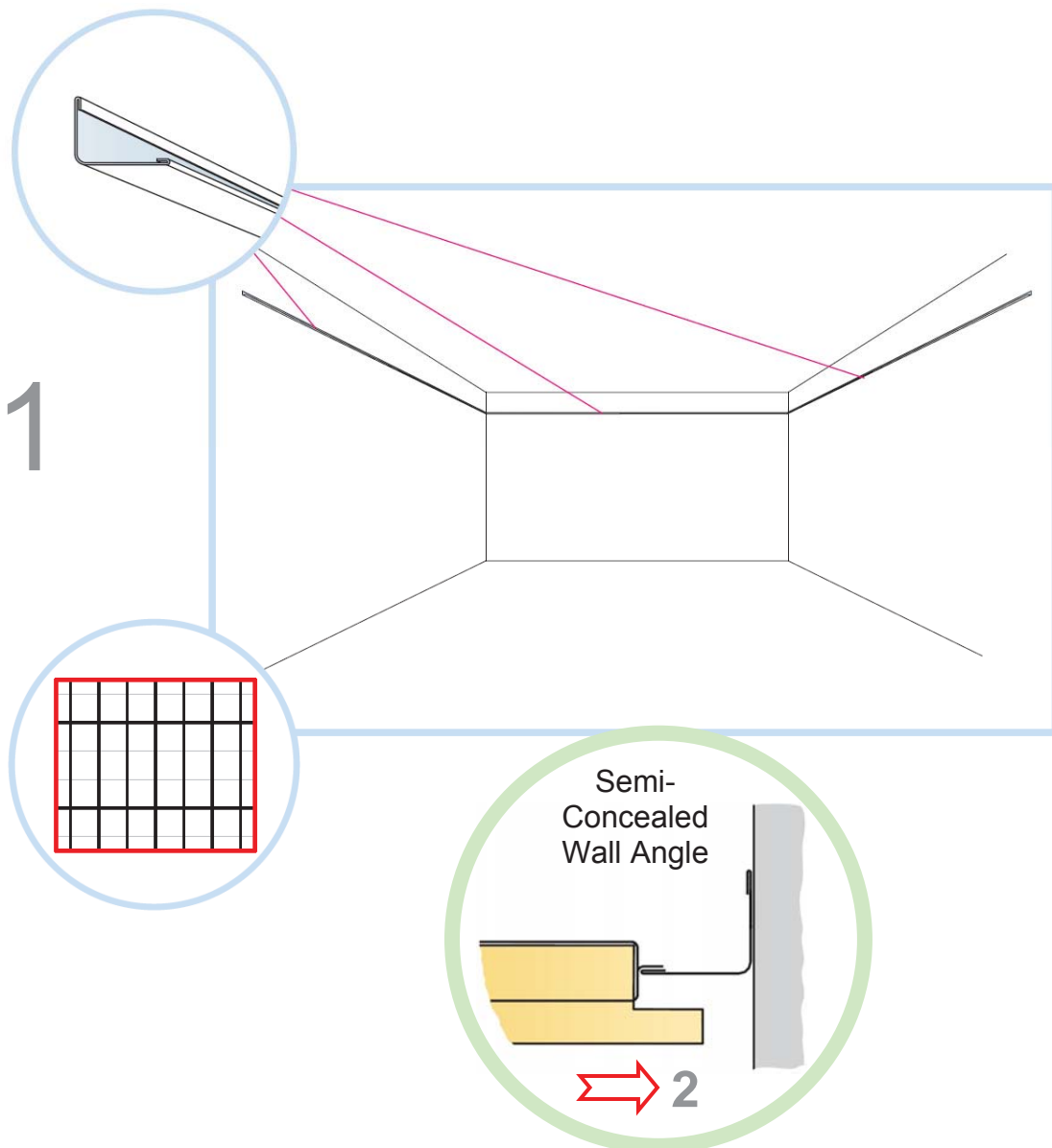

Perimeter Detail

2

Semi-Concealed Wall Angle

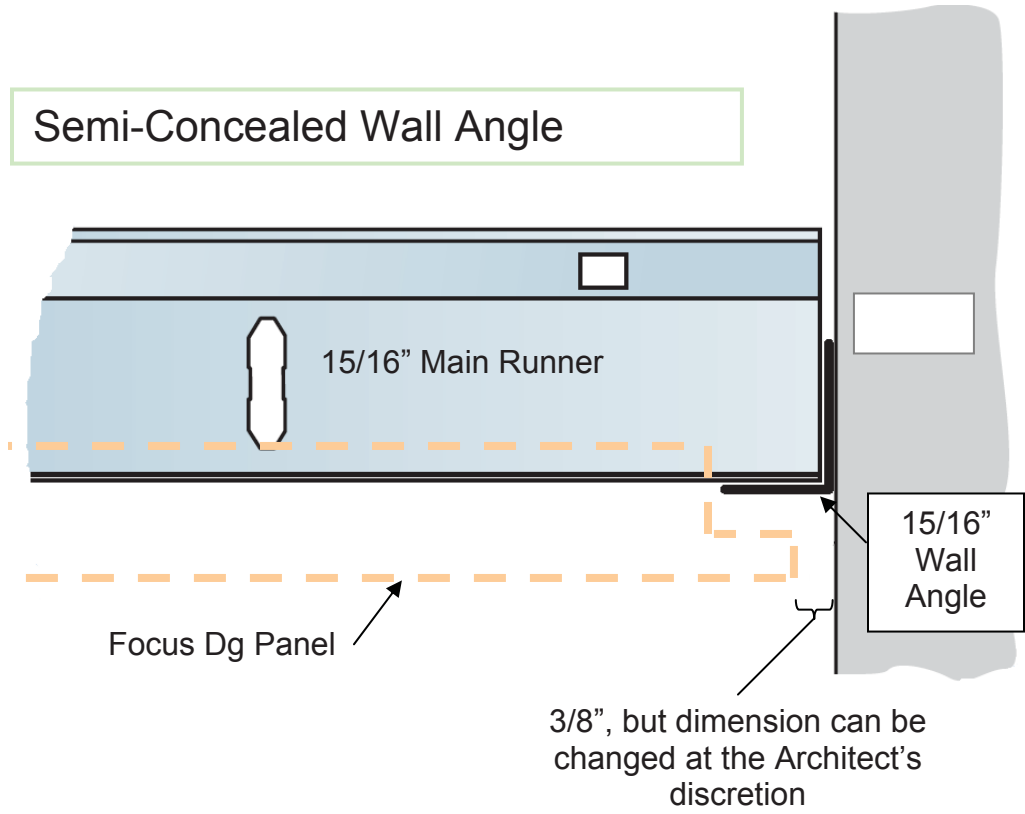

3. Install Hangers

- Mark lines for each of the main runners (4' on center for 2x2' & 2'x4' panels, 2' on center for 2x5", 2'x6', & 2'x8').
- Pull a string line along the path that the first main runner will take. Attach the line directly below the wall molding.
- Hangers are placed every 48" along the main runners, at a max of 24" from the walls.

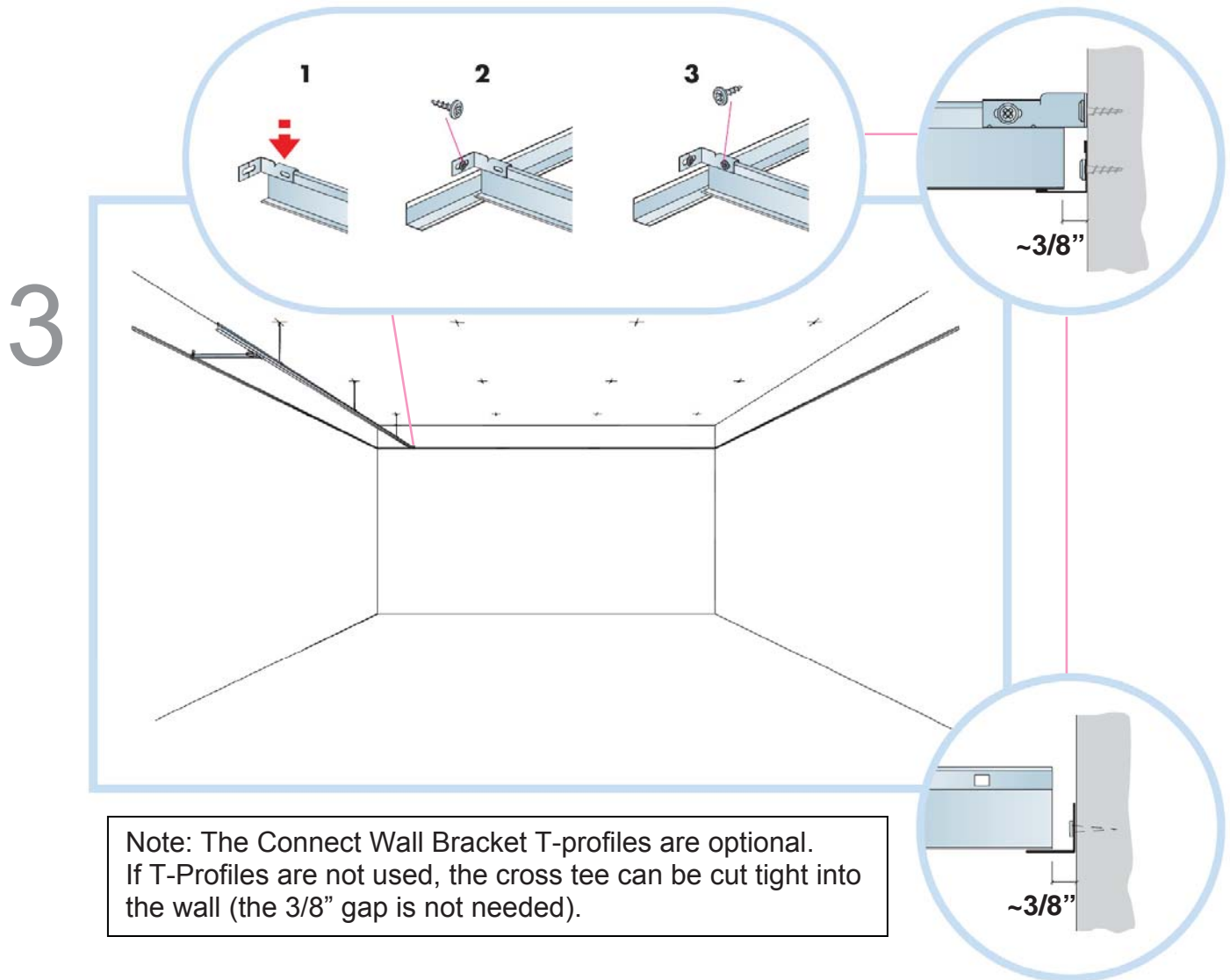

4. Install the main runners

- a. Install the first section of main runner, with cut edge sitting on the wall molding.
- b. Attach the main runner to wire.
- c. Repeat for the next sections of main runner.
- d. Make sure that all of the main runners are hanging at the same level

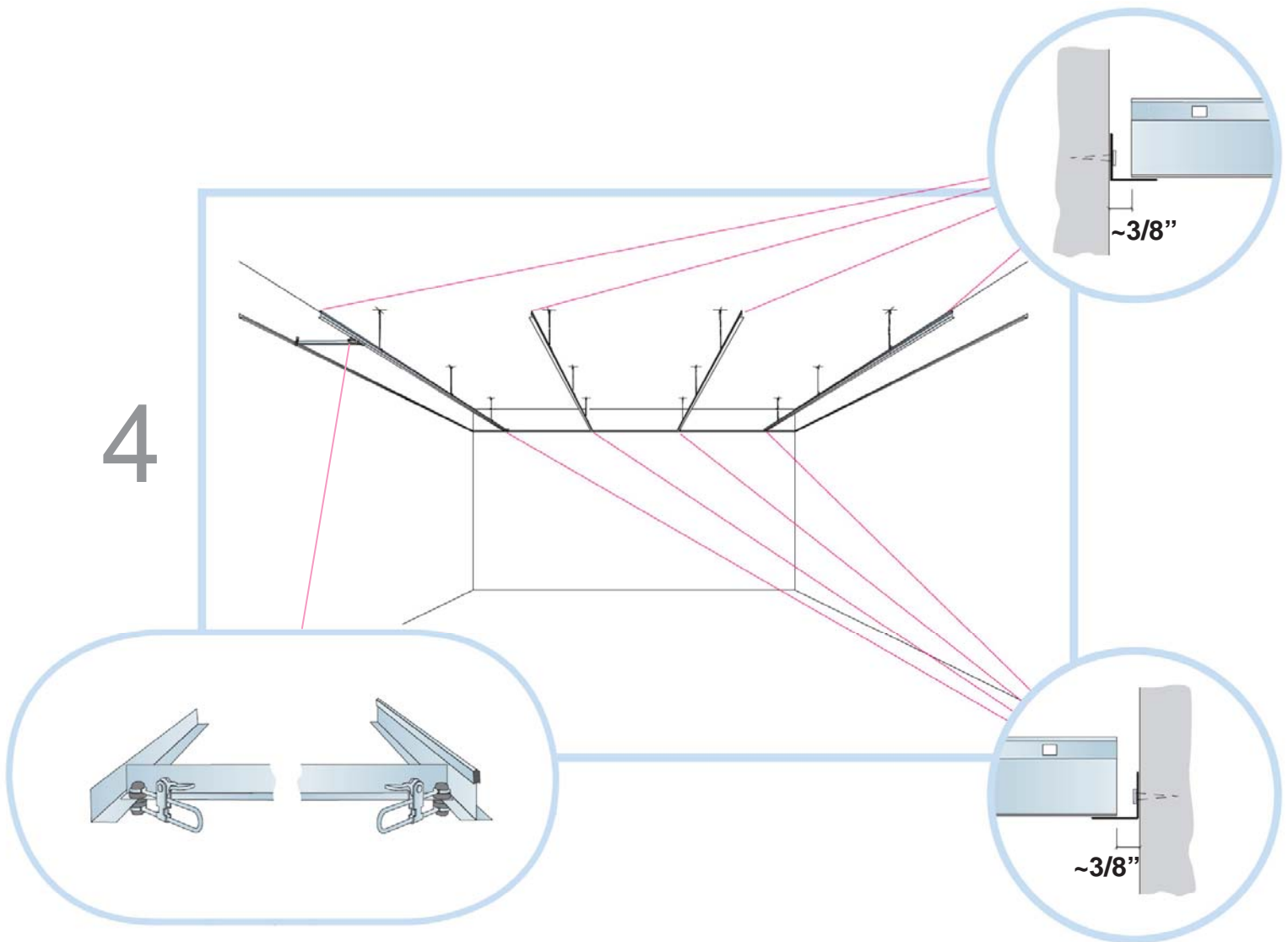

5. Install Cross Tees and Border Tees

- a. Cut in border cross tees. Use a string line to make sure the main runners are straight.
- b. Install cross tees as needed.
- c. **Check to see if the suspension system is square. Make adjustments as needed.**

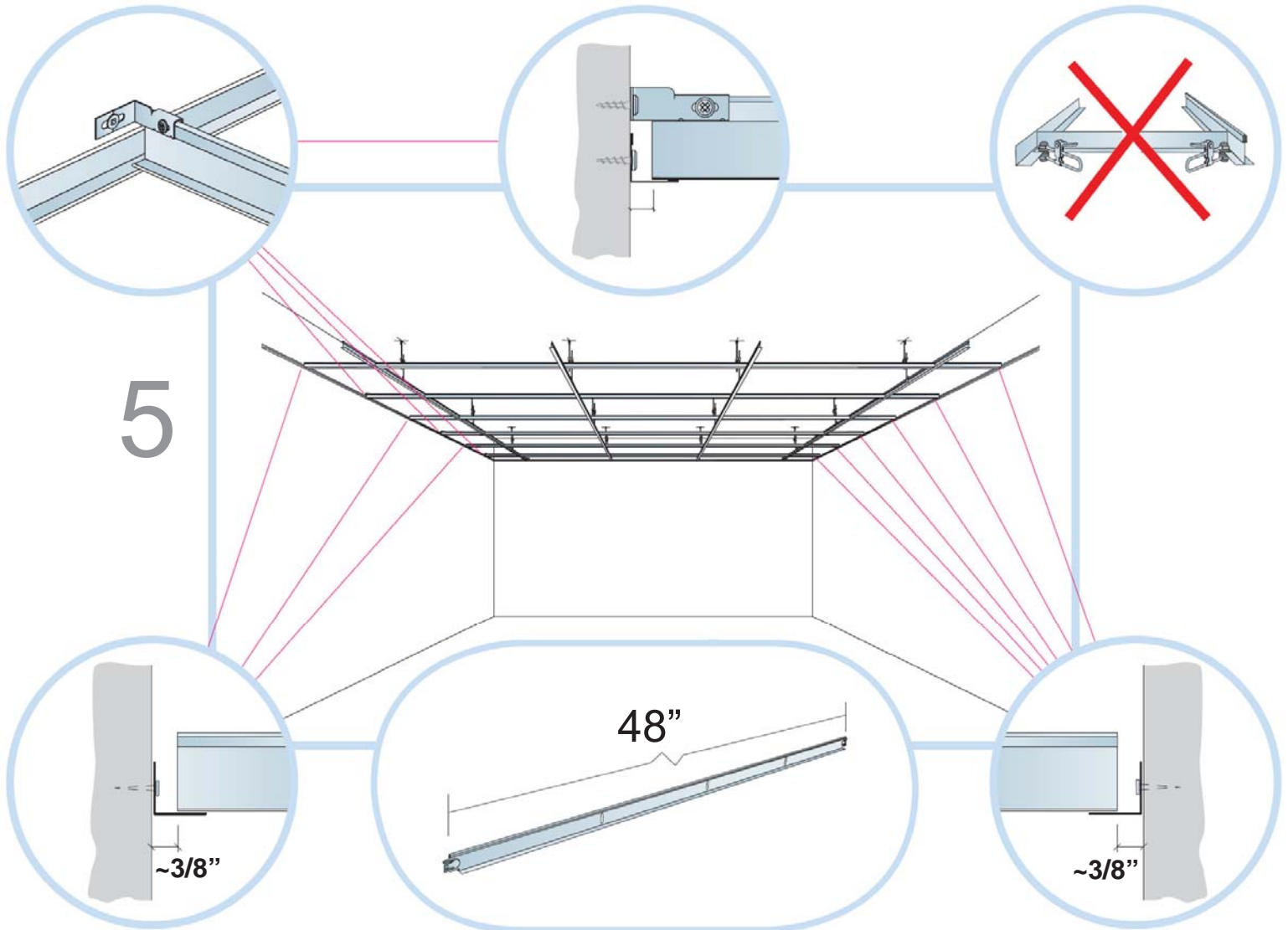

6. Install Field Panels

(Note: 4'x 4' panels require two people to install each panel).

Before you begin installing the panels, you must understand that Focus Dg panels have 2 supporting edges and 2 non-supporting edges. As illustrated below:

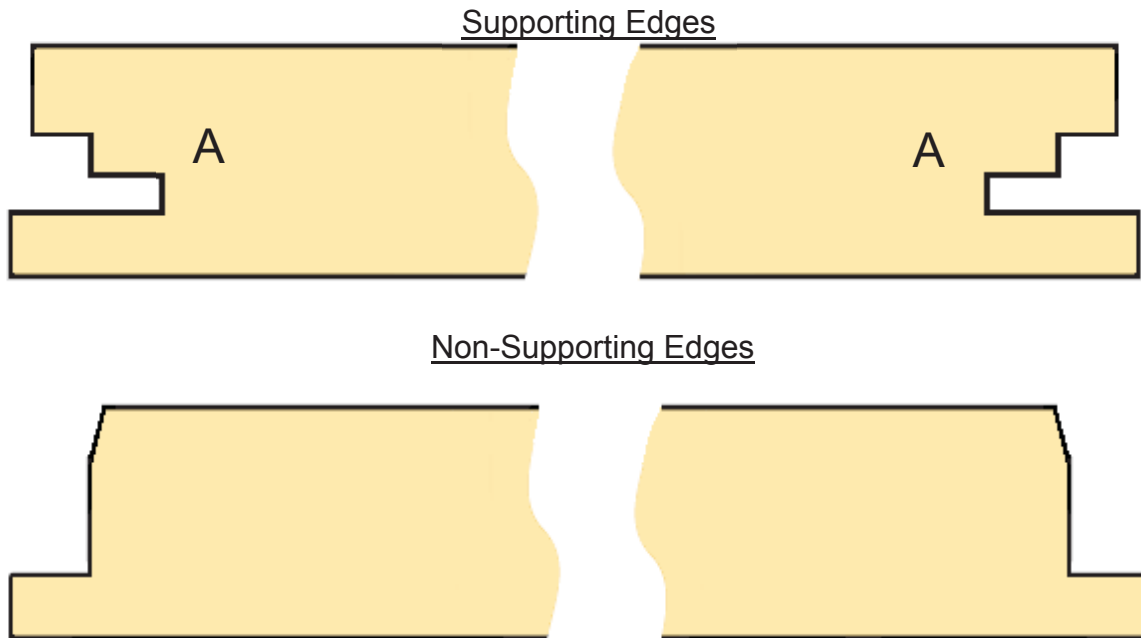

- a. **Wear white cotton gloves, so that the dirt and oil from your hands, does not get on the panels. (If gloves become soiled, replace them immediately).**
- b. Start installing panels in the middle of the field.
- c. To install Focus Dg Panels, Follow Step 7¹ - 7⁵.

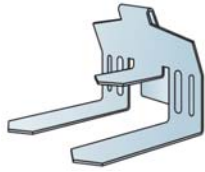

Mandatory: insert one Connect Edge Clip at or near the mid-point of each non-supporting edge.

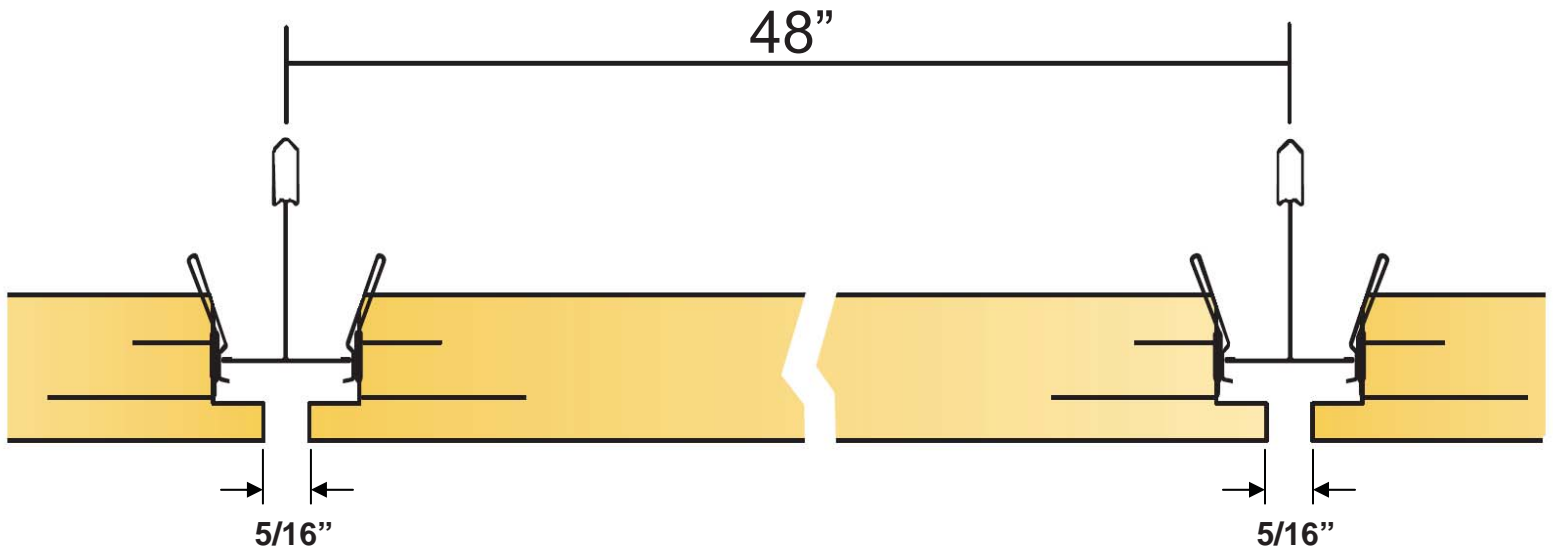

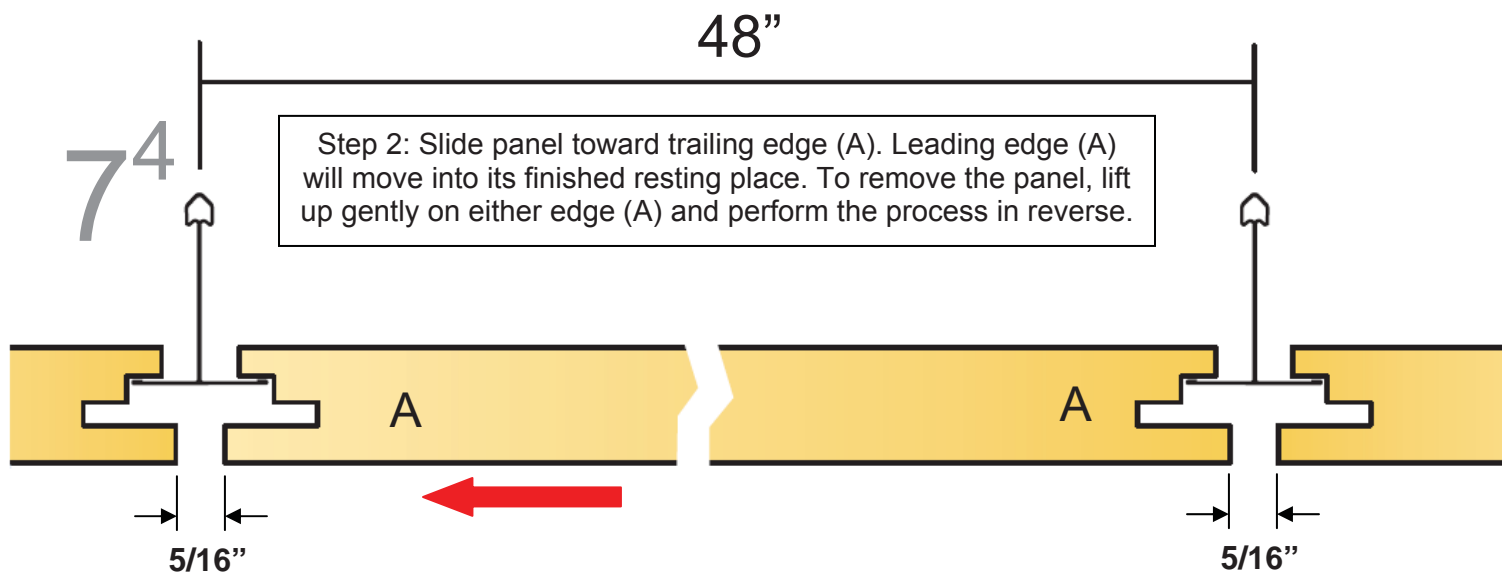
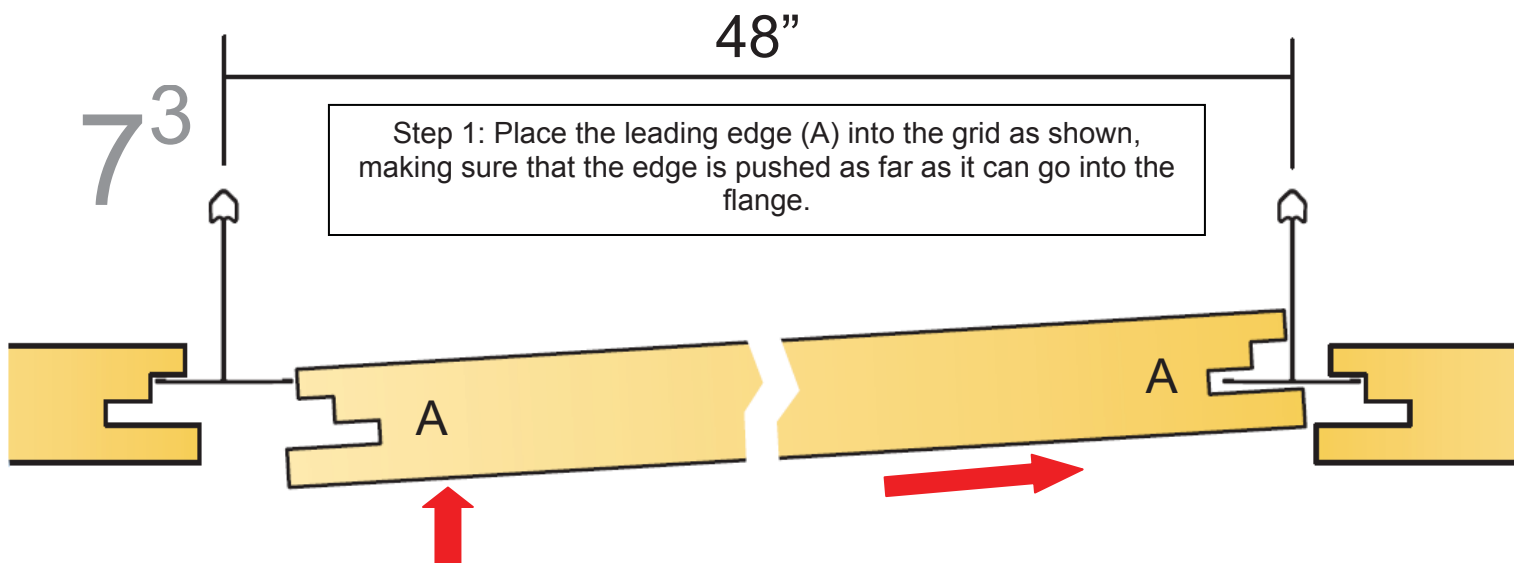

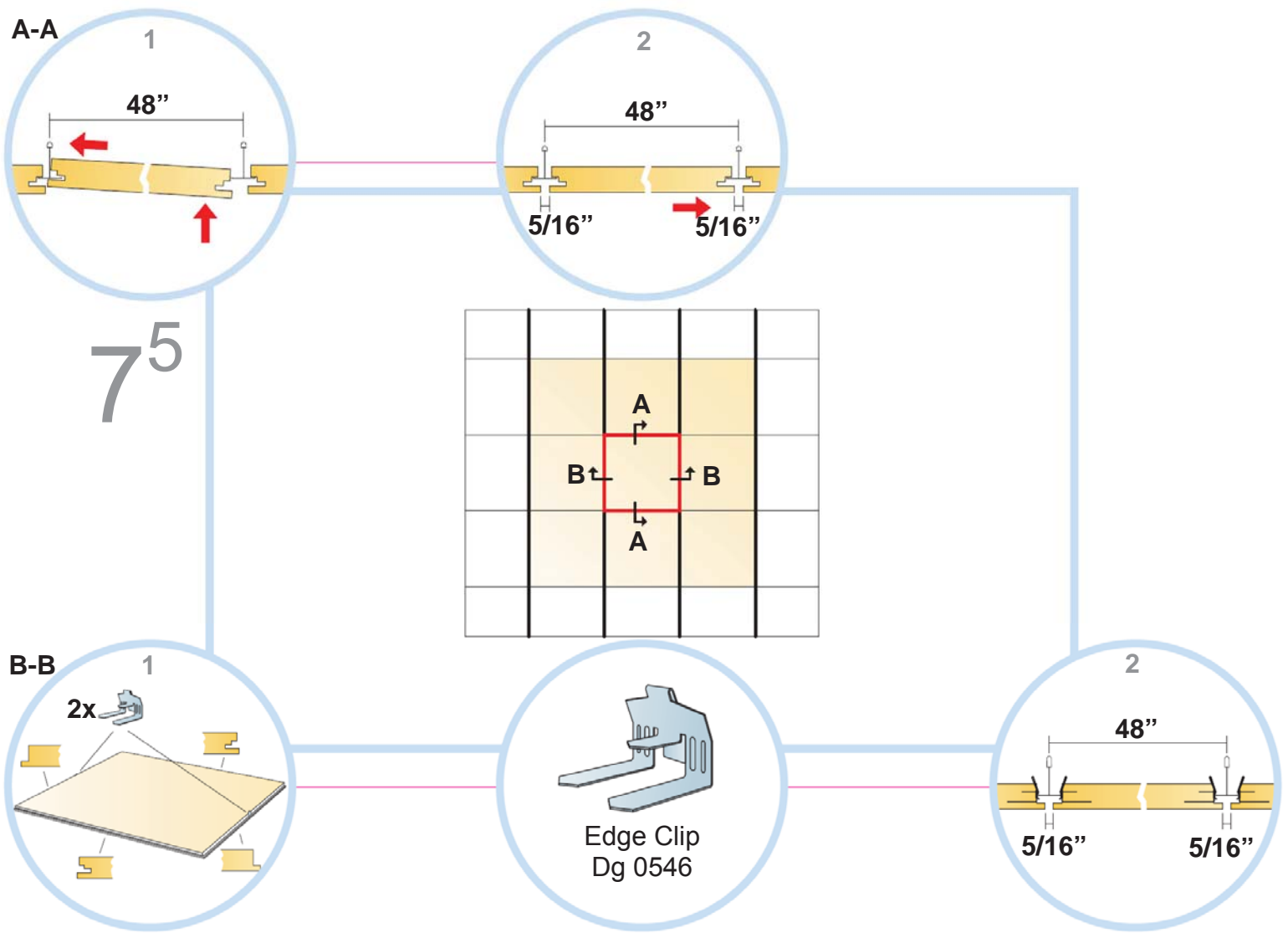

9. Install Border Panels

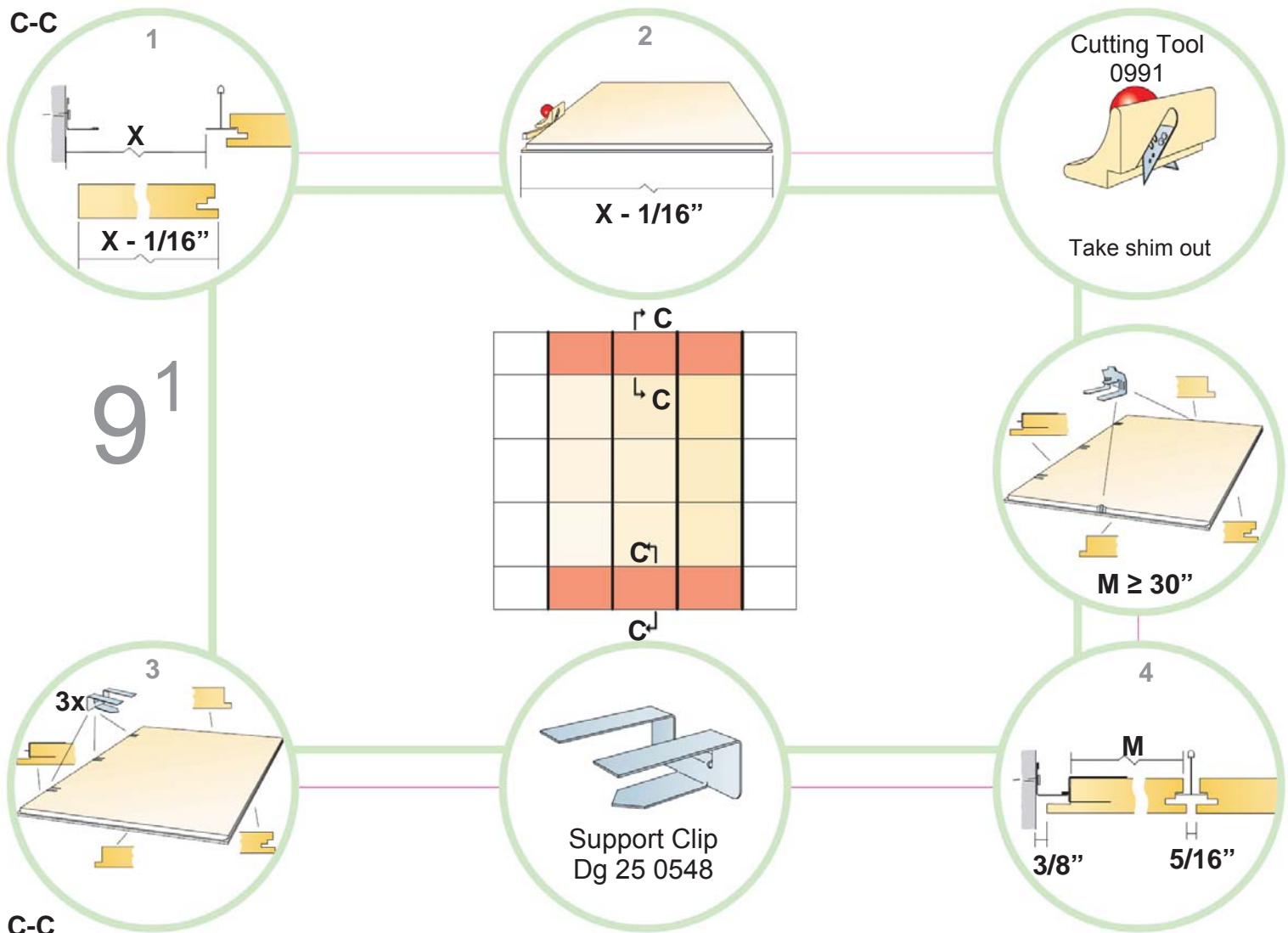

Notes:

- The Focus Dg System is designed so that $3/8''$ of the wall molding is visible from below. The dimension of molding exposed is at the Architect's discretion. If the Architect does not specify the distance, these directions will result in a $3/8''$ gap around the border.
- For more accurate cut edges, measure at least twice at each end of the panel, so the cut edge follows the contour of the wall.
- Straight cuts should be made using a razor knife and a straight edge.
- The Connect DG Cutting Tool 0991 cuts a $9/16''$ by $3/4''$ rabbet. The shim attached to the tool should be removed for cuts in 1" panels.
- Connect DG25 Support Clip 0548 should be spaced every 12"-18".
- Connect Edge Sealant 0691 is used as required. Avoid applying edge sealant to the surface of the panel.

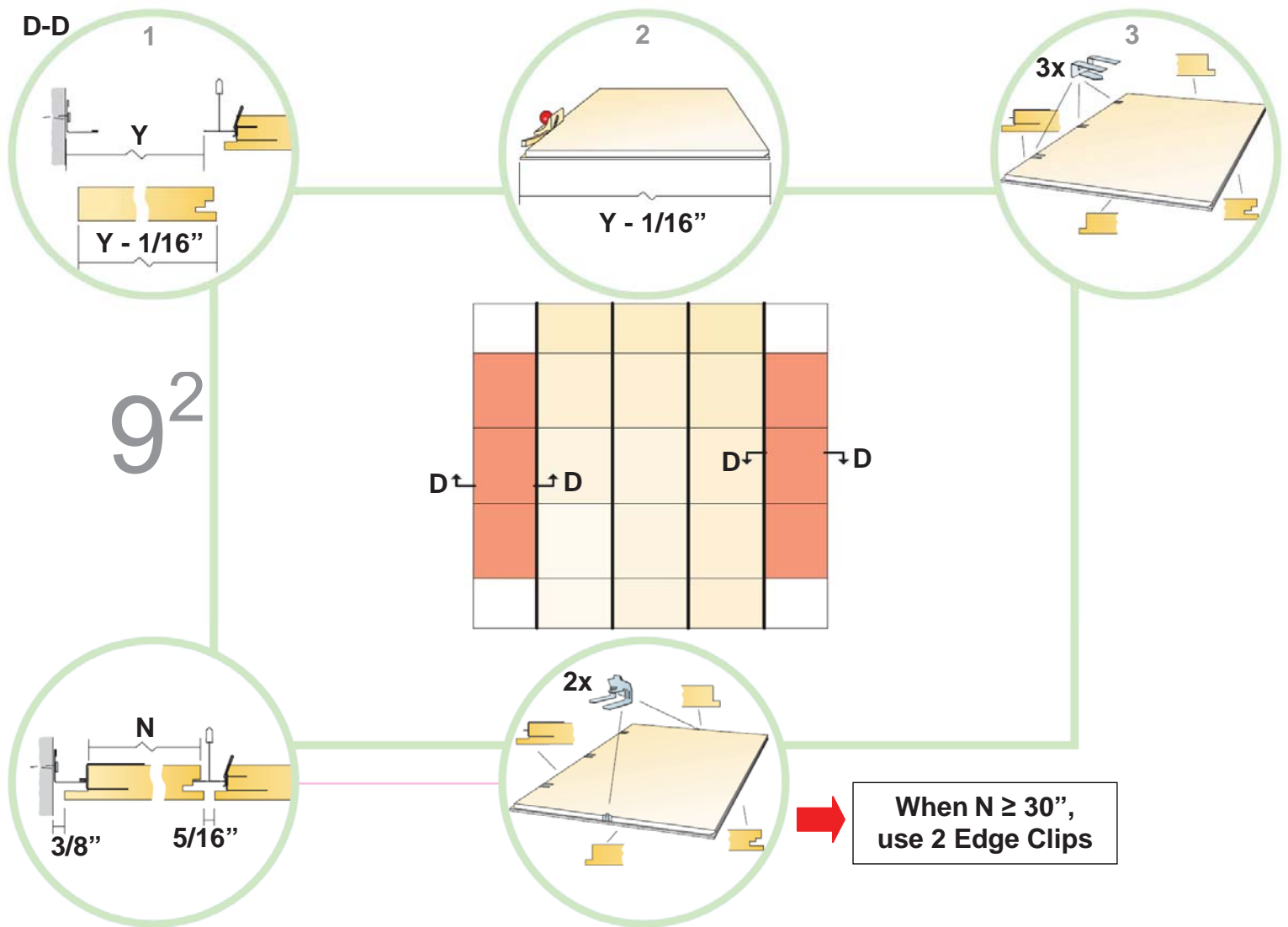

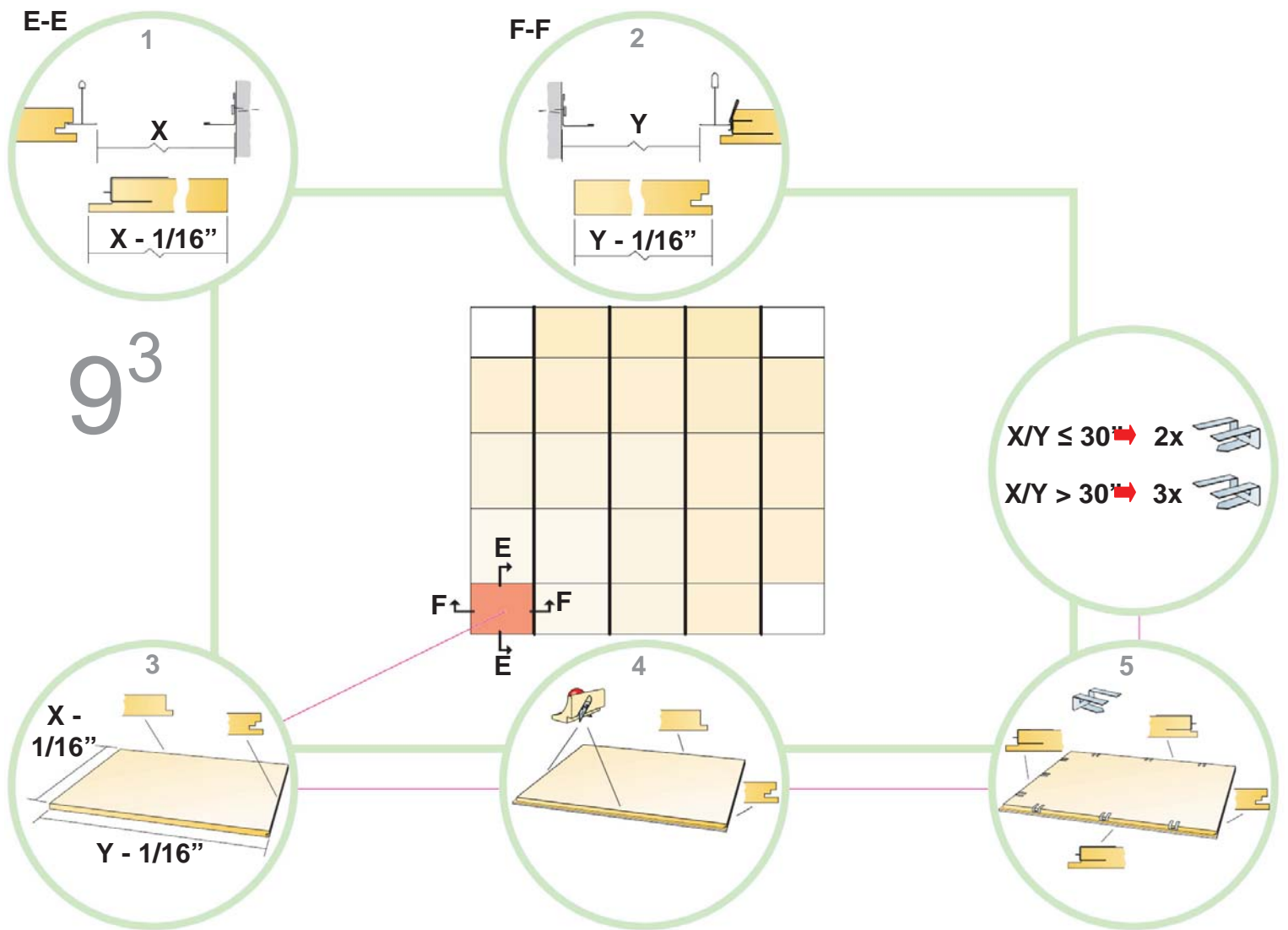

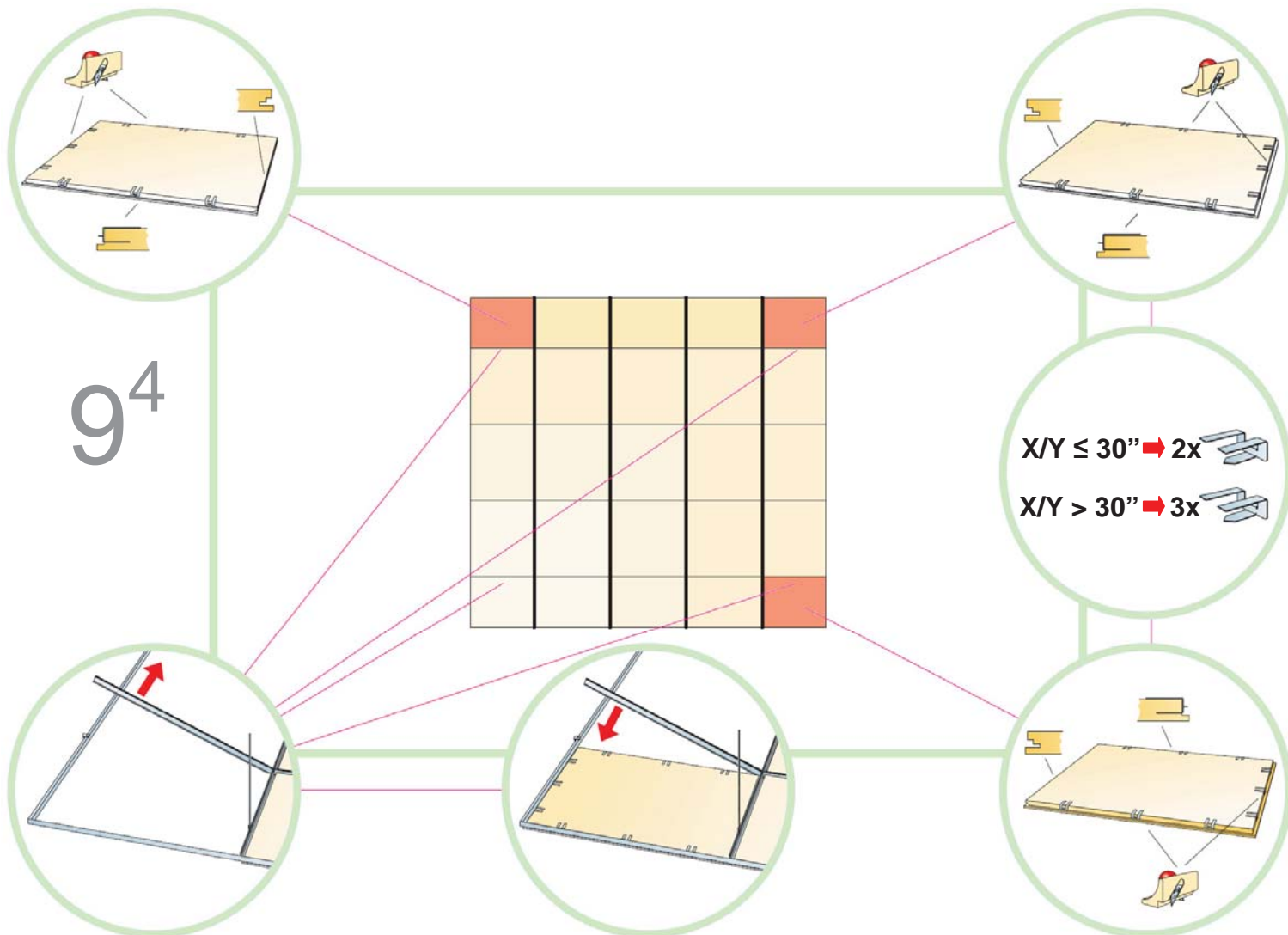

FOR PRODUCT AND INSTALLATION QUESTIONS:

- Call 1-800-233-8990 (Monday-Thursday: 7:30 am-6:30 pm; Friday: 7:30 am-6:00 pm EST); English, Spanish and French speakers available. Or email ceilingtechnicalservices@certainteed.com.

ASK ABOUT ALL OF OUR OTHER CERTAINTEED® PRODUCTS AND SYSTEMS:

ROOFING • SIDING • TRIM • DECKING • RAILING • FENCE
GYPSUM • CEILINGS • INSULATION

www.certainteed.com

CertainTeed Corporation
20 Moores Road
Malvern, PA 19355

Professional: 800-233-8990
Consumer: 800-782-8777

© 5/10 CertainTeed Corporation
Code No. CTC-4808