

FOCAL POINT

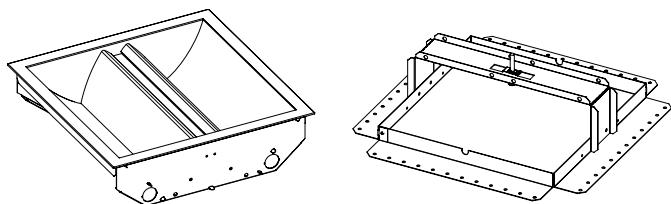

KEY

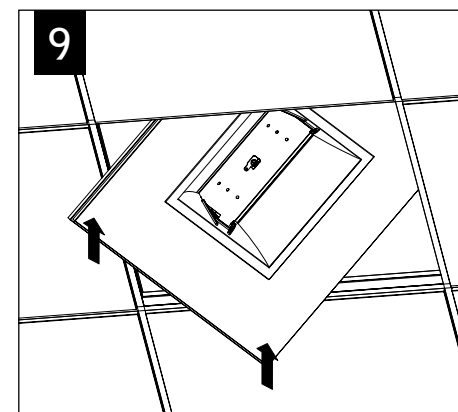
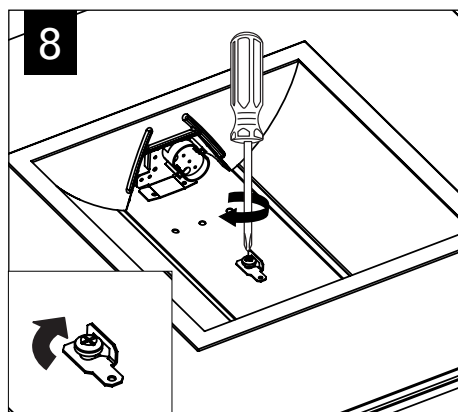
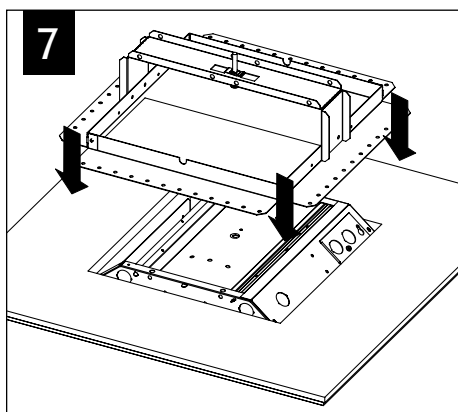
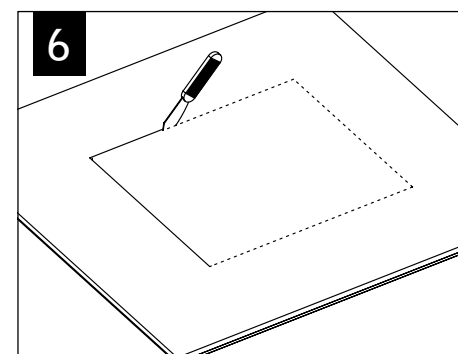
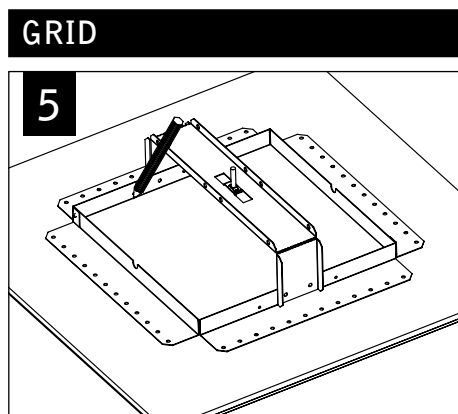
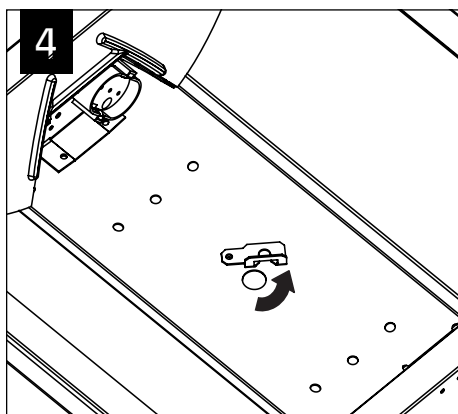
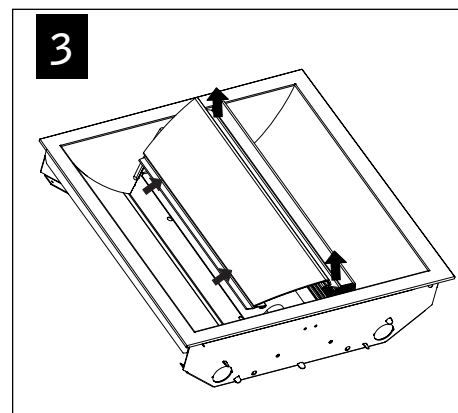
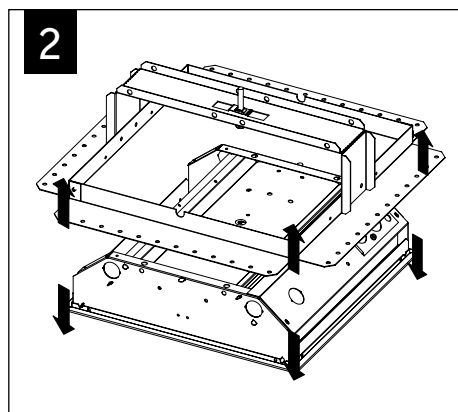
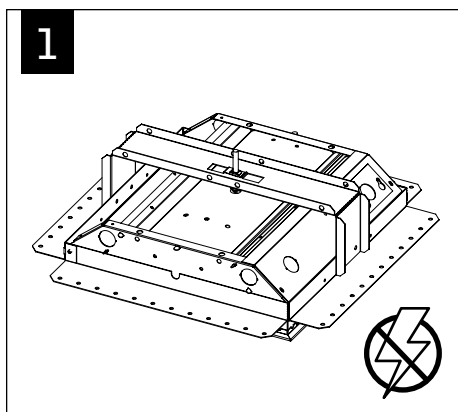
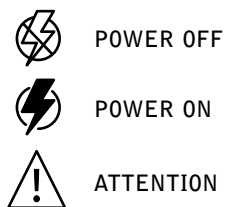

Luminaires must be installed by a qualified electrician (check with local and national codes for proper installation).
To prevent electrical shock, disconnect electrical supply before installation or servicing.

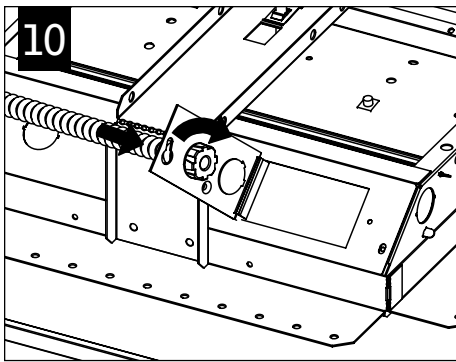

MAKE ELECTRICAL CONNECTIONS

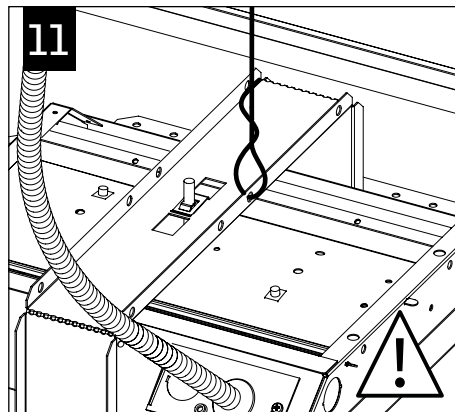

DRYWALL

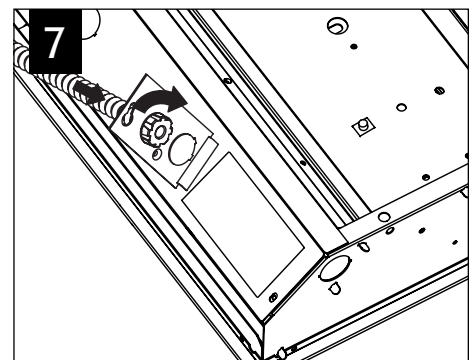
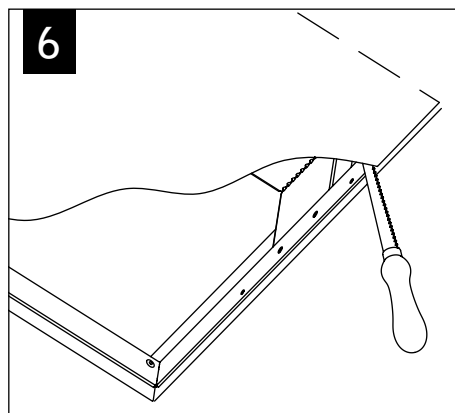
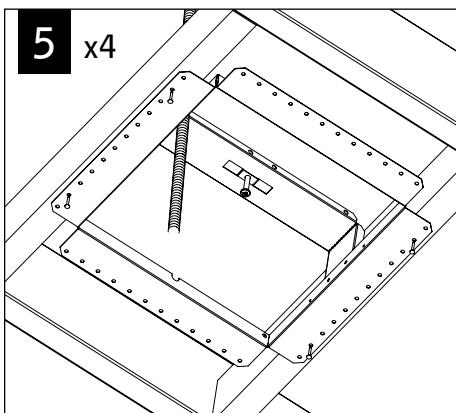

MAKE ELECTRICAL CONNECTIONS

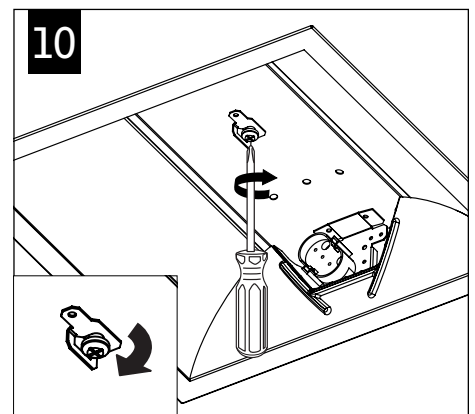
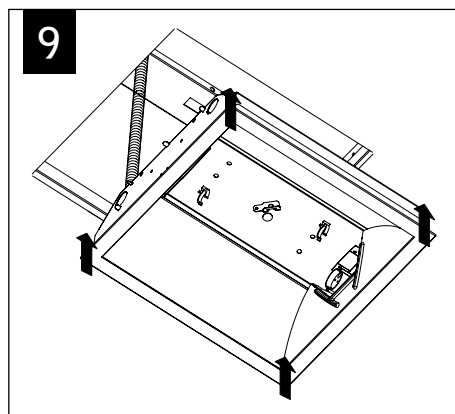
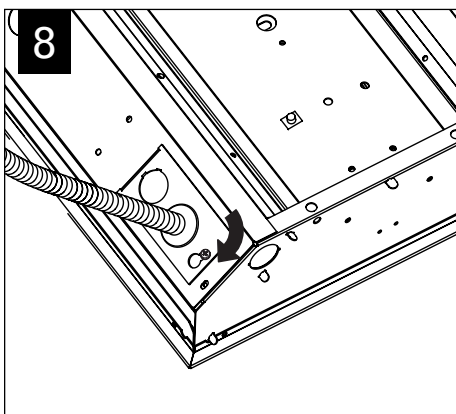

LAMPING

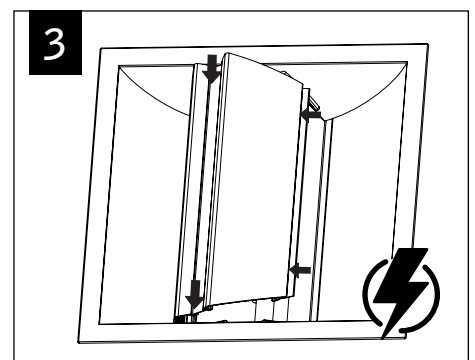
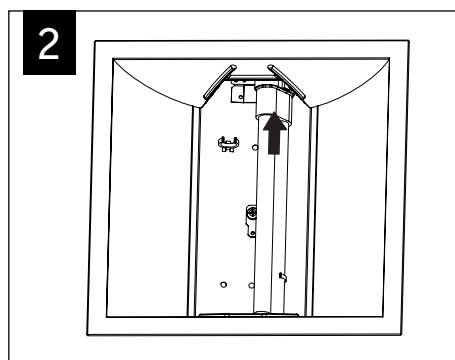
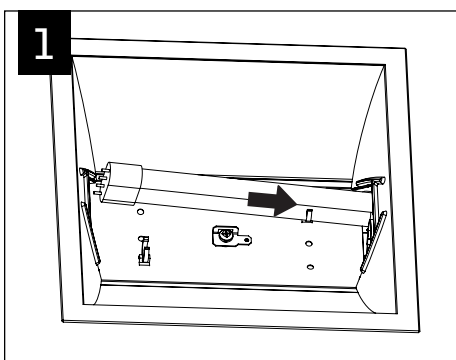

Contractor is responsible for adequately reinforcing walls and/or ceilings to support luminaire weight. Focal Point, LLC accepts no responsibility for inadequately reinforced walls and/or ceilings. The information contained in this drawing is the sole property of Focal Point, LLC. Any reproduction in part or whole without the written permission of Focal Point, LLC is prohibited. US Patents: D605,340; D605,341; D605,342; D608,490; D620,190S. European Patents: 001596313-0001, 001596313-0002, 001596313-0003, 001596313-0004, 001596313-0005, 001596313-0006, 001596313-0007, 001596313-0008, 001596313-0009. Canadian Patents: 130763, 130764, 130765, 130766.