

# PENDANT INSTALLATION INSTRUCTIONS WITH A DIE CAST HANGER

**NOTE:** THE JUNCTION BOXES MUST BE SOLIDLY FIXED TO THE CEILING AND ATTACHED TO THE STRUCTURE INSIDE THE CEILING BEFORE PROCEEDING TO THE INSTALLATION.

## ● PART LIST

A End cap retaining screw	J Aircraft cable
B End cap	K Cable grip
C Fixture 1	L Cable grip tab
D Die cast	M Fixture 2
E Power cord	N Aligner
F Ceiling power feed (by others)	O Electrical connectors
G Canopy	P Quick-wire connectors
H 1/4"- 20 threaded stud (by others)	Q Screws
I Cable mounting nut	R Wire nuts

## ● SIDE VIEW

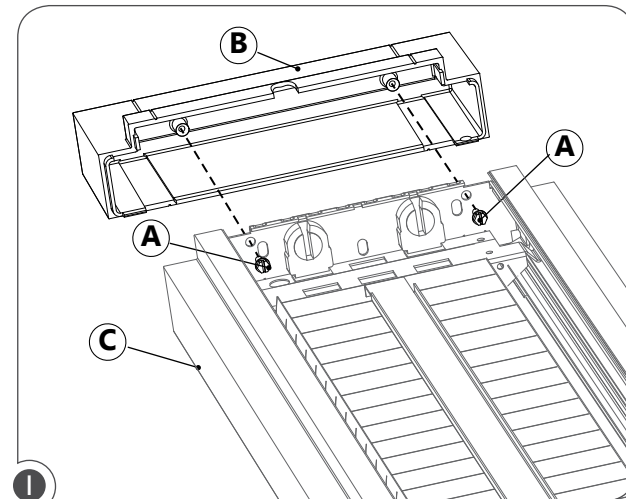
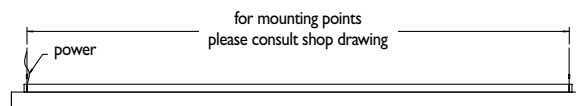

1 Unscrew retaining screws (A) to remove end cap (B) from fixture (C). Repeat on the both ends of fixture (C).

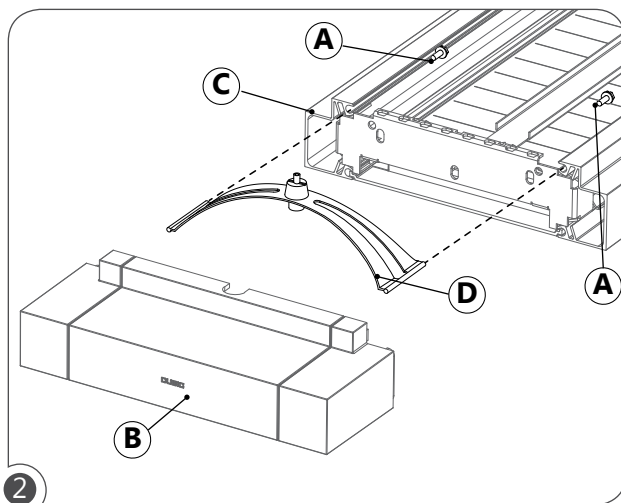

2 Slide die cast hangers (D) into fixture (C). Put end caps (B) back in place, secure with retaining screws (A). Repeat on the both ends of fixture (C).

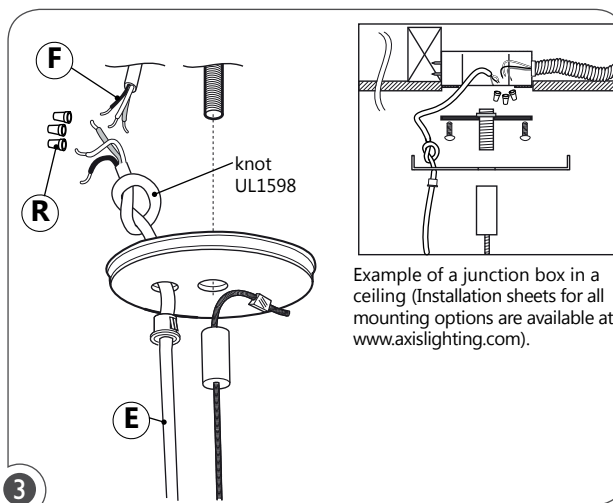

3 Ensure that the power to the fixture's circuit is turned off. Make a knot on the power cord inside the canopy. Connect the power cord (E) to the ceiling power feed (F).

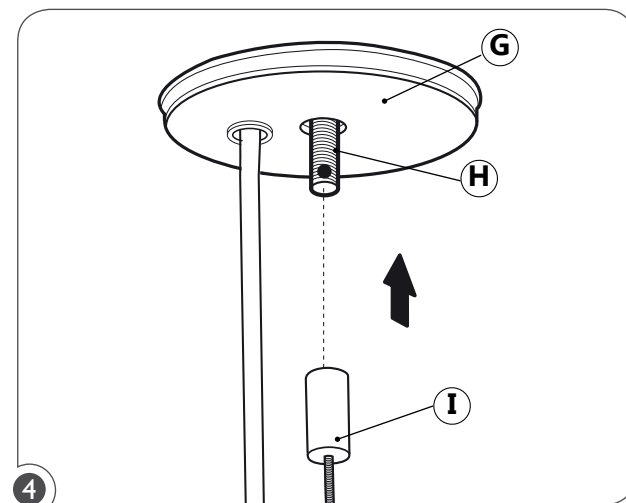

4 At all power feed suspension points, place canopy (G) in position on threaded stud (H) and secure with cable mounting nut (I).

## PENDANT INSTALLATION INSTRUCTIONS WITH A DIE CAST HANGER

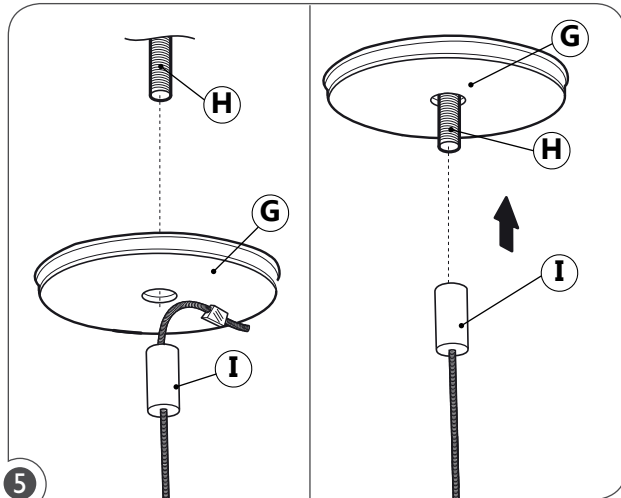

5 At all suspension points, place canopy (G) in position on threaded stud (H) and secure with cable mounting nut (I).

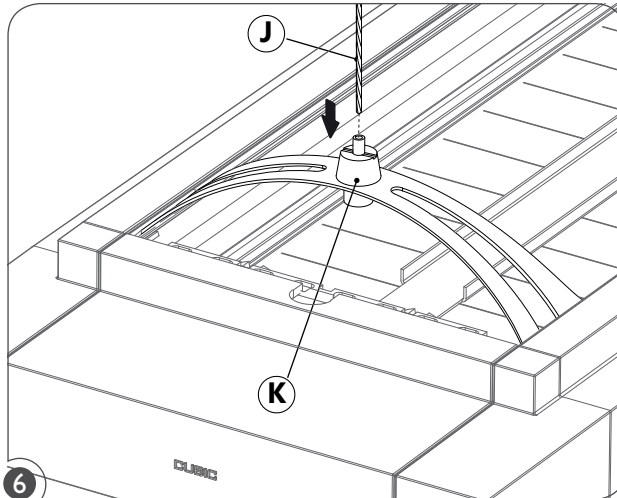

6 Push the aircraft cable (J) through the cable grip (K).

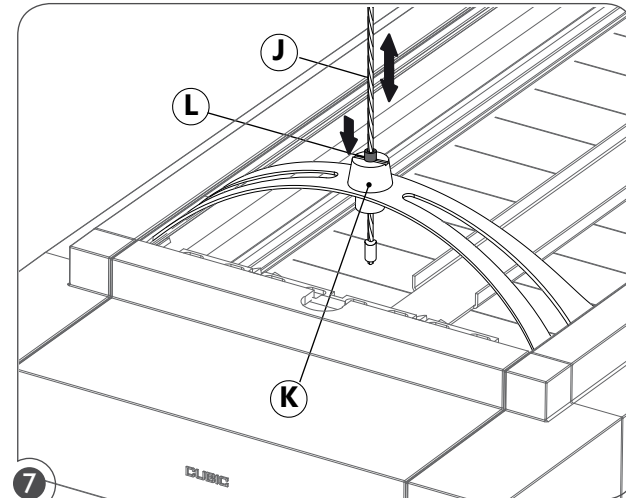

7 For adjustment press tab (L) on grip lock (K) to release or slide cable grip (J).

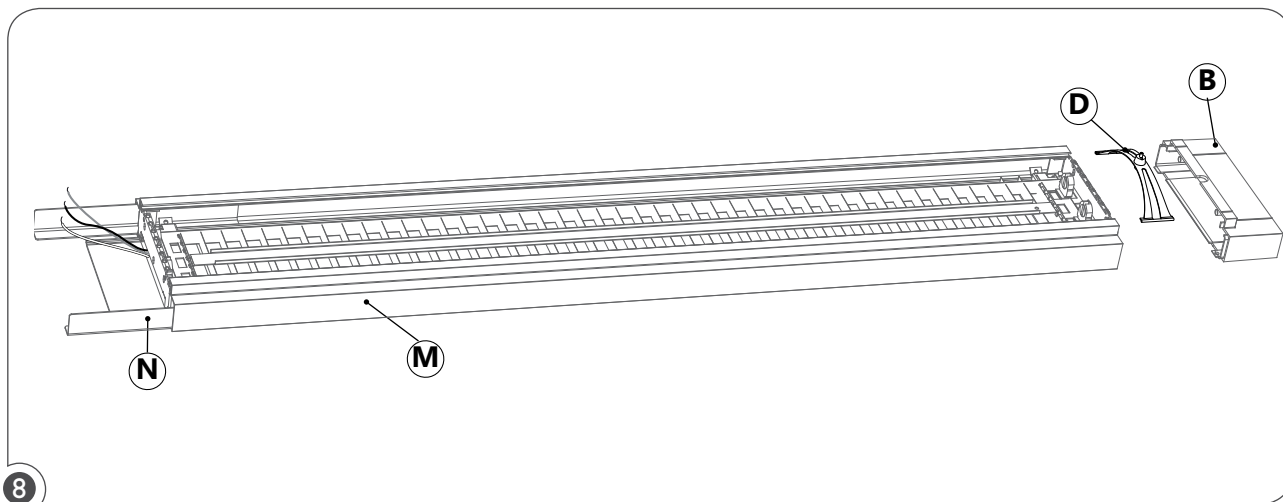

8 **For a continuous row system - last fixture:** With first fixture in place, remove end cap (B) from next fixture (M). Slide die cast hangers (D) on to fixture (M). Put end caps (B) back in place, secure with retaining screws.

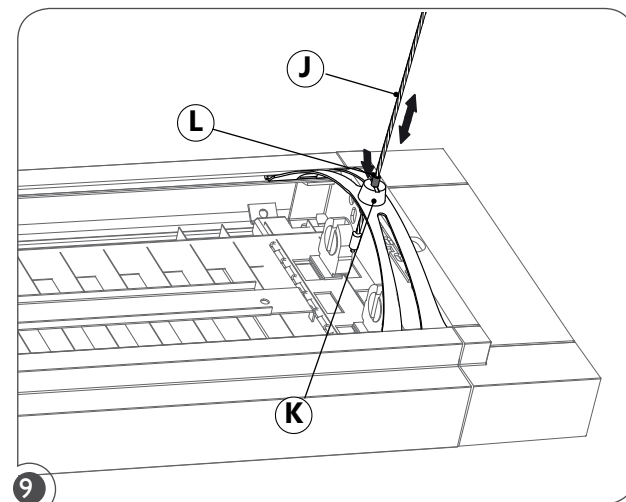

9 Push the aircraft cable (J) through the cable grip (K). For adjustment press tab (L) on grip lock (K) to release or slide cable grip (J). Continue to step 12.

## PENDANT INSTALLATION INSTRUCTIONS WITH A DIE CAST HANGER

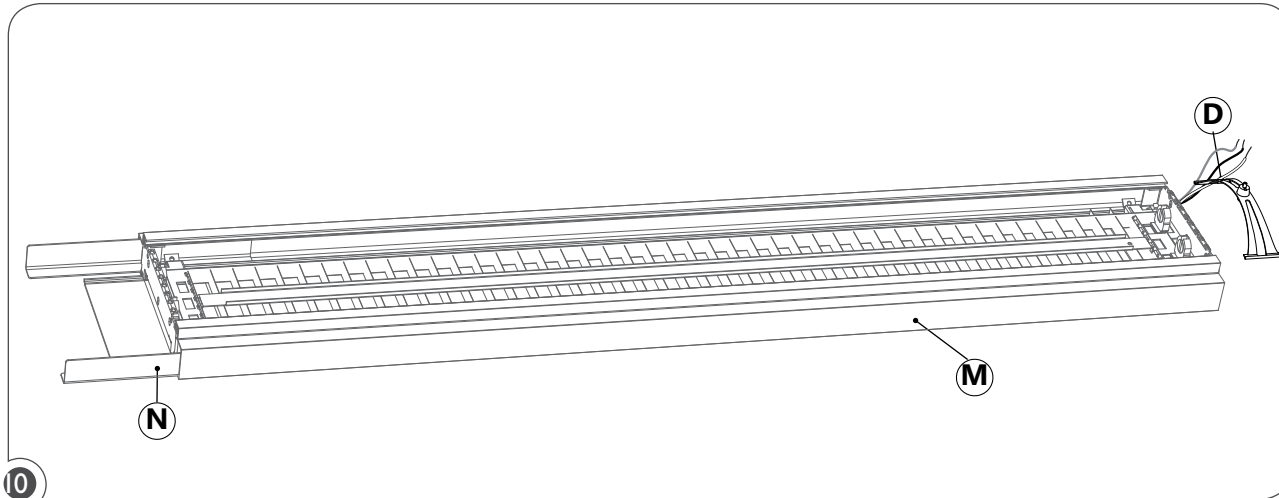

**10 For a continuous row system - middle fixture:**  
With first fixture in place, slide die cast hangers (D) into fixture (M).

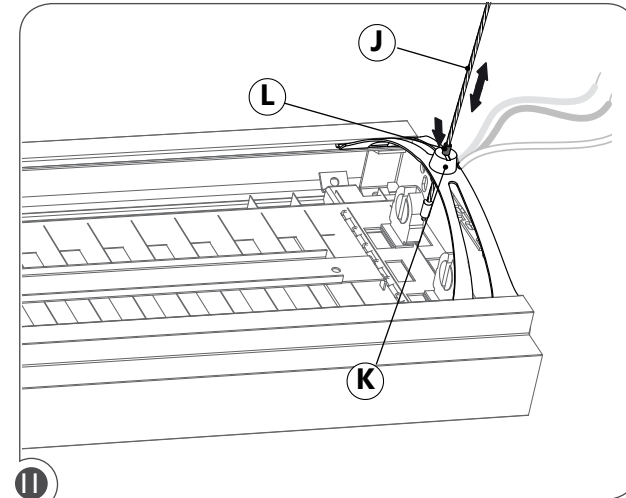

**11** Push the aircraft cable (J) through the cable grip (K). For adjustment press tab (L) on grip lock (K) to release or slide cable grip (J).

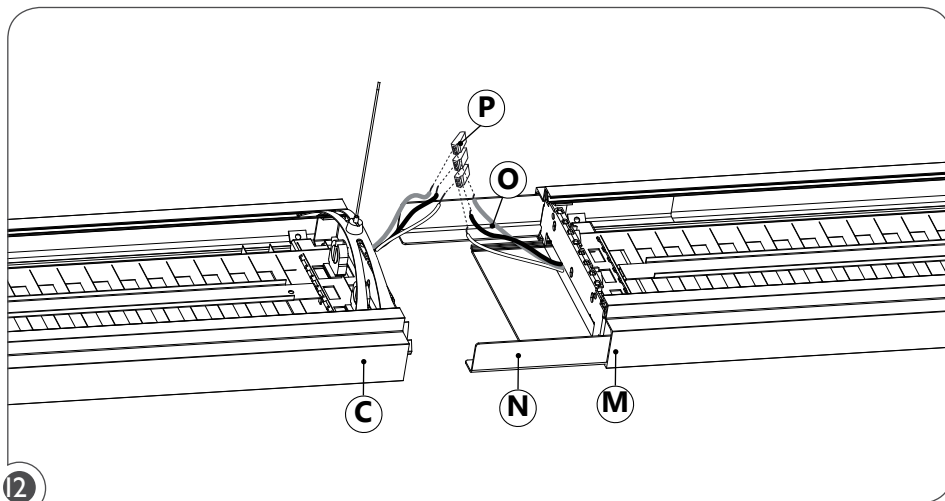

**12** Connect the electrical connectors (O) between the fixtures using supplied quick-wire connectors (P).

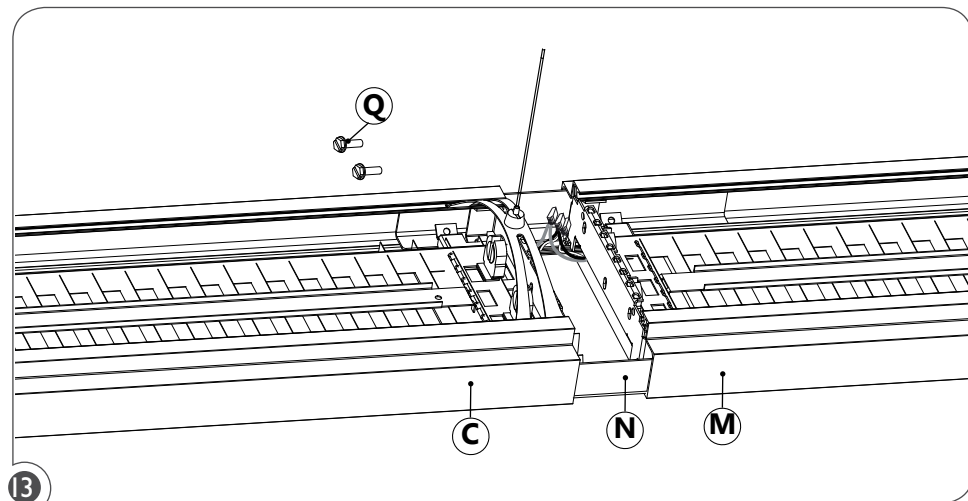

**13** Connect the fixtures (C) and (M) using the aligner (N) and secure with screws (Q). Install the lamps in the fixtures.