

PENDANT STEM INSTALLATION INSTRUCTIONS - POWER CABLE OUT OF STEM

NOTE: THE JUNCTION BOXES MUST BE SOLIDLY FIXED TO THE CEILING AND ATTACHED TO THE STRUCTURE INSIDE THE CEILING BEFORE PROCEEDING TO THE INSTALLATION.

PART LIST

A Trim ring	K Electrical wires
B Canopy	L Quick-wire connectors
C Stem	M Aligner
D J-box crossbar	N Screws
E $\frac{3}{8}$ threaded stud (by others)	O Lamps
F Threaded bracket	P Wire nuts
G Fixture 1	Q Optics
H Screws (by others)	R Reflector
I Octagonal junction box (by others)	S Nut
J Fixture 2	

SIDE VIEW

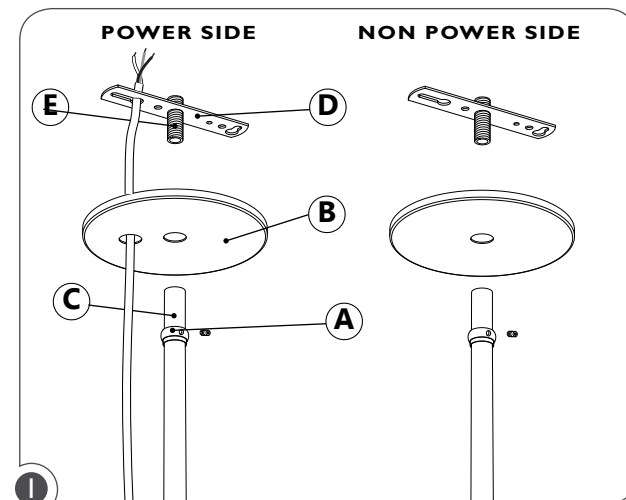
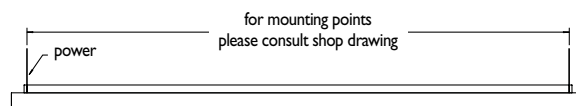

Slide the trim ring (A) and then the canopy (B) onto the stem (C) and leave loose. Screw the j-box crossbar (D) with the $\frac{3}{8}$ " threaded stud (E) onto the stem.

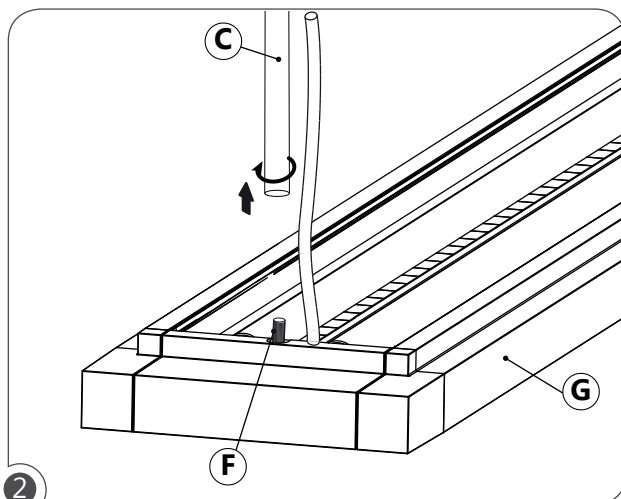

Screw the stems (C) onto the threaded bracket (F) at the ends of the fixture (G).

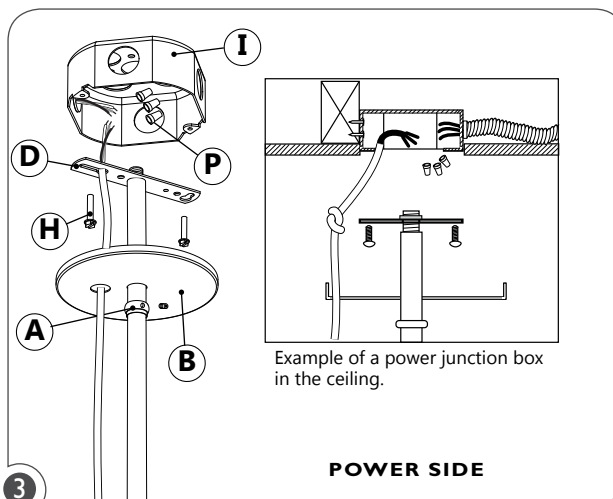

On the power side, raise the fixture to the ceiling and make electrical connection using wire nuts (P). Secure with screws (H) the j-box crossbar (D) to the junction box (I). Slide the canopy (B) and secure in place with the trim ring (A).

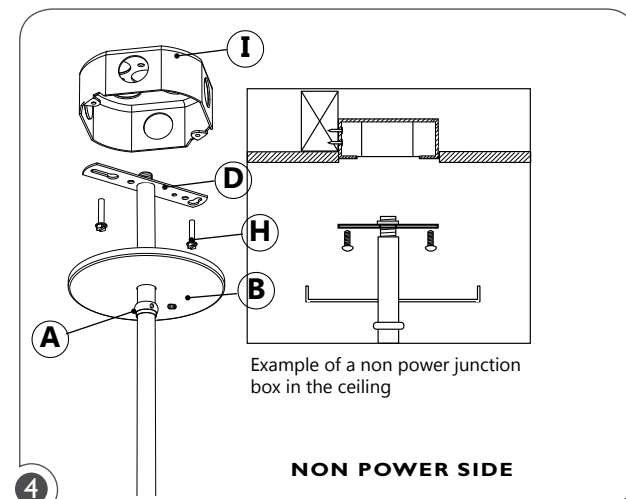

On the non power side, raise the fixture to the ceiling and secure with screws (H) the j-box crossbar (D) to the junction box (I). Slide the canopy (B) and secure in place with the trim ring (A).

WARNING:



RISK OF FIRE AND ELECTRICAL SHOCK. FIXTURE MUST BE INSTALLED BY A QUALIFIED ELECTRICIAN ONLY IN ACCORDANCE WITH NATIONAL, LOCAL BUILDING AND ELECTRICAL CODES. DISCONNECT POWER AT ELECTRICAL PANEL BEFORE SERVICING.



PENDANT STEM INSTALLATION INSTRUCTIONS

3 WIRES

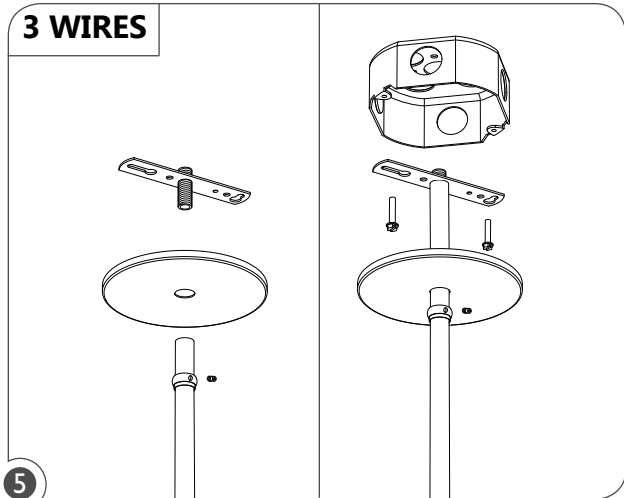

For a continuous row systems: With first fixture in place, repeat steps 1 and 4 for the next fixture in line.

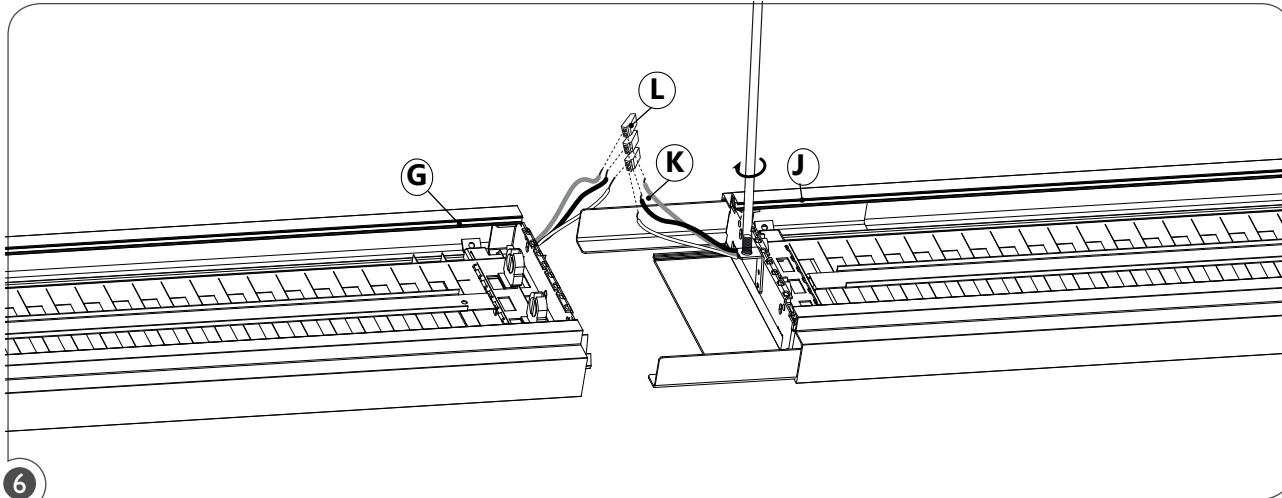

Connect the electrical wires (K) between the two fixtures (G) and (J), using supplied quick-wire connectors (L).

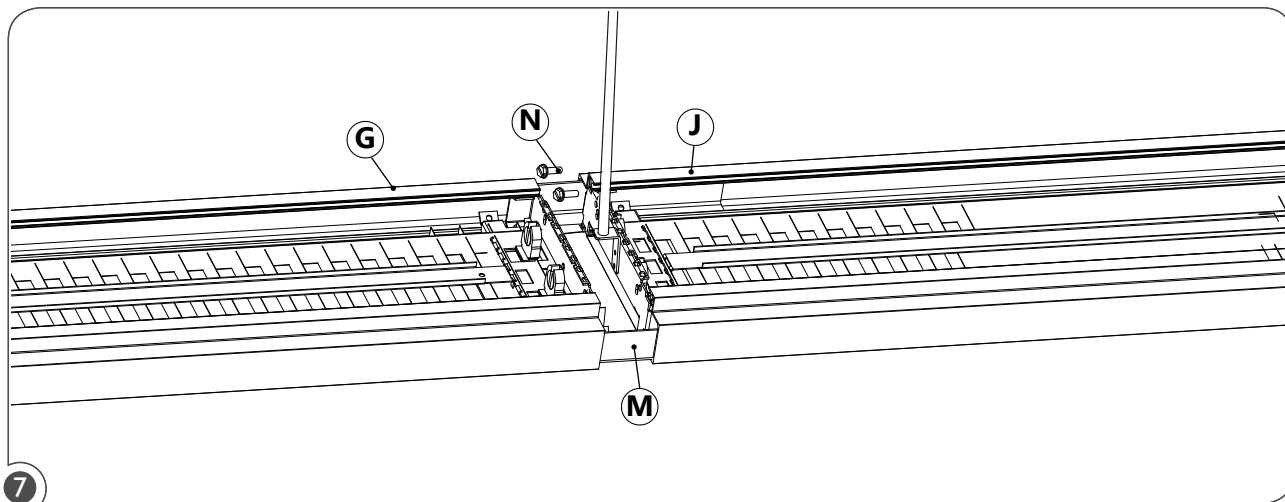

Connect the second fixture (J) using the aligner (M) and secure with screws (N).

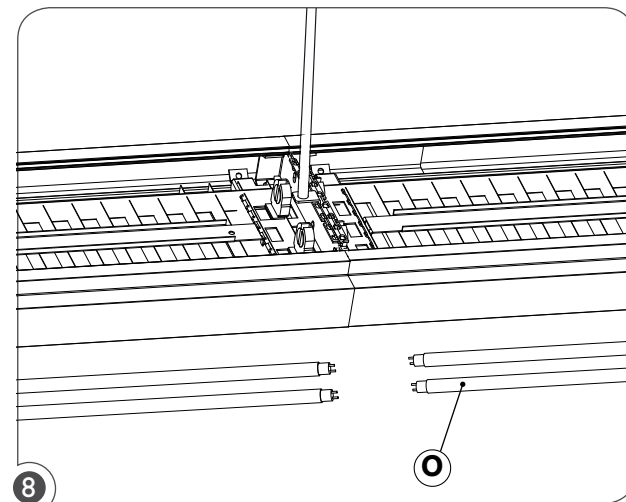

Install the lamps (O) in the fixtures.

PENDANT STEM INSTALLATION INSTRUCTIONS

4 WIRES AND MORE

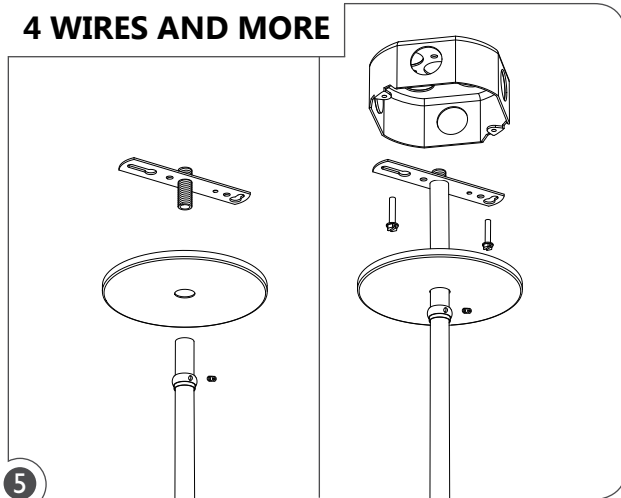

5 For a continuous row systems: With first fixture in place, repeat steps 1 and 4 for the next fixture in line.

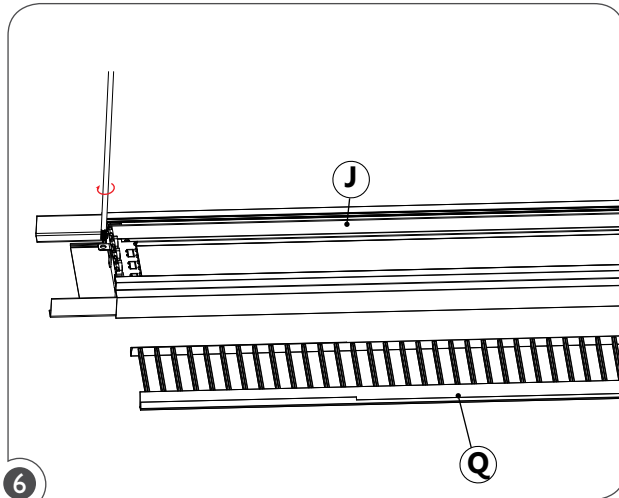

6 Remove the optics (Q) from the second fixture (J).

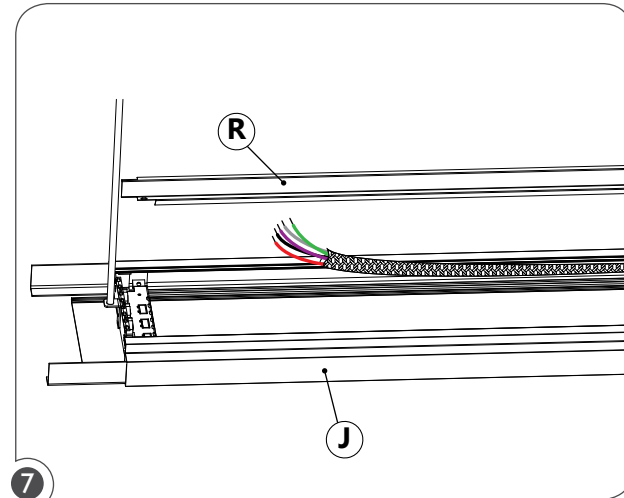

7 Remove reflector (R) from the second fixture (J).

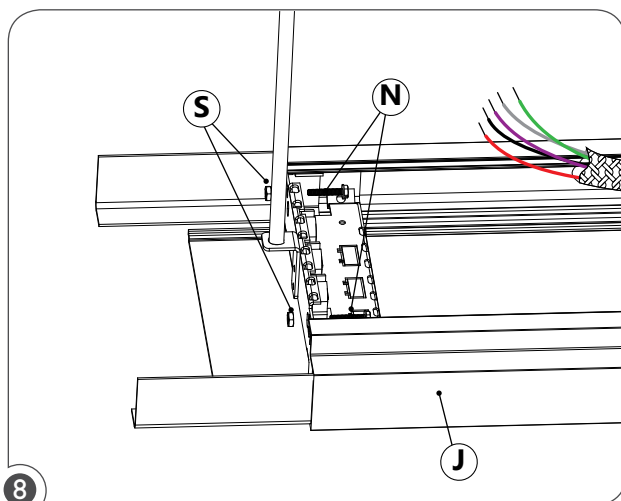

8 Remove the joining screws (N) and nuts (S) and set aside for later use.

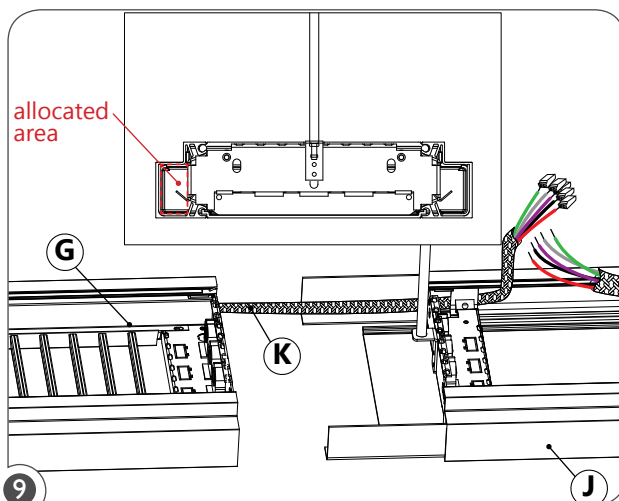

9 Push the electrical wires (K) from the first fixture (G) through the second fixture (J) in the allocated area on the side of the extrusion.

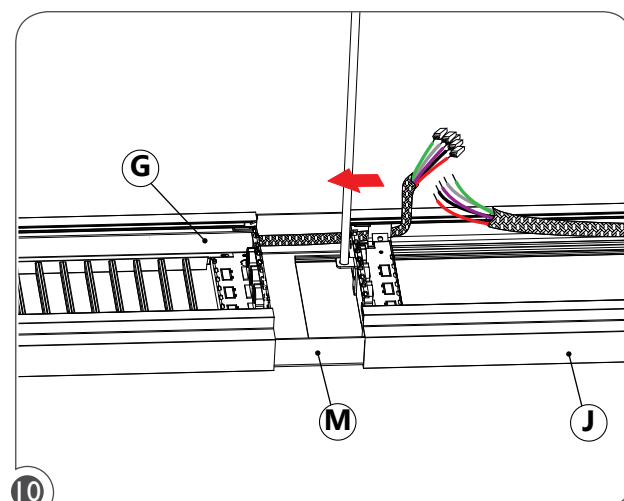

10 Push the fixtures together using the aligners (M).

WARNING:



RISK OF FIRE AND ELECTRICAL SHOCK. FIXTURE MUST BE INSTALLED BY A QUALIFIED ELECTRICIAN ONLY IN ACCORDANCE WITH NATIONAL, LOCAL BUILDING AND ELECTRICAL CODES. DISCONNECT POWER AT ELECTRICAL PANEL BEFORE SERVICING.



PENDANT STEM INSTALLATION INSTRUCTIONS

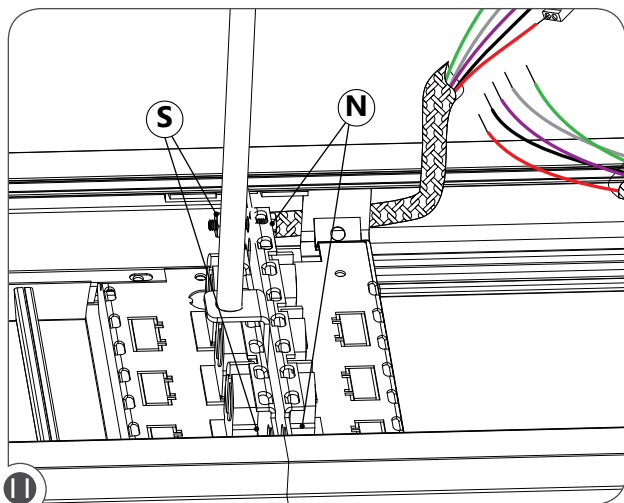

11 With the joining screws (N) and nuts (S) from step 8 join both fixtures together.

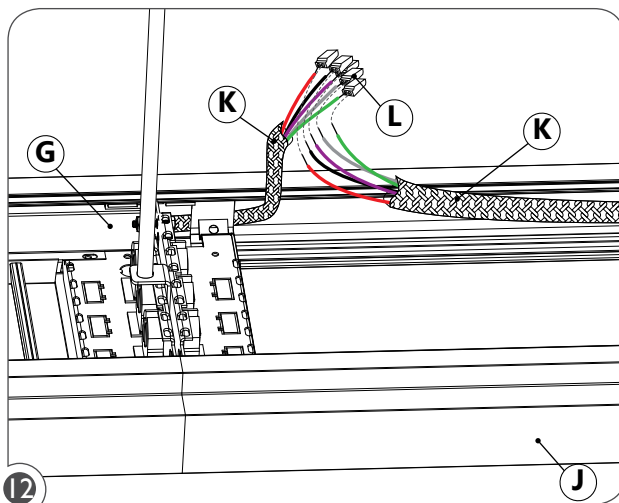

12 Connect the electrical wires (K) from both fixtures using the supplied quick-wire connectors (L).

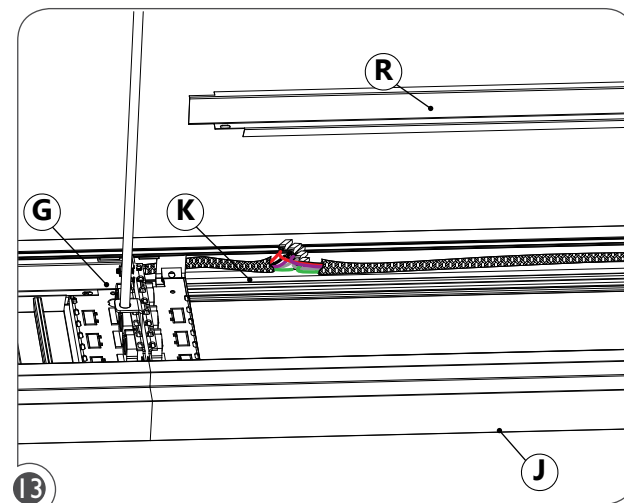

13 Push the electrical wires (K) into the side of the extrusion and screw the reflector (R) back to its place.

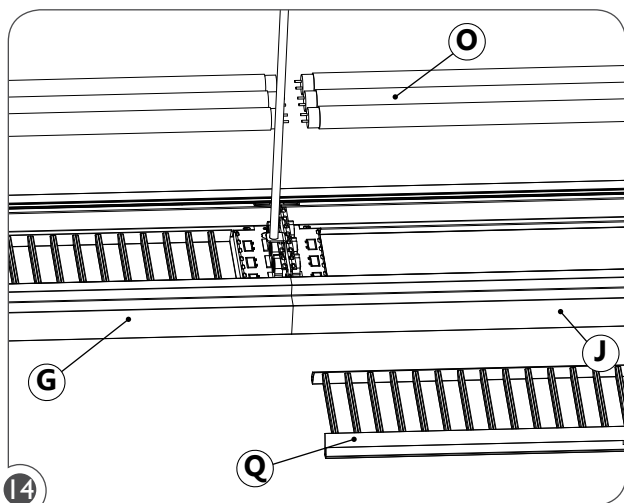

14 Install the lamps (O) in the fixtures. Reinstall the optics (Q) back to the second fixture (J).