

BALLAST REPLACEMENT INSTRUCTIONS

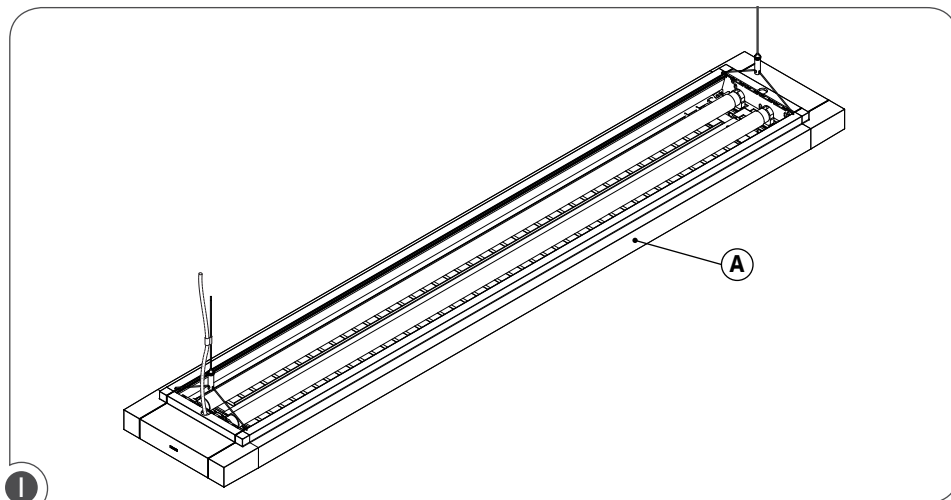

NOTE: Before attempting to verify and replace the ballast, the power to the fixture (A) must be turned off. Disconnect all circuits.

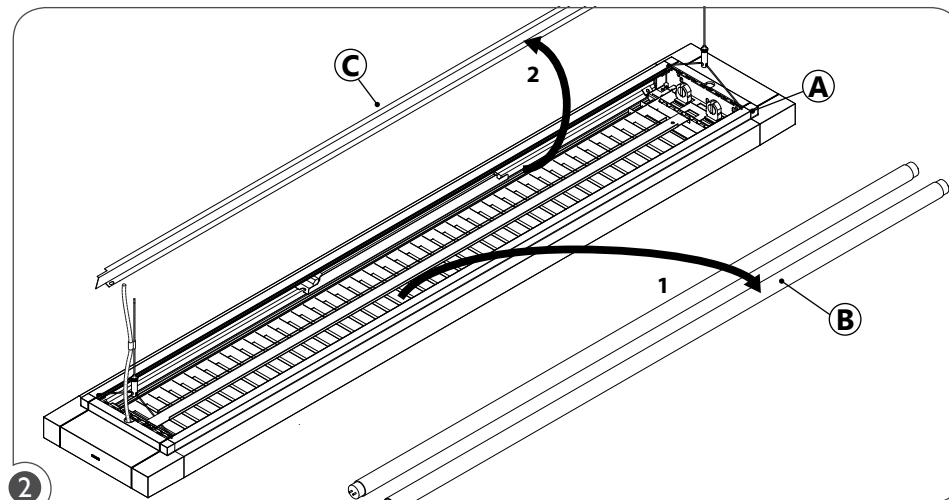

1. Remove lamps (B) from the fixture (A).
2. Remove the side reflector (C) retaining screws.

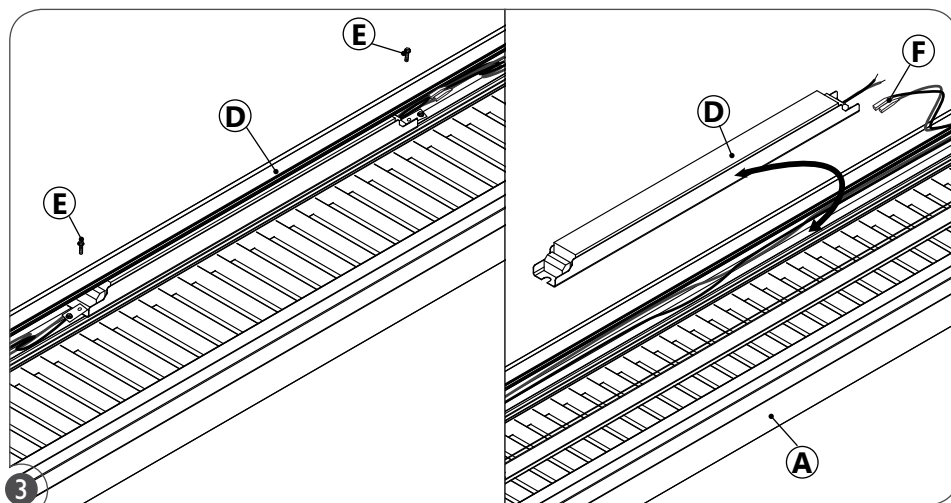

3. Remove the ballast (D) retaining screws (E). Disconnect wires (F) from the ballast (D). Replace ballast (D) and reconnect wires (F).

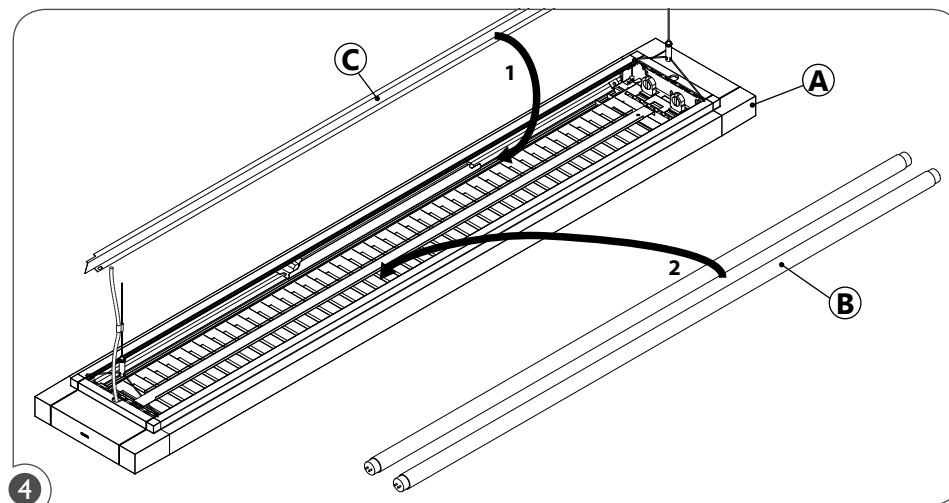

4. Put the side reflector (C) back in place and fasten retaining screws.
2. Re-install the lamps (B).

WARNING:



RISK OF FIRE AND ELECTRICAL SHOCK. FIXTURE MUST BE INSTALLED BY A QUALIFIED ELECTRICIAN ONLY IN ACCORDANCE WITH NATIONAL, LOCAL BUILDING AND ELECTRICAL CODES. DISCONNECT POWER AT ELECTRICAL PANEL BEFORE SERVICING.



BALLAST REPLACEMENT INSTRUCTIONS

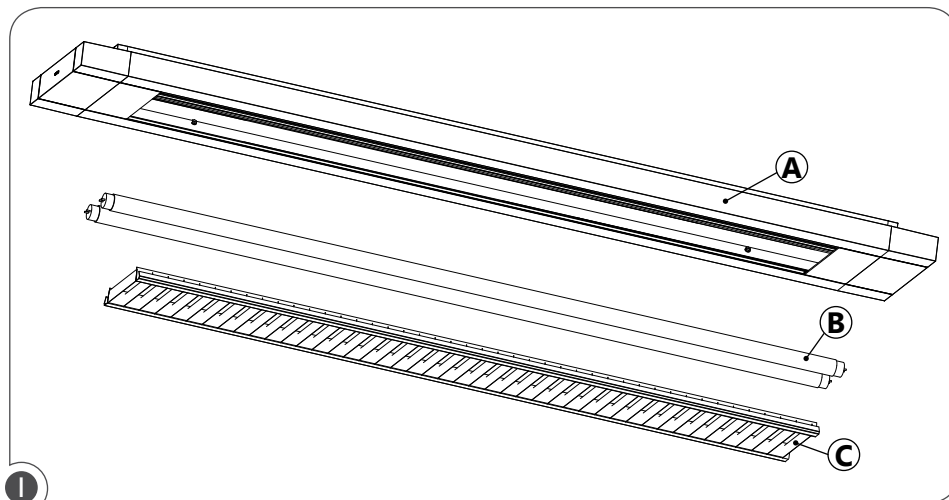

NOTE: Before attempting to verify and replace the ballast, the power to the fixture (A) must be turned off. Disconnect all circuits and remove lamps (B) and optics (C).

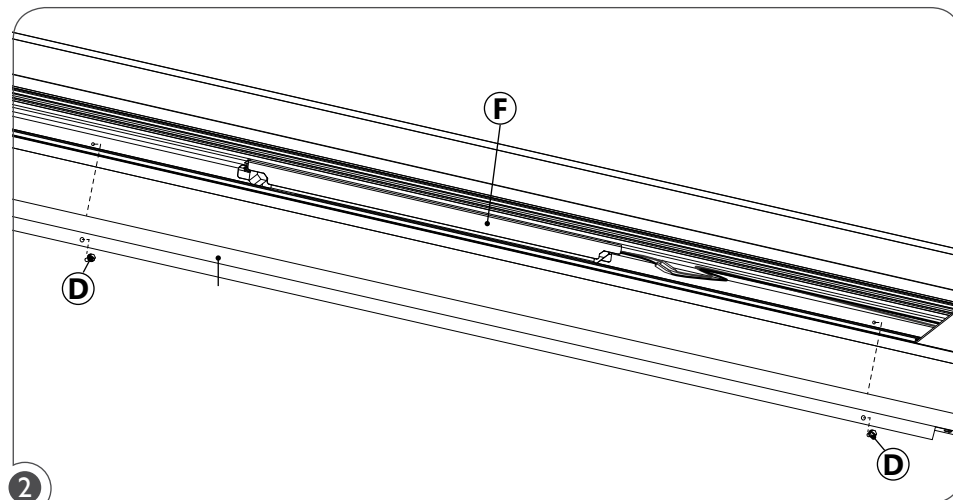

Remove the side reflector retaining screws (D) to access ballast (E).

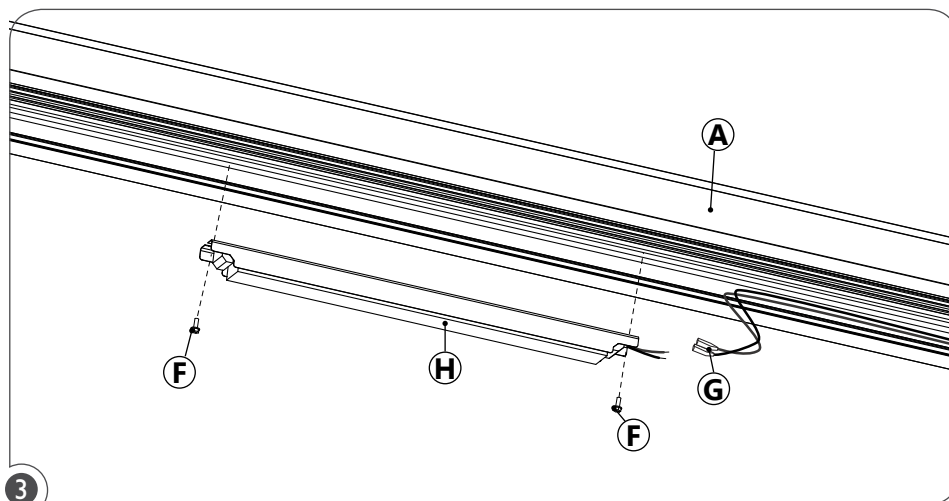

Remove the ballast retaining screws (F). Disconnect wires (G) from the ballast (H). Replace ballast (H) and reconnect wires (G).

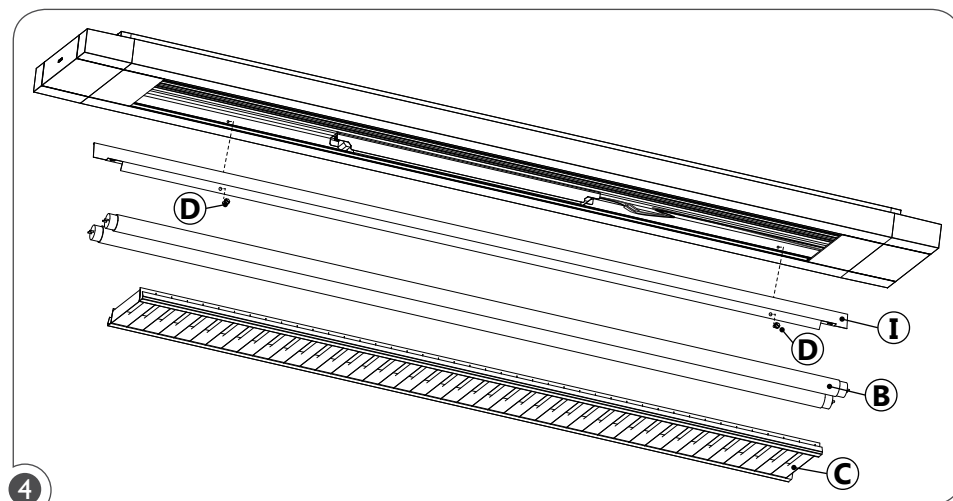

Put the side reflector (I) back in place and fasten retaining screws (D). Re-install the lamps (B) and optics (C).