



GSA prices effective April 3, 2017
(based on February 1, 2016, commercial price list)
Published June 2017

Workspaces

Ethospace® System with Meridian® and Tu® Pedestals
10-Day or Less

General Services Administration Federal Supply Service Authorized Federal Supply Schedule Price List

Online access to contract ordering information, terms and conditions, up-to-date pricing, and the option to create an electronic delivery order is available through GSA Advantage!, a menu-driven database system. The Internet address for GSA Advantage! is www.gsaadvantage.gov.

Office Furniture
FSC Group 71, Part 1
Contract Number: GS-03F-036DA
Contract Period: December 21, 2015—December 20, 2020

Contract Number: GS-28F-8049H
Contract Period: December 27, 2013—April 23, 2018 (Final Expiry Date)

Herman Miller, Inc.
855 East Main Avenue
Zeeland, Michigan 49464
(616) 654 3000 Phone
(616) 654 8278 Fax
www.HermanMiller.com/government

Business Size: Large

Contract Information

1a. Special Item Numbers (SIN)

SIN 71-1
Packaged Offices

SIN 711-1
Furniture Systems

SIN 711-2
Computer Furniture

SIN 711-3
Filing and Storage Cabinets

SIN 711-11
Tables and Accessories

SIN 711-16
Upholstered Seating

SIN 711-18
Multi-Purpose Seating

SIN 711-91
Project Management

Services under this SIN may be used only in conjunction with the purchase of new furniture. Please contact your local Herman Miller representative to discuss the available labor categories (listed below). The hourly rates listed are "Not To Exceed" or "NTE" values.

Furniture Project Manager: \$64.75 per hour
Furniture Project Coordinator: \$49.00 per hour
Build-Out Project Manager: \$80.00 per hour

SIN 711-93
Reconfiguration and Relocation Services

Reconfiguration and Relocation Services will be provided by Herman Miller, Inc., or its participating dealer based on a fee not to exceed \$55 per hour, which applies to services totaling \$150,000 (per SIN) and below only. Services above \$150,000 shall be negotiated on a case-by-case basis. This SIN may only be used with the purchase of new product under SIN 711-1.

See * Additional Notes for Installation & Reconfiguration and Relocation Services.

SIN 711-94
Design/Layout

Design service will be provided by Herman Miller, Inc., or its participating dealer based on a fee not to exceed \$65 per hour.

SIN 711-95
Installation Services

Installation Services will be provided by Herman Miller, Inc., or its participating dealer based on a fee not to exceed \$55 per hour (\$82.50 per hour for after-hours Installation), which applies to services totaling \$150,000 (per SIN) and below only. Services above \$150,000 shall be negotiated on a case-by-case basis.

See * Additional Notes for Installation & Reconfiguration and Relocation Services.

* Additional Notes for Installation & Reconfiguration and Relocation Services:

FOB Destination (Drop Ship): Price includes product delivery to the site, brought to the tailgate of the truck. The purchaser is responsible for unloading.

Prices effective up to the maximum order by SIN only. Above the MO, pricing shall be negotiated on a case-by-case basis between the client and local dealer.

Standard Services are Subject to the Following Conditions:

Installation will be performed during normal weekday working hours.

Adequate facilities for delivery, unloading, moving and staging/ storing the product during the installation process shall be provided.

Service work will not be hindered by other trades.

Electric, heat, and adequate elevator service will be furnished without charge.

The immediate installation area shall be complete and free of debris including the carpet/flooring before installation commences.

Any work requiring a licensed electrician is the responsibility of the buyer.

Additional Charges May Apply For:

Major Metro Markets and any non-ground floor installation.

Major Metro Markets include large population centers and urban environments.

Installation in a clinical/medical environment.

Special restrictions or limits established by local laws, ordinances or the directions of the buyer, including but not limited to restrictions on transportations of materials, street access to the job site and/or dock facilities.

Installations outside of a 50 mile radius of the servicing dealer.

Local Prevailing Wage and/or Union Labor Rates.

Any additional charges shall be quoted by the dealer and approved by the buyer prior to performance of the work.

SIN 711-96
Leasing

Contact Herman Miller participating government dealer for current leasing information.

SIN 711-99
New Product Introductions

Contract Information

continued

1b. Lowest Priced Model

SIN 711-1:	G9999.B	\$6
SIN 711-2:	6-5-D	\$33
SIN 711-3:	9M10018	\$13
SIN 711-11:	DT9A.	\$34
SIN 711-16:	OA401	\$40
SIN 711-18:	WC410NBK3MY7BK	\$229
SIN 711-99:	BVP3.S	\$11

1c. Not applicable

2. Maximum Order

SIN 711-1, SIN 711-2
\$500,000 net product value

SIN 711-3, SIN 711-11
\$300,000 net product value

SIN 711-16, SIN 711-18
\$200,000 net product value

SIN 711-93
\$150,000

SIN 711-94
\$150,000

SIN 711-95
\$150,000

SIN 711-96
\$500,000 net product value

SIN 711-99
\$50,000 net product value

3. Minimum Order

\$100 net

4. Geographic Coverage

Continental U.S.

Orders for Alaska, Hawaii, and Puerto Rico will be shipped F.O.B. inland carrier point of exportation.

5. Point of Production

Zeeland, Ottawa County, Michigan
Spring Lake, Ottawa County, Michigan

6. Pricing

Prices shown are list. Discounts include Industrial Funding Fee.

SIN 711-1

Product: Selected Action Office 1, Action Office 2, C-Style Overhead Storage, Ethospace System, Quadrant Pedestals, Supplemental Products, Tu Pedestals and Pedastools, and approved Herman Miller Options Products.

Standard Lead Time	Single Order Net Purchase	Discount From list
	\$100 - 250,000	73.8%
	\$250,001 - 500,000	76.8%

SIN 711-1

Product: Selected Renew™ Tables, Renew Link and approved Herman Miller Options Products

Standard Lead Time	Single Order Net Purchase	Discount From List
	\$100 - 500,000	72.8%

SIN 711-1

Product: Selected Motia™ Tables, and approved Herman Miller Options Products

Standard Lead Time	Single Order Net Purchase	Discount From List
	\$100 - 500,000	73.8%

SIN 711-1

Product: Tu Wood Pedestals and approved Herman Miller Options Products

Standard Lead Time	Single Order Net Purchase	Discount From List
	\$100 - 300,000	74.3%

SIN 711-1

Product: Selected Canvas Office Landscape and approved Herman Miller Options Products

Standard Lead Time	Single Order Net Purchase	Discount From List
	\$100 - 500,000	74.8%

SIN 711-1

Product: Selected Layout Studio® and approved Herman Miller Options Products

Standard Lead Time	Single Order Net Purchase	Discount From List
	\$100 - 500,000	60.7%

SIN 711-1

Product: Selected Meridian Pedestals, Meridian Pedastools, and approved Herman Miller Options Products

Standard Lead Time	Single Order Net Purchase	Discount From List
	\$100 - 500,000	64.2%

Contract Information

continued

SIN 711-1

Product: Selected Thrive Portfolio and approved Herman Miller Options Products

Standard Lead Time	Single Order Net Purchase	Discount From List
	\$100 - 250,000	62%
	\$250,001 - 500,000	66.4%

SIN 711-2

Product: Passage Desking System and approved Herman Miller Options Products

Standard Lead Time	Single Order Net Purchase	Discount From List
	\$100 - 500,000	56.7%

SIN 711-2

Product: 5000 Series Furniture and approved Herman Miller Options Products

Standard Lead Time	Single Order Net Purchase	Discount From List
	\$100 - 500,000	58.7%

SIN 711-3

Product: Meridian Laterals, Verticals, Towers, and Storage products and approved Herman Miller Options Products

Standard Lead Time	Single Order Net Purchase	Discount From List	Towers & Storage
	\$100 - 300,000	67.3%	62.7%
		66.3%	

SIN 711-3

Product: Tu Lateral Files, Tu Storage, Tu Towers, Tu Wood Cases, Tu Wood Cubbies, Tu Wood Credenzas, Tu Wood Towers, and approved Herman Miller Options Products

Standard Lead Time	Single Order Net Purchase	Discount From List
	\$100 - 300,000	74.3%

SIN 711-11

Product: Selected Tables and Accessories and approved Herman Miller Options Products

Standard Lead Time	Single Order Net Purchase	Discount From List
Avice® Tables	\$100 - 250,000	72.8%
	\$250,001 - 500,000	74.8%
Herman Miller Eames® Tables	\$100 - 250,000	73.6%
	\$250,001 - 300,000	77.6%
Everywhere™ Tables	\$100 - 300,000	72.8%

SIN 711-16

Product: Swoop upholstered seating products and approved Herman Miller Options Products

Standard Lead Time	Single Order Net Purchase	Discount From List
Swoop™	\$100 - 200,000	60.7%

SIN 711-18

Product: Selected Seating and approved Herman Miller Options Products

Standard Lead Time	Single Order Net Purchase	Discount From List
Aeron® (Classic and New)	\$100 - 200,000	64.5%
Aside®	\$100 - 200,000	64.2%
Caper®	\$100 - 200,000	61.5%
Celle®	\$100 - 200,000	59.7%
Embody®	\$100 - 200,000	59.7%
Equa 2®	\$100 - 200,000	65.8%
Ergon 3®	\$100 - 200,000	68.8%
Mirra® 2	\$100 - 200,000	59.7%
Setu®	\$100 - 200,000	59.7%
Sayl®	\$100 - 200,000	62.2%

SIN 711-99

Product: Selected Exclave™, Locale®, Public Office Landscape®, Resolve® System, and approved Herman Miller Options Products

Standard Lead Time	Single Order Net Purchase	Discount From List
Exclave	\$100 - 50,000	61.7%
Locale	\$100 - 50,000	63.7%
Public Office Landscape	\$100 - 50,000	61.7%
Resolve System	\$100 - 50,000	69.8%

7. Quantity Discounts

Reference item #6.

8. Payment Term

Net 30 days

9. Government Commercial Credit Card

- Government commercial credit cards are accepted below the micropurchase threshold.
- Government commercial credit cards are accepted above the micropurchase threshold.

10. Foreign Items

None

11. Time of Delivery

- 90 day ARO
- Expedited delivery: Items listed in the 10-Day section of the catalogs are available for expedited delivery.
- Overnight/2-day delivery: Select items may be available for overnight or 2-day delivery. Contact Herman Miller or a participating dealer for availability and rates.
- Urgent requirements: Agencies may contact contractor or participating dealer to request faster delivery.

Contract Information

continued

12. F.O.B.

F.O.B. destination except Alaska, Hawaii, and Puerto Rico, which will be shipped F.O.B. inland carrier point of exportation.

13. Ordering Address

- a. Herman Miller, Inc.,
Government Customer Care 0161
855 East Main Avenue
Zeeland MI 49464.
- b. For supplies and services, the ordering procedures information on Blanket Purchase Agreements (BPA 's) and a sample BPA can be found at the GSA/FSS Schedule homepage (www.fss.gsa.gov/schedules).

14. Payment Address.

Herman Miller, Inc.
22764 Network Place
Chicago, IL 60673-1227

15. Warranty

Herman Miller, Inc., commercial warranty applies.

16. Export Packing Charge

Prices supplied on request.

17. Terms and Conditions of Government Purchase Card Acceptance

(any thresholds above the micropurchase level)
None.

18. Rental Maintenance and Repair Terms

Not applicable

19. Terms and Conditions of Installation

Installation Services will be provided by Herman Miller, Inc., or its participating dealer based on a fee not to exceed \$55 per hour (\$82.50 per hour for after-hours Installation), which applies to services totaling \$150,000 (per SIN) and below only. Services above \$150,000 shall be negotiated on a case-by-case basis.

Additional Notes for Installation & Reconfiguration and Relocation Services:

FOB Destination (Drop Ship): Price includes product delivery to the site, brought to the tailgate of the truck. The purchaser is responsible for unloading.

Prices effective up to the maximum order by SIN only. Above the MO, pricing shall be negotiated on a case-by-case basis between the client and local dealer.

Standard Services are Subject to the Following Conditions:

Installation will be performed during normal weekday working hours.

Adequate facilities for delivery, unloading, moving and staging/storing the product during the installation process shall be provided.

Service work will not be hindered by other trades.

Electric, heat, and adequate elevator service will be furnished without charge.

The immediate installation area shall be complete and free of debris including the carpet/flooring before installation commences.

Any work requiring a licensed electrician is the responsibility of the buyer.

Additional Charges May Apply For:

Major Metro Markets and any non-ground floor installation.

Major Metro Markets include large population centers and urban environments.

Installation in a clinical/medical environment.

Special restrictions or limits established by local laws, ordinances or the directions of the buyer, including but not limited to restrictions on transportations of materials, street access to the job site and/or dock facilities.

Installations outside of a 50 mile radius of the servicing dealer.

Local Prevailing Wage and/or Union Labor Rates.

Any additional charges shall be quoted by the dealer and approved by the buyer prior to performance of the work.

20. Terms and Conditions of Repair Parts

Not applicable

21. Service and Distribution Points

For service and distribution points nearest you, call (800) 851 1196.

22. Participating Dealers

Access Herman Miller web site for current list of participating dealers: www.HermanMiller.com/government.

23. Preventive Maintenance

Not applicable

24a. Special Attributes.

2016

Herman Miller was recognized by the Michigan Minority Supplier Development Council (MMSDC), as a "Corporation of the Year" and was the only company in West Michigan to receive an "Ambassadors Championing Excellence" Award from the MMSDC this year.

Contract Information

continued

Herman Miller received a “2016 Excellence in Supplier Diversity Award” from the Great Lakes Women’s Business Council.

Herman Miller was named a 2020 Women on Boards Winning Company. Companies selected for this recognition are considered champions of board diversity as 20 percent or more of their board seats are occupied by women.

Herman Miller was selected for inclusion in the 2016 RobecoSAM Sustainability Yearbook for twelfth consecutive year.

2004-2015

Herman Miller was recognized for its commitment to best-in-class economic, environmental, and societal sustainability, earning a spot on the prestigious Dow Jones Sustainability Index (DJSI) for 12 consecutive years. We are one of 317 companies worldwide to be included in the DJSI World Index, and the only contract furniture company recognized globally for its corporate sustainability leadership.

2015

This is the fourth consecutive year that Herman Miller was named one of Michigan’s Best and Brightest Sustainable Companies.

Herman Miller has received the Forest Stewardship Council (FSC) Leadership Award for longstanding commitment to manufacturing with wood sourced from responsibly managed forests. Herman Miller was recognized for being dedicated to reducing environmental impacts by protecting against deforestation and forest degradation.

Herman Miller accepted its second Excellence in Reusable Packaging Award from the Reusable Packaging Association. We were acknowledged for eliminating more than 28,000 tons of corrugated waste from piling up in landfills.

Herman Miller received a Michigan Business Pollution Prevention (MBP₃) Certificate – a recognition given by the Michigan Department of Environmental Quality (MDEQ) to organizations committed to environmental stewardship, conservation, and sustainable operations.

Fast Company named Herman Miller as one of the World’s Top 10 Most Innovative Companies of 2015 in Design.

Renew Sit-to-Stand tables recognized on Record Products 2014 list by Architectural Record.

Herman Miller was again awarded a perfect score in the 2015 Corporate Equality Index.

2014

Herman Miller’s Locale wins International Design Excellence Awards (IDEA) Gold in the Office & Productivity category.

2013

Herman Miller Earns Perfect Score on the Corporate Equality Index. We are one of only 303 major U.S. businesses to receive a perfect score in 2013, an achievement we have now obtained seven years in a row.

Herman Miller is listed in Forbes Magazine inaugural “Platinum List” of America’s 400 best managed, large companies.

For the second consecutive year, Herman Miller is honored as one of West Michigan’s “101 Best and Brightest Sustainable Companies”.

2012

Architectural and design professionals participating in *Contract* magazine’s 2011 Brand Report Awareness Survey have once again named Herman Miller and its subsidiaries as their preferred source for key furnishings in the workplace and healthcare environments.

Herman Miller is named “Corporation of the Year” in the commercial products sector by the Michigan Minority Supplier Development Council.

Herman Miller was inducted into the Made in the USA Hall of Fame. Herman Miller was one of only 20 companies across the nation to receive this distinction. The Hall of Fame showcases exceptional U.S. manufacturers and demonstrates that many high-quality products are made in the United States.

Herman Miller is honored as one of West Michigan’s 101 Best and Brightest Sustainable Companies. The award celebrates organizations that are making their business more sustainable; the lives of their employees better; and the community, both locally and globally, more responsible as a whole.

The Sustainable Asset Management (SAM) group selected Herman Miller for inclusion in “The Sustainability Yearbook 2012” and has awarded Herman Miller both the “SAM Sector Leader” and “SAM Sector Mover” distinctions.

Herman Miller was named one of 16 Section Leaders on Climate Counts 2011-2012 Scorecard Report, making us the industry leader for Home and office Furnishings. The scorecard measures how well the largest companies across 16 industry sectors are preparing for a low-carbon future. Companies are scored based on 22 criteria including a company’s efforts to assess their climate footprint, reduce greenhouse gas emissions, and the ability to communicate their efforts to consumers.

2011

Herman Miller again tops the contract furniture industry in FORTUNE’s ‘Most Admired’ Companies survey. For the 23rd time in 25 years, Herman Miller was the highest ranking furniture manufacturer in a survey among the executives and board members of peer companies and independent industry analysts, as published in FORTUNE Magazine’s Annual ‘Most Admired’ Companies feature. Taking second overall in the expanded, 14 company category of ‘Home Equipment, Furnishings,’ Herman Miller received the number one ranking in five of the nine attributes surveyed.

Contract Information

continued

Trust Across America, a company dedicated to unraveling the complexities of trustworthy business behavior, listed Herman Miller as one of their "Top Ten Most Trustworthy Companies in America 2011."

The Michigan Minority Supplier Development Council (MMSDC) named Herman Miller as its "Corporation of the Year." The company was selected for the honor from among several finalists, including its largest direct competitors. This was the fifth time Herman Miller has received the prestigious award since 2005. When accepting the award, the Inclusiveness & Diversity Program Manager stated, "We are honored to be recognized for our commitment to creating an inclusive supply chain. Herman Miller strives to create a better world through all aspects of our business. Working with diverse suppliers, and the support of the MMSDC, brings us closer to that goal."

Herman Miller receives the Reader's Choice award from TreeHugger's Best of Green: Design and Architecture category for the SAYL chair.

Herman Miller wins prestigious Just Means Social Innovation Award for "Best Sustainability Performance." Herman Miller was nominated for making substantial gains in reducing its CO₂ footprint and significantly outperformed other nominees in the category of Operations.

Herman Miller Healthcare's Compass system was awarded a 2011 Medical Design Excellence Award (MDEA) for its research-based design and ability to be used in a variety of healing spaces, while simultaneously improving the overall delivery of healthcare.

The Sustainable Asset Management (SAM) Group selected Herman Miller for inclusion in the "Sustainability Yearbook 2011" and awarded us both the "SAM Sector Leader" and "SAM Sector Mover" distinctions.

2010

Herman Miller's SAYL chair named "Product Design of the Year" by the International Design Awards (IDA) jury. The award recognizes smart and sustainable multidisciplinary design.

The Flo monitor arm from Herman Miller, was chosen to receive a 2010 "Red Dot" award for product design. The Red Dot Program is considered by many to be the largest and most distinguished international design competition. There were almost 14,000 entries from 68 countries, with more than 4,400 products from 60 countries entered into the product design category.

The NASDAQ OMX CRD Global Sustainability Index (QCRD) has included Herman Miller among their top 100 companies in the world.

Herman Miller achieves LEED-CI Platinum certification from the U.S. Green Building Council for its recently completed Los Angeles Showroom.

2009

Herman Miller named Green Champion by *Business Review West Michigan*.

Herman Miller awarded the 2009 Recycling by Design award by the Institute of Scrap Recycling Industries, Inc.

Aeron receives MBDC Silver Cradle to Cradle certification.

Herman Miller's local fleet is recognized as a U.S. EPA SmartWay Transport Partnership Certified Carrier.

Herman Miller achieves LEED-CI Gold certification for its Main Site B West renovation.

2008

Herman Miller recognized by *Occupational Hazards* magazine as one of America's Safest Companies (ASC). It was one of 18 companies to achieve this distinction.

Herman Miller's Zeeland Main Site awarded status as a STAR participant in the Michigan Voluntary Protection Program (MVPP). The MVPP Star Award is the most prestigious safety and health award given in Michigan. Zeeland Main Site is the fourth Herman Miller facility to receive MVPP status, along with the Greenhouse (in 2005), Midwest Distribution Center (in 2007), and 171st Avenue facility (in 2006).

Teneo, Tu, and Meridian filing and storage product lines receive McDonough Braungart Design Chemistry (MBDC) Silver Cradle to Cradle certification.

2004-2009

Herman Miller achieves sixth consecutive placement on the Dow Jones Sustainability World Index, an international stock portfolio that evaluates the annual performance of the world's largest 2500 companies using economic, environmental, and social criteria, known as the "triple bottom line" of sustainability.

2007

Herman Miller earns the 2007 Waste Wise Gold Achievement Award for Smart Packaging. The U.S. Environmental Protection Agency (EPA) recognizes Herman Miller for its ongoing commitment to reduce transport packaging.

Herman Miller's IT North building in its Main Site facility earns LEED-CI Silver certification from the U.S. Green Building Council (USGBC).

My Studio Environments receive McDonough Braungart Design Chemistry (MBDC) Silver Cradle to Cradle certification.

Herman Miller, Inc., chosen for Sustainable Business 20 List. The company is featured for the fifth time as one of the "World's Top Sustainability Stocks," which includes companies with strong environmental initiatives and solid financial performance.

Herman Miller earns LEED-CI Gold Certification from the U.S. Green Building Council (USGBC) for its National Design Center in Atlanta, Georgia.

Contract Information

continued

2006

Business Ethics ranks Herman Miller, Inc. among the “100 Best Corporate Citizens” in America.

Herman Miller earns LEED-CI Gold Certification from the U.S. Green Building Council (USGBC) for its National Design Center in New York City, New York. This is the first LEED-CI Gold rating to be awarded in New York City.

Herman Miller honored by the U.S. Environmental Protection Agency (EPA) with its WasteWise Award for its commitment to build or renovate its facilities--leased or owned--to meet at least a LEED (Leadership in Energy and Environmental Design) Silver certification.

2005

The U.S. Environmental Protection Agency's Pacific Southwest office honors Herman Miller with its seventh annual Environmental Awards, recognizing the company's efforts to protect and preserve the environment during 2004.

The U.S. Environmental Protection Agency presents Herman Miller with its WasteWise 2005 Product Stewardship Gold Achievement Award in the Design category; Honorable Mention also received in the Large Business category for its recycling efforts.

Herman Miller earns LEED Gold Certification from the U.S. Green Building Council (USGBC) for the Design Yard Front Door in Holland, Michigan.

Michigan “Clean Corporate Citizen” Award given to Herman Miller's Greenhouse manufacturing facility for its environmental management system and record for active pollution prevention.

2004

American Institute of Architects (AIA) Committee on the Environment selects Herman Miller's Building C-1 renovation as one of the AIA/COTE Top 10 Green Projects in America.

The U.S. Green Building Council (USGBC) names Herman Miller among the recipients of its Green Building Leaders Recognition Award for 2004, in the Green Building Business category.

For the third year in a row, Herman Miller is included on SustainableBusiness.com's list of the top 20 sustainable stocks among public companies worldwide.

2003

The University of Colorado, Leeds School of Business, names Herman Miller among three finalists for the first annual “Summit Awards for Social Impact,” citing the company's environmental leadership.

Environmental Building News magazine's GreenSpec Product Directory names Herman Miller's Mirra chair among its Top 10 picks for best new “green” products.

2002

Program Champion recognition from the U.S. Environmental Protection Agency's WasteWise Program, for overall waste reduction achievements.

2000-2003

Business Ethics ranks Herman Miller, Inc. in the top 10 among the “100 Best Corporate Citizens” in America, and first among all ranked companies for “Service to the Environment.”

1999-2001

Environmental Protection Agency's (EPA) Large Industry Partners of the Year Award for overall waste reduction achievements.

2000

Waste Reduction Award Program (WRAP) from the State of California Environmental Protection Agency Integrated Waste Management Board for improving the environment by reducing waste.

24b. Section 508 Compliance

Not applicable

25. Data Universal Numbering System (DUNS): 00-601-2801

26. Registered in System for Award Management (www.SAM.gov) Database

27. Cancellation

Prior to production, no cancellation charge will apply. After production, only actual cost incurred that the contractor can demonstrate if items are sold after 3 months.

28. Restocking Charges

Agencies must notify the contractor for authorization prior to returning any items. The customer agency will be required to pay all packaging and return freight charges. A restocking fee of 50% for Systems Furniture and 35% for all other product lines will be charged for any returned items.

Herman Miller Miscellaneous Information:

Federal ID Number: 38-0837640

Commercial and Government Entity Code (CAGE): 40636

Data Universal Numbering System (DUNS) 00-601-2801

Commercial Entity Code (CEC): 00702290J

Introduction	page 2
Ethospace® System 10-Day or Less	3
Walls	5
Work Surfaces	44
Storage	59
Lighting	71
Work Organizers	73
Meridian® Pedestals 10-Day or Less	75
Tu® Pedestals 10-Day or Less	83
Metal Pedestals	85
Metal Pedestal Accessories	93
Indices	97
By Name	97
By Number	99
Appendices	
10-Day or Less Order Information	
10-Day Keyed-Alike Information	
Proprietary Textiles Application Chart - 10-Day Workspaces	
Proprietary Textile Colors - 10-Day Workspaces	
For the latest materials information, refer to the Materials pages on	
HermanMiller.com.	

Introduction

A Note on the Organization of This Book

There are a few signals that will help you understand the organization of this book. Once you know them, you should be able to find your way around easily.

Like a newspaper, this book is formatted with columns of text and illustrations that run vertically.

Information wraps from one column to the next and continues for as many pages as it needs to.

Black bars are clues.

A black bar at the top of a page signals the start of information about a product.

Specification Information, which always begins at the top of a column, includes a series of steps. Each step represents a decision you need to make in order to complete your product number. Steps must be followed sequentially. The number of pages needed to complete information on a product varies; some will be complete in one page; others may fill three or four pages. Just continue going through the steps until you run into the next product, signaled by the black bar at the top of the page.

Black tabs running along the outside edge of the page help you locate what section you are in or what section you want to go to. You can thumb forwards or backwards to find a section; tabs and text appear on both sides of the page.

The additional pages in the back of the book include the appendices and indices. They are signaled by a long black bar running along the outside edge of the page.

The index is presented two ways.

The first index is in alphabetical order by product name. It can be helpful if you are new to the products and numbering scheme or if you are looking for a type of product, such as work chair or round table.

The second index is by product number. It lists, in alphanumeric order, the base product number, typically a five-digit number.

General Information

This book is effective April 3, 2017, subject to change without notice. Products may be purchased from authorized Herman Miller dealers who will quote prices upon request. For more information about our products and services or to see a list of dealers, visit www.HermanMiller.com.

All prices are list prices. Additional services, such as planning services, design, storage, and installation, are not included and must be added to these prices when the additional services are requested.

Illustrations, specifications, and prices are based on the latest information at the time of publication. The right is reserved to make changes at any time without notice in prices, fabrics, finishes, materials, specifications, and models, and also to discontinue models and finishes.

For additional product information such as dimensional drawings and product descriptions, refer to the standard price books.

Service problems are normally handled by a Herman Miller authorized dealer. Where this cannot be accomplished on a local level, service problems should be referred to the Customer Care Representative for your region, Herman Miller, Inc., Zeeland, Michigan 49464.

- Walls
- Work Surfaces
- Storage
- Lighting
- Work Organizers

Bare Frame

E1109.

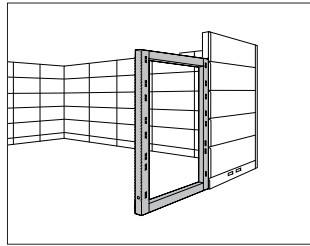

Specification Information

Step 1.

E1109.

Step 2. Height

30	30" high
38	38" high
46	46" high
54	54" high
62	62" high
70	70" high
86	86" high

Step 3. Width

24X	24" wide
30X	30" wide
36X	36" wide
42X	42" wide
48X	48" wide

Prices for Steps 1-3.

	24X	30X	36X	42X	48X
E1109. 30	\$172	181	191	208	235
38	\$198	218	226	241	250
46	\$214	235	245	249	253
54	\$237	253	271	279	299
62	\$250	267	284	295	310
70	\$273	293	302	314	335
86	\$300	322	335	347	368

Frame

E1109.

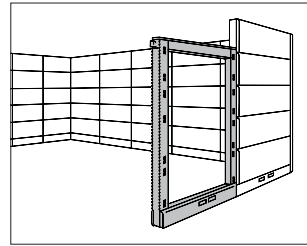

Specification Information

Step 1.

E1109.

Step 2. Height

30	30" high
38	38" high
46	46" high
54	54" high
62	62" high
70	70" high
86	86" high

Step 3. Width

24	24" wide
30	30" wide
36	36" wide
42	42" wide
48	48" wide

Step 4. Power

For 30" high (30) with 24" wide (24) or 30" wide (30)

- N** (N) nonpowered with no receptacle locations
- R** (R) nonpowered with 1 receptacle location per side (meets Chicago electrical code requirements)
- J** (J) nonpowered with 2 receptacle and 1 communication port locations per side
- G** (G) 4-circuit power with 2 receptacle and 1 communication port locations per side

For 38" high (38), 46" high (46), 54" high (54), 62" high (62), 70" high (70), or 86" high (86) with 24" wide (24) or 30" wide (30)

- N** (N) nonpowered with no receptacle locations
- R** (R) nonpowered with 1 receptacle location per side (meets Chicago electrical code requirements)
- J** (J) nonpowered with 2 receptacle and 1 communication port locations per side
- G** (G) 4-circuit power with 2 receptacle and 1 communication port locations per side

For 38" high (38), 46" high (46), 54" high (54), 62" high (62), 70" high (70), or 86" high (86) with 36" wide (36), 42" wide (42), or 48" wide (48)

N	(N) nonpowered with no receptacle locations
R	(R) nonpowered with 2 receptacle locations per side (meets Chicago electrical code requirements)
J	(J) nonpowered with 2 receptacle and 1 communication port locations per side
G	(G) 4-circuit power with 2 receptacle and 1 communication port locations per side

For 30" high (30) with 36" wide (36), 42" wide (42), or 48" wide (48)

N	(N) nonpowered with no receptacle locations
R	(R) nonpowered with 2 receptacle locations per side (meets Chicago electrical code requirements)
J	(J) nonpowered with 2 receptacle and 1 communication port locations per side
G	(G) 4-circuit power with 2 receptacle and 1 communication port locations per side

Prices for Steps 1-4.

	N	R	J	G
E1109. 30 24	\$327	337	337	493
30	\$370	379	379	532
36	\$411	420	420	573
42	\$452	460	460	617
48	\$493	500	500	656
38 24	\$356	361	362	518
30	\$396	403	403	562
36	\$437	446	446	601
42	\$479	488	488	643
48	\$518	527	527	683
46 24	\$383	391	392	547
30	\$426	433	433	589
36	\$467	473	473	631
42	\$507	515	515	670
48	\$547	556	556	712
54 24	\$410	417	418	572
30	\$451	457	457	615
36	\$493	500	500	656
42	\$532	541	541	697
48	\$572	581	581	737
62 24	\$436	444	444	600
30	\$471	484	486	641
36	\$518	527	527	683
42	\$562	568	568	722
48	\$600	607	607	763

70 24	\$464	470	470	626
30	\$504	511	511	667
36	\$545	554	554	710
42	\$586	594	594	749
48	\$626	635	635	788
86 24	\$516	525	525	681
30	\$559	566	566	720
36	\$599	605	605	762
42	\$640	647	647	802
48	\$681	687	687	843

Step 5. Top Cap Finish

NN	none	+\$0
BU	black umber	+\$14
HF	inner tone light	+\$14
LU	soft white	+\$14
MT	medium tone	+\$14
CN	metallic champagne	+\$19

Step 6. Cable Management Finish

BU	black umber	+\$0
HF	inner tone light	+\$0
HT	inner tone	+\$0
LU	soft white	+\$0
MT	medium tone	+\$0

Frame, Transaction Work Surface E1116.

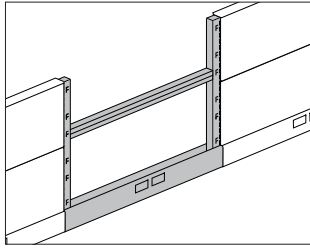

Specification Information

Step 1.

E1116.38

Step 2. Width

- 36** 36" wide
- 48** 48" wide
- 60** 60" wide

Step 3. Power

- N** (N) nonpowered with no receptacle locations
- J** (J) nonpowered with 2 to 4 receptacle and 1 to 2 communication port locations per side
- G** (G) 4-circuit power with 2 to 4 receptacle and 1 to 2 communication port locations per side

Prices for Steps 1-3.

		N	J	G
E1116.38	36	\$635	643	812
	48	\$713	720	878
	60	\$1108	1115	1271

Step 4. Cable Management Finish

- BU** black umber +\$0
- HF** inner tone light +\$0
- LU** soft white +\$0
- MT** medium tone +\$0

Stile Covers and Top Caps, Transaction Work Surface Frame E1117.

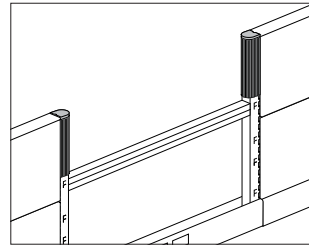

Specification Information

Step 1.

E1117.

Step 2. Type

- S** standard
- A** architectural

Prices for Steps 1-2.

E1117. S	\$102
A	\$102

Step 3. Finish

For standard (S)

8Q folkstone grey	+\$0
91 white	+\$0
BU black umber	+\$0
CL cool grey neutral	+\$0
HF inner tone light	+\$0
LU soft white	+\$0
MT medium tone	+\$0
SG slate grey	+\$0
WL sandstone	+\$0
WN warm grey neutral	+\$0

For architectural (A)

8Q folkstone grey	+\$0
91 white	+\$0
BU black umber	+\$0
CN metallic champagne	+\$0
EH metallic bronze	+\$0
HF inner tone light	+\$0
LU soft white	+\$0
MS metallic silver	+\$0
MT medium tone	+\$0
SG slate grey	+\$0
WL sandstone	+\$0

Side Cover

E1263.
E1264.

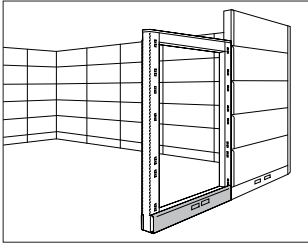

Ethospace® Walls

Specification Information

Step 1.

E126

Step 2. Base Type

- 3. plain base
- 4. grooved base

Step 3. Width

- 24** 24" wide
- 30** 30" wide
- 36** 36" wide
- 42** 42" wide
- 48** 48" wide

Step 4. Receptacle/Data Locations

For plain base (3.) with 24" wide (24) or 30" wide (30)

- N** (N) no receptacle locations
- J** (J) 2 receptacle and 1 communication port locations
- R** (R) 1 receptacle location (meets Chicago electrical code requirements)

For plain base (3.) with 36" wide (36), 42" wide (42), or 48" wide (48)

- N** (N) no receptacle locations
- J** (J) 2 receptacle and 1 communication port locations
- R** (R) 2 receptacle locations (meets Chicago electrical code requirements)

For grooved base (4.) with 24" wide (24) or 30" wide (30)

- N** (N) no receptacle locations
- R** (R) 1 receptacle location (meets Chicago electrical code requirements)

For grooved base (4.) with 36" wide (36), 42" wide (42), or 48" wide (48)

- N** (N) no receptacle locations
- R** (R) 2 receptacle locations (meets Chicago electrical code requirements)

Prices for Steps 1-4.

	N	J	R
E1263. 24	\$53	57	65
30	\$57	62	83
36	\$64	69	88
42	\$72	79	93
48	\$78	84	104

E1264. 24	\$55	—	68
30	\$59	—	86
36	\$67	—	91
42	\$74	—	96
48	\$80	—	108

Step 5. Surface Finish

For plain base (3.)

BU black umber	+\$0
HF inner tone light	+\$0
HT inner tone	+\$0
LU soft white	+\$0
MT medium tone	+\$0

For grooved base (4.)

BU black umber	+\$0
HF inner tone light	+\$0
LU soft white	+\$0
MT medium tone	+\$0

Stacking Frame

E1112.

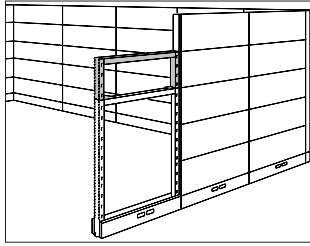

Specification Information

Step 1.

E1112.

Step 2. Width

24	24" wide
30	30" wide
36	36" wide
42	42" wide
48	48" wide

Prices for Steps 1-2.

E1112. 24	\$216
30	\$228
36	\$236
42	\$245
48	\$253

Draw Rod

E1120.

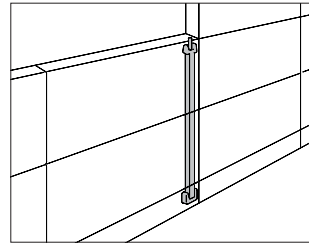

Specification Information

Step 1.

E1120.

Step 2. Height

30	30" high
38	38" high
46	46" high
54	54" high
62	62" high
70	70" high
86	86" high

Prices for Steps 1-2.

E1120. 30	\$26
38	\$26
46	\$27
54	\$27
62	\$31
70	\$32
86	\$33

Ethospace® Walls

Wall Strip

E1130.

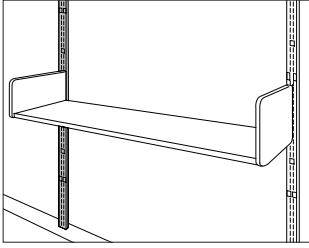

Tile Adapter

E1131.

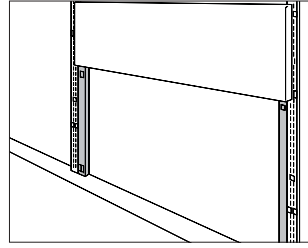

Ethospace® Walls

Specification Information

Step 1.
E1130.

Step 2. Height
64N 64" high
80N 80" high

Prices for Steps 1-2.

E1130. 64N	\$66
80N	\$72

Specification Information

Step 1.
E1131.

Step 2. Height
08 8" high
16 16" high

Prices for Steps 1-2.

E1131. 08	\$29
16	\$48

Wall Fastener

X1192.

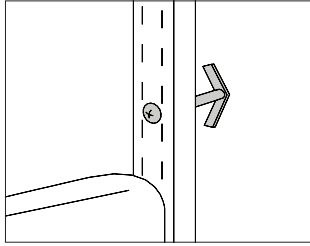

Specification Information

Step 1.

X1192.

Step 2. Size

- 1** no. 10, 1½" sheet metal screw
- 2** no. 10, 3" sheet metal screw
- 3** no. 10, 3" machine screw

Prices for Steps 1-2.

X1192. 1	\$30
2	\$30
3	\$51

Trim Strip

E1132.

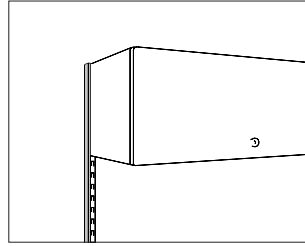

Specification Information

Step 1.

E1132.

Step 2. Height

- 64** 64" high
- 80** 80" high

Prices for Steps 1-2.

E1132. 64	\$73
80	\$89

Step 3. Surface Finish

BU	black umber	+\$0
HF	inner tone light	+\$0
LU	soft white	+\$0
MT	medium tone	+\$0

Wall Start

E1210.

Wall Start Filler

E1212.

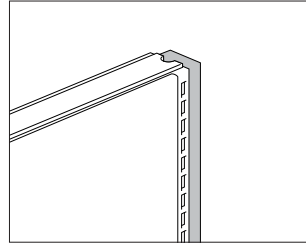
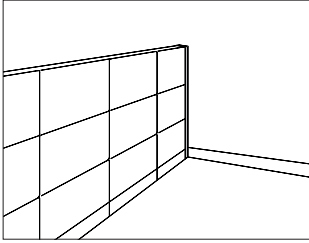

Ethospace® Walls

Specification Information

Step 1.

E1210.

Step 2. Height

- 30** 30" high
- 38** 38" high
- 46** 46" high
- 54** 54" high
- 62** 62" high
- 70** 70" high
- 86** 86" high

Prices for Steps 1-2.

E1210. 30	\$167
38	\$173
46	\$174
54	\$176
62	\$192
70	\$200
86	\$219

Step 3. Surface Finish

BU	black umber	+\$0
HF	inner tone light	+\$0
LU	soft white	+\$0
MT	medium tone	+\$0
CN	metallic champagne	+\$7

Specification Information

Step 1.

E1212.70

\$142

2-Way 90° Connector

E1220.

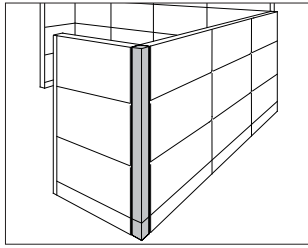

Specification Information

Step 1.

E1220.

Step 2. Height

30	30" high
38	38" high
46	46" high
54	54" high
62	62" high
70	70" high
86	86" high

Step 3. Surface Material

S	vinyl
F	fabric

Step 4. Shape

R	radius
S	square

Step 5. Power

N	(N) nonpowered
E	(E) powered

Prices for Steps 1-5.

	RN	RE	SN	SE
E1220. 30 S	\$215	254	226	262
F	\$207	242	212	249
38 S	\$235	273	244	282
F	\$218	254	231	264
46 S	\$251	290	261	298
F	\$237	273	249	286
54 S	\$267	308	282	319
F	\$252	289	263	301
62 S	\$283	322	294	329
F	\$263	301	280	316
70 S	\$294	332	309	347
F	\$275	312	289	325
86 S	\$329	371	348	383
F	\$311	348	325	361

Step 6. Surface Finish

For vinyl (S)

See application chart and textiles list for fabric usage and numbers. First 2 digits of number indicate fabric line; remaining digit(s) indicate fabric color.

Vinyl-Textured Surface

BU	black umber	+\$0
HF	inner tone light	+\$0
HT	inner tone	+\$0
LU	soft white	+\$0
MT	medium tone	+\$0

Step 7. Top Cap Finish

BU	black umber	+\$0
HF	inner tone light	+\$0
LU	soft white	+\$0
MT	medium tone	+\$0

Step 8. Cable Management Finish

BU	black umber	+\$0
HF	inner tone light	+\$0
HT	inner tone	+\$0
LU	soft white	+\$0
MT	medium tone	+\$0

Step 9. Surface Finish

For fabric (F)

See application chart and textiles list for fabric usage and numbers. First 2 digits of number indicate fabric line; remaining digit(s) indicate fabric color.

Price Category 1	+\$0
Price Category 2	+\$5
Price Category 3	+\$15
Price Category 4	+\$22

2-Way 90° Connector, Monolithic E1224.

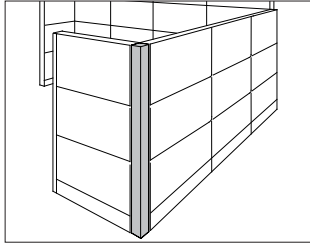

Spacer E1222.

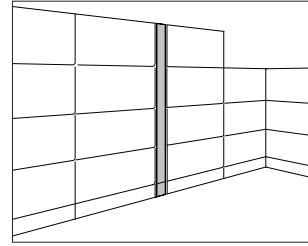

Ethospace® Walls

Specification Information

Step 1.
E1224.

Step 2. Height

30	30" high
38	38" high
46	46" high
54	54" high
62	62" high
70	70" high
86	86" high

Step 3. Surface Material

SS vinyl

Step 4. Power

N	(N) nonpowered
E	(E) powered

Prices for Steps 1-4.

	N	E
E1224. 30 SS	\$226	262
38 SS	\$244	282
46 SS	\$261	298
54 SS	\$282	319
62 SS	\$294	329
70 SS	\$309	347
86 SS	\$348	383

Step 5. Surface Finish

Vinyl-Textured Surface

BU	black umber	+\$0
HF	inner tone light	+\$0
LU	soft white	+\$0
MT	medium tone	+\$0

Step 6. Top Cap Finish

BU	black umber	+\$0
HF	inner tone light	+\$0
LU	soft white	+\$0
MT	medium tone	+\$0

Specification Information

Step 1.
E1222.

Step 2. Height

30	30" high
38	38" high
46	46" high
54	54" high
62	62" high
70	70" high
86	86" high

Step 3. Surface Material

S vinyl
F fabric

Step 4. Power

N	(N) nonpowered
E	(E) powered

Prices for Steps 1-4.

	N	E
E1222. 30 S	\$219	280
F	\$235	272
38 S	\$256	297
F	\$252	291
46 S	\$275	315
F	\$268	308
54 S	\$292	332
F	\$286	324
62 S	\$307	346
F	\$298	337
70 S	\$317	358
F	\$311	350
86 S	\$354	392
F	\$344	384

Step 5. Surface Finish Side 1		
<i>For vinyl (S)</i>		
BU	black umber	+\$0
HF	inner tone light	+\$0
HT	inner tone	+\$0
LU	soft white	+\$0
MT	medium tone	+\$0
SG	slate grey	+\$0
WL	sandstone	+\$0
WN	warm grey neutral	+\$0

Step 6. Surface Finish Side 2		
<i>For vinyl (S)</i>		
BU	black umber	+\$0
HF	inner tone light	+\$0
HT	inner tone	+\$0
LU	soft white	+\$0
MT	medium tone	+\$0

Step 7. Top Cap Finish		
<i>For vinyl (S) or fabric (F)</i>		
BU	black umber	+\$0
HF	inner tone light	+\$0
LU	soft white	+\$0
MT	medium tone	+\$0

Step 8. Cable Management Finish		
BU	black umber	+\$0
HF	inner tone light	+\$0
HT	inner tone	+\$0
LU	soft white	+\$0
MT	medium tone	+\$0

Step 9. Surface Finish Side 1		
<i>For fabric (F)</i>		
<i>See application chart and textiles list for fabric usage and numbers.</i>		
<i>First 2 digits of number indicate fabric line; remaining digit(s) indicate fabric color.</i>		
Price Category 1		+\$0
Price Category 2		+\$4
Price Category 3		+\$9
Price Category 4		+\$13

Step 10. Surface Finish Side 2		
<i>For fabric (F)</i>		
<i>See application chart and textiles list for fabric usage and numbers.</i>		
<i>First 2 digits of number indicate fabric line; remaining digit(s) indicate fabric color.</i>		
Price Category 1		+\$0
Price Category 2		+\$4
Price Category 3		+\$9
Price Category 4		+\$13

3-Way 90° Connector

E1230.

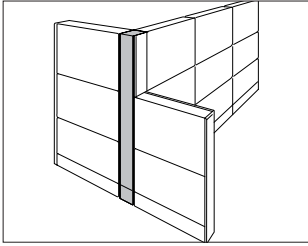

Ethospace® Walls

Specification Information

Step 1.
E1230.

Step 2. Height

30	30" high
38	38" high
46	46" high
54	54" high
62	62" high
70	70" high
86	86" high

Step 3. Surface Material

S	vinyl
F	fabric

Step 4. Power

N	(N) nonpowered
E	(E) powered

Prices for Steps 1-4.

	N	E
E1230. 30 S	\$286	322
F	\$292	327
38 S	\$309	344
F	\$315	350
46 S	\$328	365
F	\$334	371
54 S	\$350	386
F	\$354	390
62 S	\$372	409
F	\$377	413
70 S	\$393	428
F	\$397	433
86 S	\$438	473
F	\$444	478

Step 5. Surface Finish

For vinyl (S)

Vinyl-Textured Surface

BU	black umber	+\$0
HF	inner tone light	+\$0
HT	inner tone	+\$0
LU	soft white	+\$0
MT	medium tone	+\$0

Step 6. Top Cap Finish

BU	black umber	+\$0
HF	inner tone light	+\$0
LU	soft white	+\$0
MT	medium tone	+\$0

Step 7. Cable Management Finish

BU	black umber	+\$0
HF	inner tone light	+\$0
HT	inner tone	+\$0
LU	soft white	+\$0
MT	medium tone	+\$0

Step 8. Surface Finish

For fabric (F)

See application chart and textiles list for fabric usage and numbers.

First 2 digits of number indicate fabric line; remaining digit(s) indicate fabric color.

Price Category 1	+\$0
Price Category 2	+\$5
Price Category 3	+\$11
Price Category 4	+\$15

3-Way 90° Connector, Monolithic E1231.

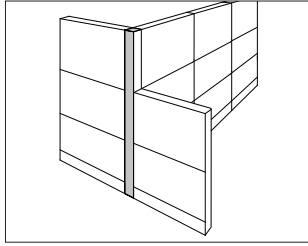

Specification Information

Step 1.

E1231.

Step 2. Height

30S	30" high
38S	38" high
46S	46" high
54S	54" high
62S	62" high
70S	70" high
86S	86" high

Step 3. Power

N	(N) nonpowered
E	(E) powered

Prices for Steps 1-3.

	N	E
E1231. 30S	\$306	340
38S	\$324	358
46S	\$348	382
54S	\$370	402
62S	\$393	427
70S	\$414	448
86S	\$454	497

Step 4. Surface Finish

Vinyl-Textured Surface

BU	black umber	+\$0
HF	inner tone light	+\$0
LU	soft white	+\$0
MT	medium tone	+\$0

Step 5. Top Cap Finish

BU	black umber	+\$0
HF	inner tone light	+\$0
LU	soft white	+\$0
MT	medium tone	+\$0

4-Way 90° Connector E1240.

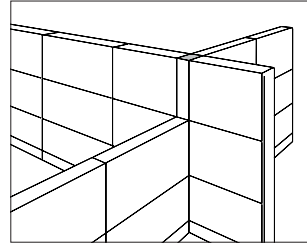

Specification Information

Step 1.

E1240.

Step 2. Height

30F	30" high
38F	38" high
46F	46" high
54F	54" high
62F	62" high
70F	70" high
86F	86" high

Step 3. Power

N	(N) nonpowered
E	(E) powered

Prices for Steps 1-3.

	N	E
E1240. 30F	\$313	360
38F	\$334	381
46F	\$355	404
54F	\$376	426
62F	\$395	445
70F	\$415	465
86F	\$461	515

Step 4. Top Cap Finish

NN	none	+\$0
BU	black umber	+\$0
HF	inner tone light	+\$0
LU	soft white	+\$0
MT	medium tone	+\$0

2-Way 90° Stacking Connector

E1220.

Spacer Stacking Connector

E1222.

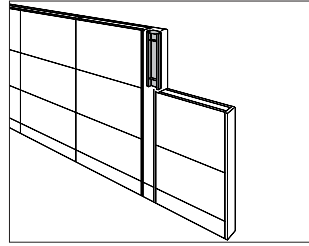
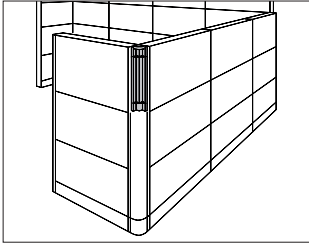

Ethospace® Walls

Specification Information

Step 1.
E1220.16

\$165

Specification Information

Step 1.
E1222.16

\$180

3-Way 90° Stacking Connector

E1230.

4-Way 90° Stacking Connector

E1240.

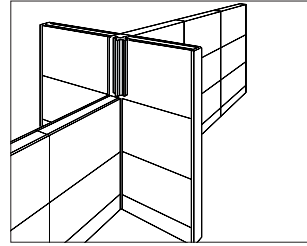
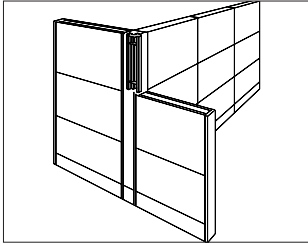

Specification Information

Step 1.

E1230.16

\$176

Specification Information

Step 1.

E1240.16

\$174

Ethospace® Walls

Stacking Frame Hardware Kit,
Change of Height

E1293.
E1294.

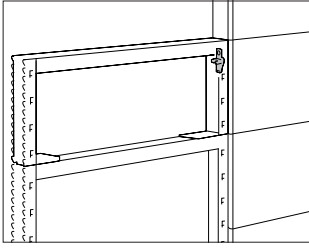

Bare Connector

E1219.

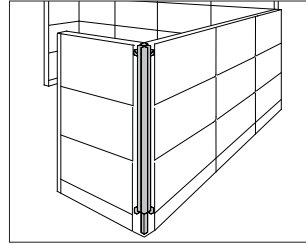

Ethospace® Walls

Specification Information

Step 1.

E129

Step 2. Connector Type

- 3. stacking frame to frame or 2-way 90° or 135° connector
- 4. stacking frame to spacer or 3- or 4-way 90° connector or 2-way 120° connector

Prices for Steps 1-2.

E1293.	\$22
E1294.	\$17

Specification Information

Step 1.

E1219.

Step 2. Height

30	30" high
38	38" high
46	46" high
54	54" high
62	62" high
70	70" high
86	86" high

Step 3. Configuration

- A** 2-way 90° connector with draw rod
- B** spacer
- C** 3-way 90° connector

Prices for Steps 1-3.

		A	B	C
E1219.	30	\$132	166	200
	38	\$144	176	206
	46	\$160	186	218
	54	\$173	197	235
	62	\$185	208	250
	70	\$198	217	266
	86	\$212	225	302

2-Way 90° Connector Cover

E1270.

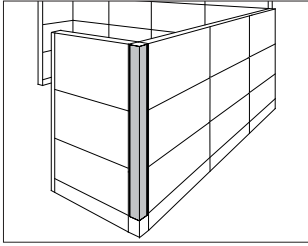

Specification Information

Step 1.

E1270.

Step 2. Height

30	30" high
38	38" high
46	46" high
54	54" high
62	62" high
70	70" high
86	86" high

Step 3. Surface Material

S	vinyl
F	fabric

Step 4. Shape

R	radius
S	square

Prices for Steps 1-4.

	R	S
E1270. 30 S	\$119	119
F	\$125	125
38 S	\$127	127
F	\$131	131
46 S	\$134	134
F	\$139	139
54 S	\$144	144
F	\$148	148
62 S	\$157	157
F	\$160	160
70 S	\$164	164
F	\$167	167
86 S	\$183	183
F	\$184	184

Step 5. Surface Finish

Vinyl-Textured Surface

For vinyl (S)

BU	black umber	+\$0
HF	inner tone light	+\$0
HT	inner tone	+\$0
LU	soft white	+\$0
MT	medium tone	+\$0

For fabric (F)

Price Category 1	+\$0
Price Category 2	+\$7
Price Category 3	+\$15
Price Category 4	+\$22

Ethospace® Walls

2-Way 90° Connector Cover,
Monolithic

E1274.

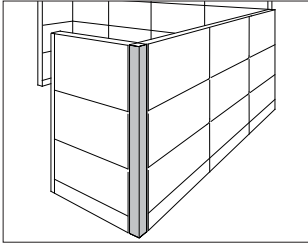

2-Way 90° Connector Cover,
Architectural

E1281.

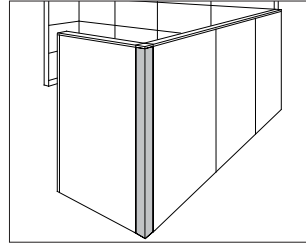

Ethospace® Walls

Specification Information

Step 1.

E1274.

Step 2. Height

30	30" high
38	38" high
46	46" high
54	54" high
62	62" high
70	70" high
86	86" high

Step 3. Surface Material

SS vinyl

Prices for Steps 1-3.

	SS
E1274. 30	\$128
38	\$134
46	\$143
54	\$157
62	\$166
70	\$175
86	\$193

Step 4. Surface Finish

Vinyl-Textured Surface

BU	black umber	+\$0
HF	inner tone light	+\$0
LU	soft white	+\$0
MT	medium tone	+\$0

Specification Information

Step 1.

E1281.

Step 2. Height

30	30" high
38	38" high
46	46" high
54	54" high
62	62" high
70	70" high
86	86" high

Step 3. Surface Material

P painted
F fabric

Prices for Steps 1-3.

	P	F
E1281. 30	\$171	209
38	\$184	229
46	\$192	251
54	\$205	270
62	\$220	298
70	\$234	320
86	\$248	354

Step 4. Surface Finish

For painted (P)

BU	black umber	+\$0
HF	inner tone light	+\$0
LU	soft white	+\$0
MT	medium tone	+\$0
CN	metallic champagne	+\$15

For fabric (F)

Price Category 1	+\$0
Price Category 2	+\$7
Price Category 3	+\$15
Price Category 4	+\$22

Spacer Connector Cover

E1271.

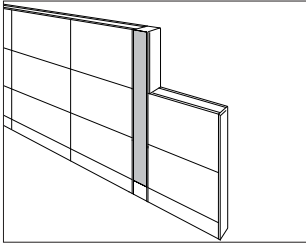

Specification Information

Step 1.

E1271.

Step 2. Height

30	30" high
38	38" high
46	46" high
54	54" high
62	62" high
70	70" high
86	86" high

Step 3. Surface Material

S	vinyl
F	fabric

Prices for Steps 1-3.

	S	F
E1271. 30	\$156	168
38	\$172	176
46	\$183	185
54	\$190	193
62	\$200	203
70	\$208	211
86	\$228	231

Step 4. Surface Finish Side 1

For vinyl (S)

Vinyl-Textured Surface

BU	black umber	+\$0
HF	inner tone light	+\$0
HT	inner tone	+\$0
LU	soft white	+\$0
MT	medium tone	+\$0

Step 5. Surface Finish Side 2

For vinyl (S)

Vinyl-Textured Surface

BU	black umber	+\$0
HF	inner tone light	+\$0
HT	inner tone	+\$0
LU	soft white	+\$0
MT	medium tone	+\$0

Step 6. Surface Finish Side 1

For fabric (F)

See application chart and textiles list for fabric usage and numbers. First 2 digits of number indicate fabric line; remaining digit(s) indicate fabric color.

Price Category 1	+\$0
Price Category 2	+\$5
Price Category 3	+\$11
Price Category 4	+\$15

Step 7. Surface Finish Side 2

For fabric (F)

See application chart and textiles list for fabric usage and numbers. First 2 digits of number indicate fabric line; remaining digit(s) indicate fabric color.

Price Category 1	+\$0
Price Category 2	+\$5
Price Category 3	+\$11
Price Category 4	+\$15

Spacer Connector Cover,
Monolithic

E1275.

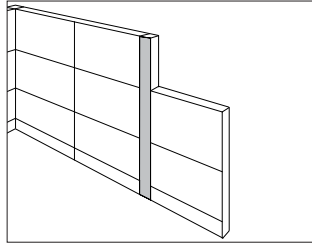

Spacer/3-Way 90° Connector
Cover, Architectural

E1282.

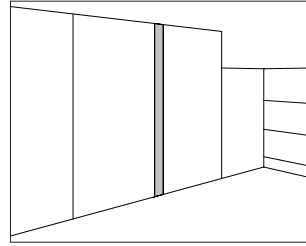

Ethospace® Walls

Specification Information

Step 1.

E1275.

Step 2. Height

30S	30" high
38S	38" high
46S	46" high
54S	54" high
62S	62" high
70S	70" high
86S	86" high

Prices for Steps 1-2.

E1275. 30S	\$183
38S	\$191
46S	\$203
54S	\$212
62S	\$221
70S	\$231
86S	\$252

Step 3. Surface Finish Side 1

BU	black umber	+\$0
HF	inner tone light	+\$0
LU	soft white	+\$0
MT	medium tone	+\$0

Step 4. Surface Finish Side 2

BU	black umber	+\$0
HF	inner tone light	+\$0
LU	soft white	+\$0
MT	medium tone	+\$0

Specification Information

Step 1.

E1282.

Step 2. Height

30	30" high
38	38" high
46	46" high
54	54" high
62	62" high
70	70" high
86	86" high

Step 3. Surface Material

P	Painted
F	fabric

Prices for Steps 1-3.

		P	F
E1282. 30		\$189	236
38		\$201	247
46		\$211	262
54		\$220	273
62		\$233	296
70		\$243	300
86		\$263	327

Step 4. Surface Finish

For painted (P)

BU	black umber	+\$0
HF	inner tone light	+\$0
LU	soft white	+\$0
MT	medium tone	+\$0
CN	metallic champagne	+\$10

For fabric (F)

Price Category 1	+\$0
Price Category 2	+\$5
Price Category 3	+\$11
Price Category 4	+\$15

3-Way 90° Connector Cover

E1272.

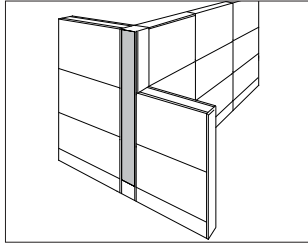

Specification Information

Step 1.

E1272.

Step 2. Height

30	30" high
38	38" high
46	46" high
54	54" high
62	62" high
70	70" high
86	86" high

Step 3. Surface Material

S	vinyl
F	fabric

Prices for Steps 1-3.

	S	F
E1272. 30	\$115	131
38	\$122	135
46	\$128	142
54	\$133	148
62	\$139	157
70	\$144	163
86	\$160	174

Step 4. Surface Finish

Vinyl-Textured Surface

For vinyl (S)

BU	black umber	+\$0
HF	inner tone light	+\$0
HT	inner tone	+\$0
LU	soft white	+\$0
MT	medium tone	+\$0

For fabric (F)

Price Category 1	+\$0
Price Category 2	+\$5
Price Category 3	+\$11
Price Category 4	+\$15

3-Way 90° Connector Cover,
Monolithic

E1276.

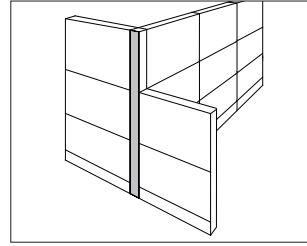

Specification Information

Step 1.

E1276.

Step 2. Height

30S	30" high
38S	38" high
46S	46" high
54S	54" high
62S	62" high
70S	70" high
86S	86" high

Prices for Steps 1-2.

E1276. 30S	\$127
38S	\$132
46S	\$140
54S	\$145
62S	\$157
70S	\$162
86S	\$174

Step 3. Surface Finish

Vinyl-Textured Surface

BU	black umber	+\$0
HF	inner tone light	+\$0
LU	soft white	+\$0
MT	medium tone	+\$0

Finished End

E1250.

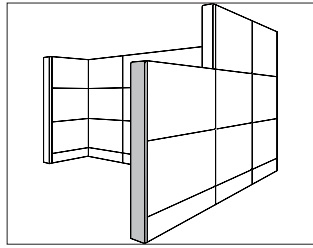

Finished End, Change of Height

E1251.

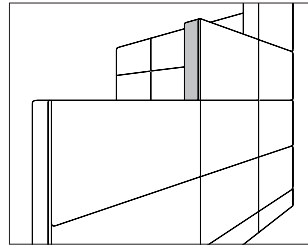

Ethospace® Walls

Specification Information

Step 1.

E1250.

Step 2. Height

30	30" high
38	38" high
46	46" high
54	54" high
62	62" high
70	70" high
86	86" high

Step 3. Shape

S	standard
A	paint architectural

Prices for Steps 1-3.

	S	A
E1250. 30	\$72	97
38	\$75	100
46	\$77	106
54	\$81	113
62	\$85	126
70	\$88	139
86	\$99	156

Step 4. Surface Finish

BU	black umber	+\$0
HF	inner tone light	+\$0
LU	soft white	+\$0
MT	medium tone	+\$0
CN	metallic champagne	+\$7

Specification Information

Step 1.

E1251.

Step 2. Height

08	8" high
16	16" high
24	24" high
32	32" high

Step 3. Shape

S	standard
A	paint architectural

Prices for Steps 1-3.

	S	A
E1251. 08	\$55	73
16	\$59	86
24	\$66	99
32	\$72	106

Step 4. Surface Finish

BU	black umber	+\$0
HF	inner tone light	+\$0
LU	soft white	+\$0
MT	medium tone	+\$0
CN	metallic champagne	+\$7

Frame Top Cap

E1260.

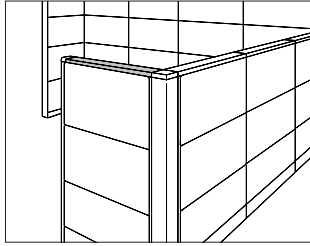

Specification Information

Step 1.

E1260.

Step 2. Width

24	24" wide
30	30" wide
36	36" wide
42	42" wide
48	48" wide

Step 3. Shape

S	standard
A	painting architectural

Prices for Steps 1-3.

	S	A
E1260. 24	\$24	68
30	\$25	78
36	\$26	94
42	\$28	102
48	\$30	114

Step 4. Surface Finish

For standard (S) or painting architectural (A)

BU	black umber	+\$0
HF	inner tone light	+\$0
LU	soft white	+\$0
MT	medium tone	+\$0
CN	metallic champagne	+\$5

Connector Top Cap

E1261.

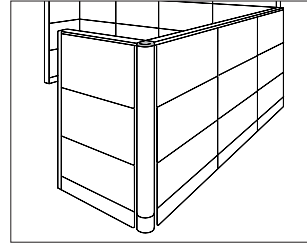

Specification Information

Step 1.

E1261.

Step 2. Configuration

1	spacer
2	2-way 90° radius-shaped connector
5	2-way 90° square-shaped connector
3	3-way 90° connector
4	4-way 90° connector

Step 3. Shape

For spacer (1), 2-way 90° radius-shaped connector (2), 3-way 90° connector (3), or 4-way 90° connector (4)

S	standard
A	painting architectural

For 2-way 90° square-shaped connector (5)

S	standard
A	painting architectural

Prices for Steps 1-3.

	S	A
E1261. 1	\$34	74
2	\$34	74
5	\$34	74
3	\$34	74
4	\$34	74

Step 4. Surface Finish

For standard (S)

BU	black umber	+\$0
HF	inner tone light	+\$0
LU	soft white	+\$0
MT	medium tone	+\$0

For painting architectural (A)

BU	black umber	+\$0
HF	inner tone light	+\$0
LU	soft white	+\$0
MT	medium tone	+\$0
CN	metallic champagne	+\$5

Power Entry, External Direct
Connect, 4 Circuit

E1322.

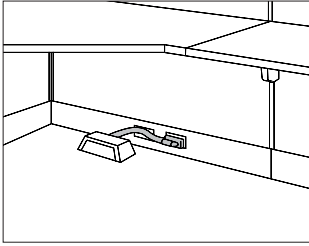

Power Entry, Internal Direct
Connect, 4 Circuit

E1325.

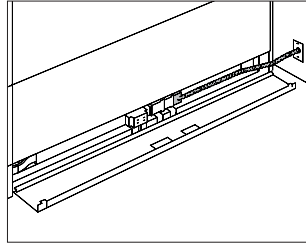

Ethospace® Walls

Specification Information

Step 1.

E1322.

Step 2. Length

06E 6' long

24E 24' long

Prices for Steps 1-2.

E1322. 06E	\$177
24E	\$366

Specification Information

Step 1.

E1325.6E

\$195

Base Power Entry, Junction Box, 4 Circuit E1323.

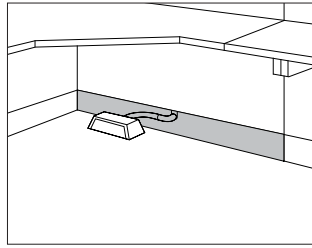

Specification Information

Step 1.

E132

Step 2. Base Option

3. plain base

Step 3. Width

- 24E** 24" wide
- 30E** 30" wide
- 36E** 36" wide
- 42E** 42" wide
- 48E** 48" wide

Prices for Steps 1-3.

E1323. 24E	\$361
30E	\$377
36E	\$389
42E	\$418
48E	\$444

Step 4. Surface Finish

BU black umber	+ \$0
HF inner tone light	+ \$0
HT inner tone	+ \$0
LU soft white	+ \$0
MT medium tone	+ \$0

Ceiling Power Entry, Internal Direct Connect E1331.

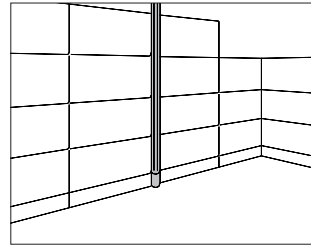

Specification Information

Step 1.

E1331.

Step 2. Height

- 46** 46" high
- 54** 54" high
- 62** 62" high
- 70** 70" high
- 86** 86" high

Step 3. Attachment

C connector- or frame-attached

Step 4. Power

- N** (N) nonpowered
- E** (E) 4-circuit power

Prices for Steps 1-4.

	N	E
E1331. 46 C	\$535	850
54 C	\$565	878
62 C	\$589	903
70 C	\$610	922
86 C	\$657	970

Step 5. Surface Finish

BU black umber	+ \$0
HF inner tone light	+ \$0
LU soft white	+ \$0
MT medium tone	+ \$0

Step 6. Cable Management Finish

BU black umber	+ \$0
HF inner tone light	+ \$0
HT inner tone	+ \$0
LU soft white	+ \$0
MT medium tone	+ \$0

Baseline Harness, 4 Circuit

E1354.
E1355.

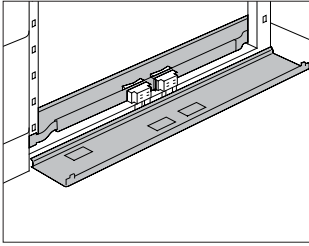

Pass-Through Harness, Frame

E1342.

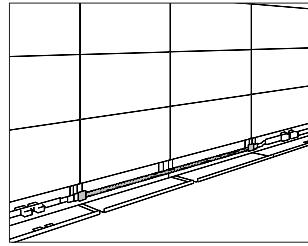

Ethospace® Walls

Specification Information

Step 1.

E135

Step 2. Side Covers

- 4. no side covers
- 5. side covers

Step 3. Frame Width

- 24 24" wide
- 30 30" wide
- 36 36" wide
- 42 42" wide
- 48 48" wide

Step 4. Power Connection

E standard

Prices for Steps 1-4.

	E
E1354. 24	\$134
30	\$141
36	\$147
42	\$158
48	\$164

E1355. 24	\$233
30	\$233
36	\$233
42	\$240
48	\$240

Step 5. Cable Management Finish

For side covers (5.)

BU black umber	+\$0
HF inner tone light	+\$0
HT inner tone	+\$0
LU soft white	+\$0
MT medium tone	+\$0

Specification Information

Step 1.

E1342.

Step 2. Length

- 24E** 24" long
- 30E** 30" long
- 36E** 36" long
- 42E** 42" long
- 48E** 48" long

Prices for Steps 1-2.

E1342. 24E	\$138
30E	\$144
36E	\$153
42E	\$162
48E	\$169

Pass-Through Harness,
Connector

E1356.

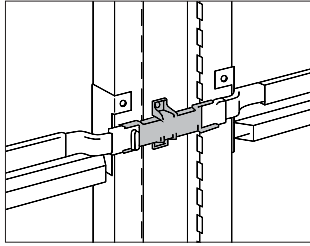

Specification Information

Step 1.

E1356.

Step 2. Configuration

- AE** 2-way 90° connector
- BE** spacer
- CE** 3-way 90° connector
- DE** 4-way 90° connector

Prices for Steps 1-2.

E1356. AE	\$198
BE	\$207
CE	\$212
DE	\$218

Beltline Harness, 4 Circuit

E1353.

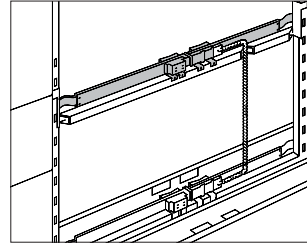

Specification Information

Step 1.

E1353.

Step 2. Frame Width

- 24** 24"-wide frame
- 30** 30"-wide frame
- 36** 36"-wide frame
- 42** 42"-wide frame
- 48** 48"-wide frame

Step 3. Power Connection

- E** standard

Prices for Steps 1-3.

	E
E1353. 24	\$198
30	\$207
36	\$211
42	\$217
48	\$222

Tile-Height Harness, 4 Circuit

E1357.

Power Jumper, 4 Circuit

E1341.

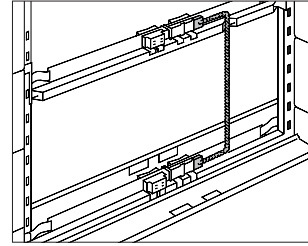
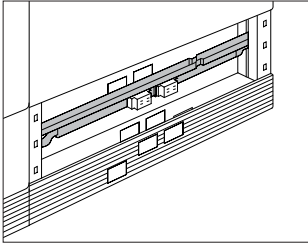

Ethospace® Walls

Specification Information

Step 1.

E1357.

Step 2. Frame Width

- 24E** 24"-wide frame
- 30E** 30"-wide frame
- 36E** 36"-wide frame
- 42E** 42"-wide frame
- 48E** 48"-wide frame

Prices for Steps 1-2.

E1357. 24E	\$198
30E	\$207
36E	\$211
42E	\$217
48E	\$222

Specification Information

Step 1.

E1341.

Step 2. Configuration

- 3E** 4th 8" tile above base
- 5E** 6th 8" tile above base

Prices for Steps 1-2.

E1341. 3E	\$111
5E	\$133

Baseline Box Assembly, H-Style
Frame

EW400.

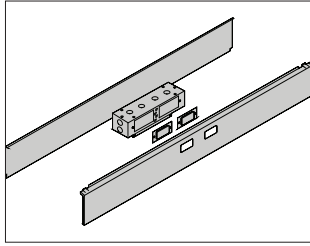

Specification Information

Step 1.

EW400.

Step 2. Width

24	24" wide
30	30" wide
36	36" wide
42	42" wide
48	48" wide

Prices for Steps 1-2.

EW400. 24	\$235
30	\$243
36	\$252
42	\$262
48	\$283

Step 3. Bezel Finish

BU	black umber	+\$0
HF	inner tone light	+\$0
LU	soft white	+\$0
MT	medium tone	+\$0

Receptacle, 4 Circuit, 15 Amp

E1311.

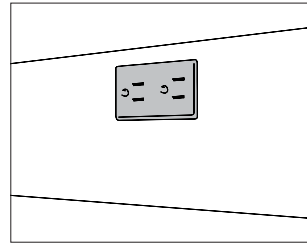

Specification Information

Step 1.

E1311.

Step 2. Type

A	duplex, circuit a
B	duplex, circuit b
C	duplex, circuit c
DN	duplex, circuit d
BI	duplex, circuit b, isolated ground
CI	duplex, circuit c, isolated ground
D	duplex, circuit d, isolated ground
CS	duplex, 3 circuit, circuit c, isolated ground

Prices for Steps 1-2.

E1311. A	\$200
B	\$200
C	\$200
DN	\$200
BI	\$200
CI	\$200
D	\$200
CS	\$200

Step 3. Surface Finish

BU	black umber	+\$0
HF	inner tone light	+\$0
HT	inner tone	+\$0
LU	soft white	+\$0
MT	medium tone	+\$0

Connect™-S300

Y1323.

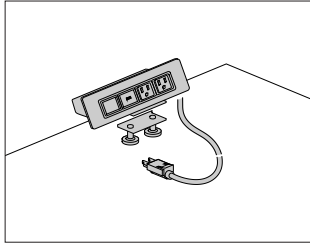

Work Surface-Attached Electrical Distributor

Y1314.

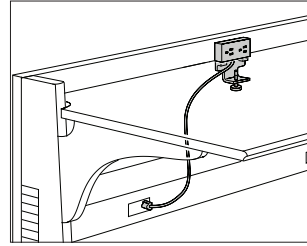

Ethospace® Walls

Specification Information

Step 1.

Y1323.

Step 2. Configuration

- 3** 2 simplex receptacles, 2 data openings
- 4** 3 simplex receptacles, 3 data openings

Step 3. Power Type

- A** power cord with plug end
- B** conduit with open end, for hard-wiring

Step 4. Cord/Conduit Length

- 03** 3' cord/conduit
- 06** 6' cord/conduit
- 10** 10' cord/conduit
- 20** 20' cord/conduit

Step 5. Attachment

- G** grommet mount
- S** surface clamp

Prices for Steps 1-5.

		03G	03S	06G	06S	10G	10S		
Y1323. 3	A	\$264	264	264	264	273	273		
	B	\$314	314	314	314	323	323		
4	A	\$329	329	329	329	338	338		
	B	\$380	380	380	380	390	390		
								20G	20S
Y1323. 3	A					\$319	319		
	B					\$368	368		
4	A					\$385	385		
	B					\$435	435		

Step 6. Finish

- 0H** black +\$0
- 0I** silver +\$0
- 0J** white +\$0

Specification Information

Step 1.

Y1314.

\$216

Cable Manager, Extra Capacity

E1396.

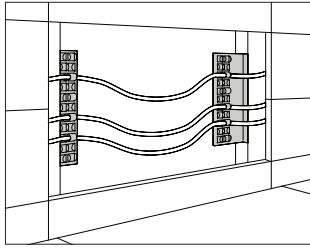

Specification Information

Step 1.

E1396.

\$77

Communication Port Faceplate Reducer

G1189.

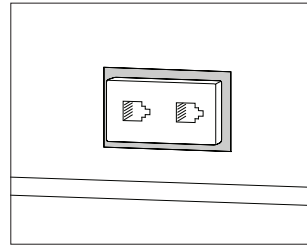

Specification Information

Step 1.

G1189.A

\$47

Ethospace® Walls

Communication Port Faceplate
Extender

G1189.

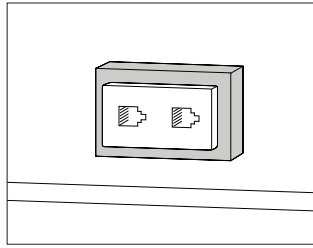

Beltline Bezel, H-Style Frame

G1510.

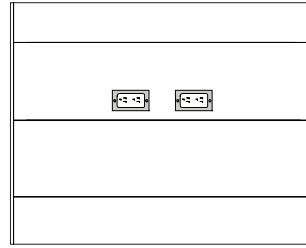

Ethospace® Walls

Specification Information

Step 1.

G1189.B \$60

Step 2. Surface Finish

8Q	folkstone grey	+\$0
BU	black umber	+\$0
CL	cool grey neutral	+\$0
HF	inner tone light	+\$0
MT	medium tone	+\$0
WL	sandstone	+\$0
WN	warm grey neutral	+\$0

Specification Information

Step 1.

G1510. \$47

Step 2. Surface Finish

BU	black umber	+\$0
HF	inner tone light	+\$0
LU	soft white	+\$0
MT	medium tone	+\$0

Face Tile

E1420.

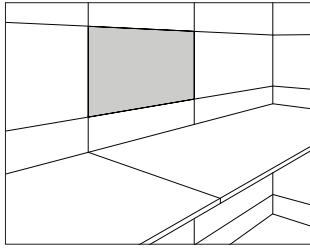

Specification Information

Step 1.

E1420.

Step 2. Height

- 08** 8" high
- 16** 16" high
- 24** 24" high

Step 3. Width

- 24** 24" wide
- 30** 30" wide
- 36** 36" wide
- 42** 42" wide
- 48** 48" wide

Step 4. Surface Material

For 8" high (08) with 24" wide (24), 30" wide (30), 36" wide (36), 42" wide (42), or 48" wide (48)

- P** painted
- F** fabric

For 16" high (16)

- P** painted
- F** fabric

For 24" high (24)

- P** painted
- F** fabric

Prices for Steps 1-4.

	P	F
E1420. 08 24	\$48	64
30	\$51	68
36	\$56	78
42	\$63	89
48	\$66	96
16 24	\$53	86
30	\$57	91
36	\$61	101
42	\$70	108
48	\$74	117

24 24	\$85	105
30	\$91	113
36	\$98	127
42	\$106	134
48	\$117	146

Step 5. Surface Finish

For painted (P)

	08	16	24
BU black umber	+\$0	0	0
HF inner tone light	+\$0	0	0
LU soft white	+\$0	0	0
MT medium tone	+\$0	0	0
CN metallic champagne	+\$5	10	15

For fabric (F)

	08	16	24
Price Category 1	+\$0	0	0
Price Category 2	+\$4	13	19
Price Category 3	+\$8	22	33
Price Category 4	+\$13	33	51

Ethospace® Walls

Floor-Length Face Tile

E1420.

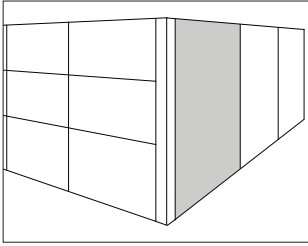

Ethospace® Walls

Specification Information

Step 1.

E1420.

Step 2. Height

22 22" high

30 30" high

Step 3. Width

24 24" wide

30 30" wide

36 36" wide

42 42" wide

48 48" wide

Step 4. Surface Material

P painted

F fabric

Prices for Steps 1-4.

	P	F
E1420. 22 24	\$97	106
30	\$104	113
36	\$111	124
42	\$116	131
48	\$131	144
30 24	\$102	111
30	\$113	128
36	\$127	138
42	\$137	150
48	\$147	165

Step 5. Surface Finish

See application chart and textiles list for fabric usage and numbers. First 2 digits of number indicate fabric line; remaining digit(s) indicate fabric color.

For 22" high (22) with painted (P)

BU	black umber	+\$0
HF	inner tone light	+\$0
LU	soft white	+\$0
MT	medium tone	+\$0
CN	metallic champagne	+\$15

For 30" high (30) with painted (P)

BU	black umber	+\$0
HF	inner tone light	+\$0
LU	soft white	+\$0
MT	medium tone	+\$0

For fabric (F)

	22	30
Price Category 1	+\$0	0
Price Category 2	+\$13	19
Price Category 3	+\$22	33
Price Category 4	+\$33	51

Architectural Cladding, Fabric

E1445.

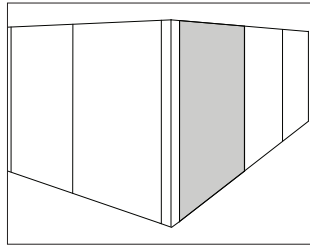

Specification Information

Step 1.

E1445.

Step 2. Height

16	16" high
24	24" high
30	30" high
32	32" high

Step 3. Width

24F	24" wide
30F	30" wide
36F	36" wide
42F	42" wide
48F	48" wide

Prices for Steps 1-3.

	24F	30F	36F	42F	48F
E1445. 16	\$151	160	167	175	182
24	\$182	192	205	213	226
30	\$207	222	232	244	257
32	\$224	239	251	261	279

Step 4. Surface Finish

See application chart and textiles list for fabric usage and numbers.
First 2 digits of number indicate fabric line; remaining digit(s) indicate fabric color.

	16	24	30	32
Price Category 1	+\$0	0	0	0
Price Category 2	+\$13	19	19	25
Price Category 3	+\$22	33	33	44
Price Category 4	+\$33	51	51	66

Acoustical Tile

E1423.

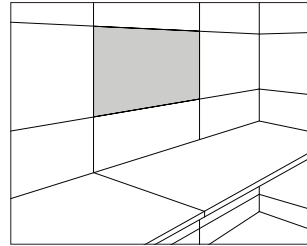

Specification Information

Step 1.

E142

Step 2. Acoustical Rating

3.16 .65 NRC, 20 STC

Step 3. Width

24	24" wide
30	30" wide
36	36" wide
42	42" wide
48	48" wide

Prices for Steps 1-3.

E1423.16 24	\$95
30	\$105
36	\$119
42	\$136
48	\$145

Step 4. Surface Finish

See application chart and textiles list for fabric usage and numbers.
First 2 digits of number indicate fabric line; remaining digit(s) indicate fabric color.

Price Category 1	+\$0
Price Category 2	+\$13
Price Category 3	+\$22
Price Category 4	+\$33

Tackable Tile

E1422.

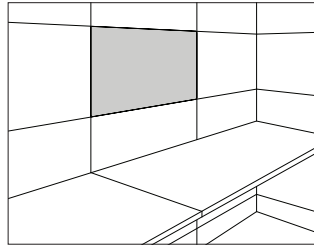

Specification Information

Step 1.

E1422.16

Step 2. Width

24	24" wide
30	30" wide
36	36" wide
42	42" wide
48	48" wide

Prices for Steps 1-2.

E1422.16	24	\$106
	30	\$117
	36	\$132
	42	\$150
	48	\$164

Step 3. Surface Finish

See application chart and textiles list for fabric usage and numbers. First 2 digits of number indicate fabric line; remaining digit(s) indicate fabric color.

Price Category 1	+\$0
Price Category 2	+\$13
Price Category 3	+\$22
Price Category 4	+\$33

Cable Access Tile

E1436.

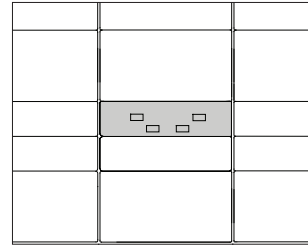

Specification Information

Step 1.

E1436.08

Step 2. Width

24	24" wide
30	30" wide
36	36" wide
42	42" wide
48	48" wide

Step 3. Surface Material

P	Painted
F	Fabric

Prices for Steps 1-3.

		P	F
E1436.08	24	\$98	114
	30	\$117	134
	36	\$123	142
	42	\$130	154
	48	\$135	161

Step 4. Receptacle Filler Finish

BU	black umber	+\$0
HF	inner tone light	+\$0
HT	inner tone	+\$0
LU	soft white	+\$0
MT	medium tone	+\$0

Step 5. Surface Finish

See application chart and textiles list for fabric usage and numbers. First 2 digits of number indicate fabric line; remaining digit(s) indicate fabric color.

For painted (P)

BU	black umber	+\$0
HF	inner tone light	+\$0
LU	soft white	+\$0
MT	medium tone	+\$0
CN	metallic champagne	+\$5

For fabric (F)

Price Category 1	+\$0
Price Category 2	+\$4
Price Category 3	+\$9
Price Category 4	+\$15

Cable Channel Tile

E1433.

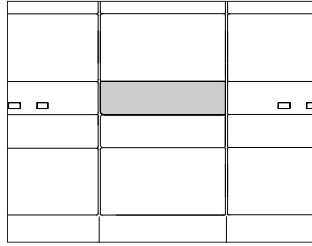

Specification Information

Step 1.

E1433.08

Step 2. Width

- 24** 24" wide
- 30** 30" wide
- 36** 36" wide
- 42** 42" wide
- 48** 48" wide

Step 3. Surface Material

- P** painted
- F** fabric

Prices for Steps 1-3.

		P	F
E1433.08	24	\$92	105
	30	\$107	130
	36	\$115	135
	42	\$126	147
	48	\$131	159

Step 4. Surface Finish

See application chart and textiles list for fabric usage and numbers. First 2 digits of number indicate fabric line; remaining digit(s) indicate fabric color.

For painted (P)

BU	black umber	+\$0
HF	inner tone light	+\$0
LU	soft white	+\$0
MT	medium tone	+\$0
CN	metallic champagne	+\$5

For fabric (F)

Price Category 1	+\$0
Price Category 2	+\$4
Price Category 3	+\$9
Price Category 4	+\$15

Open Tile

E1440.

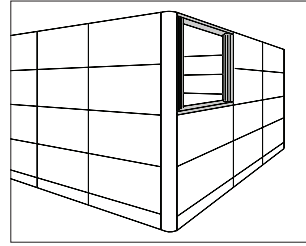

Specification Information

Step 1.

E1440.

Step 2. Height

- 16** 16" high

Step 3. Width

- 24** 24" wide
- 30** 30" wide
- 36** 36" wide
- 42** 42" wide
- 48** 48" wide

Step 4. Tile Position

- T** top
- M** middle/bottom

Prices for Steps 1-4.

		T	M
E1440. 16	24	\$200	160
	30	\$234	189
	36	\$260	208
	42	\$281	226
	48	\$305	245

Step 5. Frame Finish

BU	black umber	+\$0
HF	inner tone light	+\$0
LU	soft white	+\$0
MT	medium tone	+\$0

Open Tile, Squared Stile

E1444.

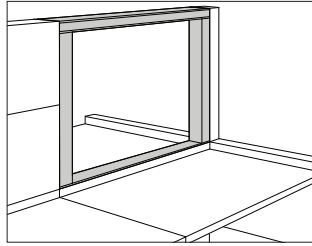

Perforated Tile, Squares

E1441.

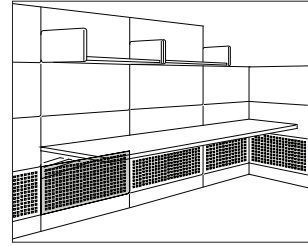

Ethospace® Walls

Specification Information

Step 1.

E1444.

Step 2. Height

- 16** 16" high
- 32** 32" high
- 48** 48" high

Step 3. Width

- 24** 24" wide
- 30** 30" wide
- 36** 36" wide
- 42** 42" wide
- 48** 48" wide

Step 4. Tile Position

- T** top
- M** middle/bottom

Prices for Steps 1-4.

		T	M
E1444. 16	24	\$204	151
	30	\$238	178
	36	\$264	195
	42	\$286	213
	48	\$311	230
32	24	\$273	205
	30	\$312	232
	36	\$344	257
	42	\$374	280
	48	\$407	307
48	24	\$347	260
	30	\$378	283
	36	\$414	311
	42	\$450	335
	48	\$484	361

Step 5. Frame Finish

- BU** black umber +\$0
- HF** inner tone light +\$0
- LU** soft white +\$0
- MT** medium tone +\$0

Specification Information

Step 1.

E1441.

Step 2. Height

- 16** 16" high

Step 3. Width

- 24P** 24" wide
- 30P** 30" wide
- 36P** 36" wide
- 42P** 42" wide
- 48P** 48" wide

Prices for Steps 1-3.

	24P	30P	36P	42P	48P
E1441. 16	\$67	73	85	91	98

Step 4. Surface Finish

- BU** black umber +\$0
- HF** inner tone light +\$0
- LU** soft white +\$0
- MT** medium tone +\$0
- CN** metallic champagne +\$10

Rail Tile

E1425.

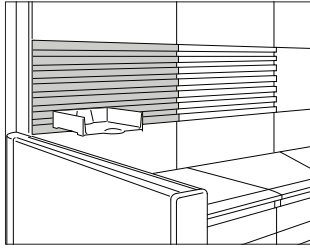

Specification Information

Step 1.

E1425.

Step 2. Height

16 16" high

Step 3. Width

24 24" wide

30 30" wide

36 36" wide

42 42" wide

48 48" wide

Prices for Steps 1-3.

	24	30	36	42	48
E1425. 16	\$175	194	212	234	251

Step 4. Surface Finish

BU black umber +\$0

HF inner tone light +\$0

LU soft white +\$0

MT medium tone +\$0

CN metallic champagne +\$15

Marker/Eraser Holder

Y7231.

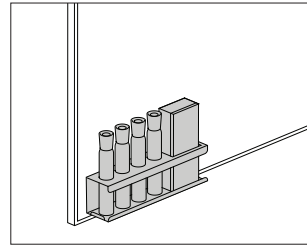

Specification Information

Step 1.

Y7231.

\$124

Step 2. Finish

91 white +\$0

BK black +\$0

MS metallic silver +\$0

Rectangular Surface

EWS10.

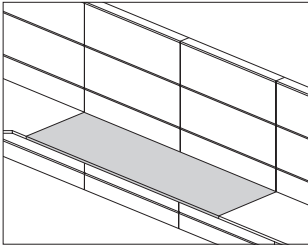

Ethospace® Work Surfaces

Specification Information

Step 1.

EW

Step 2. Edge

S10. squared-edge

Step 3. Depth

24 24" deep

30 30" deep

Step 4. Width

24 24" wide

30 30" wide

36 36" wide

42 42" wide

48 48" wide

60 60" wide

66 66" wide

72 72" wide

Step 5. Surface Material

L laminate top/thermoplastic edge

Step 6. Attachment

For 24" deep (24) or 30" deep (30) with 24" wide (24), 30" wide (30), 66" wide (66), or 72" wide (72)

F Ethospace® frame attached surface

For 24" deep (24) or 30" deep (30) with 36" wide (36), 42" wide (42), 48" wide (48), or 60" wide (60)

D surface attachment bracket

F Ethospace® frame attached surface

Prices for Steps 1-6.

	LD	LF
EWS10.24 24	—	\$158
30	—	\$180
36	\$246	205
42	\$269	229
48	\$295	253
60	\$380	338
66	—	\$380
72	—	\$422

30 24	—	\$172
30	—	\$221
36	\$299	257
42	\$334	294
48	\$372	330
60	\$479	438
66	—	\$497
72	—	\$554

Step 7. Top Finish

76	light brown walnut	+\$0
8Q	folkstone grey	+\$0
91	white	+\$0
98	studio white	+\$0
CL	cool grey neutral	+\$0
HF	inner tone light	+\$0
HM	natural maple	+\$0
HP	light anigre	+\$0
HT	inner tone	+\$0
HX	aged cherry	+\$0
HY	walnut on cherry	+\$0
LA	light ash	+\$0
LBA	clear on ash	+\$0
LBB	oak on ash	+\$0
LBC	walnut on ash	+\$0
LBD	dark brown walnut	+\$0
LBE	medium red walnut	+\$0
LBF	neutral twill	+\$0
LBG	sarum twill	+\$0
LBH	earthen twill	+\$0
LBJ	graphite twill	+\$0
LBK	pewter mesh	+\$0
LBL	steel mesh	+\$0
LBM	crisp linen	+\$0
LBN	classic linen	+\$0
LBP	casual linen	+\$0
LBQ	white twill	+\$0
LM	mahogany	+\$0
LT	light tone	+\$0
LU	soft white	+\$0
MT	medium tone	+\$0
WL	sandstone	+\$0
WN	warm grey neutral	+\$0

Step 8. Edge Finish

76	light brown walnut	+\$0
8Q	folkstone grey	+\$0

8Z	neutral grey	+\$0
91	white	+\$0
98	studio white	+\$0
BU	black umber	+\$0
CL	cool grey neutral	+\$0
HF	inner tone light	+\$0
HM	natural maple	+\$0
HP	light anigre	+\$0
HT	inner tone	+\$0
HX	aged cherry	+\$0
HY	walnut on cherry	+\$0
JB	millwork cherry	+\$0
LA	light ash	+\$0
LBA	clear on ash	+\$0
LBB	oak on ash	+\$0
LBC	walnut on ash	+\$0
LBD	dark brown walnut	+\$0
LBE	medium red walnut	+\$0
LBF	neutral twill	+\$0
LBG	sarum twill	+\$0
LBH	earthen twill	+\$0
LBJ	graphite twill	+\$0
LBK	pewter mesh	+\$0
LBL	steel mesh	+\$0
LBM	crisp linen	+\$0
LBN	classic linen	+\$0
LBP	casual linen	+\$0
LBQ	white twill	+\$0
LU	soft white	+\$0
MT	medium tone	+\$0
WL	sandstone	+\$0
WN	warm grey neutral	+\$0

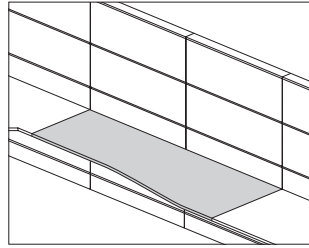

Specification Information	
Step 1.	
EW	
Step 2. Edge	
S12.	squared-edge
Step 3. Depth	
24	24" deep left, 30" deep right
30	30" deep left, 24" deep right
Step 4. Width	
30	30" wide
36	36" wide
42	42" wide
48	48" wide
60	60" wide
Step 5. Surface Material	
L	laminate top/thermoplastic edge
Step 6. Attachment	
F	Ethospace® frame attached surface
Prices for Steps 1-6.	
	LF
EWS12.24 30	\$273
36	\$292
42	\$341
48	\$392
60	\$409
30 30	\$273
36	\$292
42	\$341
48	\$432
60	\$409

Curvilinear Surface *continued*

Step 7. Top Finish		
76	light brown walnut	+\$0
8Q	folkstone grey	+\$0
91	white	+\$0
98	studio white	+\$0
CL	cool grey neutral	+\$0
HF	inner tone light	+\$0
HM	natural maple	+\$0
HP	light anigre	+\$0
HT	inner tone	+\$0
HX	aged cherry	+\$0
HY	walnut on cherry	+\$0
LA	light ash	+\$0
LBA	clear on ash	+\$0
LBB	oak on ash	+\$0
LBC	walnut on ash	+\$0
LBD	dark brown walnut	+\$0
LBE	medium red walnut	+\$0
LBF	neutral twill	+\$0
LBG	sarum twill	+\$0
LBH	earthen twill	+\$0
LBJ	graphite twill	+\$0
LBK	pewter mesh	+\$0
LBL	steel mesh	+\$0
LBM	crisp linen	+\$0
LBN	classic linen	+\$0
LBP	casual linen	+\$0
LBQ	white twill	+\$0
LM	mahogany	+\$0
LT	light tone	+\$0
LU	soft white	+\$0
MT	medium tone	+\$0
WL	sandstone	+\$0
WN	warm grey neutral	+\$0

HX	aged cherry	+\$0
HY	walnut on cherry	+\$0
JB	millwork cherry	+\$0
LA	light ash	+\$0
LBA	clear on ash	+\$0
LBB	oak on ash	+\$0
LBC	walnut on ash	+\$0
LBD	dark brown walnut	+\$0
LBE	medium red walnut	+\$0
LBF	neutral twill	+\$0
LBG	sarum twill	+\$0
LBH	earthen twill	+\$0
LBJ	graphite twill	+\$0
LBK	pewter mesh	+\$0
LBL	steel mesh	+\$0
LBM	crisp linen	+\$0
LBN	classic linen	+\$0
LBP	casual linen	+\$0
LBQ	white twill	+\$0
LU	soft white	+\$0
MT	medium tone	+\$0
WL	sandstone	+\$0
WN	warm grey neutral	+\$0

Step 8. Edge Finish		
76	light brown walnut	+\$0
8Q	folkstone grey	+\$0
8Z	neutral grey	+\$0
91	white	+\$0
98	studio white	+\$0
BU	black umber	+\$0
CL	cool grey neutral	+\$0
HF	inner tone light	+\$0
HM	natural maple	+\$0
HP	light anigre	+\$0
HT	inner tone	+\$0

Corner Surface

EWS20.

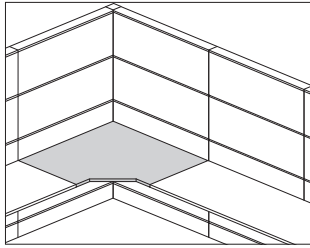

Specification Information

Step 1.

EW

Step 2. Edge

S20. squared-edge

Step 3. Depth

24 24" deep

30 30" deep

Step 4. Width

For 24" deep (24)

36 36" wide

42 42" wide

48 48" wide

For 30" deep (30)

42 42" wide

48 48" wide

Step 5. Surface Material

L laminate top/thermoplastic edge

Step 6. Attachment

F Ethospace® frame attached surface

Prices for Steps 1-6.

	LF
EWS20.24 36	\$304
42	\$373
48	\$441
30 42	\$467
48	\$526

Step 7. Top Finish

76	light brown walnut	+\$0
8Q	folkstone grey	+\$0
91	white	+\$0
98	studio white	+\$0
CL	cool grey neutral	+\$0
HF	inner tone light	+\$0
HM	natural maple	+\$0
HP	light anigre	+\$0
HT	inner tone	+\$0
HX	aged cherry	+\$0
HY	walnut on cherry	+\$0
LA	light ash	+\$0
LBA	clear on ash	+\$0
LBB	oak on ash	+\$0
LBC	walnut on ash	+\$0
LBD	dark brown walnut	+\$0
LBE	medium red walnut	+\$0
LBF	neutral twill	+\$0
LBG	sarum twill	+\$0
LBH	earthen twill	+\$0
LBJ	graphite twill	+\$0
LBK	pewter mesh	+\$0
LBL	steel mesh	+\$0
LBM	crisp linen	+\$0
LBN	classic linen	+\$0
LBP	casual linen	+\$0
LBQ	white twill	+\$0
LM	mahogany	+\$0
LT	light tone	+\$0
LU	soft white	+\$0
MT	medium tone	+\$0
WL	sandstone	+\$0
WN	warm grey neutral	+\$0

Step 8. Edge Finish

76	light brown walnut	+\$0
8Q	folkstone grey	+\$0
8Z	neutral grey	+\$0
91	white	+\$0
98	studio white	+\$0
BU	black umber	+\$0
CL	cool grey neutral	+\$0
HF	inner tone light	+\$0
HM	natural maple	+\$0
HP	light anigre	+\$0
HT	inner tone	+\$0

Ethospace® Work Surfaces

HX	aged cherry	+\$0
HY	walnut on cherry	+\$0
JB	millwork cherry	+\$0
LA	light ash	+\$0
LBA	clear on ash	+\$0
LBB	oak on ash	+\$0
LBC	walnut on ash	+\$0
LBD	dark brown walnut	+\$0
LBE	medium red walnut	+\$0
LBF	neutral twill	+\$0
LBG	sarum twill	+\$0
LBH	earthen twill	+\$0
LBJ	graphite twill	+\$0
LBK	pewter mesh	+\$0
LBL	steel mesh	+\$0
LBM	crisp linen	+\$0
LBN	classic linen	+\$0
LBP	casual linen	+\$0
LBQ	white twill	+\$0
LU	soft white	+\$0
MT	medium tone	+\$0
WL	sandstone	+\$0
WN	warm grey neutral	+\$0

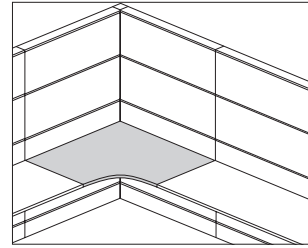

Specification Information

Step 1.

EW

Step 2. Edge

S21. squared-edge

Step 3. Depth

24 24" deep

30 30" deep

Step 4. Width

For 24" deep (24)

36 36" wide

42 42" wide

48 48" wide

For 30" deep (30)

42 42" wide

48 48" wide

Step 5. Surface Material

L laminate top/thermoplastic edge

Step 6. Attachment

F Ethospace® frame attached surface

Prices for Steps 1-6.

		LF
EWS21.24	36	\$304
	42	\$373
	48	\$441
	30 42	\$467
	48	\$526

Concave Corner Surface *continued*

Step 7. Top Finish

76	light brown walnut	+\$0
8Q	folkstone grey	+\$0
91	white	+\$0
98	studio white	+\$0
CL	cool grey neutral	+\$0
HF	inner tone light	+\$0
HM	natural maple	+\$0
HP	light anigre	+\$0
HT	inner tone	+\$0
HX	aged cherry	+\$0
HY	walnut on cherry	+\$0
LA	light ash	+\$0
LBA	clear on ash	+\$0
LBB	oak on ash	+\$0
LBC	walnut on ash	+\$0
LBD	dark brown walnut	+\$0
LBE	medium red walnut	+\$0
LBF	neutral twill	+\$0
LBG	sarum twill	+\$0
LBH	earthen twill	+\$0
LBJ	graphite twill	+\$0
LBK	pewter mesh	+\$0
LBL	steel mesh	+\$0
LBM	crisp linen	+\$0
LBN	classic linen	+\$0
LBP	casual linen	+\$0
LBQ	white twill	+\$0
LM	mahogany	+\$0
LT	light tone	+\$0
LU	soft white	+\$0
MT	medium tone	+\$0
WL	sandstone	+\$0
WN	warm grey neutral	+\$0

Step 8. Edge Finish

76	light brown walnut	+\$0
8Q	folkstone grey	+\$0
8Z	neutral grey	+\$0
91	white	+\$0
98	studio white	+\$0
BU	black umber	+\$0
CL	cool grey neutral	+\$0
HF	inner tone light	+\$0
HM	natural maple	+\$0
HP	light anigre	+\$0
HT	inner tone	+\$0

HX	aged cherry	+\$0
HY	walnut on cherry	+\$0
JB	millwork cherry	+\$0
LA	light ash	+\$0
LBA	clear on ash	+\$0
LBB	oak on ash	+\$0
LBC	walnut on ash	+\$0
LBD	dark brown walnut	+\$0
LBE	medium red walnut	+\$0
LBF	neutral twill	+\$0
LBG	sarum twill	+\$0
LBH	earthen twill	+\$0
LBJ	graphite twill	+\$0
LBK	pewter mesh	+\$0
LBL	steel mesh	+\$0
LBM	crisp linen	+\$0
LBN	classic linen	+\$0
LBP	casual linen	+\$0
LBQ	white twill	+\$0
LU	soft white	+\$0
MT	medium tone	+\$0
WL	sandstone	+\$0
WN	warm grey neutral	+\$0

Extended Corner Surface, Rectangular End

EWS22.

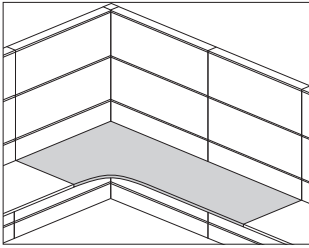

Ethospace® Work Surfaces

Specification Information

Step 1.

EW

Step 2. Edge

S22. squared-edge, 24" deep

Step 3. Width

4260 42" wide left x 60" wide right

4872 48" wide left x 72" wide right

6042 60" wide left x 42" wide right

7248 72" wide left x 48" wide right

Step 4. Surface Material

L laminate top/thermoplastic edge

Step 5. Attachment

F Ethospace® frame attached surface

Prices for Steps 1-5.

	F
EWS22.4260 L	\$709
4872 L	\$840
6042 L	\$709
7248 L	\$840

Step 6. Top Finish

76	light brown walnut	+\$0
8Q	folkstone grey	+\$0
91	white	+\$0
98	studio white	+\$0
CL	cool grey neutral	+\$0
HF	inner tone light	+\$0
HM	natural maple	+\$0
HP	light anigre	+\$0
HT	inner tone	+\$0
HX	aged cherry	+\$0
HY	walnut on cherry	+\$0
LA	light ash	+\$0
LBA	clear on ash	+\$0
LBB	oak on ash	+\$0
LBC	walnut on ash	+\$0
LBD	dark brown walnut	+\$0
LBE	medium red walnut	+\$0
LBF	neutral twill	+\$0
LBG	sarum twill	+\$0
LBH	earthen twill	+\$0
LBJ	graphite twill	+\$0
LBK	pewter mesh	+\$0
LBL	steel mesh	+\$0
LBM	crisp linen	+\$0
LBN	classic linen	+\$0
LBP	casual linen	+\$0
LBQ	white twill	+\$0
LM	mahogany	+\$0
LT	light tone	+\$0
LU	soft white	+\$0
MT	medium tone	+\$0
WL	sandstone	+\$0
WN	warm grey neutral	+\$0

Step 7. Edge Finish

76	light brown walnut	+\$0
8Q	folkstone grey	+\$0
8Z	neutral grey	+\$0
91	white	+\$0
98	studio white	+\$0
BU	black umber	+\$0
CL	cool grey neutral	+\$0
HF	inner tone light	+\$0
HM	natural maple	+\$0
HP	light anigre	+\$0
HT	inner tone	+\$0

Extended Corner Surface,
Rectangular End *continued*

HX	aged cherry	+\$0
HY	walnut on cherry	+\$0
JB	millwork cherry	+\$0
LA	light ash	+\$0
LBA	clear on ash	+\$0
LBB	oak on ash	+\$0
LBC	walnut on ash	+\$0
LBD	dark brown walnut	+\$0
LBE	medium red walnut	+\$0
LBF	neutral twill	+\$0
LBG	sarum twill	+\$0
LBH	earthen twill	+\$0
LBJ	graphite twill	+\$0
LBK	pewter mesh	+\$0
LBL	steel mesh	+\$0
LBM	crisp linen	+\$0
LBN	classic linen	+\$0
LBP	casual linen	+\$0
LBQ	white twill	+\$0
LU	soft white	+\$0
MT	medium tone	+\$0
WL	sandstone	+\$0
WN	warm grey neutral	+\$0

Squared-Edge Corner Wedge

Y2091.

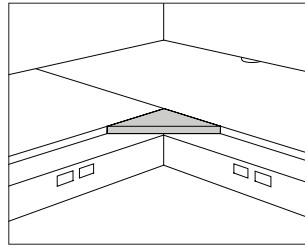

Specification Information

Step 1.

Y2091.

Step 2. Surface Material

L laminate top/thermoplastic edge

U laminate top/universal edge

Prices for Steps 1-2.

Y2091. L	\$107
U	\$107

Step 3. Top Finish

76	light brown walnut	+\$0
8Q	folkstone grey	+\$0
91	white	+\$0
98	studio white	+\$0
CL	cool grey neutral	+\$0
HF	inner tone light	+\$0
HM	natural maple	+\$0
HP	light anigre	+\$0
HT	inner tone	+\$0
HX	aged cherry	+\$0
HY	walnut on cherry	+\$0
LA	light ash	+\$0
LBA	clear on ash	+\$0
LBB	oak on ash	+\$0
LBC	walnut on ash	+\$0
LBD	dark brown walnut	+\$0
LBE	medium red walnut	+\$0
LBF	neutral twill	+\$0
LBG	sarum twill	+\$0
LBH	earthen twill	+\$0
LBJ	graphite twill	+\$0
LBK	pewter mesh	+\$0
LBL	steel mesh	+\$0
LBM	crisp linen	+\$0
LBN	classic linen	+\$0
LBP	casual linen	+\$0
LBQ	white twill	+\$0
LM	mahogany	+\$0
LT	light tone	+\$0
LU	soft white	+\$0
MT	medium tone	+\$0
WL	sandstone	+\$0
WN	warm grey neutral	+\$0

Ethospace® Work Surfaces

Squared-Edge Corner Wedge

continued

Ethospace® Work Surfaces

Step 4. Edge Finish

For laminate top/thermoplastic edge (L)

76	light brown walnut	+\$0
8Q	folkstone grey	+\$0
8Z	neutral grey	+\$0
91	white	+\$0
98	studio white	+\$0
BU	black umber	+\$0
CL	cool grey neutral	+\$0
HF	inner tone light	+\$0
HM	natural maple	+\$0
HP	light anigre	+\$0
HT	inner tone	+\$0
HX	aged cherry	+\$0
HY	walnut on cherry	+\$0
JB	millwork cherry	+\$0
LA	light ash	+\$0
LBA	clear on ash	+\$0
LBB	oak on ash	+\$0
LBC	walnut on ash	+\$0
LBD	dark brown walnut	+\$0
LBE	medium red walnut	+\$0
LBF	neutral twill	+\$0
LBG	sarum twill	+\$0
LBH	earthen twill	+\$0
LBJ	graphite twill	+\$0
LBK	pewter mesh	+\$0
LBL	steel mesh	+\$0
LBM	crisp linen	+\$0
LBN	classic linen	+\$0
LBP	casual linen	+\$0
LBQ	white twill	+\$0
LU	soft white	+\$0
MT	medium tone	+\$0
WL	sandstone	+\$0
WN	warm grey neutral	+\$0

Squared-Edge Corner Wedge

Y2091.

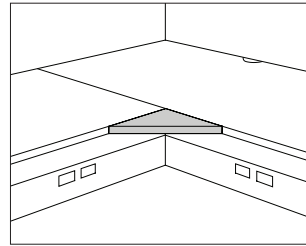

Specification Information

Step 1.

Y2091.

Step 2. Surface Material

L	laminate top/thermoplastic edge
U	laminate top/universal edge

Prices for Steps 1-2.

Y2091. L	\$107
U	\$107

Step 3. Top Finish

76	light brown walnut	+\$0
8Q	folkstone grey	+\$0
91	white	+\$0
98	studio white	+\$0
CL	cool grey neutral	+\$0
HF	inner tone light	+\$0
HM	natural maple	+\$0
HP	light anigre	+\$0
HT	inner tone	+\$0
HX	aged cherry	+\$0
HY	walnut on cherry	+\$0
LA	light ash	+\$0
LBA	clear on ash	+\$0
LBB	oak on ash	+\$0
LBC	walnut on ash	+\$0
LBD	dark brown walnut	+\$0
LBE	medium red walnut	+\$0
LBF	neutral twill	+\$0
LBG	sarum twill	+\$0
LBH	earthen twill	+\$0
LBJ	graphite twill	+\$0
LBK	pewter mesh	+\$0
LBL	steel mesh	+\$0
LBM	crisp linen	+\$0
LBN	classic linen	+\$0
LBP	casual linen	+\$0
LBQ	white twill	+\$0
LM	mahogany	+\$0
LT	light tone	+\$0
LU	soft white	+\$0
MT	medium tone	+\$0
WL	sandstone	+\$0
WN	warm grey neutral	+\$0

Squared-Edge Corner Wedge

continued

Work Surface Support, Single

E2393.

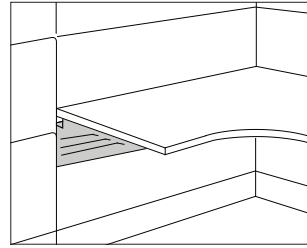

Step 4. Edge Finish

For laminate top/thermoplastic edge (L)

76	light brown walnut	+\$0
8Q	folkstone grey	+\$0
8Z	neutral grey	+\$0
91	white	+\$0
98	studio white	+\$0
BU	black umber	+\$0
CL	cool grey neutral	+\$0
HF	inner tone light	+\$0
HM	natural maple	+\$0
HP	light anigre	+\$0
HT	inner tone	+\$0
HX	aged cherry	+\$0
HY	walnut on cherry	+\$0
JB	millwork cherry	+\$0
LA	light ash	+\$0
LBA	clear on ash	+\$0
LBB	oak on ash	+\$0
LBC	walnut on ash	+\$0
LBD	dark brown walnut	+\$0
LBE	medium red walnut	+\$0
LBF	neutral twill	+\$0
LBG	sarum twill	+\$0
LBH	earthen twill	+\$0
LBJ	graphite twill	+\$0
LBK	pewter mesh	+\$0
LBL	steel mesh	+\$0
LBM	crisp linen	+\$0
LBN	classic linen	+\$0
LBP	casual linen	+\$0
LBQ	white twill	+\$0
LU	soft white	+\$0
MT	medium tone	+\$0
WL	sandstone	+\$0
WN	warm grey neutral	+\$0

Specification Information

Step 1.

E2393.

Step 2. Work Surface Depth

24 for 20"- or 24"-deep surfaces

30 for 30"-deep surfaces

Step 3. Position

L left

R right

Prices for Steps 1-3.

	L	R
E2393. 24	\$33	33
30	\$37	37

Step 4. Surface Finish

BU	black umber	+\$0
HF	inner tone light	+\$0
LU	soft white	+\$0
MT	medium tone	+\$0
CN	metallic champagne	+\$10

Step 5. Support Option

SM	on module	+\$0
-----------	-----------	------

Ethospace® Work Surfaces

Work Surface Support Bracket E2931.

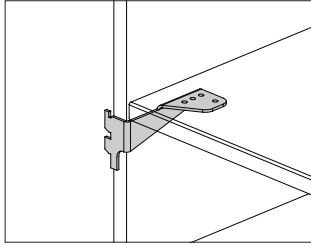

Specification Information

Step 1.
E2931.

Step 2. Position

- L left
- R right

Prices for Steps 1-2.

E2931. L	\$56
R	\$56

Step 3. Finish

BU	black umber	+\$0
HF	inner tone light	+\$0
LU	soft white	+\$0
MT	medium tone	+\$0

Ethospace® Work Surfaces

Work Surface Support Panel, End, Glides E2290.

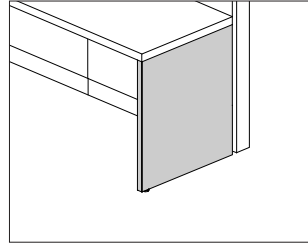

Specification Information

Step 1.
E2290.

Step 2. Depth

24	24" deep
30	30" deep

Step 3. Work Surface Edge

- S squared-edge

Step 4. Surface Material

- L laminate

Prices for Steps 1-4.

	L
E2290. 24 S	\$301
30 S	\$318

Step 5. Surface Finish

Solid-Color Laminate

BU	black umber	+\$0
HF	inner tone light	+\$0
LU	soft white	+\$0
MT	medium tone	+\$0

Step 6. Hardware Cover Finish

8Q	folkstone grey	+\$0
91	white	+\$0
BU	black umber	+\$0
CL	cool grey neutral	+\$0
HF	inner tone light	+\$0
LU	soft white	+\$0
MT	medium tone	+\$0
SG	slate grey	+\$0
WL	sandstone	+\$0
WN	warm grey neutral	+\$0

Work Surface Support Panel,
Mid-Run, Glides

E2291.

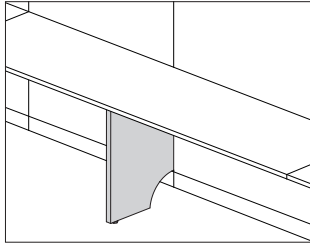

Specification Information

Step 1.

E2291.

Step 2. Size

20 for 24" and 30" deep surfaces

Step 3. Surface Material

L laminate

Prices for Steps 1-3.

	L
E2291. 20	\$303

Step 4. Surface Finish

BU black umber	+ \$0
HF inner tone light	+ \$0
LU soft white	+ \$0
MT medium tone	+ \$0

Step 5. Bracket Finish

BU black umber	+ \$0
HF inner tone light	+ \$0
LU soft white	+ \$0
MT medium tone	+ \$0

Stiffener

FV696.

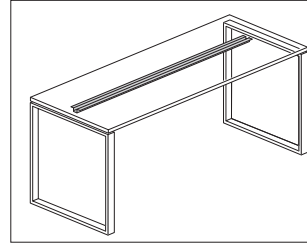

Specification Information

Step 1.

FV696.

Step 2. Width

34	33 ⁷ / ₈ " wide
39	38 ⁵ / ₈ " wide
43	43 ¹ / ₄ " wide
48	48" wide
57	57 ³ / ₈ " wide
62	62 ¹ / ₈ " wide
67	66 ³ / ₄ " wide
71	71 ¹ / ₂ " wide
81	80 ⁷ / ₈ " wide

Prices for Steps 1-2.

FV696. 34	\$68
39	\$70
43	\$70
48	\$70
57	\$70
62	\$70
67	\$70
71	\$70
81	\$70

Cord Cleat

G1331.

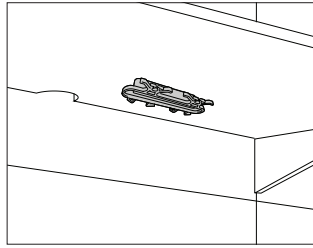

Specification Information	
Step 1.	
G1331.	\$19

Oval Transaction Surface

E2810.

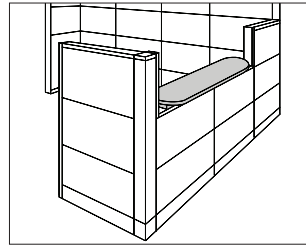

Specification Information	
Step 1.	
E2810.	

Step 2. Width

34	34" wide
40	40" wide
58	58" wide

Step 3. Surface Material

L	laminate
----------	----------

Prices for Steps 1-3.

	L
E2810. 34	\$1299
40	\$1443
58	\$1726

Step 4. Laminate Top Finish/Natural Edge

Solid-Color Laminate Top/Natural Edge

HF	inner tone light	+ \$0
HT	inner tone	+ \$0
LU	soft white	+ \$0

Wood-Grain Laminate Top/Natural Edge

LA	light ash	+ \$0
LM	mahogany	+ \$0

Step 5. Support Finish

BU	black umber	+ \$0
HF	inner tone light	+ \$0

Squared-Edge Transaction
Surface, Rectangular End

E2812.

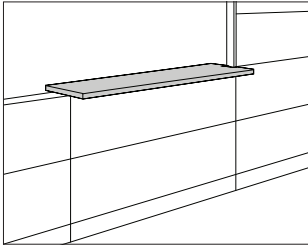

Specification Information

Step 1.

E2812.

Step 2. Width

- 24L** 24" wide
- 30L** 30" wide
- 36L** 36" wide
- 42L** 42" wide
- 48L** 48" wide

Step 3. Finished End Cutout

- N** no cutout
- C** cutout on one end

Prices for Steps 1-3.

	N	C
E2812. 24L	\$232	278
30L	\$239	288
36L	\$259	307
42L	\$269	320
48L	\$276	327

Step 4. Top Finish

76	light brown walnut	+\$0
8Q	folkstone grey	+\$0
91	white	+\$0
98	studio white	+\$0
CL	cool grey neutral	+\$0
HF	inner tone light	+\$0
HM	natural maple	+\$0
HP	light anigre	+\$0
HT	inner tone	+\$0
HX	aged cherry	+\$0
HY	walnut on cherry	+\$0
LA	light ash	+\$0
LBA	clear on ash	+\$0
LBB	oak on ash	+\$0
LBC	walnut on ash	+\$0
LBD	dark brown walnut	+\$0
LBE	medium red walnut	+\$0
LBF	neutral twill	+\$0
LBG	sarum twill	+\$0
LBH	earthen twill	+\$0
LBJ	graphite twill	+\$0
LBK	pewter mesh	+\$0
LBL	steel mesh	+\$0
LBM	crisp linen	+\$0
LBN	classic linen	+\$0
LBP	casual linen	+\$0
LBQ	white twill	+\$0
LM	mahogany	+\$0
LT	light tone	+\$0
LU	soft white	+\$0
MT	medium tone	+\$0
WL	sandstone	+\$0
WN	warm grey neutral	+\$0

Step 5. Edge Finish

76	light brown walnut	+\$0
8Q	folkstone grey	+\$0
8Z	neutral grey	+\$0
91	white	+\$0
98	studio white	+\$0
BU	black umber	+\$0
CL	cool grey neutral	+\$0
HF	inner tone light	+\$0
HM	natural maple	+\$0
HP	light anigre	+\$0
HT	inner tone	+\$0

Squared-Edge Transaction Surface, Rectangular End *continued*

Ethospace® Work Surfaces

HX	aged cherry	+\$0
HY	walnut on cherry	+\$0
JB	millwork cherry	+\$0
LA	light ash	+\$0
LBA	clear on ash	+\$0
LBB	oak on ash	+\$0
LBC	walnut on ash	+\$0
LBD	dark brown walnut	+\$0
LBE	medium red walnut	+\$0
LBF	neutral twill	+\$0
LBG	sarum twill	+\$0
LBH	earthen twill	+\$0
LBJ	graphite twill	+\$0
LBK	pewter mesh	+\$0
LBL	steel mesh	+\$0
LBM	crisp linen	+\$0
LBN	classic linen	+\$0
LBP	casual linen	+\$0
LBQ	white twill	+\$0
LU	soft white	+\$0
MT	medium tone	+\$0
WL	sandstone	+\$0
WN	warm grey neutral	+\$0

B-Style Flipper Door Unit

E3212.

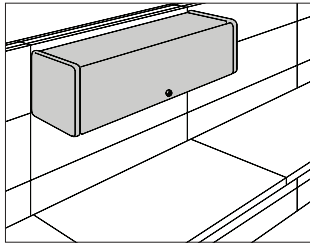

Specification Information

Step 1.

E321

Step 2. Depth/Door Material

2. 13" deep and painted or fabric door

Step 3. Width

24 24" wide
30 30" wide
36 36" wide
42 42" wide
48 48" wide

Step 4. Door Material

P painted door
F fabric door

Step 5. Lock

For lock (), skip this step.*
 lock

Prices for Steps 1-5.

	*
E3212. 24 P	\$418
F	\$431
30 P	\$441
F	\$454
36 P	\$475
F	\$489
42 P	\$511
F	\$525
48 P	\$540
F	\$554

Step 6. Lock Option

KA keyed alike +\$0
KD keyed differently +\$0

Step 7. Case Finish

BU black umber +\$0
HF inner tone light +\$0
LU soft white +\$0
MT medium tone +\$0
CN metallic champagne +\$40

Step 8. Door Finish

For 13" deep and painted or fabric door (2.) with painted door (P)

BU black umber +\$0
HF inner tone light +\$0
LU soft white +\$0
MT medium tone +\$0
CN metallic champagne +\$10

Step 9. End Panel Option

For 13" deep and painted or fabric door (2.)

SM for Ethospace® on module +\$0

Step 10. Door Finish

For 24" wide (24), 30" wide (30), 36" wide (36), 42" wide (42), or 48" wide (48) with fabric door (F)

See application chart and textiles list for fabric usage and numbers. First 2 digits of number indicate fabric line; remaining digit(s) indicate fabric color.

Price Category 1 +\$0
 Price Category 2 +\$18
 Price Category 3 +\$37
 Price Category 4 +\$54

Ethospace® Storage

B-Style Flipper Door

E3217.

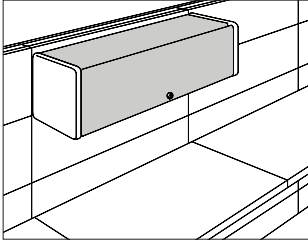

Ethospace® Storage

Specification Information

Step 1.

E321

Step 2. Depth/Door Material

7. 13" deep and painted or fabric

Step 3. Width

24 24" wide
30 30" wide
36 36" wide
42 42" wide
48 48" wide

Step 4. Door Material

P painted
F fabric

Step 5. Lock

For lock (), skip this step.*

lock

Prices for Steps 1-5.

*

E3217. 24 P	\$265
F	\$277
30 P	\$284
F	\$299
36 P	\$310
F	\$323
42 P	\$335
F	\$350
48 P	\$358
F	\$372

Step 6. Lock Option

KA keyed alike +\$0
KD keyed differently +\$0

Step 7. Top Finish

BU black umber +\$0
HF inner tone light +\$0
LU soft white +\$0
MT medium tone +\$0
CN metallic champagne +\$20

Step 8. Door Finish

See application chart and textiles list for fabric usage and numbers.

First 2 digits of number indicate fabric line; remaining digit(s) indicate fabric color.

For 24" wide (24), 30" wide (30), 36" wide (36), 42" wide (42), or 48" wide (48) with fabric (F)

Price Category 1	+\$0
Price Category 2	+\$18
Price Category 3	+\$37
Price Category 4	+\$54

For painted (P)

BU black umber	+\$0
HF inner tone light	+\$0
LU soft white	+\$0
MT medium tone	+\$0
CN metallic champagne	+\$10

B-Style Shelf

E3230.
E3231.

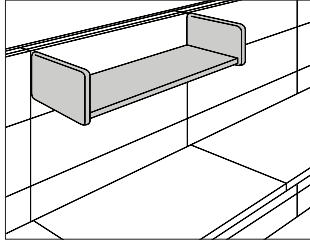

Specification Information

Step 1.

E323

Step 2. Height/Depth

- 0. 7 1/2" high x 13" deep
- 1. 15 1/2" high x 13" deep

Step 3. Width

- 24 24" wide
- 30 30" wide
- 36 36" wide
- 42 42" wide
- 48 48" wide

Prices for Steps 1-3.

E3230.	24	\$127
	30	\$134
	36	\$144
	42	\$154
	48	\$159
<hr/>		
E3231.	24	\$171
	30	\$177
	36	\$187
	42	\$197
	48	\$202

Step 4. Surface Finish

BU	black umber	+\$0
HF	inner tone light	+\$0
LU	soft white	+\$0
MT	medium tone	+\$0
CN	metallic champagne	+\$20

Step 5. End Panel Option

For 15 1/2" high x 13" deep (1.)

SM	on module	+\$0
-----------	-----------	------

B-Style Storage/Display Shelf

E3232.

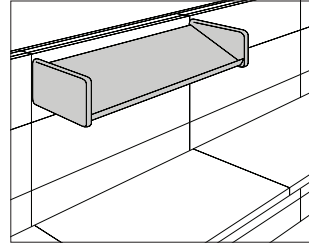

Specification Information

Step 1.

E3232.

Step 2. Width

- 24** 24" wide
- 30** 30" wide
- 36** 36" wide
- 42** 42" wide
- 48** 48" wide

Prices for Steps 1-2.

E3232.	24	\$154
	30	\$161
	36	\$169
	42	\$181
	48	\$191

Step 3. Surface Finish

BU	black umber	+\$0
HF	inner tone light	+\$0
LU	soft white	+\$0
MT	medium tone	+\$0
CN	metallic champagne	+\$20

C-Style Flipper Door Unit

X3750.

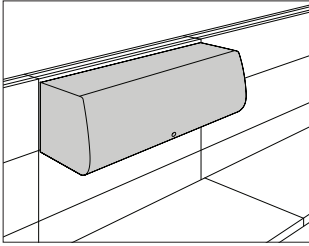

Ethospace® Storage

Specification Information

Step 1.
X3750.

Step 2. Width

24	24" wide
30	30" wide
36	36" wide
42	42" wide
48	48" wide

Step 3. Mechanism

SP	standard mechanism
-----------	--------------------

Step 4. Lift Handle

N	no lift handle
----------	----------------

Prices for Steps 1-4.

	N
X3750. 24 SP	\$560
30 SP	\$595
36 SP	\$631
42 SP	\$676
48 SP	\$724

Step 5. Lock Option

KA	keyed alike	+\$0
KD	keyed differently	+\$0

Step 6. Attachment Bracket

AO	for Action Office® system	+\$0
E1	for Ethospace® System	+\$0
F8	for Canvas	+\$0
OM	for Ethospace® off module	+\$0

Step 7. Case/Lift Handle Finish

8Q	folkstone grey	+\$0
91	white	+\$0
BU	black umber	+\$0
HF	inner tone light	+\$0
LT	light tone	+\$0
LU	soft white	+\$0
MT	medium tone	+\$0
WL	sandstone	+\$0
WN	warm grey neutral	+\$0
CN	metallic champagne	+\$40
EH	metallic bronze	+\$40

Step 8. Door Finish

8Q	folkstone grey	+\$0
91	white	+\$0
BU	black umber	+\$0
HF	inner tone light	+\$0
LT	light tone	+\$0
LU	soft white	+\$0
MT	medium tone	+\$0
WL	sandstone	+\$0
WN	warm grey neutral	+\$0
CN	metallic champagne	+\$10
EH	metallic bronze	+\$10

C-Style Flipper Door

X3710.

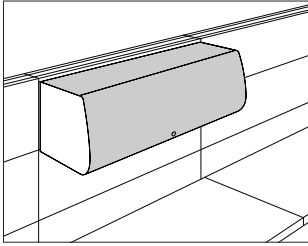

Specification Information

Step 1.

X3710.

Step 2. Width

24SP	24" wide
30SP	30" wide
36SP	36" wide
42SP	42" wide
48SP	48" wide

Step 3. Lift Handle

N no lift handle

Prices for Steps 1-3.

	N
X3710. 24SP	\$349
30SP	\$373
36SP	\$407
42SP	\$440
48SP	\$471

Step 4. Lock Option

KA	keyed alike	+\$0
KD	keyed differently	+\$0

Step 5. Top/Lift Handle Finish

8Q	folkstone grey	+\$0
91	white	+\$0
BU	black umber	+\$0
HF	inner tone light	+\$0
LT	light tone	+\$0
LU	soft white	+\$0
MT	medium tone	+\$0
WL	sandstone	+\$0
WN	warm grey neutral	+\$0
EH	metallic bronze	+ \$20

Step 6. Door Finish

8Q	folkstone grey	+\$0
91	white	+\$0
BU	black umber	+\$0
HF	inner tone light	+\$0
LT	light tone	+\$0
LU	soft white	+\$0
MT	medium tone	+\$0
WL	sandstone	+\$0
WN	warm grey neutral	+\$0
EH	metallic bronze	+\$10

Ethospace® Storage

C-Style Shelf

X3730.

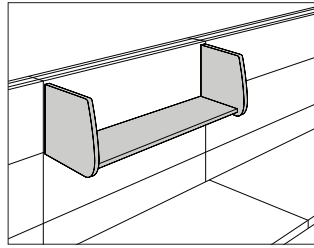

Specification Information

Step 1.
X3730.

Step 2. Width

24	24" wide
30	30" wide
36	36" wide
42	42" wide
48	48" wide

Prices for Steps 1-2.

X3730. 24	\$229
30	\$238
36	\$249
42	\$264
48	\$276

Step 3. Attachment Bracket

AO	for Action Office® system	+\$0
E1	for Ethospace® System	+\$0
F8	for Canvas	+\$0
OM	for Ethospace® off module	+\$0

Step 4. Surface Finish

8Q	folkstone grey	+\$0
91	white	+\$0
BU	black umber	+\$0
HF	inner tone light	+\$0
LT	light tone	+\$0
LU	soft white	+\$0
MT	medium tone	+\$0
WL	sandstone	+\$0
WN	warm grey neutral	+\$0
CN	metallic champagne	+\$20
EH	metallic bronze	+\$20

Ethospace® Storage

E-Style Flipper Door Unit

E3110.

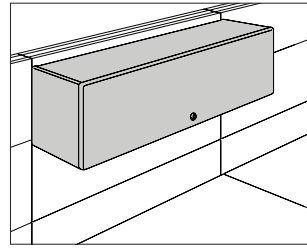

Specification Information

Step 1.
E3110.

Step 2. Width

24	24" wide
30	30" wide
36	36" wide
42	42" wide
48	48" wide

Step 3. Door Material

F	fabric door
----------	-------------

Prices for Steps 1-3.

		F
E3110. 24		\$529
30		\$570
36		\$614
42		\$652
48		\$694

Step 4. Lock Option

KA	keyed alike	+\$0
KD	keyed differently	+\$0

Step 5. Case Finish

BU	black umber	+\$0
HF	inner tone light	+\$0
LU	soft white	+\$0
MT	medium tone	+\$0
CN	metallic champagne	+\$40

Step 6. End Panel Option

SM	for Ethospace® on module	+\$0
-----------	--------------------------	------

Step 7. Door Finish

See application chart and textiles list for fabric usage and numbers.
First 2 digits of number indicate fabric line; remaining digit(s) indicate fabric color.

Price Category 1	+\$0
Price Category 2	+\$18
Price Category 3	+\$37
Price Category 4	+\$54

E-Style Flipper Door

E9002.

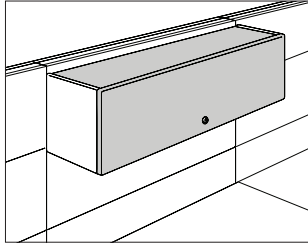

Specification Information

Step 1.

E9002.

Step 2. Width

24	24" wide
30	30" wide
36	36" wide
42	42" wide
48	48" wide

Step 3. Door Material

F fabric door

Prices for Steps 1-3.

	F
E9002. 24	\$320
30	\$347
36	\$372
42	\$394
48	\$421

Step 4. Lock Option

KA	keyed alike	+\$0
KD	keyed differently	+\$0

Step 5. Top Finish

BU	black umber	+\$0
HF	inner tone light	+\$0
LU	soft white	+\$0
MT	medium tone	+\$0
CN	metallic champagne	+\$20

Step 6. Door Finish

See application chart and textiles list for fabric usage and numbers. First 2 digits of number indicate fabric line; remaining digit(s) indicate fabric color.

Price Category 1	+\$0
Price Category 2	+\$18
Price Category 3	+\$37
Price Category 4	+\$54

E-Style Shelf

E3130.
E3133.

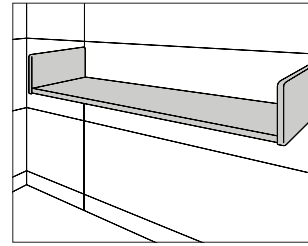

Specification Information

Step 1.

E313

Step 2. Height/Depth

0.	7 ¹ / ₂ " high x 13 ³ / ₄ " deep
3.	15 ¹ / ₂ " high x 13 ¹ / ₂ " deep

Step 3. Width

24	24" wide
30	30" wide
36	36" wide
42	42" wide
48	48" wide

Prices for Steps 1-3.

E3130. 24	\$205
30	\$221
36	\$236
42	\$247
48	\$257
<hr/>	
E3133. 24	\$240
30	\$259
36	\$278
42	\$297
48	\$313

Step 4. Surface Finish

BU	black umber	+\$0
HF	inner tone light	+\$0
LU	soft white	+\$0
MT	medium tone	+\$0
CN	metallic champagne	+\$20

Step 5. End Panel Option

For 15¹/₂" high x 13¹/₂" deep (3.)

SM	on module	+\$0
-----------	-----------	------

F-Style Sliding Door Storage Unit E3810.

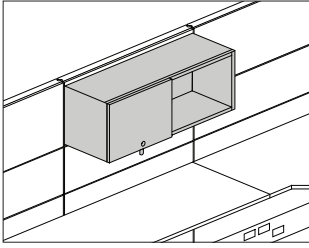

Ethospace® Storage

Specification Information

Step 1.
E3810.

Step 2. Height

1 15" high

Step 3. Width

24 24" wide
30 30" wide
36 36" wide
42 42" wide
48 48" wide

Step 4. Door Material

P painted door

Step 5. Lock

N no lock
L lock

Prices for Steps 1-5.

		PN	PL
E3810. 1	24	\$342	354
	30	\$363	374
	36	\$392	402
	42	\$422	433
	48	\$447	458

Step 6. Lock Option

For lock (L)

KA keyed alike +\$0
KD keyed differently, black +\$0

Step 7. Case Finish

BU black umber +\$0
HF inner tone light +\$0
LU soft white +\$0
MT medium tone +\$0
CN metallic champagne +\$40

Step 8. Door Finish

BU black umber +\$0
HF inner tone light +\$0
LU soft white +\$0
MT medium tone +\$0
CN metallic champagne +\$40

Step 9. Pull Finish

CL cool grey neutral +\$0
WN warm grey neutral +\$0

F-Style Upmount Sliding Door Storage Unit

E3814.

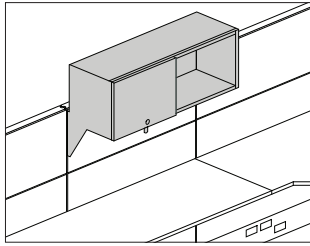

Specification Information

Step 1.

E3814.

Step 2. Width

24	24" wide
30	30" wide
36	36" wide
42	42" wide
48	48" wide

Step 3. Door Material

P	Painted door
----------	--------------

Step 4. Lock

N	no lock
L	lock

Prices for Steps 1-4.

	N	L
E3814. 24 P	\$528	539
30 P	\$563	573
36 P	\$600	611
42 P	\$638	649
48 P	\$676	687

Step 5. Lock Option

For lock (L)

KA	keyed alike	+\$0
KD	keyed differently, black	+\$0

Step 6. Case Finish

BU	black umber	+\$0
HF	inner tone light	+\$0
LU	soft white	+\$0
MT	medium tone	+\$0
CN	metallic champagne	+\$40

Step 7. Door Finish

BU	black umber	+\$0
HF	inner tone light	+\$0
LU	soft white	+\$0
MT	medium tone	+\$0
CN	metallic champagne	+\$40

Step 8. Pull Finish

CL	cool grey neutral	+\$0
WN	warm grey neutral	+\$0

F-Style Shelf

E3811.

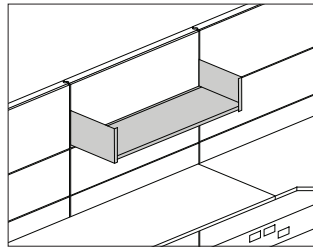

Specification Information

Step 1.

E3811.

Step 2. Width

24	24" wide
30	30" wide
36	36" wide
42	42" wide
48	48" wide

Prices for Steps 1-2.

E3811. 24	\$129
30	\$137
36	\$146
42	\$156
48	\$162

Step 3. Surface Finish

BU	black umber	+\$0
HF	inner tone light	+\$0
LU	soft white	+\$0
MT	medium tone	+\$0
CN	metallic champagne	+\$20

F-Style Storage Unit Back Panel

E3812.

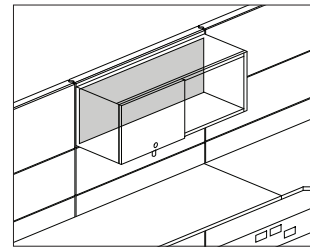

Specification Information

Step 1.

E3812.

Step 2. Height

15	15" high
-----------	----------

Step 3. Width

24	24" wide
30	30" wide
36	36" wide
42	42" wide
48	48" wide

Prices for Steps 1-3.

	24	30	36	42	48
E3812. 15	\$114	118	125	134	142

Step 4. Surface Finish

8Q	folkstone grey	+\$0
91	white	+\$0
BU	black umber	+\$0
HF	inner tone light	+\$0
LU	soft white	+\$0
MT	medium tone	+\$0
SG	slate grey	+\$0
WL	sandstone	+\$0
CN	metallic champagne	+\$20
EH	metallic bronze	+\$20
MS	metallic silver	+\$20

Ethospace® Storage

Component Brace

X3910.

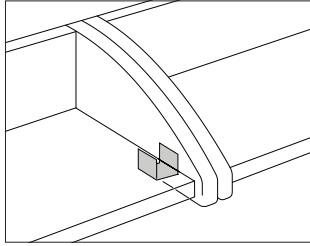

Specification Information

Step 1.

X3910.

Step 2. Usage

- 1** for C-/E-style flipper unit/shelf
- 2** for utility shelf (E3234.)

Prices for Steps 1-2.

X3910. 1	\$41
2	\$41

Step 3. Surface Finish

For C-/E-style flipper unit/shelf (1)

98 studio white	+ \$0
BU black umber	+ \$0

Shelf Divider, Angled

G7330.

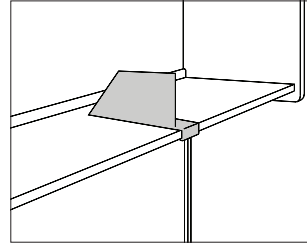

Specification Information

Step 1.

G7330.

\$239

Step 2. Surface Finish

8Q folkstone grey	+ \$0
91 white	+ \$0
BU black umber	+ \$0
HF inner tone light	+ \$0
LT light tone	+ \$0
LU soft white	+ \$0
MT medium tone	+ \$0
SG slate grey	+ \$0
WL sandstone	+ \$0
WN warm grey neutral	+ \$0
CN metallic champagne	+ \$5
EH metallic bronze	+ \$5

Ethospace® Storage

Coat Hook

E3922.

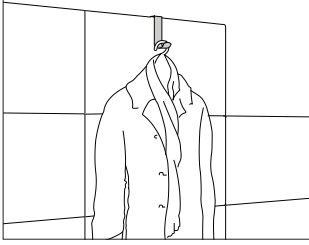

Specification Information

Step 1.
E3922. \$66

Step 2. Finish

BU black umber +\$0
HF inner tone light +\$0

Ethospace® Storage

Energy-Efficient Task Light

G6120.
G6121.
G6123.

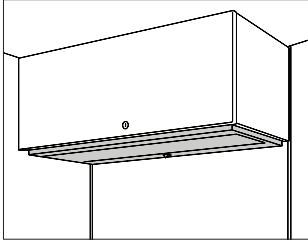

Specification Information

Step 1.

G612

Step 2. Code Requirements

- 0. meets local codes including Canada
- 1. meets Chicago codes
- 3. meets New York City codes

Step 3. Width

- 24 24" wide
- 30 30" wide
- 36 36" wide
- 42 42" wide
- 48 48" wide
- 60 60" wide

Step 4. Dimmer

For 24" wide (24)

- N no dimmer

For 30" wide (30), 36" wide (36), 42" wide (42), 48" wide (48), or 60" wide (60)

- N no dimmer
- D 3-step dimmer

Step 5. Bracket Option

- S for Action Office® or Ethospace® Systems or Canvas
- Q for C-style storage or E3234.
- P for Passage® Desking System

Prices for Steps 1-5.

	S	Q	P
G6120. 24 N	\$307	307	307
30 N	\$318	318	318
D	\$349	349	349
36 N	\$326	326	326
D	\$359	359	359
42 N	\$341	341	341
D	\$373	373	373
48 N	\$348	348	348
D	\$381	381	381
60 N	\$380	380	380
D	\$419	419	419
G6121. 24 N	\$352	352	352

30 N	\$369	369	369
D	\$401	401	401
36 N	\$376	376	376
D	\$415	415	415
42 N	\$387	387	387
D	\$426	426	426
48 N	\$395	395	395
D	\$433	433	433
60 N	\$431	431	431
D	\$475	475	475
G6123. 24 N	\$304	304	304
30 N	\$330	330	330
D	\$365	365	365
36 N	\$340	340	340
D	\$372	372	372
42 N	\$348	348	348
D	\$381	381	381
48 N	\$358	358	358
D	\$393	393	393
60 N	\$393	393	393
D	\$431	431	431

Step 6. Surface Finish

For Action Office® or Ethospace® Systems or Canvas (S) or C-style storage or E3234. (Q)

8Q	folkstone grey	+\$0
91	white	+\$0
BU	black umber	+\$0
CL	cool grey neutral	+\$0
HF	inner tone light	+\$0
LT	light tone	+\$0
LU	soft white	+\$0
MT	medium tone	+\$0
WL	sandstone	+\$0
WN	warm grey neutral	+\$0
EH	metallic bronze	+\$15

For Passage® Desking System (P)

BU	black umber	+\$0
-----------	-------------	------

Ethospace® Lighting

Utility Task Light

G6136.
G6137.

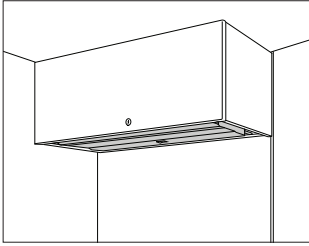

Ethospace® Lighting

Specification Information

Step 1.

G613

Step 2. Code Requirements

- 6. meets local codes including Canada and New York City
- 7. meets Chicago codes

Step 3. Width

- 24 24" wide
- 30 30" wide
- 42 42" wide
- 60 60" wide

Step 4. Attachment Bracket

- S** for Action Office® or Ethospace® Systems or Canvas
- Q** for C-style storage or E3234.
- P** for Passage® Desking System
- F** for 5000 Series Furniture
- T** for transaction surface/counter top/wood cabinets

Prices for Steps 1-4.

	S	Q	P	F	T
G6136. 24	\$226	226	226	226	226
30	\$230	230	230	230	230
42	\$253	253	253	253	253
60	\$281	281	281	281	281
G6137. 24	\$304	304	304	304	304
30	\$308	308	308	308	308
42	\$330	330	330	330	330
60	\$361	361	361	361	361

Tool Bar

E3610.

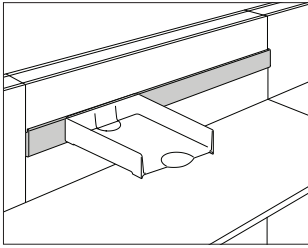

Specification Information

Step 1.

E3610.

Step 2. Width

24	24" wide
30	30" wide
36	36" wide
42	42" wide
48	48" wide

Prices for Steps 1-2.

E3610. 24	\$64
30	\$75
36	\$86
42	\$95
48	\$102

Step 3. Surface Finish

BU	black umber	+\$0
HF	inner tone light	+\$0
LU	soft white	+\$0
MT	medium tone	+\$0
CN	metallic champagne	+\$10



Standard-Pull Freestanding Pedestal

F16-1

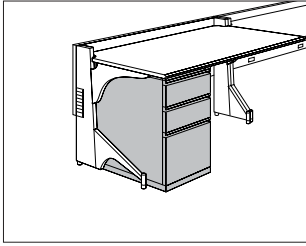

Specification Information

Step 1.

F16-

Step 2. Width

15 15" wide

Step 3. Depth

18- 18" deep

22- 22" deep

28- 28" deep

Step 4. Configuration

FF file/file

BBF box/box/file

Prices for Steps 1-4.

		FF	BBF
F16-15	18-	\$634	663
	22-	\$659	686
	28-	\$675	713

Step 5. Paint/Steel Type

TS smooth paint on textured steel +\$20

Step 6. Surface Finish

Nonmetallic Paint

For smooth paint on textured steel (TS)

98	studio white	+\$0
BU	black umber	+\$0
G2	graphite satin	+\$0
HF	inner tone light	+\$0
HT	inner tone	+\$0
LT	light tone	+\$0
LU	soft white	+\$0
MT	medium tone	+\$0
SG	slate grey	+\$0

Step 7. Top

Ethospace® Pedestal Top (TE3) available only on 15"-wide, 22"- or 28"-deep pedestals.

T1	1"-high painted metal top with squared edge	+\$0
T2	1 1/4"-high painted metal top with squared edge	+\$0

Step 8. Lock

For 18" deep (18-) AND 22" deep (22-)

KA	keyed alike	+\$0
KC	keyed differently, chrome	+\$0
KD	keyed differently, black	+\$0

Step 9. Base Height

B1	1"-high base	+\$0
B2	1 1/2"-high base	+\$0
B3	2 1/4"-high base	+\$0
B4	3 1/4"-high base	+\$0

Step 10. Counterweight

NO	no counterweight	+\$0
CB	counterweight	+\$88

Step 11. Compressor

C	standard compressor	+\$0
----------	---------------------	------

Meridian® Pedestals

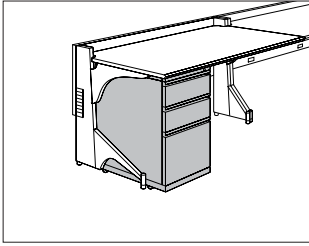

Meridian® Pedestals

Specification Information

Step 1.

M16-

Step 2. Width

15 15" wide

Step 3. Depth

18- 18" deep

22- 22" deep

28- 28" deep

Step 4. Configuration

BF box/file

FF file/file

BBF box/box/file

Prices for Steps 1-4.

	BF	FF	BBF
M16-15 18-	\$675	774	802
22-	\$692	796	826
28-	\$717	832	851

Step 5. Paint/Steel Type

TS smooth paint on textured steel +\$20

Step 6. Surface Finish

Nonmetallic Paint

For smooth paint on textured steel (TS)

98	studio white	+\$0
BU	black umber	+\$0
G2	graphite satin	+\$0
HF	inner tone light	+\$0
HT	inner tone	+\$0
LT	light tone	+\$0
LU	soft white	+\$0
MT	medium tone	+\$0
SG	slate grey	+\$0

Step 7. Top

T1 1"-high painted metal top with squared edge +\$0

T2 1¼"-high painted metal top with squared edge +\$0

Step 8. Lock

KA keyed alike +\$0

KC keyed differently, chrome +\$0

KD keyed differently, black +\$0

Step 9. Handle

HN no hand grip or transit handle +\$0

Step 10. Compressor

C standard compressor +\$0

Standard-Pull Suspended Pedestal

S16-1

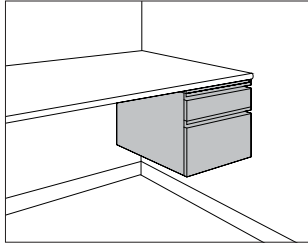

Specification Information

Step 1.

S16-

Step 2. Width

15 15" wide

Step 3. Depth

22- 22" deep

28- 28" deep

Step 4. Configuration

BF box/file

Prices for Steps 1-4.

	BF
S16-15 22-	\$493
28-	\$507

Step 5. Paint/Steel Type

TS smooth paint on textured steel +\$20

Step 6. Surface Finish

Nonmetallic Paint

For smooth paint on textured steel (TS)

BU black umber	+\$0
G2 graphite satin	+\$0
HF inner tone light	+\$0
HT inner tone	+\$0
LT light tone	+\$0
LU soft white	+\$0
MT medium tone	+\$0
SG slate grey	+\$0

Step 7. Lock

KA keyed alike +\$0

KC keyed differently, chrome +\$0

KD keyed differently, black +\$0

Step 8. Base Height

NB no base +\$0

Step 9. Compressor

For 22" deep (22-) or 28" deep (28-) with box/file (BF)

C standard compressor +\$0

Sloped-Pull Freestanding Pedestal

F19P-

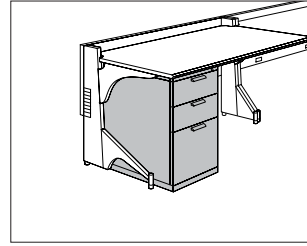

Specification Information

Step 1.

F19

Step 2. Front Material

P-15 painted metal front

Step 3. Depth

18- 18" deep

22- 22" deep

Step 4. Configuration

FF file/file

BBF box/box/file

Prices for Steps 1-4.

	FF	BBF
F19P-15 18-	\$698	730
22-	\$725	755

Step 5. Paint/Steel Type

TS smooth paint on textured steel +\$20

Step 6. Surface Finish

Nonmetallic Paint

For smooth paint on textured steel (TS)

BU black umber	+\$0
G2 graphite satin	+\$0
HF inner tone light	+\$0
HT inner tone	+\$0
LT light tone	+\$0
LU soft white	+\$0
MT medium tone	+\$0
SG slate grey	+\$0

Step 7. Top

Ethospace® Pedestal Top (TE3) available only on 15"-wide, 22"- or 28"-deep pedestals.

T1 1"-high painted metal top with squared edge +\$0

T2 1 1/4"-high painted metal top with squared edge +\$0

Sloped-Pull Freestanding Pedestal *continued*

Step 8. Lock

For 1"-high painted metal top with squared edge (T1) or 1 1/4"-high painted metal top with squared edge (T2)

KA	keyed alike	+\$0
KC	keyed differently, chrome	+\$0
KD	keyed differently, black	+\$0

Step 9. Pull Finish

G2	graphite satin	+\$0
-----------	----------------	------

Step 10. Base Height

B1	1"-high base	+\$0
B2	1 1/2"-high base	+\$0
B3	2 1/4"-high base	+\$0
B4	3 1/4"-high base	+\$0

Step 11. Counterweight

NO	no counterweight	+\$0
CB	counterweight	+\$88

Step 12. Compressor

C	standard compressor	+\$0
----------	---------------------	------

Sloped-Pull Mobile Pedestal

M19P-

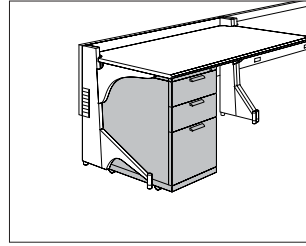

Specification Information

Step 1.

M19

Step 2. Front Material

P-15 painted metal front

Step 3. Depth

18-	18" deep
22-	22" deep

Step 4. Configuration

FF	file/file
BF	box/file
BBF	box/box/file

Prices for Steps 1-4.

	FF	BF	BBF
M19P-15 18-	\$852	743	883
22-	\$876	762	909

Step 5. Paint/Steel Type

TS	smooth paint on textured steel	+\$20
-----------	--------------------------------	-------

Step 6. Surface Finish

Nonmetallic Paint

For smooth paint on textured steel (TS)

BU	black umber	+\$0
G2	graphite satin	+\$0
HF	inner tone light	+\$0
HT	inner tone	+\$0
LT	light tone	+\$0
LU	soft white	+\$0
MT	medium tone	+\$0
SG	slate grey	+\$0

Step 7. Top

T1	1"-high painted metal top with squared edge	+\$0
T2	1 1/4"-high painted metal top with squared edge	+\$0

Step 8. Lock

KA	keyed alike	+\$0
KC	keyed differently, chrome	+\$0
KD	keyed differently, black	+\$0

Sloped-Pull Mobile Pedestal

continued

Step 9. Handle		
HN	no hand grip or transit handle	+\$0
Step 10. Pull Finish		
G2	graphite satin	+\$0
Step 11. Compressor		
C	standard compressor	+\$0

Pencil Tray for Box Drawer, Meridian® Pedestal

73-15

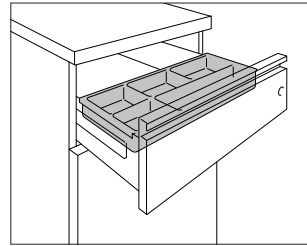

Specification Information	
Step 1.	
73-	
Step 2. Width	
1516-PT	for 15"-wide drawer (for Meridian® pedestals and 5000 Series furniture)
Prices for Steps 1-2.	
73-1516-PT	\$20

Meridian® Pedestals

Drawer Divider for Box Drawer,
Meridian® Pedestal

73-15

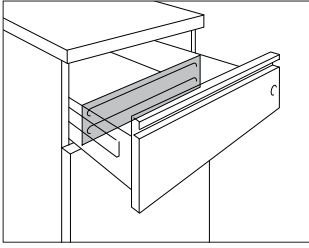

File Drawer Organizer

LG901

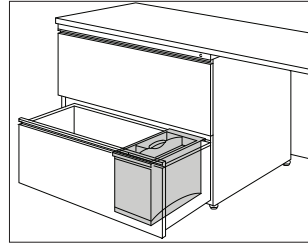

Meridian® Pedestals

Specification Information

Step 1.

73-

Step 2. Width

1567-D for 15"-wide drawer (for Meridian® pedestals and 5000 Series furniture)

Prices for Steps 1-2.

73-1567-D

\$14

Specification Information

Step 1.

LG901

\$74

Metal Pedestals





W-Pull Freestanding Pedestal

LW100.

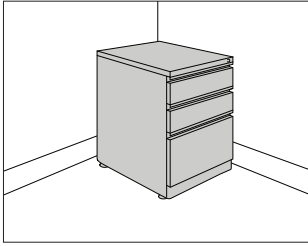

Specification Information

Step 1.

LW100.

Step 2. Depth

20	20" deep
24	24" deep
28	28" deep

Step 3. Configuration

BBF	box/box/file
FF	file/file

Prices for Steps 1-3.

	BBF	FF
LW100. 20	\$545	500
24	\$558	514
28	\$627	578

Step 4. Slides

For box/box/file (BBF)

SR	3/4-extension roller slides on box drawer, full-extension ball bearing on file drawer	+\$0
-----------	---	------

For file/file (FF)

SB	full-extension ball-bearing	+\$0
-----------	-----------------------------	------

Step 5. Paint/Steel Type

SS	smooth paint on smooth steel	+\$0
XS	textured paint on smooth steel	+\$0

Step 6. Surface Finish

For smooth paint on smooth steel (SS)

8Q	folkstone grey	+\$0
98	studio white	+\$0
BU	black umber	+\$0
CN	metallic champagne	+\$40
EH	metallic bronze	+\$40
HF	inner tone light	+\$0
LT	light tone	+\$0
LU	soft white	+\$0
MS	metallic silver	+\$40
MT	medium tone	+\$0
WL	sandstone	+\$0

Sand Texture Paint

For textured paint on smooth steel (XS)

98	studio white	+\$0
-----------	--------------	------

Bright Sand Texture Paint

For textured paint on smooth steel (XS)

91	white	+\$0
CL	cool grey neutral	+\$0
WN	warm grey neutral	+\$0

Step 7. Lock

KA	keyed alike	+\$0
KC	keyed differently, chrome	+\$0
KD	keyed differently, black	+\$0

Step 8. Base Height

1F	standard height	+\$0
2F	raised height	+\$0

Step 9. Drawer Interior

For box/box/file (BBF)

NN	none	+\$0
3M	drawer divider in one box drawer, pencil tray in one box drawer, 2 file converters in file drawer	+\$25

For file/file (FF)

NN	none	+\$0
1M	2 file converters in each file drawer	+\$25

V-Pull Freestanding Pedestal

LV100.

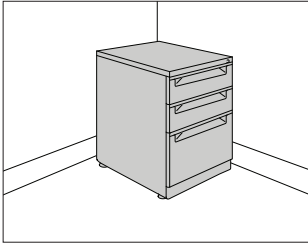

Tu® Metal Pedestals

Specification Information

Step 1.

LV100.

Step 2. Depth

20	20" deep
24	24" deep
28	28" deep

Step 3. Configuration

BBF	box/box/file
FF	file/file

Prices for Steps 1-3.

	BBF	FF
LV100. 20	\$560	516
24	\$577	529
28	\$646	593

Step 4. Slides

For 20" deep (20) with box/box/file (BBF)

SR	$\frac{3}{4}$ -extension roller slides on box drawer, full-extension ball bearing on file drawer	+\$0
SB	full-extension ball-bearing	+\$50

For 24" deep (24) or 28" deep (28) with box/box/file (BBF)

SR	$\frac{3}{4}$ -extension roller slides on box drawer, full-extension ball bearing on file drawer	+\$0
-----------	--	------

For file/file (FF)

SB	full-extension ball-bearing	+\$0
-----------	-----------------------------	------

Step 5. Paint/Steel Type

SS	smooth paint on smooth steel	+\$0
XS	textured paint on smooth steel	+\$0

Step 6. Surface Finish

For smooth paint on smooth steel (SS)

8Q	folkstone grey	+\$0
98	studio white	+\$0
BU	black umber	+\$0
HF	inner tone light	+\$0
LT	light tone	+\$0
LU	soft white	+\$0
MT	medium tone	+\$0
WL	sandstone	+\$0
CN	metallic champagne	+\$40
EH	metallic bronze	+\$40
MS	metallic silver	+\$40

Bright Sand Texture Paint

For textured paint on smooth steel (XS)

91	white	+\$0
CL	cool grey neutral	+\$0
WN	warm grey neutral	+\$0

Step 7. Lock

KA	keyed alike	+\$0
KC	keyed differently, chrome	+\$0
KD	keyed differently, black	+\$0

Step 8. Base Height

1F	standard height	+\$0
2F	raised height	+\$0

Step 9. Drawer Interior

For box/box/file (BBF)

NN	none	+\$0
3M	drawer divider in one box drawer, pencil tray in one box drawer, 2 file converters in file drawer	+\$25

For file/file (FF)

NN	none	+\$0
1M	2 file converters in each file drawer	+\$25

W-Pull Mobile Pedestal

LW110.

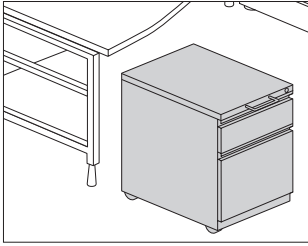

Specification Information

Step 1.

LW110.

Step 2. Depth

20	20" deep
24	24" deep

Step 3. Configuration

For 20" deep (20)

BBF	box/box/file
BF	box/file
FF	file/file

For 24" deep (24)

BBF	box/box/file
FF	file/file

Prices for Steps 1-3.

	BBF	BF	FF
LW110. 20	\$594	500	539
24	\$599	—	547

Step 4. Slides

For box/box/file (BBF)

SR	3/4-extension roller slides on box drawer, full-extension ball bearing on file drawer	+\$0
SB	full-extension ball-bearing	+\$50

For box/file (BF)

SR	3/4-extension roller slides on box drawer, full-extension ball bearing on file drawer	+\$0
-----------	---	------

For file/file (FF)

SB	full-extension ball-bearing	+\$0
-----------	-----------------------------	------

Step 5. Paint/Steel Type

SS	smooth paint on smooth steel	+\$0
XS	textured paint on smooth steel	+\$0

Step 6. Surface Finish

For smooth paint on smooth steel (SS)

8Q	folkstone grey	+\$0
98	studio white	+\$0
BU	black umber	+\$0
CN	metallic champagne	+\$40
EH	metallic bronze	+\$40
HF	inner tone light	+\$0
LT	light tone	+\$0
LU	soft white	+\$0
MS	metallic silver	+\$40
MT	medium tone	+\$0
WL	sandstone	+\$0

Sand Texture Paint

For textured paint on smooth steel (XS)

98	studio white	+\$0
-----------	--------------	------

Bright Sand Texture Paint

For textured paint on smooth steel (XS)

91	white	+\$0
CL	cool grey neutral	+\$0
WN	warm grey neutral	+\$0

Step 7. Lock

KA	keyed alike	+\$0
KC	keyed differently, chrome	+\$0
KD	keyed differently, black	+\$0

Step 8. Drawer Interior

For box/box/file (BBF)

NN	none	+\$0
3M	drawer divider in one box drawer, pencil tray in one box drawer, 2 file converters in file drawer	+\$25

For box/file (BF)

NN	none	+\$0
5M	pencil tray in box drawer, 2 file converters in file drawer	+\$20

For file/file (FF)

NN	none	+\$0
1M	2 file converters in each file drawer	+\$25

Step 9. Handle		
HN	no hand grip	+\$0
H1	hand grip only	+\$48

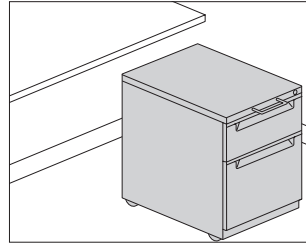

Specification Information

Step 1.
LV110.

Step 2. Depth	
20	20" deep
24	24" deep

Step 3. Configuration

For 20" deep (20)

BBF	box/box/file
BF	box/file
FF	file/file

For 24" deep (24)

BBF	box/box/file
FF	file/file

Prices for Steps 1-3.

	BBF	BF	FF
LV110. 20	\$612	516	555
24	\$617	—	562

Step 4. Slides

For box/box/file (BBF) or box/file (BF)

SR	3/4-extension roller slides on box drawer, full-extension ball bearing on file drawer	+\$0
-----------	---	------

For file/file (FF)

SB	full-extension ball-bearing	+\$0
-----------	-----------------------------	------

Step 5. Paint/Steel Type

SS	smooth paint on smooth steel	+\$0
XS	textured paint on smooth steel	+\$0

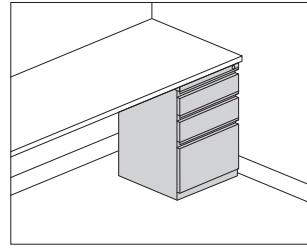

Step 6. Surface Finish

For smooth paint on smooth steel (SS)

8Q	folkstone grey	+\$0
98	studio white	+\$0
BU	black umber	+\$0
HF	inner tone light	+\$0
LT	light tone	+\$0
LU	soft white	+\$0
MT	medium tone	+\$0
WL	sandstone	+\$0
CN	metallic champagne	+\$40
EH	metallic bronze	+\$40
MS	metallic silver	+\$40

Bright Sand Texture Paint

For textured paint on smooth steel (XS)

91	white	+\$0
CL	cool grey neutral	+\$0
WN	warm grey neutral	+\$0

Step 7. Lock

KA	keyed alike	+\$0
KC	keyed differently, chrome	+\$0
KD	keyed differently, black	+\$0

Step 8. Drawer Interior

For box/box/file (BBF)

NN	none	+\$0
3M	drawer divider in one box drawer, pencil tray in one box drawer, 2 file converters in file drawer	+\$25

For box/file (BF)

NN	none	+\$0
5M	pencil tray in box drawer, 2 file converters in file drawer	+\$20

For file/file (FF)

NN	none	+\$0
1M	2 file converters in each file drawer	+\$25

Step 9. Handle

HN	no hand grip	+\$0
H1	hand grip only	+\$48

Specification Information

Step 1.
LW140.

Step 2. Depth

24	24" deep
28	28" deep

Step 3. Configuration

BBF	box/box/file
FF	file/file

Prices for Steps 1-3.

	BBF	FF
LW140. 24	\$521	475
28	\$608	559

Step 4. Slides

	24BBF	24FF	28BBF	28FF
SB	full-extension ball-bearing	+\$50	50	0

Step 5. Paint/Steel Type

SS	smooth paint on smooth steel	+\$0
XS	textured paint on smooth steel	+\$0

Step 6. Surface Finish

For smooth paint on smooth steel (SS)

8Q	folkstone grey	+\$0
98	studio white	+\$0
BU	black umber	+\$0
CN	metallic champagne	+\$40
EH	metallic bronze	+\$40
HF	inner tone light	+\$0
LT	light tone	+\$0
LU	soft white	+\$0
MS	metallic silver	+\$40
MT	medium tone	+\$0
WL	sandstone	+\$0

Sand Texture Paint

For textured paint on smooth steel (XS)

98	studio white	+\$0
-----------	--------------	------

W-Pull Surface-Attached Pedestal

continued

Tur® Metal Pedestals

Bright Sand Texture Paint

For textured paint on smooth steel (XS)

91	white	+\$0
CL	cool grey neutral	+\$0
WN	warm grey neutral	+\$0

Step 7. Lock

KA	keyed alike	+\$0
KD	keyed differently, black	+\$0
KC	keyed differently, chrome	+\$0

Step 8. Base Height

2F	27 ¹ / ₄ " high (raised height)	+\$0
-----------	---	------

Step 9. Drawer Interior

For box/box/file (BBF)

NN	none	+\$0
3M	drawer divider in one box drawer, pencil tray in one box drawer, 2 file converters in file drawer	+\$25

For file/file (FF)

NN	none	+\$0
1M	2 file converters in each file drawer	+\$25

W-Pull Support Pedestal

LW150.

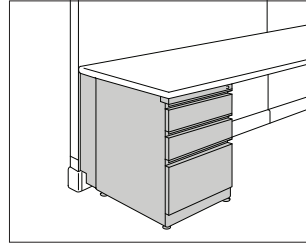

Specification Information

Step 1.

LW150.

Step 2. Depth

20	20" deep
24	24" deep
28	28" deep

Step 3. Configuration

BBF	box/box/file
FF	file/file

Prices for Steps 1-3.

	BBF	FF
LW150. 20	\$581	539
24	\$608	579
28	\$641	614

Step 4. Slides

For box/box/file (BBF)

SR	3/4"-extension roller slides on box drawer, full-extension ball bearing on file drawer	+\$0
-----------	--	------

For file/file (FF)

SB	full-extension ball-bearing	+\$0
-----------	-----------------------------	------

Step 5. Paint/Steel Type

SS	smooth paint on smooth steel	+\$0
XS	textured paint on smooth steel	+\$0

Step 6. Surface Finish

For smooth paint on smooth steel (SS)

8Q	folkstone grey	+\$0
98	studio white	+\$0
BU	black umber	+\$0
CN	metallic champagne	+\$40
EH	metallic bronze	+\$40
HF	inner tone light	+\$0
LT	light tone	+\$0
LU	soft white	+\$0
MS	metallic silver	+\$40
MT	medium tone	+\$0
WL	sandstone	+\$0

W-Pull Support Pedestal *continued*

Sand Texture Paint		
<i>For textured paint on smooth steel (XS)</i>		
98	studio white	+\$0

Bright Sand Texture Paint		
<i>For textured paint on smooth steel (XS)</i>		
91	white	+\$0
CL	cool grey neutral	+\$0
WN	warm grey neutral	+\$0

Step 7. Attachment Bracket		
<i>For smooth paint on smooth steel (SS)</i>		
1A	for Action Office® Series 1 and 2 radiused-edge work surface	+\$0
2A	for Action Office® Series 1 and 2 squared-edge work surface	+\$0
E1	for Ethospace® System	+\$0
F8	for Canvas Office Landscape®	+\$0

<i>For textured paint on smooth steel (XS)</i>		
1A	for Action Office® Series 1 and 2 radiused-edge work surface	+\$0
2A	for Action Office® Series 1 and 2 squared-edge work surface	+\$0
F8	for Canvas Office Landscape®	+\$0

Step 8. Lock		
KA	keyed alike	+\$0
KC	keyed differently, chrome	+\$0
KD	keyed differently, black	+\$0

Step 9. Drawer Interior		
<i>For box/box/file (BBF)</i>		
NN	none	+\$0
3M	drawer divider in one box drawer, pencil tray in one box drawer, 2 file converters in file drawer	+\$25

<i>For file/file (FF)</i>		
NN	none	+\$0
1M	2 file converters in each file drawer	+\$25

V-Pull Support Pedestal

LV150.

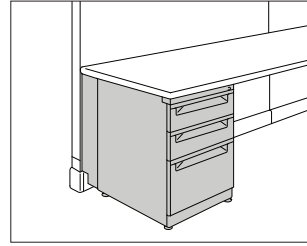

Specification Information

Step 1.
LV150.

Step 2. Depth		
20	20" deep	
24	24" deep	
28	28" deep	

Step 3. Configuration		
BBF	box/box/file	
FF	file/file	

Prices for Steps 1-3.			
		BBF	FF
LV150. 20		\$576	534
24		\$603	574
28		\$636	607

Step 4. Slides		
<i>For box/box/file (BBF)</i>		
SR	3/4"-extension roller slides on box drawer, full-extension ball bearing on file drawer	+\$0

<i>For file/file (FF)</i>		
SB	full-extension ball-bearing	+\$0

Step 5. Paint/Steel Type		
SS	smooth paint on smooth steel	+\$0
XS	textured paint on smooth steel	+\$0

Step 6. Surface Finish		
<i>For smooth paint on smooth steel (SS)</i>		
8Q	folkstone grey	+\$0
98	studio white	+\$0
BU	black umber	+\$0
HF	inner tone light	+\$0
LT	light tone	+\$0
LU	soft white	+\$0
MT	medium tone	+\$0
WL	sandstone	+\$0
CN	metallic champagne	+\$40
EH	metallic bronze	+\$40
MS	metallic silver	+\$40

Ty® Metal Pedestals

Bright Sand Texture Paint

For textured paint on smooth steel (XS)

91	white	+\$0
CL	cool grey neutral	+\$0
WN	warm grey neutral	+\$0

Step 7. Attachment Bracket

For smooth paint on smooth steel (SS)

1A	for Action Office® Series 1 and 2 radiused-edge work surface	+\$0
2A	for Action Office® Series 1 and 2 squared-edge work surface	+\$0
E1	for Ethospace® System	+\$0
F8	for Canvas Office Landscape®	+\$0

For textured paint on smooth steel (XS)

1A	for Action Office® Series 1 and 2 radiused-edge work surface	+\$0
2A	for Action Office® Series 1 and 2 squared-edge work surface	+\$0
F8	for Canvas Office Landscape®	+\$0

Step 8. Lock

KA	keyed alike	+\$0
KC	keyed differently, chrome	+\$0
KD	keyed differently, black	+\$0

Step 9. Drawer Interior

For box/box/file (BBF)

NN	none	+\$0
3M	drawer divider in one box drawer, pencil tray in one box drawer, 2 file converters in file drawer	+\$25

For file/file (FF)

NN	none	+\$0
1M	2 file converters in each file drawer	+\$25

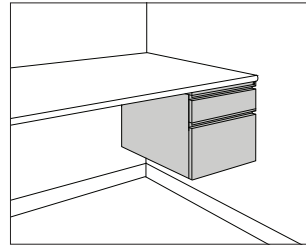

Specification Information

Step 1.		
LW130.20BF		\$367

Step 2. Slides

SR	¾-extension roller slides on box drawer, full-extension ball bearing on file drawer	+\$0
-----------	---	------

Step 3. Paint/Steel Type

SS	smooth paint on smooth steel	+\$0
XS	textured paint on smooth steel	+\$0

Step 4. Surface Finish

For smooth paint on smooth steel (SS)

8Q	folkstone grey	+\$0
98	studio white	+\$0
BU	black umber	+\$0
CN	metallic champagne	+\$40
EH	metallic bronze	+\$40
HF	inner tone light	+\$0
LT	light tone	+\$0
LU	soft white	+\$0
MS	metallic silver	+\$40
MT	medium tone	+\$0
WL	sandstone	+\$0

Sand Texture Paint

For textured paint on smooth steel (XS)

98	studio white	+\$0
-----------	--------------	------

Bright Sand Texture Paint

For textured paint on smooth steel (XS)

91	white	+\$0
CL	cool grey neutral	+\$0
WN	warm grey neutral	+\$0

Step 5. Lock

KA	keyed alike	+\$0
KC	keyed differently, chrome	+\$0
KD	keyed differently, black	+\$0

Step 6. Drawer Interior

NN	none	+\$0
5M	pencil tray in box drawer, 2 file converters in file drawer	+\$20

V-Pull Suspended Pedestal

LV130.

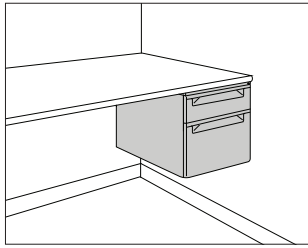

Specification Information

Step 1.

LV130.20BF \$396

Step 2. Slides

SR 3/4-extension roller slides on box drawer, full-extension ball bearing on file drawer +\$0

Step 3. Paint/Steel Type

SS smooth paint on smooth steel +\$0

XS textured paint on smooth steel +\$0

Step 4. Surface Finish

For smooth paint on smooth steel (SS)

8Q folkstone grey +\$0

98 studio white +\$0

BU black umber +\$0

HF inner tone light +\$0

LT light tone +\$0

LU soft white +\$0

MT medium tone +\$0

WL sandstone +\$0

CN metallic champagne +\$40

EH metallic bronze +\$40

MS metallic silver +\$40

Bright Sand Texture Paint

For textured paint on smooth steel (XS)

91 white +\$0

CL cool grey neutral +\$0

WN warm grey neutral +\$0

Step 5. Lock

KA keyed alike +\$0

KC keyed differently, chrome +\$0

KD keyed differently, black +\$0

Step 6. Drawer Interior

NN none +\$0

5M pencil tray in box drawer, 2 file converters in file drawer +\$20

File Drawer Organizer

LG901

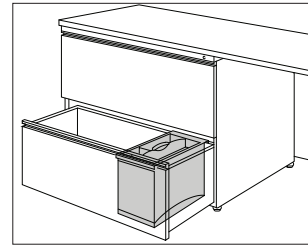

Specification Information

Step 1.

LG901 \$74

Ty® Metal Pedestals

Drawer Divider, Tu® Pedestal

LG903.

Stationery Divider, Tu® Pedestal

LG905

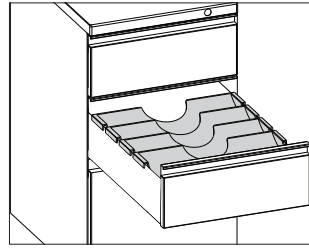
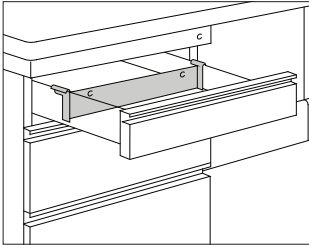

Tu® Metal Pedestals

Specification Information

Step 1.

LG903.

Step 2. Usage

3 for pencil drawer

6 for box drawer

Prices for Steps 1-2.

LG903. 3 \$15

6 \$16

Specification Information

Step 1.

LG905 \$53

Utility Tray, Tu® Pedestal

LG906

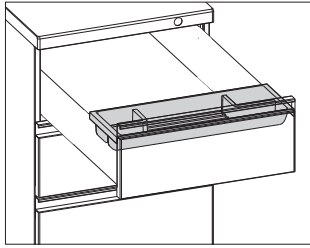

Specification Information

Step 1.

LG906

\$19

File Converter, Tu®

LG907

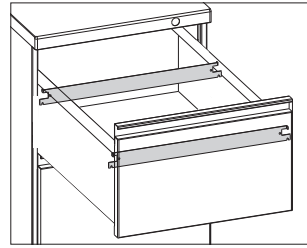

Specification Information

Step 1.

LG907

\$27

Tu® Metal Pedestals

File Compressor, Tu®

LG908

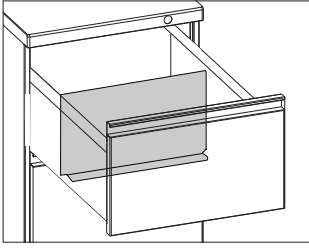

Tu® Metal Pedestals

Specification Information

Step 1.

LG908

\$44

Index by Product Name

Ethospace® System 10-Day or Less	
	page(s)
2-Way 90° Connector	13
2-Way 90° Connector Cover	21
2-Way 90° Connector Cover, Architectural	22
2-Way 90° Connector Cover, Monolithic	22
2-Way 90° Connector, Monolithic	14
2-Way 90° Stacking Connector	18
3-Way 90° Connector	16
3-Way 90° Connector Cover	25
3-Way 90° Connector Cover, Monolithic	25
3-Way 90° Connector, Monolithic	17
3-Way 90° Stacking Connector	19
4-Way 90° Connector	17
4-Way 90° Stacking Connector	19
Acoustical Tile	39
Architectural Cladding, Fabric	39
B-Style Flipper Door	60
B-Style Flipper Door Unit	59
B-Style Shelf	61
B-Style Storage/Display Shelf	61
Bare Connector	20
Bare Frame	5
Base Power Entry, Junction Box, 4 Circuit	29
Baseline Box Assembly, H-Style Frame	33
Baseline Harness, 4 Circuit	30
Beltline Bezel, H-Style Frame	36
Beltline Harness, 4 Circuit	31
C-Style Flipper Door	63
C-Style Flipper Door Unit	62
C-Style Shelf	64
Cable Access Tile	40
Cable Channel Tile	41
Cable Manager, Extra Capacity	35
Ceiling Power Entry, Internal Direct Connect	29
Coat Hook	70
Communication Port Faceplate Extender	36
Communication Port Faceplate Reducer	35
Component Brace	69
Concave Corner Surface	48
Connector Top Cap	27
Connect™-S300	34
Cord Cleat	56
Corner Surface	47
Curvilinear Surface	45
Draw Rod	9
E-Style Flipper Door	65

E-Style Flipper Door Unit	64
E-Style Shelf	65
Energy-Efficient Task Light	71
Extended Corner Surface, Rectangular End	50
F-Style Shelf	68
F-Style Sliding Door Storage Unit	66
F-Style Storage Unit Back Panel	68
F-Style Upmount Sliding Door Storage Unit	67
Face Tile	37
Finished End	26
Finished End, Change of Height	26
Floor-Length Face Tile	38
Frame	5
Frame Top Cap	27
Frame, Transaction Work Surface	7
Marker/Eraser Holder	43
Open Tile	41
Open Tile, Squared Stile	42
Oval Transaction Surface	56
Pass-Through Harness, Connector	31
Pass-Through Harness, Frame	30
Perforated Tile, Squares	42
Power Entry, External Direct Connect, 4 Circuit	28
Power Entry, Internal Direct Connect, 4 Circuit	28
Power Jumper, 4 Circuit	32
Rail Tile	43
Receptacle, 4 Circuit, 15 Amp	33
Rectangular Surface	44
Shelf Divider, Angled	69
Side Cover	8
Spacer	14
Spacer Connector Cover	23
Spacer Connector Cover, Monolithic	24
Spacer Stacking Connector	18
Spacer/3-Way 90° Connector Cover, Architectural	24
Squared-Edge Corner Wedge	51, 52
Squared-Edge Transaction Surface, Rectangular End	57
Stacking Frame	9
Stacking Frame Hardware Kit, Change of Height	20
Stiffener	55
Stile Covers and Top Caps, Transaction Work Surface Frame	7
Tackable Tile	40
Tile-Height Harness, 4 Circuit	32
Tile Adapter	10
Tool Bar	73
Trim Strip	11

Index by Product Name *continued*

Index: Product Name

Utility Task Light	72
Wall Fastener	11
Wall Start	12
Wall Start Filler	12
Wall Strip	10
Work Surface-Attached Electrical Distributor	34
Work Surface Support Bracket	54
Work Surface Support Panel, End, Glides	54
Work Surface Support Panel, Mid-Run, Glides	55
Work Surface Support, Single	53
Meridian® Pedestals 10-Day or Less	
Drawer Divider for Box Drawer, Meridian® Pedestal	page(s) 82
File Drawer Organizer	82
Pencil Tray for Box Drawer, Meridian® Pedestal	81
Sloped-Pull Freestanding Pedestal	79
Sloped-Pull Mobile Pedestal	80
Standard-Pull Freestanding Pedestal	77
Standard-Pull Mobile Pedestal	78
Standard-Pull Suspended Pedestal	79
Tu® Pedestals 10-Day or Less	
Drawer Divider, Tu® Pedestal	page(s) 94
File Compressor, Tu®	96
File Converter, Tu®	95
File Drawer Organizer	93
Stationery Divider, Tu® Pedestal	94
Utility Tray, Tu® Pedestal	95
V-Pull Freestanding Pedestal	86
V-Pull Mobile Pedestal	88
V-Pull Support Pedestal	91
V-Pull Suspended Pedestal	93
W-Pull Freestanding Pedestal	85
W-Pull Mobile Pedestal	87
W-Pull Support Pedestal	90
W-Pull Surface-Attached Pedestal	89
W-Pull Suspended Pedestal	92

Index by Product Number

73-15	Drawer Divider for Box Drawer, Meridian® Pedestal	page(s) 82	E1342.	Pass-Through Harness, Frame	30
73-15	Pencil Tray for Box Drawer, Meridian® Pedestal	81	E1353.	Beltline Harness, 4 Circuit	31
E1109.	Bare Frame	5	E1354.	Baseline Harness, 4 Circuit	30
E1109.	Frame	5	E1355.		
E1112.	Stacking Frame	9	E1356.	Pass-Through Harness, Connector	31
E1116.	Frame, Transaction Work Surface	7	E1357.	Tile-Height Harness, 4 Circuit	32
E1117.	Stile Covers and Top Caps, Transaction Work Surface Frame	7	E1396.	Cable Manager, Extra Capacity	35
E1120.	Draw Rod	9	E1420.	Face Tile	37
E1130.	Wall Strip	10	E1420.	Floor-Length Face Tile	38
E1131.	Tile Adapter	10	E1422.	Tackable Tile	40
E1132.	Trim Strip	11	E1423.	Acoustical Tile	39
E1210.	Wall Start	12	E1425.	Rail Tile	43
E1212.	Wall Start Filler	12	E1433.	Cable Channel Tile	41
E1219.	Bare Connector	20	E1436.	Cable Access Tile	40
E1220.	2-Way 90° Connector	13	E1440.	Open Tile	41
E1220.	2-Way 90° Stacking Connector	18	E1441.	Perforated Tile, Squares	42
E1222.	Spacer	14	E1444.	Open Tile, Squared Stile	42
E1222.	Spacer Stacking Connector	18	E1445.	Architectural Cladding, Fabric	39
E1224.	2-Way 90° Connector, Monolithic	14	E2290.	Work Surface Support Panel, End, Glides	54
E1230.	3-Way 90° Connector	16	E2291.	Work Surface Support Panel, Mid-Run, Glides	55
E1230.	3-Way 90° Stacking Connector	19	E2393.	Work Surface Support, Single	53
E1231.	3-Way 90° Connector, Monolithic	17	E2810.	Oval Transaction Surface	56
E1240.	4-Way 90° Connector	17	E2812.	Squared-Edge Transaction Surface, Rectangular End	57
E1240.	4-Way 90° Stacking Connector	19	E2931.	Work Surface Support Bracket	54
E1250.	Finished End	26	E3110.	E-Style Flipper Door Unit	64
E1251.	Finished End, Change of Height	26	E3130.	E-Style Shelf	65
E1260.	Frame Top Cap	27	E3133.		
E1261.	Connector Top Cap	27	E3212.	B-Style Flipper Door Unit	59
E1263.	Side Cover	8	E3217.	B-Style Flipper Door	60
E1264.			E3230.	B-Style Shelf	61
E1270.	2-Way 90° Connector Cover	21	E3231.		
E1271.	Spacer Connector Cover	23	E3232.	B-Style Storage/Display Shelf	61
E1272.	3-Way 90° Connector Cover	25	E3610.	Tool Bar	73
E1274.	2-Way 90° Connector Cover, Monolithic	22	E3810.	F-Style Sliding Door Storage Unit	66
E1275.	Spacer Connector Cover, Monolithic	24	E3811.	F-Style Shelf	68
E1276.	3-Way 90° Connector Cover, Monolithic	25	E3812.	F-Style Storage Unit Back Panel	68
E1281.	2-Way 90° Connector Cover, Architectural	22	E3814.	F-Style Upmount Sliding Door Storage Unit	67
E1282.	Spacer/3-Way 90° Connector Cover, Architectural	24	E3922.	Coat Hook	70
E1293.	Stacking Frame Hardware Kit, Change of Height	20	E9002.	E-Style Flipper Door	65
E1294.			EW400.	Baseline Box Assembly, H-Style Frame	33
E1311.	Receptacle, 4 Circuit, 15 Amp	33	EWS10.	Rectangular Surface	44
E1322.	Power Entry, External Direct Connect, 4 Circuit	28	EWS12.	Curvilinear Surface	45
E1323.	Base Power Entry, Junction Box, 4 Circuit	29	EWS20.	Corner Surface	47
E1325.	Power Entry, Internal Direct Connect, 4 Circuit	28	EWS21.	Concave Corner Surface	48
E1331.	Ceiling Power Entry, Internal Direct Connect	29	EWS22.	Extended Corner Surface, Rectangular End	50
E1341.	Power Jumper, 4 Circuit	32	F16-1	Standard-Pull Freestanding Pedestal	77

Index by Product Number *continued*

Index: Product Number

F19P-	Sloped-Pull Freestanding Pedestal	79
FV696.	Stiffener	55
G1189.	Communication Port Faceplate Extender	36
G1189.	Communication Port Faceplate Reducer	35
G1331.	Cord Cleat	56
G1510.	Beltline Bezel, H-Style Frame	36
G6120.	Energy-Efficient Task Light	71
G6121.		
G6123.		
G6136.	Utility Task Light	72
G6137.		
G7330.	Shelf Divider, Angled	69
LG901	File Drawer Organizer	82, 93
LG903.	Drawer Divider, Tu® Pedestal	94
LG905	Stationery Divider, Tu® Pedestal	94
LG906	Utility Tray, Tu® Pedestal	95
LG907	File Converter, Tu®	95
LG908	File Compressor, Tu®	96
LV100.	V-Pull Freestanding Pedestal	86
LV110.	V-Pull Mobile Pedestal	88
LV130.	V-Pull Suspended Pedestal	93
LV150.	V-Pull Support Pedestal	91
LW100.	W-Pull Freestanding Pedestal	85
LW110.	W-Pull Mobile Pedestal	87
LW130.	W-Pull Suspended Pedestal	92
LW140.	W-Pull Surface-Attached Pedestal	89
LW150.	W-Pull Support Pedestal	90
M16-1	Standard-Pull Mobile Pedestal	78
M19P-	Sloped-Pull Mobile Pedestal	80
S16-1	Standard-Pull Suspended Pedestal	79
X1192.	Wall Fastener	11
X3710.	C-Style Flipper Door	63
X3730.	C-Style Shelf	64
X3750.	C-Style Flipper Door Unit	62
X3910.	Component Brace	69
Y1314.	Work Surface-Attached Electrical Distributor	34
Y1323.	Connect™-S300	34
Y2091.	Squared-Edge Corner Wedge	51, 52
Y7231.	Marker/Eraser Holder	43

10-Day or Less Order Information

10-Day or Less Program

10-day or less products are designed for established Herman Miller dealers with pre-approved credit.

Products are distributed from multiple West Michigan manufacturing facilities. These include Holland, Spring Lake, and Zeeland. Orders will be shipped within 10 business days or less from the date of Herman Miller acknowledgement.

Ordering Procedures

1. Please place orders through Order Manager. If this is not available to you, place orders through mail or fax. Verbal purchase orders will not be accepted.
Order Entry fax number for Passage®, 5000 Series, and Meridian® Filing and Storage: (616) 846 9236.
Order Entry fax number for all other products: (616) 654 3085.
2. Orders must be clearly marked “10-day or less program” and include only 10-day or less products. Orders not marked this way will be processed under standard lead times. Orders for standard lead times must be placed on a separate purchase order.
3. Only fabrics and finishes listed with each product are available through the 10-day or less program.
4. For any 10-day or less project over \$250,000 list price, please contact your Customer Care representative within 48 hours of order entry to reserve lead time.
5. For more information, contact your Customer Care representative at: (866) 854 3048 EXT 3400.

Shipments and Delivery

Per Herman Miller Terms and Conditions.

Changes and Cancellation

Per Herman Miller Terms and Conditions.



10-Day Keyed-Alike Information

Keyed-Alike Locks

All components with locks may be specified keyed alike. Products with keyed-alike locks will be shipped with lock chassis installed. Installation of lock cylinders will be on-site according to instructions provided. Herman Miller, Inc. will not be responsible for lock cylinder installation.

When specifying product keyed-alike, include separate lines on your order for the lock cylinders.

For Action Office®, Ethospace®, and Passage® products, list cylinder part number and key number (232092-XXX); select a key number (or numbers) between 226 and 427, excluding numbers 408 and 412.

For Meridian® Storage or 5000 Series, see the following charts.

Keyed-alike locks are field installed.

To order keyed-alike locks for Action Office® Series 1 and 2 door panels, please contact Customer Care.

A master key can be used to open any lock on an attached or freestanding component. In addition, a removal key or lock change tool is required to remove lock plugs. Customers interested in ordering master keys, removal keys, or lock change tools should contact Customer Care.

For Meridian Storage or 5000 Series desk components with pedestals, specify as follows:

Specification Code	Key Number	Color	Lock Series
KA	232092-XXX ¹	black	UM series 226-427
KA	1B2JK7-XXX ¹	chrome	UM series 226-427

For 5000 Series flipper door unit with bezel or credenza storage cabinet with bezel, specify as follows:

Specification Code	Key Number	Color	Lock Series
KA	232092-XXX ¹	black	UM series 226-427

Key Number:

XXX¹ = a key number between 226 and 427 (excluding 408 and 412)



Proprietary Textiles Application Chart – 10-Day Workspaces

- Available

Application Note: Herman Miller cannot guarantee material/pattern alignment in adjacent products. For example, a fabric's pattern may not align from one screen to the next, or from one panel to the next.

	Action Office® Panels/Connectors	B-Style Flipper Doors	B-Style Tackboards	E-Style Flipper Doors	Ethospace® Tiles/Connectors	Ethospace Attaching Screens	Canvas Office Landscape™ Tiles	Resolve® Boundary Screens	5000 Series Storage and Tackboards	Seating
Price Category 1										
8A__ Bubbletack								•		
2V__ Chain	•	•	•	•	•		22		3	
8T__ Crossing (85__)	5	2	2	•			•		3	6
95__ Gem	2	2	2	•	•		•		3	•
2I__ Grasscloth	•	•	•	•	•		•		3	
8B__ Multiscrim™						•		•		
5T__ Resonance	•	•	•	•	•		•		3	
8C__ Scrim Trim								•		
2M__ Silkworm	•	•	•	•	•		•		3	
Price Category 2										
51__ Cord	•	•	•	•	•		•		3	
92__ Crepe	2	•	•	•	•		•		3	•
57__ Frost	•	•	•	•	•		•		3	
84__ Grosgrain	5			•	•		•		3	
4N__ Horizon	2	2	2	•	•		•		3	
1LM__ Loom	•	•	•	•			•			
3A__ Moiré		2	2	•	•		22		3	
8R__ Twist (5S__)	4	2	2	•	•		•		3	6
Price Category 3										
70__ Bento	2	2	2	•			•		3	•
8Z__ Glaze	•	•	•	•	•		•		3	
47__ Ground Cloth®	•	•	•	•	•		•		3	
5D__ Kira 2	2	2	2	•	•		•		3	
8L__ Savannah	•	20	•	•	•		•	•		
8U__ Stitches (5Z__)									3	6
8W__ Strands	•	•	•	•	•		•		3	
Price Category 4										
65__ Quilty	2	2	2	•	•		•		3	
63__ Sironetta	•	•	•	•	•		•		3	

- 2 Available on all products except 54" and 60" wide.
- 3 Fabric is railroaded for all widths.
- 4 Not available on Action Office acoustical panels and not available on 54" and 60" wide products.
- 5 Not available on Action Office acoustical panels.
- 6 Available on seating products in select colors. See the "Proprietary Textile Colors-10-Day Seating" appendix.

- 10 Not available on Action Office connectors, cable management, and spacers.
- 20 Available only on Ethospace B-Style.
- 22 Not available as railroaded application option for Chain (2V__) and Moiré (3A__).



Proprietary Textile Colors – 10-Day Workspaces

Price Category 1

Bubbletack
100% polyester
8A01 Seashell White
8A02 Pearl Grey
8A07 Pebble Beige
8A19 Spa Blue

Chain
66" wide
100% recycled polyester
2V01 Pearl
2V02 Oyster
2V03 Wheat
2V04 Linen
2V05 Wicker
2V06 Bamboo
2V07 Sage
2V08 Spring Wood
2V09 Iceberg

Crossing
54" wide
86% antimony-free polyester
14% polyester
8T03 Wicker
8T04 Porcelain
8T05 Warm Grey
8T06 Sepia
8T07 Pumpkin
8T08 Copper
8T09 Cranberry
8T10 Tomato
8T11 Mulberry
8T12 Plum
8T13 Green Apple
8T14 Loden
8T15 Spruce
8T16 Periwinkle
8T17 Cerulean
8T18 Indigo
8T19 Shale
8T20 Brownstone
8T21 Bark
8T22 Tin
8T23 Graphite
8T24 Black

Crossing
For systems products only.
54" wide
86% antimony-free polyester
14% polyester
8501 Ivory
8502 Oyster

Gem
54" wide
100% antimony-free polyester
9501 Sesame
9502 Tangerine
9503 Red
9510 Berry Blue
9512 Green Apple
9514 Black
9515 Slate Grey
9516 Fog

Grasscloth
66" wide
100% recycled polyester
2I01 Silver Birch
2I02 Pampas
2I03 Sedge
2I07 Lea
2I08 Taro
2I09 Steam Grey
2I10 Cayenne
2I11 Bottle Green
2I12 Surf
2I13 Gravel

Multiscrim™
60" wide
100% polyester
8B01 Seashell White
8B02 Pearl Grey
8B07 Pebble Beige
8B19 Spa Blue

Resonance
66" wide
100% polyester
5T04 Greige
5T05 Porcelain
5T06 Alabaster
5T15 Iris
5T28 Sugar
5T54 Saltbush

Scrim Trim
61" wide
82% polyester
18% spandex
8C01 Seashell White
8C02 Pearl Grey

Silkworm
66" wide
58% recycled polyester
42% polyester
2M01 Cocoon
2M02 Pongee
2M03 Saffron
2M04 Tussah
2M05 Ceylon
2M06 Jasmine
2M07 Shale
2M08 Monsoon

Price Category 2

Cord
66" wide
52% antimony-free polyester
48% polyester
5101 Ivory
5102 White Ash
5103 Linen
5104 Bamboo
5105 Sepia
5106 Wicker
5107 Sesame
5108 Kiwi Green
5109 Bayou
5110 Shade
5111 Spring Wood
5112 Summer White

Crepe
54" wide
100% recycled polyester
9201 Licorice
9203 Smoke
9209 Claret
9223 Cadet
9241 Beachglass
9243 Midnight
9244 Artichoke
9251 Fog
9252 Slate Grey
9260 Brownstone
9261 Shale
9262 Graphite
9263 Tomato
9264 Green Apple

Frost
66" wide
100% recycled polyester
5701 Bisque
5702 Abalone
5703 Porcelain
5704 Honey
5706 Sage
5710 Sable Grey

Proprietary Textile Colors – 10-Day Workspaces

continued

Price Category 2

continued

Grosgrain

66" wide
100% recycled polyester
8401 Pearl
8402 White Ash
8403 Warm Grey
8404 Khaki
8405 Oyster
8406 Celedon
8412 Tin

Horizon

54" wide
65% antimony-free polyester
35% polyester
4N01 Rye Grass
4N02 Sugar Pine
4N04 White Ash
4N05 Spring Wood
4N09 Oat Grass

Loom

54" wide
100% polyester
1LM01 Linen
1LM02 Brown Sugar and Spice
1LM03 Brick and Mortar
1LM04 Salt and Pepper
1LM07 Poppy
1LM09 Loden
1LM11 Deep Sea

Moiré

54" wide
100% recycled polyester
3A01 Concrete
3A03 Rattan
3A04 Chambray
3A12 Cork

Twist

54" wide
80% antimony-free polyester
13% recycled polyester
7% polyester
8R05 Wicker
8R10 Poppy
8R14 Tin
8R15 Shale
8R16 Graphite
8R17 Birch
8R18 Sepia
8R22 Blueberry
8R23 Green Apple
8R26 Gunmetal
8R28 Citrus
8R30 Tangerine
8R32 Wisteria
8R35 Waterfall
8R37 Carbon Dark

Twist

For systems products only.
54" wide
80% antimony-free polyester
13% recycled polyester
7% polyester
5S01 Pearl
5S02 Ivory
5S03 Oyster

Price Category 3

Bento

54" wide
100% antimony-free polyester
7001 Frost
7003 Khaki
7004 Truffle

Glaze

66" wide
100% recycled polyester
8Z01 Wicker
8Z03 Porcelain
8Z06 Rye
8Z07 Frost
8Z08 Silver Birch

Ground Cloth®

66" wide
100% polyester
4701 Vapor Grey
4721 Warm White
4722 Fog
4723 Straw
4724 Red Orange
4725 Wild Berry
4726 Green Apple
4727 Caribbean
4728 Midnight
4729 Cappuccino

Kira 2

54" wide
100% recycled polyester
5D13 Oasis
5D15 Ash
5D16 Falcon

Savannah

66" wide
76% recycled polyester
24% polypropelene
8L01 Pearl
8L07 Linen
8L10 Frost

Strands

66" wide
100% recycled polyester
8W01 Pebble
8W02 Porcelain
8W03 Taupe
8W05 Khaki
8W08 Tin

Proprietary Textile Colors – 10-Day Workspaces

continued

Price Category 4

Quilty

56" wide

100% antimony-free polyester

GreenShield

6S04 Straw

6S07 Brick

6S10 Mink

6S11 Green Apple

6S13 Indigo

Sironetta

66" wide

100% recycled polyester

6301 Acapella

6302 Sonata

6303 Interlude

6308 Harmony

For more information about our products and services or to see a list of dealers, please visit us at HermanMiller.com or call (800) 851 1196.

This book is recyclable. Printed in U.S.A. on recycled paper.

© 2017 Herman Miller, Inc., Zeeland, Michigan

® **HermanMiller**, , Action Office, Aeron, Aside, Avive, Canvas Office Landscape, Caper, Celle, Co/Struc, Eames, Embody, Equa 2, Ergon 3, Ethospace, Exclave, Fine-Tune, FlexFront, Formcoat, Ground Cloth, Herman Miller Healthcare, Layout Studio, Maharam, Meridian, Mirra, Passage, Pellicle, Perspectives, PostureFit, Resolve, Sayl, Setu, Thrive, Tu, Y-Tower, and Z-Axis are among the registered trademarks of Herman Miller, Inc., and its owned subsidiaries.

™ AireWeave, Bubbletack, Cellular Suspension, Compass, Connect, DOT, Durawrap, Everywhere, Flex-Edge, Hopsak 2, Iota, Keyless Entry, Latitude, Lyris 2, Motia, Multiscrim, Nelson, Renew, Stackable, Swoop, TriFlex, and Twist are among the trademarks of Herman Miller, Inc., and its owned subsidiaries.

®Chemsurf® is a registered trademark of Wilsonart International.

®Corian® is a registered trademark of E.I. du Pont de Nemours and Company Corporation.

FLEXNET™ is a trademark of Milliken & Company.

Floor Saver Glide® is a registered trademark of Carpin Manufacturing, Inc.

®Geiger® is a registered trademark of Geiger International.

®Microsoft® and Natural® Keyboard are registered trademarks of Microsoft Corporation.

®Place Textiles® is a registered trademark of Place Textiles.