



# Systems Task Lighting



## ILLUMINATING THE TASK AT HAND

There's more to lighting than turning on a switch. Research over the years has documented that the quality of people's work is directly related to the quality of the lighting. What's more, people with control over their lighting consistently report greater satisfaction with their work environment. Herman Miller's task lights allow you to focus light where you need it, when you want it. For performance, dependability, and energy efficiency in lighting, we have a lot to offer.

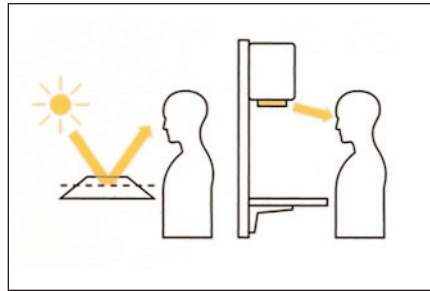

Figure 1

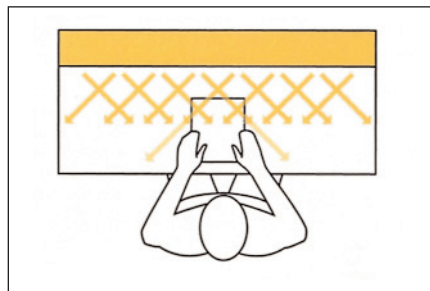

Figure 2

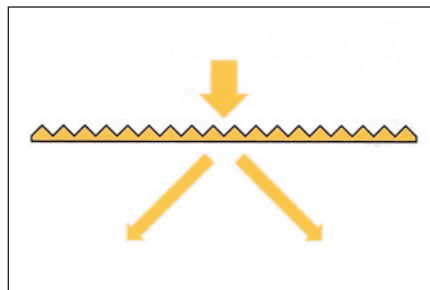

Figure 3

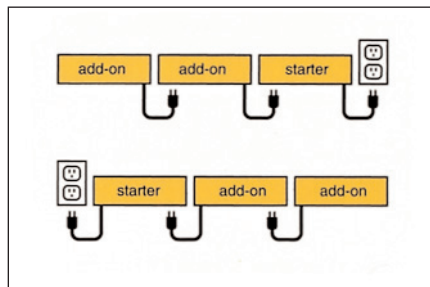

Figure 4

### REDUCING GLARE

When light strikes a page or computer screen at a certain angle, or if it shines directly into your eyes, it causes glare (figure 1). Glare reduces the “task contrast” of the work—making the detail of text and graphics blend with the background.

Good lighting reduces glare by reflecting and redirecting light so it strikes the work surface at optimal angles. Certain lighting features, like lenses, are key to producing bright, consistent illumination, which is better for your eyes (figure 2).

### TASK LIGHT FEATURES

Herman Miller's line of systems task lights are UL listed and CSA certified. Their finishes coordinate with a variety of systems colors, materials, and finishes, except for the utility task light, which comes in black. All our task lights have several features to help you see the work at hand:

**Lenses.** Three high-quality lenses are offered to help minimize glare. The prismatic lens contains a pattern of pyramid-shaped prisms used to distribute light. The batwing directs light through special prisms at specific angles (figure 3). The Holophane® lens uses a series of focal lenses to distribute the light directly on the task area, controlling both direct and indirect glare.

**Lamps.** Herman Miller offers either a T5 or T8 fluorescent lamp. T5 lamps are smaller in diameter and require less power to start up. Both fluorescent lamps are energy-efficient and provide exceptional color rendition. They typically perform for more than 20,000 hours of operation.

**Ballasts.** A ballast is the device that starts the fluorescent lamp and regulates its flow of electricity. Electronic ballasts consume no electricity when the lamp is on, and they can help the lamp operate more efficiently.

**Daisy chain system.** To operate a run of lights from one power source, a daisy chain system—a series of add-on units—is plugged into one starter unit that can operate multiple lights from a single outlet (figure 4). The starter and add-on units have independent on/off switches.

**Dimmers.** Lower lighting levels use less energy and may be more comfortable for some types of work, such as computer use. Dimmers allow you to adapt the light level to the task, and conserve energy at the same time.



Luminsoft task light



### LUMISOFT TASK LIGHT

The Lumisoft task light has a patented optical system that effectively eliminates glare. A metal shield blocks and redirects light through two batwing lenses, which reflect light indirectly onto the work surface. The back lens also directly illuminates the surrounding vertical surfaces. An energy-efficient, high-power-factor electronic ballast and T8 lamp are standard. The Lumisoft undershelf task light mounts beneath a flipper door unit or shelf. The three-step dimmer and daisy-chain system, which operates up to eight lights, are optional features.



Performance task light



### PERFORMANCE TASK LIGHT

The performance task light (also shown on the cover page) has a T5 lamp, batwing lens, and the option for a normal-power-factor electronic ballast or high-power-factor electronic ballast. This undershelf light mounts beneath a flipper door unit, shelf, or countertop to light a work area. Its daisy-chain system operates up to 10 lights.



Energy-efficient task light



### ENERGY-EFFICIENT TASK LIGHT

The energy-efficient task light has a T8 lamp, batwing lens, and a normal-power-factor electronic ballast. A three-step dimmer for optimizing energy usage is optional. This undershelf light mounts beneath a flipper door unit or shelf.



Utility task light



### UTILITY TASK LIGHT

Herman Miller's utility task light offers a good blend of quality and value with its standard prismatic lens, T5 lamp, and electronic ballast. This undershelf light mounts beneath a flipper door unit, shelf or countertop.



Panel-mounted task light

#### PANEL-MOUNTED TASK LIGHT

Unique in task lights, this panel-mounted fixture attaches directly to most Herman Miller panels or frames to equip a workstation with task lighting regardless of panel/frame height. Wider lights may also be mounted on smaller panels or frames—a 48-inch-wide light on a 24-inch-wide panel, for example. A batwing lens with an overlay provides virtually glare-free illumination. A T5 lamp and high-power-factor electronic ballast are standard.



Linear task light

#### LINEAR TASK LIGHT

The linear panel-mounted task light attaches to any Herman Miller frame or monorail. This light comes with a T5 lamp, a refractive Holophane lens, and an electronic ballast.

Task Light	Lens Style	Unit Width	Unit Thickness	Lamp	Cord Exit	Switch Location	Compatible Systems
<b>Lumisoft</b>	dual batwing	28", 34", 40", 46", 58"	2"	T8	center	center	Action Office®, C-style storage, Ethospace®
<b>Performance</b>	batwing	13", 24", 35", 59"	1¼"	T5	left-hand	off-center (left)	Action Office, C-style storage, Ethospace, Passage®, Prospects®, Vivo®, 5000 Series
<b>Energy-efficient</b>	batwing	20¾", 26¾", 32¾", 38¾", 44¾", 56¾"	1¼"	T8	right-hand	center	Action Office, C-style storage, Ethospace, Passage, Prospects, Vivo, 5000 Series
<b>Utility</b>	prismatic	13", 24", 35", 59"	1¼"	T5	left-hand	off-center (left)	Action Office, C-style storage, Ethospace, Passage, Prospects, Vivo, 5000 Series
<b>Panel-mounted</b>	batwing	30", 36", 42", 48"	1¼"	T5	right-hand	right-hand	Action Office, Ethospace, Passage, Prospects, Vivo
<b>Linear</b>	Holophane	30", 36", 42", 48"	1¼"	T5	right-hand	right-hand	Ethospace, Vivo

#### WARRANTY

##### 12-Year, 3-Shift Warranty

Herman Miller systems task lights are durable for a long life and carry a comprehensive, 12-year, 3-shift warranty.

##### 5-Year Warranty

Electronic ballasts used in task lighting carry a 5-year warranty.

#### EASY OPTIONS<sup>SM</sup> CAPABILITY

Our versatile, flexible products give people real choices. If they need something extra, we can do that, too, from modifying existing products to developing new ones. For more information on our Easy Options capability, please visit [www.HermanMiller.com/easyoptions](http://www.HermanMiller.com/easyoptions).

For more information about our products and services or to see a list of dealers, please visit us at [www.HermanMiller.com](http://www.HermanMiller.com) or call (800) 851 1196.

© 2007 Herman Miller, Inc. Zeeland, Michigan

®  Herman Miller, Action Office, Ethospace, Passage, Prospects, and Vivo are among the registered trademarks of Herman Miller, Inc.

® Holophane is a registered trademark of Holophane.