

DESCRIPTION

The Lumière Eon LED 303-W1-LEDB1 is a compact, low profile, dimmable LED direct and indirect luminaire providing both uplight and downlight simultaneously. The luminaire features full vertical adjustment (180°) for easy aiming and mounts directly to any wall or ceiling surface over a standard 4" square junction box. It is standard with a universal input LED driver (120 - 277V, 50/60 Hz). Dimming is achieved with a standard ELV, reverse phase dimming driver or an optional 0-10V dimming driver. 303-W1-LEDB1 may be used indoors or outdoors and carries an IP66 rating.

Catalog #		Type
Project		
Comments		Date
Prepared by		

SPECIFICATION FEATURES

Construction

Head and back plate are precision machined from corrosion-resistant 6061-T6 aluminum. A universal mounting plate and one piece silicone key hole gasket is provided for adaption to junction box or surface. Stainless steel hardware is included.

Mounting

The luminaire mounts directly to a standard 4" square junction box. For further mounting information see technical notes section on page 2.

Optical

LightBAR™ and optical assembly are sealed by a diffused, impact resistant tempered glass lens. The uplight portion is always a T5X (Extra Wide Flood), while

the downlight portion is available in three distributions: T2 (lateral throw), T4 (forward throw) and T5X. The optical assembly is available in several color temperatures: 2700K, 3000K, 3500K, 4000K and TSAM (Amber). Both color temperature and distribution must be specified when ordering – see catalog logic for details. The specified distribution (T2, T4 or T5X) is associated with the downlight. An edge-lit option is available.

Electrical

The 8.5W 303-W2-LEDB2 is standard with an ELV trailing edge phase dimmable driver that accepts a universal input (120-277, 50/60Hz). It will operate in -40°C to 50°C [-40°F to 122°F]. The driver incorporates surge protection. An optional 0-10V dimming driver is also available.

Finish

The luminaires are double protected by a RoHS compliant chemical film undercoating and polyester powder coat paint finish, surpassing the rigorous demands of the outdoor environment. A variety of standard colors are available. RAL and custom color matches available upon request. Luminaires can also be brushed with a clear coat finish. The LightBAR™ cover plates are standard white and may be specified to match finish of luminaire housing (LCF).

Warranty

Lumière warrants the EON series of fixtures against defects in material and workmanship for five (5) years. Auxiliary equipment such as LED drivers carries the original manufacturer's warranty.



303-W2-LEDB2 EON LED

APPLICATIONS:
CEILING / WALL MOUNT
DIRECT - INDIRECT

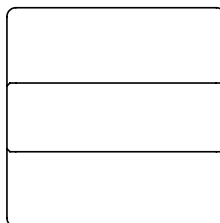
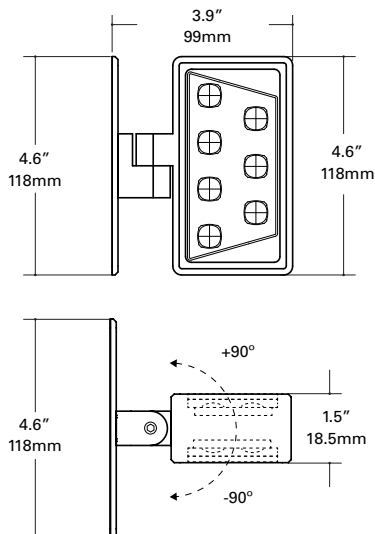

CERTIFICATION DATA

UL and cUL Wet Location Listed
LM79 / LM80 Compliant
ROHS Compliant
IP66 Ingressed Protection Rated

TECHNICAL DATA

35°C Maximum Temperature Rating
External Supply Wiring 90°C Minimum

ORDERING INFORMATION

Sample Number: 303-W2-LEDB2-2700-UNV-T2-DIM10-BK-EDGE

Series	Color Temperature	Input Voltage	Optics	Dimming	Finish ¹	Options ^{2,3}
303-W2-LEDB2 Head contains two (2) Mini LightBAR™ - one on top and bottom.	2700=2700K 3000=3000K 3500=3500K 4000=4000K TSAM =Turtle Safe Amber (585-595nm)	UNV=Universal 120-277, 50/60Hz	T2=Type II, Lateral Throw T4=Type IV, Forward Throw T5X=Type V, Extra Wide Flood	DIMELV=Trailing Edge Phase DIM10=0-10V Dimming	Painted BK=Black BZ=Bronze CS=City Silver WT=White Premium Finish BA=Brushed NSS=Solid Stainless Steel	EDGE=Edge lit glass lens LCF=LightBAR cover plate matches housing finish

NOTES: 1 Custom and RAL color matching available upon request. Consult factory for further information. 2 Add suffix in the order shown. 3 LCF option not available when WT (white) finish is selected.

LUMEN MAINTENANCE

Ambient Temperature	TM-21 Lumen Maintenance (72,000 Hours)	TM-21 Reported L70(10k) (Hours)	Theoretical L70 (Hours)
25°C	> 94%	> 60,000	365,000
40°C			
50°C			

CURRENT DRAW

Model	Line Voltage	Current Draw
303-W2-LEDB2	120-277V, 50/60Hz	0.13A

LUMENS - CRI/CCT TABLE

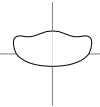
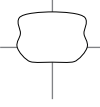
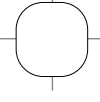
Optic Type	Distribution	Watts	Delivered Lumens ¹	LPW	CCT (K) / Color	CRI nom. / Wavelength
T2 (Lateral Throw)		15.5	696	45	2700	95
			1156	75	3000	75
			808	52	3500	85
			1274	82	4000	75
		12.1	354	29	TSAM (Amber)	585-595nm
T4 (Forward Throw)		15.5	653	42	2700	95
			1084	70	3000	75
			758	49	3500	80
			1195	77	4000	75
		12.1	332	28	TSAM (Amber)	585-595nm
T5X (Extra Wide Flood)		15.5	731	47	2700	95
			1214	79	3000	75
			849	55	3500	85
			1338	87	4000	75
		12.1	372	31	TSAM (Amber)	585-595nm

NOTES: 1 When the LCF option is selected use a lumen multiplier of .85

OPTIONS

Edge

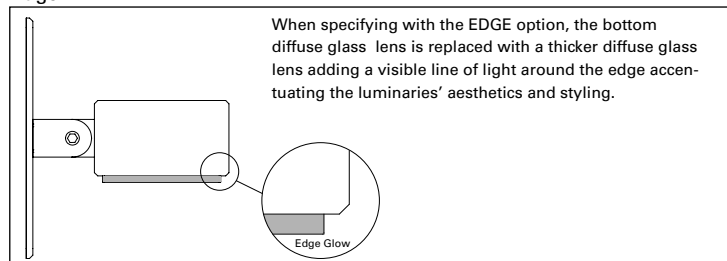

TECHNICAL NOTES

- Junction box size and depth is important when specifying product. Recommended junction boxes include 2-1/8" deep, 4" square weld/drawn Crouse Hinds part numbers TP403, TP434, TP494, TP196, TP395 or equivalent. Use with included universal mounting plate or with Crouse-Hinds part number TP480 or equivalent cover with similar fixture mounting locations.
- The universal wall plate provided with all EON wall mount fixtures can be used with an outdoor rated two gang 30.5 cubic inch capacity outlet box. Cooper Crouse-Hinds part numbers TP7086 – TP7122 or equivalent. The universal mounting plate will attach with four (4) 6-32 pan head/flat stainless steel screws (not provided).
- Driver can be remote mounted in a junction box a max distance of 25 feet (voltage drop needs to be considered) or placed in the junction box behind the luminaire.
- When specifying with the EDGE option, the diffused glass becomes thicker adding a visible line of light around the edge accentuating the luminaires' aesthetics and styling.
- If Luminaire will not be dimmed, the Luminaire must be ordered with DIMELV option, but does not have to be dimmed.
- Driver Dimensions:

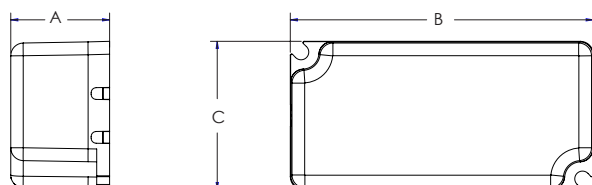

Luminaire Type	Dimming Type	Driver Dimensions in [mm]		
		A	B	C
303-W2-LEDB2	DIMELV	.98 [25.0]	3.36 [85.3]	1.49 [37.9]
	DIM10	1.18 [30.0]	3.49 [88.6]	1.64 [41.6]