

DESCRIPTION

The next generation addition to the Iridium family, the direct-indirect i2 series, offers a generous open center aperture for maximum versatility in optics, lamping and distribution. The i2 is also available with adjustable uplight and downlight optics for evolving interior spaces with Corelite's Slide-N-Lock (TM) optics accessory. i2 may be mounted individually or continuously with 4' and 8' modular sections. Luminaires align with T-Grid and interface with all ceiling types. The i2 is ideally suited for open offices, conference rooms, classrooms, libraries, labs and public spaces.

Catalog #		Type
Project		
Comments		Date
Prepared by		

SPECIFICATION FEATURES

A ... Construction

Housing is one piece die-formed cold rolled steel, forming a 9" x 2-1/2" architectural profile. Standard 4'-0" and 8'-0" fixture lengths combine for continuous runs.

B ... End Caps

Standard Straight and optional Beveled end caps are precision die-cast aluminum mechanically attached without exposed fasteners.

C ... Perf Inlay

Inlay is comprised of 0.025" perforated white powder coat aluminum and frosted acrylic backing.

D ... Reflectors

Reflector pan is painted with a high reflectance white powder coat finish. Optional die-formed side reflectors are highly specular anodized aluminum.

E ... Electrical

Fixtures are prewired with quick wire connectors and use UL listed Class P, 265ma T8 instant start universal voltage electronic ballasts. Power factor of 95% with less than 10% THD. Fixtures and electrical components certified to UL and CUL standards.

F ... Finish

Fixture housings are standard white using electrostatically applied polyester powder coat paint.

Mounting

Standard aircraft cable mounts on 4'-0" and 8'-0" centers. Refer to installation section for various ceiling interface details and rigid pendant mounting details.

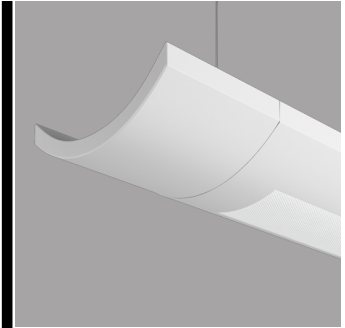

i2 Perf Inlay

3T8

Suspended
Semi-Indirect

Light Distribution
Indirect - 87.8%
Direct - 12.2%

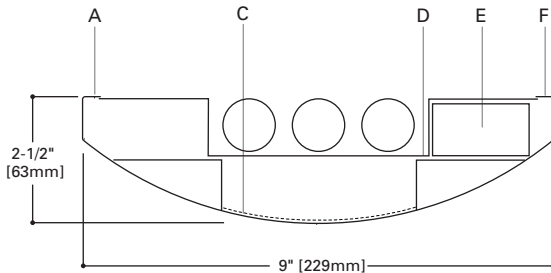

MODULES AND DIMENSIONS*

48" [1219mm]

96" [2438mm]

*Dimensions do not include end caps.

Standard Straight End Cap

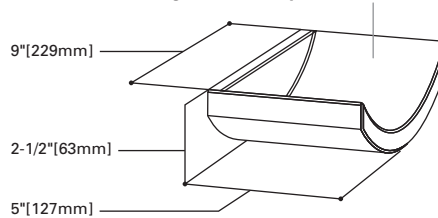

Beveled End Cap

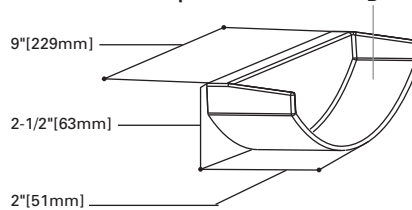

ORDERING INFORMATION

Sample Number: I2-WD-3T8-1C-UNV-AC48-T1-12-ES

Series I2: i2 Suspended	Number of Lamps 3: 3 Lamps	Wiring ¹ B: Battery Pack C: Standard Circuit D: Dimming E: Emergency T: Nightlight Y: Daylight	Voltage ¹ 120: 120V 277: 277V 347: 347V UNV: Universal (120V-277V)	Suspension A: Aircraft Cable	Ceiling Type T1: 1" T-Bar T9: 9/16" T-Bar TS: Slotted T-Bar ST: Structure JB: 4" Octagonal J-Box
Optics Up S: Specular W: White	Lamp Type T8: T8 Normal Output			Power Feed ¹ C: Straight Cord K: Curly Cord	Run Length Individually Mounted Luminaires may be 4' or 8' in length Continuously Mounted Standard row configurations over 8' consist of 4' and 8' sections
Optics Down D: Perf Inlay	Number of Circuits ¹ 1: 1 Circuit 2: 2 Circuits			Suspension Length Adjustable Cable 48", 120", 240", 300", or 360" (infinite adjustment along entire length of cable)	

Notes: 1 Not all options available. Please consult your Cooper Lighting Representative for availability.

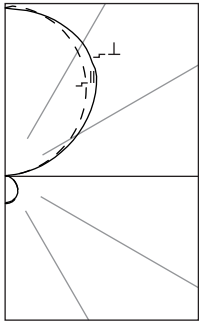

I2-WD-3T8
(3) F32T8/TL835
3000 Lumens

Efficiency 81.8%

Test Report
#LSI26355

Coefficients of Utilization

rc	Effective floor cavity reflectance												20%																				
	80%				70%				50%				30%				10%				0%												
rw	70	50	30	10	70	50	30	10	50	30	10	50	30	10	50	30	10	50	30	10	50	30	10	50	30	10	50	30	10	50	30	10	
RCR	0	80	80	80	80	70	70	70	70	51	51	51	34	34	34	18	18	18	10	10	10	10	10	10	10	10	10	10	10	10	10	10	10
	1	73	70	67	64	64	61	59	56	45	43	42	29	29	28	15	15	15	8	8	8	8	8	8	8	8	8	8	8	8	8	8	8
	2	67	61	56	52	58	53	50	46	39	37	34	26	24	23	14	13	12	7	7	7	7	7	7	7	7	7	7	7	7	7	7	7
	3	61	53	48	43	53	47	42	39	34	31	29	23	21	20	12	11	11	6	6	6	6	6	6	6	6	6	6	6	6	6	6	6
	4	55	47	41	37	48	41	36	32	30	27	24	20	18	17	11	10	9	5	5	5	5	5	5	5	5	5	5	5	5	5	5	5
	5	51	42	36	31	44	37	32	28	27	24	21	18	16	14	10	9	8	5	5	5	5	5	5	5	5	5	5	5	5	5	5	5
	6	47	37	31	27	40	33	28	24	24	21	18	16	14	12	9	8	7	4	4	4	4	4	4	4	4	4	4	4	4	4	4	4
	7	43	33	27	23	37	29	24	21	22	18	16	15	12	11	8	7	6	4	4	4	4	4	4	4	4	4	4	4	4	4	4	4
	8	40	30	24	20	34	27	22	18	20	16	14	13	11	10	7	6	5	3	3	3	3	3	3	3	3	3	3	3	3	3	3	3
	9	37	27	22	18	32	24	19	16	18	15	12	12	10	8	7	6	5	3	3	3	3	3	3	3	3	3	3	3	3	3	3	3
	10	34	25	19	16	30	22	17	14	16	13	11	11	9	8	6	5	4	3	3	3	3	3	3	3	3	3	3	3	3	3	3	3

Candela

Angle	Along II	45°	Across I
0	335	335	335
5	338	335	328
15	328	325	320
25	304	301	300
35	265	265	266
45	213	217	216
55	154	158	155
65	93	94	93
75	51	41	41
85	12	11	11
90	0	9	18
95	79	114	124
105	408	456	460
115	758	844	835
125	1091	1225	1220
135	1394	1520	1571
145	1652	1732	1792
155	1853	1896	1934
165	1991	1992	2010
175	2065	2041	2037
180	2051	2051	2051

Zonal Lumen Summary

Zone	Lumens	%Lamp	%Fixture
0-30	262	3.0	3.6
0-40	428	4.8	5.9
0-60	733	8.3	10.1
0-90	885	10.0	12.2
40-90	457	5.2	6.3
60-90	152	1.7	2.1
90-180	6356	71.8	87.8
0-180	7240	81.8	100.0

Luminance Data

Angle in Deg	0-Deg cd/sm	45-Deg cd/sm	90-Deg cd/sm
45	2849	2902	2890
55	2530	2597	2556
65	2087	2100	2087
75	1859	1483	1501
85	1334	1160	1182

COMMON CIRCUIT CONFIGURATIONS FOR ONE LAMP SUSPENDED FIXTURES

- 2C=Two circuit luminaire
- 2E=Two circuit luminaire with emergency circuit
- 1B=Single circuit luminaire with battery pack

- /1/ =Circuit 1
- /2/ =Circuit 2
- /E/ =Emergency Circuit
- /B/ =Battery Circuit

=Power Mount

=Non-Power Mount

