

DESCRIPTION

The next generation addition to the Iridium family, the direct-indirect i2 series, offers a generous open center aperture for maximum versatility in optics, lamping and distribution. The i2 is also available with adjustable uplight and downlight optics for evolving interior spaces with Corelite's Slide-N-Lock (TM) optics accessory. i2 may be mounted individually or continuously with 4' and 8' modular sections. Luminaires align with T-Grid and interface with all ceiling types. The i2 is ideally suited for open offices, conference rooms, classrooms, libraries, labs and public spaces.

Catalog #		Type
Project		
Comments		Date
Prepared by		

SPECIFICATION FEATURES

A ... Construction

Housing is one piece die-formed cold rolled steel, forming a 9" x 2-1/2" architectural profile. Standard 4'-0" and 8'-0" fixture lengths combine for continuous runs.

B ... End Caps

Standard Straight and optional Beveled end caps are precision die-cast aluminum mechanically attached without exposed fasteners.

C ... Inlay

Inlay is comprised of 0.025" perforated white powder coat aluminum and frosted acrylic backing.

D ... Reflectors

Reflector pan is painted with a high reflectance white powder coat finish. Optional die-formed side reflectors are highly specular anodized aluminum.

E ... Electrical

Fixtures are prewired with quick wire connectors and use UL listed Class P, 265ma T8 instant start universal voltage electronic ballasts. Power factor of 95% with less than 10% THD. Fixtures and electrical components certified to UL and CUL standards.

F ... Finish

Fixture housings are standard white using electrostatically applied polyester powder coat paint.

Mounting

Standard aircraft cable mounts on 4'-0" and 8'-0" centers. Refer to installation section for various ceiling interface details.

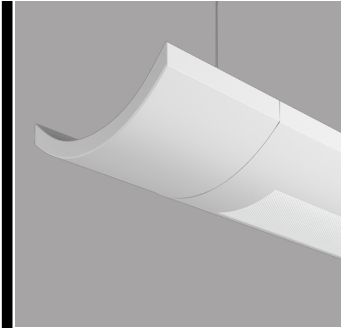

i2 Perf Inlay

1T8

**Suspended
Semi-Indirect**

Light Distribution
Indirect - 92.4%
Direct - 7.6%

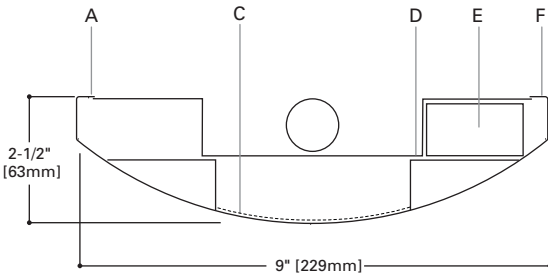

MODULES AND DIMENSIONS*

48" [1219mm]

96" [2438mm]

*Dimensions do not include end caps.

Standard Straight End Cap

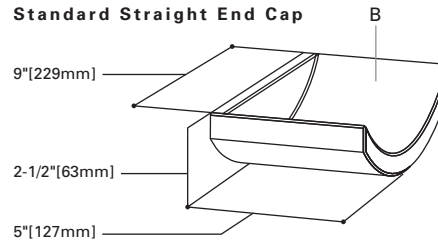

Beveled End Cap

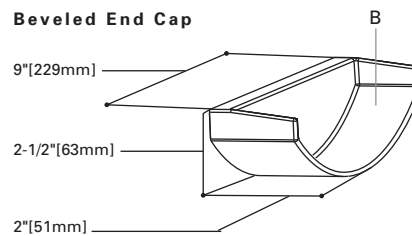

ORDERING INFORMATION

Sample Number: I2-WD-1T8-1C-UNV-AC48-T1-12-ES

Series I2: i2 Suspended	Number of Lamps 1: 1 Lamp	Wiring ¹ B: Battery Pack C: Standard Circuit D: Dimming E: Emergency T: Nightlight Y: Daylight	Voltage ¹ 120: 120V 277: 277V 347: 347V UNV: Universal (120V-277V)	Suspension A: Aircraft Cable	Ceiling Type T1: 1" T-Bar T9: 9/16" T-Bar TS: Slotted T-Bar ST: Structure JB: 4" Octagonal J-Box
Optics Up S: Specular W: White	Lamp Type T8: T8 Normal Output			Power Feed ¹ C: Straight Cord K: Curly Cord	
Optics Down D: Perf Inlay	Number of Circuits ¹ 1: 1 Circuit			Suspension Length Adjustable Cable 48", 120", 240", 300", or 360" (infinite adjustment along entire length of cable)	Run Length Individually Mounted Luminaires may be 4' or 8' in length Continuously Mounted Standard row configurations over 8' consist of 4' and 8' sections

Notes: 1 Not all options available. Please consult your Cooper Lighting Representative for availability.

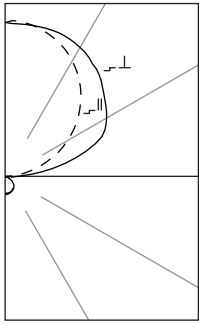

I2-WD-1T8
(1) F32T8/TL835
3000 Lumens

Efficiency 92.3%

Test Report
#LSI26351

Coefficients of Utilization

rc	Effective floor cavity reflectance																										
	80%				70%				50%				30%				10%				0%						
rw	70	50	30	10	70	50	30	10	50	30	10	50	30	10	50	30	10	50	30	10	50	30	10	50	30	10	
RCR	0	90	90	90	90	78	78	78	78	55	55	55	35	35	35	16	16	16	7								
	1	81	78	74	71	70	67	65	62	48	46	45	30	29	29	14	14	13	6								
	2	74	68	63	58	64	59	55	51	42	39	37	27	25	24	12	12	11	5								
	3	68	59	53	48	58	52	47	42	37	34	31	23	22	20	11	10	10	4								
	4	62	52	46	41	53	46	40	36	33	29	26	21	19	17	10	9	8	4								
	5	56	46	40	34	49	40	35	30	29	25	22	19	16	15	9	8	7	3								
	6	52	41	35	30	45	36	30	26	26	22	19	17	14	13	8	7	6	3								
	7	48	37	30	26	41	32	27	23	23	20	17	15	13	11	7	6	5	2								
	8	44	33	27	22	38	29	24	20	21	17	15	14	11	10	6	5	5	2								
	9	41	30	24	20	35	27	21	17	19	16	13	12	10	9	6	5	4	2								
	10	38	28	21	17	33	24	19	15	18	14	11	11	9	8	5	4	4	2								

Candela

Angle	Along II	45°	Across I
0	76	76	76
5	77	76	75
15	75	75	74
25	70	69	70
35	61	62	62
45	49	51	51
55	36	37	36
65	23	22	21
75	13	10	10
85	3	3	2
90	0	15	27
95	30	97	112
105	139	294	324
115	258	388	486
125	371	470	545
135	472	548	601
145	228	607	648
155	626	652	677
165	671	673	686
175	696	685	684
180	688	688	688

Zonal Lumen Summary

Zone	Lumens	%Lamp	%Fixture
0-30	60	2.0	2.2
0-40	99	3.3	3.6
0-60	170	5.8	6.2
0-90	207	7.0	7.6
40-90	108	3.7	4.0
60-90	37	1.2	1.4
90-180	2515	85.2	92.4
0-180	2722	92.3	100.00

Luminance Data

Angle in Deg	0-Deg cd/sm	45-Deg cd/sm	90-Deg cd/sm
45	654	680	675
55	588	608	592
65	505	490	479
75	482	351	347
85	336	315	249

COMMON CIRCUIT CONFIGURATIONS FOR ONE LAMP SUSPENDED FIXTURES

- 1C=Single circuit luminaire
- 1E=Single circuit luminaire with emergency circuit
- 1B=Single circuit luminaire with battery pack

/1/ =Circuit 1
/E/ =Emergency Circuit
/B/ =Battery Circuit

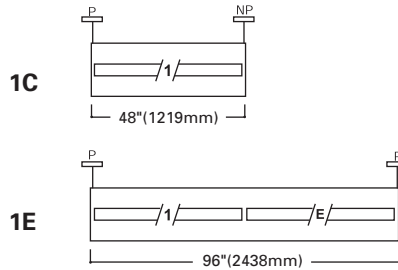

=Power Mount
 =Non-Power Mount