

# FINELITE Series 11 Micro Profile LED Driver Replacement Installation Instructions

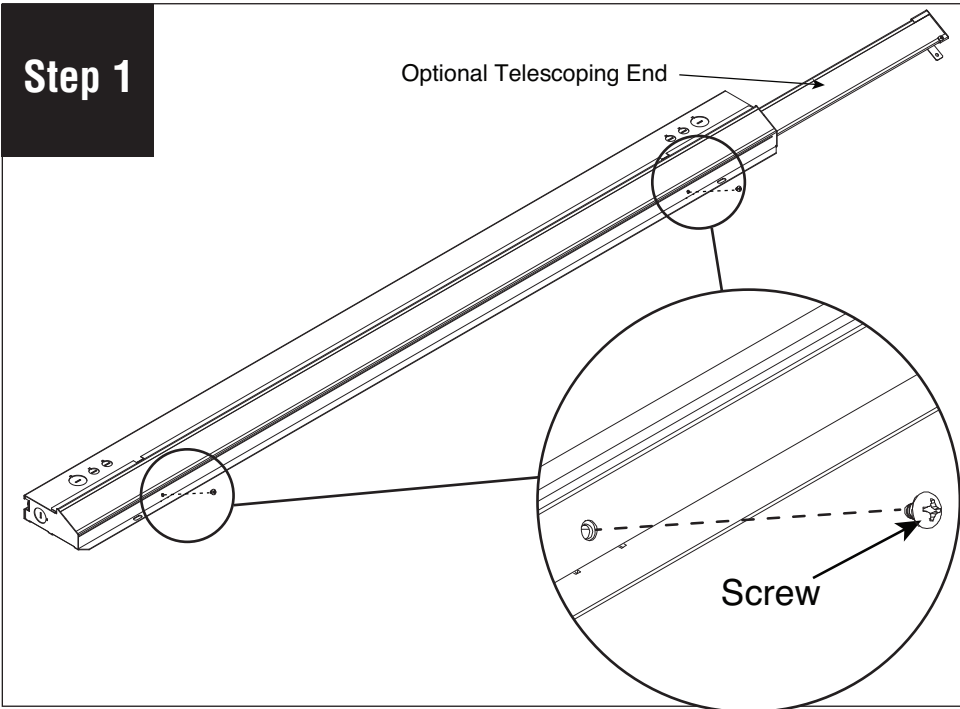

Confirm which Power Supply needs to be replaced. Shut off power to the fixture. Remove 2x Phillips screws on cover using #2 phillips screw driver.

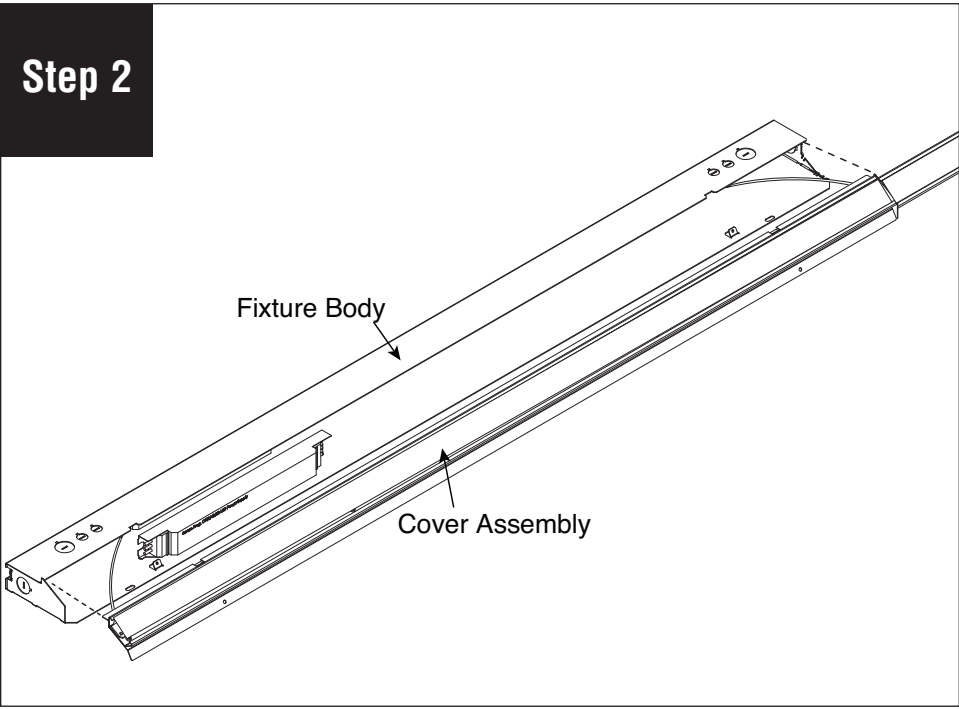

Pull cover assembly away from body.

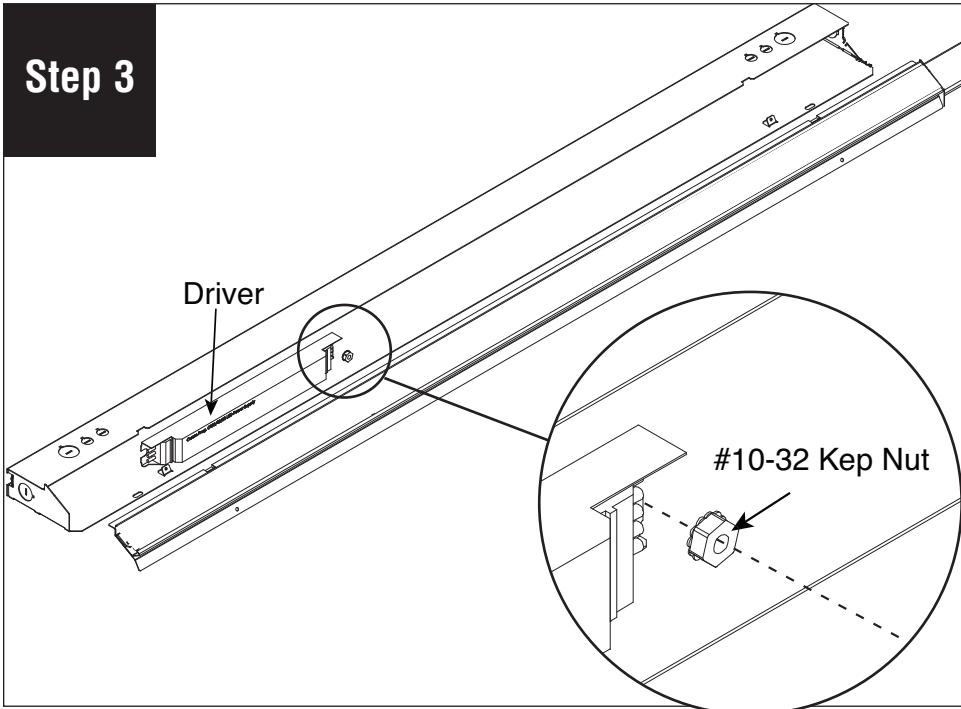

Carefully remove wires connected to Power Supply. Remove #10-32 Kep Nut with 3/8" Nut Driver, and remove Driver from Housing. Return spent Power Supply to Finelite or local E-Waste Recycler.

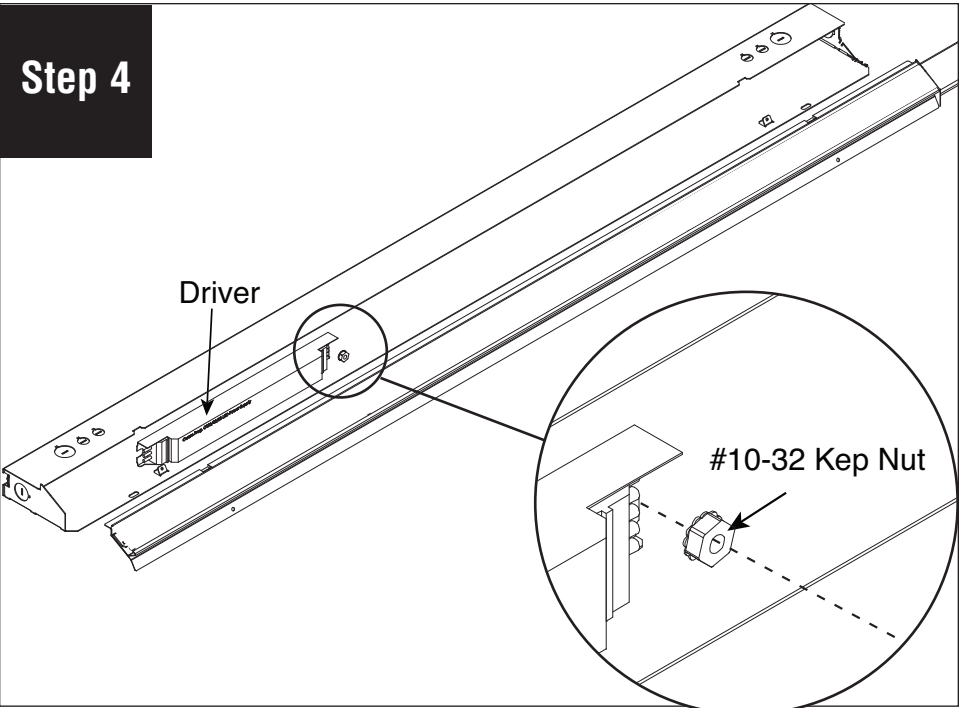

Carefully replace wires connected to Power Supply. Replace #10-32 Kep Nut with 3/8" Nut Driver to secure Power Supply to housing.

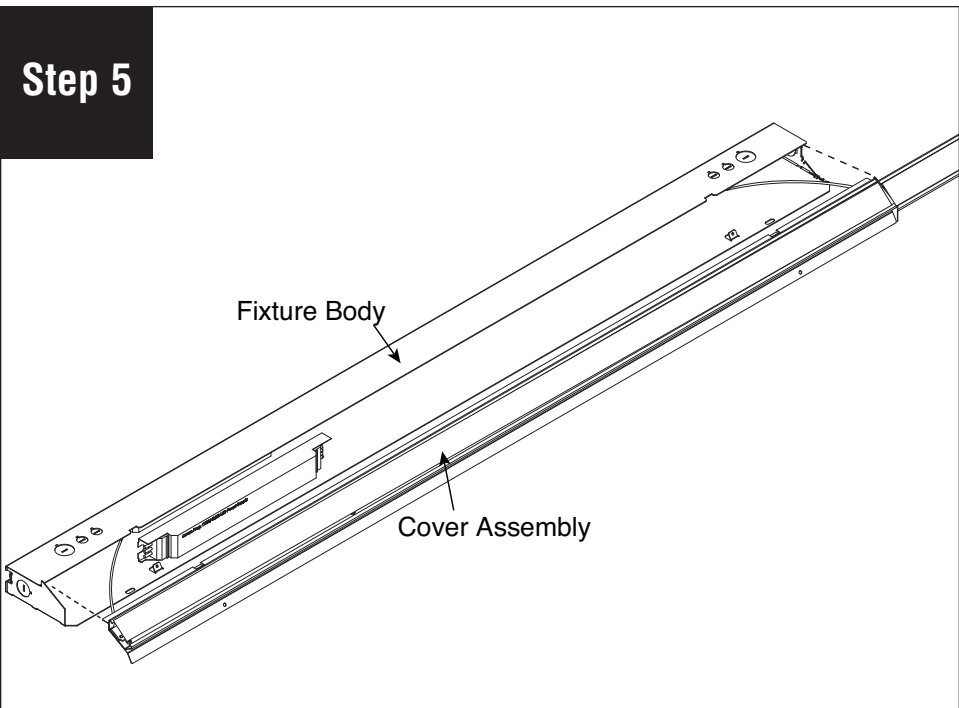

Return cover assembly and secure 2x phillips screws on cover using #2 phillips screw driver.

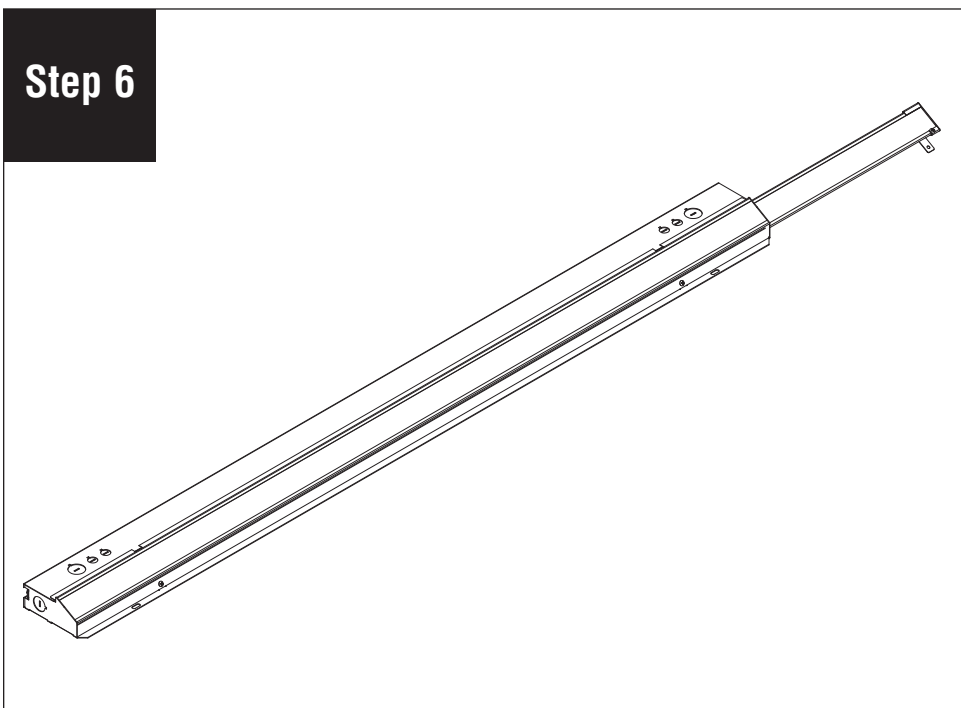

Turn power on to fixture.