

# FINELITE

## HP-4 Standard Mitered Corner Installation Instructions

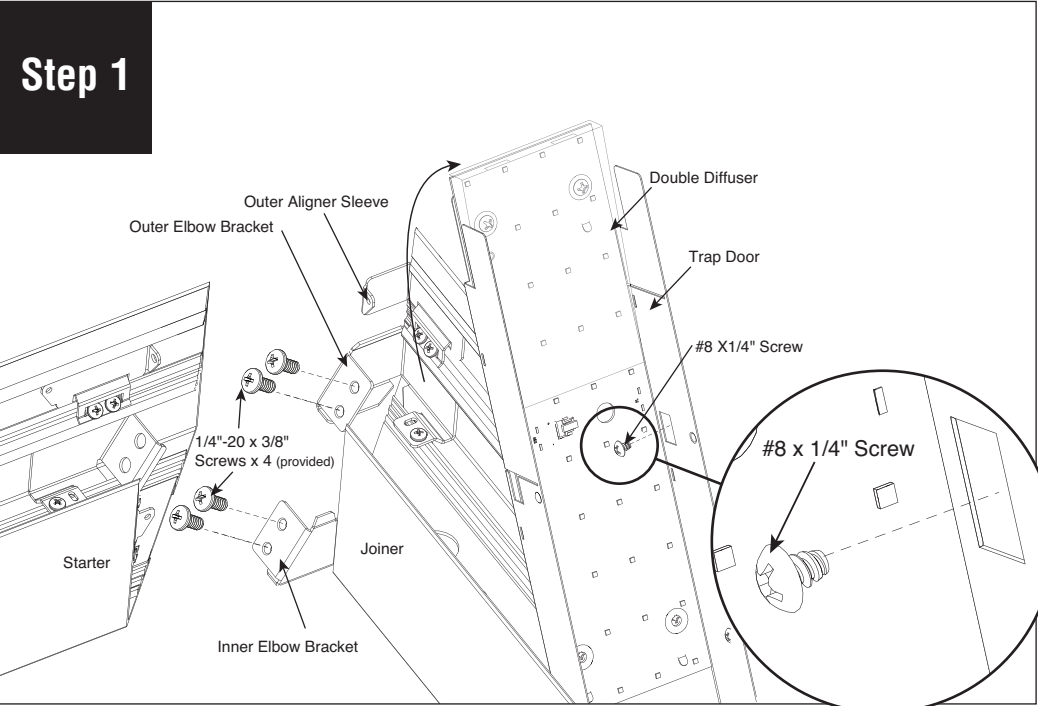

Remove #8 screws to open both the joiner and starter trap doors. Then remove four 1/4"-20 screws from both the outer and inner elbow brackets.

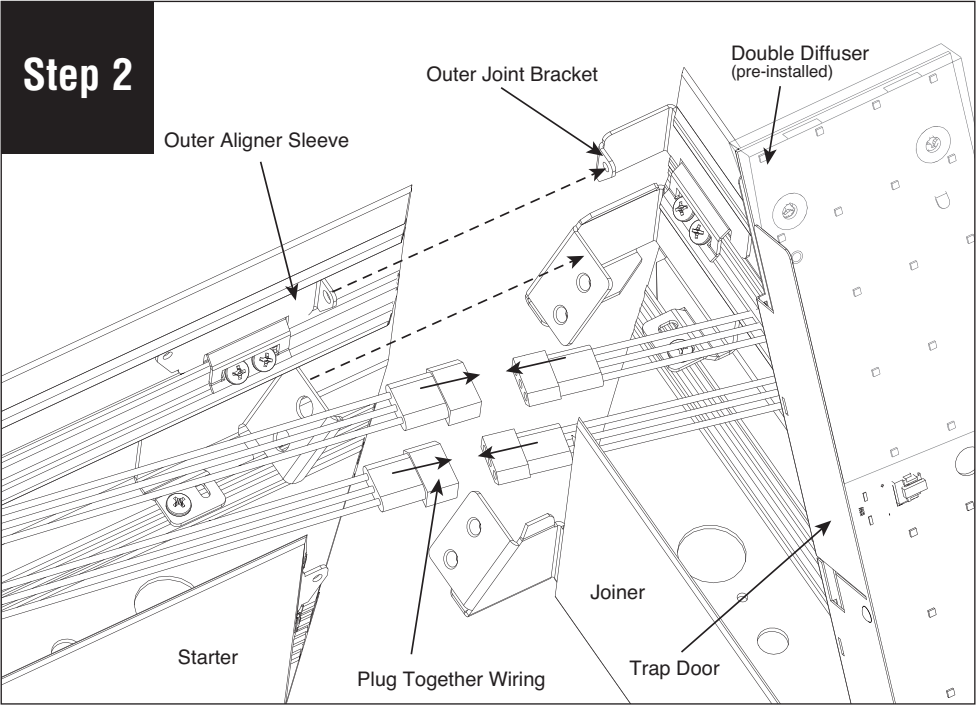

Connect plug together wiring. Align joint brackets to channels and slide fixtures together.

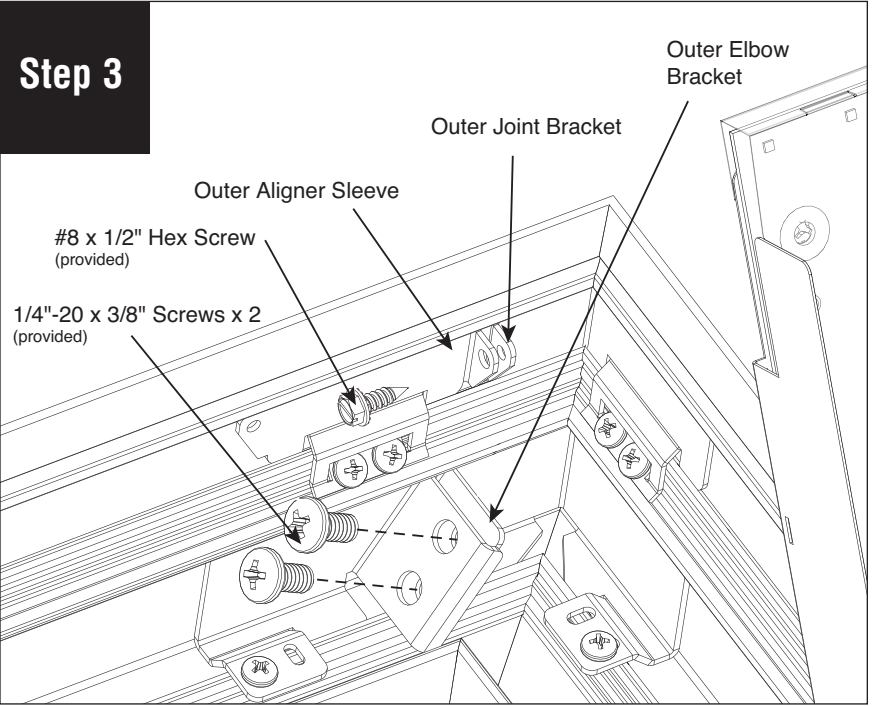

Fasten the outer elbow bracket and aligner sleeve using two 1/4"-20 screws. Then fasten the outer joint bracket and aligner sleeve using one #8 hex screw.

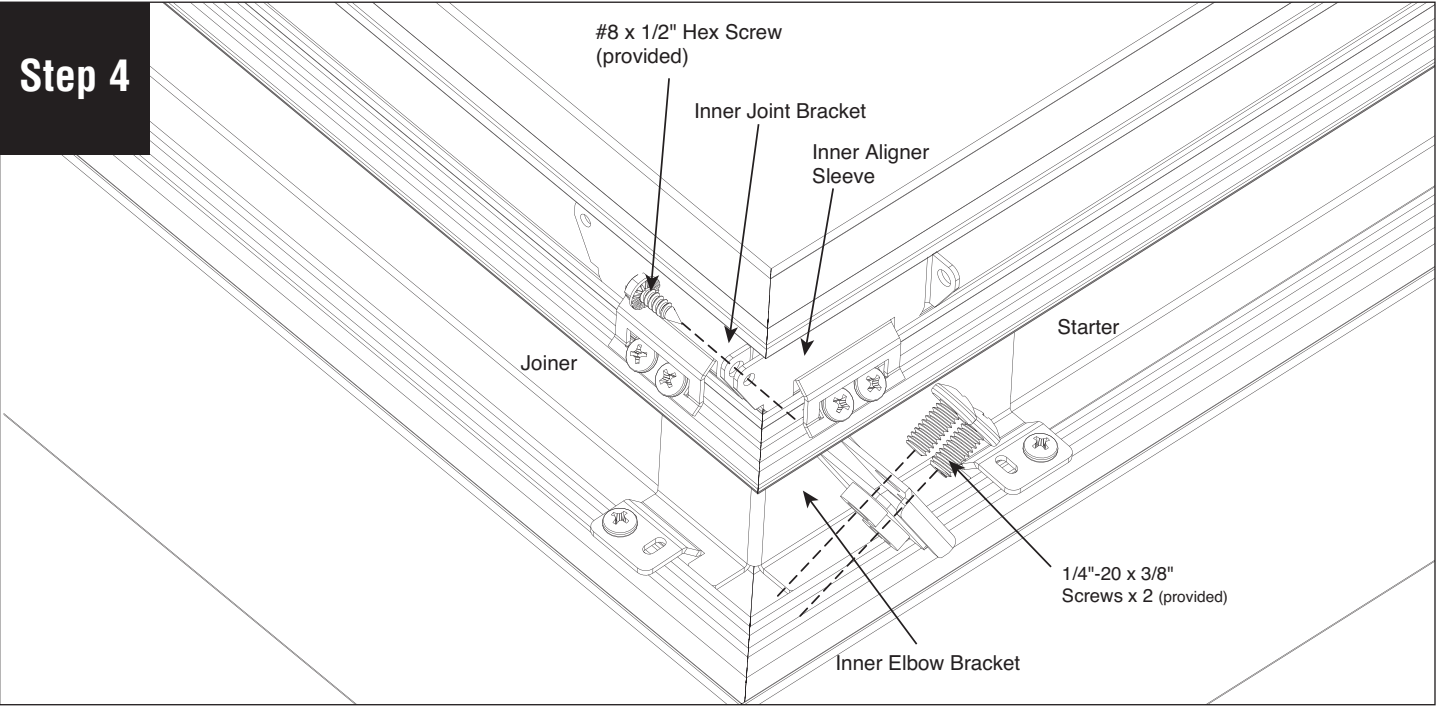

Fasten the inner elbow bracket and aligner sleeve using two 1/4"-20 screws. Then fasten the inner joint bracket and aligner sleeve using one #8 hex screw.

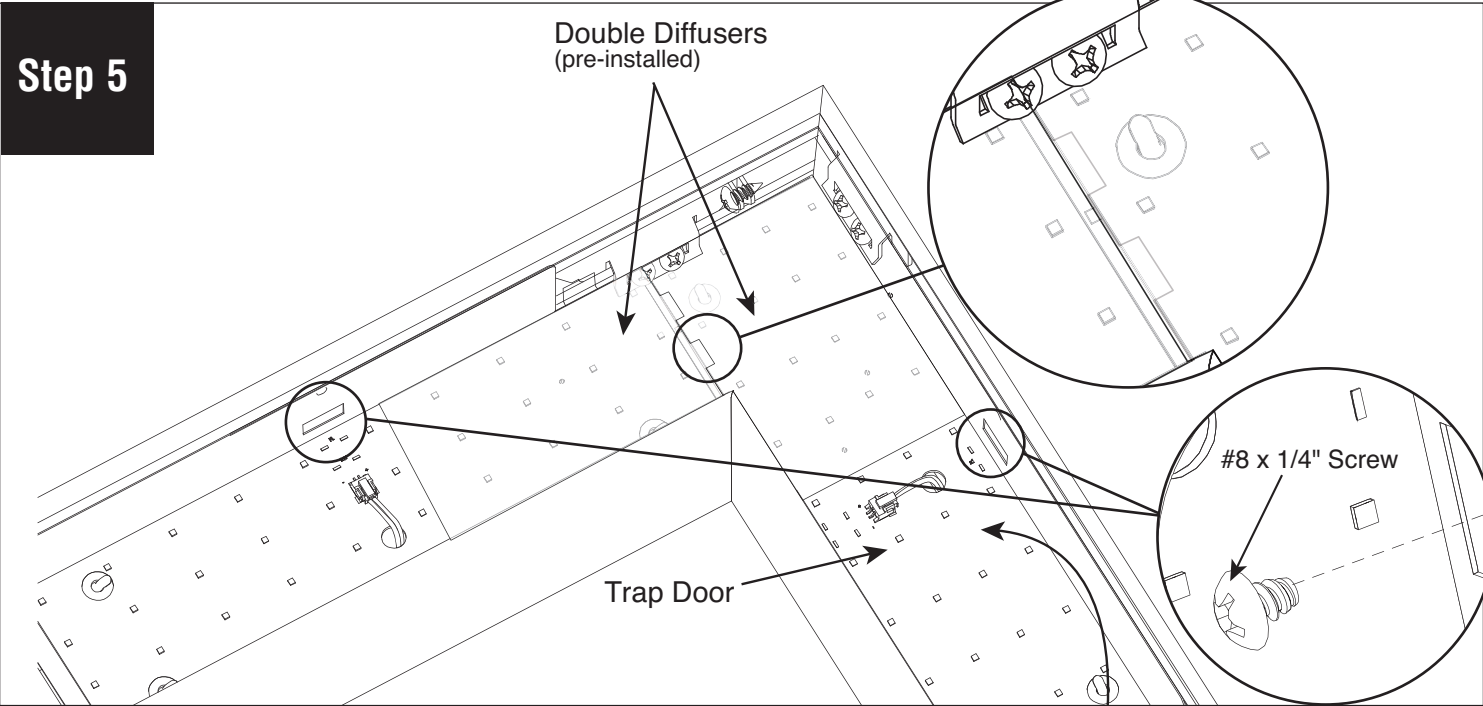

Replace trap doors and fasten with #8 screws. Ensure right (long section) diffuser is under left (short section) diffuser tabs.