

FINELITE

HP-4 Recessed with Regressed Diffuser Spackle Flange Starter/Independent Installation Instructions

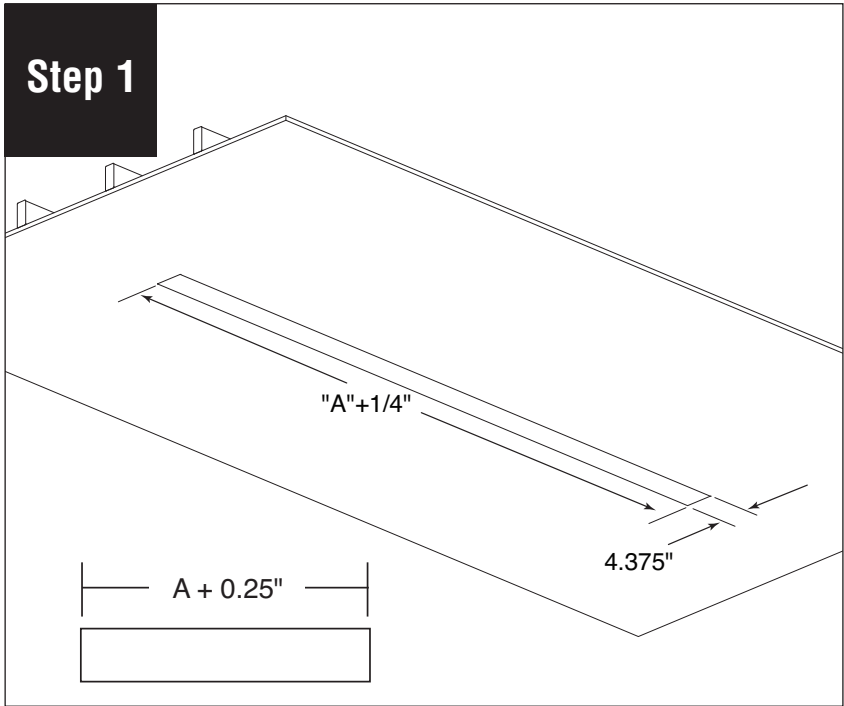

Add 1/4" to the body/row length (A) to simplify installation. Fixture needs to be installed next to support blocking.

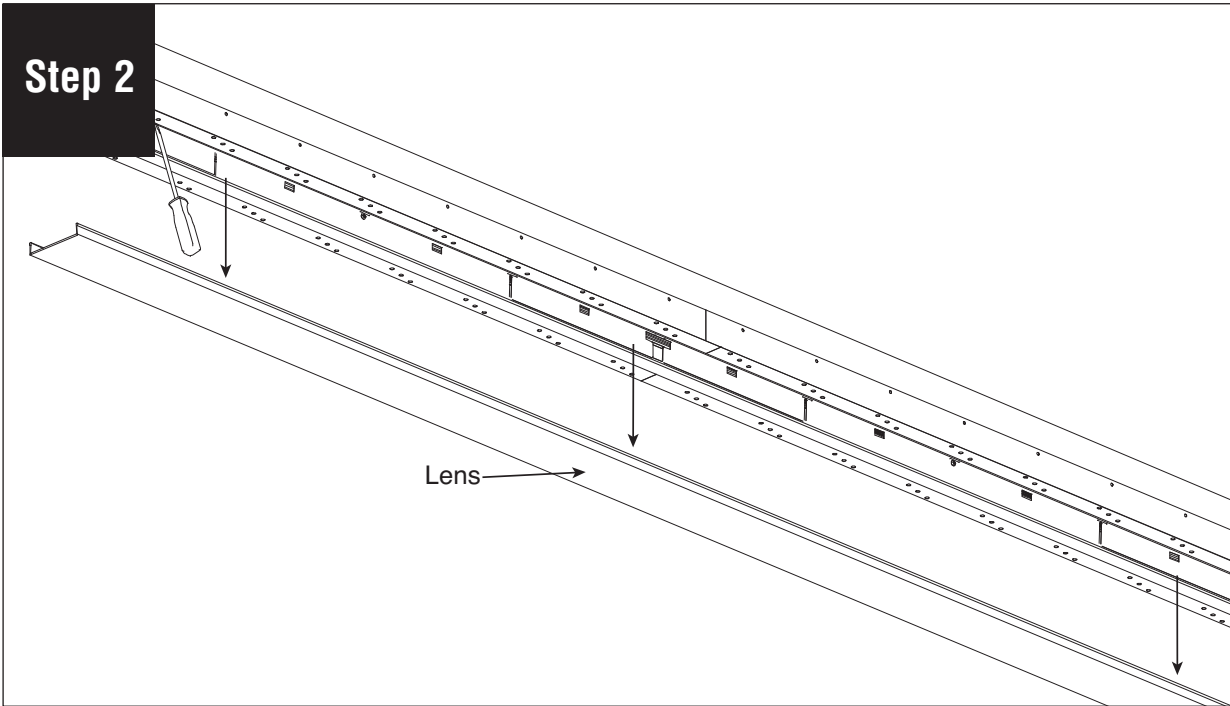

Remove bottom diffuser by wedging a screwdriver between the diffuser and the body. Carefully pivot screwdriver to unsnap the diffuser from the body. Set diffuser aside to prevent it from getting dirty or damaged during installation.

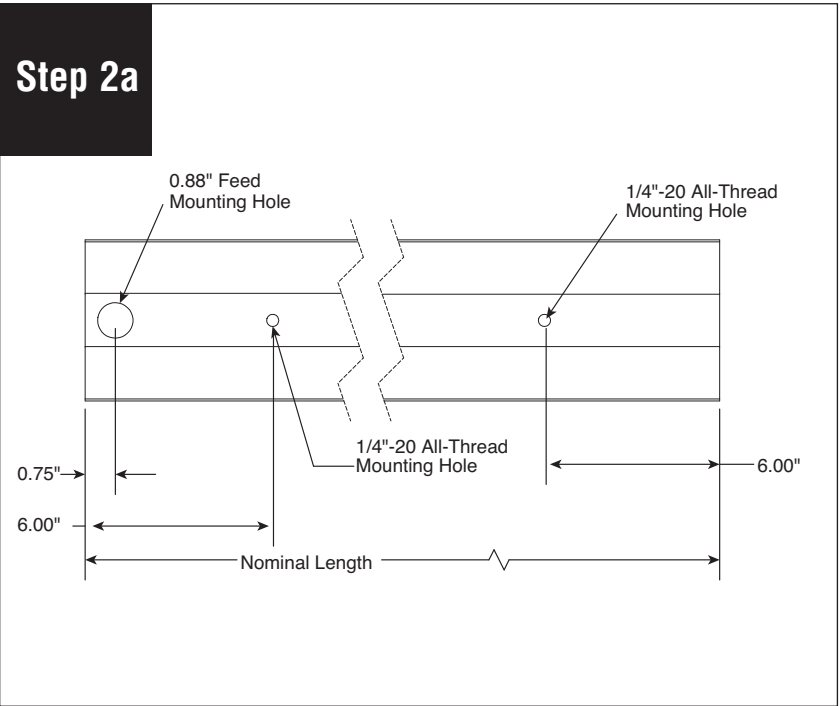

Refer to threads and feed hole locations above before connecting fixture wires.

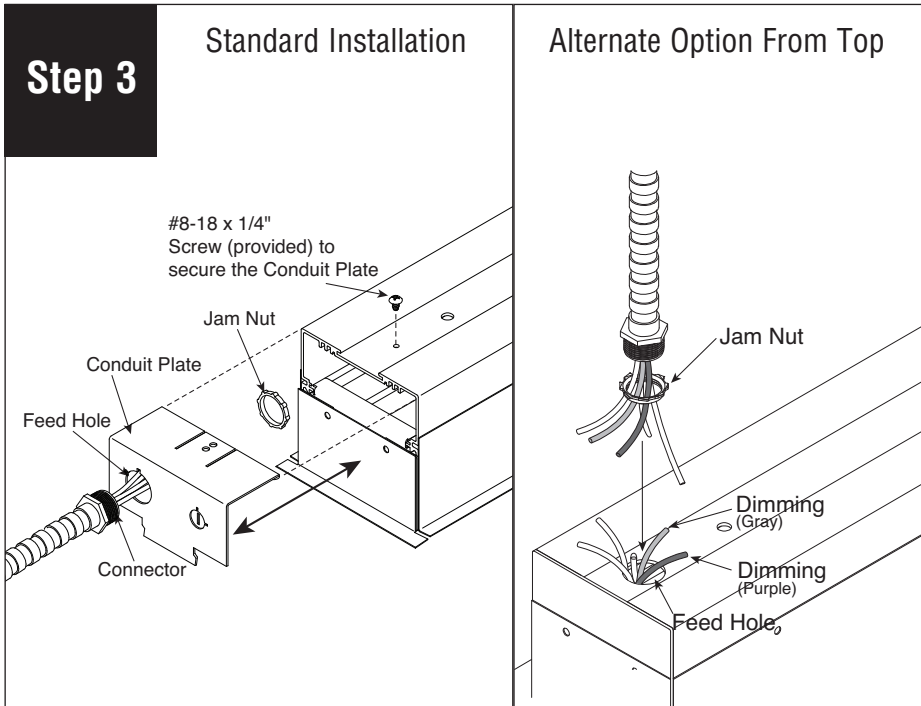

Alternate Option From Top

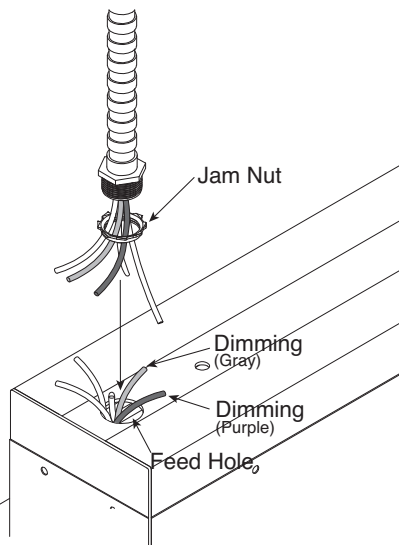

Remove jam nut from conduit then insert wires and connector through feed hole.

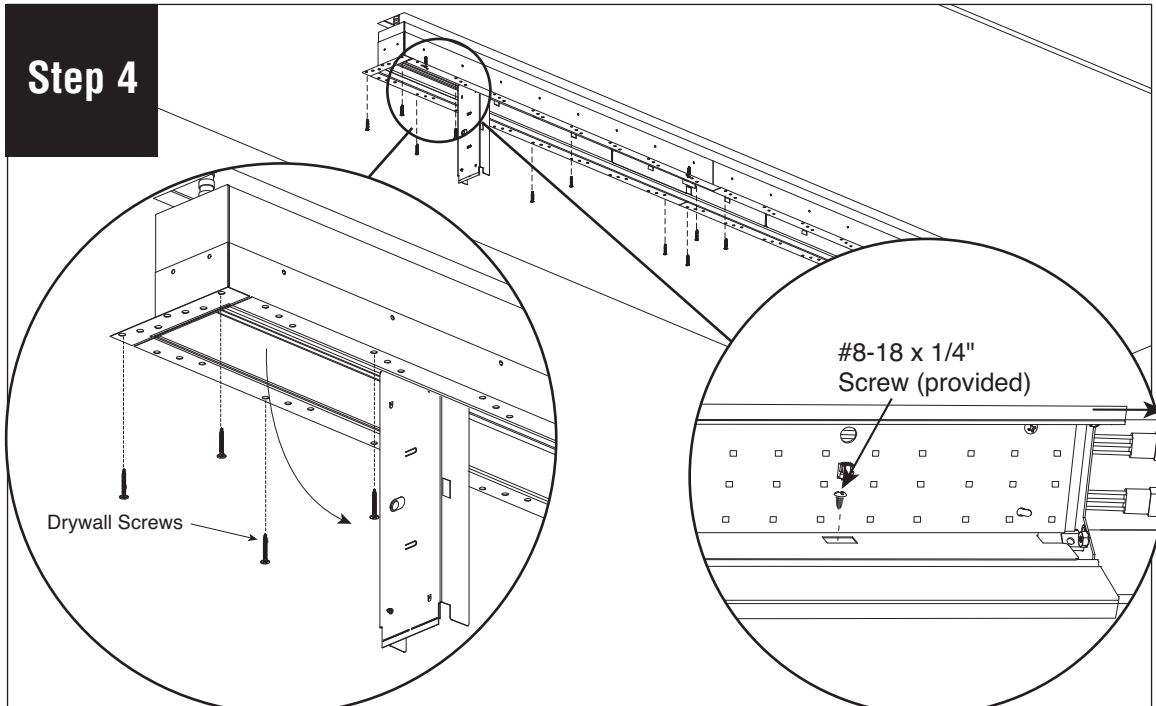

Remove #8-18 x 1/4" screw (provided) to open trap door at both ends and align fixture within rough opening in drywall and 1/4"-20 All-Thread. Insert fixture into ceiling and fasten fixture to the ceiling with drywall screws through flange into blocking.

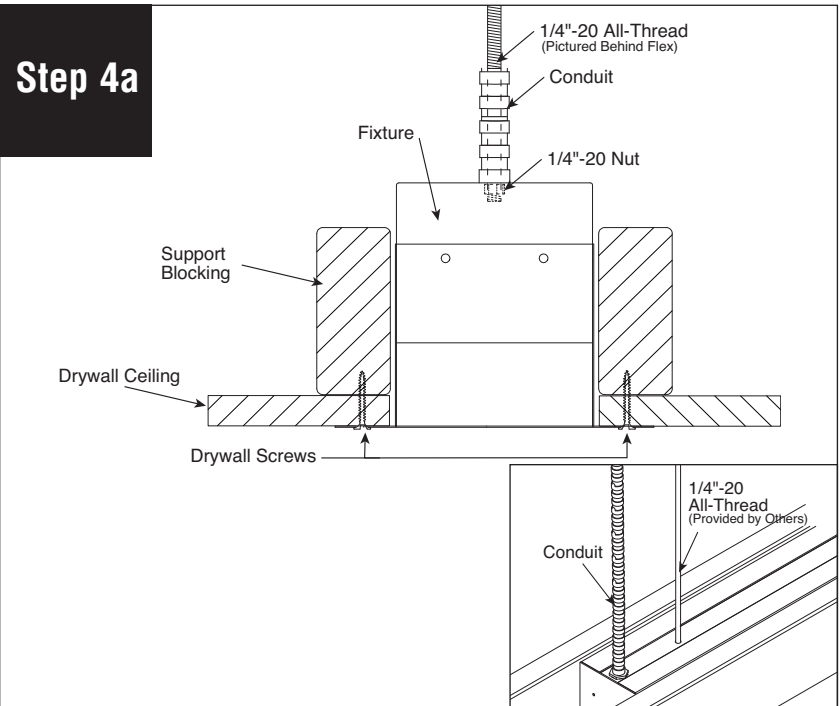

Secure fixture to structure using 1/4"-20 All-Thread. Secure spackle flange to blocking.

FINELITE

HP-4 Recessed with Regressed Diffuser Spackle Flange Starter/Independent Installation Instructions

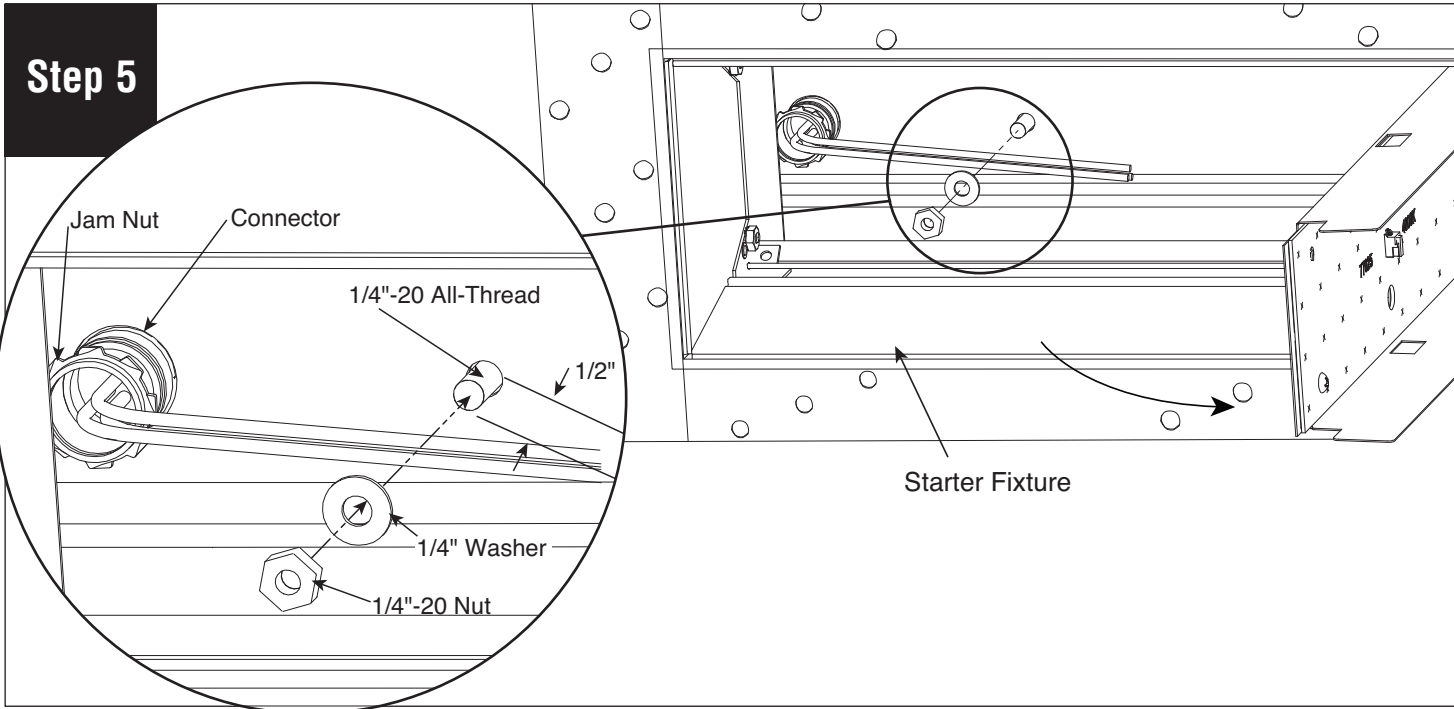

Install jam nut onto connector. Install 1/4"-20 nut and 1/4" washer onto 1/4"-20 All-Thread (provided by others)

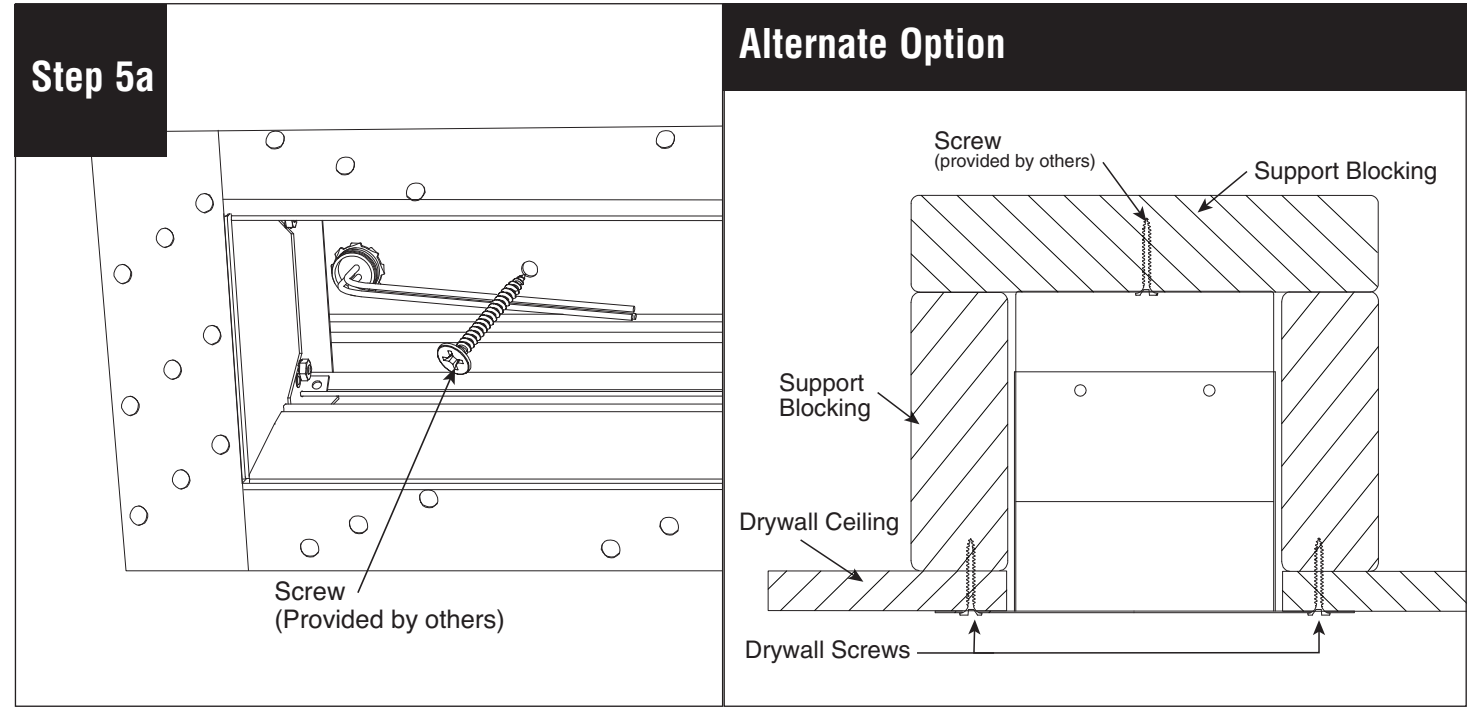

**ALTERNATE OPTION:** Install screw (provided by others) through mounting hole into proper structurally supported blocking (provided by others).

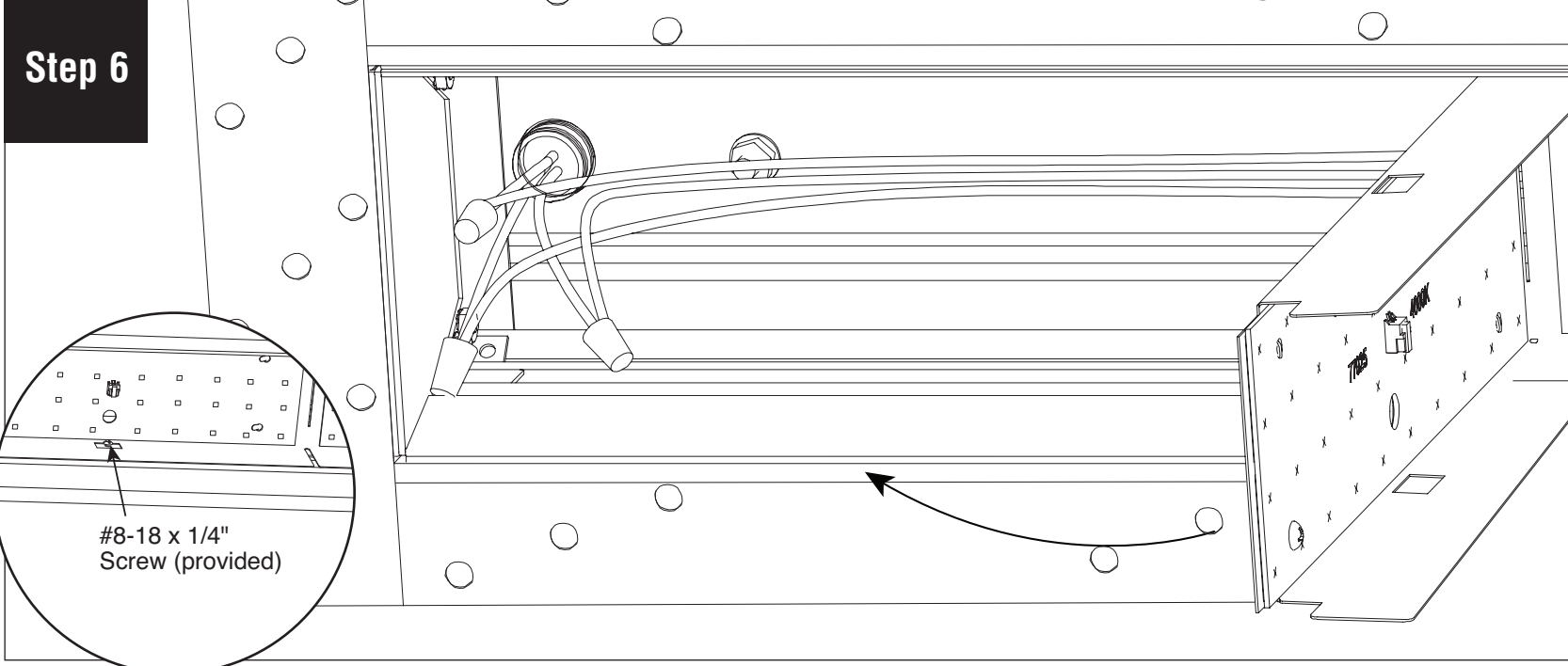

Make wire connections and secure trap door with #8-18 x 1/4" screw (provided).

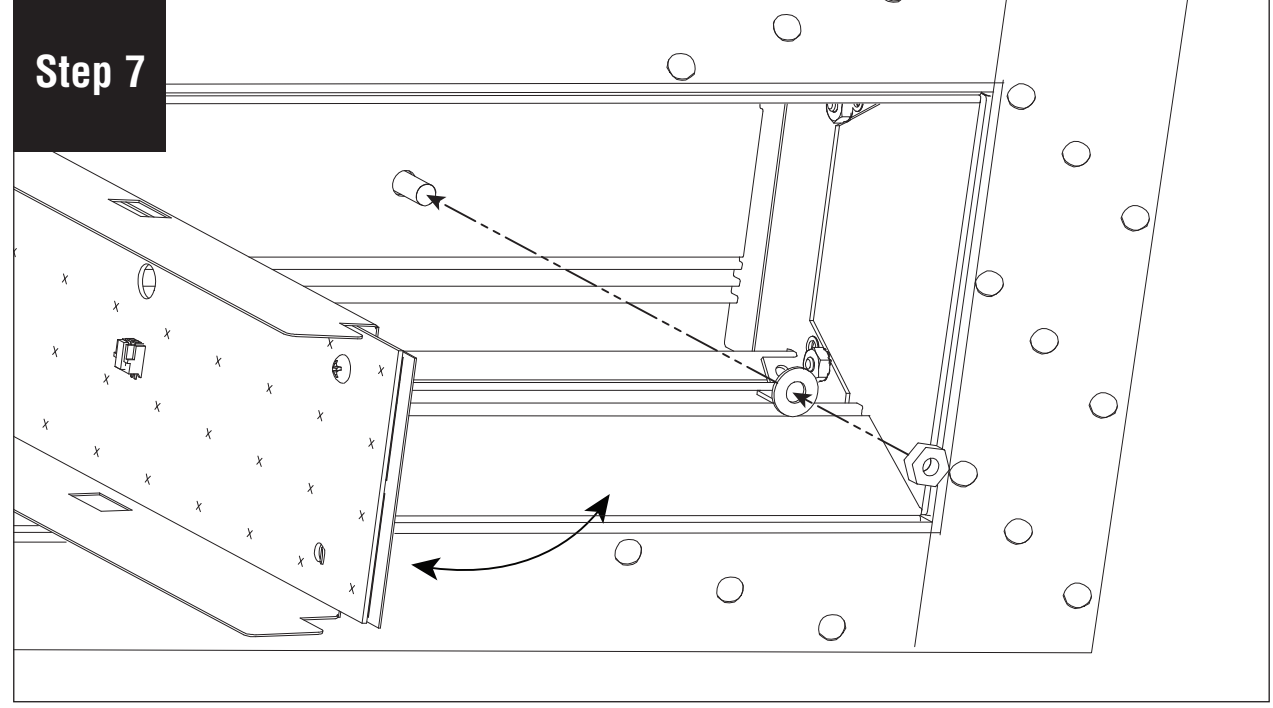

On opposite end of fixture, fold trap door down. Install 1/4"-20 nut and 1/4" washer onto 1/4"-20 All-Thread or use ALTERNATE OPTION. Replace trap door and fasten with #8-18 x 1/4" screws (provided).

FINELITE

HP-4 Recessed with Regressed Diffuser Spackle Flange Starter/Independent Installation Instructions

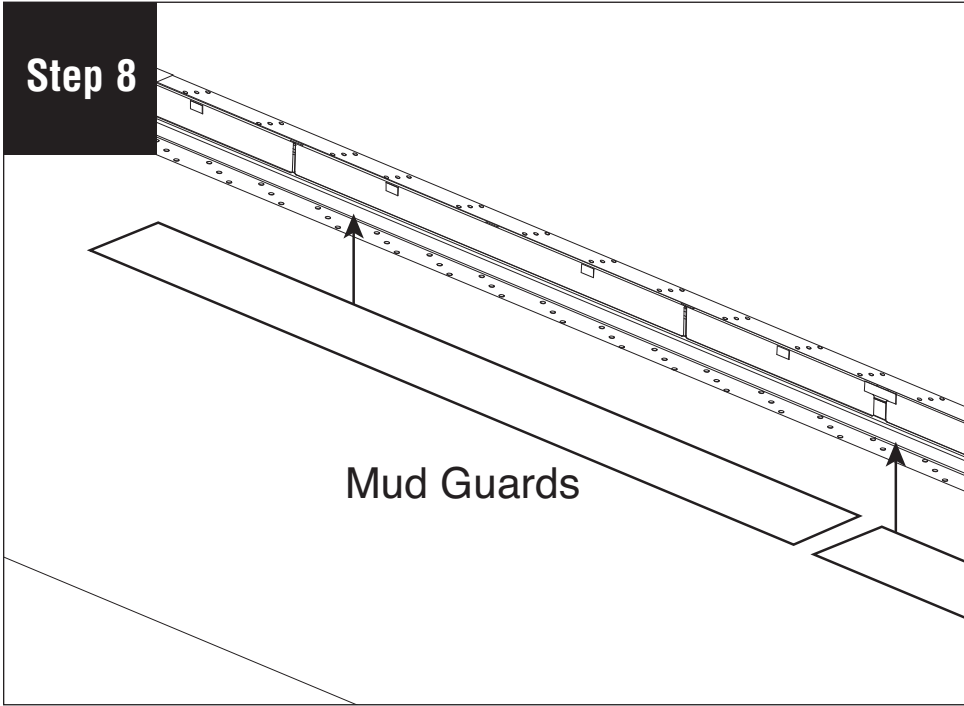

Install the “mud guard” cardboard inserts (provided) to help prevent spackle from getting into the light fixture.

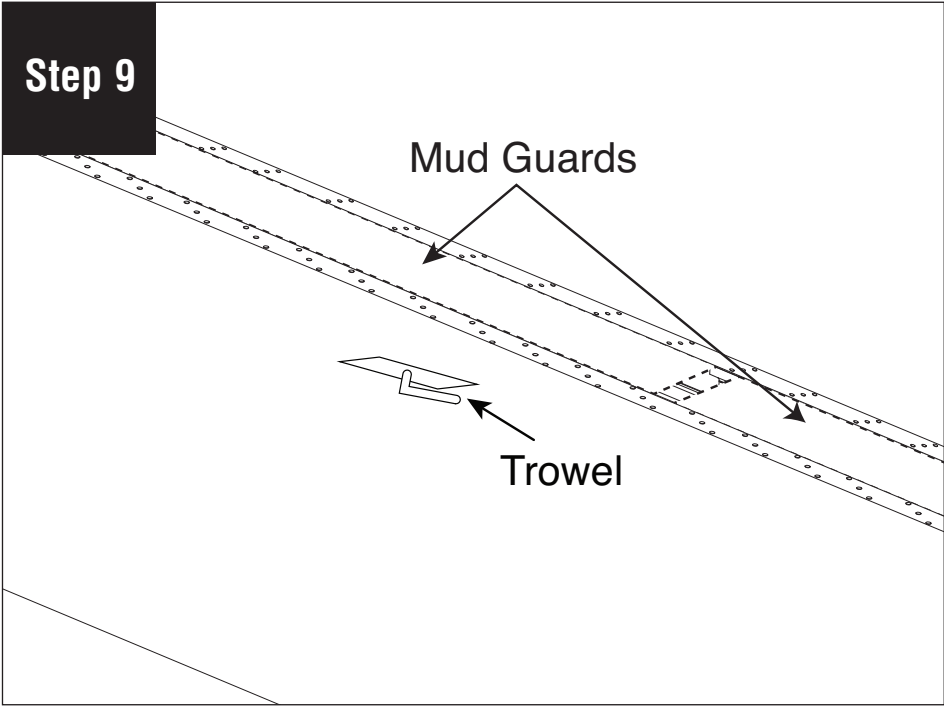

Use spackle to cover up the flange. Remove the “mud guard” cardboard inserts (provided) when done.

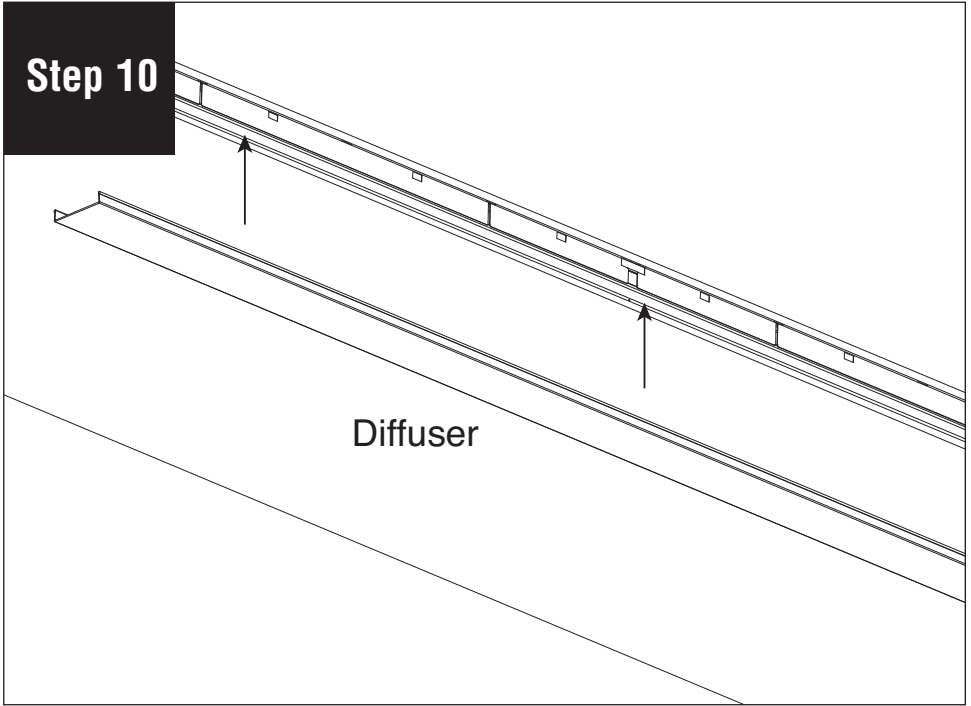

Reinstall diffuser and turn power on.

FINELITE

# HP-4 Recessed with Regressed Diffuser Spackle Flange Joiner/Ender

## Installation Instructions

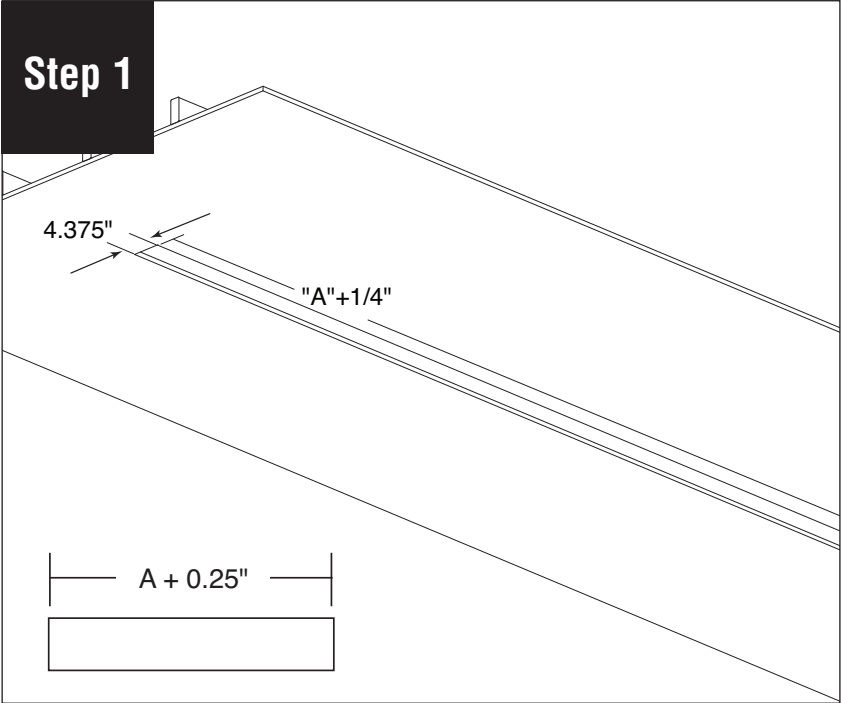

Turn off the power to the fixture's circuit. Provide rough opening according to the measurements indicated. Fixture needs to be installed next to support blocking.

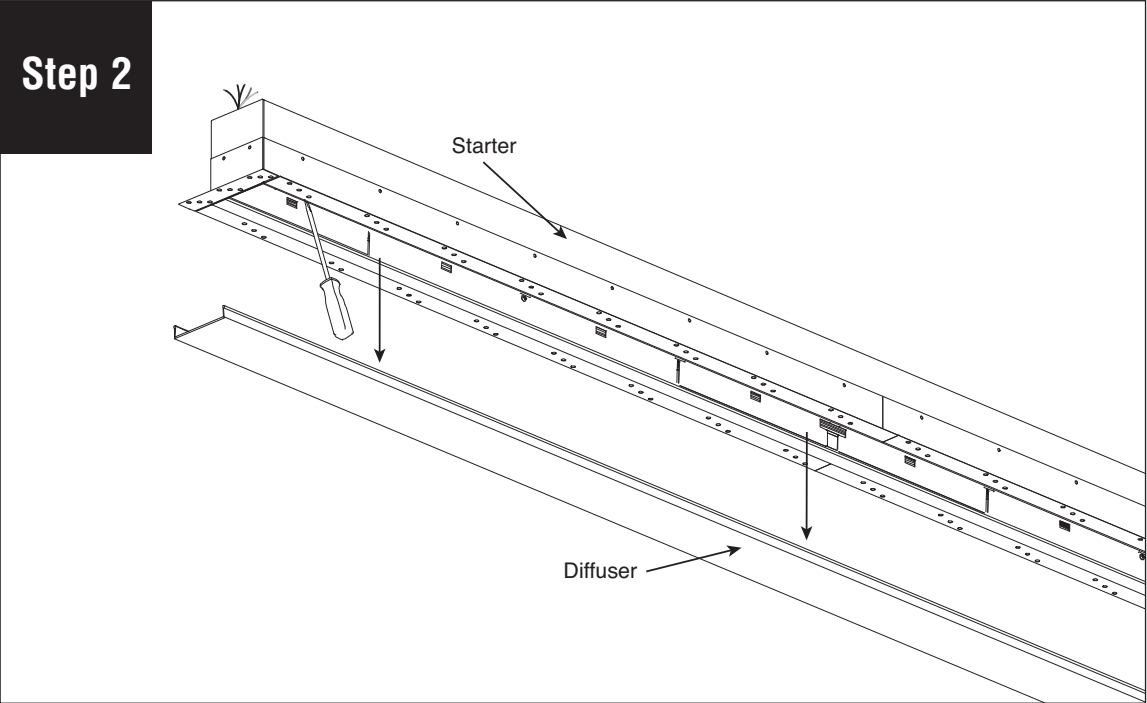

Remove bottom diffuser by wedging a screwdriver between the diffuser and the body. Carefully pivot screwdriver to unsnap the diffuser from the body. Set diffuser aside to prevent it from getting dirty or damaged during installation.

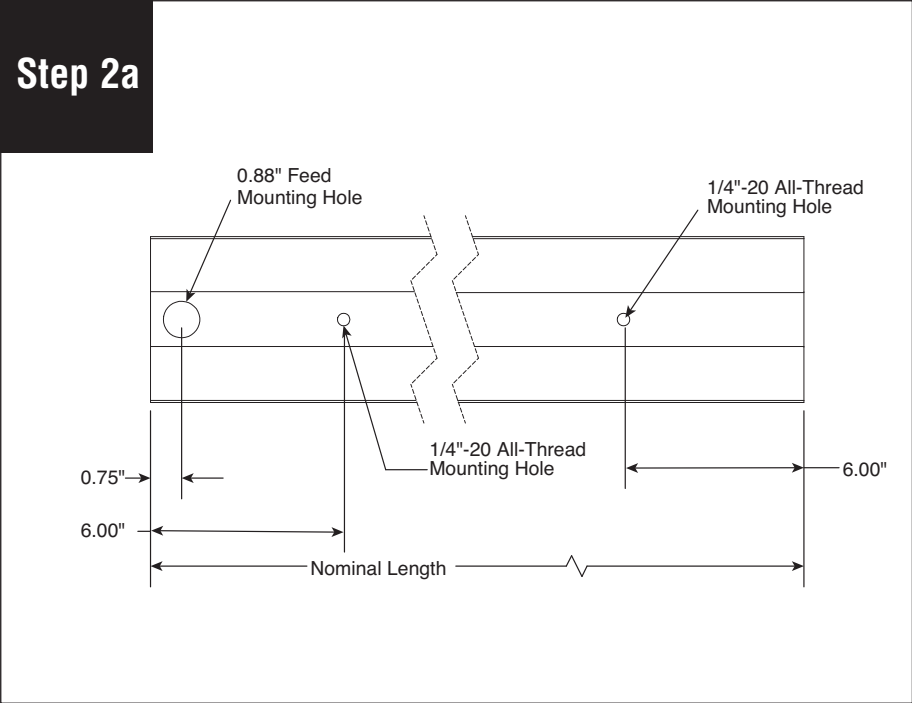

Refer to threads and feed hole locations above before connecting fixture wires.

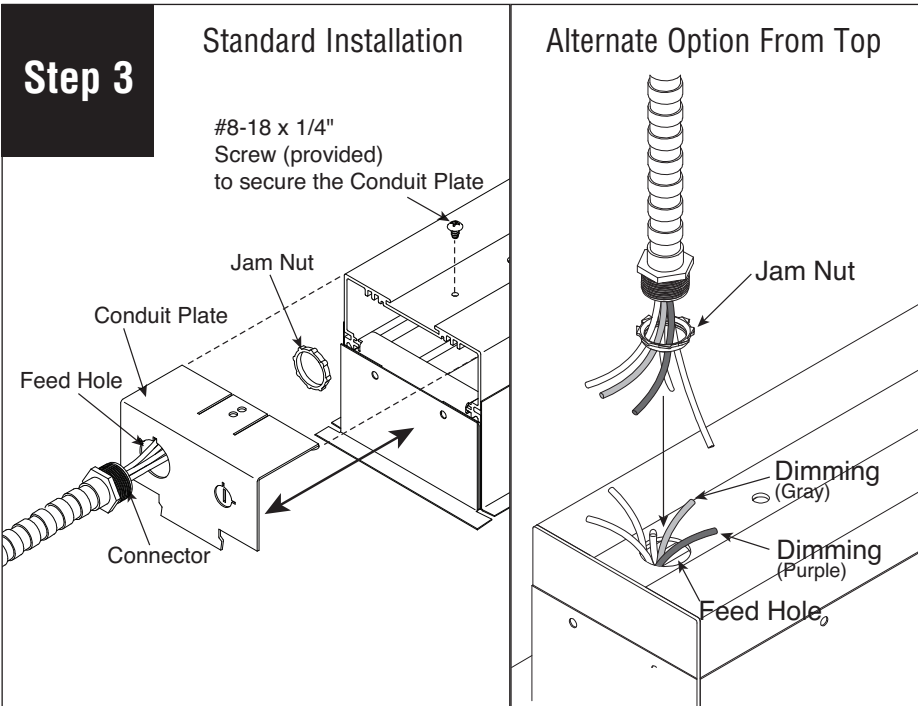

Remove jam nut from conduit then insert wires and connector through feed hole.

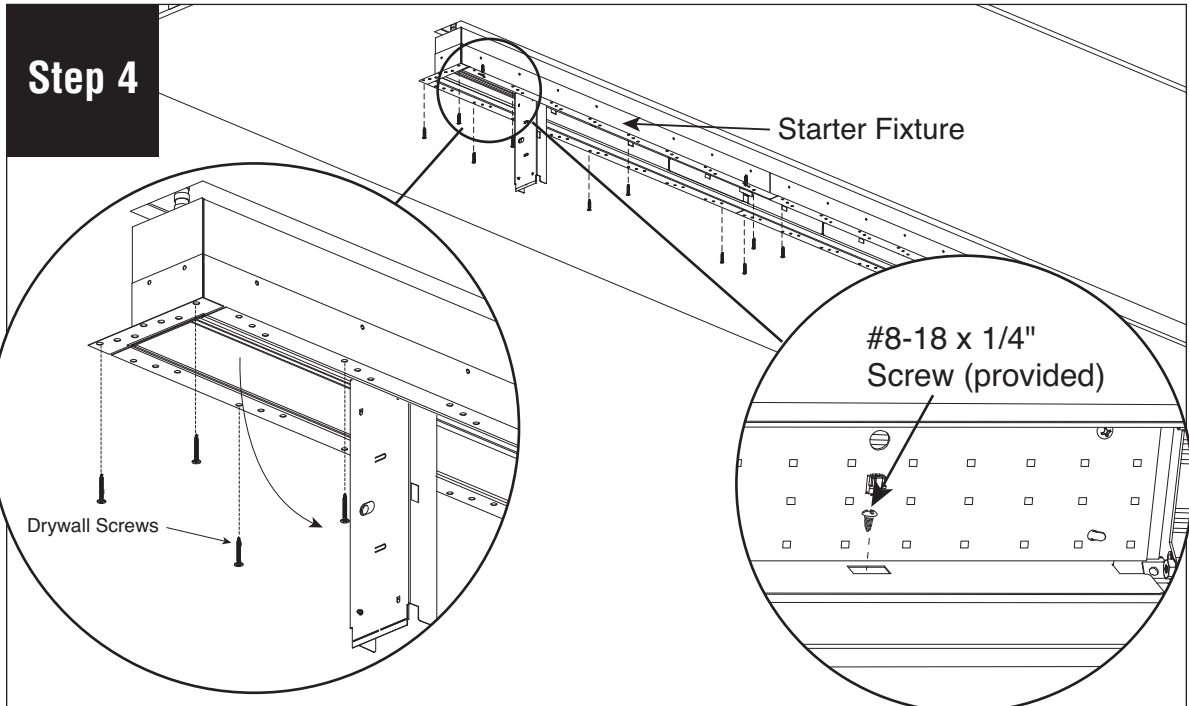

Remove #8-18 x 1/4" screw (provided) to open trap door at both ends and align fixture within rough opening in drywall and 1/4"-20 All-Thread. Insert fixture into ceiling and fasten fixture to the ceiling with drywall screws through flange into blocking.

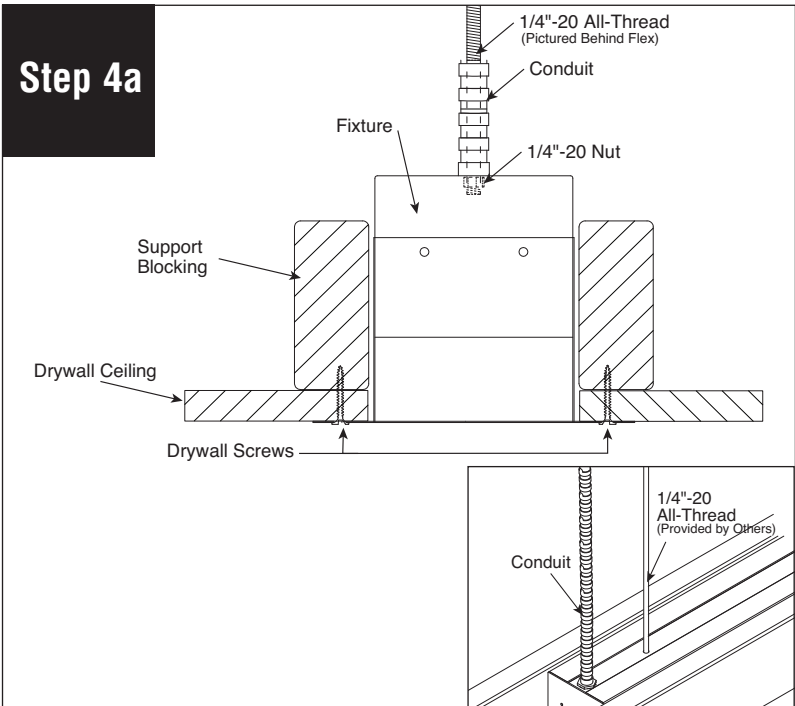

Secure fixture to structure using 1/4"-20 All-Thread. Secure spackle flange to blocking.



# FINELITE

## HP-4 Recessed with Regressed Diffuser Spackle Flange Joiner/Ender Installation Instructions

### Step 5

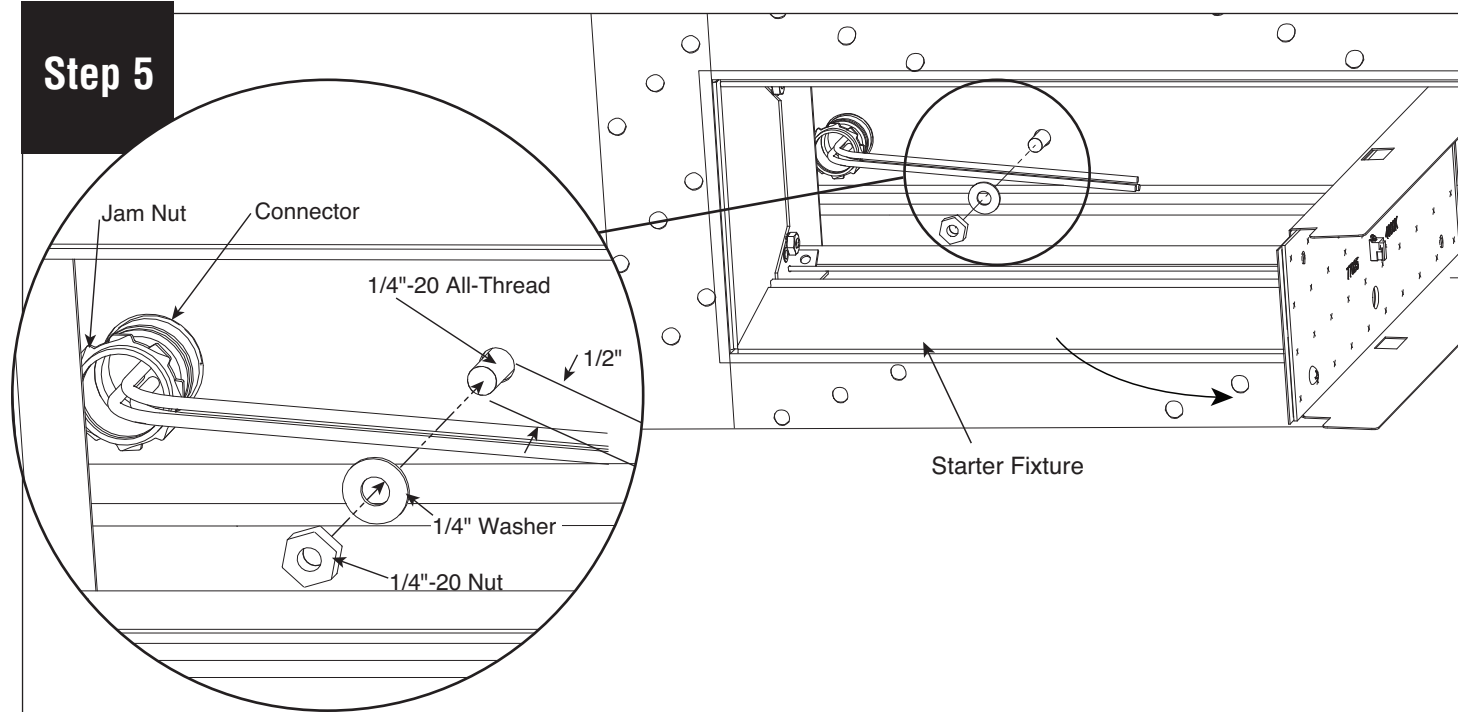

Install jam nut onto connector. Install 1/4"-20 nut and 1/4" washer onto 1/4"-20 All-Thread (provide by others)

### Step 5a

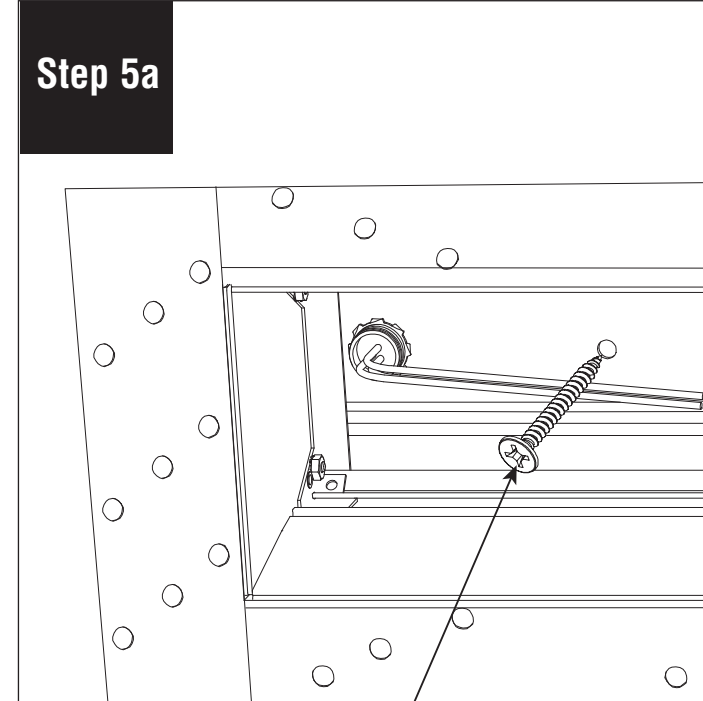

**ALTERNATE OPTION:** Install screw (provided by others) through mounting hole into proper structurally supported blocking (provided by others).

### Alternate Option

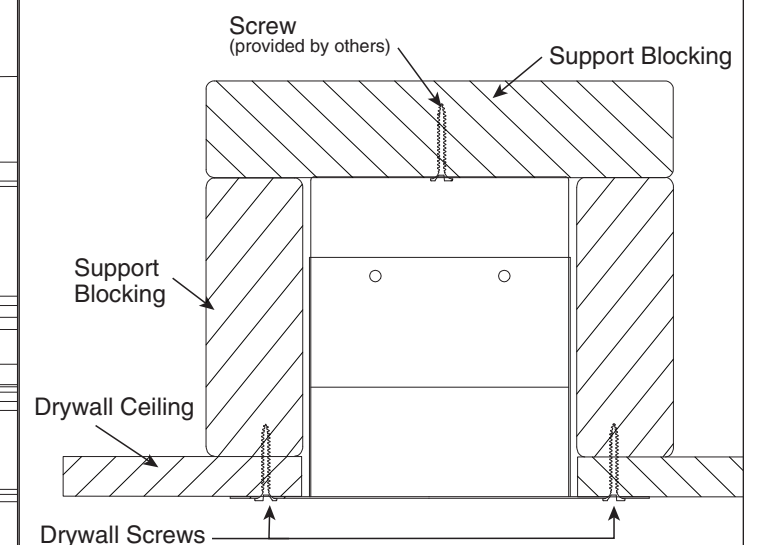

### Step 6

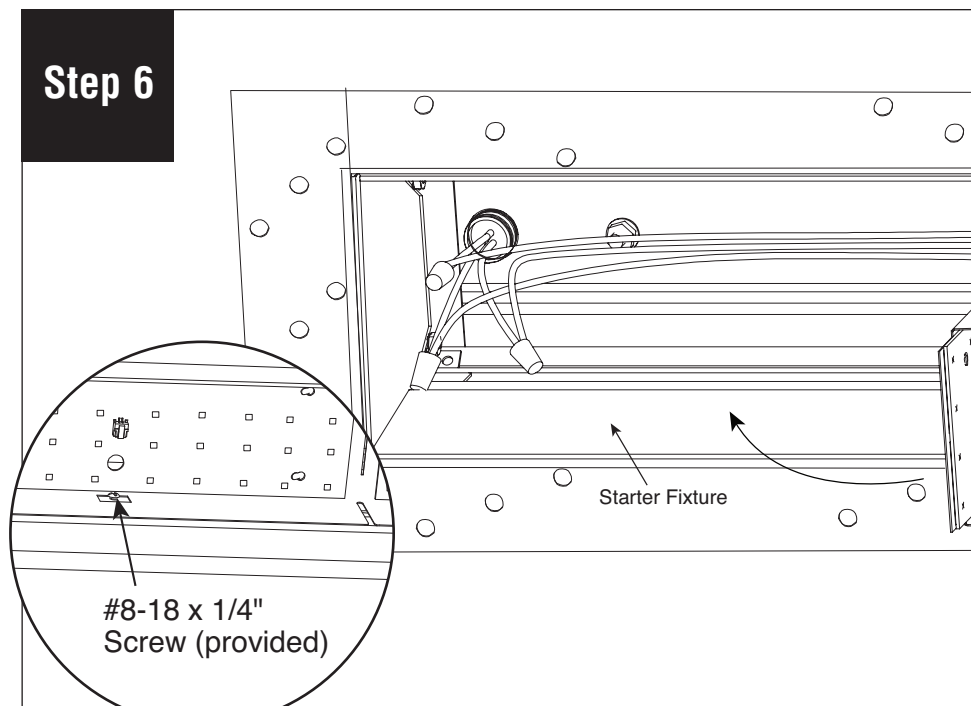

Make wire connections and secure trap door with #8-18 x 1/4" screw (provided).

### Step 7

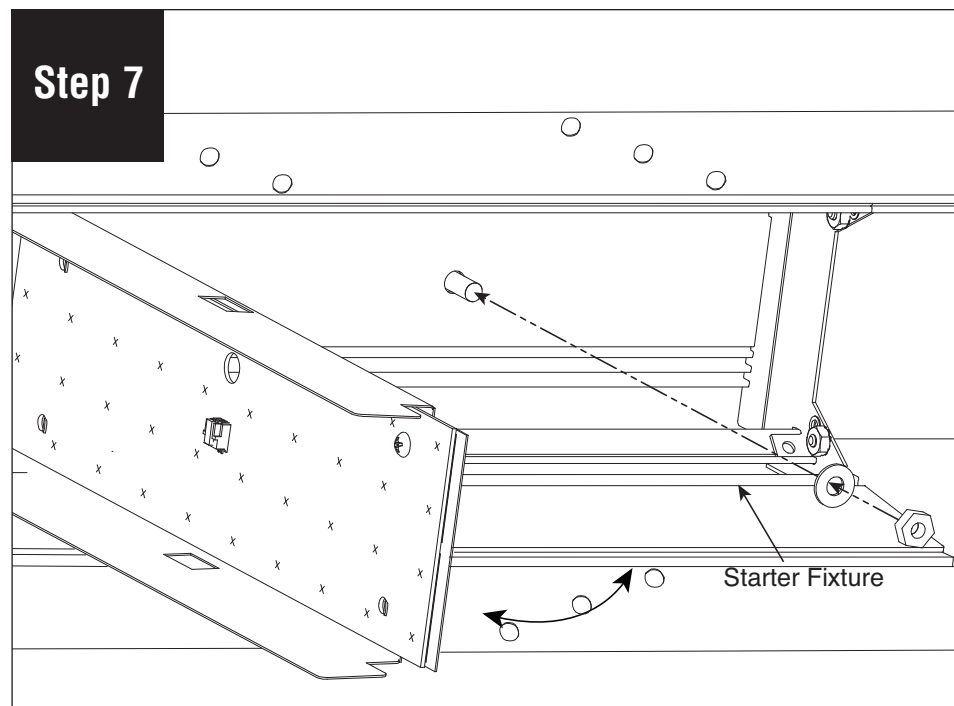

On opposite end of fixture, fold trap door down. Install 1/4"-20 nut and 1/4" washer onto 1/4"-20 All-Thread or use ALTERNATE OPTION. Replace trap door and fasten with #8-18 x 1/4" screws (provided).

### Step 8

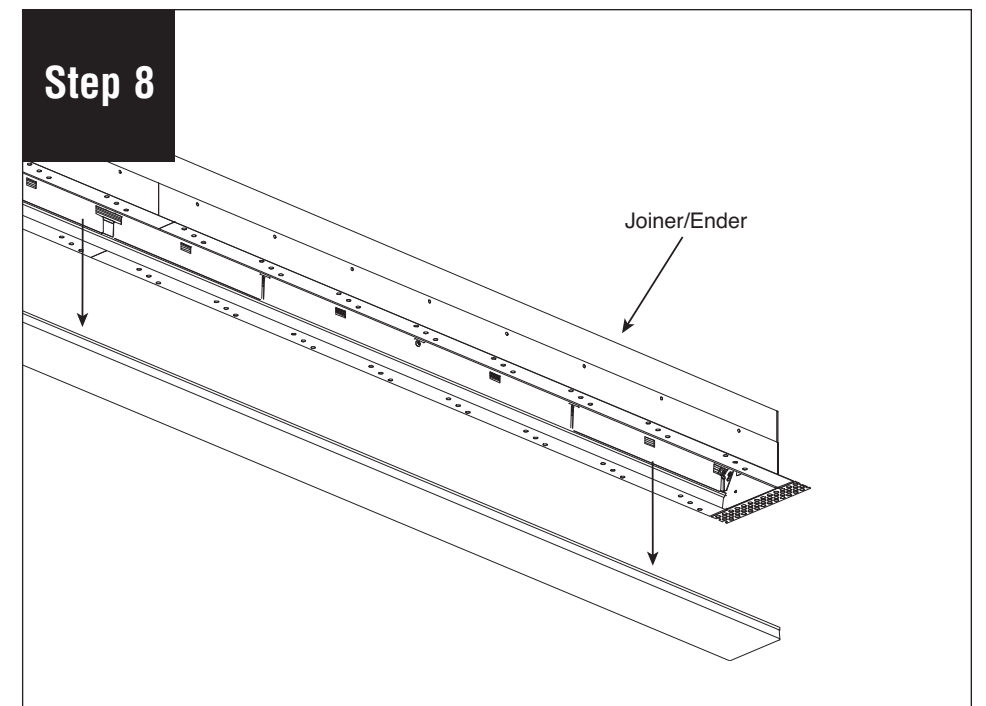

Remove bottom diffuser from joiner/ender and set it aside to prevent it from getting dirty or damaged.

# FINELITE

## HP-4 Recessed with Regressed Diffuser Spackle Flange Joiner/Ender Installation Instructions

### Step 9

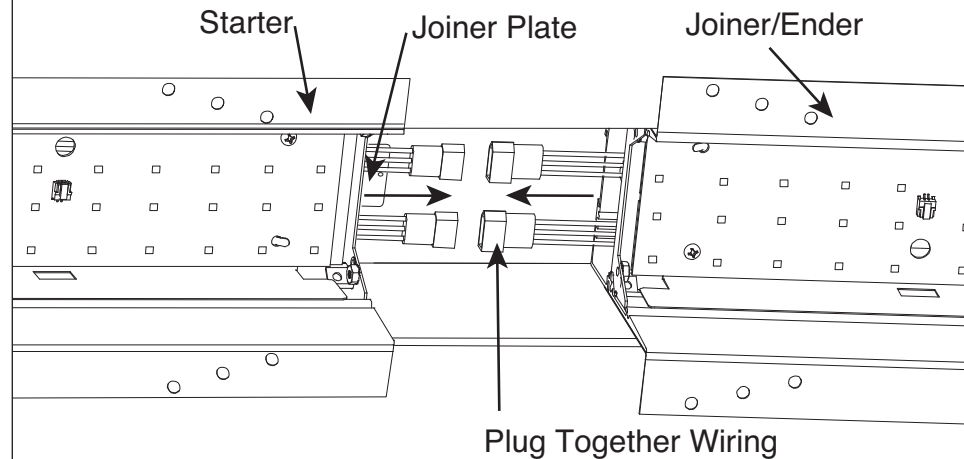

Connect plug together wiring. Slide joiner fixture against starter fixture. Be careful not to damage any wiring.

### Step 10

### IMPORTANT STEP

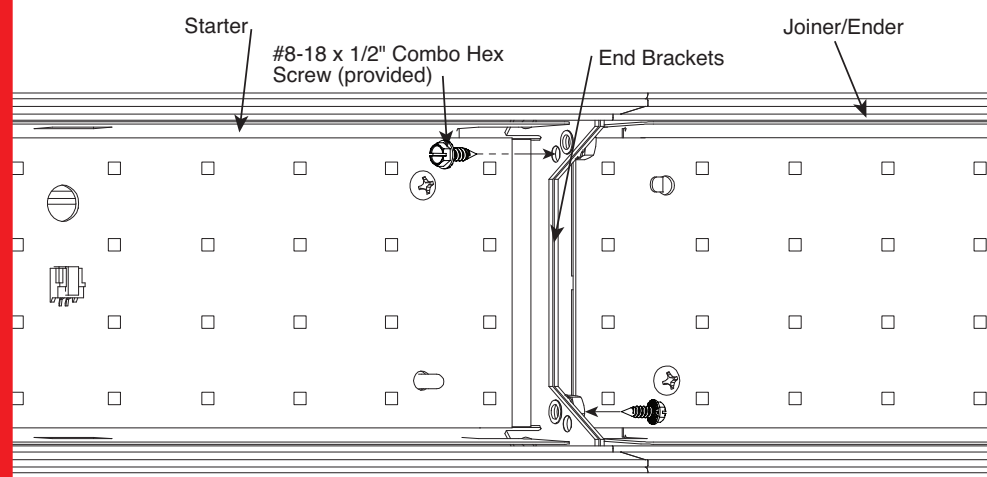

Install 2 #8-18 x 1/2" combo hex screws (provided) into end brackets as shown. Screws can be installed from the left or right.

### Step 11

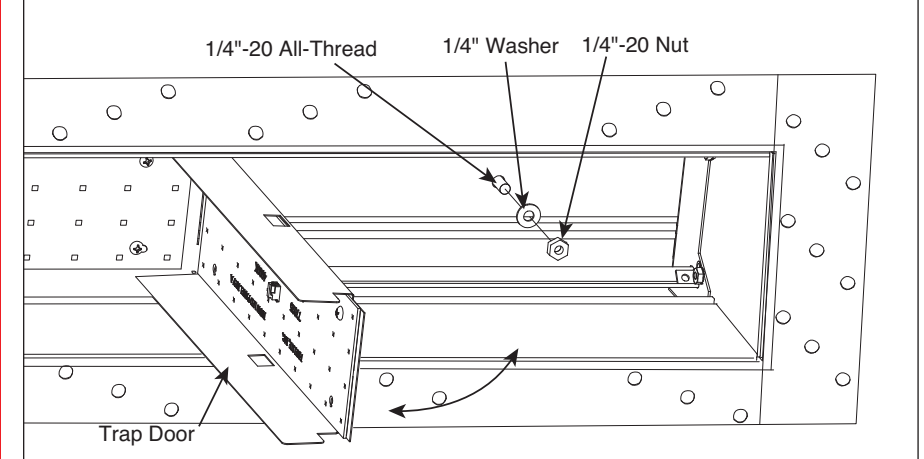

Fold trap door down. Install 1/4" washer and 1/4"-20 nut onto 1/4"-20 All-Thread or use ALTERNATE OPTION (see step 5A). Replace trap door and fasten with screws.

### Step 12

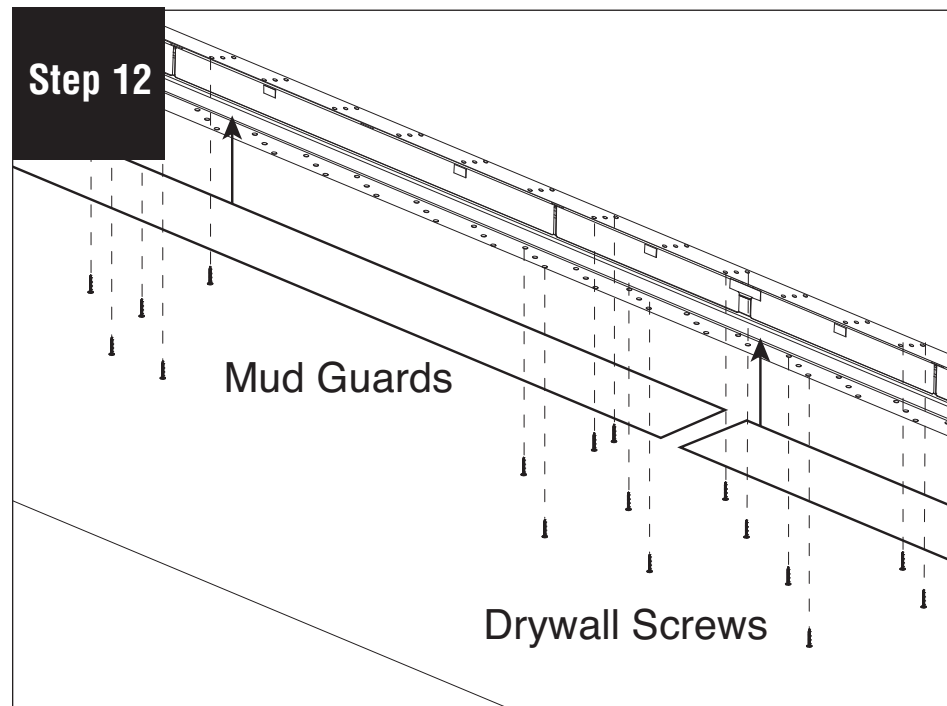

Fasten fixture to the ceiling with drywall screws (by others) through flange into blocking. Install the "mud guard" cardboard inserts (provided) to help prevent spackle from getting into the light fixture.

### Step 13

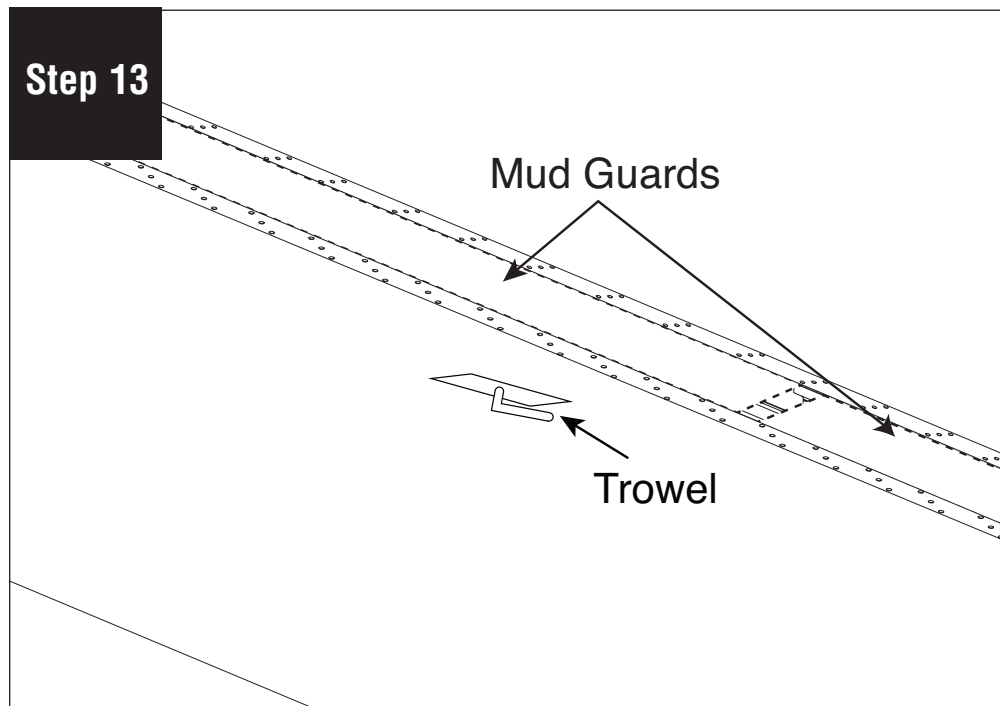

Use spackle to cover up the flanges. Remove the "mud guard" cardboard inserts (provided) when done.

### Step 14

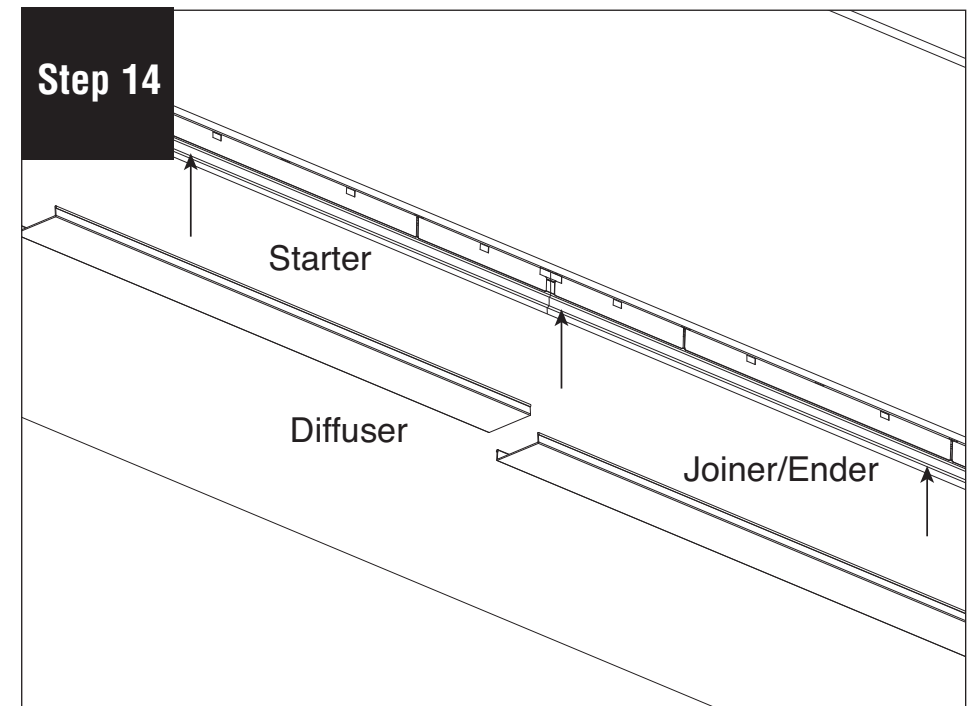

Reinstall diffuser and turn power on.