

FINELITE

HP-4 Recessed with Regressed Lens Visible Flange Starter/Independent Installation Instructions

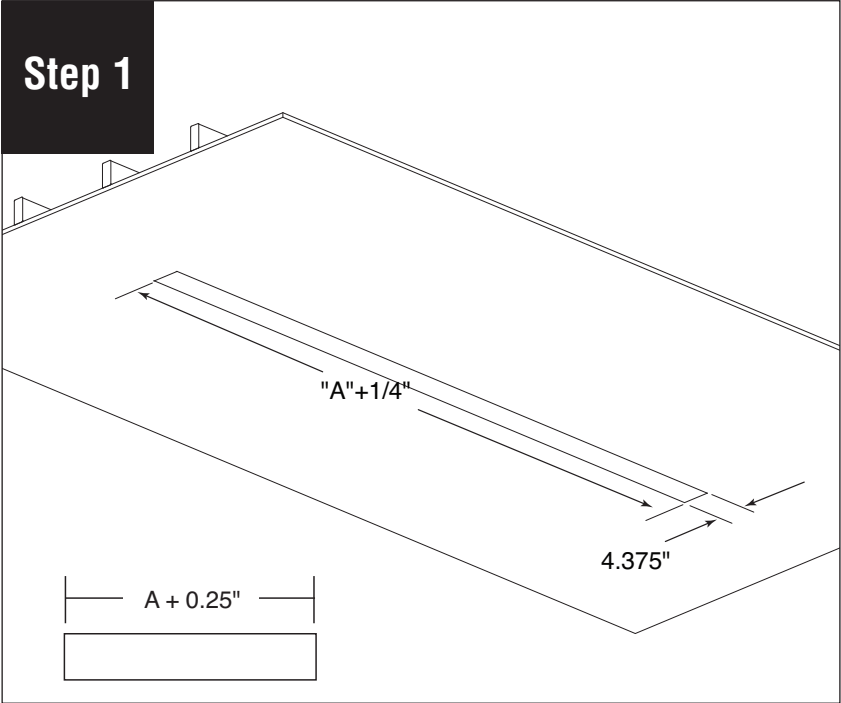

Add 0.25" to body/row length (A) +/- 1/16" to simplify installation. Fixture installed next to supporting block (optional).

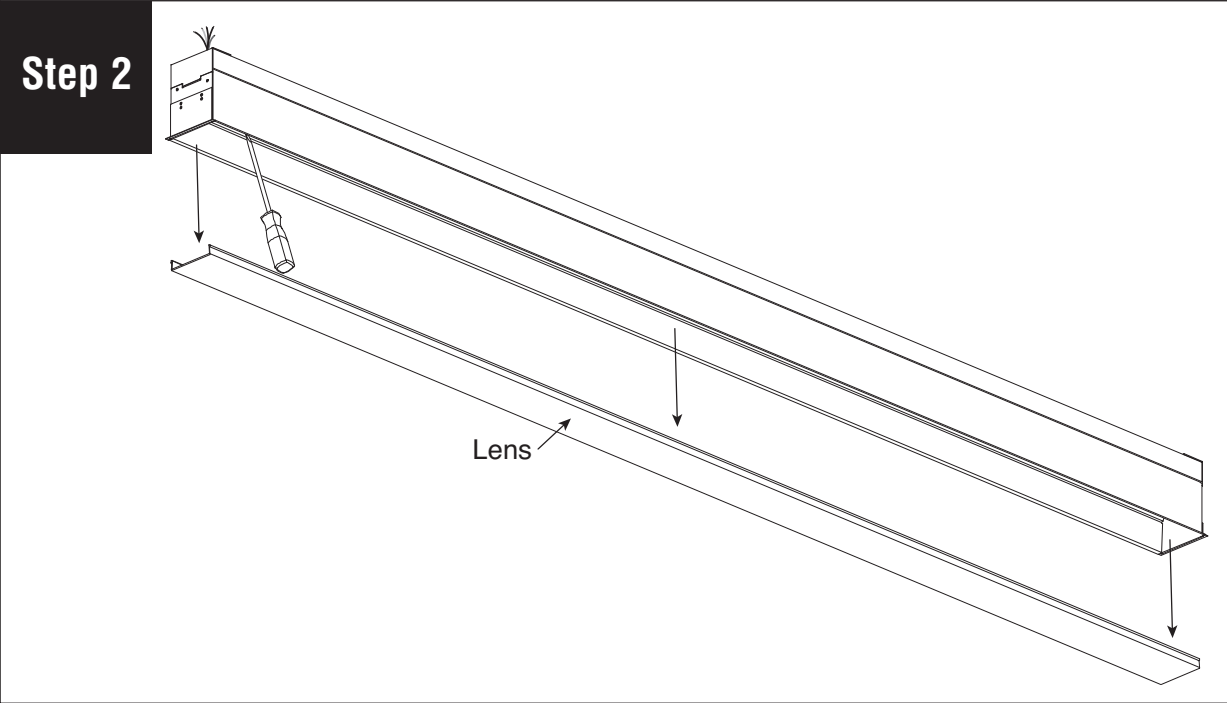

Remove bottom lens by wedging a screwdriver between the lens and the body. Carefully pivot screwdriver to unsnap the lens from the body. Set lens aside to prevent it from getting dirty or damaged during installation.

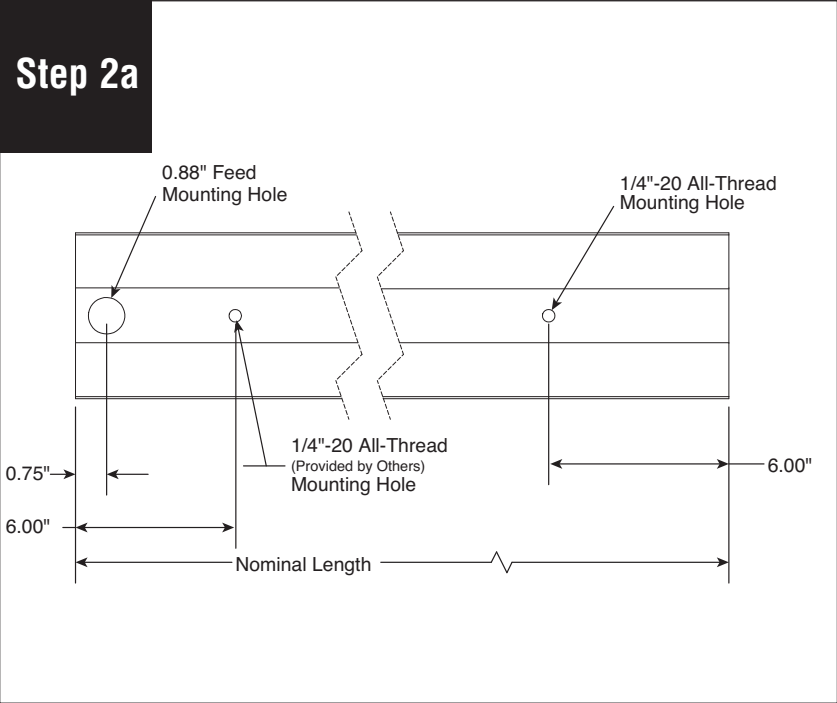

Refer to threads and feed hole locations above before connecting fixture wires.

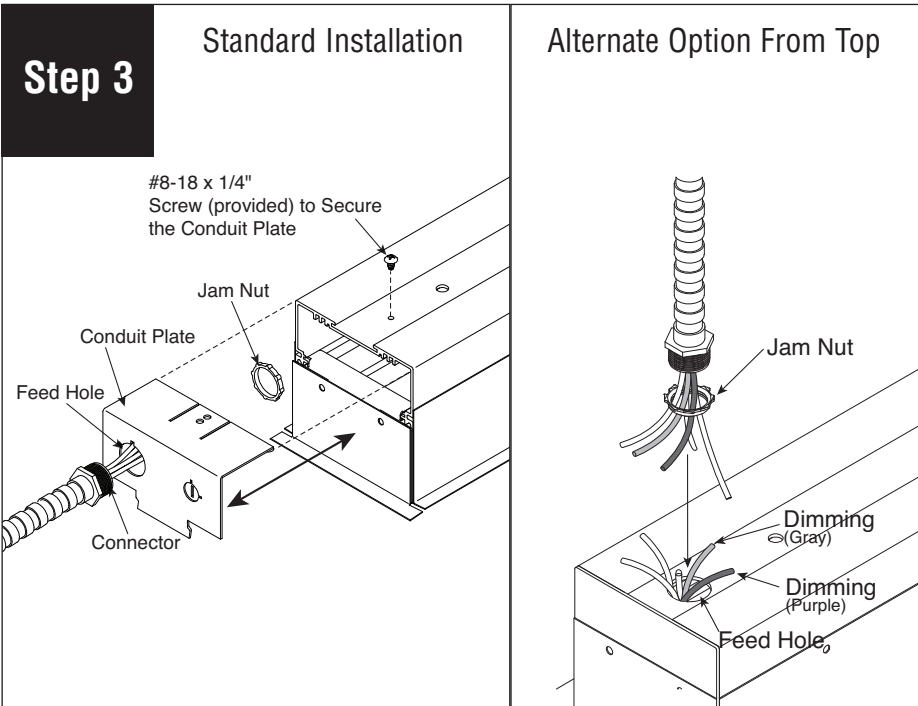

Remove jam nut from conduit then insert wires and connector through feed hole.

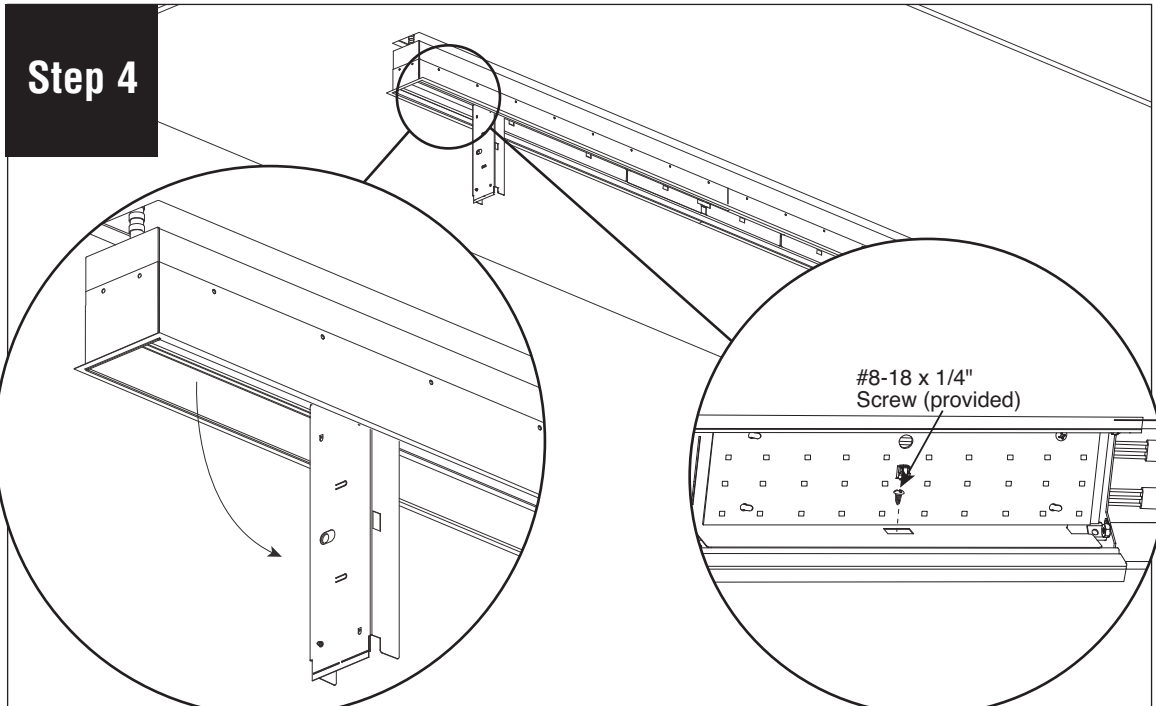

Remove #8-18 x 1/4" screw (provided) to open trap door and then insert fixture into ceiling. Align fixture within rough opening in drywall and 1/4"-20 All-Thread.

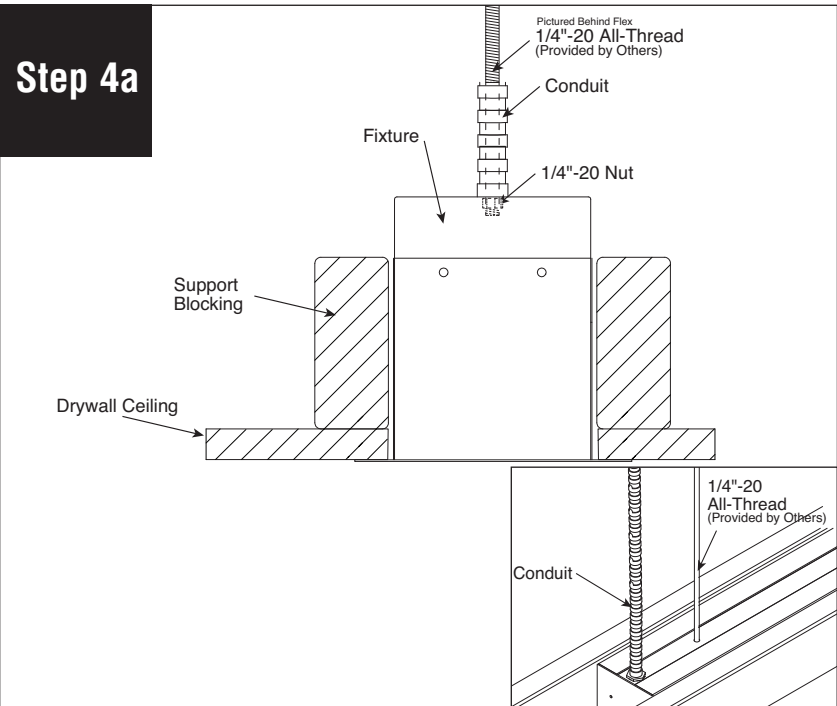

Secure fixture to structure using 1/4"-20 All-Thread.

FINELITE

HP-4 Recessed with Regressed Lens Visible Flange Starter/Independent Installation Instructions

Step 5

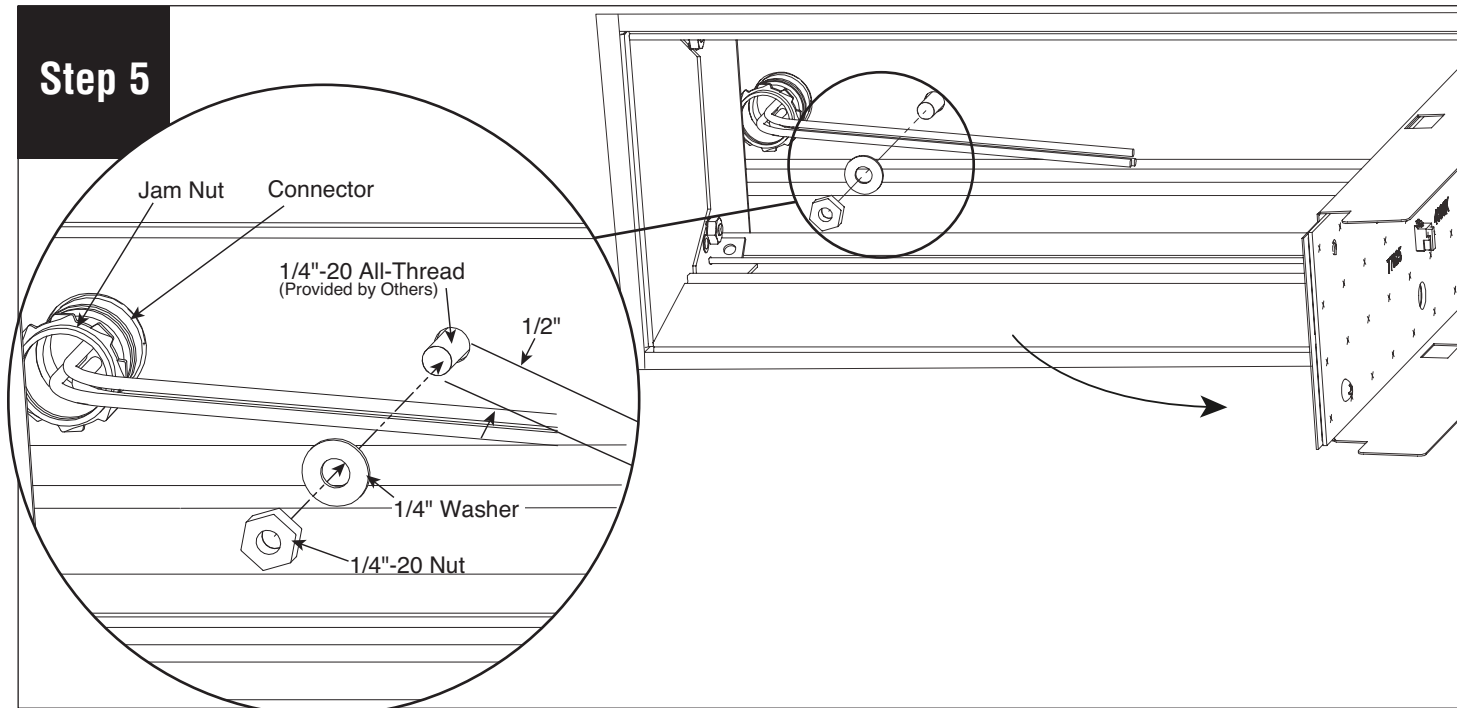

Install jam nut onto connector. Install 1/4\"-20 nut and 1/4\" washer onto 1/4\"-20 All-Thread (provided by others)

Step 5a

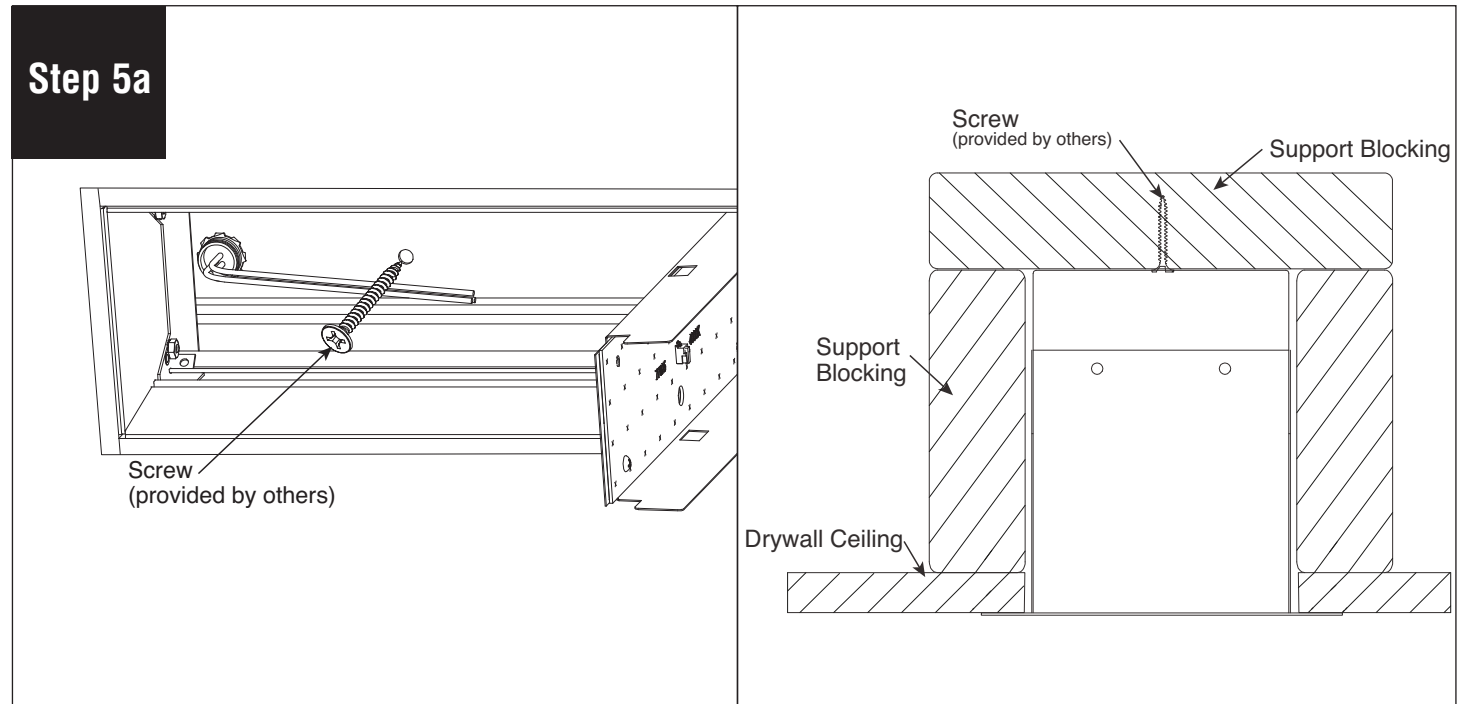

ALTERNATE OPTION: Install screw (provided by others) through mounting hole into proper backing (provided by others).

Step 6

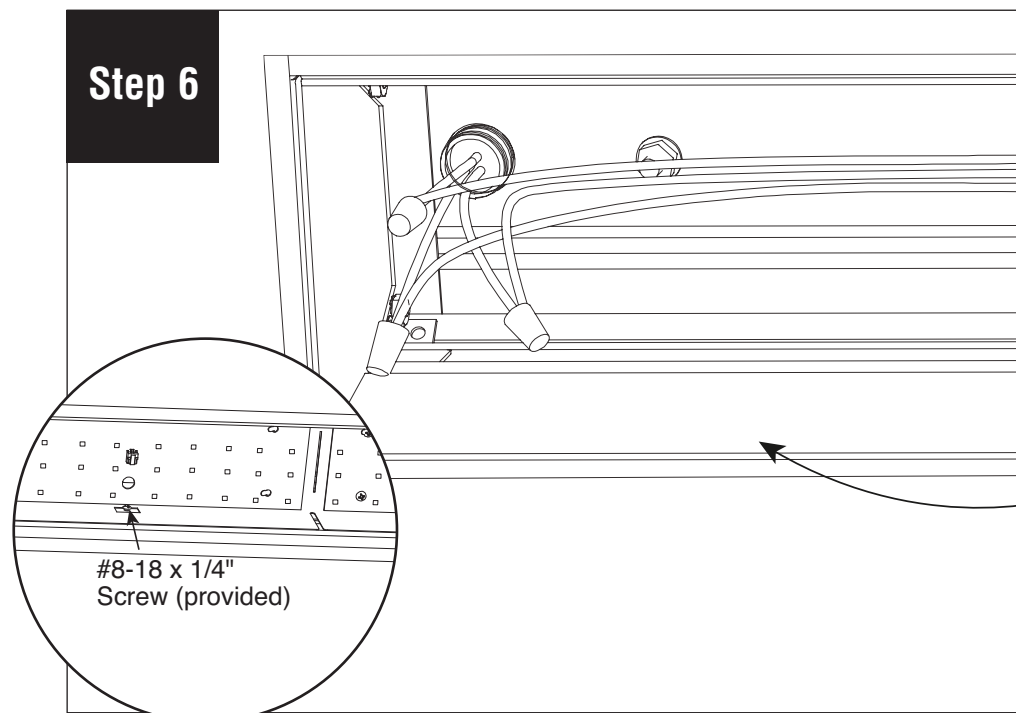

Make wire connections and secure trap door with #8-18 x 1/4\" screw (provided).

Step 7

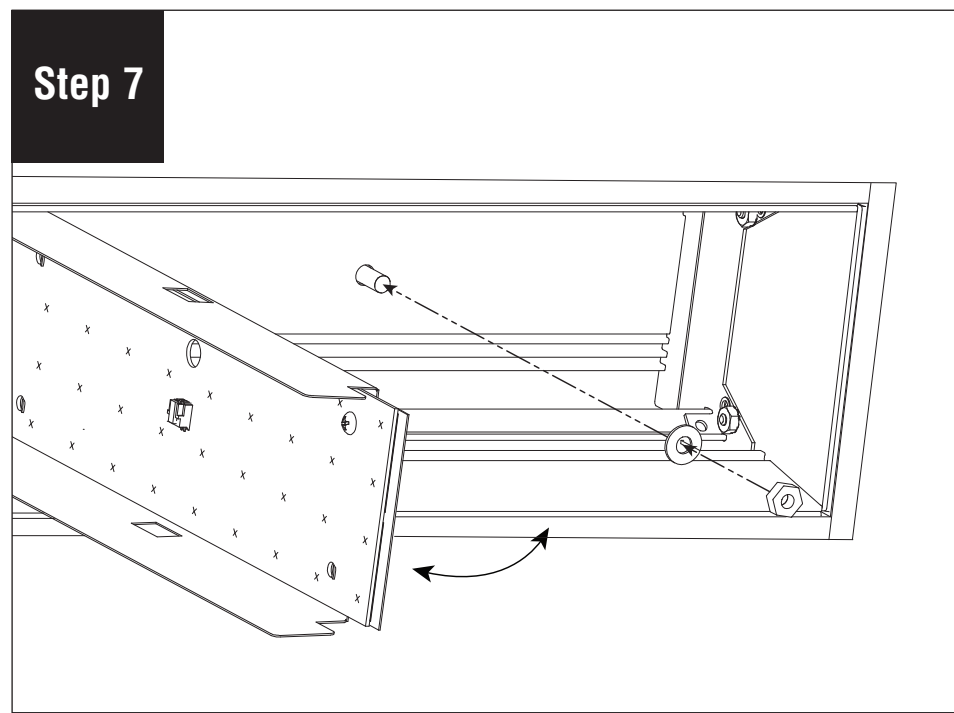

On opposite end of fixture, fold trap door down. Install 1/4\"-20 nut and 1/4\" washer onto 1/4\"-20 All-Thread or use ALTERNATE OPTION. Replace trap door and fasten with #8-18 x 1/4\" screws (provided).

Step 8

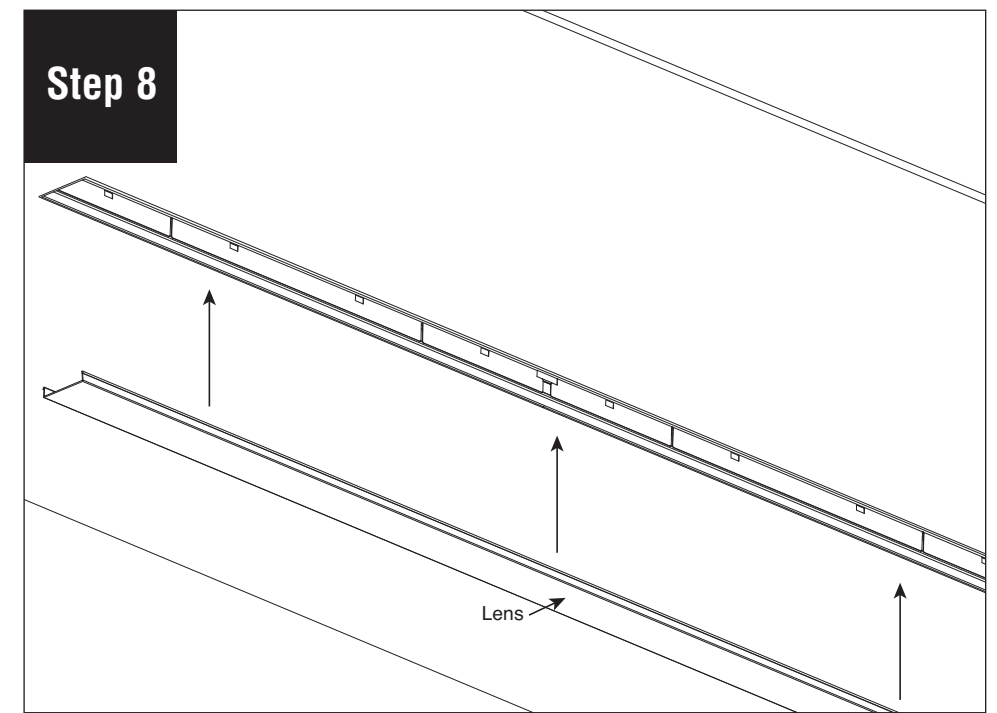

Reinstall lens and turn power on.

FINELITE

HP-4 Recessed with Regressed Lens Visible Flange Joiner Installation Instructions

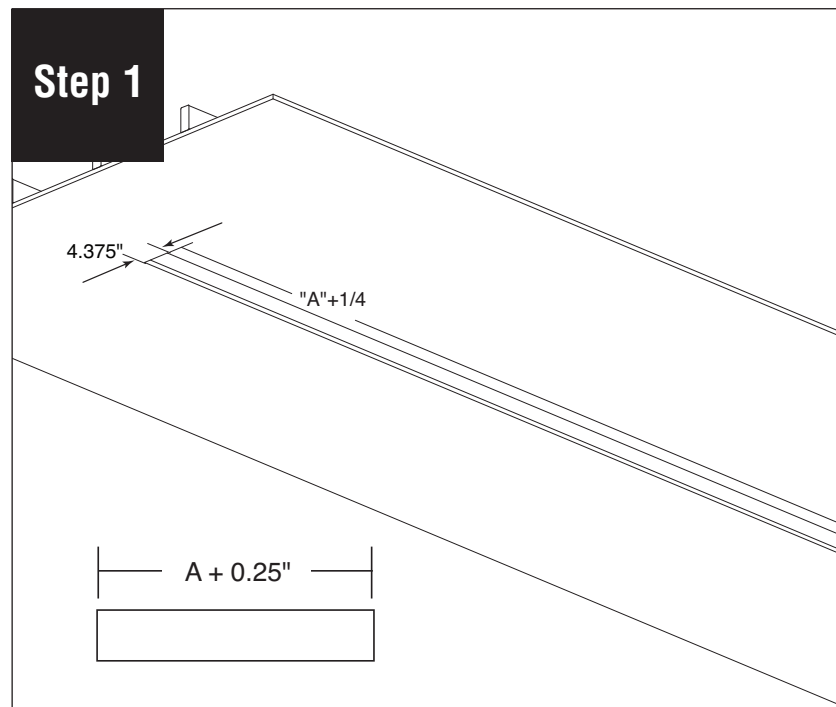

Turn off the power to the fixture's circuit. Provide rough opening according to the measurements indicated. Fixture needs to be installed next to support blocking.

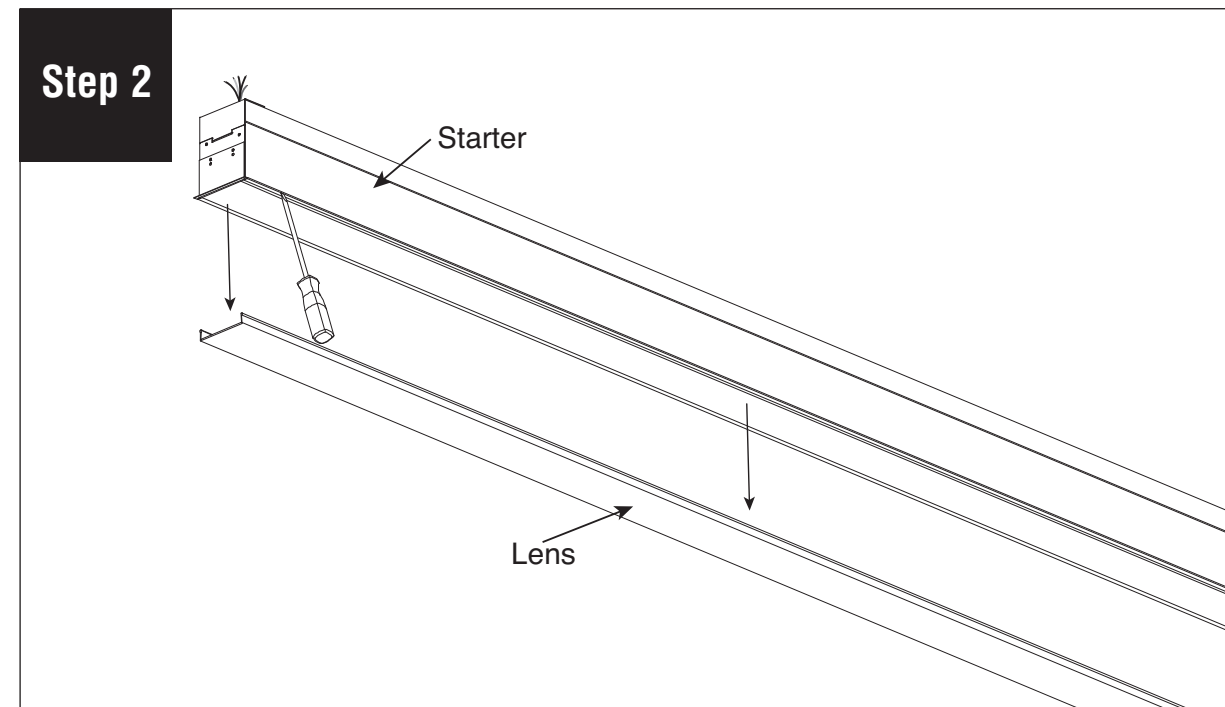

Remove bottom lens by wedging a screwdriver between the lens and the body. Carefully pivot screwdriver to unsnap the lens from the body. Set lens aside to prevent it from getting dirty or damaged during installation.

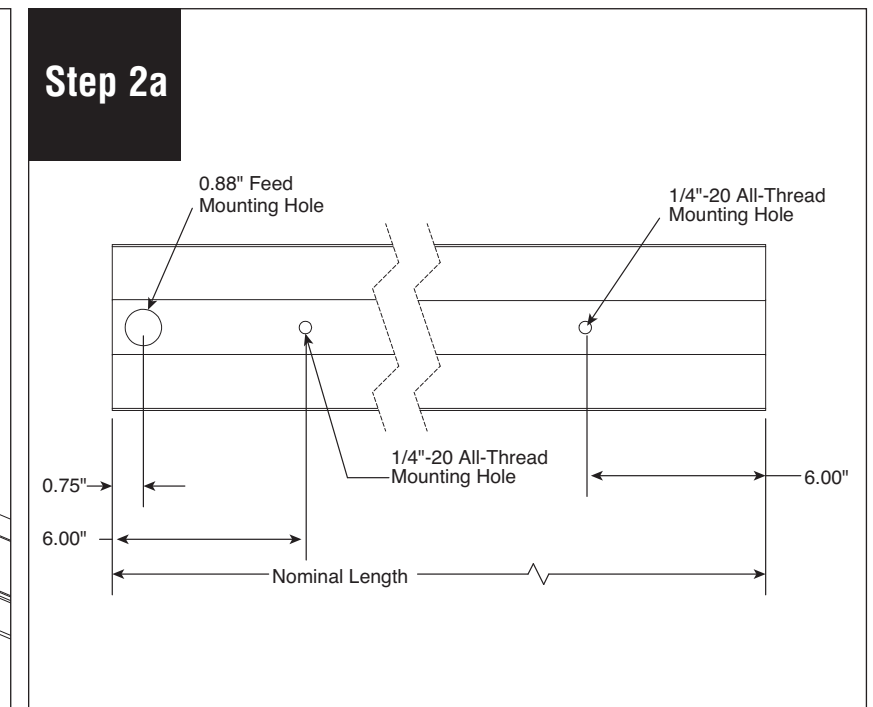

Refer to threads and feed hole locations above before connecting fixture wires.

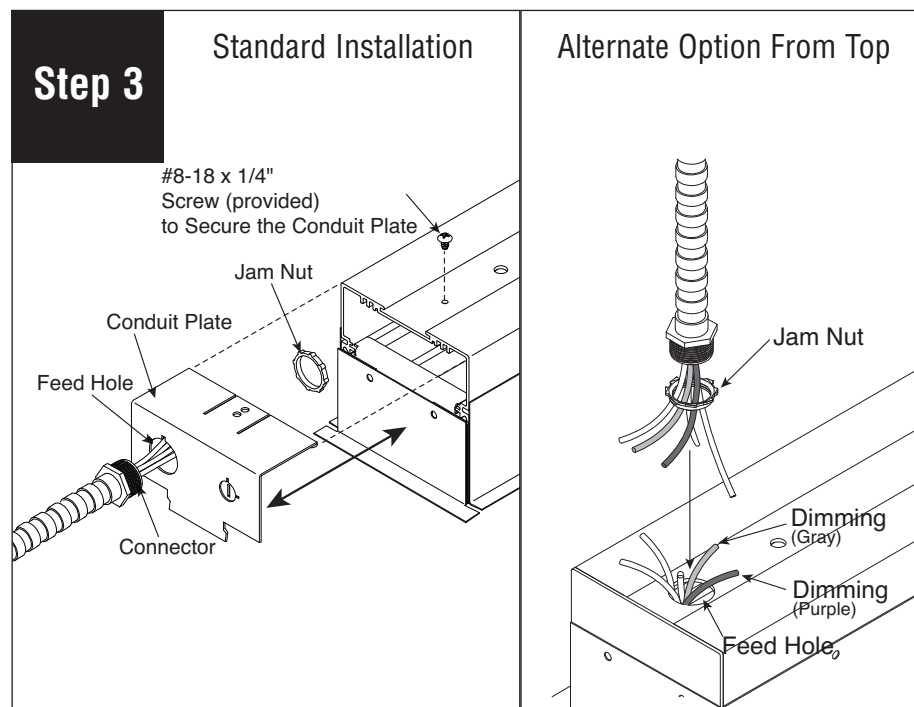

Remove jam nut from conduit then insert wires and connector through feed hole.

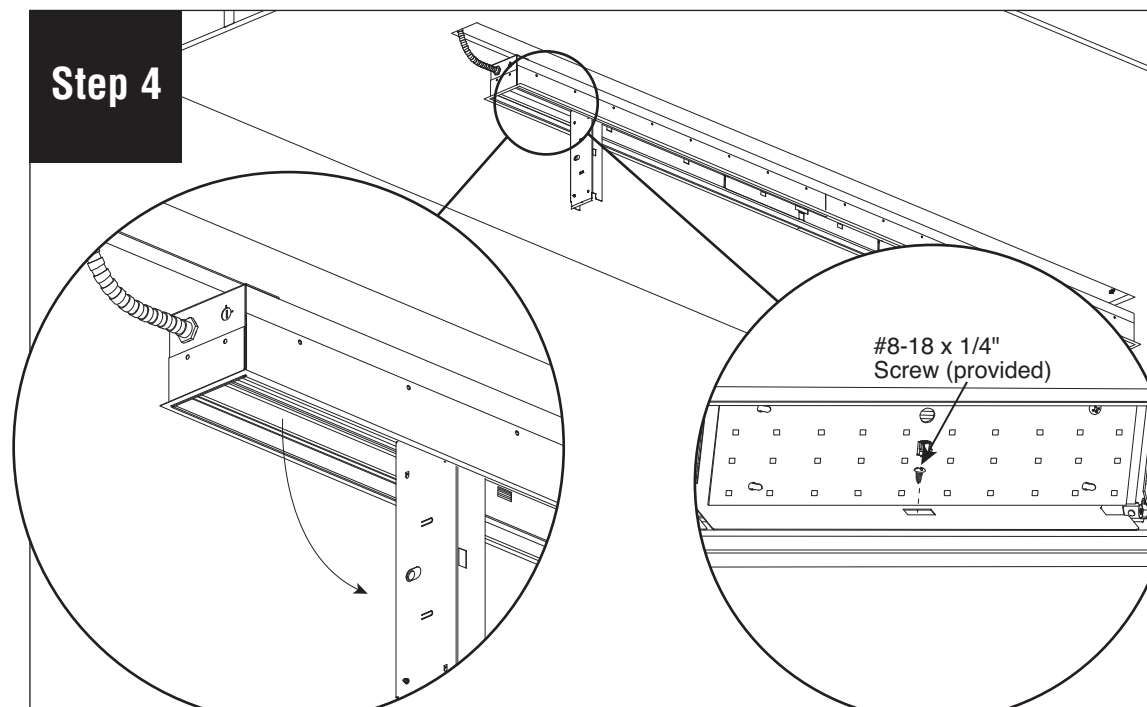

Remove #8-18 x 1/4 inch screw (provided) to open trap door and then insert fixture into ceiling. Align starter fixture within rough opening in drywall and 1/4 inch-20 All-Thread.

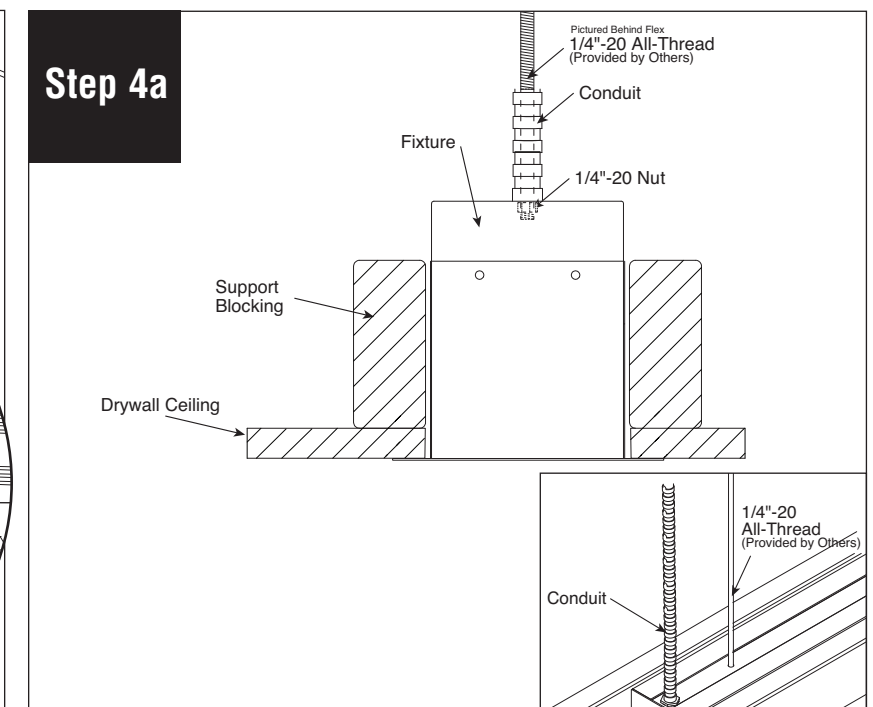

Secure fixture to structure using 1/4 inch-20 All-Thread.

FINELITE

HP-4 Recessed with Regressed Lens Visible Flange Joiner Installation Instructions

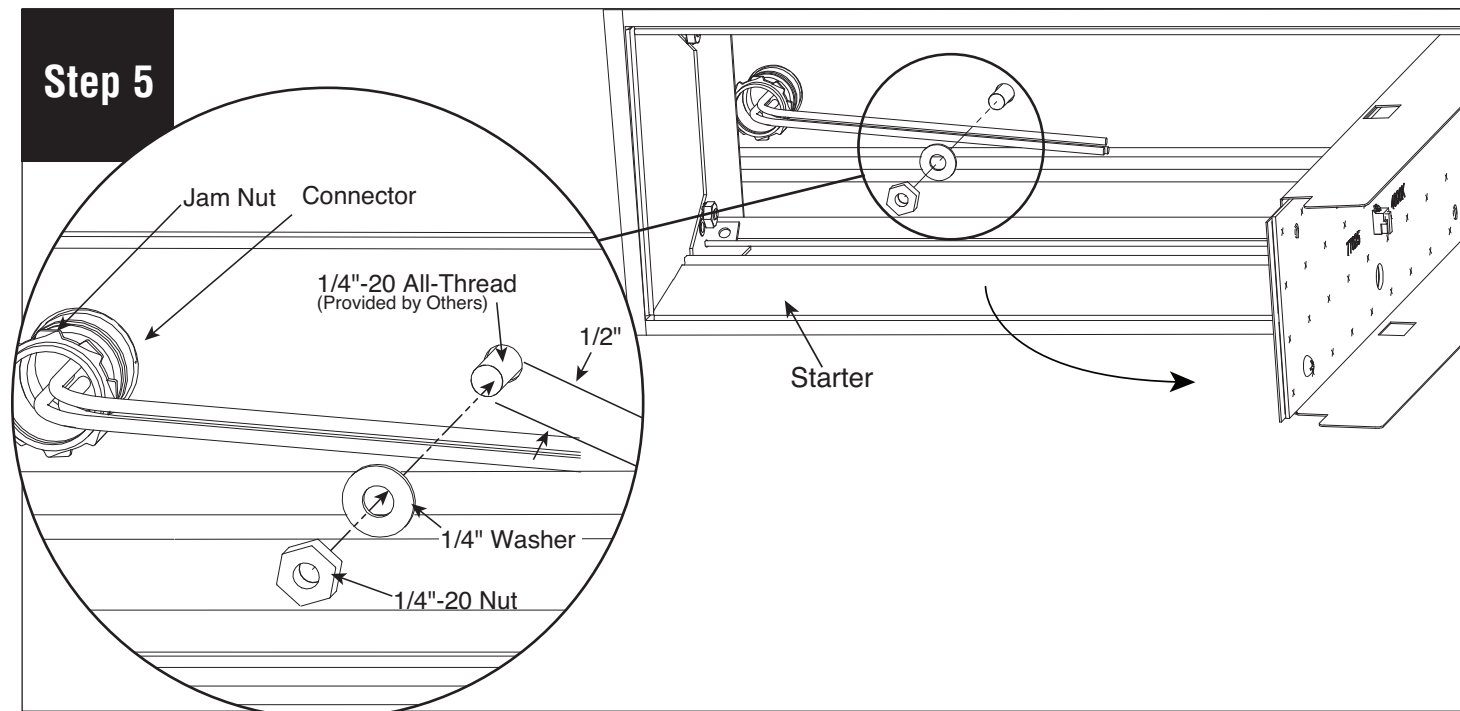

Install jam nut onto connector. Install 1/4"-20 nut and 1/4" washer onto 1/4"-20 All-Thread (provide by others)

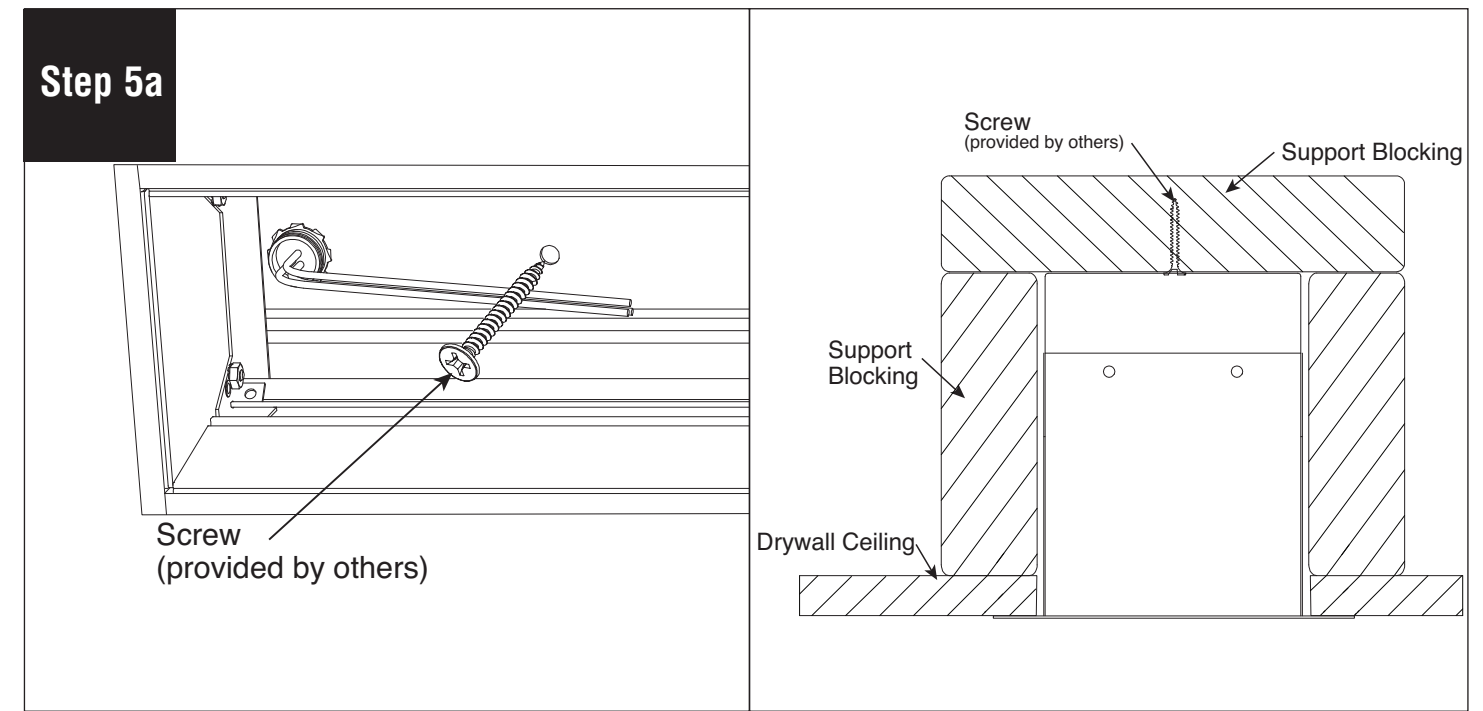

ALTERNATE OPTION: Install screw (provided by others) through mounting hole into proper backing (provided by others).

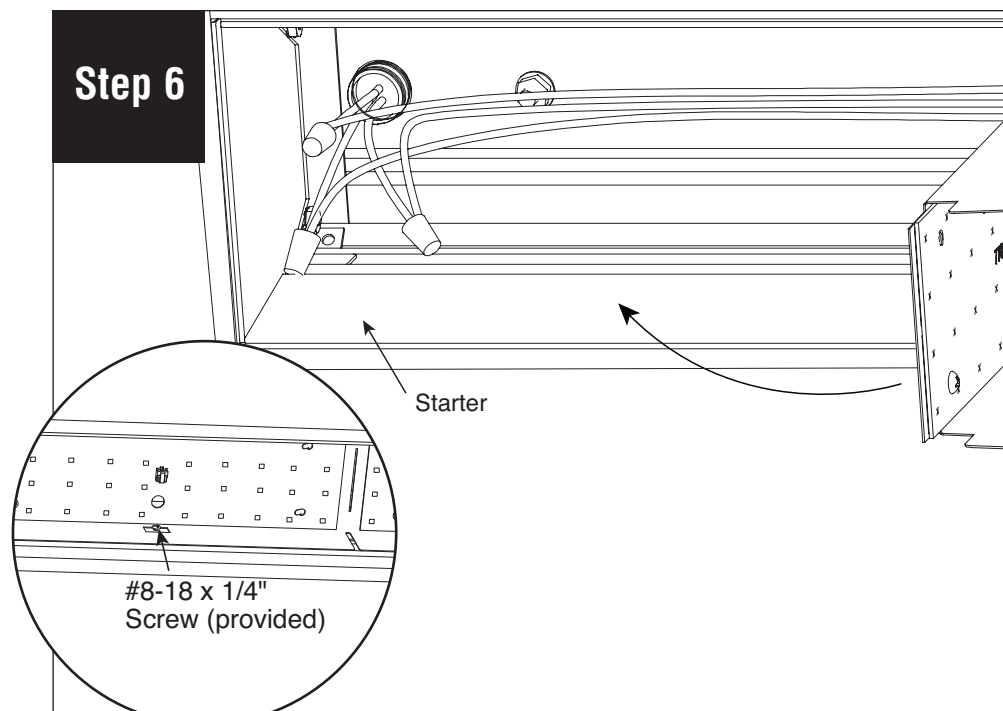

Make wire connections and secure trap door with #8-18 x 1/4" screw (provided).

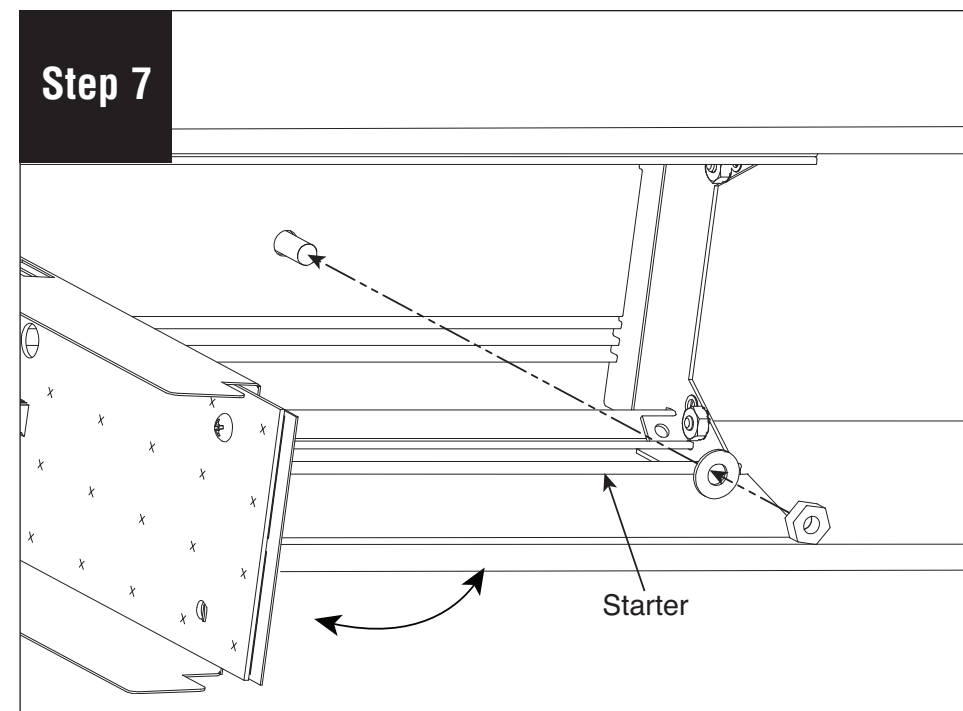

On opposite end of fixture, fold trap door down. Install 1/4"-20 nut and 1/4" washer onto 1/4"-20 All-Thread or use ALTERNATE OPTION. Replace trap door and fasten with #8-18 x 1/4" screws (provided).

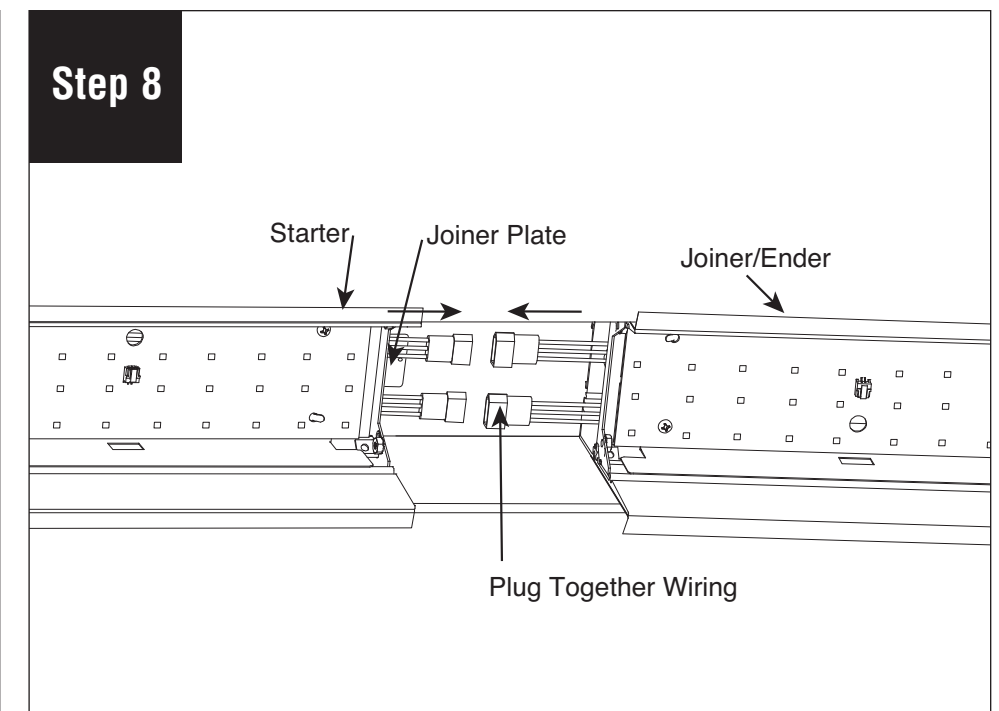

Connect plug together wiring. Slide joiner fixture against starter fixture. Be careful not to damage any wiring.

FINELITE

HP-4 Recessed with Regressed Lens Visible Flange Joiner

Installation Instructions

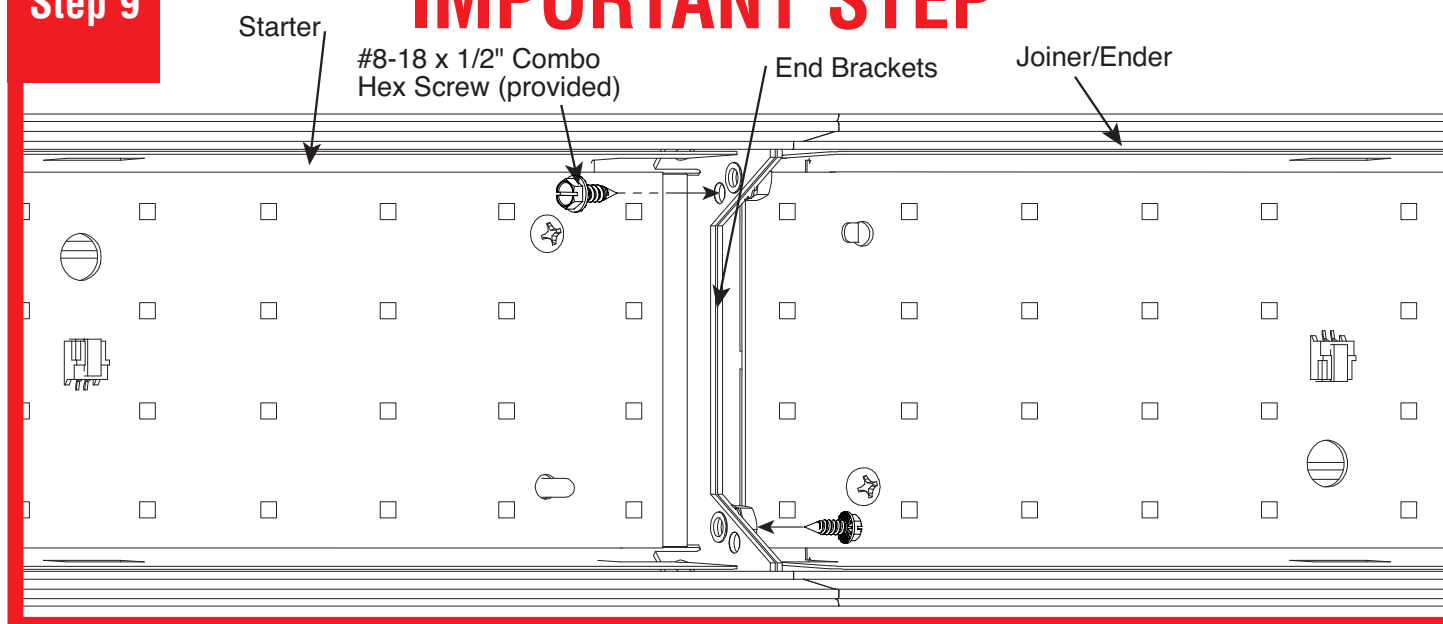
Step 9**IMPORTANT STEP**

Install 2 #8-18 x 12" combo hex screws (provided) into end brackets as shown. Screws can be installed from the left or right.

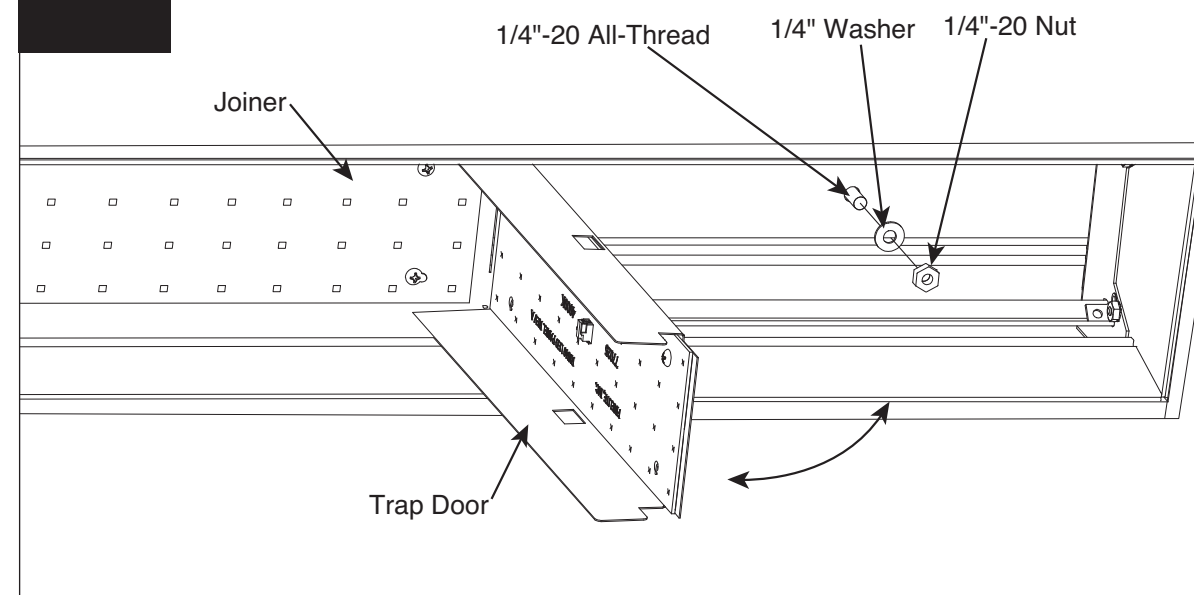
Step 10

On opposite end of fixture, fold trap door down. Install 1/4" washer and 1/4"-20 nut onto 1/4"-20 All-Thread or use ALTERNATE OPTION (see step 5A). Replace trap door and fasten with #8-18 x 1/4" screws (provided).

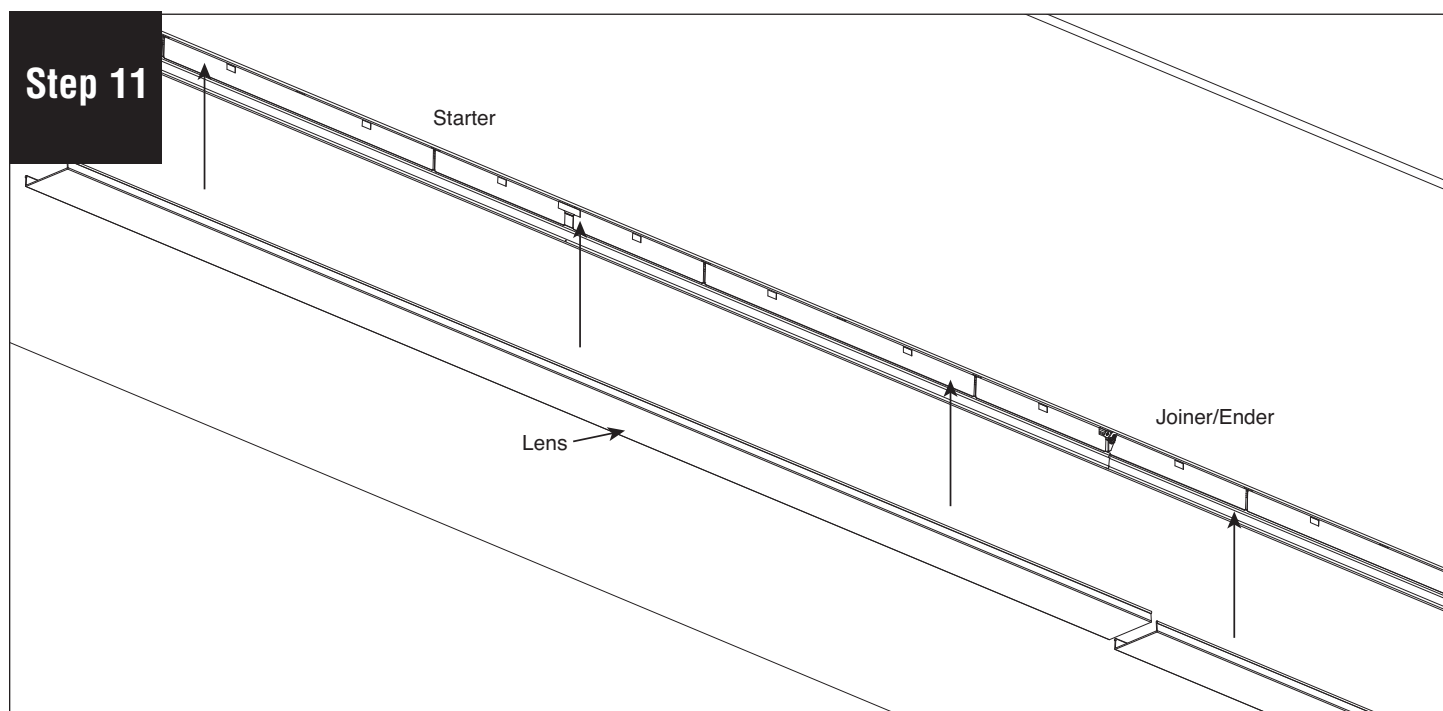
Step 11

Reinstall lens and turn power on.