

FINELITE

HP-4 Recessed with Regressed Lens Tech Zone 6" Starter/Independent Installation Instructions

Step 1

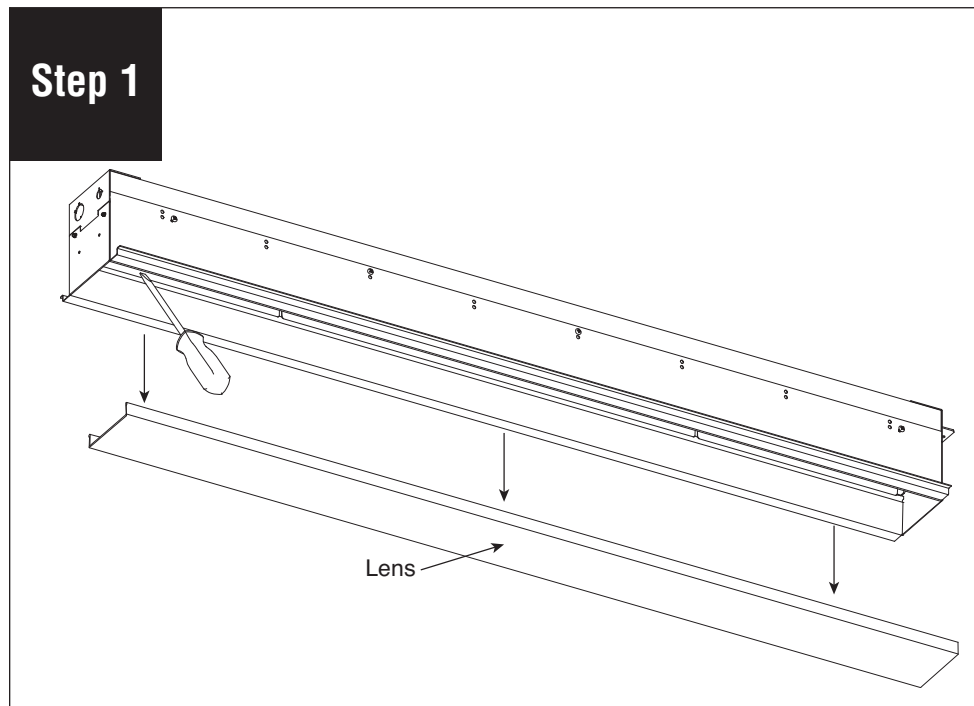

Insert screwdriver in between fixture body and lens. Pivot Screwdriver slightly to release locking fixture of lens. Set lens aside to prevent it from getting dirty or damaged during installation.

Step 2

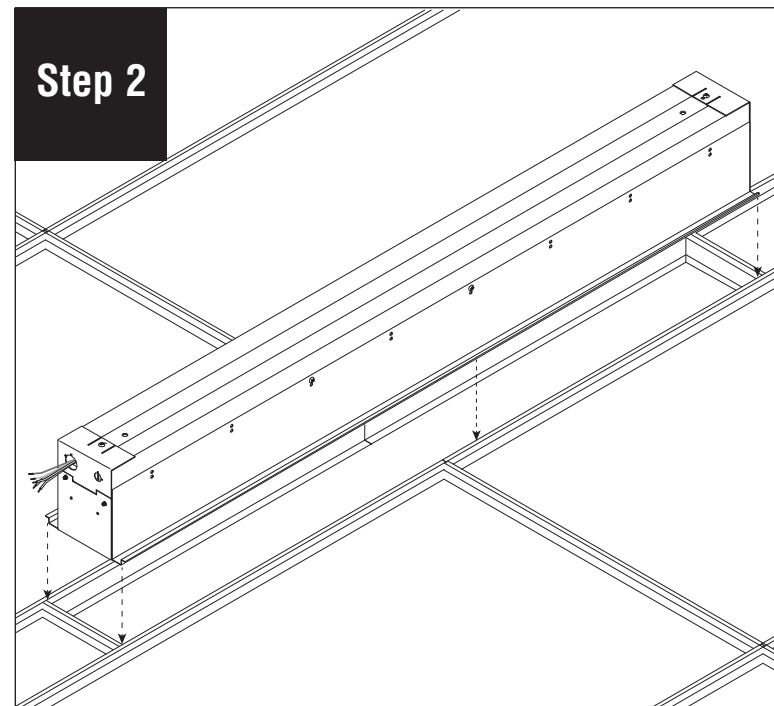

Place fixture on ceiling grid.

Tech Zone 6" Collection. Center-to-center T-Grid spacing.

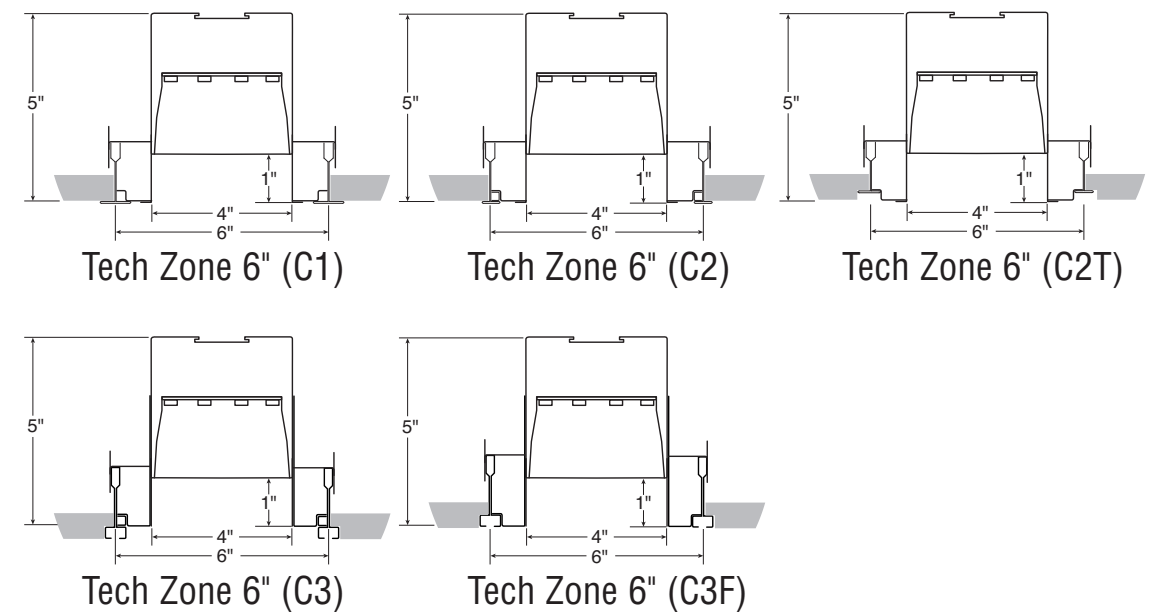

Step 3

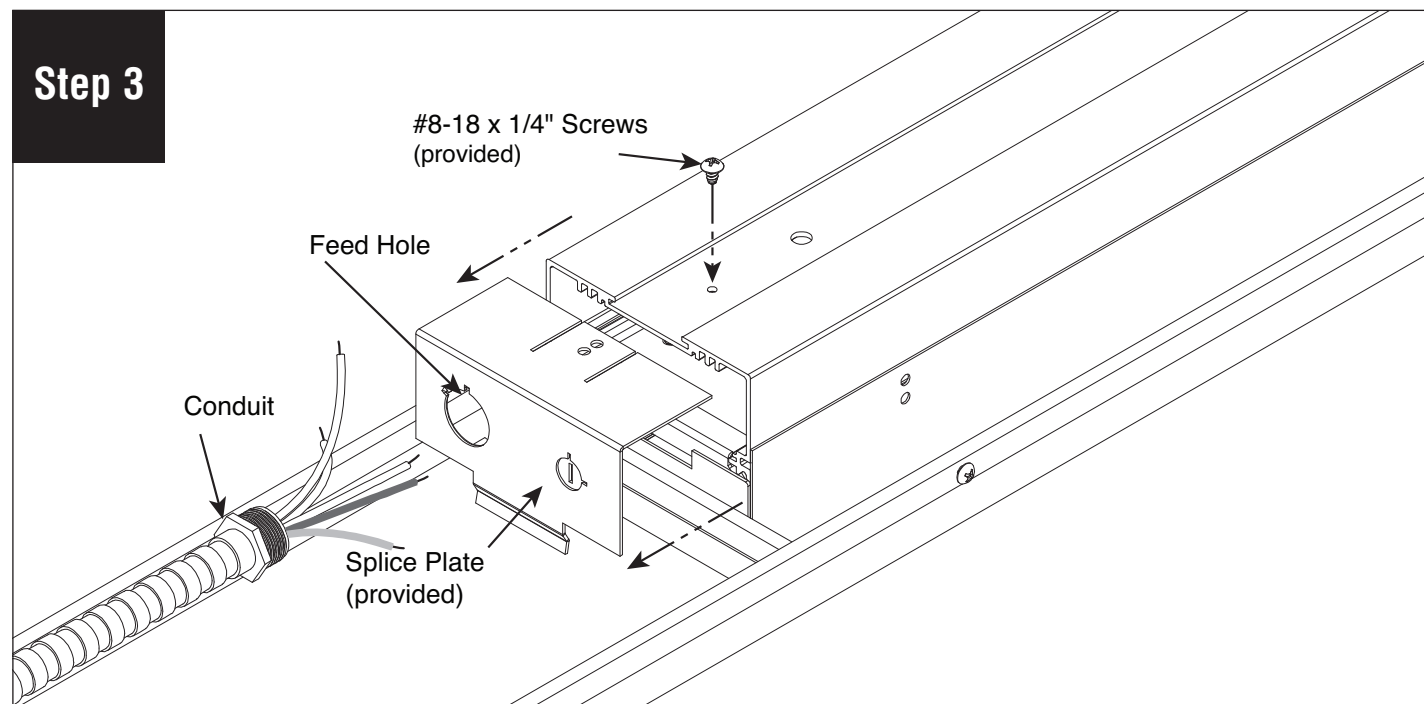

Remove #8-18 x 1/4" screw (provided) and splice plate. Install conduit onto splice plate through feed hole.

Step 4

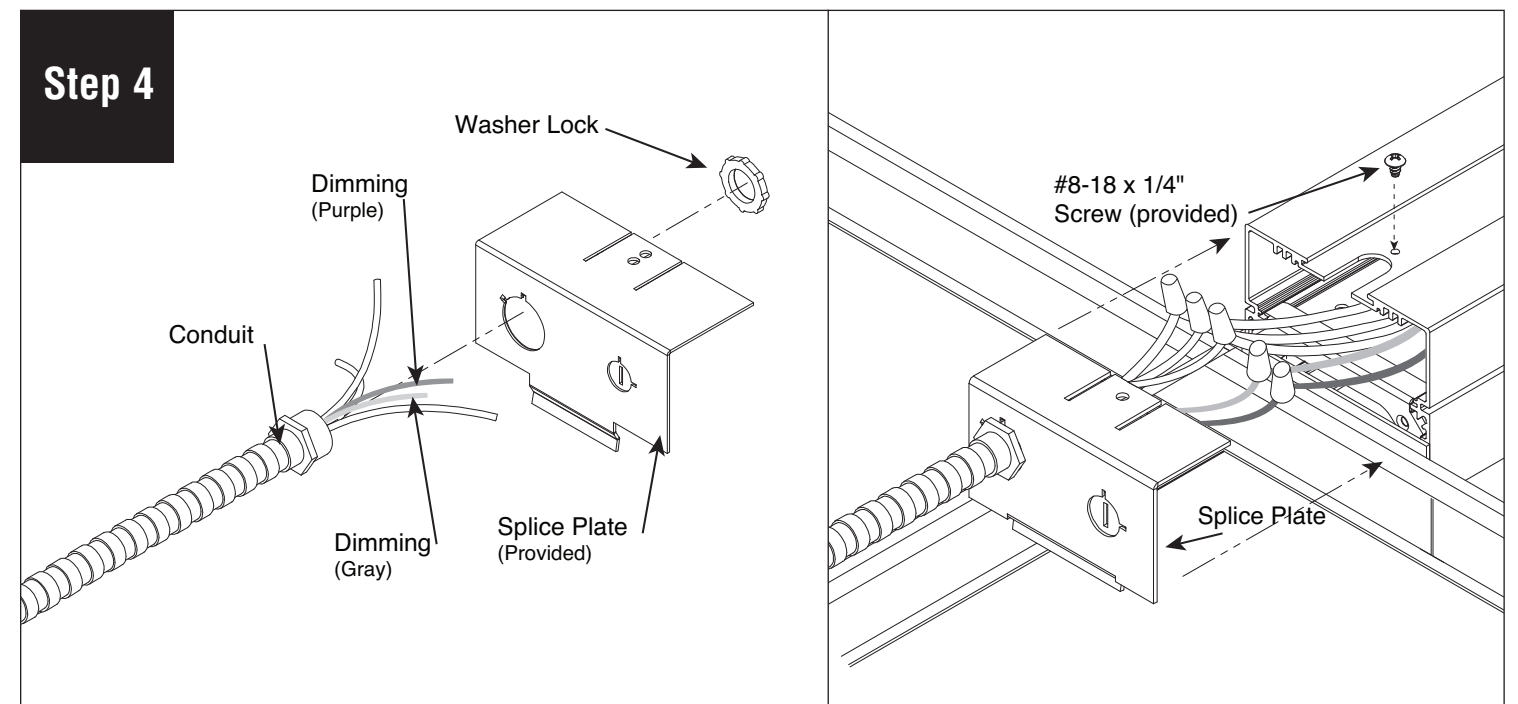

Install washer lock onto conduit connector and make wiring connections.

FINELITE

HP-4 Recessed with Regressed Lens Tech Zone 6" Starter/Independent Installation Instructions

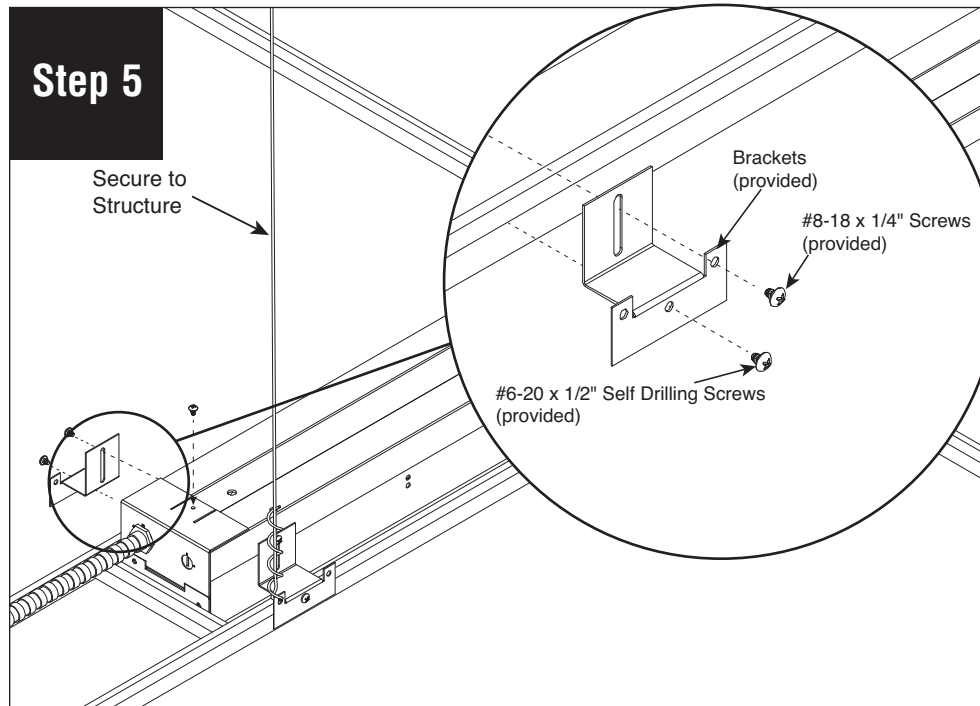
Step 5

Reinstall splice plate to fixture. Drive #6-20 x 1/2" self drilling screws (provided) through brackets into T-Grid. Connect all fixtures to building structure, as per code. Use #8-18 x 1/4" screws (provided) to install brackets on fixtures.

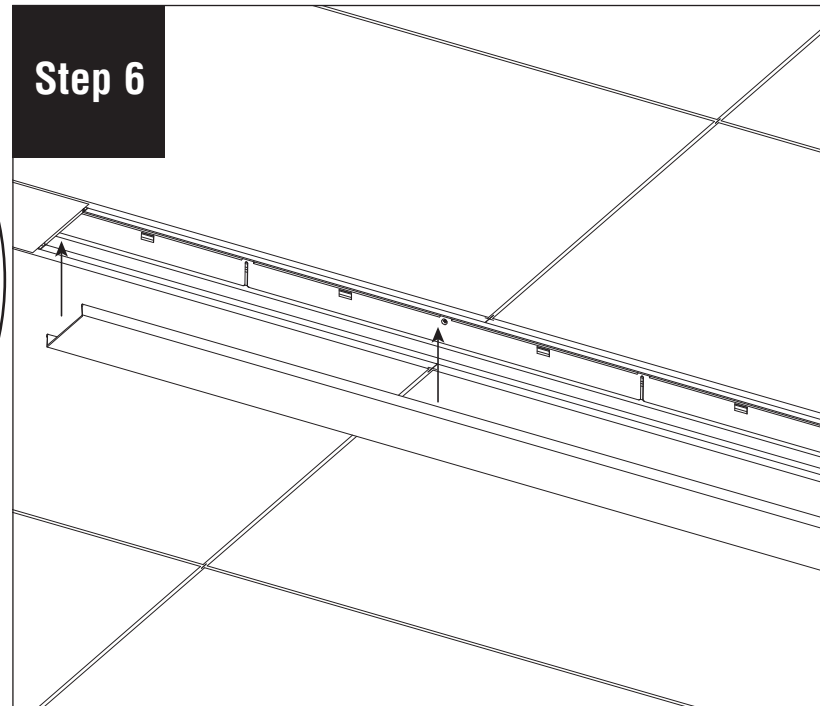
Step 6

Reinstall lens and turn power on to fixture.

FINELITE

HP-4 Recessed with Regressed Lens Tech Zone 6" Joiner Installation Instructions

Step 1

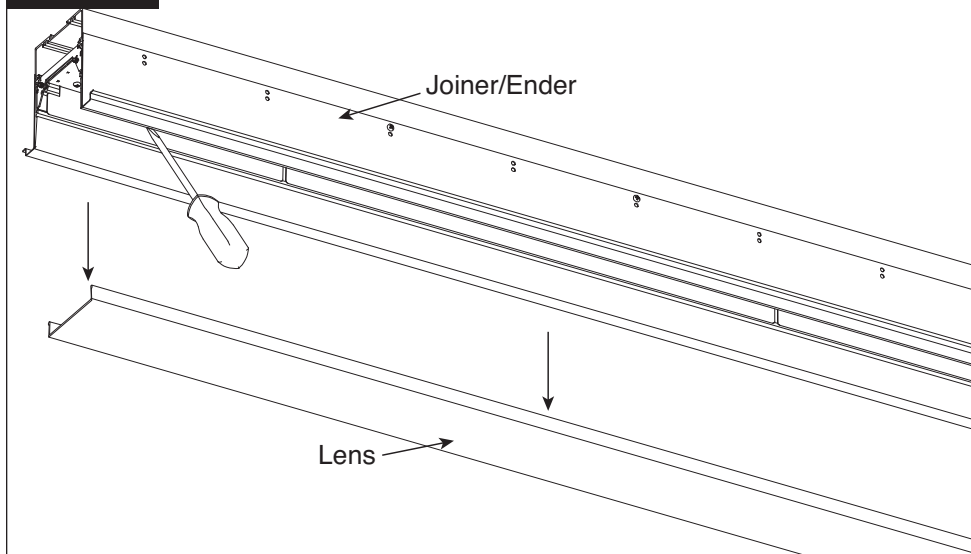

Insert screwdriver in between fixture body and lens. Pivot Screwdriver slightly to release locking feature of lens. Set lens aside to prevent it from getting dirty or damaged during installation.

Step 2

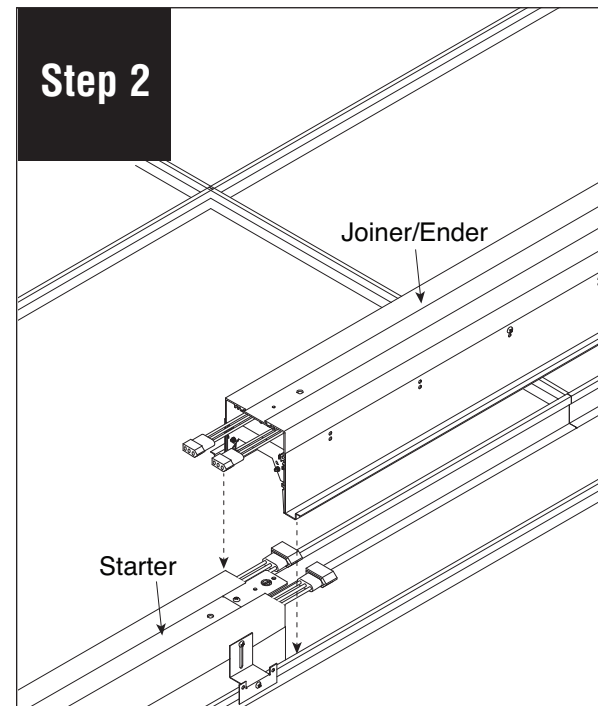

Place fixture on ceiling grid next to Starter.

Tech Zone 6" Collection. Center-to-center T-Grid spacing.

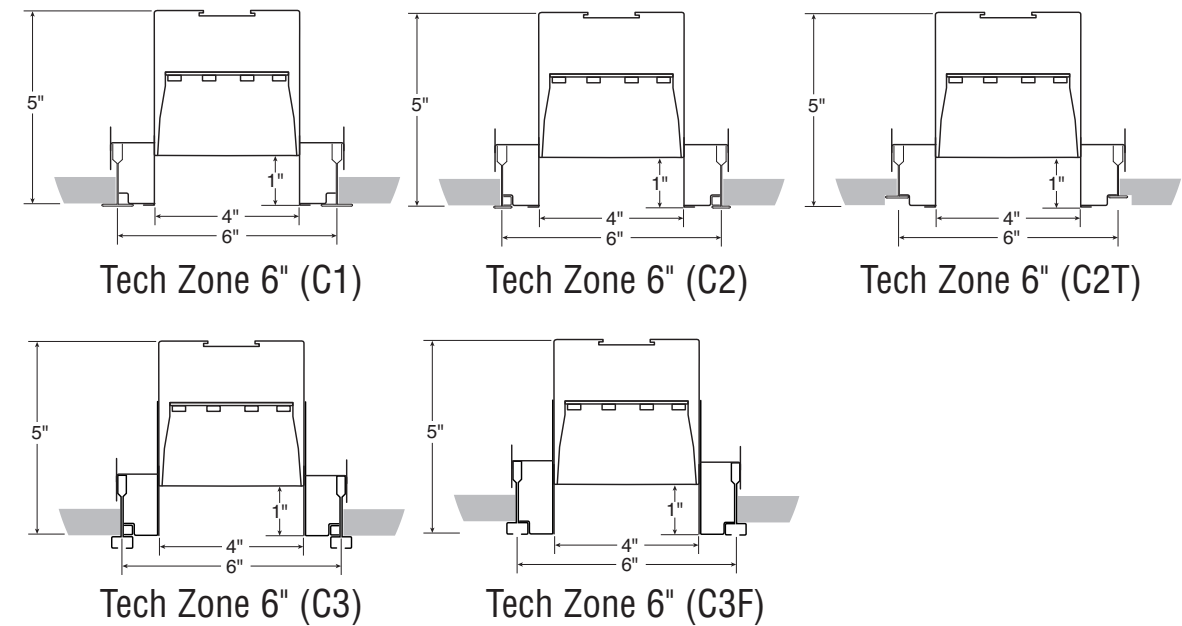

Step 3

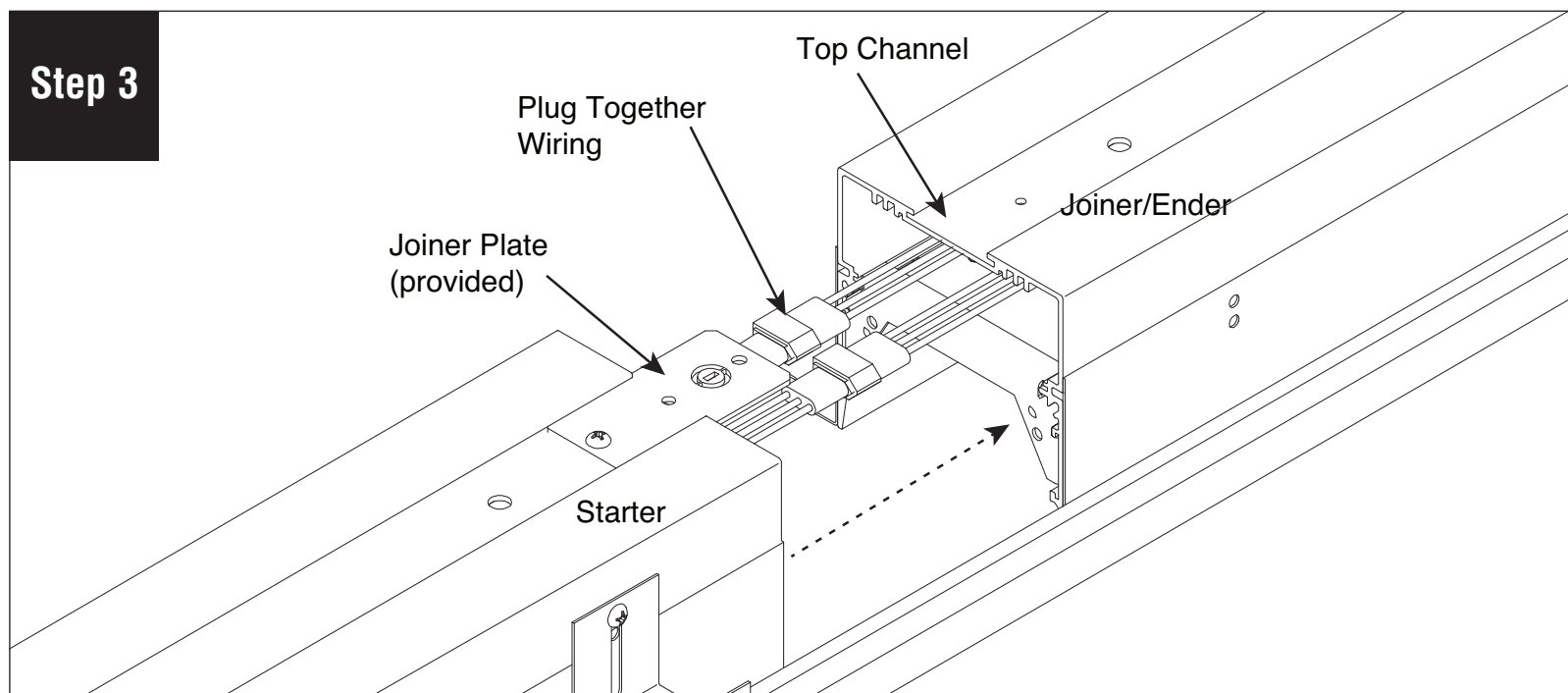

Connect Plug Together Wiring and align Joiner with Joiner Plate. Carefully slide Starter and Joiner together.

Step 4

IMPORTANT STEP

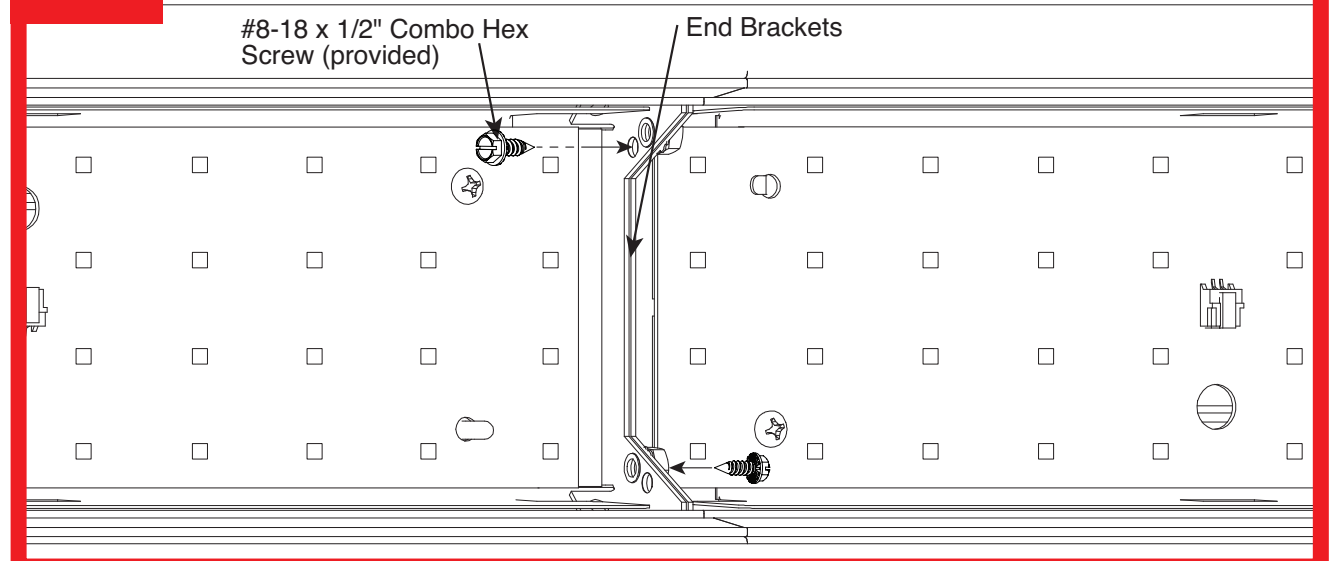

Install 2 #8-18 x 1/2" combo hex screws (provided) into end bracket as shown. Screws can be installed from the left or right.

FINELITE

HP-4 Recessed with Regressed Lens Tech Zone 6" Joiner Installation Instructions

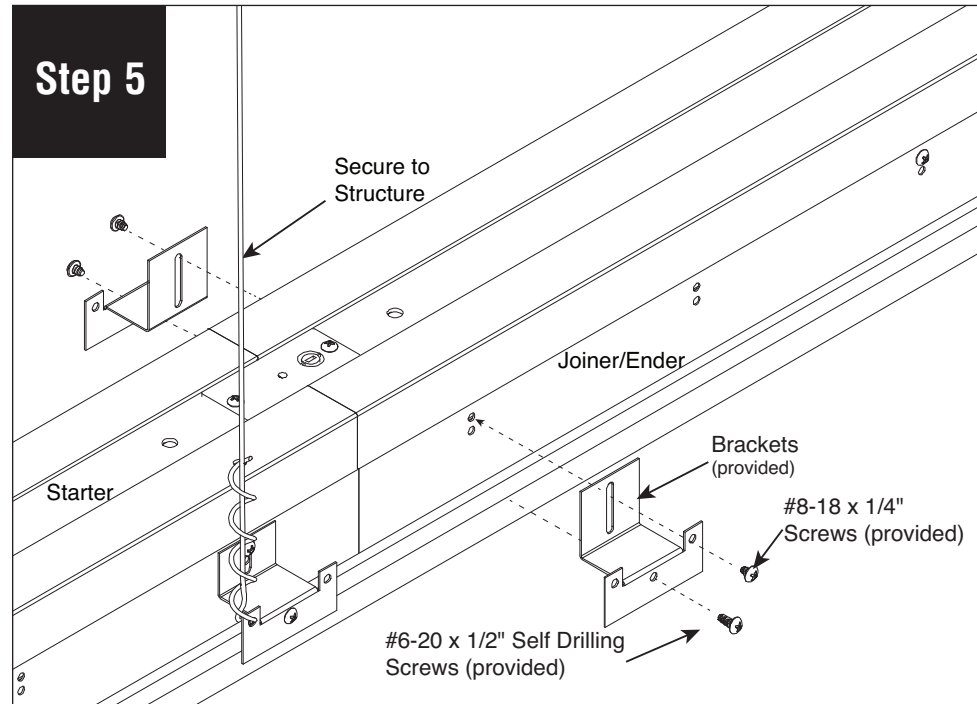

Secure Joiner on T-Grid using provided brackets and screws. Secure fixture to building structure, as per code.

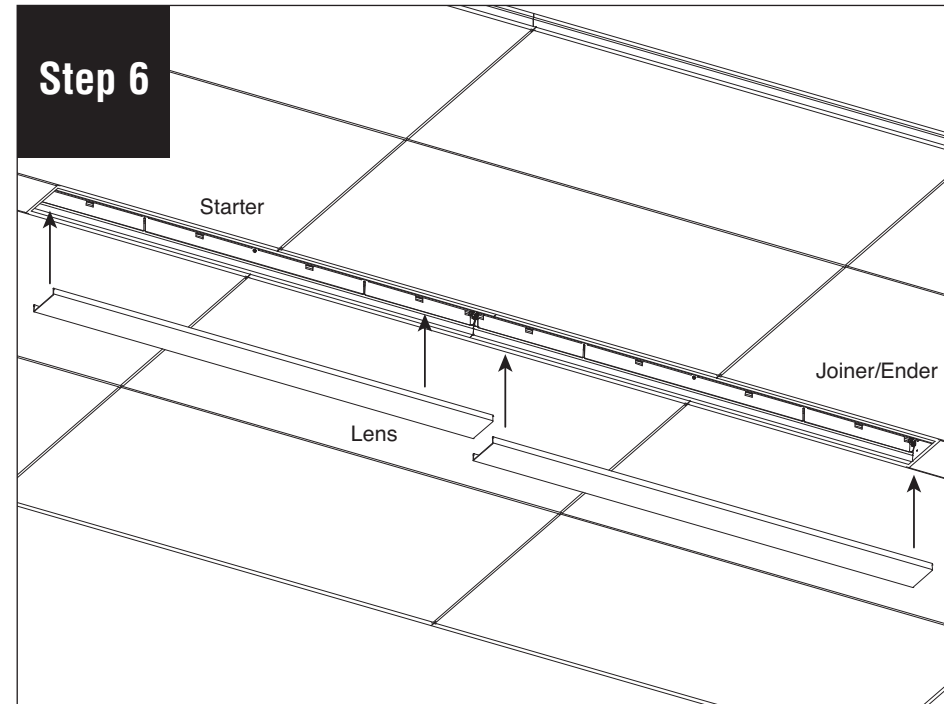

Reinstall lens and turn power on to fixture.