

Deadbolt Locksets

Standard — A

Latchbolt operates by knob or lever from either side. Deadbolt activated by key outside and turnpiece inside.

Double Cylinder — AC

Latchbolt operates by knob or lever from either side. Deadbolt activated only by key from either side.

Tubular Deadbolt with Mortise Cylinder

- Available with backset of 2³/₈" or 2³/₄".
- Supplied for 2³/₈" backset and 1³/₄" door thickness unless otherwise specified.
- Fits narrow stiles of less than 4".
- For 2³/₈" backset, stile width can be as narrow as 3⁵/₈".
- For 2³/₄" backset, stile width can be as narrow as 4".
- Suitable for most pre-existing bores for cylindrical locks.
- Full 1" throw deadbolt.
- Supplied with Schlage "C" keyway as a standard. Available on special order with a variety of other keyways and key combinations.
- Deadbolt employs standard mortise cylinder for ease of re-keying and key changes.

Tubular Latch Specifications

- All dimensions are standard for most replacement installations.
- Tough, non-rusting materials used throughout. Face covers and strikes are solid brass.
- Critical interior parts are made of solid brass.
- For almost four decades these latches have been opening and closing hundreds of thousands of doors all around the world.

Specify either 2³/₈" or 2³/₄" backset.

BACKPLATE

11000/12000 PLATES STANDARD WITH 5¹/₂" CC FOR DEADBOLTS

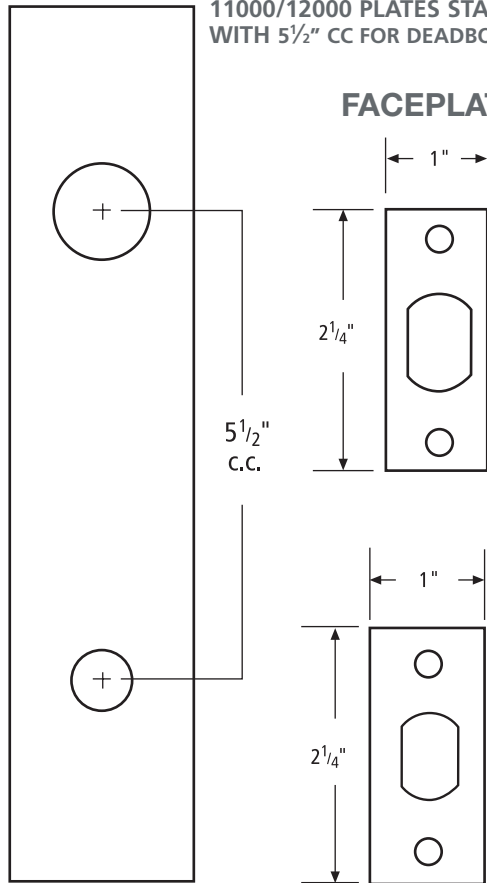

DRAWINGS NOT TO SCALE

HIGH SECURITY DEADBOLT

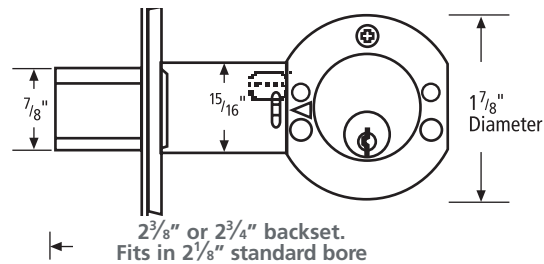

HEAVY DUTY TUBULAR LATCH

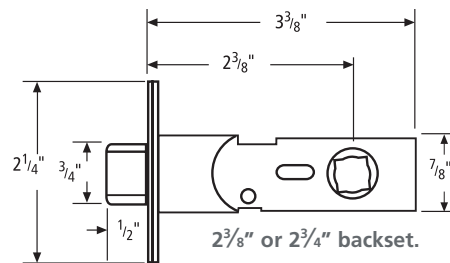

■ Auxiliary deadbolt kits (with collar) are also available. See pages 41-43. ■