

Notes:

Job:

Type:

DESIGNER SPOT

DSP7 - 7" DIAMETER

GENERAL DESCRIPTION: The Gardco DSP is an outdoor luminaire utilizing HID, compact fluorescent, or incandescent lamps – designed to produce an assortment of lighting distributions. The soft contemporary die cast housing is available in a variety of textured powdercoat finishes creating compatibility with most architecture and landscapes. The designer spotlight is suitable for mounting at grade on recessed box (provided), directly to building surfaces, or on surface j-box (by others).

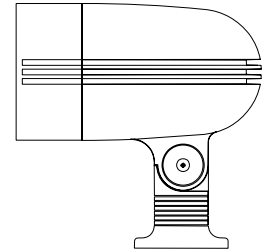

ORDERING

PREFIX	MOUNTING	DISTRIBUTION	WATTAGE	VOLTAGE	FINISH	OPTIONS
<input type="text"/>	<input type="text"/>	<input type="text"/>	<input type="text"/>	<input type="text"/>	<input type="text"/>	<input type="text"/>

Enter the order code into the appropriate box above. Note: Gardco reserves the right to refuse a configuration. Not all combinations and configurations are valid. Refer to notes below for exclusions and limitations. For questions or concerns, please consult the factory.

PREFIX

DSP7

MOUNTING

- J** J-Box Mount For mounting to surface J-Box (by others)
- U** Universal Mount
Includes shallow cast box. For mounting to surface conduit on walls, canopies, trees, etc. The universal mount also allows for mounting flush to ground and when box is installed in a poured concrete pad.
- W** Wall Mount
For mounting over a recessed box (by others) on a wall or canopy surface.
- ST** Stanchion Mount
For direct burial in concrete. Luminaire may be mounted from 2"-12" above grade.
- SPM** Side Pole Mount
- SPS** Side Pole Mount for use with Surface Conduit

DISTRIBUTION

E17-WSP

R40/PAR38

**R40/PAR38-INC
TRF-WSP**

WATTAGE

50HPS
70HPS
100HPS
50MH
70MH
100MH
70CMHE⁶

70MH
100MH
70HPS
70CMHE⁶

300R40⁵ (max)
26QF⁷
32TRF⁷
42TRF⁷

MH Metal Halide
HPS High Pressure Sodium
CMH Ceramic Metal Halide
QF Quad Tube Fluorescent
TRF Triple Tube Fluorescent

5. 120V only
6. CMHE - Ceramic MH with Electronic Ballast. Luminaire supplied with Electronic MH ballast for use with Ceramic MH Lamps ONLY. If a specific ballast brand is required, contact factory for feasibility. Not all ballast brands are compatible with this product. Available only with 120V or 277V input voltages.
7. 26QF, 32TRF and 42TRF types feature an electronic fluorescent ballast that accepts 120V through 277V, 50hz or 60hz input.

LAMP/DISTRIBUTION:

E17-WSP Wide Spot Distribution - For use with E-17 HID Lamps
R40/PAR38 For use with R40 or PAR 38 Metal Halide Lamps.
R40/PAR38-INC For use with R40 or PAR 38 Incandescent Lamps (300w maximum).
TRF-WSP Wide Spot Distribution - For use with compact fluorescent lamps.

VOLTAGE

120
277

FINISH

- BRP** Bronze Paint
- BLP** Black Paint
- WP** White Paint
- NP** Natural Aluminum Paint
- BGP** Beige Paint
- VP** Verde Green Paint
- OC** Optional Color Paint
Specify RAL designation
ex: OC-RAL7024
- SC** Special Color Paint
Specify. Must supply color chip

OPTIONS

- F** Fusing *Not available with Incandescent*
- CH** Cutoff Hood *Replaces standard door/lens holder. May be specified with Colored lenses.*

COLORED LENS OPTIONS (Replaces Clear Lens. 100w maximum)

- AB** Light Blue
- CB** Cobalt Blue
- GR** Green
- LG** Light Green
- OR** Orange
- RD** Red
- YL** Yellow
- Consult factory before specifying luminaires equipped with Electronic Metal Halide Ballasts with the Colored Lens option*

Gardco Lighting reserves the right to change materials or modify the design of its product without notification as part of the company's continuing product improvement program.

© Copyright Gardco Lighting 2001-2004. All Rights Reserved. International Copyright Secured.

A Genlyte Company

Gardco Lighting
2661 Alvarado Street
San Leandro, CA 94577

800/227-0758
510/357-6900 in California
Fax: 510/357-3088
www.sitelighting.com



79115-141/0904

DESIGNER SPOT

DSP7 - 7" DIAMETER

SPECIFICATIONS

HOUSING: Single piece aluminum housing is diecast in a semi-ellipsoidal form. One piece "O" ring gasket mates with lens assembly.

LENS ASSEMBLY: Heat and impact resistant tempered clear convex glass lens is mechanically secured to diecast lens holder. Optional cutoff hood replaces standard lens assembly and provides additional shielding to lamp and lamp images.

STEM/KNUCKLE ASSEMBLY: Rugged diecast aluminum stem and knuckle assembly provide 360° lateral and 90° vertical aiming capability and secure locking mechanism.

OPTICAL SYSTEMS: Reflectors systems for E17 and compact fluorescent lamps provide an assortment of distributions. R and PAR lamp distributions are lamp dependent. All optical systems offer sharp cutoff to aperture brightness at normal viewing angles.

ELECTRICAL: HID luminaires that utilize magnetic ballasts are high power factor. All HID ballasts are designed for reliable lamp starting to -20° F. Luminaires supplied with electronic metal halide ballasts will operate Ceramic Metal Halide lamps only. All lampholders are medium base, pulse-rated, glazed porcelain with nickel plated screw shells.

All fluorescent luminaires utilize electronic ballasts that are high power factor and designed for reliable lamp starting to 0°F.

FINISH: Each luminaire receives a fade and abrasion resistant electrostatically applied, thermally cured, (TGIC) polyester powder coat finish.

LABELS: All luminaires bear UL or CUL (where applicable) Wet Location labels.

DIMENSIONS AND MOUNTING DETAIL

DSP7

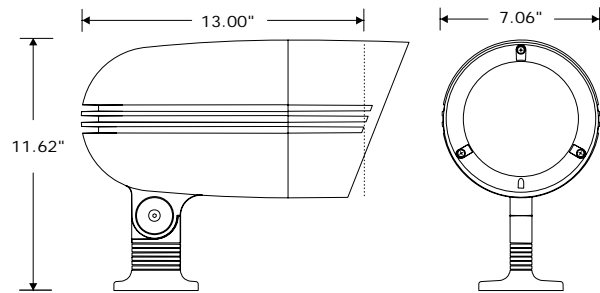

Side Pole Mount

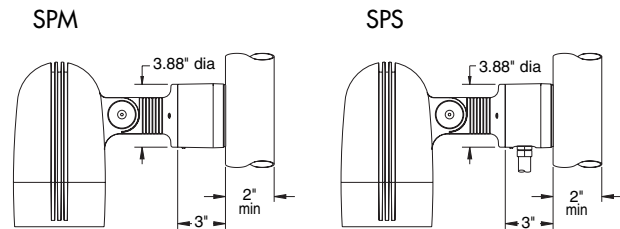

Universal Mount

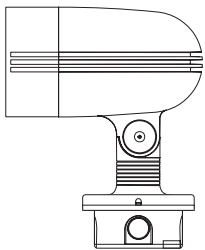

Wall Mount

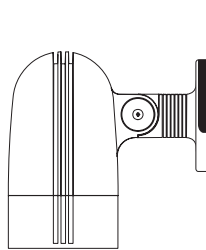

J-Box Mount

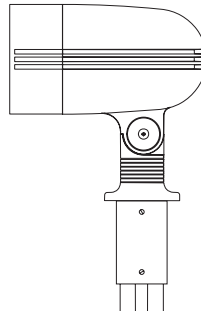

Stanchion Mount

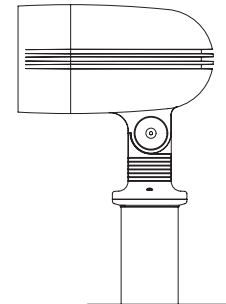

Gardco Lighting reserves the right to change materials or modify the design of its product without notification as part of the company's continuing product improvement program.

© Copyright Gardco Lighting 2001-2004. All Rights Reserved. International Copyright Secured.

A Genlyte Company

Gardco Lighting
2661 Alvarado Street
San Leandro, CA 94577

800/227-0758
510/357-6900 in California
Fax: 510/357-3088
www.sitelighting.com



79115-141/0904