

Notes:

Job:

Type:

DESIGNER CANOPY

220/221 SERIES RECESSED LUMINAIRES

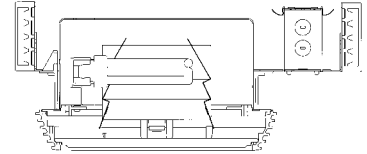

GENERAL DESCRIPTION: The Gardco Designer Canopy Luminaire is a family of downlight and wall wash ceiling mounted fixtures utilizing high intensity discharge and compact fluorescent lamps. The contemporary form housing is available in a variety of architectural finishes assuring compatibility with the building. Downlight optical systems are offered with prismatic or fresnel lenses and the wall washer is offered with a prismatic lens. The Designer Canopy Luminaire is suitable for outdoor applications and features rugged die cast construction, silicone seals and gaskets, and polyester powdercoat finishes.

ORDERING

PREFIX	DISTRIBUTION	WATTAGE	VOLTAGE	FINISH	OPTIONS
<input type="text"/>	<input type="text"/>	<input type="text"/>	<input type="text"/>	<input type="text"/>	<input type="text"/>

Enter the order code into the appropriate box above. Note: Gardco reserves the right to refuse a configuration. Not all combinations and configurations are valid. Refer to notes below for exclusions and limitations. For questions or concerns, please consult the factory.

PREFIX

220	Downlight
221	Wall Wash

DISTRIBUTION

P	Prismatic Lens
F	Fresnel Lens <i>Available with 220 units only</i>

WATTAGE

50MH	50CMHE⁴	50HPS	26QF³
70MH	70CMHE⁴	70HPS	32TRF³
100MH	100CMHE⁴	100HPS	42TRF³
150MH¹	150CMHE⁴	150HPS²	
175MH			

VOLTAGE

120	
277	
347	<i>Consult factory for 347V availability prior to ordering. Not available in Ceramic Metal Halide with Electronic Ballast (CMHE) types</i>

MH Metal Halide
 CMHE Ceramic Metal Halide
 HPS High Pressure Sodium
 QF Quad Tube Compact Fluorescent
 TRF Triple Tube Compact Fluorescent

1. ANSI #M102

2. ANSI #S55

3. 26QF, 32TRF and 42TRF types feature an electronic fluorescent ballast that accepts 120V through 277V, 50hz or 60hz input and provides for a 0° F starting temperature.

4. Ceramic Metal Halide with electronic ballast, with ballast brand selected by Gardco only, 120V or 277V only.

FINISH

BRP	Bronze Paint
BLP	Black Paint
WP	White Paint
NP	Natural Aluminum Paint
BGP	Beige Paint
OC	Optional Color Paint <i>Specify RAL designation ex: OC-RAL7024</i>
SC	Special Color Paint <i>Specify. Must supply color chip</i>

OPTIONS

F	Fusing <i>Not available w/ 347V or Ceramic Metal Halide with Electronic Ballast (CMHE) types</i>
RS	Tamper Resistant Hardware
QS	Quartz Standby <i>Limited to 100W maximum quartz lamp wattage Not available in Ceramic Metal Halide with Electronic Ballast (CMHE) types Available with 150 watt and lower only.</i>
QST	Quartz Restrike Timed Delay <i>Limited to 100W maximum quartz lamp wattage. Not available in Ceramic Metal Halide with Electronic Ballast (CMHE) types</i>

Gardco Lighting reserves the right to change materials or modify the design of its product without notification as part of the company's continuing product improvement program.

© Copyright Gardco Lighting 2001-2005. All Rights Reserved. International Copyright Secured.

A Genlyte Company

Gardco Lighting
 2661 Alvarado Street
 San Leandro, CA 94577

800/227-0758
 510/357-6900 in California
 Fax: 510/357-3088
 www.sitelighting.com



79115-92/405

DESIGNER CANOPY

220/221 SERIES RECESSED LUMINAIRES

SPECIFICATIONS

GENERAL: The Gardco Designer Canopy Luminaire utilizes compact fluorescent and high intensity discharge lamps. Housing is recessed in ceiling cavity and shallow trim assembly is surfaced mounted on canopy. Two downlight and one wall wash optical systems are available.

HOUSINGS: Housing assembly features diecast aluminum plaster flange, formed steel ballast tray, adjustable mounting brackets, and steel housing cover.

TRIMS: Diecast aluminum trim mechanically secures tempered glass lens. Hollow core, extruded silicone gaskets seal trim assembly to both housing and lens to permanently exclude insects, moisture, dust, and pollutants from luminaire.

OPTICAL SYSTEMS: Fresnel lens provides an even, symmetrical downlight distribution. Prismatic downlight lens creates an elongated lighting pattern.

Prismatic wall wash distribution provides uniform illumination on adjacent vertical surfaces. Cutout side trim on the Designer Canopy Luminaire allows light pattern on the wall to reach the ceiling line.

ELECTRICAL: HID luminaires that utilize magnetic ballasts are high power factor and designed for reliable lamp starting to -20° F. HID luminaires that utilize electronic metal halide ballasts will operate ceramic metal halide lamps only. Medium base pulse rated sockets are glazed porcelain with nickel plated screw shells.

All fluorescent luminaires utilize electronic ballasts that are high power factor and designed for reliable lamp starting to 0°F. Sockets are high temperature PBT with brass contacts.

FINISH: Each luminaire receives a fade and abrasion resistant electrostatically applied, thermally cured, (TGIC) polyester powdercoat finish.

LABELS: All luminaires have UL or CUL (where applicable) Wet Location labels.

DIMENSIONS

HID Units

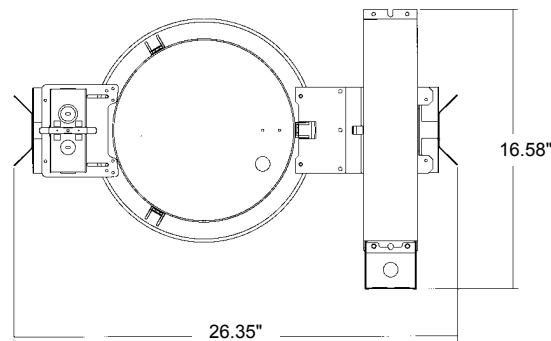
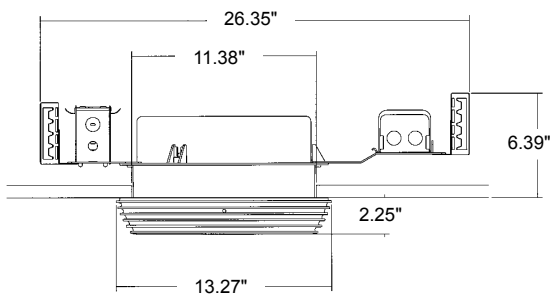

Compact Fluorescent Units

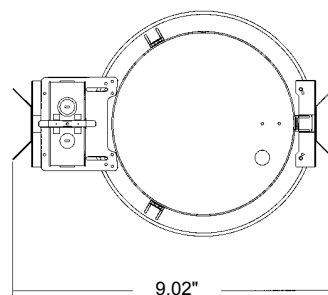
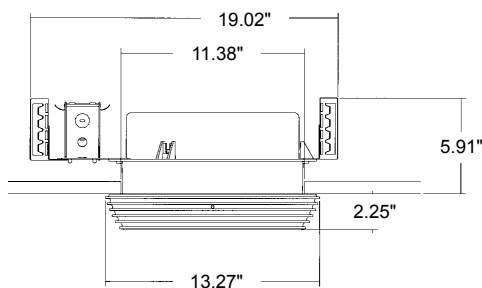

Gardco Lighting reserves the right to change materials or modify the design of its product without notification as part of the company's continuing product improvement program.

© Copyright Gardco Lighting 2001-2005. All Rights Reserved. International Copyright Secured.

A Genlyte Company

Gardco Lighting
2661 Alvarado Street
San Leandro, CA 94577

800/227-0758
510/357-6900 in California
Fax: 510/357-3088
www.sitelighting.com

