

Notes:

Job:

Type:

# DESIGNER CANOPY

## 220C/221C SERIES RECESSED CONCRETE POUR LUMINAIRES

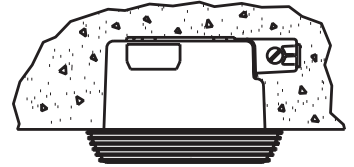

**GENERAL DESCRIPTION:** The Gardco Designer Canopy Luminaire is a family of downlight and wall wash ceiling mounted fixtures utilizing high intensity discharge and compact fluorescent lamps. The contemporary form housing is available in a variety of architectural finishes assuring compatibility with the building. Downlight optical systems are offered with prismatic or fresnel lenses and the wall washer is offered with a prismatic lens. The Designer Canopy Luminaire is suitable for outdoor applications and features rugged die cast construction, silicone seals and gaskets, and polyester powdercoat finishes.

### ORDERING

PREFIX	DISTRIBUTION	WATTAGE	VOLTAGE	FINISH	OPTIONS
<input type="text"/>	<input type="text"/>	<input type="text"/>	<input type="text"/>	<input type="text"/>	<input type="text"/>

Enter the order code into the appropriate box above. Note: Gardco reserves the right to refuse a configuration. Not all combinations and configurations are valid. Refer to notes below for exclusions and limitations. For questions or concerns, please consult the factory.

### PREFIX

**220C** Downlight Concrete Pour  
**221C** Wall Wash Concrete Pour

### DISTRIBUTION

**P** Prismatic Lens  
**F** Fresnel Lens *Available with 220 units only*

### WATTAGE

**50CMHE<sup>1</sup>**      **26QF<sup>2</sup>**  
**70CMHE<sup>1</sup>**      **32TRF<sup>2</sup>**  
**100CMHE<sup>1</sup>**      **42TRF<sup>2</sup>**  
**150CMHE<sup>1</sup>**

### VOLTAGE

**120**  
**277**

CMHE Ceramic Metal Halide  
 QF Quad Tube Compact Fluorescent  
 TRF Triple Tube Compact Fluorescent

1. Ceramic Metal Halide with electronic ballast, with ballast brand selected by Gardco only, 120V or 277V only.  
 2. 26QF, 32TRF and 42TRF types feature an electronic fluorescent ballast that accepts 120V through 277V, 50hz or 60hz input and provides for a 0° F starting temperature.

### FINISH

**BRP** Bronze Paint  
**BLP** Black Paint  
**WP** White Paint  
**NP** Natural Aluminum Paint  
**BGP** Beige Paint  
**OC** Optional Color Paint  
*Specify RAL designation  
 ex: OC-RAL7024*  
**SC** Special Color Paint  
*Specify. Must supply color chip*

### OPTIONS

**RS** Tamper Resistant Hardware

Gardco Lighting reserves the right to change materials or modify the design of its product without notification as part of the company's continuing product improvement program.

© Copyright Gardco Lighting 2001-2004. All Rights Reserved. International Copyright Secured.

A Genlyte Company

**Gardco Lighting**  
 2661 Alvarado Street  
 San Leandro, CA 94577

800/227-0758  
 510/357-6900 in California  
 Fax: 510/357-3088  
[www.sitelighting.com](http://www.sitelighting.com)



79115-144/0105

# DESIGNER CANOPY

## 220C/221C SERIES RECESSED CONCRETE POUR LUMINAIRES

### SPECIFICATIONS

**GENERAL:** The Gardco Designer Canopy Luminaire utilizes compact fluorescent and high intensity discharge lamps. Housing is recessed in a concrete cavity and the shallow trim assembly is surfaced mounted to the concrete. Two downlight and one wall wash optical systems are available.

**HOUSINGS:** Housing assembly features diecast aluminum plaster flange, formed steel ballast tray, adjustable mounting brackets, and steel housing cover.

**TRIMS:** Diecast aluminum trim mechanically secures tempered glass lens. Hollow core, extruded silicone gaskets seal trim assembly to both housing and lens to permanently exclude insects, moisture, dust, and pollutants from luminaire.

**OPTICAL SYSTEMS:** Fresnel lens provides an even, symmetrical downlight distribution. Prismatic downlight lens creates an elongated lighting pattern.

Prismatic wall wash distribution provides uniform illumination on adjacent vertical surfaces. Cutout side trim on the Designer Canopy Luminaire allows light pattern on the wall to reach the ceiling line.

**ELECTRICAL:** All HID luminaires utilize electronic metal halide ballasts that are high power factor and will operate ceramic metal halide lamps only. Ballasts are designed for reliable lamp starting to -20° F. Medium base pulse rated sockets are glazed porcelain with nickel plated screw shells.

All fluorescent luminaires utilize electronic ballasts that are high power factor and designed for reliable lamp starting to 0°F. Sockets are high temperature PBT with brass contacts.

**FINISH:** Each luminaire receives a fade and abrasion resistant electrostatically applied, thermally cured, (TGIC) polyester powdercoat finish.

**LABELS:** All luminaires have UL or CUL (where applicable) Wet Location labels.

### DIMENSIONS

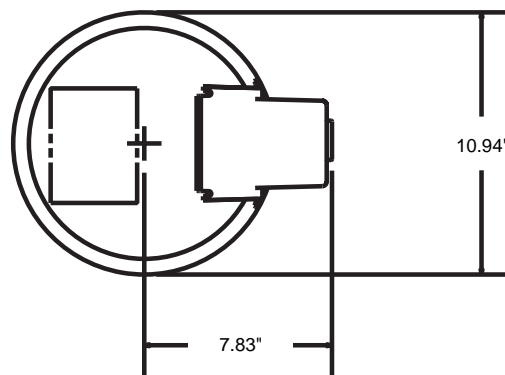
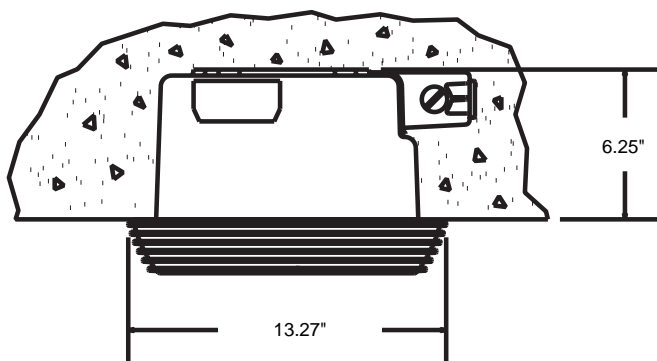

Gardco Lighting reserves the right to change materials or modify the design of its product without notification as part of the company's continuing product improvement program.

© Copyright Gardco Lighting 2001-2004. All Rights Reserved. International Copyright Secured.

A Genlyte Company

**Gardco Lighting**  
2661 Alvarado Street  
San Leandro, CA 94577

800/227-0758  
510/357-6900 in California  
Fax: 510/357-3088  
[www.sitelighting.com](http://www.sitelighting.com)



79115-144/0105