

ECOSCAPE I

Ecoscape 1

With LED Prism module or high performance LED module, thermal monitoring device protection class I, IP65 windage area AW 0.36 ft2 die cast aluminium housing, polyester powder coated, all exterior steel parts are stainless steel, tempered, high transmission safety glass, silicon gasket, hinged frame, installation of luminaire using fixing accessories, cable entry: M20, fixing via a 1.65" diameter borehole, integral driver

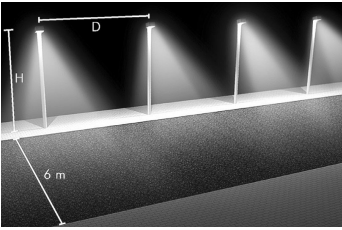

Illumination examples (S3 according to DIN EN 13201-2)

	Ecoscape 1	
	Comfort Optic	Street Optic
H	19.7'	19.7'
D	78.7'	98.4'
D/H	4	5
FC Avg	0.7 fc	0.7 fc
FC Min/FC Avg	0.36	0.32
TI*	7%	12%

* TI: Threshold Increment (unit for measuring glare).
A low TI value indicates a low glare factor.

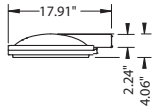
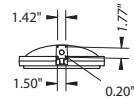
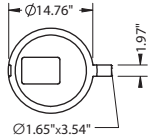

Ecoscape 1, Comfort Optic

Part number	Color	Light source	Weight	Main beam angle γ	
				C 0 – 180	C 90 – 270
M8 292 046 109	black	1 x LED Prism module 55 W	14.3 lbs	48°	54°
M8 292 066 109	white	warm white (3000 K)			
M8 292 056 109	silver grey				

Part number	Color	Light source	Weight	Main beam angle γ	
				C 0 – 180	C 90 – 270
M8 292 045 109	black	1 x LED Prism module 55 W	14.3 lbs	48°	54°
M8 292 065 109	white	neutral white (4000 K)			
M8 292 055 109	silver grey				

Ecoscape 1, Street Optic (according to DIN EN 13201)

Part number	Color	Light source	Weight	Main beam angle γ	
				C 0 – 180	C 90 – 270
M8 294 046 109	black	1 x LED module (Osram) 32 W	14.3 lbs	56°	47°
M8 294 066 109	white	warm white (3000 K)			
M8 294 056 109	silver grey				

Part number	Color	Light source	Weight	Main beam angle γ	
				C 0 – 180	C 90 – 270
M8 294 045 109	black	1 x LED module (Osram) 32 W	14.3 lbs	56°	47°
M8 294 065 109	white	neutral white (4000 K)			
M8 294 055 109	silver grey				

Accessories required for installation of luminaires – see below.

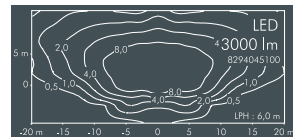
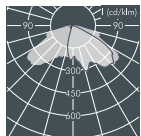
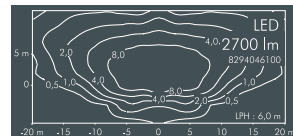
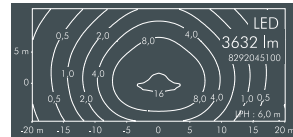
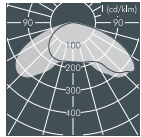
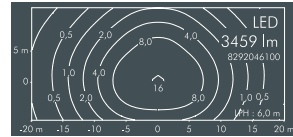

Job Name:

Fixture Type:



Rated IP65



sales@designplan.com
www.designplan.com

Tel: 908-996-7710
Fax: 908-996-7042

79 Trenton Ave
Frenchtown, NJ 08825

ACCESSORIES

Pole top fitter for one luminaire

Part number	Color	Description
122 0 281 940	black	Pole top fitter - aluminum, polyester powder coated, for pole \varnothing 2.36" - 2.99"
122 0 281 960	white	
122 0 281 950	silver grey	

Creates a 2° angle above the horizontal.

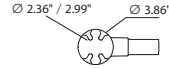
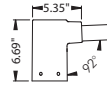

Pole top fitter for two luminaires

Part number	Color	Description
122 0 282 940	black	Pole top fitter , aluminum, polyester powder coated, for pole \varnothing 2.36" - 2.99"
122 0 282 960	white	
122 0 282 950	silver grey	

Creates a 2° angle above the horizontal.

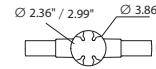
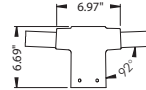

Pole adapter

Part number	Color	Description
122 0 283 940	black	Pole adapter , aluminum, polyester powder coated, for poles \varnothing 2.36" - 2.99"
122 0 283 960	white	
122 0 283 950	silver grey	

Creates a 2° angle above the horizontal.

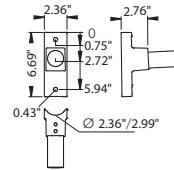
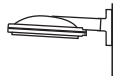

Wall adapter

Part number	Color	Description
122 0 284 940	black	Wall adapter , aluminum, polyester powder coated
122 0 284 960	white	
122 0 284 950	silver grey	

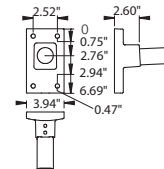
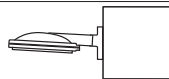

Job Name:

Fixture Type:



Rated IP65

designplan 

sales@designplan.com
www.designplan.com

Tel: 908-996-7710
Fax: 908-996-7042

© Copyright 2015 Designplan Lighting Inc.

79 Trenton Ave
Frenchtown, NJ 08825

ACCESSORIES

Pole outrigger for one luminaire

Part number	Color	Description
122 0 291 940	black	Pole outrigger, 35.83", aluminum, polyester powder coated, for pole Ø 2.36"
122 0 291 960	white	
122 0 291 950	silver grey	
122 0 293 940	black	Pole outrigger, 35.83", aluminum, polyester powder coated, for pole Ø 2.99"
122 0 293 960	white	
122 0 293 950	silver grey	

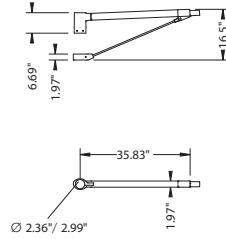

Creates a 2° angle above the horizontal.

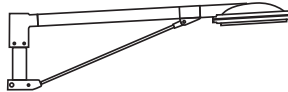

Pole outrigger for two luminaires

Part number	Color	Description
122 0 292 940	black	Pole outrigger, 2 x 35.83", aluminum, polyester powder coated, for pole Ø 2.36"
122 0 292 960	white	
122 0 292 950	silver grey	
122 0 294 940	black	Pole outrigger, 2 x 35.83", aluminum, polyester powder coated, for pole Ø 2.99"
122 0 294 960	white	
122 0 294 950	silver grey	

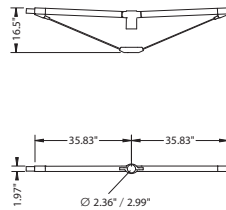

Creates a 2° angle above the horizontal.

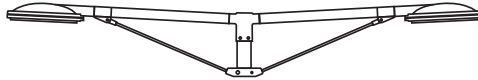

Wall outrigger

Part number	Color	Description
122 0 285 940	black	Wall outrigger, 34.84", aluminum, polyester powder coated
122 0 285 960	white	
122 0 285 950	silver grey	

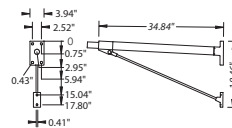

Creates a 2° angle above the horizontal.

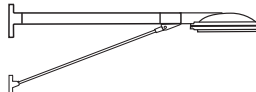

Job Name:

Fixture Type:



Rated IP65

designplan 

sales@designplan.com
www.designplan.com

© Copyright 2015 Designplan Lighting Inc.

79 Trenton Ave
Frenchtown, NJ 08825

Tel: 908-996-7710
Fax: 908-996-7042