

DESCRIPTION

The Corelite Z3 recessed luminaire meets the demands of the new energy culture with superior lighting and energy performance. Its engineered optical system delivers luminaire efficiencies greater than 85% while maintaining a soft luminous glow for high visual comfort. Its unique light distribution fills the volume of space to ensure that vertical surfaces glow to create the perception of spaciousness. To further realize the design potential of the Z3 series, it is available with a complete palette of shielding options, and lamp options, including T5, T8, LED and compact fluorescent, and maintains the series dedication to shallow plenum applications with a minimal 3-3/4 inch deep housing.

SPECIFICATION FEATURES

A ... Construction

Low profile housing die-formed 20 gauge cold rolled steel with integral 20 gauge gear tray.

B ... Reflectors

Precision tooled, high reflectance sheet metal, which allows for easy access to ballast compartment.

C ... Shielding

Center shielding consists of UV-stable co-extruded external acrylic lens with internal high light transmission Nano-Prismatic inlay material. The Nano-Prismatic film mitigates lamp image brightness with organized microscopic acrylic particles. Lens is secured to housing via injection molded inserts for easy lamp access.

D ... Electrical

T8 fixtures use UL listed Class P, 265ma T8 instant start universal voltage electronic ballasts. Power factor of 95% with less than 10% THD. Fixtures and electrical components certified to UL and CUL standards.

E ... Finish

Fixture housings are standard white using electrostatically applied polyester powder coat paint.

Mounting

Standard flange design works with most lay-in ceiling types. Integral pryout tabs secure luminaire to ceiling grid from above. Fixture offers tie-in locations for tie-wire on all corners, consult local code for appropriate tie-wire recommendations. Cannot mount more than four (4) fixtures continuously in one direction, or eight (8) fixtures total.

NOTE: Concealed Ceiling

Class R may be installed into inaccessible ceilings (sheet rock, wood panel, etc.). This is achieved with the Metalux DFW series drywall frame-in kit, ordered separately from Metalux. Specify "CC" for the Corelite Ceiling Type. Specify the following part numbers separately, from Metalux: For 1x4, order Metalux part # DF-14W-U



CLASS Z3 Nano Prism Lens

1T8

1'x4' Recessed
3-3/4" Depth

Alternate Dimensions - 1x4

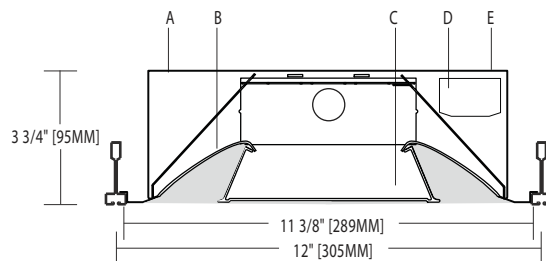
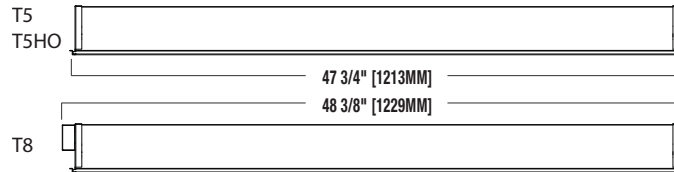

ORDERING INFORMATION

Sample Number: Z3-WN-1T8-1C-UNV-14-T1

| | | | | | | |
|-------------------------------|--|---|--|---|--|--|
| Series Z3: Class Z3 | Shielding N: Nano Prism Lens | Lamp Type T8: T8 Normal Output | Wiring 1 B: Battery Pack C: Standard Circuit D: Dimming / Step Dimming E: Emergency T: Nightlight Y: Daylight | Voltage 1 120: 120V 277: 277V 347: 347V UNV: Universal (120V-277V) | Ceiling Type T1: 1" Grid, Slot-Grid, 9/16" Tegular T9: 9/16" Grid CC: Concealed Ceiling SU: Surface Mount | Options 1 AR: Air Return CP: Chicago Plenum SD: Step Dimming WG: 6' Whip Flex W12: 12' Whip Flex |
| Reflector W: White | Number of Lamps 1: 1 Lamp | Number of Circuits 1: 1 Circuit | | Size 14: 1' x 4' | | |

Notes: 1 Not all options available. Please consult your Cooper Lighting Representative for availability.