

SLOAN®

FLUSHOMETERS

DV-32-AA I.I. — Rev. 1 (01/01)
Code No. 0816159

INSTALLATION INSTRUCTIONS DV-32-AA BEDPAN WASHER SPRAY ARM REPAIR KIT

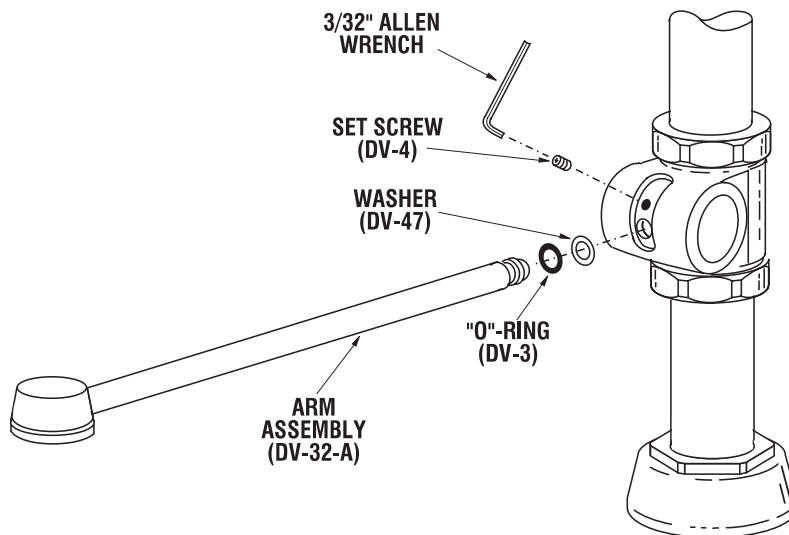

INSTALLATION INSTRUCTIONS

1. Remove old Spray Arm by removing Set Screw from Diverter Body (use 3/32" Allen Wrench). **Discard old set screw.**
2. Insert Flat Washer (DV-47) into Diverter Body.
3. Insert "O" Ring (DV-3) into Diverter Body.
4. Insert new Arm Assembly (DV-32-A) into Diverter Body.
5. Insert new Set Screw (DV-4) into Diverter Body and tighten securely.

NOTE: This DV-32-AA Spray Arm Repair Kit has been designed to retrofit into any Sloan Diverter Assembly presently in the field.

The information contained in this document is subject to change without notice.