



GSA prices effective November 5, 2012
(based on September 4, 2012, commercial price list)
Published November 2014

Systems Furniture

Ethospace® System with Quadrant®, Meridian®, and Tu®
Pedestals 10-Day or Less

General Services Administration Federal Supply Service Authorized Federal Supply Schedule Price List

Online access to contract ordering information, terms and conditions, up-to-date pricing, and the option to create an electronic delivery order is available through GSA Advantage!, a menu-driven database system. The Internet address for GSA Advantage! is www.gsaadvantage.gov.

Office Furniture
FSC Group 71, Part 1
Contract Number: GS-28F-8049H
Contract Period: December 27, 2013, through April 23, 2018

Herman Miller, Inc.
855 East Main Avenue
Zeeland, Michigan 49464
(616) 654 3000 Phone
(616) 654 8278 Fax
www.HermanMiller.com/government

Business Size: Large

Contract Information

1a. Special Item Numbers (SIN)

SIN 711-1
Furniture Systems

SIN 711-2
Computer Furniture

SIN 711-3
Filing and Storage Cabinets

SIN 711-11
Tables and Accessories

SIN 711-16
Upholstered Seating

SIN 711-18
Multi-Purpose Seating

SIN 711-91
Project Management
Services may only be used in conjunction with the purchase of new furniture.

SIN 711-93
Reconfiguration Services
Reconfiguration Services shall be negotiated on a project-by-project basis by the ordering agency. This SIN may only be used with the purchase of new product under SIN 711-11.

SIN 711-94
Design/Layout
Design service will be provided by Herman Miller, Inc., or its participating dealer based on a fee not to exceed \$65 per hour.

SIN 711-95
Installation Services
Installation shall be negotiated on a project-by-project basis by the ordering agency.

SIN 711-96
Leasing
Contact Herman Miller participating government dealer for current leasing information.

SIN 711-99
New Product Introductions

1b. Lowest Priced Model

SIN 711-1:	Y7149.	\$12
SIN 711-2:	73-1567-D	\$14
SIN 711-3:	9M10018	\$13
SIN 711-11:	EZ7100.	\$27
SIN 711-16:	OA401	\$36
SIN 711-18:	WC410N	\$220
SIN 711-99:	NT111.	\$13

1c. Not applicable

2. Maximum Order

SIN 711-1, SIN 711-2
\$500,000 net product value

SIN 711-3, SIN 711-11
\$300,000 net product value

SIN 711-16, SIN 711-18
\$200,000 net product value

SIN 711-93
\$500,000

SIN 711-94
\$500,000

SIN 711-95
\$500

SIN 711-96
\$500,000

SIN 711-99
\$50,000 net product value

3. Minimum Order

\$100 net

4. Geographic Coverage

Continental U.S. Orders for Alaska, Hawaii, and Puerto Rico will be shipped F.O.B. inland carrier point of exportation.

5. Point of Production

Zeeland, Ottawa County, Michigan
Spring Lake, Ottawa County, Michigan

Contract Information

continued

6. Pricing

Prices shown are list. Discounts include Industrial Funding Fee.

SIN 711-1

Product: Selected Action Office 1, Action Office 2, Energy Manager, Ethospace System, Quadrant Pedestals, Supplemental Products, Tu Pedestals and Pedastools, and approved Herman Miller Options Products.

Standard Lead Time	Single Order Net Purchase	Discount From List
	\$100 - 250,000	73.8%
	\$250,001 - 500,000	76.8%

SIN 711-1

Product: Selected Canvas Office Landscape and approved Herman Miller Options Products

Standard Lead Time	Single Order Net Purchase	Discount From List
	\$100 - 250,000	72.8%
	\$250,001 - 500,000	74.8%

SIN 711-1

Product: Selected Meridian Pedestals, Meridian Pedastools, and approved Herman Miller Options Products

Standard Lead Time	Single Order Net Purchase	Discount From List
	\$100 - 500,000	64.2%

SIN 711-1

Product: Thrive Portfolio

Standard Lead Time	Single Order Net Purchase	Discount From List
	\$100 - 250,000	62%
	\$250,001 - 500,000	66.4%

SIN 711-2

Product: Passage Desking System and approved Herman Miller Options Products

Standard Lead Time	Single Order Net Purchase	Discount From List
	\$100 - 500,000	56.7%

SIN 711-2

Product: 5000 Series Furniture and approved Herman Miller Options Products

Standard Discount From List	Lead Time	Single Order Net Purchase
	\$100 - 500,000	58.7%

SIN 711-3

Product: Meridian Laterals, Verticals, and Storage products and approved Herman Miller Options Products

Standard Lead Time	Single Order Net Purchase	Discount From List Laterals	Verticals	Storage
	\$100 - 300,000	67.3%	66.3%	62.7%

SIN 711-3

Product: Tu Lateral Files, Tu Storage Cases, Tu Storage Towers and approved Herman Miller Options Products

Standard Lead Time	Single Order Net Purchase	Discount From List
	\$100 - 300,000	74.3%

SIN 711-11

Product: Selected Tables and Accessories and approved Herman Miller Options Products

Standard Lead Time	Single Order Net Purchase	Discount From List
Avive®	\$100 - 250,000	72.8%
	\$250,001 - 500,000	74.8%
Eames®	\$100 - 250,000	73.6%
	\$250,001 - 300,000	77.6%
Everywhere™	\$100 - 300,000	72.8%
Sense™	\$100 - 300,000	66.75%

SIN 711-16

Product: Swoop upholstered seating products and approved Herman Miller Options Products

Standard Lead Time	Single Order Net Purchase	Discount From List
Swoop™	\$100 - 200,000	60.7%

SIN 711-18

Product: Selected Seating and approved Herman Miller Options Products

Standard Lead Time	Single Order Net Purchase	Discount From List
Aeron®	\$100 - 200,000	64.5%
Ambi®	\$100 - 200,000	62.5%
Aside®	\$100 - 200,000	64.2%
Caper®	\$100 - 200,000	61.5%
Celle®	\$100 - 200,000	59.7%
Embody®	\$100 - 200,000	59.7%
Equa 2®	\$100 - 200,000	65.8%
Ergon 3®	\$100 - 200,000	68.8%
Mirra®	\$100 - 200,000	62.2%
Mirra® 2	\$100 - 200,000	59.7%
Setu®	\$100 - 200,000	59.7%
SAYL®	\$100 - 200,000	62.2%

Contract Information

continued

SIN 711-99

Product: Selected Resolve System, My Studio Environments, and approved Herman Miller Options Products

Standard Lead Time	Single Order Net Purchase	Discount From List
My Studio Environments	\$100 - 50,000	57.7%
Resolve System	\$100 - 50,000	69.8%

7. Quantity Discounts

Reference item #6.

8. Payment Term

Net 30 days

9. Government Commercial Credit Card

- Government commercial credit cards are accepted below the micropurchase threshold.
- Government commercial credit cards are accepted above the micropurchase threshold.

10. Foreign Items

None

11. Time of Delivery

- 90 day ARO
- Expedited delivery: Items listed in the 10-Day section of the catalogs are available for expedited delivery.
- Overnight/2-day delivery: Select items may be available for overnight or 2-day delivery. Contact Herman Miller or a participating dealer for availability and rates.
- Urgent requirements: Agencies may contact contractor or participating dealer to request faster delivery.

12. F.O.B.

F.O.B. destination except Alaska, Hawaii, and Puerto Rico, which will be shipped F.O.B. inland carrier point of exportation.

13. Ordering Address

- Herman Miller, Inc.,
Government Customer Care 0161
855 East Main Avenue
Zeeland MI 49464.
- For supplies and services, the ordering procedures information on Blanket Purchase Agreements (BPA 's) and a sample BPA can be found at the GSA/FSS Schedule homepage (www.fss.gsa.gov/schedules).

14. Payment Address.

Herman Miller, Inc.
22764 Network Place
Chicago, IL 60673-1227

15. Warranty

Herman Miller, Inc., commercial warranty applies.

16. Export Packing Charge

Prices supplied on request.

17. Terms and Conditions of Government Purchase Card Acceptance

(any thresholds above the micropurchase level)
None.

18. Rental Maintenance and Repair Terms

Not applicable

19. Terms and Conditions of Installation

Installation services shall be negotiated on a project-by-project basis by the ordering agency.

20. Terms and Conditions of Repair Parts

Not applicable

21. Service and Distribution Points

For service and distribution points nearest you, call (800) 851 1196.

22. Participating Dealers

Access Herman Miller web site for current list of participating dealers: www.HermanMiller.com/government.

23. Preventive Maintenance

Not applicable

24a. Special Attributes.

2012

Survey Recognizes Herman Miller Top Furniture Brand in Seating, Systems, Healthcare, and Environmental Sustainability

Architectural and design professionals participating in *Contract* magazine's 2011 Brand Report Awareness Survey have once again named Herman Miller and its subsidiaries as their preferred source for key furnishings in the workplace and healthcare environments.

Contract Information

continued

2011

Herman Miller Honored for Sustainable Performance and Community Commitment

Herman Miller, Inc. has once again been recognized as a leader in corporate sustainability and community involvement by both The Dow Jones Sustainability World Index (DJSI World), and the state of Michigan's Neighborhood Environmental Partners Program (NEP). This marks the eighth consecutive year Herman Miller has been placed on the DJSI World and the third straight year earning an NEP award.

Herman Miller Recognized as Industry Leader on Climate Counts 2011-2012 Scorecard Report

Herman Miller, Inc. has been named one of 16 Section Leaders on Climate Counts 2011-2012 Scorecard Report, making them the industry leader for Home and Office Furnishings. The scorecard measures how well the largest companies across 16 industry sectors are preparing for a low-carbon future. Companies are scored based on 22 criteria including a company's efforts to assess their climate footprint, reduce greenhouse gas emissions, and the ability to communicate their efforts to consumers.

2010

Herman Miller achieves LEED-CI Platinum certification from the U.S. Green Building Council for its recently completed Los Angeles Showroom.

2009

Herman Miller named Green Champion by *Business Review West Michigan*.

Herman Miller awarded the 2009 Recycling by Design award by the Institute of Scrap Recycling Industries, Inc.

Aeron receives MBDC Silver Cradle to Cradle certification.

Herman Miller's local fleet is recognized as a U.S. EPA SmartWay Transport Partnership Certified Carrier.

Herman Miller achieves LEED-CI Gold certification for its Main Site B West renovation.

2008

Herman Miller recognized by *Occupational Hazards* magazine as one of America's Safest Companies (ASC). It was one of 18 companies to achieve this distinction.

Herman Miller's Zeeland Main Site awarded status as a STAR participant in the Michigan Voluntary Protection Program (MVPP). The MVPP Star Award is the most prestigious safety and health award given in Michigan. Zeeland Main Site is the fourth Herman Miller facility to receive MVPP status, along with the Greenhouse (in 2005), Midwest Distribution Center (in 2007), and 171st Avenue facility (in 2006).

Teneo, Tu, and Meridian filing and storage product lines receive McDonough Braungart Design Chemistry (MBDC) Silver Cradle to Cradle certification.

2004-2009

Herman Miller achieves sixth consecutive placement on the Dow Jones Sustainability World Index, an international stock portfolio that evaluates the annual performance of the world's largest 2500 companies using economic, environmental, and social criteria, known as the "triple bottom line" of sustainability.

2007

Herman Miller earns the 2007 Waste Wise Gold Achievement Award for Smart Packaging. The U.S. Environmental Protection Agency (EPA) recognizes Herman Miller for its ongoing commitment to reduce transport packaging.

Herman Miller's IT North building in its Main Site facility earns LEED-CI Silver certification from the U.S. Green Building Council (USGBC).

My Studio Environments receive McDonough Braungart Design Chemistry (MBDC) Silver Cradle to Cradle certification.

Herman Miller, Inc., chosen for Sustainable Business 20 List. The company is featured for the fifth time as one of the "World's Top Sustainability Stocks," which includes companies with strong environmental initiatives and solid financial performance.

Herman Miller earns LEED-CI Gold Certification from the U.S. Green Building Council (USGBC) for its National Design Center in Atlanta, Georgia.

2006

Business Ethics ranks Herman Miller, Inc. among the "100 Best Corporate Citizens" in America.

Herman Miller earns LEED-CI Gold Certification from the U.S. Green Building Council (USGBC) for its National Design Center in New York City, New York. This is the first LEED-CI Gold rating to be awarded in New York City.

Herman Miller honored by the U.S. Environmental Protection Agency (EPA) with its WasteWise Award for its commitment to build or renovate its facilities--leased or owned--to meet at least a LEED (Leadership in Energy and Environmental Design) Silver certification.

2005

The U.S. Environmental Protection Agency's Pacific Southwest office honors Herman Miller with its seventh annual Environmental Awards, recognizing the company's efforts to protect and preserve the environment during 2004.

Contract Information

continued

The U.S. Environmental Protection Agency presents Herman Miller with its WasteWise 2005 Product Stewardship Gold Achievement Award in the Design category; Honorable Mention also received in the Large Business category for its recycling efforts.

Herman Miller earns LEED Gold Certification from the U.S. Green Building Council (USGBC) for the Design Yard Front Door in Holland, Michigan.

Michigan "Clean Corporate Citizen" Award given to Herman Miller's Greenhouse manufacturing facility for its environmental management system and record for active pollution prevention.

2004

American Institute of Architects (AIA) Committee on the Environment selects Herman Miller's Building C-1 renovation as one of the AIA/COTE Top 10 Green Projects in America.

The U.S. Green Building Council (USGBC) names Herman Miller among the recipients of its Green Building Leaders Recognition Award for 2004, in the Green Building Business category.

For the third year in a row, Herman Miller is included on SustainableBusiness.com's list of the top 20 sustainable stocks among public companies worldwide.

2003

The University of Colorado, Leeds School of Business, names Herman Miller among three finalists for the first annual "Summit Awards for Social Impact," citing the company's environmental leadership.

Environmental Building News magazine's GreenSpec Product Directory names Herman Miller's Mirra chair among its Top 10 picks for best new "green" products.

2002

Program Champion recognition from the U.S. Environmental Protection Agency's WasteWise Program, for overall waste reduction achievements.

2001-2002

Herman Miller achieves placement on the Dow Jones Sustainability World Index, an international stock portfolio that evaluates the annual performance of the world's largest 2500 companies using economic, environmental, and social criteria, known as the "triple bottom line" of sustainability.

2000-2003

Business Ethics ranks Herman Miller, Inc. in the top 10 among the "100 Best Corporate Citizens" in America, and first among all ranked companies for "Service to the Environment."

1999-2001

Environmental Protection Agency's (EPA) Large Industry Partners of the Year Award for overall waste reduction achievements.

2000

Waste Reduction Award Program (WRAP) from the State of California Environmental Protection Agency Integrated Waste Management Board for improving the environment by reducing waste.

1999 and 2000

Cited in *Fortune* magazine among "America's Most Admired" companies and ranked number three overall for social responsibility.

1998

Green Award from the United States government's General Services Administration (GSA) for product design and business practices.

Champion Award from the EPA's Waste Wise Program, for overall waste reduction achievements.

24b. Section 508 Compliance

Not applicable

25. Data Universal Numbering System (DUNS): 00-601-2801

26. Registered in Central Contractor Registration (CCR) Database

27. Cancellation

Prior to production, no cancellation charge will apply. After production, only actual cost incurred that the contractor can demonstrate if items are sold after 3 months.

28. Restocking Charges

Agencies must notify the contractor for authorization prior to returning any items. The customer agency will be required to pay all packaging and return freight charges. A restocking fee of 50% for Systems Furniture and 35% for all other product lines will be charged for any returned items.

Herman Miller Miscellaneous Information:

Federal ID Number: 38-0837640

Commercial and Government Entity Code (CAGE): 40636

Data Universal Numbering System (DUNS) 00-601-2801

Commercial Entity Code (CEC): 00702290J

Introduction	page 2
Ethospace® System 10-Day or Less	3
Walls	5
Work Surfaces	45
Storage	55
Lighting	67
Work Organizers	69
Quadrant® Pedestals 10-Day or Less	71
B-Pull	73
F-Pull	75
Meridian® Pedestals 10-Day or Less	79
Tu® Pedestals 10-Day or Less	87
Pedestals	89
Pedestal Accessories	97
Indices	101
By Name	101
By Number	103
Appendices	
10-Day or Less Order Information	
10-Day Keyed-Alike Information	
Proprietary Textiles Application Chart - 10-Day Workspaces	
Proprietary Textile Colors - 10-Day Workspaces	
For the latest materials information, refer to the Materials pages on	
HermanMiller.com.	

Introduction

A Note on the Organization of This Book

There are a few signals that will help you understand the organization of this book. Once you know them, you should be able to find your way around easily.

Like a newspaper, this book is formatted with columns of text and illustrations that run vertically.

Information wraps from one column to the next and continues for as many pages as it needs to.

Black bars are clues.

A black bar at the top of a page signals the start of information about a product.

Specification Information, which always begins at the top of a column, includes a series of steps. Each step represents a decision you need to make in order to complete your product number. Steps must be followed sequentially. The number of pages needed to complete information on a product varies; some will be complete in one page; others may fill three or four pages. Just continue going through the steps until you run into the next product, signaled by the black bar at the top of the page.

Black tabs running along the outside edge of the page help you locate what section you are in or what section you want to go to. You can thumb forwards or backwards to find a section; tabs and text appear on both sides of the page.

The additional pages in the back of the book include the appendices and indices. They are signaled by a long black bar running along the outside edge of the page.

The index is presented two ways.

The first index is in alphabetical order by product name. It can be helpful if you are new to the products and numbering scheme or if you are looking for a type of product, such as work chair or round table.

The second index is by product number. It lists, in alphanumeric order, the base product number, typically a five-digit number.

General Information

This book is effective November 5, 2012, subject to change without notice. Products may be purchased from authorized Herman Miller dealers who will quote prices upon request. For more information about our products and services or to see a list of dealers, visit www.HermanMiller.com.

All prices are list prices. Additional services, such as planning services, design, storage, and installation, are not included and must be added to these prices when the additional services are requested.

Illustrations, specifications, and prices are based on the latest information at the time of publication. The right is reserved to make changes at any time without notice in prices, fabrics, finishes, materials, specifications, and models, and also to discontinue models and finishes.

For additional product information such as dimensional drawings and product descriptions, refer to the standard price books.

Service problems are normally handled by a Herman Miller authorized dealer. Where this cannot be accomplished on a local level, service problems should be referred to the Customer Care Representative for your region, Herman Miller, Inc., Zeeland, Michigan 49464.

Walls

Work Surfaces

Storage

Lighting

Work Organizers

Bare Frame

E1109.

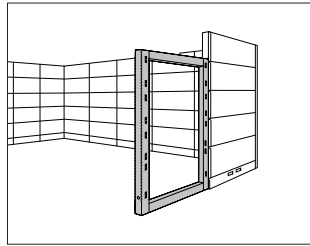

Specification Information

Step 1.

E1109.

Step 2. Height

30	30" high
38	38" high
46	46" high
54	54" high
62	62" high
70	70" high
86	86" high

Step 3. Width

24X	24" wide
30X	30" wide
36X	36" wide
42X	42" wide
48X	48" wide

Prices for Steps 1-3.

	24X	30X	36X	42X	48X
E1109. 30	\$141	149	157	171	193
38	\$163	180	186	199	206
46	\$176	193	201	205	209
54	\$195	209	223	230	246
62	\$206	220	234	243	255
70	\$225	241	249	259	276
86	\$247	265	276	286	303

Frame

E1109.

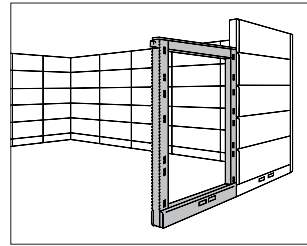

Specification Information

Step 1.

E1109.

Step 2. Height

30	30" high
38	38" high
46	46" high
54	54" high
62	62" high
70	70" high
86	86" high

Step 3. Width

24	24" wide
30	30" wide
36	36" wide
42	42" wide
48	48" wide

Step 4. Power

For 30" high (30) with 24" wide (24) or 30" wide (30)

- N** (N) nonpowered with no receptacle locations
- R** (R) nonpowered with 1 receptacle location per side (meets Chicago electrical code requirements)
- J** (J) nonpowered with 2 receptacle and 1 communication port locations per side
- G** (G) 4-circuit power with 2 receptacle and 1 communication port locations per side

For 38" high (38), 46" high (46), 54" high (54), 62" high (62), 70" high (70), or 86" high (86) with 24" wide (24) or 30" wide (30)

- N** (N) nonpowered with no receptacle locations
- R** (R) nonpowered with 1 receptacle location per side (meets Chicago electrical code requirements)
- J** (J) nonpowered with 2 receptacle and 1 communication port locations per side
- G** (G) 4-circuit power with 2 receptacle and 1 communication port locations per side

For 38" high (38), 46" high (46), 54" high (54), 62" high (62), 70" high (70), or 86" high (86) with 36" wide (36), 42" wide (42), or 48" wide (48)

N	(N) nonpowered with no receptacle locations
R	(R) nonpowered with 2 receptacle locations per side (meets Chicago electrical code requirements)
J	(J) nonpowered with 2 receptacle and 1 communication port locations per side
G	(G) 4-circuit power with 2 receptacle and 1 communication port locations per side

For 30" high (30) with 36" wide (36), 42" wide (42), or 48" wide (48)

N	(N) nonpowered with no receptacle locations
R	(R) nonpowered with 2 receptacle locations per side (meets Chicago electrical code requirements)
J	(J) nonpowered with 2 receptacle and 1 communication port locations per side
G	(G) 4-circuit power with 2 receptacle and 1 communication port locations per side

Prices for Steps 1-4.

	N	R	J	G
E1109. 30 24	\$317	327	327	477
30	\$358	367	367	516
36	\$398	406	406	555
42	\$438	446	446	598
48	\$477	484	484	636
38 24	\$344	349	350	502
30	\$384	391	391	544
36	\$423	432	432	583
42	\$464	472	472	623
48	\$502	511	511	662
46 24	\$371	379	380	530
30	\$412	419	419	571
36	\$453	459	459	611
42	\$491	499	499	650
48	\$530	538	538	690
54 24	\$397	403	404	554
30	\$437	443	443	596
36	\$477	484	484	636
42	\$516	525	525	675
48	\$554	563	563	715
62 24	\$422	430	430	582
30	\$457	468	470	621
36	\$502	511	511	662
42	\$544	550	550	700
48	\$582	589	589	739

70 24	\$450	456	456	606
30	\$488	495	495	647
36	\$528	536	536	688
42	\$568	576	576	726
48	\$606	615	615	764
86 24	\$500	509	509	660
30	\$541	548	548	698
36	\$581	587	587	738
42	\$620	627	627	778
48	\$660	666	666	817

Step 5. Top Cap Finish

NN	none	+\$0
BU	black umber	+\$14
HF	inner tone light	+\$14
LU	soft white	+\$14
MT	medium tone	+\$14
CN	metallic champagne	+\$19

Step 6. Cable Management Finish

BU	black umber	+\$0
HF	inner tone light	+\$0
HT	inner tone	+\$0
LU	soft white	+\$0
MT	medium tone	+\$0

Frame, Transaction Work Surface E1116.

Stile Covers and Top Caps, Transaction Work Surface Frame E1117.

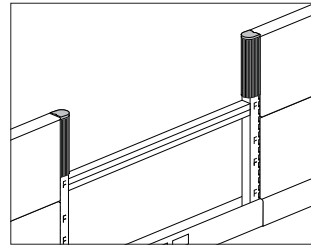
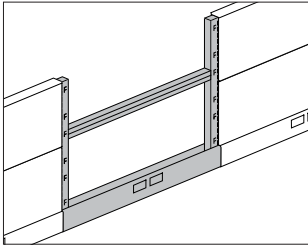

Specification Information

Step 1.

E1116.38

Step 2. Width

36	36" wide
48	48" wide
60	60" wide

Step 3. Power

- N** (N) nonpowered with no receptacle locations
- J** (J) nonpowered with 2 to 4 receptacle and 1 to 2 communication port locations per side
- G** (G) 4-circuit power with 2 to 4 receptacle and 1 to 2 communication port locations per side

Prices for Steps 1-3.

		N	J	G
E1116.38	36	\$615	623	788
	48	\$691	698	852
	60	\$1074	1081	1233

Step 4. Cable Management Finish

BU	black umber	+\$0
HF	inner tone light	+\$0
LU	soft white	+\$0
MT	medium tone	+\$0

Specification Information

Step 1.

E1117. \$92

Step 2. Finish

BU	black umber	+\$0
HF	inner tone light	+\$0
LU	soft white	+\$0
MT	medium tone	+\$0

Ethospace® Walls

Side Cover

E1263.
E1264.

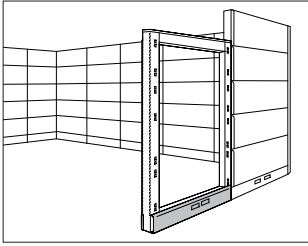

Ethospace® Walls

Specification Information

Step 1.

E126

Step 2. Base Type

- 3. plain base
- 4. grooved base

Step 3. Width

- 24** 24" wide
- 30** 30" wide
- 36** 36" wide
- 42** 42" wide
- 48** 48" wide

Step 4. Receptacle/Data Locations

For plain base (3.) with 24" wide (24) or 30" wide (30)

- N** (N) no receptacle locations
- J** (J) 2 receptacle and 1 communication port locations
- R** (R) 1 receptacle location (meets Chicago electrical code requirements)

For plain base (3.) with 36" wide (36), 42" wide (42), or 48" wide (48)

- N** (N) no receptacle locations
- J** (J) 2 receptacle and 1 communication port locations
- R** (R) 2 receptacle locations (meets Chicago electrical code requirements)

For grooved base (4.) with 24" wide (24) or 30" wide (30)

- N** (N) no receptacle locations
- R** (R) 1 receptacle location (meets Chicago electrical code requirements)

For grooved base (4.) with 36" wide (36), 42" wide (42), or 48" wide (48)

- N** (N) no receptacle locations
- R** (R) 2 receptacle locations (meets Chicago electrical code requirements)

Prices for Steps 1-4.

	N	J	R
E1263. 24	\$52	56	64
30	\$56	61	81
36	\$63	67	86
42	\$70	77	91
48	\$76	82	102

E1264. 24	\$52	—	64
30	\$56	—	81
36	\$63	—	86
42	\$70	—	91
48	\$76	—	102

Step 5. Surface Finish

For plain base (3.)

BU black umber	+\$0
HF inner tone light	+\$0
HT inner tone	+\$0
LU soft white	+\$0
MT medium tone	+\$0

For grooved base (4.)

BU black umber	+\$0
HF inner tone light	+\$0
LU soft white	+\$0
MT medium tone	+\$0

Stacking Frame

E1112.

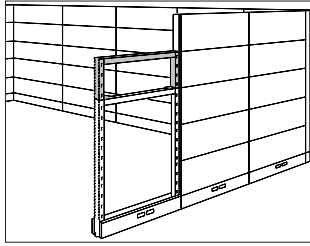

Specification Information

Step 1.

E1112.

Step 2. Width

24	24" wide
30	30" wide
36	36" wide
42	42" wide
48	48" wide

Prices for Steps 1-2.

E1112. 24	\$212
30	\$224
36	\$232
42	\$241
48	\$249

Draw Rod

E1120.

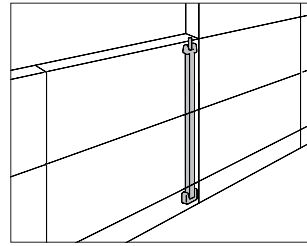

Specification Information

Step 1.

E1120.

Step 2. Height

30	30" high
38	38" high
46	46" high
54	54" high
62	62" high
70	70" high
86	86" high

Prices for Steps 1-2.

E1120. 30	\$23
38	\$23
46	\$24
54	\$24
62	\$28
70	\$29
86	\$30

Ethospace® Walls

Wall Strip

E1130.

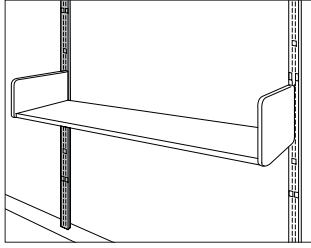

Wall Fastener

X1192.

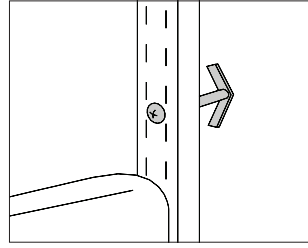

Ethospace® Walls

Specification Information

Step 1.

E1130.

Step 2. Height

64N 64" high

80N 80" high

Prices for Steps 1-2.

E1130. 64N	\$64
80N	\$68

Specification Information

Step 1.

X1192.

Step 2. Size

1 no. 10, 1½" sheet metal screw

2 no. 10, 3" sheet metal screw

3 no. 10, 3" machine screw

Prices for Steps 1-2.

X1192. 1	\$28
2	\$28
3	\$48

Tile Adapter

E1131.

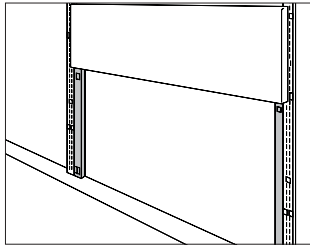

Specification Information

Step 1.

E1131.

Step 2. Height

08 8" high

16 16" high

Prices for Steps 1-2.

E1131. 08	\$27
16	\$46

Trim Strip

E1132.

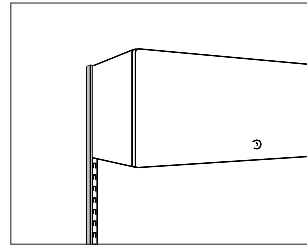

Specification Information

Step 1.

E1132.

Step 2. Height

64 64" high

80 80" high

Prices for Steps 1-2.

E1132. 64	\$69
80	\$85

Step 3. Surface Finish

BU	black umber	+\$0
HF	inner tone light	+\$0
LU	soft white	+\$0
MT	medium tone	+\$0

Wall Start

E1210.

Wall Start Filler

E1212.

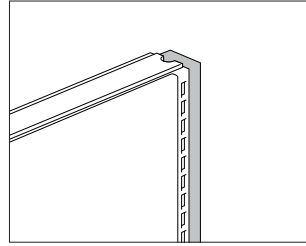
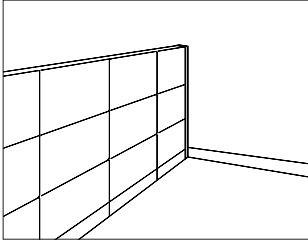

Ethospace® Walls

Specification Information

Step 1.

E1210.

Step 2. Height

- 30** 30" high
- 38** 38" high
- 46** 46" high
- 54** 54" high
- 62** 62" high
- 70** 70" high
- 86** 86" high

Prices for Steps 1-2.

E1210. 30	\$108
38	\$111
46	\$112
54	\$113
62	\$124
70	\$129
86	\$141

Step 3. Surface Finish

BU	black umber	+\$0
HF	inner tone light	+\$0
LU	soft white	+\$0
MT	medium tone	+\$0
CN	metallic champagne	+\$7

Specification Information

Step 1.

E1212.70

\$136

2-Way 90° Connector

E1220.

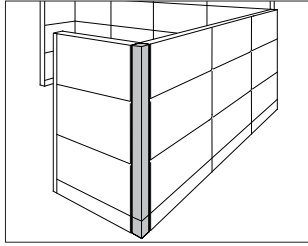

Specification Information

Step 1.

E1220.

Step 2. Height

30	30" high
38	38" high
46	46" high
54	54" high
62	62" high
70	70" high
86	86" high

Step 3. Surface Material

S	vinyl
F	fabric

Step 4. Shape

R	radius
S	square

Step 5. Power

N	(N) nonpowered
E	(E) powered

Prices for Steps 1-5.

	RN	RE	SN	SE
E1220. 30 S	\$207	246	218	254
F	\$200	234	204	241
38 S	\$227	264	236	272
F	\$210	246	223	256
46 S	\$243	280	253	288
F	\$229	264	241	276
54 S	\$259	298	272	309
F	\$244	279	255	291
62 S	\$273	312	284	319
F	\$255	291	270	306
70 S	\$284	322	299	335
F	\$266	302	279	315
86 S	\$319	359	336	371
F	\$301	336	315	349

Step 6. Surface Finish

For vinyl (S)

See application chart and textiles list for fabric usage and numbers. First 2 digits of number indicate fabric line; remaining digit(s) indicate fabric color.

Vinyl-Textured Surface

BU	black umber	+\$0
HF	inner tone light	+\$0
HT	inner tone	+\$0
LU	soft white	+\$0
MT	medium tone	+\$0

Step 7. Top Cap Finish

BU	black umber	+\$0
HF	inner tone light	+\$0
LU	soft white	+\$0
MT	medium tone	+\$0

Step 8. Cable Management Finish

BU	black umber	+\$0
HF	inner tone light	+\$0
HT	inner tone	+\$0
LU	soft white	+\$0
MT	medium tone	+\$0

Step 9. Surface Finish

For fabric (F)

See application chart and textiles list for fabric usage and numbers. First 2 digits of number indicate fabric line; remaining digit(s) indicate fabric color.

Price Category 1	+\$0
Price Category 2	+\$5
Price Category 3	+\$15
Price Category 4	+\$22

2-Way 90° Connector, Monolithic E1224.

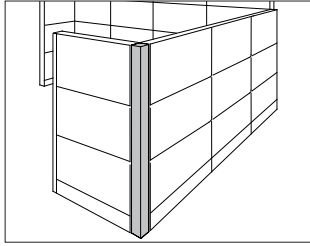

Spacer E1222.

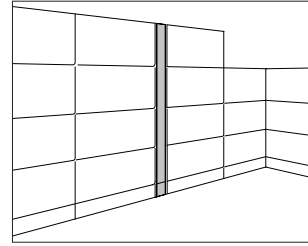

Ethospace® Walls

Specification Information

Step 1.
E1224.

Step 2. Height

30	30" high
38	38" high
46	46" high
54	54" high
62	62" high
70	70" high
86	86" high

Step 3. Surface Material

SS vinyl

Step 4. Power

N (N) nonpowered
E (E) powered

Prices for Steps 1-4.

	N	E
E1224. 30 SS	\$218	254
38 SS	\$236	272
46 SS	\$253	288
54 SS	\$272	309
62 SS	\$284	319
70 SS	\$299	335
86 SS	\$336	371

Step 5. Surface Finish

Vinyl-Textured Surface

BU	black umber	+\$0
HF	inner tone light	+\$0
LU	soft white	+\$0
MT	medium tone	+\$0

Step 6. Top Cap Finish

BU	black umber	+\$0
HF	inner tone light	+\$0
LU	soft white	+\$0
MT	medium tone	+\$0

Specification Information

Step 1.
E1222.

Step 2. Height

30	30" high
38	38" high
46	46" high
54	54" high
62	62" high
70	70" high
86	86" high

Step 3. Surface Material

S vinyl
F fabric

Step 4. Power

N (N) nonpowered
E (E) powered

Prices for Steps 1-4.

	N	E
E1222. 30 S	\$211	270
F	\$227	263
38 S	\$248	287
F	\$244	281
46 S	\$266	305
F	\$260	298
54 S	\$282	322
F	\$276	314
62 S	\$297	334
F	\$288	327
70 S	\$307	346
F	\$301	338
86 S	\$342	380
F	\$333	372

Step 5. Surface Finish Side 1		
<i>For vinyl (S)</i>		
BU	black umber	+\$0
HF	inner tone light	+\$0
HT	inner tone	+\$0
LU	soft white	+\$0
MT	medium tone	+\$0
SG	slate grey	+\$0
WL	sandstone	+\$0
WN	warm grey neutral	+\$0

Step 6. Surface Finish Side 2		
<i>For vinyl (S)</i>		
BU	black umber	+\$0
HF	inner tone light	+\$0
HT	inner tone	+\$0
LU	soft white	+\$0
MT	medium tone	+\$0

Step 7. Top Cap Finish		
<i>For vinyl (S) or fabric (F)</i>		
BU	black umber	+\$0
HF	inner tone light	+\$0
LU	soft white	+\$0
MT	medium tone	+\$0

Step 8. Cable Management Finish		
BU	black umber	+\$0
HF	inner tone light	+\$0
HT	inner tone	+\$0
LU	soft white	+\$0
MT	medium tone	+\$0

Step 9. Surface Finish Side 1		
<i>For fabric (F)</i>		
<i>See application chart and textiles list for fabric usage and numbers.</i>		
<i>First 2 digits of number indicate fabric line; remaining digit(s) indicate fabric color.</i>		
Price Category 1		+\$0
Price Category 2		+\$4
Price Category 3		+\$9
Price Category 4		+\$13

Step 10. Surface Finish Side 2		
<i>For fabric (F)</i>		
<i>See application chart and textiles list for fabric usage and numbers.</i>		
<i>First 2 digits of number indicate fabric line; remaining digit(s) indicate fabric color.</i>		
Price Category 1		+\$0
Price Category 2		+\$4
Price Category 3		+\$9
Price Category 4		+\$13

3-Way 90° Connector

E1230.

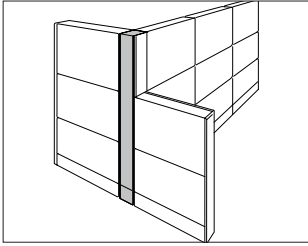

Ethospace® Walls

Specification Information

Step 1.

E1230.

Step 2. Height

30	30" high
38	38" high
46	46" high
54	54" high
62	62" high
70	70" high
86	86" high

Step 3. Surface Material

S	vinyl
F	fabric

Step 4. Power

N	(N) nonpowered
E	(E) powered

Prices for Steps 1-4.

	N	E
E1230. 30 S	\$281	317
F	\$287	322
38 S	\$304	338
F	\$310	344
46 S	\$323	359
F	\$329	365
54 S	\$344	380
F	\$348	384
62 S	\$366	402
F	\$371	406
70 S	\$387	421
F	\$391	426
86 S	\$431	466
F	\$437	470

Step 5. Surface Finish

For vinyl (S)

Vinyl-Textured Surface

BU	black umber	+\$0
HF	inner tone light	+\$0
HT	inner tone	+\$0
LU	soft white	+\$0
MT	medium tone	+\$0

Step 6. Top Cap Finish

BU	black umber	+\$0
HF	inner tone light	+\$0
LU	soft white	+\$0
MT	medium tone	+\$0

Step 7. Cable Management Finish

BU	black umber	+\$0
HF	inner tone light	+\$0
HT	inner tone	+\$0
LU	soft white	+\$0
MT	medium tone	+\$0

Step 8. Surface Finish

For fabric (F)

See application chart and textiles list for fabric usage and numbers.

First 2 digits of number indicate fabric line; remaining digit(s) indicate fabric color.

Price Category 1	+\$0
Price Category 2	+\$5
Price Category 3	+\$11
Price Category 4	+\$15

3-Way 90° Connector, Monolithic E1231.

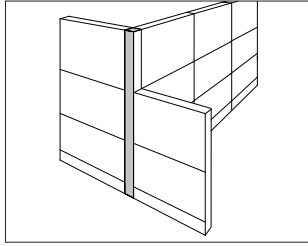

Specification Information

Step 1.

E1231.

Step 2. Height

30S	30" high
38S	38" high
46S	46" high
54S	54" high
62S	62" high
70S	70" high
86S	86" high

Step 3. Power

N	(N) nonpowered
E	(E) powered

Prices for Steps 1-3.

	N	E
E1231. 30S	\$301	334
38S	\$319	352
46S	\$342	376
54S	\$364	396
62S	\$387	420
70S	\$407	441
86S	\$447	489

Step 4. Surface Finish

Vinyl-Textured Surface

BU	black umber	+\$0
HF	inner tone light	+\$0
LU	soft white	+\$0
MT	medium tone	+\$0

Step 5. Top Cap Finish

BU	black umber	+\$0
HF	inner tone light	+\$0
LU	soft white	+\$0
MT	medium tone	+\$0

4-Way 90° Connector E1240.

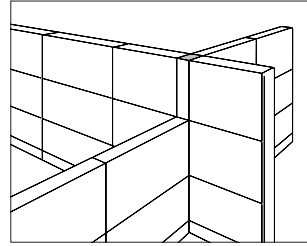

Specification Information

Step 1.

E1240.

Step 2. Height

30F	30" high
38F	38" high
46F	46" high
54F	54" high
62F	62" high
70F	70" high
86F	86" high

Step 3. Power

N	(N) nonpowered
E	(E) powered

Prices for Steps 1-3.

	N	E
E1240. 30F	\$308	354
38F	\$329	375
46F	\$349	398
54F	\$370	419
62F	\$389	438
70F	\$408	458
86F	\$454	507

Step 4. Top Cap Finish

NN	none	+\$0
BU	black umber	+\$0
HF	inner tone light	+\$0
LU	soft white	+\$0
MT	medium tone	+\$0

2-Way 90° Stacking Connector

E1220.

Spacer Stacking Connector

E1222.

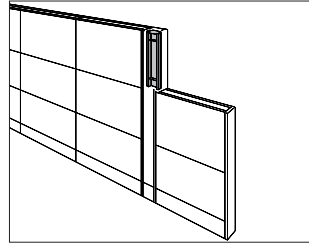
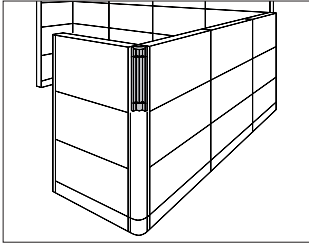

Ethospace® Walls

Specification Information

Step 1.
E1220.16

\$159

Specification Information

Step 1.
E1222.16

\$174

3-Way 90° Stacking Connector

E1230.

4-Way 90° Stacking Connector

E1240.

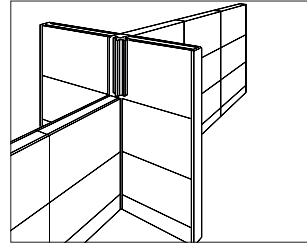
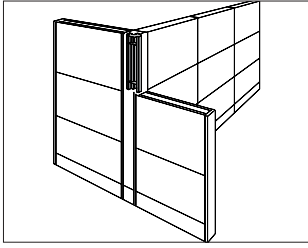

Specification Information

Step 1.

E1230.16

\$173

Specification Information

Step 1.

E1240.16

\$171

Stacking Frame Hardware Kit,
Change of Height

E1293.
E1294.

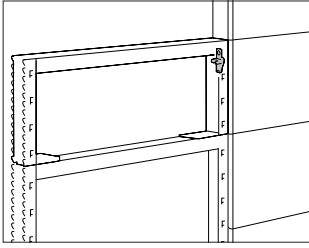

Bare Connector

E1219.

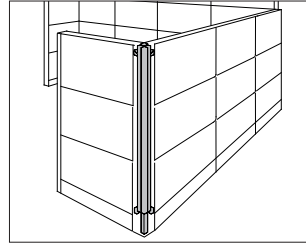

Ethospace® Walls

Specification Information

Step 1.

E129

Step 2. Connector Type

- 3. stacking frame to frame or 2-way 90° or 135° connector
- 4. stacking frame to spacer or 3- or 4-way 90° connector or 2-way 120° connector

Prices for Steps 1-2.

E1293.	\$21
E1294.	\$16

Specification Information

Step 1.

E1219.

Step 2. Height

30	30" high
38	38" high
46	46" high
54	54" high
62	62" high
70	70" high
86	86" high

Step 3. Configuration

- A** 2-way 90° connector with draw rod
- B** spacer
- C** 3-way 90° connector

Prices for Steps 1-3.

		A	B	C
E1219.	30	\$128	161	195
	38	\$139	171	200
	46	\$155	181	211
	54	\$168	192	228
	62	\$180	201	243
	70	\$193	210	259
	86	\$205	218	294

2-Way 90° Connector Cover

E1270.

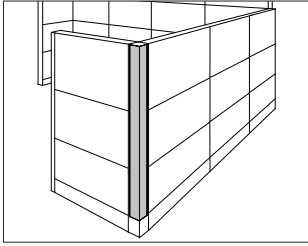

Specification Information

Step 1.

E1270.

Step 2. Height

30	30" high
38	38" high
46	46" high
54	54" high
62	62" high
70	70" high
86	86" high

Step 3. Surface Material

S	vinyl
F	fabric

Step 4. Shape

R	radius
S	square

Prices for Steps 1-4.

	R	S
E1270. 30 S	\$117	117
F	\$123	123
38 S	\$125	125
F	\$129	129
46 S	\$132	132
F	\$136	136
54 S	\$141	141
F	\$145	145
62 S	\$154	154
F	\$157	157
70 S	\$161	161
F	\$164	164
86 S	\$180	180
F	\$181	181

Step 5. Surface Finish

Vinyl-Textured Surface

For vinyl (S)

BU	black umber	+\$0
HF	inner tone light	+\$0
HT	inner tone	+\$0
LU	soft white	+\$0
MT	medium tone	+\$0

For fabric (F)

Price Category 1	+\$0
Price Category 2	+\$7
Price Category 3	+\$15
Price Category 4	+\$22

Ethospace® Walls

2-Way 90° Connector Cover,
Monolithic

E1274.

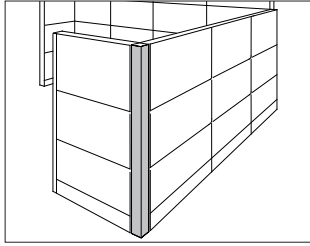

2-Way 90° Connector Cover,
Architectural

E1281.

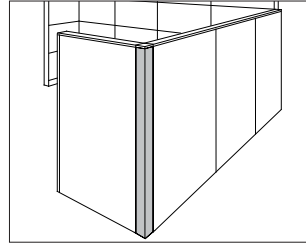

Ethospace® Walls

Specification Information

Step 1.

E1274.

Step 2. Height

30	30" high
38	38" high
46	46" high
54	54" high
62	62" high
70	70" high
86	86" high

Step 3. Surface Material

SS vinyl

Prices for Steps 1-3.

	SS
E1274. 30	\$124
38	\$130
46	\$137
54	\$151
62	\$160
70	\$169
86	\$187

Step 4. Surface Finish

Vinyl-Textured Surface

BU	black umber	+\$0
HF	inner tone light	+\$0
LU	soft white	+\$0
MT	medium tone	+\$0

Specification Information

Step 1.

E1281.

Step 2. Height

30	30" high
38	38" high
46	46" high
54	54" high
62	62" high
70	70" high
86	86" high

Step 3. Surface Material

P painted
F fabric

Prices for Steps 1-3.

	P	F
E1281. 30	\$154	199
38	\$166	218
46	\$173	239
54	\$185	258
62	\$199	284
70	\$211	305
86	\$224	337

Step 4. Surface Finish

For painted (P)

BU	black umber	+\$0
HF	inner tone light	+\$0
LU	soft white	+\$0
MT	medium tone	+\$0
CN	metallic champagne	+\$15

For fabric (F)

Price Category 1	+\$0
Price Category 2	+\$7
Price Category 3	+\$15
Price Category 4	+\$22

Spacer Connector Cover

E1271.

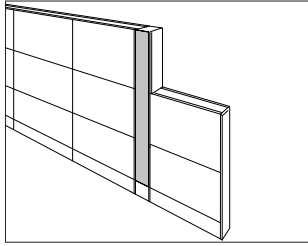

Specification Information

Step 1.

E1271.

Step 2. Height

30	30" high
38	38" high
46	46" high
54	54" high
62	62" high
70	70" high
86	86" high

Step 3. Surface Material

S	vinyl
F	fabric

Prices for Steps 1-3.

	S	F
E1271. 30	\$153	165
38	\$169	173
46	\$180	182
54	\$187	190
62	\$197	200
70	\$204	207
86	\$224	227

Step 4. Surface Finish Side 1

For vinyl (S)

Vinyl-Textured Surface

BU	black umber	+ \$0
HF	inner tone light	+ \$0
HT	inner tone	+ \$0
LU	soft white	+ \$0
MT	medium tone	+ \$0

Step 5. Surface Finish Side 2

For vinyl (S)

Vinyl-Textured Surface

BU	black umber	+ \$0
HF	inner tone light	+ \$0
HT	inner tone	+ \$0
LU	soft white	+ \$0
MT	medium tone	+ \$0

Step 6. Surface Finish Side 1

For fabric (F)

See application chart and textiles list for fabric usage and numbers. First 2 digits of number indicate fabric line; remaining digit(s) indicate fabric color.

Price Category 1	+ \$0
Price Category 2	+ \$5
Price Category 3	+ \$11
Price Category 4	+ \$15

Step 7. Surface Finish Side 2

For fabric (F)

See application chart and textiles list for fabric usage and numbers. First 2 digits of number indicate fabric line; remaining digit(s) indicate fabric color.

Price Category 1	+ \$0
Price Category 2	+ \$5
Price Category 3	+ \$11
Price Category 4	+ \$15

Spacer Connector Cover,
Monolithic

E1275.

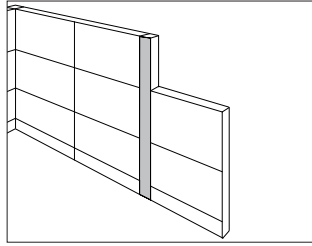

Spacer/3-Way 90° Connector
Cover, Architectural

E1282.

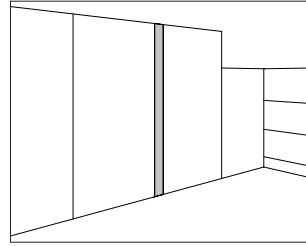

Ethospace® Walls

Specification Information

Step 1.

E1275.

Step 2. Height

30S	30" high
38S	38" high
46S	46" high
54S	54" high
62S	62" high
70S	70" high
86S	86" high

Prices for Steps 1-2.

E1275. 30S	\$165
38S	\$172
46S	\$183
54S	\$191
62S	\$200
70S	\$209
86S	\$228

Step 3. Surface Finish Side 1

BU	black umber	+\$0
HF	inner tone light	+\$0
LU	soft white	+\$0
MT	medium tone	+\$0

Step 4. Surface Finish Side 2

BU	black umber	+\$0
HF	inner tone light	+\$0
LU	soft white	+\$0
MT	medium tone	+\$0

Specification Information

Step 1.

E1282.

Step 2. Height

30	30" high
38	38" high
46	46" high
54	54" high
62	62" high
70	70" high
86	86" high

Step 3. Surface Material

P	painting
F	fabric

Prices for Steps 1-3.

		P	F
E1282. 30		\$177	218
38		\$188	227
46		\$197	241
54		\$205	252
62		\$218	273
70		\$227	277
86		\$246	301

Step 4. Surface Finish

For painted (P)

BU	black umber	+\$0
HF	inner tone light	+\$0
LU	soft white	+\$0
MT	medium tone	+\$0
CN	metallic champagne	+\$10

For fabric (F)

Price Category 1	+\$0
Price Category 2	+\$5
Price Category 3	+\$11
Price Category 4	+\$15

3-Way 90° Connector Cover

E1272.

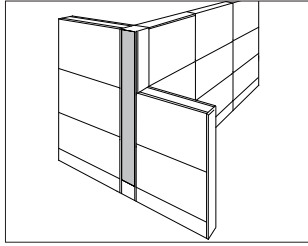

Specification Information

Step 1.

E1272.

Step 2. Height

30	30" high
38	38" high
46	46" high
54	54" high
62	62" high
70	70" high
86	86" high

Step 3. Surface Material

S	vinyl
F	fabric

Prices for Steps 1-3.

	S	F
E1272. 30	\$113	129
38	\$120	133
46	\$126	139
54	\$131	145
62	\$136	154
70	\$141	160
86	\$157	171

Step 4. Surface Finish

Vinyl-Textured Surface

For vinyl (S)

BU	black umber	+\$0
HF	inner tone light	+\$0
HT	inner tone	+\$0
LU	soft white	+\$0
MT	medium tone	+\$0

For fabric (F)

Price Category 1	+\$0
Price Category 2	+\$5
Price Category 3	+\$11
Price Category 4	+\$15

3-Way 90° Connector Cover,
Monolithic

E1276.

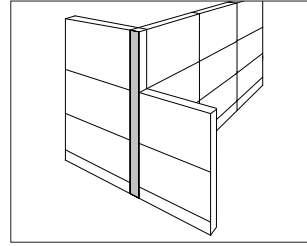

Specification Information

Step 1.

E1276.

Step 2. Height

30S	30" high
38S	38" high
46S	46" high
54S	54" high
62S	62" high
70S	70" high
86S	86" high

Prices for Steps 1-2.

E1276. 30S	\$123
38S	\$128
46S	\$134
54S	\$139
62S	\$151
70S	\$156
86S	\$168

Step 3. Surface Finish

Vinyl-Textured Surface

BU	black umber	+\$0
HF	inner tone light	+\$0
LU	soft white	+\$0
MT	medium tone	+\$0

Finished End

E1250.

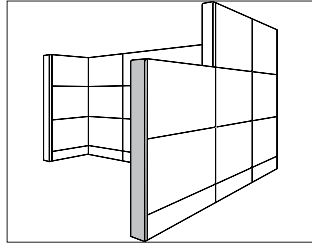

Finished End, Change of Height

E1251.

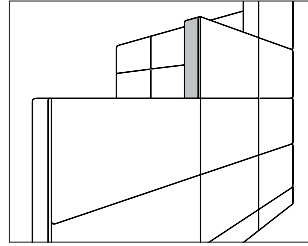

Ethospace® Walls

Specification Information

Step 1.

E1250.

Step 2. Height

30	30" high
38	38" high
46	46" high
54	54" high
62	62" high
70	70" high
86	86" high

Step 3. Shape

S	standard
A	painted architectural

Prices for Steps 1-3.

	S	A
E1250. 30	\$68	88
38	\$71	91
46	\$73	96
54	\$77	102
62	\$81	115
70	\$84	126
86	\$95	142

Step 4. Surface Finish

BU	black umber	+\$0
HF	inner tone light	+\$0
LU	soft white	+\$0
MT	medium tone	+\$0
CN	metallic champagne	+\$7

Specification Information

Step 1.

E1251.

Step 2. Height

08	8" high
16	16" high
24	24" high
32	32" high

Step 3. Shape

S	standard
A	painted architectural

Prices for Steps 1-3.

	S	A
E1251. 08	\$53	66
16	\$57	78
24	\$64	90
32	\$68	96

Step 4. Surface Finish

BU	black umber	+\$0
HF	inner tone light	+\$0
LU	soft white	+\$0
MT	medium tone	+\$0
CN	metallic champagne	+\$7

Frame Top Cap

E1260.

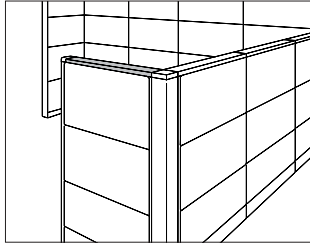

Specification Information

Step 1.

E1260.

Step 2. Width

24	24" wide
30	30" wide
36	36" wide
42	42" wide
48	48" wide

Step 3. Shape

S	standard
A	painting architectural

Prices for Steps 1-3.

	S	A
E1260. 24	\$22	61
30	\$23	71
36	\$24	85
42	\$26	93
48	\$28	103

Step 4. Surface Finish

For standard (S) or painting architectural (A)

BU	black umber	+ \$0
HF	inner tone light	+ \$0
LU	soft white	+ \$0
MT	medium tone	+ \$0
CN	metallic champagne	+ \$5

Connector Top Cap

E1261.

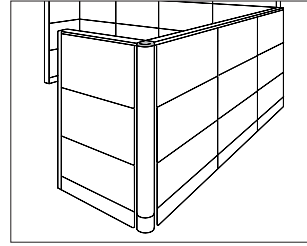

Specification Information

Step 1.

E1261.

Step 2. Configuration

1	spacer
2	2-way 90° radius-shaped connector
5	2-way 90° square-shaped connector
3	3-way 90° connector
4	4-way 90° connector

Step 3. Shape

For spacer (1), 2-way 90° radius-shaped connector (2), 3-way 90° connector (3), or 4-way 90° connector (4)

S	standard
A	painting architectural

For 2-way 90° square-shaped connector (5)

S	standard
A	painting architectural

Prices for Steps 1-3.

	S	A
E1261. 1	\$32	68
2	\$32	68
5	\$32	68
3	\$32	68
4	\$32	68

Step 4. Surface Finish

For standard (S)

BU	black umber	+ \$0
HF	inner tone light	+ \$0
LU	soft white	+ \$0
MT	medium tone	+ \$0

For painting architectural (A)

BU	black umber	+ \$0
HF	inner tone light	+ \$0
LU	soft white	+ \$0
MT	medium tone	+ \$0
CN	metallic champagne	+ \$5

Power Entry, External Direct
Connect, 4 Circuit

E1322.

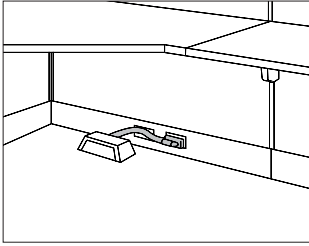

Power Entry, Internal Direct
Connect, 4 Circuit

E1325.

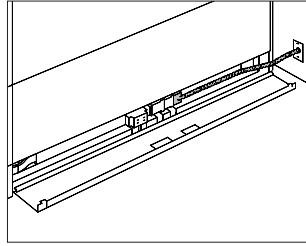

Ethospace® Walls

Specification Information

Step 1.

E1322.

Step 2. Length

06E 6' long

24E 24' long

Prices for Steps 1-2.

E1322. 06E \$171

24E \$354

Specification Information

Step 1.

E1325.6E

\$189

Base Power Entry, Junction Box, 4 Circuit E1323.

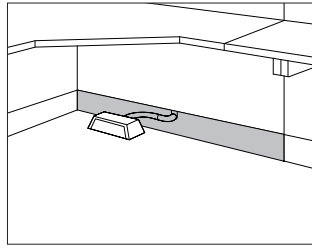

Specification Information

Step 1.

E132

Step 2. Base Option

3. plain base

Step 3. Width

- 24E** 24" wide
- 30E** 30" wide
- 36E** 36" wide
- 42E** 42" wide
- 48E** 48" wide

Prices for Steps 1-3.

E1323. 24E	\$349
30E	\$365
36E	\$377
42E	\$404
48E	\$430

Step 4. Surface Finish

BU black umber	+ \$0
HF inner tone light	+ \$0
HT inner tone	+ \$0
LU soft white	+ \$0
MT medium tone	+ \$0

Ceiling Power Entry, Internal Direct Connect E1331.

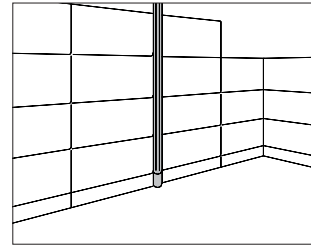

Specification Information

Step 1.

E1331.

Step 2. Height

- 46** 46" high
- 54** 54" high
- 62** 62" high
- 70** 70" high
- 86** 86" high

Step 3. Attachment

C connector- or frame-attached

Step 4. Power

- N** (N) nonpowered
- E** (E) 4-circuit power

Prices for Steps 1-4.

	N	E
E1331. 46 C	\$285	453
54 C	\$301	468
62 C	\$314	481
70 C	\$325	491
86 C	\$350	517

Step 5. Surface Finish

BU black umber	+ \$0
HF inner tone light	+ \$0
LU soft white	+ \$0
MT medium tone	+ \$0

Step 6. Cable Management Finish

BU black umber	+ \$0
HF inner tone light	+ \$0
HT inner tone	+ \$0
LU soft white	+ \$0
MT medium tone	+ \$0

Baseline Harness, 4 Circuit

E1354.
E1355.

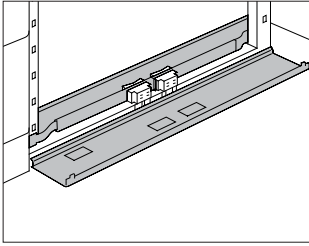

Pass-Through Harness, Frame

E1342.

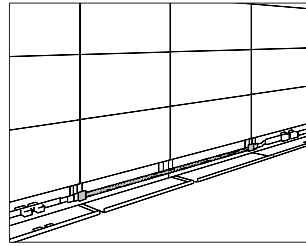

Ethospace® Walls

Specification Information

Step 1.

E135

Step 2. Side Covers

- 4. no side covers
- 5. side covers

Step 3. Frame Width

- 24 24" wide
- 30 30" wide
- 36 36" wide
- 42 42" wide
- 48 48" wide

Step 4. Power Connection

- E** standard

Prices for Steps 1-4.

	E
E1354. 24	\$130
30	\$135
36	\$141
42	\$152
48	\$158

E1355. 24	\$225
30	\$225
36	\$225
42	\$232
48	\$232

Step 5. Cable Management Finish

For side covers (5.)

BU	black umber	+\$0
HF	inner tone light	+\$0
HT	inner tone	+\$0
LU	soft white	+\$0
MT	medium tone	+\$0

Specification Information

Step 1.

E1342.

Step 2. Length

- 24E** 24" long
- 30E** 30" long
- 36E** 36" long
- 42E** 42" long
- 48E** 48" long

Prices for Steps 1-2.

E1342. 24E	\$128
30E	\$134
36E	\$142
42E	\$151
48E	\$158

Pass-Through Harness,
Connector

E1356.

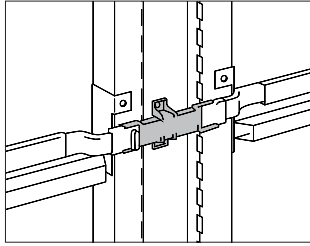

Specification Information

Step 1.

E1356.

Step 2. Configuration

- AE** 2-way 90° connector
- BE** spacer
- CE** 3-way 90° connector
- DE** 4-way 90° connector

Prices for Steps 1-2.

E1356. AE	\$192
BE	\$200
CE	\$204
DE	\$210

Beltline Harness, 4 Circuit

E1353.

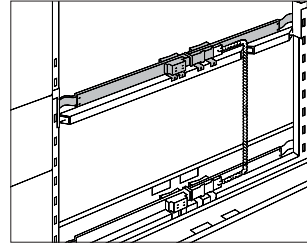

Specification Information

Step 1.

E1353.

Step 2. Frame Width

- 24** 24"-wide frame
- 30** 30"-wide frame
- 36** 36"-wide frame
- 42** 42"-wide frame
- 48** 48"-wide frame

Step 3. Power Connection

- E** standard

Prices for Steps 1-3.

	E
E1353. 24	\$192
30	\$200
36	\$203
42	\$209
48	\$214

Tile-Height Harness, 4 Circuit

E1357.

Power Jumper, 4 Circuit

E1341.

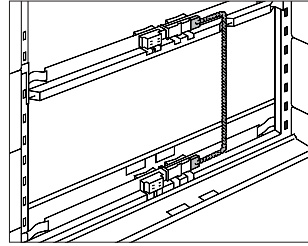
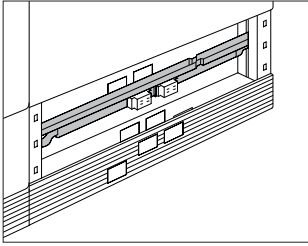

Ethospace® Walls

Specification Information

Step 1.

E1357.

Step 2. Frame Width

- 24E** 24"-wide frame
- 30E** 30"-wide frame
- 36E** 36"-wide frame
- 42E** 42"-wide frame
- 48E** 48"-wide frame

Prices for Steps 1-2.

E1357. 24E	\$192
30E	\$200
36E	\$203
42E	\$209
48E	\$214

Specification Information

Step 1.

E1341.

Step 2. Configuration

- 3E** 4th 8" tile above base
- 5E** 6th 8" tile above base

Prices for Steps 1-2.

E1341. 3E	\$107
5E	\$129

Baseline Box Assembly, H-Style
Frame

EW400.

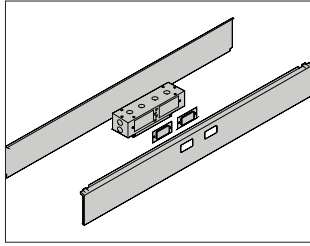

Specification Information

Step 1.

EW400.

Step 2. Width

24	24" wide
30	30" wide
36	36" wide
42	42" wide
48	48" wide

Prices for Steps 1-2.

EW400.24	\$227
30	\$235
36	\$244
42	\$254
48	\$273

Step 3. Bezel Finish

BU	black umber	+\$0
HF	inner tone light	+\$0
LU	soft white	+\$0
MT	medium tone	+\$0

Receptacle, 4 Circuit, 15 Amp

E1311.

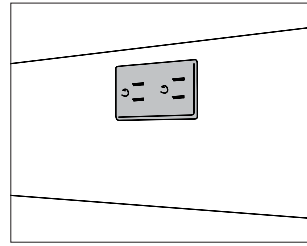

Specification Information

Step 1.

E1311.

Step 2. Type

A	duplex, circuit a
B	duplex, circuit b
C	duplex, circuit c
DN	duplex, circuit d
D	duplex, circuit d, isolated ground

Prices for Steps 1-2.

E1311. A	\$197
B	\$197
C	\$197
DN	\$197
D	\$197

Step 3. Surface Finish

BU	black umber	+\$0
HF	inner tone light	+\$0
HT	inner tone	+\$0
LU	soft white	+\$0
MT	medium tone	+\$0

Connect™-S300

Y1323.

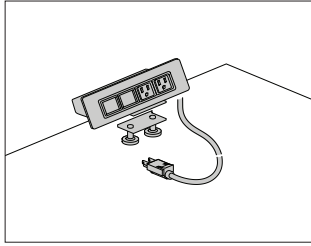

Work Surface-Attached Electrical Distributor

Y1314.

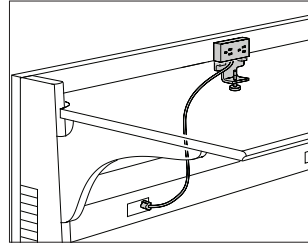

Ethospace® Walls

Specification Information

Step 1.

Y1323.

Step 2. Configuration

- 3** 2 simplex receptacles, 2 data openings
- 4** 3 simplex receptacles, 3 data openings

Step 3. Power Type

- A** power cord with plug end
- B** conduit with open end, for hard-wiring

Step 4. Cord/Conduit Length

- 03** 3' cord/conduit
- 06** 6' cord/conduit
- 10** 10' cord/conduit
- 20** 20' cord/conduit

Step 5. Attachment

- G** grommet mount
- S** surface clamp

Prices for Steps 1-5.

		03G	03S	06G	06S	10G	10S
Y1323. 3	A	\$249	249	249	249	258	258
	B	\$296	296	296	296	305	305
4	A	\$311	311	311	311	320	320
	B	\$359	359	359	359	368	368

			20G	20S
Y1323. 3	A		\$301	301
	B		\$348	348
4	A		\$363	363
	B		\$411	411

Step 6. Finish

- 0H** black +\$0
- 0I** silver +\$0
- 0J** white +\$0

Specification Information

Step 1.

Y1314.

\$169

Cable Manager, Extra Capacity

E1396.

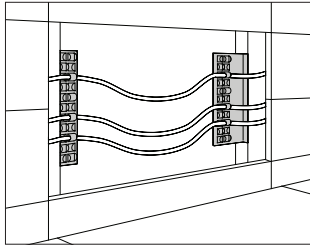

Specification Information

Step 1.

E1396.

\$73

Communication Port Faceplate Reducer

G1189.

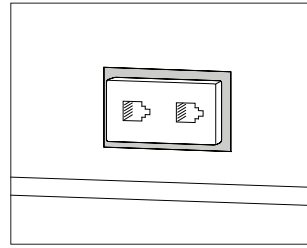

Specification Information

Step 1.

G1189.A

\$44

Ethospace® Walls

Communication Port Faceplate
Extender

G1189.

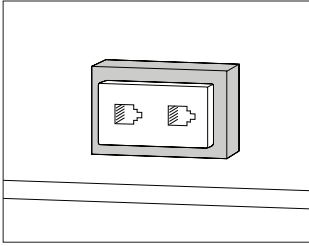

Work Surface-Attached
Voice/Data Outlet

Y1320.

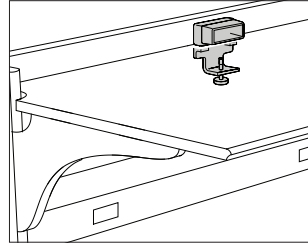

Ethospace® Walls

Specification Information

Step 1.

G1189.B

\$57

Step 2. Surface Finish

8Q	folkstone grey	+\$0
BU	black umber	+\$0
CL	cool grey neutral	+\$0
HF	inner tone light	+\$0
MT	medium tone	+\$0
WL	sandstone	+\$0
WN	warm grey neutral	+\$0

Specification Information

Step 1.

Y1320.

\$102

Beltline Bezel, H-Style Frame

G1510.

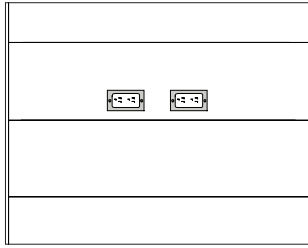

Specification Information

Step 1.

G1510. \$45

Step 2. Surface Finish

BU	black umber	+\$0
HF	inner tone light	+\$0
LU	soft white	+\$0
MT	medium tone	+\$0

Face Tile

E1420.

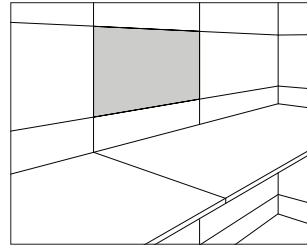

Specification Information

Step 1.

E1420.

Step 2. Height

08	8" high
16	16" high
24	24" high

Step 3. Width

24	24" wide
30	30" wide
36	36" wide
42	42" wide
48	48" wide

Step 4. Surface Material

For 8" high (08) with 24" wide (24), 30" wide (30), 36" wide (36), 42" wide (42), or 48" wide (48)

P	Painted
F	fabric

For 16" high (16)

P	Painted
F	fabric

For 24" high (24)

P	Painted
F	fabric

Prices for Steps 1-4.

		P	F
E1420. 08	24	\$46	62
	30	\$49	66
	36	\$54	75
	42	\$61	86
	48	\$64	93
	16 24	\$51	83
	30	\$55	88
	36	\$59	98
	42	\$67	104
	48	\$71	113

24 24	\$82	101
30	\$88	109
36	\$95	123
42	\$102	130
48	\$113	141

Step 5. Surface Finish

For painted (P)

	08	16	24
BU black umber	+\$0	0	0
HF inner tone light	+\$0	0	0
LU soft white	+\$0	0	0
MT medium tone	+\$0	0	0
CN metallic champagne	+\$5	10	15

For fabric (F)

	08	16	24
Price Category 1	+\$0	0	0
Price Category 2	+\$4	13	19
Price Category 3	+\$8	22	33
Price Category 4	+\$13	33	51

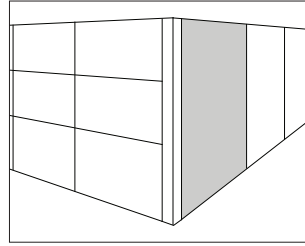

Specification Information

Step 1.

E1420.

Step 2. Height

22	22" high
30	30" high

Step 3. Width

24	24" wide
30	30" wide
36	36" wide
42	42" wide
48	48" wide

Step 4. Surface Material

P	painted
F	fabric

Prices for Steps 1-4.

	P	F
E1420. 22 24	\$93	102
30	\$100	109
36	\$107	120
42	\$112	127
48	\$127	138
30 24	\$98	107
30	\$109	124
36	\$123	133
42	\$132	144
48	\$141	159

Step 5. Surface Finish

See application chart and textiles list for fabric usage and numbers. First 2 digits of number indicate fabric line; remaining digit(s) indicate fabric color.

For 22" high (22) with painted (P)

BU	black umber	+\$0
HF	inner tone light	+\$0
LU	soft white	+\$0
MT	medium tone	+\$0
CN	metallic champagne	+\$15

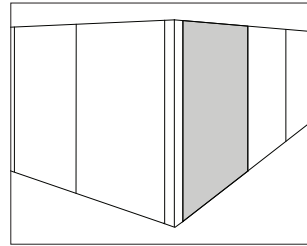

<i>For 30" high (30) with painted (P)</i>		
BU	black umber	+\$0
HF	inner tone light	+\$0
LU	soft white	+\$0
MT	medium tone	+\$0

<i>For fabric (F)</i>		
	22	30
Price Category 1	+\$0	0
Price Category 2	+\$13	19
Price Category 3	+\$22	33
Price Category 4	+\$33	51

Specification Information

Step 1.
E1445.

Step 2. Height

16	16" high
24	24" high
30	30" high
32	32" high

Step 3. Width

24F	24" wide
30F	30" wide
36F	36" wide
42F	42" wide
48F	48" wide

Prices for Steps 1-3.

	24F	30F	36F	42F	48F
E1445. 16	\$145	154	161	169	176
24	\$176	186	198	205	218
30	\$200	214	224	236	249
32	\$216	231	243	253	269

Step 4. Surface Finish

*See application chart and textiles list for fabric usage and numbers.
First 2 digits of number indicate fabric line; remaining digit(s) indicate fabric color.*

	16	24	30	32
Price Category 1	+\$0	0	0	0
Price Category 2	+\$13	19	19	25
Price Category 3	+\$22	33	33	44
Price Category 4	+\$33	51	51	66

Acoustical Tile

E1423.
E1424.

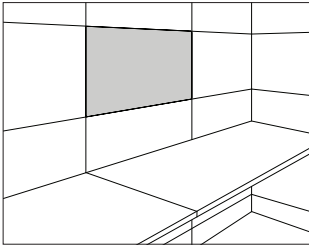

Tackable Tile

E1422.

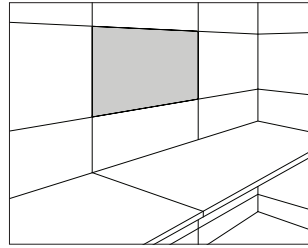

Ethospace® Walls

Specification Information

Step 1.

E142

Step 2. Acoustical Rating

3.16 .65 NRC, 20 STC

4.16 .80 NRC, 21 STC

Step 3. Width

24 24" wide

30 30" wide

36 36" wide

42 42" wide

48 48" wide

Prices for Steps 1-3.

E1423.16	24	\$92
	30	\$101
	36	\$115
	42	\$132
	48	\$140

E1424.16	24	\$99
	30	\$107
	36	\$125
	42	\$141
	48	\$155

Step 4. Surface Finish

See application chart and textiles list for fabric usage and numbers.

First 2 digits of number indicate fabric line; remaining digit(s) indicate fabric color.

Price Category 1	+\$0
Price Category 2	+\$13
Price Category 3	+\$22
Price Category 4	+\$33

Specification Information

Step 1.

E1422.16

Step 2. Width

24 24" wide

30 30" wide

36 36" wide

42 42" wide

48 48" wide

Prices for Steps 1-2.

E1422.16	24	\$102
	30	\$113
	36	\$128
	42	\$145
	48	\$159

Step 3. Surface Finish

See application chart and textiles list for fabric usage and numbers.

First 2 digits of number indicate fabric line; remaining digit(s) indicate fabric color.

Price Category 1	+\$0
Price Category 2	+\$13
Price Category 3	+\$22
Price Category 4	+\$33

Cable Access Tile

E1436.

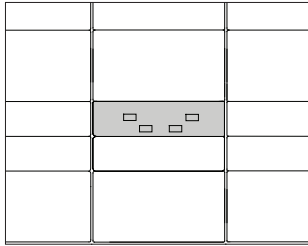

Specification Information

Step 1.

E1436.08

Step 2. Width

24	24" wide
30	30" wide
36	36" wide
42	42" wide
48	48" wide

Step 3. Surface Material

P	Painted
F	Fabric

Prices for Steps 1-3.

		P	F
E1436.08	24	\$96	112
	30	\$115	132
	36	\$121	139
	42	\$128	151
	48	\$133	158

Step 4. Receptacle Filler Finish

BU	black umber	+\$0
HF	inner tone light	+\$0
HT	inner tone	+\$0
LU	soft white	+\$0
MT	medium tone	+\$0

Step 5. Surface Finish

See application chart and textiles list for fabric usage and numbers. First 2 digits of number indicate fabric line; remaining digit(s) indicate fabric color.

For painted (P)

BU	black umber	+\$0
HF	inner tone light	+\$0
LU	soft white	+\$0
MT	medium tone	+\$0
CN	metallic champagne	+\$5

For fabric (F)

Price Category 1	+\$0
Price Category 2	+\$4
Price Category 3	+\$9
Price Category 4	+\$15

Cable Channel Tile

E1433.

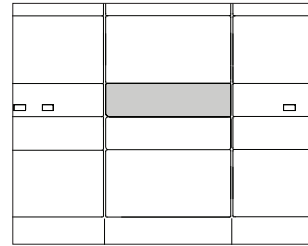

Specification Information

Step 1.

E1433.08

Step 2. Width

24	24" wide
30	30" wide
36	36" wide
42	42" wide
48	48" wide

Step 3. Surface Material

P	Painted
F	Fabric

Prices for Steps 1-3.

		P	F
E1433.08	24	\$90	103
	30	\$105	128
	36	\$113	133
	42	\$124	144
	48	\$129	156

Step 4. Surface Finish

See application chart and textiles list for fabric usage and numbers. First 2 digits of number indicate fabric line; remaining digit(s) indicate fabric color.

For painted (P)

BU	black umber	+\$0
HF	inner tone light	+\$0
LU	soft white	+\$0
MT	medium tone	+\$0
CN	metallic champagne	+\$5

For fabric (F)

Price Category 1	+\$0
Price Category 2	+\$4
Price Category 3	+\$9
Price Category 4	+\$15

Open Tile

E1440.

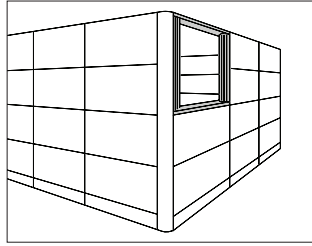

Open Tile, Squared Stile

E1444.

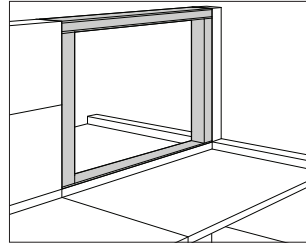

Ethospace® Walls

Specification Information

Step 1.
E1440.

Step 2. Height
16 16" high

Step 3. Width
24 24" wide
30 30" wide
36 36" wide
42 42" wide
48 48" wide

Step 4. Tile Position
T top
M middle/bottom

Prices for Steps 1-4.

	T	M
E1440. 16 24	\$168	145
30	\$196	172
36	\$218	189
42	\$236	205
48	\$256	222

Step 5. Frame Finish

BU	black umber	+\$0
HF	inner tone light	+\$0
LU	soft white	+\$0
MT	medium tone	+\$0

Specification Information

Step 1.
E1444.

Step 2. Height
16 16" high
32 32" high
48 48" high

Step 3. Width
24 24" wide
30 30" wide
36 36" wide
42 42" wide
48 48" wide

Step 4. Tile Position
T top
M middle/bottom

Prices for Steps 1-4.

	T	M
E1444. 16 24	\$168	145
30	\$196	172
36	\$218	189
42	\$236	205
48	\$256	222
32 24	\$225	198
30	\$257	224
36	\$283	249
42	\$309	270
48	\$336	297
48 24	\$286	252
30	\$311	273
36	\$341	301
42	\$371	325
48	\$400	349

Step 5. Frame Finish

BU	black umber	+\$0
HF	inner tone light	+\$0
LU	soft white	+\$0
MT	medium tone	+\$0

Perforated Tile, Squares

E1441.

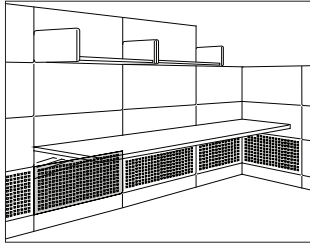

Specification Information

Step 1.

E1441.

Step 2. Height

16 16" high

Step 3. Width

24P 24" wide

30P 30" wide

36P 36" wide

42P 42" wide

48P 48" wide

Prices for Steps 1-3.

	24P	30P	36P	42P	48P
E1441. 16	\$65	70	82	88	95

Step 4. Surface Finish

BU	black umber	+\$0
HF	inner tone light	+\$0
LU	soft white	+\$0
MT	medium tone	+\$0
CN	metallic champagne	+\$10

Rail Tile

E1425.

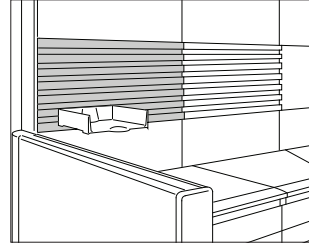

Specification Information

Step 1.

E1425.

Step 2. Height

16 16" high

Step 3. Width

24 24" wide

30 30" wide

36 36" wide

42 42" wide

48 48" wide

Prices for Steps 1-3.

	24	30	36	42	48
E1425. 16	\$170	189	205	227	244

Step 4. Surface Finish

BU	black umber	+\$0
HF	inner tone light	+\$0
LU	soft white	+\$0
MT	medium tone	+\$0
CN	metallic champagne	+\$15

Marker Tile

E1426.

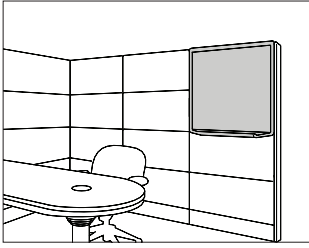

Marker/Eraser Holder

Y7231.

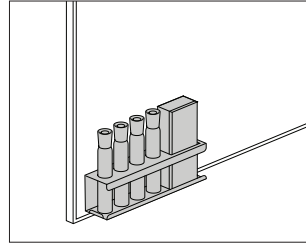

Ethospace® Walls

Specification Information

Step 1.

E1426.

Step 2. Height

16 16" high

32 32" high

Step 3. Width

30 30" wide

36 36" wide

42 42" wide

48 48" wide

Prices for Steps 1-3.

	30	36	42	48
E1426. 16	\$265	278	291	311
32	\$371	386	397	432

Specification Information

Step 1.

Y7231.

\$117

Step 2. Finish

91 white +\$0

BK black +\$0

MS metallic silver +\$0

Rectangular Surface

EWS10.

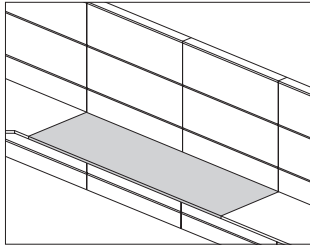

Specification Information

Step 1.

EW

Step 2. Edge

S10. squared-edge

Step 3. Depth

24 24" deep

30 30" deep

Step 4. Width

24 24" wide

30 30" wide

36 36" wide

42 42" wide

48 48" wide

60 60" wide

66 66" wide

72 72" wide

Step 5. Surface Material

L laminate top/thermoplastic edge

Step 6. Attachment

For 24" deep (24) or 30" deep (30) with 24" wide (24), 30" wide (30), 66" wide (66), or 72" wide (72)

F Ethospace® frame attached surface

For 24" deep (24) or 30" deep (30) with 36" wide (36), 42" wide (42), 48" wide (48), or 60" wide (60)

D surface attachment bracket

F Ethospace® frame attached surface

Prices for Steps 1-6.

	LD	LF
EWS10.24 24	—	\$152
30	—	\$174
36	\$238	198
42	\$261	221
48	\$285	245
60	\$368	328
66	—	\$368
72	—	\$408

30 24	—	\$166
30	—	\$213
36	\$289	249
42	\$324	284
48	\$360	320
60	\$464	424
66	—	\$481
72	—	\$536

Step 7. Top/Edge Finish

Solid-Color Laminate Top/Thermoplastic Edge

HF	inner tone light	+\$0
HT	inner tone	+\$0
LU	soft white	+\$0

Fiber Laminate Top/Thermoplastic Edge

1X	vanilla	+\$0
4X	coriander	+\$0
7X	cardamom	+\$0

Frosted Laminate Top/Thermoplastic Edge

J5	frosted inner tone light	+\$0
-----------	--------------------------	------

Wood-Grain Laminate Top/Thermoplastic Edge

LA	light ash	+\$0
LBD	dark brown walnut	+\$0
LBE	medium red walnut	+\$0
LM	mahogany	+\$0

Ethospace® Work Surfaces

Curvilinear Surface

EWS12.

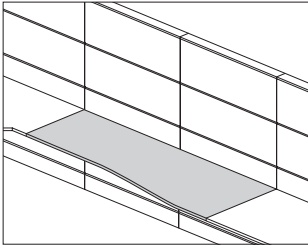

Ethospace® Work Surfaces

Specification Information

Step 1.

EW

Step 2. Edge

S12. squared-edge

Step 3. Depth

24 24" deep left, 30" deep right

30 30" deep left, 24" deep right

Step 4. Width

30 30" wide

36 36" wide

42 42" wide

48 48" wide

60 60" wide

Step 5. Surface Material

L laminate top/thermoplastic edge

Step 6. Attachment

F Ethospace® frame attached surface

Prices for Steps 1-6.

	LF
EWS12.24 30	\$264
36	\$282
42	\$330
48	\$380
60	\$396
30 30	\$264
36	\$282
42	\$330
48	\$380
60	\$396

Step 7. Top/Edge Finish

Solid-Color Laminate Top/Thermoplastic Edge

HF inner tone light +\$0

HT inner tone +\$0

LU soft white +\$0

Fiber Laminate Top/Thermoplastic Edge

1X vanilla +\$0

4X coriander +\$0

7X cardamom +\$0

Frosted Laminate Top/Thermoplastic Edge

J5 frosted inner tone light +\$0

Wood-Grain Laminate Top/Thermoplastic Edge

LA light ash +\$0

LM mahogany +\$0

Corner Surface

EWS20.

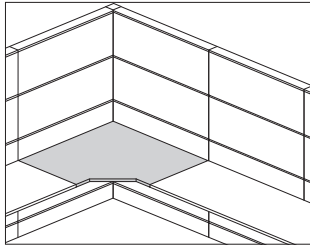

Specification Information

Step 1.

EW

Step 2. Edge

S20. squared-edge

Step 3. Depth

24 24" deep

30 30" deep

Step 4. Width

For 24" deep (24)

36 36" wide

42 42" wide

48 48" wide

For 30" deep (30)

42 42" wide

48 48" wide

Step 5. Surface Material

L laminate top/thermoplastic edge

Step 6. Attachment

F Ethospace® frame attached surface

Prices for Steps 1-6.

	LF
EWS20.24 36	\$294
42	\$361
48	\$427
30 42	\$453
48	\$510

Step 7. Top/Edge Finish

For laminate top/thermoplastic edge (L)

Solid-Color Laminate Top/Thermoplastic Edge

HF inner tone light	+\$0
HT inner tone	+\$0
LU soft white	+\$0

Fiber Laminate Top/Thermoplastic Edge

1X vanilla	+\$0
4X coriander	+\$0
7X cardamom	+\$0

Frosted Laminate Top/Thermoplastic Edge

J5 frosted inner tone light	+\$0
------------------------------------	------

Wood-Grain Laminate Top/Thermoplastic Edge

LA light ash	+\$0
LM mahogany	+\$0

Concave Corner Surface

EWS21.

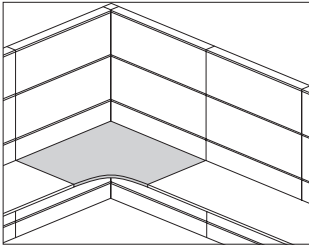

Ethospace® Work Surfaces

Specification Information

Step 1.

EW

Step 2. Edge

S21. squared-edge

Step 3. Depth

24 24" deep

30 30" deep

Step 4. Width

For 24" deep (24)

36 36" wide

42 42" wide

48 48" wide

For 30" deep (30)

42 42" wide

48 48" wide

Step 5. Surface Material

L laminate top/thermoplastic edge

Step 6. Attachment

F Ethospace® frame attached surface

Prices for Steps 1-6.

	LF
EWS21.24 36	\$294
42	\$361
48	\$427
30 42	\$453
48	\$510

Step 7. Top/Edge Finish

Solid-Color Laminate Top/Thermoplastic Edge

HF inner tone light +\$0

HT inner tone +\$0

LU soft white +\$0

Fiber Laminate Top/Thermoplastic Edge

1X vanilla +\$0

4X coriander +\$0

7X cardamom +\$0

Frosted Laminate Top/Thermoplastic Edge

J5 frosted inner tone light +\$0

Wood-Grain Laminate Top/Thermoplastic Edge

LA light ash +\$0

LM mahogany +\$0

Extended Corner Surface,
Rectangular End

EWS22.

Squared-Edge Corner Wedge

Y2091.

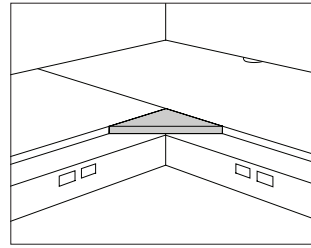
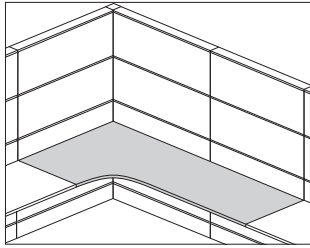

Specification Information

Step 1.

EW

Step 2. Edge

S22. squared-edge, 24" deep

Step 3. Width

4260 42" wide left x 60" wide right

4872 48" wide left x 72" wide right

6042 60" wide left x 42" wide right

7248 72" wide left x 48" wide right

Step 4. Surface Material

L laminate top/thermoplastic edge

Step 5. Attachment

F Ethospace® frame attached surface

Prices for Steps 1-5.

	F
EWS22.4260 L	\$687
4872 L	\$814
6042 L	\$687
7248 L	\$814

Step 6. Top/Edge Finish

Solid-Color Laminate Top/Thermoplastic Edge

HF inner tone light	+ \$0
HT inner tone	+ \$0
LU soft white	+ \$0

Fiber Laminate Top/Thermoplastic Edge

1X vanilla	+ \$0
4X coriander	+ \$0
7X cardamom	+ \$0

Frosted Laminate Top/Thermoplastic Edge

J5 frosted inner tone light	+ \$0
------------------------------------	-------

Wood-Grain Laminate Top/Thermoplastic Edge

LA light ash	+ \$0
LM mahogany	+ \$0

Specification Information

Step 1.

Y2091.

Step 2. Surface Material

L laminate

Prices for Steps 1-2.

Y2091. L \$100

Step 3. Top/Edge Finish

Solid-Color Laminate Top/Thermoplastic Edge

8Q folkstone grey	+ \$0
91 white	+ \$0
HF inner tone light	+ \$0
HT inner tone	+ \$0
LT light tone	+ \$0
LU soft white	+ \$0
WL sandstone	+ \$0
WN warm grey neutral	+ \$0

Fiber Laminate Top/Thermoplastic Edge

1X vanilla	+ \$0
2X wheat	+ \$0
4X coriander	+ \$0
7X cardamom	+ \$0

Frosted Laminate Top/Thermoplastic Edge

J5 frosted inner tone light	+ \$0
------------------------------------	-------

Wood-Grain Laminate Top/Thermoplastic Edge

HM natural maple	+ \$0
LA light ash	+ \$0
LM mahogany	+ \$0
76 light brown walnut	+ \$30
HX aged cherry	+ \$30

Squared-Edge Corner Wedge

Y2091.

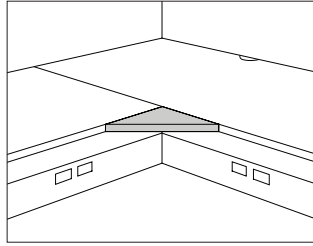

Specification Information

Step 1.

Y2091.

Step 2. Surface Material

L laminate

Prices for Steps 1-2.

Y2091. L \$100

Step 3. Top/Edge Finish

Solid-Color Laminate Top/Thermoplastic Edge

8Q	folkstone grey	+\$0
91	white	+\$0
HF	inner tone light	+\$0
HT	inner tone	+\$0
LT	light tone	+\$0
LU	soft white	+\$0
WL	sandstone	+\$0
WN	warm grey neutral	+\$0

Fiber Laminate Top/Thermoplastic Edge

1X	vanilla	+\$0
2X	wheat	+\$0
4X	coriander	+\$0
7X	cardamom	+\$0

Frosted Laminate Top/Thermoplastic Edge

J5	frosted inner tone light	+\$0
-----------	--------------------------	------

Wood-Grain Laminate Top/Thermoplastic Edge

HM	natural maple	+\$0
LA	light ash	+\$0
LM	mahogany	+\$0
76	light brown walnut	+\$30
HX	aged cherry	+\$30

Work Surface Support, Single

E2393.

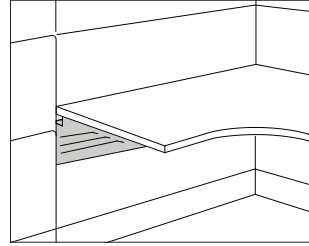

Specification Information

Step 1.

E2393.

Step 2. Work Surface Depth

24 for 20"- or 24"-deep surfaces
30 for 30"-deep surfaces

Step 3. Position

L left
R right

Prices for Steps 1-3.

	L	R
E2393. 24	\$30	30
30	\$34	34

Step 4. Surface Finish

BU	black umber	+\$0
HF	inner tone light	+\$0
LU	soft white	+\$0
MT	medium tone	+\$0
CN	metallic champagne	+\$10

Step 5. Support Option

SM	on module	+\$0
-----------	-----------	------

Work Surface Support Bracket

E2931.

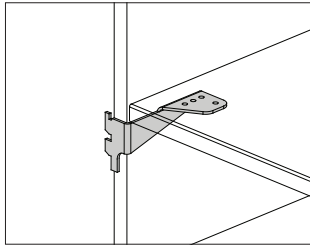

Specification Information

Step 1.

E2931.

Step 2. Position

- L** left
- R** right

Prices for Steps 1-2.

E2931. L	\$54
R	\$54

Step 3. Finish

BU black umber	+ \$0
HF inner tone light	+ \$0
LU soft white	+ \$0
MT medium tone	+ \$0

Work Surface Support Panel, End, Glides

E2290.

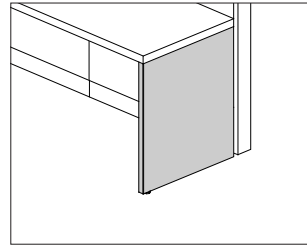

Specification Information

Step 1.

E2290.

Step 2. Depth

- 24** 24" deep
- 30** 30" deep

Step 3. Work Surface Edge

- S** squared-edge

Step 4. Surface Material

- L** laminate

Prices for Steps 1-4.

	L
E2290. 24 S	\$293
30 S	\$309

Step 5. Surface Finish

Solid-Color Laminate

BU black umber	+ \$0
HF inner tone light	+ \$0
LU soft white	+ \$0
MT medium tone	+ \$0

Step 6. Hardware Cover Finish

8Q folkstone grey	+ \$0
91 white	+ \$0
BU black umber	+ \$0
CL cool grey neutral	+ \$0
HF inner tone light	+ \$0
LU soft white	+ \$0
MT medium tone	+ \$0
SG slate grey	+ \$0
WL sandstone	+ \$0
WN warm grey neutral	+ \$0

Work Surface Support Panel,
Mid-Run, Glides

E2291.

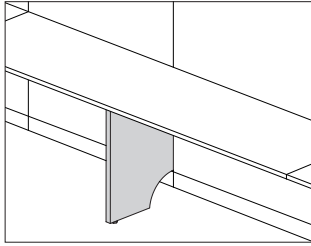

Specification Information

Step 1.

E2291.

Step 2. Size

20 for 24" and 30" deep surfaces

Step 3. Surface Material

L laminate

Prices for Steps 1-3.

	L
E2291. 20	\$295

Step 4. Surface Finish

BU black umber	+\$0
HF inner tone light	+\$0
LU soft white	+\$0
MT medium tone	+\$0

Step 5. Bracket Finish

BU black umber	+\$0
HF inner tone light	+\$0
LU soft white	+\$0
MT medium tone	+\$0

Stiffener

FV696.

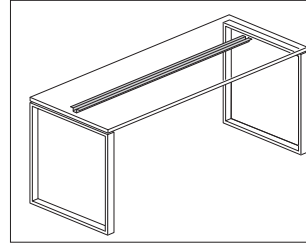

Specification Information

Step 1.

FV696.

Step 2. Width

34	33 ⁷ / ₈ " wide
39	38 ⁵ / ₈ " wide
43	43 ¹ / ₄ " wide
48	48" wide
57	57 ³ / ₈ " wide
62	62 ¹ / ₈ " wide
67	66 ³ / ₄ " wide
71	71 ¹ / ₂ " wide
81	80 ⁷ / ₈ " wide

Prices for Steps 1-2.

FV696. 34	\$66
39	\$68
43	\$68
48	\$68
57	\$68
62	\$68
67	\$68
71	\$68
81	\$68

Cord Cleat

G1331.

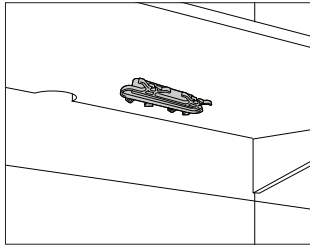

Specification Information

Step 1.

G1331.

\$17

Oval Transaction Surface

E2810.

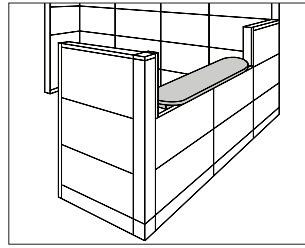

Specification Information

Step 1.

E2810.

Step 2. Width

34	34" wide
40	40" wide
58	58" wide

Step 3. Surface Material

L	laminate
----------	----------

Prices for Steps 1-3.

	L
E2810. 34	\$1113
40	\$1237
58	\$1480

Step 4. Laminate Top Finish/Natural Edge

Solid-Color Laminate Top/Natural Edge

HF	inner tone light	+\$0
HT	inner tone	+\$0
LU	soft white	+\$0

Fiber Laminate Top/Natural Edge

1X	vanilla	+\$0
4X	coriander	+\$0
7X	cardamom	+\$0

Frosted Laminate Top/Natural Edge

J5	frosted inner tone light	+\$0
-----------	--------------------------	------

Wood-Grain Laminate Top/Natural Edge

LA	light ash	+\$0
LM	mahogany	+\$0

Step 5. Support Finish

BU	black umber	+\$0
HF	inner tone light	+\$0

Squared-Edge Transaction
Surface, Rectangular End

E2812.

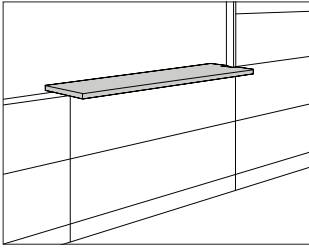

Ethospace® Work Surfaces

Specification Information

Step 1.

E2812.

Step 2. Width

24L	24" wide
30L	30" wide
36L	36" wide
42L	42" wide
48L	48" wide

Step 3. Finished End Cutout

N	no cutout
C	cutout on one end

Prices for Steps 1-3.

	N	C
E2812. 24L	\$198	238
30L	\$204	246
36L	\$221	262
42L	\$230	273
48L	\$236	280

Step 4. Top/Edge Finish

Solid-Color Laminate Top/Thermoplastic Edge

HF	inner tone light	+\$0
HT	inner tone	+\$0
LU	soft white	+\$0

Fiber Laminate Top/Thermoplastic Edge

1X	vanilla	+\$0
4X	coriander	+\$0
7X	cardamom	+\$0

Frosted Laminate Top/Thermoplastic Edge

J5	frosted inner tone light	+\$0
-----------	--------------------------	------

Wood-Grain Laminate Top/Thermoplastic Edge

LA	light ash	+\$0
LM	mahogany	+\$0

B-Style Flipper Door Unit

E3212.

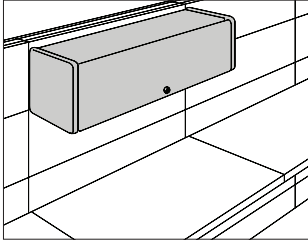

Specification Information

Step 1.

E321

Step 2. Depth/Door Material

2. 13" deep and painted or fabric door

Step 3. Width

- 24** 24" wide
- 30** 30" wide
- 36** 36" wide
- 42** 42" wide
- 48** 48" wide

Step 4. Door Material

- P** painted door
- F** fabric door

Step 5. Lock

For lock (), skip this step.*
lock

Prices for Steps 1-5.

	*
E3212. 24 P	\$406
F	\$419
30 P	\$429
F	\$442
36 P	\$463
F	\$476
42 P	\$497
F	\$511
48 P	\$526
F	\$539

Step 6. Lock Option

- KA** keyed alike +\$0
- KD** keyed differently +\$0

Step 7. Case Finish

- BU** black umber +\$0
- HF** inner tone light +\$0
- LU** soft white +\$0
- MT** medium tone +\$0
- CN** metallic champagne +\$40

Step 8. Door Finish

For 13" deep and painted or fabric door (2.) with painted door (P)

- BU** black umber +\$0
- HF** inner tone light +\$0
- LU** soft white +\$0
- MT** medium tone +\$0
- CN** metallic champagne +\$10

Step 9. End Panel Option

For 13" deep and painted or fabric door (2.)

- SM** for Ethospace® on module +\$0

Step 10. Door Finish

For 24" wide (24), 30" wide (30), 36" wide (36), 42" wide (42), or 48" wide (48) with fabric door (F)

See application chart and textiles list for fabric usage and numbers. First 2 digits of number indicate fabric line; remaining digit(s) indicate fabric color.

- Price Category 1 +\$0
- Price Category 2 +\$18
- Price Category 3 +\$37
- Price Category 4 +\$54

Ethospace® Storage

B-Style Flipper Door

E3217.

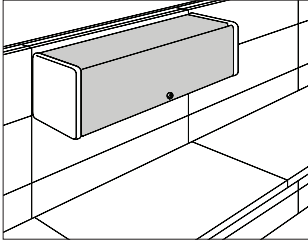

Ethospace® Storage

Specification Information

Step 1.

E321

Step 2. Depth/Door Material

7. 13" deep and painted or fabric

Step 3. Width

24 24" wide
30 30" wide
36 36" wide
42 42" wide
48 48" wide

Step 4. Door Material

P painted
F fabric

Step 5. Lock

For lock (), skip this step.*

lock

Prices for Steps 1-5.

*

E3217. 24 P	\$258
F	\$269
30 P	\$276
F	\$291
36 P	\$301
F	\$314
42 P	\$326
F	\$340
48 P	\$348
F	\$362

Step 6. Lock Option

KA keyed alike +\$0
KD keyed differently +\$0

Step 7. Top Finish

BU black umber +\$0
HF inner tone light +\$0
LU soft white +\$0
MT medium tone +\$0
CN metallic champagne +\$20

Step 8. Door Finish

See application chart and textiles list for fabric usage and numbers.

First 2 digits of number indicate fabric line; remaining digit(s) indicate fabric color.

For 24" wide (24), 30" wide (30), 36" wide (36), 42" wide (42), or 48" wide (48) with fabric (F)

Price Category 1	+\$0
Price Category 2	+\$18
Price Category 3	+\$37
Price Category 4	+\$54

For painted (P)

BU black umber	+\$0
HF inner tone light	+\$0
LU soft white	+\$0
MT medium tone	+\$0
CN metallic champagne	+\$10

B-Style Shelf

E3230.
E3231.

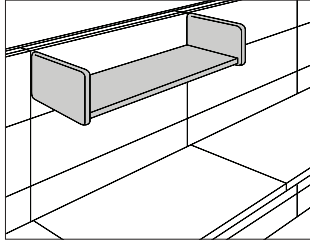

Specification Information

Step 1.

E323

Step 2. Height/Depth

- 0. 7½" high x 13" deep
- 1. 15½" high x 13" deep

Step 3. Width

- 24 24" wide
- 30 30" wide
- 36 36" wide
- 42 42" wide
- 48 48" wide

Prices for Steps 1-3.

E3230. 24	\$123
30	\$130
36	\$139
42	\$149
48	\$154
<hr/>	
E3231. 24	\$166
30	\$172
36	\$182
42	\$192
48	\$197

Step 4. Surface Finish

BU	black umber	+\$0
HF	inner tone light	+\$0
LU	soft white	+\$0
MT	medium tone	+\$0
CN	metallic champagne	+\$20

Step 5. End Panel Option

For 15½" high x 13" deep (1.)

SM	on module	+\$0
-----------	-----------	------

B-Style Storage/Display Shelf

E3232.

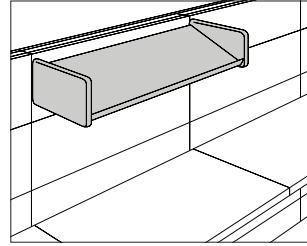

Specification Information

Step 1.

E3232.

Step 2. Width

- 24 24" wide
- 30 30" wide
- 36 36" wide
- 42 42" wide
- 48 48" wide

Prices for Steps 1-2.

E3232. 24	\$149
30	\$156
36	\$164
42	\$176
48	\$186

Step 3. Surface Finish

BU	black umber	+\$0
HF	inner tone light	+\$0
LU	soft white	+\$0
MT	medium tone	+\$0
CN	metallic champagne	+\$20

C-Style Flipper Door Unit

X3750.

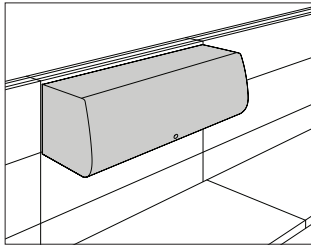

Ethospace® Storage

Specification Information

Step 1.

X3750.

Step 2. Width

24	24" wide
30	30" wide
36	36" wide
42	42" wide
48	48" wide

Step 3. Mechanism

SP standard mechanism

Step 4. Lift Handle

N no lift handle

Prices for Steps 1-4.

	N
X3750. 24 SP	\$512
30 SP	\$544
36 SP	\$577
42 SP	\$618
48 SP	\$662

Step 5. Lock Option

KA	keyed alike	+\$0
KD	keyed differently	+\$0

Step 6. Attachment Bracket

AO	for Action Office® system	+\$0
E1	for Ethospace® System	+\$0
F8	for Canvas	+\$0
OM	for Ethospace® off module	+\$0

Step 7. Case/Lift Handle Finish

8Q	folkstone grey	+\$0
91	white	+\$0
BU	black umber	+\$0
HF	inner tone light	+\$0
LT	light tone	+\$0
LU	soft white	+\$0
MT	medium tone	+\$0
WL	sandstone	+\$0
WN	warm grey neutral	+\$0
CN	metallic champagne	+\$40
EH	metallic bronze	+\$40

Step 8. Door Finish

8Q	folkstone grey	+\$0
91	white	+\$0
BU	black umber	+\$0
HF	inner tone light	+\$0
LT	light tone	+\$0
LU	soft white	+\$0
MT	medium tone	+\$0
WL	sandstone	+\$0
WN	warm grey neutral	+\$0
CN	metallic champagne	+\$10
EH	metallic bronze	+\$10

C-Style Flipper Door

X3710.

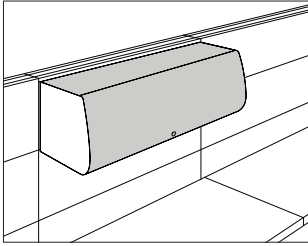

Specification Information

Step 1.

X3710.

Step 2. Width

24SP	24" wide
30SP	30" wide
36SP	36" wide
42SP	42" wide
48SP	48" wide

Step 3. Lift Handle

N no lift handle

Prices for Steps 1-3.

	N
X3710. 24SP	\$318
30SP	\$341
36SP	\$372
42SP	\$402
48SP	\$431

Step 4. Lock Option

KA	keyed alike	+\$0
KD	keyed differently	+\$0

Step 5. Top/Lift Handle Finish

8Q	folkstone grey	+\$0
91	white	+\$0
BU	black umber	+\$0
HF	inner tone light	+\$0
LT	light tone	+\$0
LU	soft white	+\$0
MT	medium tone	+\$0
WL	sandstone	+\$0
WN	warm grey neutral	+\$0
EH	metallic bronze	+\$20

Step 6. Door Finish

8Q	folkstone grey	+\$0
91	white	+\$0
BU	black umber	+\$0
HF	inner tone light	+\$0
LT	light tone	+\$0
LU	soft white	+\$0
MT	medium tone	+\$0
WL	sandstone	+\$0
WN	warm grey neutral	+\$0
EH	metallic bronze	+\$10

Ethospace® Storage

C-Style Shelf

X3730.

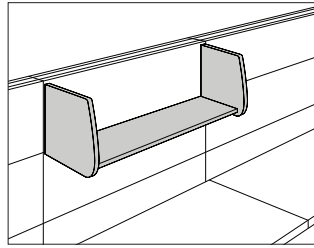

Specification Information

Step 1.
X3730.

Step 2. Width

24	24" wide
30	30" wide
36	36" wide
42	42" wide
48	48" wide

Prices for Steps 1-2.

X3730. 24	\$209
30	\$217
36	\$227
42	\$241
48	\$251

Step 3. Attachment Bracket

AO	for Action Office® system	+\$0
E1	for Ethospace® System	+\$0
F8	for Canvas	+\$0
OM	for Ethospace® off module	+\$0

Step 4. Surface Finish

8Q	folkstone grey	+\$0
91	white	+\$0
BU	black umber	+\$0
HF	inner tone light	+\$0
LT	light tone	+\$0
LU	soft white	+\$0
MT	medium tone	+\$0
WL	sandstone	+\$0
WN	warm grey neutral	+\$0
CN	metallic champagne	+\$20
EH	metallic bronze	+\$20

Ethospace® Storage

E-Style Flipper Door Unit

E3110.

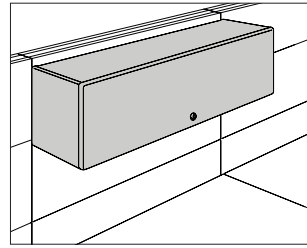

Specification Information

Step 1.
E3110.

Step 2. Width

24	24" wide
30	30" wide
36	36" wide
42	42" wide
48	48" wide

Step 3. Door Material

F	fabric door
----------	-------------

Prices for Steps 1-3.

	F
E3110. 24	\$481
30	\$519
36	\$559
42	\$594
48	\$632

Step 4. Lock Option

KA	keyed alike	+\$0
KD	keyed differently	+\$0

Step 5. Case Finish

BU	black umber	+\$0
HF	inner tone light	+\$0
LU	soft white	+\$0
MT	medium tone	+\$0
CN	metallic champagne	+\$40

Step 6. End Panel Option

SM	for Ethospace® on module	+\$0
-----------	--------------------------	------

Step 7. Door Finish

See application chart and textiles list for fabric usage and numbers.
First 2 digits of number indicate fabric line; remaining digit(s) indicate fabric color.

Price Category 1	+\$0
Price Category 2	+\$18
Price Category 3	+\$37
Price Category 4	+\$54

E-Style Flipper Door

E9002.

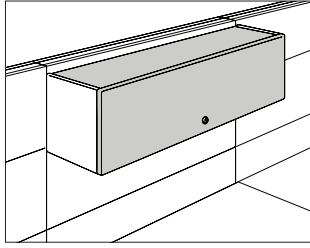

Specification Information

Step 1.

E9002.

Step 2. Width

24	24" wide
30	30" wide
36	36" wide
42	42" wide
48	48" wide

Step 3. Door Material

F fabric door

Prices for Steps 1-3.

	F
E9002. 24	\$310
30	\$335
36	\$360
42	\$382
48	\$407

Step 4. Lock Option

KA	keyed alike	+\$0
KD	keyed differently	+\$0

Step 5. Top Finish

BU	black umber	+\$0
HF	inner tone light	+\$0
LU	soft white	+\$0
MT	medium tone	+\$0
CN	metallic champagne	+\$20

Step 6. Door Finish

See application chart and textiles list for fabric usage and numbers. First 2 digits of number indicate fabric line; remaining digit(s) indicate fabric color.

Price Category 1	+\$0
Price Category 2	+\$18
Price Category 3	+\$37
Price Category 4	+\$54

E-Style Shelf

E3130.
E3133.

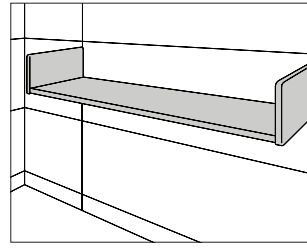

Specification Information

Step 1.

E313

Step 2. Height/Depth

0.	7 ¹ / ₂ " high x 13 ³ / ₄ " deep
3.	15 ¹ / ₂ " high x 13 ¹ / ₂ " deep

Step 3. Width

24	24" wide
30	30" wide
36	36" wide
42	42" wide
48	48" wide

Prices for Steps 1-3.

E3130. 24	\$201
30	\$217
36	\$232
42	\$243
48	\$253
<hr/>	
E3133. 24	\$236
30	\$255
36	\$273
42	\$292
48	\$308

Step 4. Surface Finish

BU	black umber	+\$0
HF	inner tone light	+\$0
LU	soft white	+\$0
MT	medium tone	+\$0
CN	metallic champagne	+\$20

Step 5. End Panel Option

For 15¹/₂" high x 13¹/₂" deep (3.)

SM	on module	+\$0
-----------	-----------	------

F-Style Sliding Door Storage Unit E3810.

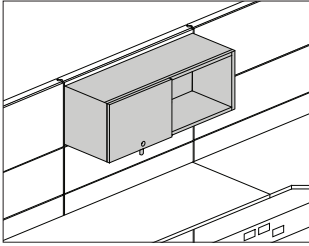

Ethospace® Storage

Specification Information

Step 1.
E3810.

Step 2. Height

1 15" high

Step 3. Width

24 24" wide
30 30" wide
36 36" wide
42 42" wide
48 48" wide

Step 4. Door Material

P painted door

Step 5. Lock

N no lock
L lock

Prices for Steps 1-5.

		PN	PL
E3810. 1	24	\$331	342
	30	\$351	362
	36	\$380	390
	42	\$408	419
	48	\$433	444

Step 6. Lock Option

For lock (L)

KA keyed alike +\$0
KD keyed differently, black +\$0

Step 7. Case Finish

BU black umber +\$0
HF inner tone light +\$0
LU soft white +\$0
MT medium tone +\$0
CN metallic champagne +\$40

Step 8. Door Finish

BU black umber +\$0
HF inner tone light +\$0
LU soft white +\$0
MT medium tone +\$0
CN metallic champagne +\$40

Step 9. Pull Finish

CL cool grey neutral +\$0
WN warm grey neutral +\$0

F-Style Upmount Sliding Door Storage Unit

E3814.

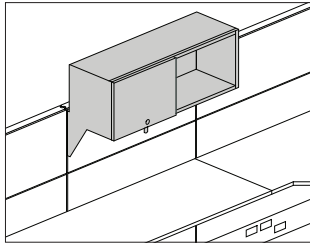

Specification Information

Step 1.

E3814.

Step 2. Width

24	24" wide
30	30" wide
36	36" wide
42	42" wide
48	48" wide

Step 3. Door Material

P painted door

Step 4. Lock

N	no lock
L	lock

Prices for Steps 1-4.

	N	L
E3814. 24 P	\$514	525
30 P	\$548	558
36 P	\$585	595
42 P	\$621	632
48 P	\$659	669

Step 5. Lock Option

For lock (L)

KA	keyed alike	+\$0
KD	keyed differently, black	+\$0

Step 6. Case Finish

BU	black umber	+\$0
HF	inner tone light	+\$0
LU	soft white	+\$0
MT	medium tone	+\$0
CN	metallic champagne	+\$40

Step 7. Door Finish

BU	black umber	+\$0
HF	inner tone light	+\$0
LU	soft white	+\$0
MT	medium tone	+\$0
CN	metallic champagne	+\$40

Step 8. Pull Finish

CL	cool grey neutral	+\$0
WN	warm grey neutral	+\$0

F-Style Shelf

E3811.

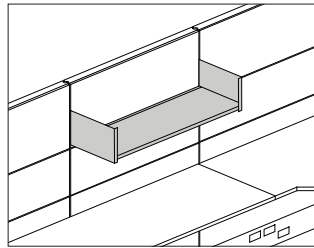

Specification Information

Step 1.

E3811.

Step 2. Width

24	24" wide
30	30" wide
36	36" wide
42	42" wide
48	48" wide

Prices for Steps 1-2.

E3811. 24	\$118
30	\$124
36	\$133
42	\$142
48	\$147

Step 3. Surface Finish

BU	black umber	+\$0
HF	inner tone light	+\$0
LU	soft white	+\$0
MT	medium tone	+\$0
CN	metallic champagne	+\$20

F-Style Storage Unit Back Panel

E3812.

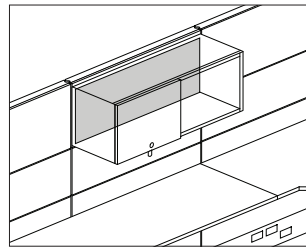

Specification Information

Step 1.

E3812.

Step 2. Height

15	15" high
-----------	----------

Step 3. Width

24	24" wide
30	30" wide
36	36" wide
42	42" wide
48	48" wide

Prices for Steps 1-3.

	24	30	36	42	48
E3812. 15	\$95	99	104	112	119

Step 4. Surface Finish

8Q	folkstone grey	+\$0
91	white	+\$0
BU	black umber	+\$0
HF	inner tone light	+\$0
LU	soft white	+\$0
MT	medium tone	+\$0
SG	slate grey	+\$0
WL	sandstone	+\$0
CN	metallic champagne	+\$20
EH	metallic bronze	+\$20
MS	metallic silver	+\$20

Component Brace

X3910.

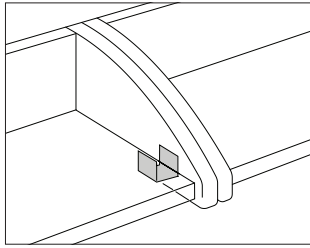

Specification Information

Step 1.

X3910.

Step 2. Usage

- 1** for C-/E-style flipper unit/shelf
- 2** for utility shelf (E3234.)

Prices for Steps 1-2.

X3910. 1	\$38
2	\$38

Step 3. Surface Finish

For C-/E-style flipper unit/shelf (1)

BU black umber	+ \$0
-----------------------	-------

Shelf Divider, Angled

G7330.

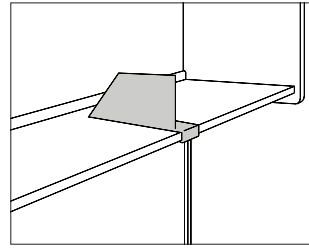

Specification Information

Step 1.

G7330.

\$228

Step 2. Surface Finish

8Q folkstone grey	+ \$0
91 white	+ \$0
BU black umber	+ \$0
HF inner tone light	+ \$0
LT light tone	+ \$0
LU soft white	+ \$0
MT medium tone	+ \$0
SG slate grey	+ \$0
WL sandstone	+ \$0
WN warm grey neutral	+ \$0
CN metallic champagne	+ \$5
EH metallic bronze	+ \$5

Ethospace® Storage

Coat Hook

E3922.

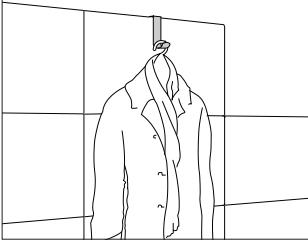

Specification Information

Step 1.
E3922. \$64

Step 2. Finish

BU black umber +\$0
HF inner tone light +\$0

Ethospace® Storage

Energy-Efficient Task Light

G6120.
G6121.
G6123.

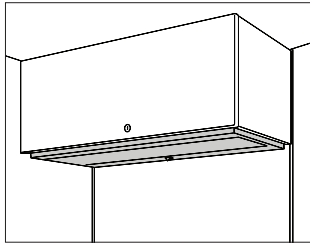

Specification Information

Step 1.

G612

Step 2. Code Requirements

- 0. meets local codes including Canada
- 1. meets Chicago codes
- 3. meets New York City codes

Step 3. Width

24	24" wide
30	30" wide
36	36" wide
42	42" wide
48	48" wide
60	60" wide

Step 4. Dimmer

For 24" wide (24)

N no dimmer

For 30" wide (30), 36" wide (36), 42" wide (42), 48" wide (48), or 60" wide (60)

N no dimmer
D 3-step dimmer

Step 5. Bracket Option

S for Action Office® or Ethospace® Systems or Canvas
Q for C-style storage or E3234.
P for Passage® Desking System

Prices for Steps 1-5.

	S	Q	P
G6120. 24 N	\$293	293	293
30 N	\$303	303	303
D	\$333	333	333
36 N	\$311	311	311
D	\$342	342	342
42 N	\$325	325	325
D	\$356	356	356
48 N	\$332	332	332
D	\$364	364	364
60 N	\$363	363	363
D	\$400	400	400
G6121. 24 N	\$335	335	335

30 N	\$352	352	352
D	\$383	383	383
36 N	\$359	359	359
D	\$396	396	396
42 N	\$369	369	369
D	\$406	406	406
48 N	\$377	377	377
D	\$413	413	413
60 N	\$411	411	411
D	\$453	453	453
G6123. 24 N	\$290	290	290
30 N	\$315	315	315
D	\$348	348	348
36 N	\$324	324	324
D	\$355	355	355
42 N	\$332	332	332
D	\$364	364	364
48 N	\$341	341	341
D	\$375	375	375
60 N	\$375	375	375
D	\$411	411	411

Step 6. Surface Finish

For Action Office® or Ethospace® Systems or Canvas (S) or C-style storage or E3234. (Q)

8Q	folkstone grey	+\$0
91	white	+\$0
BU	black umber	+\$0
CL	cool grey neutral	+\$0
HF	inner tone light	+\$0
LT	light tone	+\$0
LU	soft white	+\$0
MT	medium tone	+\$0
WL	sandstone	+\$0
WN	warm grey neutral	+\$0
EH	metallic bronze	+\$15

For Passage® Desking System (P)

BU	black umber	+\$0
-----------	-------------	------

Ethospace® Lighting

Utility Task Light

G6136.
G6137.

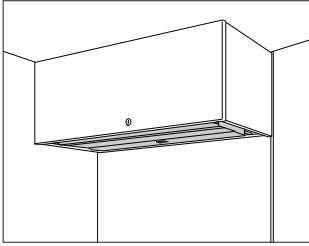

Specification Information

Step 1.

G613

Step 2. Code Requirements

- 6. meets local codes including Canada and New York City
- 7. meets Chicago codes

Step 3. Width

- 24 24" wide
- 30 30" wide
- 42 42" wide
- 60 60" wide

Step 4. Attachment Bracket

- S** for Action Office® or Ethospace® Systems or Canvas
- Q** for C-style storage or E3234.
- P** for Passage® Desking System
- F** for 5000 Series Furniture
- T** for transaction surface/counter top/wood cabinets

Prices for Steps 1-4.

	S	Q	P	F	T
G6136. 24	\$215	215	215	215	215
30	\$219	219	219	219	219
42	\$241	241	241	241	241
60	\$267	267	267	267	267
G6137. 24	\$290	290	290	290	290
30	\$294	294	294	294	294
42	\$315	315	315	315	315
60	\$344	344	344	344	344

Tool Bar

E3610.

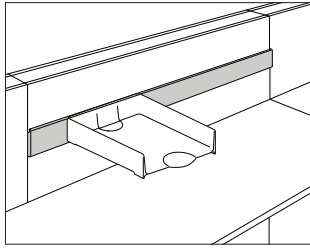

Specification Information

Step 1.

E3610.

Step 2. Width

- 24** 24" wide
- 30** 30" wide
- 36** 36" wide
- 42** 42" wide
- 48** 48" wide

Prices for Steps 1-2.

E3610. 24	\$62
30	\$71
36	\$82
42	\$91
48	\$98

Step 3. Surface Finish

BU black umber	+ \$0
HF inner tone light	+ \$0
LU soft white	+ \$0
MT medium tone	+ \$0
CN metallic champagne	+ \$10

B-Pull

F-Pull



B-Pull Freestanding Pedestal

G5120.
G5130.

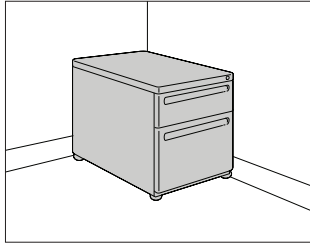

Specification Information

Step 1.

G51

Step 2. Configuration

- 30.** file/file
- 20.** box/box/file

Step 3. Depth

- 19** 20" deep
- 24** 24" deep
- 28** 28" deep

Prices for Steps 1-3.

G5130. 19	\$935
24	\$1028
28	\$1129
<hr/>	
G5120. 19	\$971
24	\$1067
28	\$1173

Step 4. Surface Finish

8Q folkstone grey	+ \$0
BU black umber	+ \$0
HF inner tone light	+ \$0
LT light tone	+ \$0
LU soft white	+ \$0
MT medium tone	+ \$0

Step 5. Lock Option

KA keyed alike	+ \$0
KD keyed differently	+ \$0

B-Pull Mobile Pedestal

G5121.
G5131.

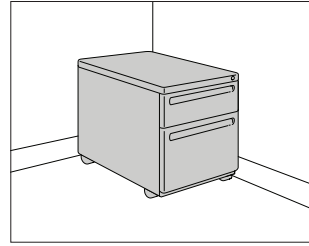

Specification Information

Step 1.

G51

Step 2. Configuration

- 31.** file/file
- 21.** box/box/file

Step 3. Depth

- 19** 20" deep
- 24** 24" deep

Prices for Steps 1-3.

G5131. 19	\$989
24	\$1037
<hr/>	
G5121. 19	\$1059
24	\$1111

Step 4. Surface Finish

8Q folkstone grey	+ \$0
BU black umber	+ \$0
HF inner tone light	+ \$0
LT light tone	+ \$0
LU soft white	+ \$0
MT medium tone	+ \$0

Step 5. Lock Option

KA keyed alike	+ \$0
KD keyed differently	+ \$0

B-Pull Suspended Pedestal

G5112.

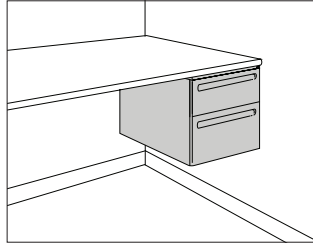

B-Pull Support Pedestal

G5150.
G5151.

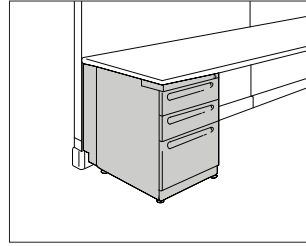

Quadrant® B-Pull Pedestals

Specification Information

Step 1.
G5112.19 \$646

Step 2. Surface Finish		
8Q	folkstone grey	+\$0
BU	black umber	+\$0
HF	inner tone light	+\$0
LT	light tone	+\$0
LU	soft white	+\$0
MT	medium tone	+\$0

Step 3. Lock Option		
KA	keyed alike	+\$0
KD	keyed differently	+\$0

Specification Information

Step 1.
G515

Step 2. Configuration		
0.	file/file	
1.	box/box/file	

Step 3. Depth		
19	20" deep for 24"-deep work surface	
30	28" deep for 30"-deep work surface	

Prices for Steps 1-3.		
G5150. 19		\$1061
30		\$1221
<hr/>		
G5151. 19		\$1077
30		\$1234

Step 4. Surface Finish		
8Q	folkstone grey	+\$0
BU	black umber	+\$0
HF	inner tone light	+\$0
LT	light tone	+\$0
LU	soft white	+\$0
MT	medium tone	+\$0

Step 5. Lock Option		
KA	keyed alike	+\$0
KD	keyed differently	+\$0

Step 6. Attachment Bracket		
1A	for Action Office® Series 1 and 2 radiused-edge work surface	+\$0
2A	for Action Office® Series 1 and 2 squared-edge work surface	+\$0
E1	for Ethospace® System	+\$0

F-Pull Freestanding Pedestal

FAF10.

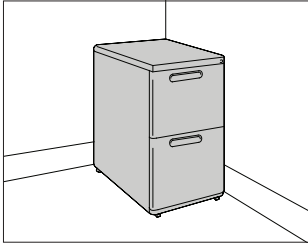

Specification Information

Step 1.
FAF10.

Step 2. Depth

2015	20" deep
2415	24" deep
2815	28" deep

Step 3. Configuration

For 20" deep (2015)

B	file/file
F	box/box/file

For 24" deep (2415)

B	file/file
F	box/box/file

For 28" deep (2815)

B	file/file
F	box/box/file

Prices for Steps 1-3.

	B	F
FAF10. 2015	\$710	747
2415	\$745	829
2815	\$823	910

Step 4. Surface Finish

8Q	folkstone grey	+\$0
BU	black umber	+\$0
HF	inner tone light	+\$0
LT	light tone	+\$0
LU	soft white	+\$0
MT	medium tone	+\$0
CN	metallic champagne	+\$40
MS	metallic silver	+\$40

Step 5. Pull Orientation

SI	standard	+\$0
-----------	----------	------

Step 6. Pull Finish

8Q	folkstone grey	+\$0
BU	black umber	+\$0
HF	inner tone light	+\$0
LT	light tone	+\$0
LU	soft white	+\$0
MT	medium tone	+\$0

Step 7. Lock Option

KA	keyed alike	+\$0
KD	keyed differently	+\$0

Step 8. Base Option

1F	standard height	+\$0
-----------	-----------------	------

Quadrant® F-Pull Pedestals

F-Pull Mobile Pedestal

FAF11.

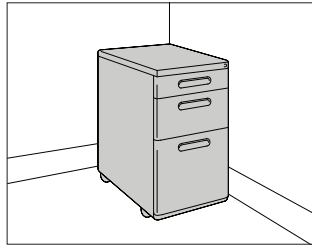

Specification Information

Step 1.

FAF11.

Step 2. Depth

2015 20" deep

2415 24" deep

Step 3. Configuration

For 20" deep (2015)

B file/file

F box/box/file

For 24" deep (2415)

B file/file

F box/box/file

Prices for Steps 1-3.

	B	F
FAF11. 2015	\$807	876
2415	\$847	921

Step 4. Surface Finish

8Q folkstone grey +\$0

BU black umber +\$0

HF inner tone light +\$0

LT light tone +\$0

LU soft white +\$0

MT medium tone +\$0

CN metallic champagne +\$40

MS metallic silver +\$40

Step 5. Pull Orientation

SI standard +\$0

Step 6. Pull Finish

8Q folkstone grey +\$0

BU black umber +\$0

HF inner tone light +\$0

LT light tone +\$0

LU soft white +\$0

MT medium tone +\$0

Step 7. Lock Option

KA keyed alike +\$0

KD keyed differently +\$0

Quadrant® F-Pull Pedestals

F-Pull Suspended Pedestal

FAF12.

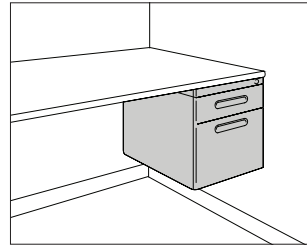

Specification Information

Step 1.

FAF12.2015

Step 2. Configuration

A box/file

Prices for Steps 1-2.

FAF12.2015 A \$539

Step 3. Surface Finish

8Q folkstone grey +\$0

BU black umber +\$0

HF inner tone light +\$0

LT light tone +\$0

LU soft white +\$0

MT medium tone +\$0

CN metallic champagne +\$40

MS metallic silver +\$40

Step 4. Pull Orientation

SI standard +\$0

Step 5. Pull Finish

8Q folkstone grey +\$0

BU black umber +\$0

HF inner tone light +\$0

LT light tone +\$0

LU soft white +\$0

MT medium tone +\$0

Step 6. Lock Option

KA keyed alike +\$0

KD keyed differently +\$0

F-Pull Support Pedestal

FAF13.

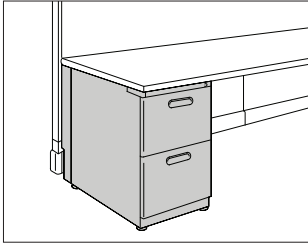

Specification Information

Step 1.

FAF13.

Step 2. Depth

2015 20" deep for 24"-deep work surface

3015 28" deep for 30"-deep work surface

Step 3. Configuration

B file/file

F box/box/file

Prices for Steps 1-3.

	B	F
FAF13. 2015	\$828	879
3015	\$913	1016

Step 4. Surface Finish

8Q	folkstone grey	+\$0
BU	black umber	+\$0
HF	inner tone light	+\$0
LT	light tone	+\$0
LU	soft white	+\$0
MT	medium tone	+\$0
CN	metallic champagne	+\$40
MS	metallic silver	+\$40

Step 5. Pull Orientation

SI	standard	+\$0
-----------	----------	------

Step 6. Pull Finish

8Q	folkstone grey	+\$0
BU	black umber	+\$0
HF	inner tone light	+\$0
LT	light tone	+\$0
LU	soft white	+\$0
MT	medium tone	+\$0

Step 7. Lock Option

KA	keyed alike	+\$0
KD	keyed differently	+\$0

Step 8. Attachment Bracket

1A	for Action Office® Series 1 and 2 radiused-edge work surface	+\$0
2A	for Action Office® Series 1 and 2 squared-edge work surface	+\$0
E1	for Ethospace® System	+\$0

Quadrant® F-Pull Pedestals



Standard-Pull Freestanding Pedestal

F16-1

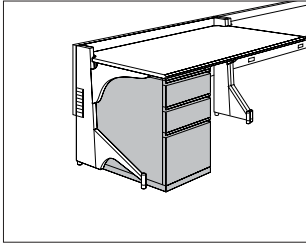

Specification Information

Step 1.

F16-

Step 2. Width

15 15" wide

Step 3. Depth

18- 18" deep

22- 22" deep

28- 28" deep

Step 4. Configuration

FF file/file

BBF box/box/file

Prices for Steps 1-4.

		FF	BBF
F16-15	18-	\$634	663
	22-	\$659	686
	28-	\$675	713

Step 5. Paint/Steel Type

TS smooth paint on textured steel +\$0

Step 6. Surface Finish

Nonmetallic Paint

For smooth paint on textured steel (TS)

BU	black umber	+\$0
G2	graphite satin	+\$0
HF	inner tone light	+\$0
HT	inner tone	+\$0
LT	light tone	+\$0
LU	soft white	+\$0
MT	medium tone	+\$0
SG	slate grey	+\$0

Step 7. Top

Ethospace® Pedestal Top (TE3) available only on 15"-wide, 22"- or 28"-deep pedestals.

T1	1"-high painted metal top with squared edge	+\$0
T2	1 1/4"-high painted metal top with squared edge	+\$0

Step 8. Lock

For 18" deep (18-) AND 22" deep (22-)

KA	keyed alike	+\$0
KC	keyed differently, chrome	+\$0
KD	keyed differently, black	+\$0

Step 9. Base Height

B1	1"-high base	+\$0
B2	1 1/2"-high base	+\$0
B3	2 1/4"-high base	+\$0
B4	3 1/4"-high base	+\$0

Step 10. Counterweight

NO	no counterweight	+\$0
CB	counterweight	+\$88

Step 11. Compressor

C	standard compressor	+\$0
----------	---------------------	------

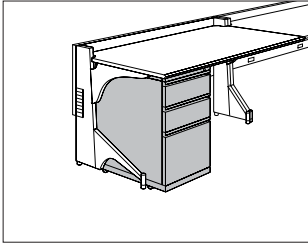

Meridian® Pedestals

Specification Information

Step 1.

M16-

Step 2. Width

15 15" wide

Step 3. Depth

18- 18" deep

22- 22" deep

28- 28" deep

Step 4. Configuration

BF box/file

FF file/file

BBF box/box/file

Prices for Steps 1-4.

	BF	FF	BBF
M16-15 18-	\$675	774	802
22-	\$692	796	826
28-	\$717	832	851

Step 5. Paint/Steel Type

TS smooth paint on textured steel +\$0

Step 6. Surface Finish

Nonmetallic Paint

For smooth paint on textured steel (TS)

BU black umber +\$0

G2 graphite satin +\$0

HF inner tone light +\$0

HT inner tone +\$0

LT light tone +\$0

LU soft white +\$0

MT medium tone +\$0

SG slate grey +\$0

Step 7. Top

T1 1"-high painted metal top with squared edge +\$0

T2 1 1/4"-high painted metal top with squared edge +\$0

Step 8. Lock

KA keyed alike +\$0

KC keyed differently, chrome +\$0

KD keyed differently, black +\$0

Step 9. Handle

HN no hand grip or transit handle +\$0

Step 10. Compressor

C standard compressor +\$0

Standard-Pull Suspended Pedestal

S16-1

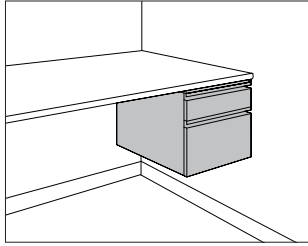

Specification Information

Step 1.

S16-

Step 2. Width

15 15" wide

Step 3. Depth

22- 22" deep

28- 28" deep

Step 4. Configuration

BF box/file

Prices for Steps 1-4.

	BF
S16-15 22-	\$493
28-	\$507

Step 5. Paint/Steel Type

TS smooth paint on textured steel +\$0

Step 6. Surface Finish

Nonmetallic Paint

For smooth paint on textured steel (TS)

BU black umber	+\$0
G2 graphite satin	+\$0
HF inner tone light	+\$0
HT inner tone	+\$0
LT light tone	+\$0
LU soft white	+\$0
MT medium tone	+\$0
SG slate grey	+\$0

Step 7. Lock

KA keyed alike +\$0

KC keyed differently, chrome +\$0

KD keyed differently, black +\$0

Step 8. Base Height

NB no base +\$0

Step 9. Compressor

For 22" deep (22-) or 28" deep (28-) with box/file (BF)

C standard compressor +\$0

Sloped-Pull Freestanding Pedestal

F19P-

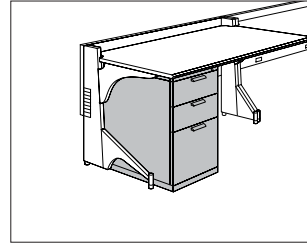

Specification Information

Step 1.

F19

Step 2. Front Material

P-15 painted metal front

Step 3. Depth

18- 18" deep

22- 22" deep

Step 4. Configuration

FF file/file

BBF box/box/file

Prices for Steps 1-4.

	FF	BBF
F19P-15 18-	\$634	663
22-	\$659	686

Step 5. Paint/Steel Type

TS smooth paint on textured steel +\$0

Step 6. Surface Finish

Nonmetallic Paint

For smooth paint on textured steel (TS)

BU black umber	+\$0
G2 graphite satin	+\$0
HF inner tone light	+\$0
HT inner tone	+\$0
LT light tone	+\$0
LU soft white	+\$0
MT medium tone	+\$0
SG slate grey	+\$0

Step 7. Top

Ethospace® Pedestal Top (TE3) available only on 15"-wide, 22"- or 28"-deep pedestals.

T1 1"-high painted metal top with squared edge +\$0

T2 1 1/4"-high painted metal top with squared edge +\$0

Sloped-Pull Freestanding Pedestal *continued*

Step 8. Lock

For 1"-high painted metal top with squared edge (T1) or 1 1/4"-high painted metal top with squared edge (T2)

KA	keyed alike	+\$0
KC	keyed differently, chrome	+\$0
KD	keyed differently, black	+\$0

Step 9. Pull Finish

G2	graphite satin	+\$0
-----------	----------------	------

Step 10. Base Height

B1	1"-high base	+\$0
B2	1 1/2"-high base	+\$0
B3	2 1/4"-high base	+\$0
B4	3 1/4"-high base	+\$0

Step 11. Counterweight

NO	no counterweight	+\$0
CB	counterweight	+\$88

Step 12. Compressor

C	standard compressor	+\$0
----------	---------------------	------

Sloped-Pull Mobile Pedestal

M19P-

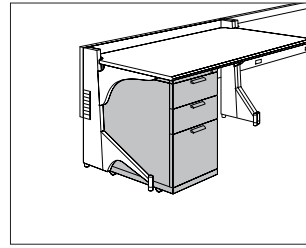

Specification Information

Step 1.

M19

Step 2. Front Material

P-15 painted metal front

Step 3. Depth

18-	18" deep
22-	22" deep

Step 4. Configuration

FF	file/file
BF	box/file
BBF	box/box/file

Prices for Steps 1-4.

	FF	BF	BBF
M19P-15 18-	\$774	675	802
22-	\$796	692	826

Step 5. Paint/Steel Type

TS	smooth paint on textured steel	+\$0
-----------	--------------------------------	------

Step 6. Surface Finish

Nonmetallic Paint

For smooth paint on textured steel (TS)

BU	black umber	+\$0
G2	graphite satin	+\$0
HF	inner tone light	+\$0
HT	inner tone	+\$0
LT	light tone	+\$0
LU	soft white	+\$0
MT	medium tone	+\$0
SG	slate grey	+\$0

Step 7. Top

T1	1"-high painted metal top with squared edge	+\$0
T2	1 1/4"-high painted metal top with squared edge	+\$0

Step 8. Lock

KA	keyed alike	+\$0
KC	keyed differently, chrome	+\$0
KD	keyed differently, black	+\$0

Sloped-Pull Mobile Pedestal

continued

Step 9. Handle		
HN	no hand grip or transit handle	+\$0
Step 10. Pull Finish		
G2	graphite satin	+\$0
Step 11. Compressor		
C	standard compressor	+\$0

Pencil Tray for Box Drawer, Meridian® Pedestal

73-15

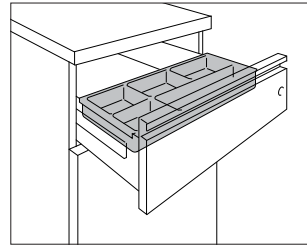

Specification Information

Step 1.

73-

Step 2. Width

1516-PT for 15"-wide drawer (for Meridian® pedestals and 5000 Series furniture)

Prices for Steps 1-2.

73-1516-PT

\$20

Meridian® Pedestals

Drawer Divider for Box Drawer,
Meridian® Pedestal

73-15

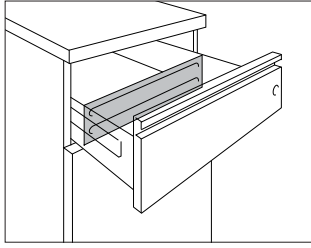

Meridian® Pedestals

Specification Information

Step 1.

73-

Step 2. Width

1567-D for 15"-wide drawer (for Meridian® pedestals and 5000 Series furniture)

Prices for Steps 1-2.

73-1567-D

\$14

File Drawer Organizer

LG901

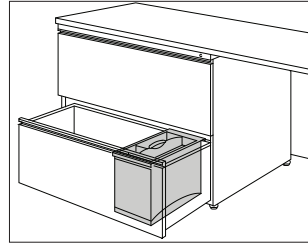

Specification Information

Step 1.

LG901

\$68





W-Pull Freestanding Pedestal

LW100.

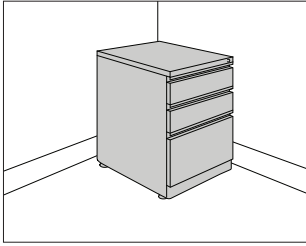

Specification Information

Step 1.
LW100.

Step 2. Depth

20	20" deep
24	24" deep
28	28" deep

Step 3. Configuration

BBF	box/box/file
FF	file/file

Prices for Steps 1-3.

	BBF	FF
LW100. 20	\$523	480
24	\$536	493
28	\$601	554

Step 4. Slides

For box/box/file (BBF)

SR	3/4-extension roller slides on box drawer, full-extension ball bearing on file drawer	+\$0
-----------	---	------

For file/file (FF)

SB	full-extension ball-bearing	+\$0
-----------	-----------------------------	------

Step 5. Paint/Steel Type

SS	smooth paint on smooth steel	+\$0
XS	textured paint on smooth steel	+\$0

Step 6. Surface Finish

For smooth paint on smooth steel (SS)

8Q	folkstone grey	+\$0
BU	black umber	+\$0
HF	inner tone light	+\$0
LT	light tone	+\$0
LU	soft white	+\$0
MT	medium tone	+\$0
WL	sandstone	+\$0
CN	metallic champagne	+\$40
EH	metallic bronze	+\$40
MS	metallic silver	+\$40

Bright Sand Texture Paint
For textured paint on smooth steel (XS)

91	white	+\$0
CL	cool grey neutral	+\$0
WN	warm grey neutral	+\$0

Step 7. Lock

KA	keyed alike	+\$0
KC	keyed differently, chrome	+\$0
KD	keyed differently, black	+\$0

Step 8. Base Height

1F	standard height	+\$0
2F	raised height	+\$0

Step 9. Drawer Interior

For box/box/file (BBF)

NN	none	+\$0
3M	drawer divider in one box drawer, pencil tray in one box drawer, 2 file converters in file drawer	+\$25

For file/file (FF)

NN	none	+\$0
1M	2 file converters in each file drawer	+\$25

Tur Pedestals

V-Pull Freestanding Pedestal

LV100.

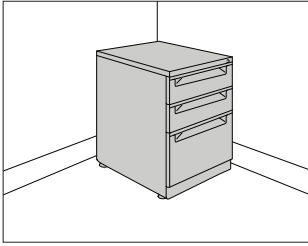

Til® Pedestals

Specification Information

Step 1.

LV100.

Step 2. Depth

20	20" deep
24	24" deep
28	28" deep

Step 3. Configuration

BBF	box/box/file
FF	file/file

Prices for Steps 1-3.

	BBF	FF
LV100. 20	\$543	500
24	\$559	512
28	\$626	575

Step 4. Slides

For 20" deep (20) with box/box/file (BBF)

SR	$\frac{3}{4}$ -extension roller slides on box drawer, full-extension ball bearing on file drawer	+\$0
SB	full-extension ball-bearing	+\$50

For 24" deep (24) or 28" deep (28) with box/box/file (BBF)

SR	$\frac{3}{4}$ -extension roller slides on box drawer, full-extension ball bearing on file drawer	+\$0
-----------	--	------

For file/file (FF)

SB	full-extension ball-bearing	+\$0
-----------	-----------------------------	------

Step 5. Paint/Steel Type

SS	smooth paint on smooth steel	+\$0
XS	textured paint on smooth steel	+\$0

Step 6. Surface Finish

For smooth paint on smooth steel (SS)

8Q	folkstone grey	+\$0
BU	black umber	+\$0
HF	inner tone light	+\$0
LT	light tone	+\$0
LU	soft white	+\$0
MT	medium tone	+\$0
WL	sandstone	+\$0
CN	metallic champagne	+\$40
EH	metallic bronze	+\$40
MS	metallic silver	+\$40

Bright Sand Texture Paint

For textured paint on smooth steel (XS)

91	white	+\$0
CL	cool grey neutral	+\$0
WN	warm grey neutral	+\$0

Step 7. Lock

KA	keyed alike	+\$0
KC	keyed differently, chrome	+\$0
KD	keyed differently, black	+\$0

Step 8. Base Height

1F	standard height	+\$0
2F	raised height	+\$0

Step 9. Drawer Interior

For box/box/file (BBF)

NN	none	+\$0
3M	drawer divider in one box drawer, pencil tray in one box drawer, 2 file converters in file drawer	+\$25

For file/file (FF)

NN	none	+\$0
1M	2 file converters in each file drawer	+\$25

W-Pull Mobile Pedestal

LW110.

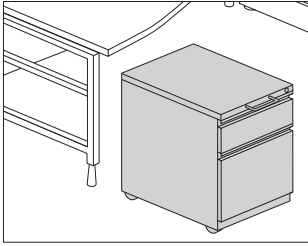

Specification Information

Step 1.

LW110.

Step 2. Depth

20	20" deep
24	24" deep

Step 3. Configuration

For 20" deep (20)

BBF	box/box/file
BF	box/file
FF	file/file

For 24" deep (24)

BBF	box/box/file
FF	file/file

Prices for Steps 1-3.

	BBF	BF	FF
LW110. 20	\$570	480	517
24	\$575	—	525

Step 4. Slides

For box/box/file (BBF)

SR	3/4-extension roller slides on box drawer, full-extension ball bearing on file drawer	+\$0
SB	full-extension ball-bearing	+\$50

For box/file (BF)

SR	3/4-extension roller slides on box drawer, full-extension ball bearing on file drawer	+\$0
-----------	---	------

For file/file (FF)

SB	full-extension ball-bearing	+\$0
-----------	-----------------------------	------

Step 5. Paint/Steel Type

SS	smooth paint on smooth steel	+\$0
XS	textured paint on smooth steel	+\$0

Step 6. Surface Finish

For smooth paint on smooth steel (SS)

8Q	folkstone grey	+\$0
BU	black umber	+\$0
HF	inner tone light	+\$0
LT	light tone	+\$0
LU	soft white	+\$0
MT	medium tone	+\$0
WL	sandstone	+\$0
CN	metallic champagne	+\$40
EH	metallic bronze	+\$40
MS	metallic silver	+\$40

Bright Sand Texture Paint

For textured paint on smooth steel (XS)

91	white	+\$0
CL	cool grey neutral	+\$0
WN	warm grey neutral	+\$0

Step 7. Lock

KA	keyed alike	+\$0
KC	keyed differently, chrome	+\$0
KD	keyed differently, black	+\$0

Step 8. Drawer Interior

For box/box/file (BBF)

NN	none	+\$0
3M	drawer divider in one box drawer, pencil tray in one box drawer, 2 file converters in file drawer	+\$25

For box/file (BF)

NN	none	+\$0
5M	pencil tray in box drawer, 2 file converters in file drawer	+\$20

For file/file (FF)

NN	none	+\$0
1M	2 file converters in each file drawer	+\$25

Step 9. Handle

HN	no hand grip	+\$0
H1	hand grip only	+\$48

V-Pull Mobile Pedestal

LV110.

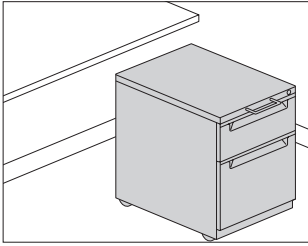

Tu® Pedestals

Specification Information

Step 1.

LV110.

Step 2. Depth

20	20" deep
24	24" deep

Step 3. Configuration

For 20" deep (20)

BBF	box/box/file
BF	box/file
FF	file/file

For 24" deep (24)

BBF	box/box/file
FF	file/file

Prices for Steps 1-3.

	BBF	BF	FF
LV110. 20	\$593	500	538
24	\$598	—	545

Step 4. Slides

For box/box/file (BBF) or box/file (BF)

SR	$\frac{3}{4}$ "-extension roller slides on box drawer, full-extension ball bearing on file drawer	+\$0
-----------	---	------

For file/file (FF)

SB	full-extension ball-bearing	+\$0
-----------	-----------------------------	------

Step 5. Paint/Steel Type

SS	smooth paint on smooth steel	+\$0
XS	textured paint on smooth steel	+\$0

Step 6. Surface Finish

For smooth paint on smooth steel (SS)

8Q	folkstone grey	+\$0
BU	black umber	+\$0
HF	inner tone light	+\$0
LT	light tone	+\$0
LU	soft white	+\$0
MT	medium tone	+\$0
WL	sandstone	+\$0
CN	metallic champagne	+\$40
EH	metallic bronze	+\$40
MS	metallic silver	+\$40

Bright Sand Texture Paint

For textured paint on smooth steel (XS)

91	white	+\$0
CL	cool grey neutral	+\$0
WN	warm grey neutral	+\$0

Step 7. Lock

KA	keyed alike	+\$0
KC	keyed differently, chrome	+\$0
KD	keyed differently, black	+\$0

Step 8. Drawer Interior

For box/box/file (BBF)

NN	none	+\$0
3M	drawer divider in one box drawer, pencil tray in one box drawer, 2 file converters in file drawer	+\$25

For box/file (BF)

NN	none	+\$0
5M	pencil tray in box drawer, 2 file converters in file drawer	+\$20

For file/file (FF)

NN	none	+\$0
1M	2 file converters in each file drawer	+\$25

Step 9. Handle

HN	no hand grip	+\$0
H1	hand grip only	+\$48

W-Pull Surface-Attached Pedestal LW140.

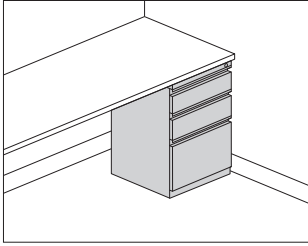

Specification Information

Step 1.

LW140.

Step 2. Depth

24 24" deep

28 28" deep

Step 3. Configuration

BBF box/box/file

FF file/file

Prices for Steps 1-3.

	BBF	FF
LW140. 24	\$486	443
28	\$567	521

Step 4. Slides

	24BBF	24FF	28BBF	28FF
SB full-extension ball-bearing	+\$50	50	0	0

Step 5. Paint/Steel Type

SS smooth paint on smooth steel +\$0

XS textured paint on smooth steel +\$0

Step 6. Surface Finish

For smooth paint on smooth steel (SS)

8Q folkstone grey	+\$0
BU black umber	+\$0
HF inner tone light	+\$0
LT light tone	+\$0
LU soft white	+\$0
MT medium tone	+\$0
WL sandstone	+\$0
CN metallic champagne	+\$40
EH metallic bronze	+\$40
MS metallic silver	+\$40

Bright Sand Texture Paint

For textured paint on smooth steel (XS)

91 white	+\$0
CL cool grey neutral	+\$0
WN warm grey neutral	+\$0

Step 7. Lock

KA keyed alike +\$0

KD keyed differently, black +\$0

KC keyed differently, chrome +\$0

Step 8. Base Height

2F 27¹/₄" high (raised height) +\$0

Step 9. Drawer Interior

For box/box/file (BBF)

NN none +\$0

3M drawer divider in one box drawer, pencil tray in one box drawer, 2 file converters in file drawer +\$25

For file/file (FF)

NN none +\$0

1M 2 file converters in each file drawer +\$25

W-Pull Support Pedestal

LW150.

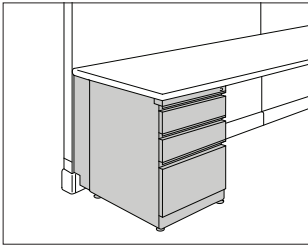

Tu® Pedestals

Specification Information

Step 1.

LW150.

Step 2. Depth

20	20" deep
24	24" deep
28	28" deep

Step 3. Configuration

BBF	box/box/file
FF	file/file

Prices for Steps 1-3.

	BBF	FF
LW150. 20	\$542	502
24	\$567	540
28	\$598	572

Step 4. Slides

For box/box/file (BBF)

SR	$\frac{3}{4}$ -extension roller slides on box drawer, full-extension ball bearing on file drawer	+\$0
-----------	--	------

For file/file (FF)

SB	full-extension ball-bearing	+\$0
-----------	-----------------------------	------

Step 5. Paint/Steel Type

SS	smooth paint on smooth steel	+\$0
XS	textured paint on smooth steel	+\$0

Step 6. Surface Finish

For smooth paint on smooth steel (SS)

8Q	folkstone grey	+\$0
BU	black umber	+\$0
HF	inner tone light	+\$0
LT	light tone	+\$0
LU	soft white	+\$0
MT	medium tone	+\$0
WL	sandstone	+\$0
CN	metallic champagne	+\$40
EH	metallic bronze	+\$40
MS	metallic silver	+\$40

Bright Sand Texture Paint

For textured paint on smooth steel (XS)

91	white	+\$0
CL	cool grey neutral	+\$0
WN	warm grey neutral	+\$0

Step 7. Attachment Bracket

For smooth paint on smooth steel (SS)

1A	for Action Office® Series 1 and 2 radiused-edge work surface	+\$0
2A	for Action Office® Series 1 and 2 squared-edge work surface	+\$0
E1	for Ethospace® System	+\$0
F8	for Canvas Office Landscape®	+\$0

For textured paint on smooth steel (XS)

1A	for Action Office® Series 1 and 2 radiused-edge work surface	+\$0
2A	for Action Office® Series 1 and 2 squared-edge work surface	+\$0
F8	for Canvas Office Landscape®	+\$0

Step 8. Lock

KA	keyed alike	+\$0
KC	keyed differently, chrome	+\$0
KD	keyed differently, black	+\$0

Step 9. Drawer Interior

For box/box/file (BBF)

NN	none	+\$0
3M	drawer divider in one box drawer, pencil tray in one box drawer, 2 file converters in file drawer	+\$25

For file/file (FF)

NN	none	+\$0
1M	2 file converters in each file drawer	+\$25

V-Pull Support Pedestal

LV150.

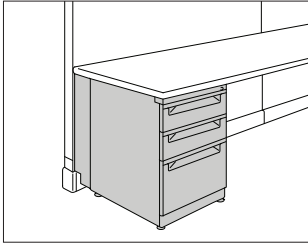

Specification Information

Step 1.

LV150.

Step 2. Depth

20	20" deep
24	24" deep
28	28" deep

Step 3. Configuration

BBF	box/box/file
FF	file/file

Prices for Steps 1-3.

	BBF	FF
LV150. 20	\$564	523
24	\$591	562
28	\$623	595

Step 4. Slides

For box/box/file (BBF)

SR	3/4-extension roller slides on box drawer, full-extension ball bearing on file drawer	+\$0
-----------	---	------

For file/file (FF)

SB	full-extension ball-bearing	+\$0
-----------	-----------------------------	------

Step 5. Paint/Steel Type

SS	smooth paint on smooth steel	+\$0
XS	textured paint on smooth steel	+\$0

Step 6. Surface Finish

For smooth paint on smooth steel (SS)

8Q	folkstone grey	+\$0
BU	black umber	+\$0
HF	inner tone light	+\$0
LT	light tone	+\$0
LU	soft white	+\$0
MT	medium tone	+\$0
WL	sandstone	+\$0
CN	metallic champagne	+\$40
EH	metallic bronze	+\$40
MS	metallic silver	+\$40

Bright Sand Texture Paint

For textured paint on smooth steel (XS)

91	white	+\$0
CL	cool grey neutral	+\$0
WN	warm grey neutral	+\$0

Step 7. Attachment Bracket

For smooth paint on smooth steel (SS)

1A	for Action Office® Series 1 and 2 radiused-edge work surface	+\$0
2A	for Action Office® Series 1 and 2 squared-edge work surface	+\$0
E1	for Ethospace® System	+\$0
F8	for Canvas Office Landscape®	+\$0

For textured paint on smooth steel (XS)

1A	for Action Office® Series 1 and 2 radiused-edge work surface	+\$0
2A	for Action Office® Series 1 and 2 squared-edge work surface	+\$0
F8	for Canvas Office Landscape®	+\$0

Step 8. Lock

KA	keyed alike	+\$0
KC	keyed differently, chrome	+\$0
KD	keyed differently, black	+\$0

Step 9. Drawer Interior

For box/box/file (BBF)

NN	none	+\$0
3M	drawer divider in one box drawer, pencil tray in one box drawer, 2 file converters in file drawer	+\$25

For file/file (FF)

NN	none	+\$0
1M	2 file converters in each file drawer	+\$25

W-Pull Suspended Pedestal

LW130.

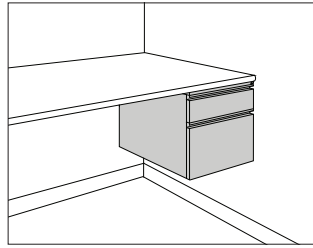

V-Pull Suspended Pedestal

LV130.

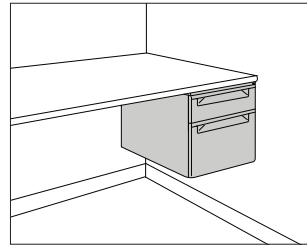

Til® Pedestals

Specification Information

Step 1.
LW130.20BF \$332

Step 2. Slides
SR 3/4-extension roller slides on box drawer, full-extension ball bearing on file drawer +\$0

Step 3. Paint/Steel Type
SS smooth paint on smooth steel +\$0
XS textured paint on smooth steel +\$0

Step 4. Surface Finish

For smooth paint on smooth steel (SS)

8Q	folkstone grey	+\$0
BU	black umber	+\$0
HF	inner tone light	+\$0
LT	light tone	+\$0
LU	soft white	+\$0
MT	medium tone	+\$0
WL	sandstone	+\$0
CN	metallic champagne	+\$40
EH	metallic bronze	+\$40
MS	metallic silver	+\$40

Bright Sand Texture Paint

For textured paint on smooth steel (XS)

91	white	+\$0
CL	cool grey neutral	+\$0
WN	warm grey neutral	+\$0

Step 5. Lock

KA	keyed alike	+\$0
KC	keyed differently, chrome	+\$0
KD	keyed differently, black	+\$0

Step 6. Drawer Interior

NN	none	+\$0
5M	pencil tray in box drawer, 2 file converters in file drawer	+\$20

Specification Information

Step 1.
LV130.20BF \$358

Step 2. Slides
SR 3/4-extension roller slides on box drawer, full-extension ball bearing on file drawer +\$0

Step 3. Paint/Steel Type
SS smooth paint on smooth steel +\$0
XS textured paint on smooth steel +\$0

Step 4. Surface Finish

For smooth paint on smooth steel (SS)

8Q	folkstone grey	+\$0
BU	black umber	+\$0
HF	inner tone light	+\$0
LT	light tone	+\$0
LU	soft white	+\$0
MT	medium tone	+\$0
WL	sandstone	+\$0
CN	metallic champagne	+\$40
EH	metallic bronze	+\$40
MS	metallic silver	+\$40

Bright Sand Texture Paint

For textured paint on smooth steel (XS)

91	white	+\$0
CL	cool grey neutral	+\$0
WN	warm grey neutral	+\$0

Step 5. Lock

KA	keyed alike	+\$0
KC	keyed differently, chrome	+\$0
KD	keyed differently, black	+\$0

Step 6. Drawer Interior

NN	none	+\$0
5M	pencil tray in box drawer, 2 file converters in file drawer	+\$20

File Drawer Organizer

LG901

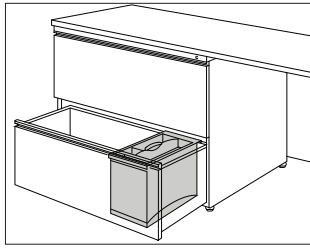

Specification Information

Step 1.

LG901

\$68

Drawer Divider, Tu® Pedestal

LG903.

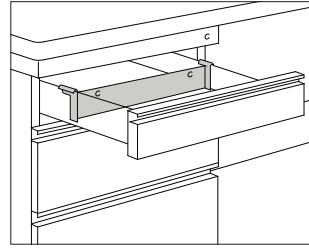

Specification Information

Step 1.

LG903.

Step 2. Usage

3 for pencil drawer

6 for box drawer

Prices for Steps 1-2.

LG903. 3

\$13

6

\$14

Tu® Pedestals

Stationery Divider, Tu® Pedestal

LG905

Utility Tray, Tu® Pedestal

LG906

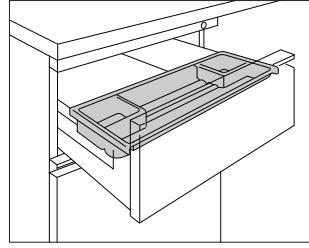
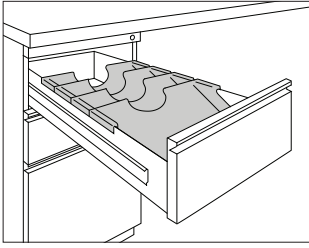

Tu® Pedestals

Specification Information

Step 1.

LG905

\$43

Specification Information

Step 1.

LG906

\$18

File Converter, Tu®

LG907

File Compressor, Tu®

LG908

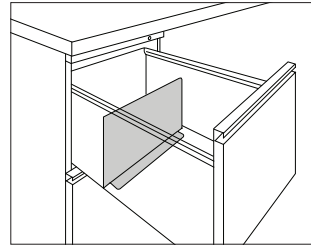
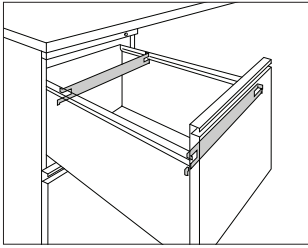

Specification Information

Step 1.

LG907

\$26

Specification Information

Step 1.

LG908

\$43

Tu® Pedestals

Index by Product Name

Ethospace® System 10-Day or Less	
	page(s)
2-Way 90° Connector	13
2-Way 90° Connector Cover	21
2-Way 90° Connector Cover, Architectural	22
2-Way 90° Connector Cover, Monolithic	22
2-Way 90° Connector, Monolithic	14
2-Way 90° Stacking Connector	18
3-Way 90° Connector	16
3-Way 90° Connector Cover	25
3-Way 90° Connector Cover, Monolithic	25
3-Way 90° Connector, Monolithic	17
3-Way 90° Stacking Connector	19
4-Way 90° Connector	17
4-Way 90° Stacking Connector	19
Acoustical Tile	40
Architectural Cladding, Fabric	39
B-Style Flipper Door	56
B-Style Flipper Door Unit	55
B-Style Shelf	57
B-Style Storage/Display Shelf	57
Bare Connector	20
Bare Frame	5
Base Power Entry, Junction Box, 4 Circuit	29
Baseline Box Assembly, H-Style Frame	33
Baseline Harness, 4 Circuit	30
Beltline Bezel, H-Style Frame	37
Beltline Harness, 4 Circuit	31
C-Style Flipper Door	59
C-Style Flipper Door Unit	58
C-Style Shelf	60
Cable Access Tile	41
Cable Channel Tile	41
Cable Manager, Extra Capacity	35
Ceiling Power Entry, Internal Direct Connect	29
Coat Hook	66
Communication Port Faceplate Extender	36
Communication Port Faceplate Reducer	35
Component Brace	65
Concave Corner Surface	48
Connector Top Cap	27
Connect™-S300	34
Cord Cleat	53
Corner Surface	47
Curvilinear Surface	46
Draw Rod	9
E-Style Flipper Door	61

E-Style Flipper Door Unit	60
E-Style Shelf	61
Energy-Efficient Task Light	67
Extended Corner Surface, Rectangular End	49
F-Style Shelf	64
F-Style Sliding Door Storage Unit	62
F-Style Storage Unit Back Panel	64
F-Style Upmount Sliding Door Storage Unit	63
Face Tile	37
Finished End	26
Finished End, Change of Height	26
Floor-Length Face Tile	38
Frame	5
Frame Top Cap	27
Frame, Transaction Work Surface	7
Marker Tile	44
Marker/Eraser Holder	44
Open Tile	42
Open Tile, Squared Stile	42
Oval Transaction Surface	53
Pass-Through Harness, Connector	31
Pass-Through Harness, Frame	30
Perforated Tile, Squares	43
Power Entry, External Direct Connect, 4 Circuit	28
Power Entry, Internal Direct Connect, 4 Circuit	28
Power Jumper, 4 Circuit	32
Rail Tile	43
Receptacle, 4 Circuit, 15 Amp	33
Rectangular Surface	45
Shelf Divider, Angled	65
Side Cover	8
Spacer	14
Spacer Connector Cover	23
Spacer Connector Cover, Monolithic	24
Spacer Stacking Connector	18
Spacer/3-Way 90° Connector Cover, Architectural	24
Squared-Edge Corner Wedge	49, 50
Squared-Edge Transaction Surface, Rectangular End	54
Stacking Frame	9
Stacking Frame Hardware Kit, Change of Height	20
Stiffener	52
Stile Covers and Top Caps, Transaction Work Surface Frame	7
Tackable Tile	40
Tile-Height Harness, 4 Circuit	32
Tile Adapter	11
Tool Bar	69

Index by Product Name *continued*

Index: Product Name

Trim Strip	11
Utility Task Light	68
Wall Fastener	10
Wall Start	12
Wall Start Filler	12
Wall Strip	10
Work Surface-Attached Electrical Distributor	34
Work Surface-Attached Voice/Data Outlet	36
Work Surface Support Bracket	51
Work Surface Support Panel, End, Glides	51
Work Surface Support Panel, Mid-Run, Glides	52
Work Surface Support, Single	50
Meridian® Pedestals 10-Day or Less	
Drawer Divider for Box Drawer, Meridian® Pedestal	page(s) 86
File Drawer Organizer	86
Pencil Tray for Box Drawer, Meridian® Pedestal	85
Sloped-Pull Freestanding Pedestal	83
Sloped-Pull Mobile Pedestal	84
Standard-Pull Freestanding Pedestal	81
Standard-Pull Mobile Pedestal	82
Standard-Pull Suspended Pedestal	83
Quadrant® Pedestals 10-Day or Less	
B-Pull Freestanding Pedestal	page(s) 73
B-Pull Mobile Pedestal	73
B-Pull Support Pedestal	74
B-Pull Suspended Pedestal	74
F-Pull Freestanding Pedestal	75
F-Pull Mobile Pedestal	76
F-Pull Support Pedestal	77
F-Pull Suspended Pedestal	76
Tu® Pedestals 10-Day or Less	
Drawer Divider, Tu® Pedestal	page(s) 97
File Compressor, Tu®	99
File Converter, Tu®	99
File Drawer Organizer	97
Stationery Divider, Tu® Pedestal	98
Utility Tray, Tu® Pedestal	98
V-Pull Freestanding Pedestal	90
V-Pull Mobile Pedestal	92
V-Pull Support Pedestal	95
V-Pull Suspended Pedestal	96
W-Pull Freestanding Pedestal	89
W-Pull Mobile Pedestal	91
W-Pull Support Pedestal	94
W-Pull Surface-Attached Pedestal	93
W-Pull Suspended Pedestal	96

Index by Product Number

73-15	Drawer Divider for Box Drawer, Meridian® Pedestal	page(s) 86	E1342.	Pass-Through Harness, Frame	30
73-15	Pencil Tray for Box Drawer, Meridian® Pedestal	85	E1353.	Beltline Harness, 4 Circuit	31
E1109.	Bare Frame	5	E1354.	Baseline Harness, 4 Circuit	30
E1109.	Frame	5	E1355.		
E1112.	Stacking Frame	9	E1356.	Pass-Through Harness, Connector	31
E1116.	Frame, Transaction Work Surface	7	E1357.	Tile-Height Harness, 4 Circuit	32
E1117.	Stile Covers and Top Caps, Transaction Work Surface Frame	7	E1396.	Cable Manager, Extra Capacity	35
E1120.	Draw Rod	9	E1420.	Face Tile	37
E1130.	Wall Strip	10	E1420.	Floor-Length Face Tile	38
E1131.	Tile Adapter	11	E1422.	Tackable Tile	40
E1132.	Trim Strip	11	E1423.	Acoustical Tile	40
E1210.	Wall Start	12	E1424.		
E1212.	Wall Start Filler	12	E1425.	Rail Tile	43
E1219.	Bare Connector	20	E1426.	Marker Tile	44
E1220.	2-Way 90° Connector	13	E1433.	Cable Channel Tile	41
E1220.	2-Way 90° Stacking Connector	18	E1436.	Cable Access Tile	41
E1222.	Spacer	14	E1440.	Open Tile	42
E1222.	Spacer Stacking Connector	18	E1441.	Perforated Tile, Squares	43
E1224.	2-Way 90° Connector, Monolithic	14	E1444.	Open Tile, Squared Stile	42
E1230.	3-Way 90° Connector	16	E1445.	Architectural Cladding, Fabric	39
E1230.	3-Way 90° Stacking Connector	19	E2290.	Work Surface Support Panel, End, Glides	51
E1231.	3-Way 90° Connector, Monolithic	17	E2291.	Work Surface Support Panel, Mid-Run, Glides	52
E1240.	4-Way 90° Connector	17	E2393.	Work Surface Support, Single	50
E1240.	4-Way 90° Stacking Connector	19	E2810.	Oval Transaction Surface	53
E1250.	Finished End	26	E2812.	Squared-Edge Transaction Surface, Rectangular End	54
E1251.	Finished End, Change of Height	26	E2931.	Work Surface Support Bracket	51
E1260.	Frame Top Cap	27	E3110.	E-Style Flipper Door Unit	60
E1261.	Connector Top Cap	27	E3130.	E-Style Shelf	61
E1263.	Side Cover	8	E3133.		
E1264.			E3212.	B-Style Flipper Door Unit	55
E1270.	2-Way 90° Connector Cover	21	E3217.	B-Style Flipper Door	56
E1271.	Spacer Connector Cover	23	E3230.	B-Style Shelf	57
E1272.	3-Way 90° Connector Cover	25	E3231.		
E1274.	2-Way 90° Connector Cover, Monolithic	22	E3232.	B-Style Storage/Display Shelf	57
E1275.	Spacer Connector Cover, Monolithic	24	E3610.	Tool Bar	69
E1276.	3-Way 90° Connector Cover, Monolithic	25	E3810.	F-Style Sliding Door Storage Unit	62
E1281.	2-Way 90° Connector Cover, Architectural	22	E3811.	F-Style Shelf	64
E1282.	Spacer/3-Way 90° Connector Cover, Architectural	24	E3812.	F-Style Storage Unit Back Panel	64
E1293.	Stacking Frame Hardware Kit, Change of Height	20	E3814.	F-Style Upmount Sliding Door Storage Unit	63
E1294.			E3922.	Coat Hook	66
E1311.	Receptacle, 4 Circuit, 15 Amp	33	E9002.	E-Style Flipper Door	61
E1322.	Power Entry, External Direct Connect, 4 Circuit	28	EW400.	Baseline Box Assembly, H-Style Frame	33
E1323.	Base Power Entry, Junction Box, 4 Circuit	29	EWS10.	Rectangular Surface	45
E1325.	Power Entry, Internal Direct Connect, 4 Circuit	28	EWS12.	Curvilinear Surface	46
E1331.	Ceiling Power Entry, Internal Direct Connect	29	EWS20.	Corner Surface	47
E1341.	Power Jumper, 4 Circuit	32	EWS21.	Concave Corner Surface	48

Index by Product Number *continued*

Index: Product Number

EWS22. Extended Corner Surface, Rectangular End	49
F16-1 Standard-Pull Freestanding Pedestal	81
F19P- Sloped-Pull Freestanding Pedestal	83
FAF10. F-Pull Freestanding Pedestal	75
FAF11. F-Pull Mobile Pedestal	76
FAF12. F-Pull Suspended Pedestal	76
FAF13. F-Pull Support Pedestal	77
FV696. Stiffener	52
G1189. Communication Port Faceplate Extender	36
G1189. Communication Port Faceplate Reducer	35
G1331. Cord Cleat	53
G1510. Beltline Bezel, H-Style Frame	37
G5112. B-Pull Suspended Pedestal	74
G5120. B-Pull Freestanding Pedestal	73
G5121. B-Pull Mobile Pedestal	73
G5130. B-Pull Freestanding Pedestal	73
G5131. B-Pull Mobile Pedestal	73
G5150. B-Pull Support Pedestal	74
G5151.	
G6120. Energy-Efficient Task Light	67
G6121.	
G6123.	
G6136. Utility Task Light	68
G6137.	
G7330. Shelf Divider, Angled	65
LG901 File Drawer Organizer	86, 97
LG903. Drawer Divider, Tu® Pedestal	97
LG905 Stationery Divider, Tu® Pedestal	98
LG906 Utility Tray, Tu® Pedestal	98
LG907 File Converter, Tu®	99
LG908 File Compressor, Tu®	99
LV100. V-Pull Freestanding Pedestal	90
LV110. V-Pull Mobile Pedestal	92
LV130. V-Pull Suspended Pedestal	96
LV150. V-Pull Support Pedestal	95
LW100. W-Pull Freestanding Pedestal	89
LW110. W-Pull Mobile Pedestal	91
LW130. W-Pull Suspended Pedestal	96
LW140. W-Pull Surface-Attached Pedestal	93
LW150. W-Pull Support Pedestal	94
M16-1 Standard-Pull Mobile Pedestal	82
M19P- Sloped-Pull Mobile Pedestal	84
S16-1 Standard-Pull Suspended Pedestal	83
X1192. Wall Fastener	10
X3710. C-Style Flipper Door	59
X3730. C-Style Shelf	60

X3750. C-Style Flipper Door Unit	58
X3910. Component Brace	65
Y1314. Work Surface-Attached Electrical Distributor	34
Y1320. Work Surface-Attached Voice/Data Outlet	36
Y1323. Connect™-S300	34
Y2091. Squared-Edge Corner Wedge	49, 50
Y7231. Marker/Eraser Holder	44

10-Day or Less Order Information

10-Day or Less Program

10-day or less products are designed for established Herman Miller dealers with pre-approved credit.

Products are distributed from multiple West Michigan manufacturing facilities. These include Holland, Spring Lake, and Zeeland. Orders will be shipped within 10 business days or less from the date of Herman Miller acknowledgement.

Ordering Procedures

1. Please place orders through Order Manager. If this is not available to you, place orders through mail or fax. Verbal purchase orders will not be accepted.
Order Entry fax number for Passage®, 5000 Series, and Meridian® Filing and Storage: (616) 846 9236.
Order Entry fax number for all other products: (616) 654 3085.
2. Orders must be clearly marked “10-day or less program” and include only 10-day or less products. Orders not marked this way will be processed under standard lead times. Orders for standard lead times must be placed on a separate purchase order.
3. Only fabrics and finishes listed with each product are available through the 10-day or less program.
4. For any 10-day or less project over \$250,000 list price, please contact your Customer Care representative within 48 hours of order entry to reserve lead time.
5. For more information, contact your Customer Care representative at: (866) 854 3048 EXT 3400.

Shipments and Delivery

Per Herman Miller Terms and Conditions.

Changes and Cancellation

Per Herman Miller Terms and Conditions.



10-Day Keyed-Alike Information

Keyed-Alike Locks

All components with locks may be specified keyed alike. Products with keyed-alike locks will be shipped with lock chassis installed. Installation of lock cylinders will be on-site according to instructions provided. Herman Miller, Inc. will not be responsible for lock cylinder installation.

When specifying product keyed-alike, include separate lines on your order for the lock cylinders.

For Action Office®, Ethospace®, and Passage® products, list cylinder part number and key number (232092-XXX); select a key number (or numbers) between 226 and 427, excluding numbers 408 and 412.

For Meridian® Filing and Storage or Herman Miller 5000 Series, see the following charts.

Keyed-alike locks are field installed.

To order keyed-alike locks for Action Office® Series 1 and 2 door panels, please contact Customer Care.

A master key can be used to open any lock on an attached or freestanding component. In addition, a removal key or lock change tool is required to remove lock plugs. Customers interested in ordering master keys, removal keys, or lock change tools should contact Customer Care.

For Meridian Filing and Storage or Herman Miller 5000 Series desk components with pedestals, specify as follows:

Specification Code	Key Number	Color	Lock Series
KA	232092-XXX ¹	black	UM series 226-427
KA	1B2JKP-XXX ²	black	BT series 1-165
KA	1B2JK7-XXX ¹	chrome	UM series 226-427
KA	1B2JK6-XXX ²	chrome	BT series 1-165

For 5000 Series flipper door unit with bezel or credenza storage cabinet with bezel, specify as follows:

Specification Code	Key Number	Color	Lock Series
KA	232092-XXX ¹	black	UM series 226-427
KA	1B2JKP-XXX ²	black	BT series 1-165
KQ	1B2JK7-XXX ¹	chrome	UM series 226-427
KQ	1B2JK6-XXX ²	chrome	BT series 1-165

Key Number:

XXX¹ = a key number between 226 and 427 (excluding 408 and 412)

XXX² = a key number between 1 and 165



Proprietary Textiles Application Chart – 10-Day Workspaces

- Available

Application Note: Herman Miller cannot guarantee material/pattern alignment in adjacent products. For example, a fabric's pattern may not align from one screen to the next, or from one panel to the next.

	Action Office® Panels/Connectors	B-Style Flipper Doors	B-Style Tackboards	E-Style Flipper Doors	Ethospace® Tiles/Connectors	Ethospace Attaching Screens	Canvas Office Landscape™ Tiles	Passage® Flipper Doors	Passage Screens	Resolve® Boundary Screens	5000 Series Flipper Doors	5000 Series Tackboards	Seating
Price Category 1													
8A__ Bubbletack										•			
2V__ Chain	•	•	•	•	•		22	3	15		3	3	
8T__ Crossing (85__)	5	2	2	•			•	3	15		3	3	6
2I__ Grasscloth	•	•	•	•	•		•	3	15		3	3	
5B__ Infusion	2	2	2	•	•		•	3	15		3	3	
8B__ Multiscrim™						•				•			
1Z__ Penumbra	•	•	•	•	•		•	3	15		3	3	
5T__ Resonance	•	•	•	•	•		•	3	15		3	3	
8C__ Scrim Trim										•			
2M__ Silkworm	•	•	•	•	•		•	3	15		3	3	
2Z__ Slideshow		2		•	•		•	3	15		3	3	•
Price Category 2													
5E__ Aggregate	•	•	•	•	•		•	3	15		3	3	
51__ Cord	•	•	•	•	•		•	3	15		3	3	
92__ Crepe	2	•	•	•	•		•	3	15		3	3	•
57__ Frost	•	•	•	•	•		•	3	15		3	3	
84__ Grosgrain	5			•	•		•	3	15		3	3	
4N__ Horizon	2	2	2	•	•		•				3	3	
2U__ Luminary	•	•	•	•	•		•	3	15		3	3	
3A__ Moiré		2	2	•	•		22	3	15		3	3	
8V__ Railroad		2	2	•				3	15		3	3	•
8R__ Twist (5S__)	4	2	2	•	•		•	3	15		3	3	6
Price Category 3													
70__ Bento	2	2	2	•			•	3	15		3	3	•
8S__ Coil	2	2	2	•	•		•	3	15		3	3	•
8Z__ Glaze	•	•	•	•	•		•	3	15		3	3	
47__ Ground Cloth®	•	•	•	•	•		•	3	15		3	3	
5D__ Kira 2	2	2	2	•	•		•				3	3	
8L__ Savannah	•	20	21	•	•		•			•			
67__ Soba	5	•	•	•	•		•	3	15		3	3	
8U__ Stitches (5Z__)								3	15		3	3	6
8W__ Strands	•	•	•	•	•		•	3	15		3	3	
68__ Udon	5	•	•	•	•		•	3	15		3	3	
5K__ Wickendon	2	2	2	•	•		•	3	15		3	3	•
Price Category 4													
2W__ Gleam	•	•	•	•	•		•				3		
2X__ Glisten	•	•	•	•	•		•	3	15		3	3	
63__ Sironetta	•	•	•	•	•		•	3	15		3	3	
1V__ Violetta	•	•	•	•	•		•	3	15		3	3	

- 2 Available on all products except 54" and 60" wide.
- 3 Fabric is railroaded for all widths.
- 4 Not available on Action Office acoustical panels and not available on 54" and 60" wide products.
- 5 Not available on Action Office acoustical panels.

- 6 Available on seating products in select colors. See the "Proprietary Textile Colors-10-Day Seating" appendix.
- 15 Fabric is railroaded for all widths, except on Passage full-height screens.
- 20 Available only on Ethospace B-Style.
- 22 Not available as railroaded application option for Chain (2V__) and Moiré (3A__).



Proprietary Textile Colors – 10-Day Workspaces

Price Category 1

Bubbletack
100% polyester
8A01 Seashell White
8A02 Pearl Grey
8A07 Pebble Beige
8A19 Spa Blue

Chain
66" wide
100% recycled polyester
2V02 Oyster
2V04 Linen
2V05 Wicker
2V08 Spring Wood
2V09 Iceberg

Crossing
54" wide
86% antimony-free polyester
14% polyester
8T03 Wicker
8T04 Porcelain
8T06 Sepia
8T07 Pumpkin
8T10 Tomato
8T11 Mulberry
8T13 Green Apple
8T14 Loden
8T17 Cerulean
8T18 Indigo
8T19 Shale
8T21 Bark
8T22 Tin
8T23 Graphite
8T24 Black

Crossing
For systems products only.
54" wide
86% antimony-free polyester
14% polyester
8502 Oyster

Grasscloth
66" wide
100% recycled polyester
2I01 Silver Birch
2I02 Pampas
2I03 Sedge
2I07 Lea
2I08 Taro

Infusion
54" wide
100% polyester
5B01 Tint
5B02 Iron
5B03 Ginseng
5B04 Fennel
5B05 Pollen
5B08 Blue Spray

Multiscrim™
60" wide
100% polyester
8B01 Seashell White
8B02 Pearl Grey
8B07 Pebble Beige
8B19 Spa Blue

Penumbra
66" wide
100% recycled polyester
1Z01 Janus
1Z02 Phoebe
1Z03 Rhea
1Z06 Umbriel

Resonance
66" wide
100% polyester
5T04 Greige
5T05 Porcelain
5T06 Alabaster
5T15 Iris
5T22 Marsh
5T28 Sugar
5T37 Bud
5T42 Khaki
5T45 Cattail
5T51 Bayou

Scrim Trim
61" wide
82% polyester
18% spandex
8C01 Seashell White
8C02 Pearl Grey

Silkworm
66" wide
58% recycled polyester
42% polyester
2M01 Cocoon
2M02 Pongee
2M03 Saffron
2M04 Tussah

Slideshow
54" wide
56% recycled polyester
44% polyester
2Z01 Cinema
2Z03 Shutter
2Z04 Scenic
2Z05 Portrait
2Z09 Exposure

Price Category 2

Aggregate
66" wide
100% polyester
5E01 Foxglove
5E03 Shale
5E05 Lichen
5E06 Parchment
5E07 Straw
5E16 Fawna

Cord
66" wide
52% antimony-free polyester
48% polyester
5I02 White Ash
5I03 Linen
5I04 Bamboo
5I05 Sepia
5I11 Spring Wood

Crepe
54" wide
100% recycled polyester
9201 Licorice
9203 Smoke
9209 Claret
9235 Cashew
9239 Chutney
9241 Beachglass
9243 Midnight
9244 Artichoke
9246 Malt
9247 Phantom

Proprietary Textile Colors – 10-Day Workspaces

continued

Price Category 2

continued

Frost

66" wide
100% recycled polyester
5701 Bisque
5702 Abalone
5703 Porcelain
5704 Honey
5706 Sage
5710 Sable Grey

Grograin

66" wide
100% recycled polyester
8401 Pearl
8402 White Ash
8404 Khaki
8412 Tin

Horizon

54" wide
65% antimony-free polyester
35% polyester
4N01 Rye Grass
4N02 Sugar Pine
4N04 White Ash
4N05 Spring Wood
4N09 Oat Grass

Luminary

66" wide
100% recycled polyester
2U01 Shimmer
2U05 Glow
2U07 Flicker

Moiré

54" wide
100% recycled polyester
3A01 Concrete
3A03 Rattan
3A04 Chambray
3A12 Cork

Railroad

54" wide
100% recycled polyester
8V01 Straw
8V05 Root
8V06 Wicker
8V09 Slate

Twist

54" wide
80% antimony-free polyester
13% recycled polyester
7% polyester
8R05 Wicker
8R07 Squash
8R09 Cayenne
8R10 Poppy
8R12 Garnet
8R14 Tin
8R15 Shale
8R16 Graphite
8R17 Birch
8R18 Sepia
8R21 Periwinkle
8R22 Blueberry
8R23 Green Apple
8R24 Loden
8R25 Turquoise

Twist

For systems products only.
54" wide
80% antimony-free polyester
13% recycled polyester
7% polyester
5S01 Pearl
5S02 Ivory
5S03 Oyster

Price Category 3

Bento

54" wide
100% antimony-free polyester
7003 Khaki
7004 Truffle

Coil

54" wide
100% recycled polyester
8S01 Nougat
8S06 Claret
8S11 Hemlock
8S12 Java
8S16 Ink
8S17 Black

Glaze

66" wide
100% recycled polyester
8Z01 Wicker
8Z03 Porcelain
8Z06 Rye
8Z07 Frost
8Z08 Silver Birch

Ground Cloth®

66" wide
100% polyester
4701 Vapor Grey
4702 Oyster Grey
4703 Yellow Flax
4712 Pearl Ash
4714 Frosty Morn
4717 Hedge Row

Kira 2

54" wide
100% recycled polyester
5D13 Oasis
5D15 Ash
5D16 Falcon

Savannah

66" wide
76% recycled polyester
24% polypropelene
8L01 Pearl
8L07 Linen
8L10 Frost

Soba

66" wide
100% antimony-free polyester
6701 Steam Grey
6704 Khaki
6705 Oyster

Stitches

54" wide
54% polyester
46% recycled polyester
8U02 Rye
8U03 Khaki
8U07 Brick
8U11 Evening Blue
8U12 Charcoal
8U14 Olive
8U16 Cocoa
8U17 Seed

Stitches

For systems products only.
54" wide
54% polyester
46% recycled polyester
5Z01 White Ash

Strands

66" wide
100% recycled polyester
8W01 Pebble
8W02 Porcelain
8W03 Taupe
8W05 Khaki
8W08 Tin

Proprietary Textile Colors – 10-Day Workspaces

continued

Price Category 3

continued

Udon
66" wide
100% antimony-free polyester
6801 Steam Grey
6804 Khaki
6805 Oyster

Wickendon
54" wide
100% polyester
5K01 Morning Glory
5K02 Jasmine
5K05 Grapevine
5K08 Trumpet Vine

Price Category 4

Gleam
66" wide
100% recycled polyester
2W06 Khaki
2W08 Reed

Glisten
66" wide
84% polyester
16% recycled polyester
2X02 Rye
2X05 Iceberg
2X09 Pewter
2X10 Ash

Quilty
56" wide
100% antimony-free polyester
GreenShield
6S01 Wicker
6S05 Squash
6S06 Cayenne
6S10 Mink
6S11 Green Apple

Sironetta
66" wide
100% recycled polyester
6301 Acapella
6302 Sonata
6303 Interlude
6308 Harmony

Violetta
66" wide
100% recycled polyester
1V01 Camilla
1V02 Bellina
1V03 Alfredo
1V04 Barone
1V05 Renata

For more information about our products and services or to see a list of dealers, please visit us at HermanMiller.com or call (800) 851 1196.

This book is recyclable. Printed in U.S.A. on recycled paper.

© 2014 Herman Miller, Inc., Zeeland, Michigan

® **HermanMiller**, , Action Office, Aeron, Ambi, Ardea, Aside, Avive, Canvas Office Landscape, Caper, Celle, Co/Struc, DOT, Eames, Embody, Equa 2, Ergon 3, Ethospace, Fine-Tune, FlexFront, Ground Cloth, Herman Miller Healthcare, Herman Miller Options, Leaf, Maharam, Meridian, Mirra, Passage, Pellicle, Perspectives, PostureFit, Resolve, SAYL, Setu, Thrive, Tu, Vary Easy, Y-Tower, and Z-Axis are among the registered trademarks of Herman Miller, Inc., and its owned subsidiaries.

™ AireWeave, Boomerang, Bubbletack, Cellular Suspension, CLT, Compass, Connect, Durawrap, Flex-Edge, Formcoat, Hopsak 2, Intent, Iota, Keyless Entry, Everywhere, Latitude, Lyris 2, Multiscrim, My Studio Environments, Nelson, Rapunzel, Sense, Stackable, Stackable Storage, Swoop, TriFlex, and V-Wall are among the trademarks of Herman Miller, Inc., and its owned subsidiaries.

SM TAP, Textile Alliance Program, and Thrive are among the service marks of Herman Miller, Inc.

Chemsurf® is a registered trademark of Wilsonart International.

Corian® is a registered trademark of E.I. du Pont de Nemours and Company Corporation.

FLEXNET™ is a trademark of Milliken & Company.

Floor Saver Glide® is a registered trademark of Carpin Manufacturing, Inc.

Geiger® is a registered trademark of Geiger International.

GREENGUARD® is a registered trademark of the Greenguard Environmental Institute.

Microsoft® and Natural® Keyboard are registered trademarks of Microsoft Corporation.